

senelux

INSTRUCTION MANUAL

STAND FAN



Model: FD-40M

ENGLISH

TABLE OF CONTENTS

(i) Instructions For Safe Operation	02
(ii) Parts Description	04
(iii) Operating Instructions	05
(iv) Maintenance Instructions	05
(v) Warranty	06
(vi) Information	06

1. INSTRUCTIONS FOR SAFE OPERATION

1. Fan should be used only at rated voltage. This fan is designed for a 230V~ 50Hz electric supply.
2. Never insert fingers or any other object through the fan guard when fan is running.
3. Unplug when not in use, or when moving the fan from one location to another, and before putting on or taking off parts and before cleaning.
4. Regularly check the power cable and power plug for any signs of wear and tear or damage. If any damage is noticed, the manufacturer or service agent must repair it before using it again. Please note that any unofficial repair may invalidate your warranty.
5. Do not put your fingers through the openings. Do not let children put any objects into the front case.
6. Do not use this fan outside or in a damp area such as bathroom.
7. Do not place the electrical cable under a cover. Do not overlay the cable with coverings, rugs, or similar objects. Place the fan's power cable in an area where there are no trip hazards.
8. The fan must always be unplugged when not in use. To unplug the fan, all the switches must be turned to the position "OFF", and then the power plug can be removed.
9. Do not operate the fan in an area where gasoline is used or stocked, painting or such flammable liquids.
10. If you need to move the fan, switch off and unplug it.

11. If the fan requires maintenance or repair it must be sent to a registered service agent or the manufacturer.
12. No part of this fan must be replaced by the user.
13. The fan should not be opened up by the user.
14. Do not allow water or any other liquid to get inside the motor.
15. The fan must be earthed.
16. The fan must be placed on a stable, flat and level surface.
17. The fan must be kept away from any obstructions when oscillating
18. The appliance is not intended for use by persons (including children) with reduced physical, sensory, or mental capabilities, or lack of experience and knowledge unless they have been given supervision or instruction concerning the use of the appliance by a person responsible for their safety. Children should be supervised to ensure that they do not play with the appliance. This device is not suitable for children.

ENVIRONMENTAL PROTECTION



Discarded electric appliances are recyclable and should not be discarded in the domestic waste! Please actively support us in conserving resources and protecting the environment by returning this appliance to the collection centres.

Please read the user manual carefully before use and keep it for future reference.

2. PARTS DESCRIPTION

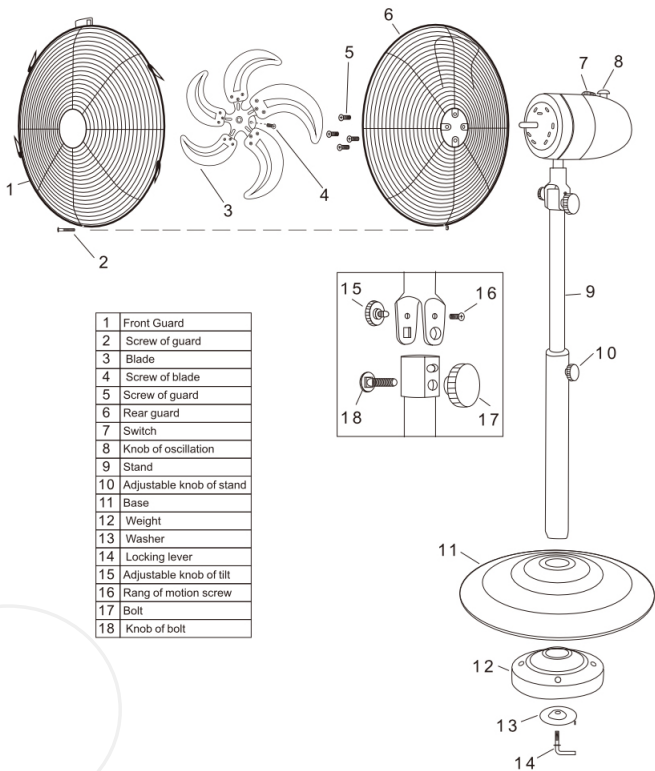

1	Front Guard
2	Screw of guard
3	Blade
4	Screw of blade
5	Screw of guard
6	Rear guard
7	Switch
8	Knob of oscillation
9	Stand
10	Adjustable knob of stand
11	Base
12	Weight
13	Washer
14	Locking lever
15	Adjustable knob of tilt
16	Range of motion screw
17	Bolt
18	Knob of bolt

3. OPERATING INSTRUCTIONS

1. Check that mains voltage complies with the voltage stated on the product.
2. Adjust the speed by the switch on motor housing:
0-Stop 1-Low 2-Medium 3-High
3. Push the **OSCILLATION KNOB** on motor housing to turn on the oscillation function. Pull the **OSCILLATION KNOB** to stop.

4. MAINTENANCE INSTRUCTIONS

1. Before cleaning turn the fan off and unplug from the power supply.
2. To clean the fan use a soft cloth to wipe off any dust. If the fan is very dirty use a damp cloth and wipe dry. Do not use any cleaning detergents, sprays or other chemicals, as they will damage the fan.
3. Store the fan in the original packing in a ventilated dry area.
4. The motor bearings are permanently sealed and do not require additional lubrication.
5. Do not allow water to drip on or enter the fan housing.

5. WARRANTY

All Senelux products are covered from the date of original purchase by a standard 2-year warranty. To register your warranty, please visit www.senelux.co.uk

If in the unlikely event that your product has any manufacturing defect, please contact our customer service team at support@senelux.co.uk. Please quote your order number and any other relevant details regarding the issues you are facing. FAQs and help regarding all our products are available on our website.

Any unauthorised repair of this product invalidates your warranty.

6. INFORMATION

If you would like any further information regarding the use of this product or any of our products, please contact us via the details below.

Senelux Ltd
Unit 5-6
105 Boundary Street
Liverpool
L5 9YJ
United Kingdom
Email – info@senelux.co.uk
Website – www.senelux.co.uk



Be sure to tag us in your photos on social media using #seneluxathome to be featured



Thank you very much for using our products.
Please read the user manual carefully before use and keep it for future reference.