

versatile™ 4C Mailbox, 4CADS-03

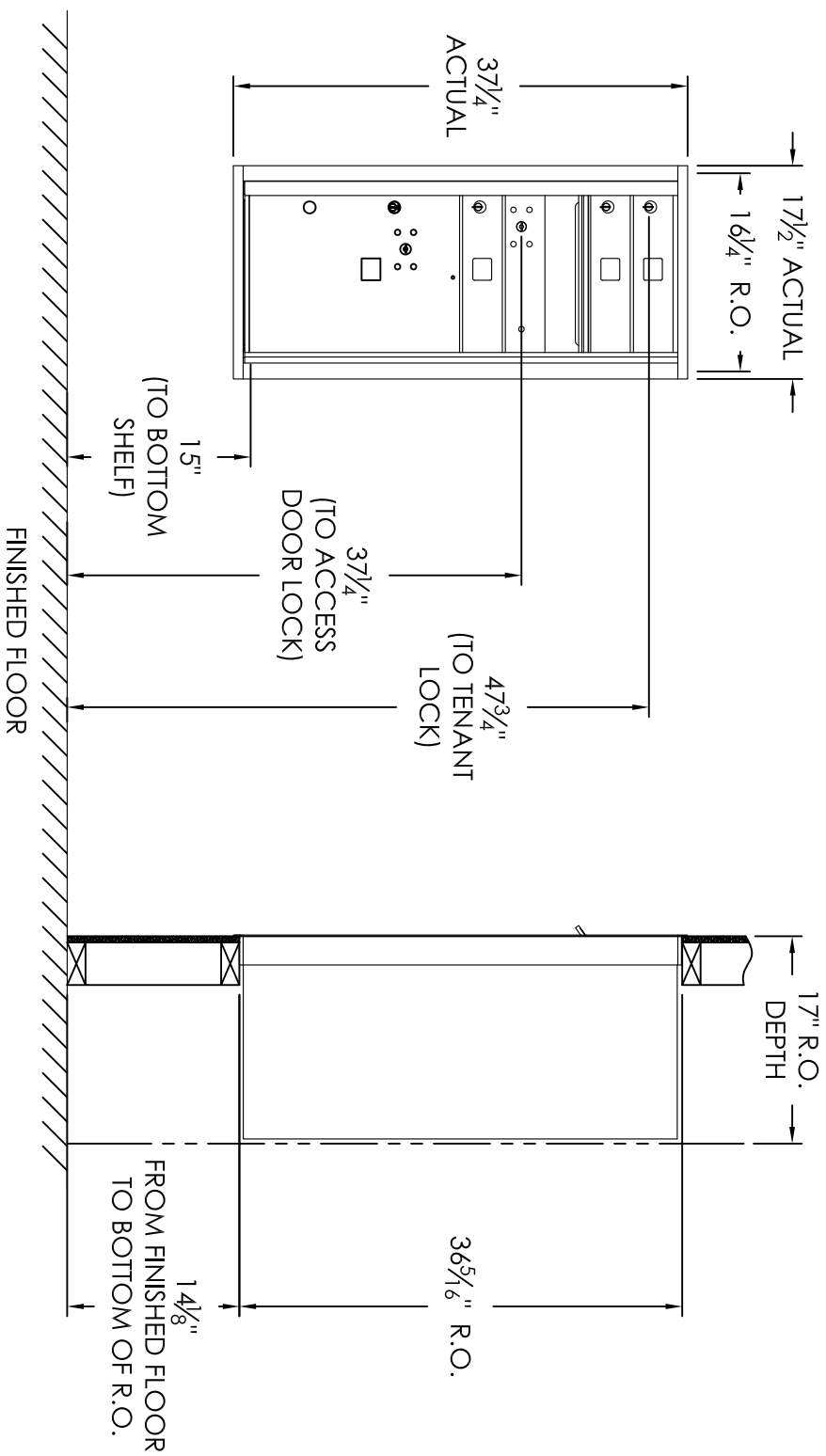

COMPARTMENT CHART

| DESCRIPTION | COMPARTMENT | COMPARTMENT SIZE | QTY. |
|---------------|-------------|--------------------------|------|
| MAILBOX | MB1 | 3" H x 12" W x 15" D | 3 |
| OUTGOING MAIL | OM2 | 6-1/2" H x 12" W x 15" D | 1 |
| PARCEL | PL5 | 17" H x 12" W x 15" D | 1 |

PRODUCT SERIES: VERSATILE™ 4C FRONT LOAD MAILBOX

AF FLORENCE
manufacturing company

MODEL 4CADS-03 REV B

SCALE NONE LAST REV DATE

DRAWING NUMBER 4CADS-03CS DRAWN BY

- Notes:
- This module meets the USPS STD-4C requirements for installation defined below when the mailbox is installed per the dimensions provided on this drawing.
 - At least one customer compartment shall be positioned less than 48" above finished floor (AFF).
 - No parcel locker (interior bottom shelf) shall be positioned less than 15" AFF.
 - No patron (tenant) lock shall be positioned more than 67" AFF.
 - No customer compartment (interior bottom shelf) shall be positioned less than 28" AFF.
 - The USPS Arrow lock shall be positioned 36"-48" AFF.
 - This 4C mailbox can also be used for private applications.
 - The rough opening width for multi-unit 4C installations = (the sum of all actual unit widths) - 1/8".