

versatile™ 4C Mailbox, 4C15D-09

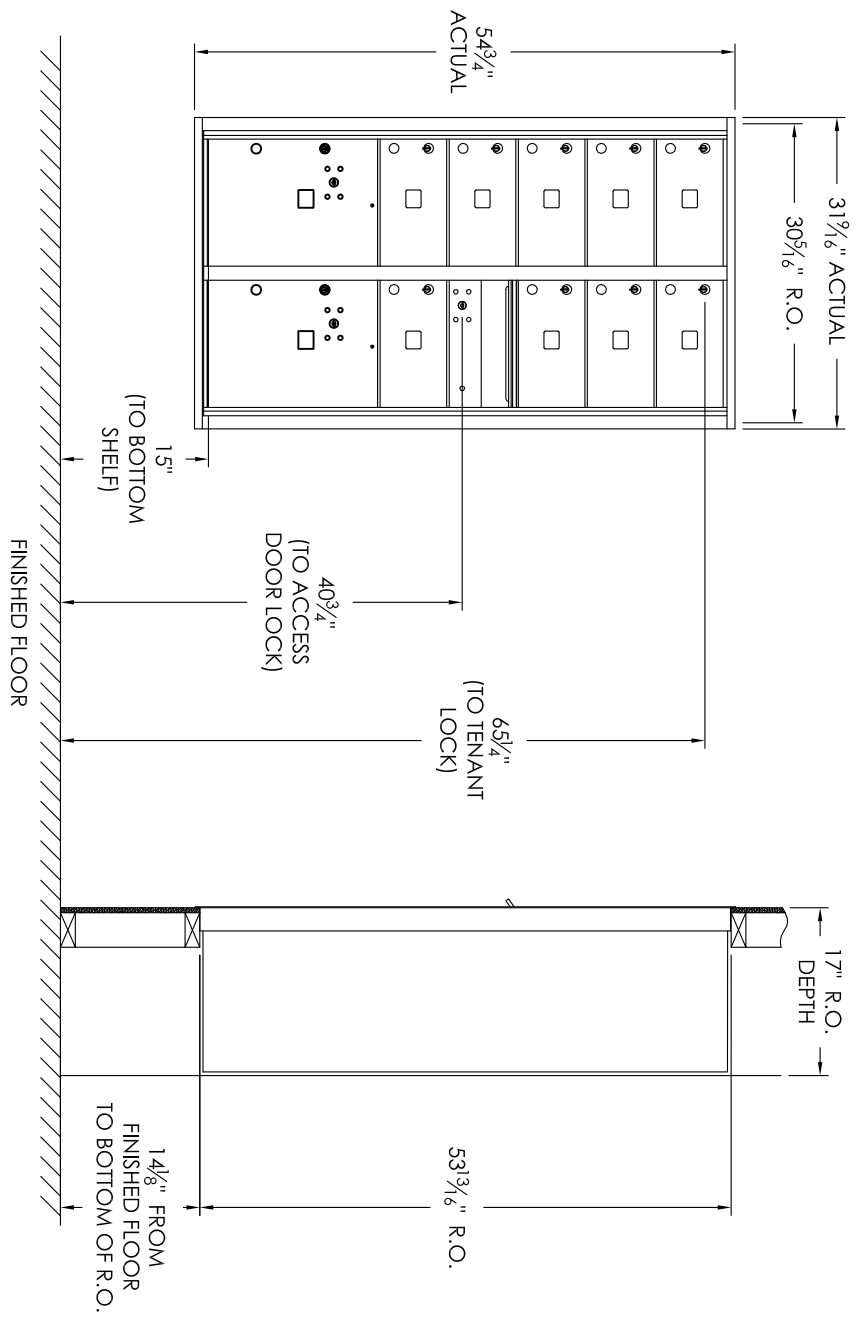

COMPARTMENT CHART

DESCRIPTION	COMPARTMENT	COMPARTMENT SIZE	QTY.
MAILBOX	MB2	6-1/2" H x 12" W x 15" D	9
OUTGOING MAIL	OM2	6-1/2" H x 12" W x 15" D	1
PARCEL	PL5	17" H x 12" W x 15" D	2

PRODUCT SERIES: VERSATILE™ 4C FRONT LOAD MAILBOX



<p>Notes:</p> <p>1. This module meets the USPS STD-4C requirements for installation defined below when the mailbox is installed per the dimensions provided on this drawing.</p> <p>a. At least one customer compartment shall be positioned less than 48" above finished floor (AFF).</p> <p>b. No parcel locker (interior bottom shelf) shall be positioned less than 15" AFF.</p> <p>c. No patron (tenant) lock shall be positioned more than 67" AFF.</p> <p>d. No customer compartment (interior bottom shelf) shall be positioned less than 28" AFF.</p> <p>e. The USPS Arrow lock shall be positioned 36"-48" AFF.</p> <p>2. This 4C mailbox can also be used for private applications.</p> <p>3. The rough opening width for multi-unit 4C installations = (the sum of all actual unit widths) - 1/8".</p>			
MODEL 4C15D-09		REV C	
SCALE NONE		LAST REV DATE	
DRAWING NUMBER 4C15D-09CS		DRAWN BY	