

versatile™ 4C Mailbox, 4C1 4D-07

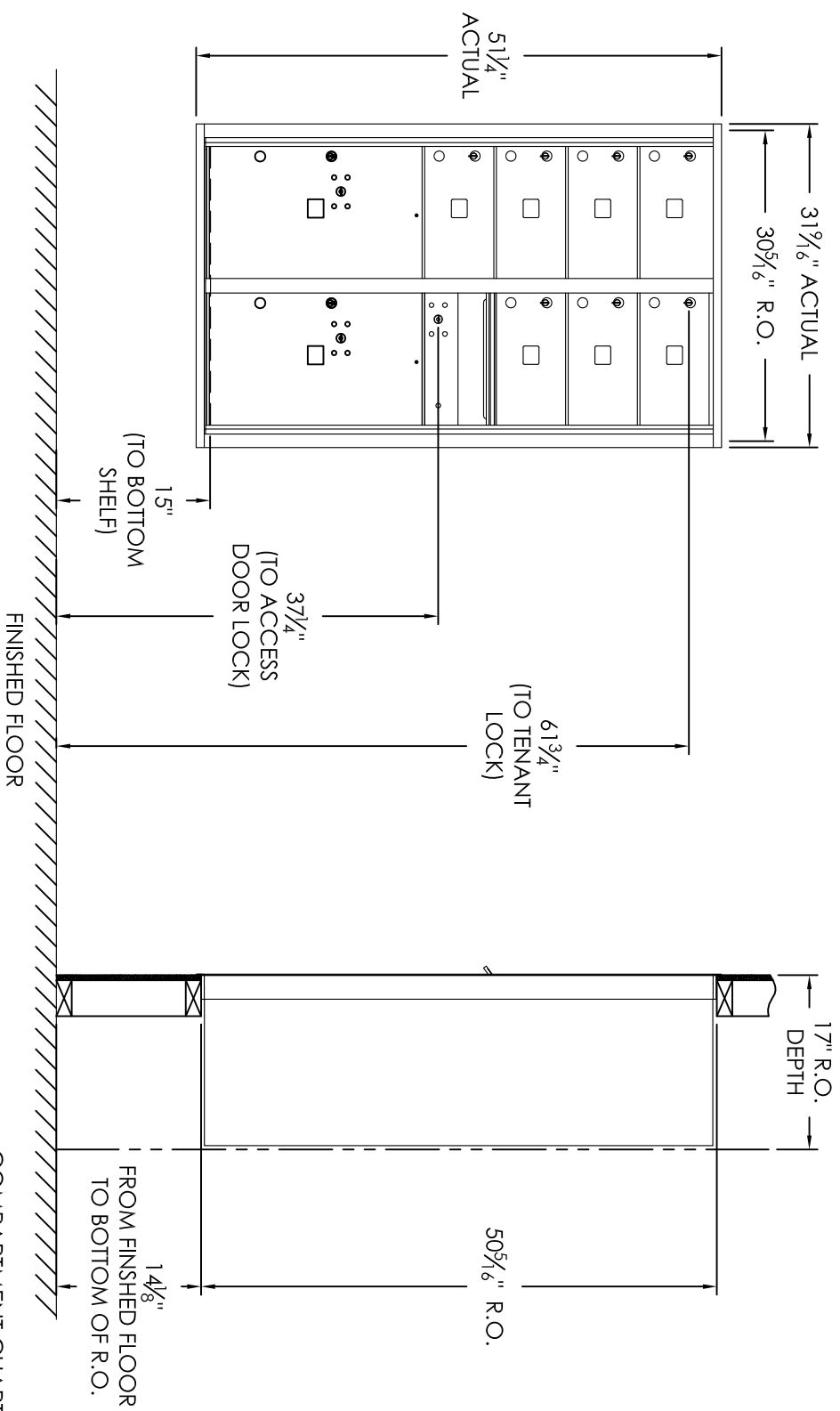

- Notes:
1. This module meets the USPS STD-4C requirements for installation defined below when the mailbox is installed per the dimensions provided on this drawing.
 - a. At least one customer compartment shall be positioned less than 48" above finished floor (AFF).
 - b. No parcel locker (interior bottom shelf) shall be positioned less than 15" AFF.
 - c. No patron (tenant) lock shall be positioned more than 67" AFF.
 - d. No customer compartment (interior bottom shelf) shall be positioned less than 28" AFF.
 - e. The USPS Arrow lock shall be positioned 36"-48" AFF.
 2. This 4C mailbox can also be used for private applications.
 3. The rough opening width for multi-unit 4C installations = (the sum of all actual unit widths) - 1/8".

PRODUCT SERIES: VERSATILE™ 4C FRONT LOAD MAILBOX

COMPARTMENT CHART

DESCRIPTION	COMPARTMENT	COMPARTMENT SIZE	QTY.
MAILBOX	MB2	6-1/2" H x 12" W x 15" D	7
OUTGOING MAIL	OM2	6-1/2" H x 12" W x 15" D	1
PARCEL	PL6	20-1/2" H x 12" W x 15" D	2

AF FLORENCE
manufacturing company

MODEL	4C1 4D-07	REV	A
SCALE	NONE	LAST REV DATE	
DRAWING NUMBER	4C1 4D-07CS	DRAWN BY	