





Labanca

Designer: Lievore Altherr Molina  
Year: 2004

A system of extremely versatile sofas, armchairs, and benches, developed and designed to suit any space and expressing an universal and international style with a fine and elegant form.

Developed by Tacchini in Italy

Dimensions (cm)

Cod. OLABA80

Cod. OLABP80

Cod. OLABB140

Cod. OLABP140

Cod. OLABC200

Cod. OLABP200

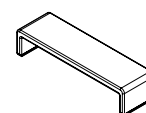
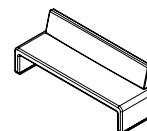
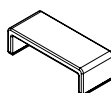
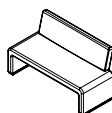

W 80 D 62 cm  
H 74 cm  
Seat H 39,5 cm

W 80 D 62 cm  
H 39,5 cm  
Seat H 39,5 cm

W 140 D 62 cm  
H 74 cm  
Seat H 39,5 cm

W 140 D 62 cm  
H 39,5 cm  
Seat H 39,5 cm

W 200 D 62 cm  
H 74 cm  
Seat H 39,5 cm

W 200 D 62 cm  
H 39,5 cm  
Seat H 39,5 cm

Cod. OLABD240

Cod. OLABP240

Non-removable covers

CAD Files:  
3D (.dwg, .3ds)  
2D (.dwg)

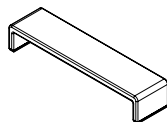
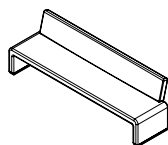

W 240 D 62 cm  
H 74 cm  
Seat H 39,5 cm

W 240 D 62 cm  
H 39,5 cm  
Seat H 39,5 cm

Download CAD files at [tacchini.it/en/downloads](http://tacchini.it/en/downloads)

---

Materials description

Internal frame: metal seat frame with elastic belts + seat bottom, back and armrest birch plywood 18 mm thickness.

---

Padding: differentiated - density polyurethane foam.

---

Base: shiny aluminium plates.

---

Upholstery: non removable cover.

Suggested upholsteries



Bakul

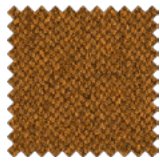

Bamboo



Berberis



Bopha

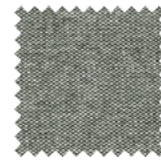

Bryony



Caladium



Cambria



Carissa



Daiki



Dianella

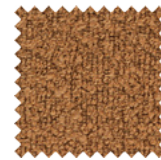

Dionea



Dulcamara



Erika

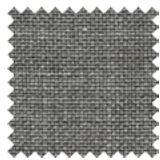

Thesium



Leather



Guarana

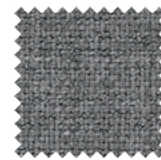

Escallonia



Escobaría



Schinus



Euclidium

Materials informations

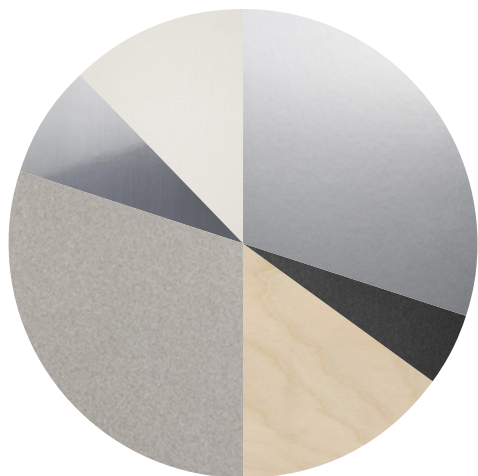

Metal Frame	28%
Polyurethane	30%
Plywood, Softwood	15%
Upholstery	12%
Aluminum	8%
Elastic Belts	5%

Polyurethane

Flexible expanded polyurethane is a solid elastic polymeric material with open cell structure. It is a non-toxic material and above all free from ozone-damaging components. Production and processing of the polyurethane we use meet the objectives of the new policy of ensuring the protection of human health and of the environment. We focus in particular on the choice and use of the types of density of polyurethane suitable for preserving over the years the features of load capacity, elasticity and resilience. For products used in public spaces flame-retardant expanded polyurethane is chosen, tested and certified according to international regulations.

Elastic belts

The elastic belt used on the seats of our upholstered products is a component to be chosen with care in order to ensure adequate elasticity and springing for the dimension and the structure of the product. We use plaited elastic webbing to add greater comfort and resistance to weight stresses.

Metal

The need to combine complex yet lightweight shapes with resistant materials necessarily involves the use of metals such as steel and aluminium. Products in polyurethane foam are made with an inner steel frame for adding strength to the structure. The bases are in tubular metal which can be chromed with a gloss or satin finish or painted with epoxy powders.

Wood

Wood is a renewable raw material. All products derived from wood, such as for example plywood, have the advantage of being able to be machined more easily than wood and do not deform. The timber we use – solid or plywood – comes mainly from European and Russian forests and is seasoned to specific values of humidity with tests. Most of the structures of the products in the collection have a frame in solid pine or ash, or in beech or poplar plywood.

Recyclability

All Labanca elements are 100% recyclable when fully separated. Tacchini undertakes on-going research and development, with efforts made to introduce products which are a perfect combination of function and safety without jeopardizing the final design of the same articles. During production attempts are made to minimize noise and emission levels and to reduce rejects as far as possible. All the single materials which make up the production process, once disassembled, can be reused several times, maintaining a high quality standard.

Packaging

Labanca element is dispatched already assembled. It is protected by tissue paper and cellophane to protect the covering from dust and direct contact with the cardboard. The product is packed in rigid cardboard boxes suitable for world export. Manufacture of the packaging observes the criteria for recovery both as recycling and energy recovery and composting.

Once a product reaches the end of its life cycle it has to be eliminated.

To discover more about Tacchini environmental policy please visit: [www.tacchini.it](http://www.tacchini.it)





---

**Lievore Altherr Molina**

Born in 1948, Alberto Lievore studied architecture in Buenos Aires. In the early years he focused not only on design, but also on the production and marketing of furniture, then, having moved to Barcelona, he was part of the Grupo Berenguer (1977), a leading name in Spanish design. In 1984 he inaugurated his own studio, focusing on industrial design, and on consultancy and art direction for a number of firms. His partners are designer and stylist Jeannette Altherr, who specializes in objects and spaces for children, and Manel Molina, who again brings with him vast and varied experiences in the industrial and exhibition design sectors.

---

**Selected projects:**

Axa  
(Paris, France)



Feusi Bildungszentrum  
(Bern, Switzerland)