

**HFCI-CD316R IN STAINLESS STEEL with RIMLEX®**

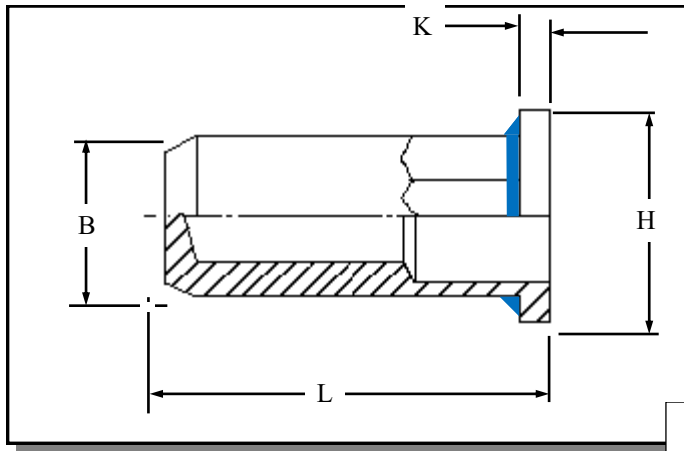

Hexagon flat head closed ended Rivetnuts with Rimlex® seal for material up to 4.50 mm thick

All dimensions in mm  
Material :- 316 Stainless Steel  
Contains >2% Molybden  
Finish :- Self colour  
With Rimlex® Seal See below \*

**R.T.S. SALES LINE**  
**01296 330331**

THREAD SIZE	GRIP RANGE	HOLE SIZE A/F -0.0 +0.10	BODY A/F "B"	HEAD DIA "H" ± 0.10	LENGTH "L"	"K"	PART NUMBER
M4	0.50 to 1.50	6.10	6.00	9.00	15.00	1.00	HFCI-04020-CD316R
M5	0.50 to 2.00	7.10	7.00	10.00	17.50	1.00	HFCI-05030-CD316R
M6	0.50 to 2.00	9.10	9.00	12.00	21.50	1.50	HFCI-06030-CD316R
	3.00 to 4.00				23.50		HFCI-06050-CD316R
M8	0.50 to 2.00	11.10	11.00	15.00	23.50	1.50	HFCI-08030-CD316R
	3.00 to 4.50				26.00		HFCI-08055-CD316R

The Rimlex® non-reactive seal is made of flexible organic based material, is applied under the head, it is resistant to many automotive oils, antifreeze and transmission fluids.

**NOTE**  
The application of Rimlex® under the head may reduce the grip range.

Colour	Blue
Hardness (ShoreA)	50 (approximately)
Sealing pressure:	> 150 bar
Shelf life on components	Indefinite
Re-usability:	Up to 10 times but is application dependent
Temperature range:	-40 to 150°C
Approved Specifications:	Ford Wss-M4G365-A1 Rover RES 22 FP05 Perkins PMS P.1.13 Eaton JCB Textron Fastening systems P1248
Cure time	30mins @ 160°C

For additional information and technical support please contact R.T.S. technical sales department . R.T.S. reserve the right to change specifications at any time . Information given is for guidance only and should not be used for specific design criteria without reference to our application engineers.