



USER'S MANUAL

WD24HX5201

TABLE OF CONTENTS

1	IMPORTANT INFORMATION		2
2	HOW TO INSTALL THE STAND		4
3	PREFACE		5
4	SAFETY PRECAUTIONS		5
5	CONTENTS		7
6	FRONT/BACK CONNECTIONS OF LED TV		8
7	TV INSTALLATION	Power Cord Connection	9
		Antenna Connection	9
		AV Connection	10
		VGA(PC) Connection	11
		USB Port Function	11
		HDMI Connection	12
8	REMOTE CONTROL	Remote control instructions in TV mode	13
		Remote control setup	14
9	MENU OPERATION	Setup Wizard	15
		Select Input Source	17
		Basic Operation	17
		Picture Menu	18
		Audio Menu	21
		Time Menu	22
		Setup Menu	23
		Lock Menu	25
		Channel Menu	27
		Setup Menu	29
		USB Menu	30
		DVD OPERATION	32
		DVD FUNCTIONS	35
10	TROUBLESHOOTING		43

IMPORTANT INFORMATION

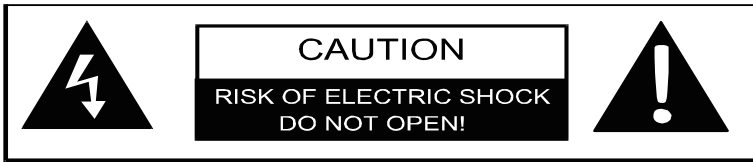

The lightning flash with arrowhead symbol, within an equilateral triangle, is intended to alert the user to the presence of un-insulated dangerous voltage within the products enclosure that may be of sufficient magnitude to constitute a risk of electric to persons.



The exclamation point within an equilateral triangle is intended to alert the user to the presence of important operating and maintenance (servicing) instruction the literature accompanying the appliance.

CAUTION: USE OF ANY CONTROLS, ADJUSTMENTS, OR PROCEDURES OTHER THAN THOSE SPECIFIED HEREIN MAY RESULT IN HAZARDOUS RADIATION EXPOSURE.

CAUTION: These servicing instructions are for use by qualified service personnel only. To reduce the risk of electric shock, do not perform any servicing other than that contained in the operating instructions unless you are qualified to do so.

Refer to service manual for servicing instructions.

Important Safety Instructions

Note:

1. Read these instructions.
2. Keep these instructions.
3. Heed all warnings.
4. Follow all instructions.
5. Do not use near water.
6. Clean only with dry cloth.
7. Do not block any ventilation openings. Install in accordance with the manufacturer's instructions.
8. Do not install near any heat sources such as radiators, heat registers, stoves, or other apparatus (including amplifiers) that produce heat.
9. Do not defeat the safety purpose of the polarized or grounding-type plug. A polarized plug has two blades with one wider than the other. A grounding type plug has two blades and a third grounding prong. The wide blade or the third prong are provided for your safety. If the provided plug does not fit into your outlet, consult an electrician for replacement of the obsolete outlet.

IMPORTANT INFORMATION

10. Protect the power cord from being walked on or pinched particularly at plugs, convenience receptacles, and the point where they exit from the apparatus.
11. Only use attachments / accessories specified by the manufacturer.
12. Use only with the cart, stand, tripod, bracket, or table specified by the manufacturer, or sold with the apparatus. When a cart is used, use caution when moving the cart / apparatus combination to avoid injury from tip-over.



13. Unplug this apparatus during lightning storms or when unused for long periods of time.
14. Refer all servicing to qualified service personnel. Servicing is required when the apparatus has been damaged in any way, such as power-supply cord or plug is damaged, liquid has been spilled or objects have fallen into the apparatus, the apparatus has been exposed to rain or moisture, does not operate normally, or has been dropped.
15. Apparatus shall not be exposed to dripping or splashing and that no objects filled with liquids, such as vases, shall be placed on the apparatus.
16. WARNING: To reduce the risk of fire or electric shock, do not expose this apparatus to rain or moisture.
17. Mains plug or appliance coupler is used as the disconnect device, shall be readily operable.
18. The apparatus shall be connected to a MAINS socket outlet with a protective earthing connection.
19. WARNING: The batteries shall not be exposed to excessive heat such as sunshine, fire or the like.
20. The ON-MODE Power under Home Mode should be less than 40 W.
21. The Sleep Mode power should be less than 0.49 W.
22.  This equipment is a Class II or double insulated electrical appliance. It has been designed in such a way that it does not require a safety connection to electrical earth.

Licensing and Patent Information

This WESTINGHOUSE product may be covered by one or more U.S. and foreign patents and patent applications.



The terms HDMI and HDMI High-Definition Multimedia Interface, and the HDMI Logo are trademarks or registered trademarks of HDMI Licensing Administrator, Inc. in the United States and other countries.

How to install the stand!

Installing the Stand

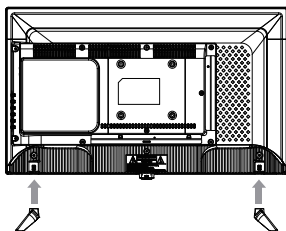

- 1. Lay the TV face down on a flat, cushioned surface to avoid damaging or scratching.
- 2. Insert 2 legs directly into the bottom of the base, no screw is needed.

Removing the Stand for Wall-Mounting

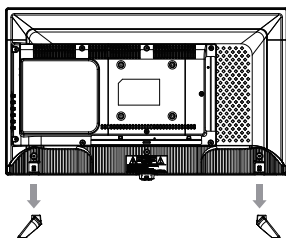

- 1. Lay the TV face down on a flat, cushioned surface to avoid damaging or scratching.
- 2. Pull the 2 legs straight out of the base without screws.
- 3. Attach the wall-mount bracket to the TV using the mounting holes on the back of the TV. Mount this TV according to the instructions included in the wall-mount bracket.

Wall-Mounting Screws

- Mount the VESA bracket using 4*M4 isometric threaded screws (sold separately).
- Screws (4pcs) for attaching the TV to the wall-mounting bracket (sold separately).

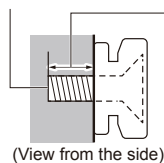

(View from the side)

Depth of screw:
Minimum: 0.20" (5.0 mm)
Maximum: 0.24" (6.0 mm)

WARNING: To prevent injury, this apparatus must be securely attached to the floor/wall in accordance with the installation instruction.

WARNING:

Never place a television set in an unstable location. A television set may fall, causing serious personal injury or death. Many injuries, particularly to children, can be avoided by taking simple precautions such as:

- Using cabinets or stands recommended by the manufacturer of the television set.
 - Only using furniture that can safely support the television set.
 - Ensuring the television set is not overhanging the edge of the supporting furniture.
 - Not placing the television set on tall furniture (for example, cupboards or bookcases) without anchoring both the furniture and the television set to a suitable support.
 - Not placing the television set on cloth or other materials that may be located between the television set and supporting furniture.
 - Educating children about the dangers of climbing on furniture to reach the television set or its controls.
 - Wall hanging height of the whole machine shall not exceed 2m.
- Machines need to be mounted on rigid surfaces such as cement or concrete.

If your existing television set is being retained and relocated, the same considerations as above should be applied.

3. PREFACE

Thank you for buying this TV! Please read this manual thoroughly before operating the TV. Make sure the TV was not damaged in transit. Should the TV be damaged, do not install it and contact your dealer. Check that you have all the accessories according to the model.

4. SAFETY PRECAUTIONS



Put the TV on a stable surface.



Do not place any material on the TV.

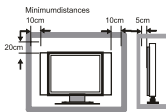

Do not use the TV with fixtures other than those provided or suggested by the manufacturer.



Do not block or cover the ventilation openings on the TV.
If you have a wall mount, check that it is steady.



Power cord and cables must be properly routed and protected to prevent people from stepping on them and causing the TV to fall.

SAFETY PRECAUTIONS



Keep the TV dry and away from humidity.

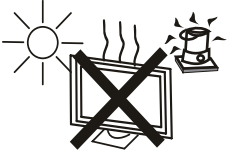

Keep the TV away from heat sources.



Unplug the TV before cleaning it. Do not use solvent or liquid to clean the TV.

Only clean the TV with a soft and dry cloth.

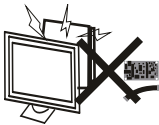

In case of troubleshooting, do not use spare parts other than those suggested by the manufacturer. Using inadequate spare parts can lead to electric shocks, short-circuits, fire or other incidents.



Unplug the TV during lightning storms or when unused for long periods of time.

5. CONTENTS

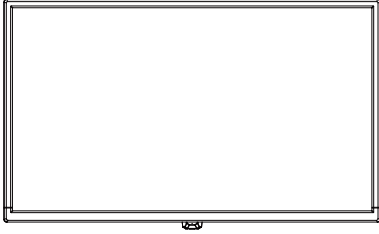

TV Set

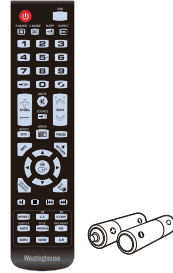

Remote Control with Batteries

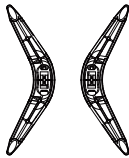

TV Stand

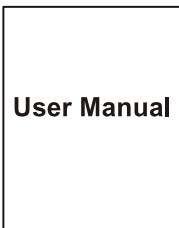

User Manual

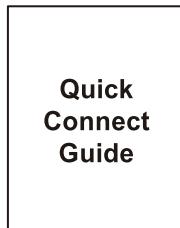

Quick Connect Guide

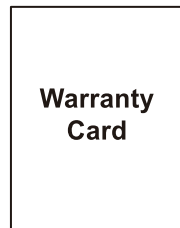

Warranty Card

6. FRONT/BACK CONNECTIONS OF LED TV

Front View

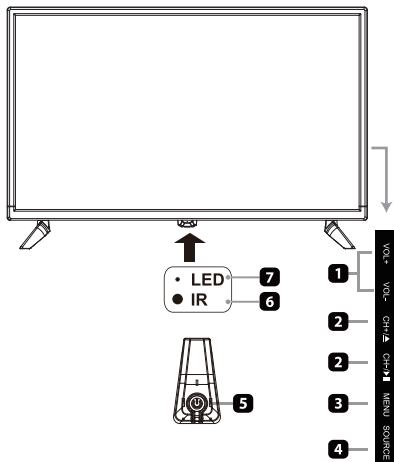

1. Press “VOL+” or “VOL-” to increase or decrease the volume.
2. Press “CH^” or “CHv” to scan through channels.
3. Press “MENU” to bring up the main menu on the screen.
4. Press “SOURCE” to select the input source.
5. Press “POWER” button to turn the TV on or off.
6. REMOTE SENSOR: infrared sensor for the remote control.
7. POWER INDICATOR: Blue when TV is powered on. Red when TV is powered off.
8. Play/Pause button for DVD
9. Open/Close button for DVD

Back View and Control Connections

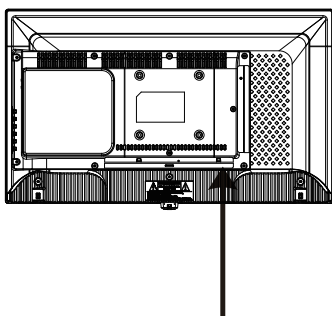

1. Headphone: Connect a stereo headphone for private listening.
2. Optical Output: Connect a digital sound system to this jack.
3. AV: Connect the Video and Audio output.
4. HDMI: Connect the HDMI output jack of DVD.
5. VGA (PC) : Connect the PC-RGB output jack of PC.
PC AUDIO: Connect the Audio output jack of PC.
6. RF IN : Connect the antenna.
7. USB : USB Port.



7. TV INSTALLATION

Power Cord Connection

- Connect the power cord correctly as shown.

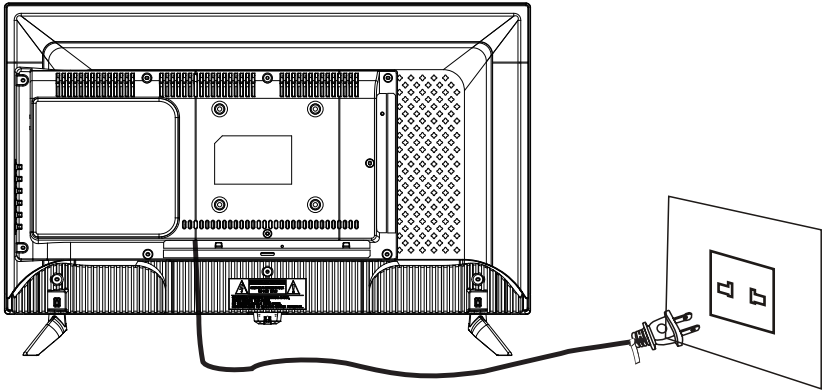

Antenna Connection

To ensure good picture and sound, TV antenna system needs to be installed. The antenna system as shown can be sourced from TV equipment shops, which will provide service for correct installation and connection. After installation, insert the 75-ohm antenna plug into the antenna jack as shown.

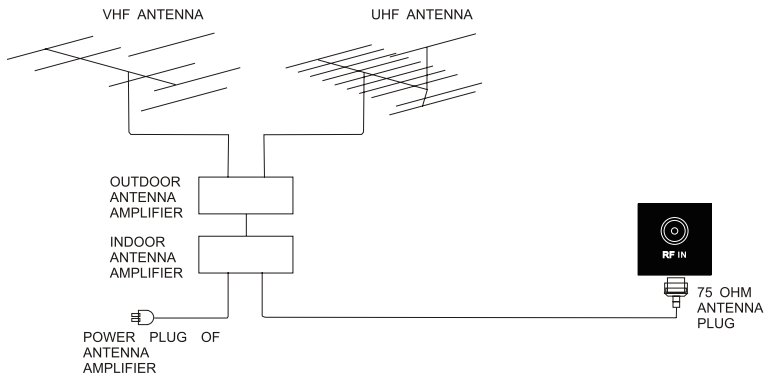

AV Connection

Connect the VIDEO and AUDIO output jack of the DVD or VCR to the VIDEO jacks on the set using the RCA cable. Match the jack colors: Video is yellow, Audio left is white, and Audio right is red. Select the AV input source using the SOURCE button on the remote control.

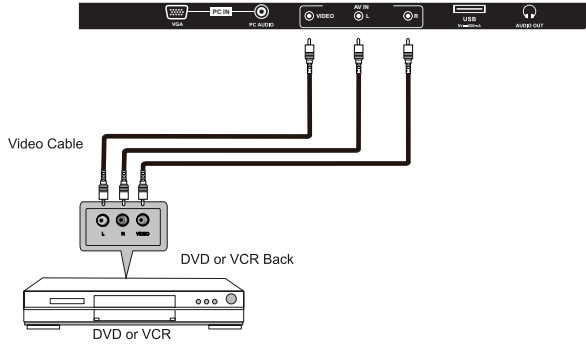

VGA(PC) Connection

Connect the RGB output of the PC to the VGA(PC) jack on the set. Connect the AUDIO output of The PC to the PC AUDIO jack on the set. Select the VGA input source with using SOURCE button on the remote control.

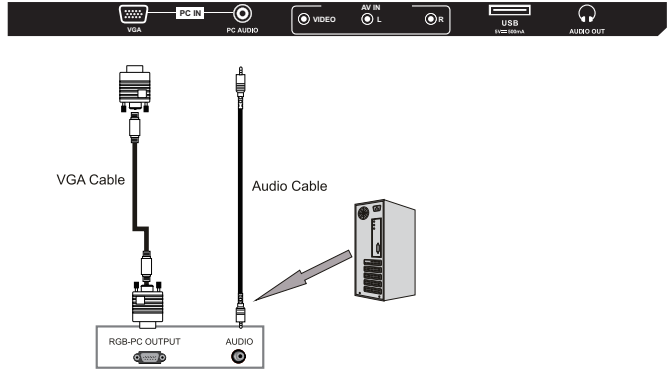

USB Port Function



HDMI Connection

HDMI plug which replaces the HDMI connection allows transfer of all audio/video control signals through one cable only. These signals are transferred in digital.

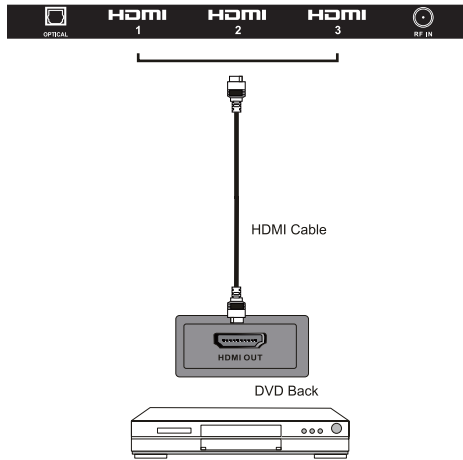

REMOTE CONTROL

▶▶: Skip to the beginning of the next chapter/track/photo.

REPEAT: Select between different repeat modes.

CC: Closed Caption selection: ON/OFF/CC On Mute

◀◀: Reverse playback rapidly.

V-CHIP: Set up parental control

▶▶: Advance playback rapidly.

SUBTITLE: Display the subtitle.

AUTO: Press to adjust the picture automatically in VGA source

TITLE: Press to return to the main title page. (DVD mode).

ADD/ERASE: Add or delete favorite channels

DVD.MENU: To show the menu of the DVD disc.

FAV: Display the favorite channel list.

GOTO: Skips to a specific location on a DVD / CD. (DVD mode).

SLOW: Press to select the slow speed playing. (DVD mode).

A-B: Repeats a segment between A and B. (DVD mode).

Remote control setup

1. Open the cover.
2. Uses AAA size batteries. When inserting the batteries, make sure correct polarities "+" and "-" marks on the batteries line up correctly with compartment markings.
3. Replace the battery cover.

To prevent battery leakage which may result in bodily injury or damage to the remote:

1. Install all batteries correctly, and as marked on the remote control.
2. Do not mix batteries: (OLD and NEW or CARBON and ALKALINE, etc)
Remove batteries when the remote is not used for a long period of time.



9.Menu Operation

SETUP WIZARD

Select Language

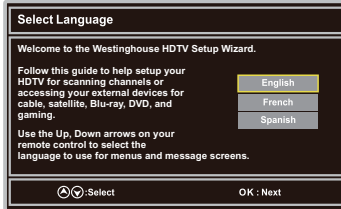

Power On Mode

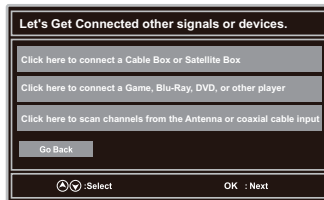
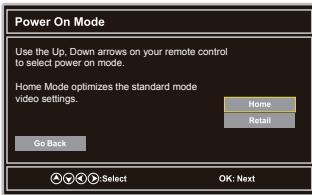

The SLEEP-MODE Power should be less than 0.5W.

Channel Scan

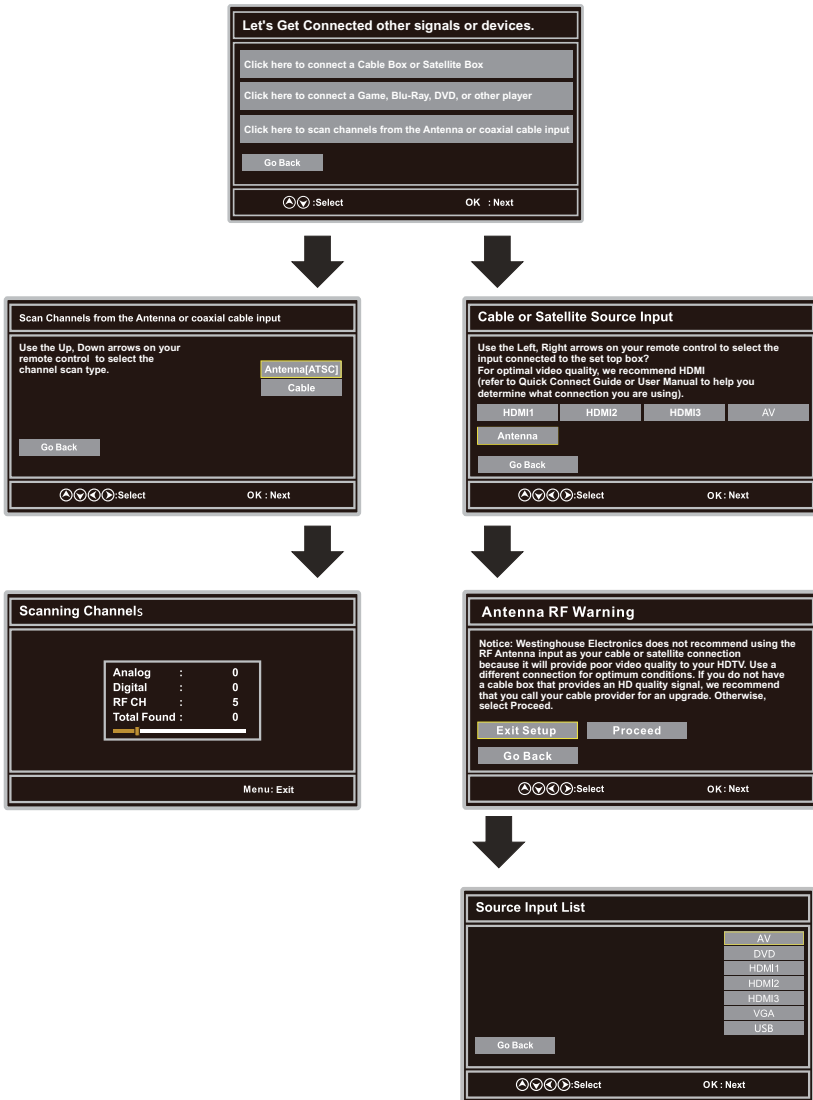

Select Input Source



- Press **SOURCE** button to display the input source list.
- Press **▼/▲** button to select the input source you want to watch.
- Press **ok** button to enter the selected source.

Basic Operation



- Press **MENU** button to display the MAIN OSD MENU.
- Press **◀/▶** button to select the MENU you want.
- Press **▼** button to enter the sub menu.
- Press **▼/▲** button to select the option and then press **◀/▶** to adjust the value in the sub menu.
- You can press **MENU** button to go back to the upper menu or **EXIT** button to close the OSD.

For TV Mode:

Picture Menu

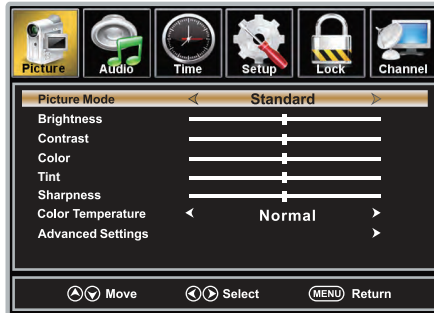

1. Press ◀/▶ button to select **Picture** in the main menu.
2. Press ▼/▲ button to select the option that you want to adjust in the Picture menu.
3. Press ◀/▶ button to desired level.
4. When you have changed the settings, you can exit from the menu by pressing MENU.

Picture Mode

Press ▼/▲ button to select Picture Mode, then press ◀/▶ button to adjust.

Available picture mode: Standard, Retail, Movie, User.

Brightness

Press ▼/▲ button to select Brightness, then press ◀/▶ button to adjust.

Contrast

Press ▼/▲ button to select Contrast, then press ◀/▶ button to adjust.

Color

Press ▼/▲ button to select Color, then press ◀/▶ button to adjust.

Tint

Press ▼/▲ button to select Tint , then press ◀/▶ button to adjust.

Sharpness

Press ▼/▲ button to select Sharpness, then press ◀/▶ button to adjust.

Color Temperature

Press ▼/▲ button to select Color Temperature, then press ◀/▶ button to adjust.

Advanced Settings

Press **▼/▲** button to select Advanced Settings, then press **ok** button to enter.
Adjust advanced video features to fine tune the picture.

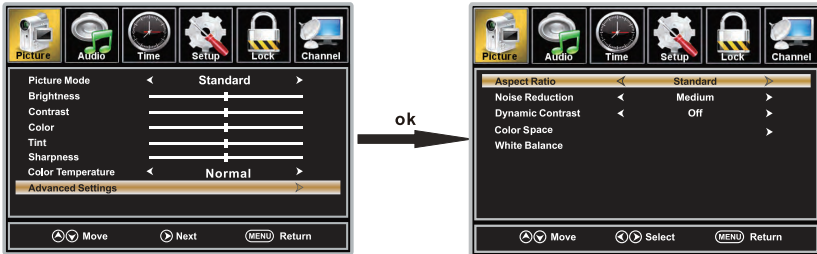

Aspect Ratio

Press **▼/▲** button to select Aspect Ratio, then press **◀/▶** button to adjust. Available Aspect Ratio: Standard, Fill, Over Scan.

Noise Reduction

Press **▼/▲** button to select the item Noise Reduction, then press **◀/▶** button to adjust.
Available Noise Reduction: Off,Weak,Medium,Strong.

Dynamic Contrast

Press **▼/▲** button to select Dynamic Contrast, then press **◀/▶** button to adjust On or Off. It can adjust the contrast corresponding to the input signal in order to improve the picture quality displayed.

Color Space

Press **▼/▲** button to select Color Space, then press **ok** button to enter.

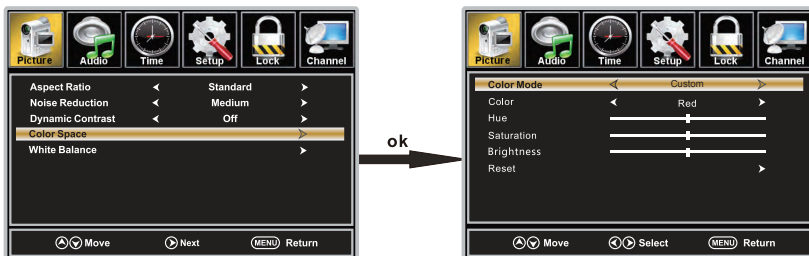

MENU OPERATION

Color Mode

Press **▼/▲** button to select Color Mode, then press **◀/▶** button to adjust. Available Color Mode: Auto, Native, Custom.

Color

Press **▼/▲** button to select Color, then press **◀/▶** button to adjust. Available Color Mode: Red, Green, Blue, Yellow, Cyan, Magenta.(It is available in Custom mode.)

Hue

Press **▼/▲** button to select Hue, then press **◀/▶** button to adjust.(It is available in Custom mode.)

Saturation

Press **▼/▲** button to select Saturation, then press **◀/▶** button to adjust.(It is available in Custom mode.)

Brightness

Press **▼/▲** button to select Brightness, then press **◀/▶** button to adjust.(It is available in Custom mode.)

Reset

Press **▼/▲** button to select Reset, Press **ok** to enter, then press **◀/▶** button to select No or Yes.

White Balance

Press **▼/▲** button to select White Balance, then press **ok** button to enter.

Press **▼/▲** button to select the option you want,then press **◀/▶** button to adjust.

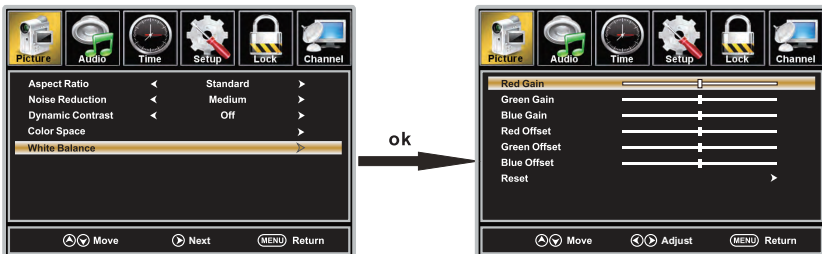

Audio Menu

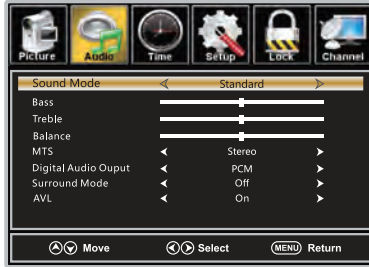

1. Press ◀/▶ button to select **Audio** in the main menu.
2. Press ▼/▲ button to select the option that you want to adjust in the Audio menu.
3. Press ◀/▶ button to desired level.
4. When you have changed the settings, you can exit from the menu by pressing MENU.

Sound Mode

Press ▼/▲ button to select the item Sound Mode, then press ◀/▶ button to select the desired mode. Available Sound Mode: Sports, User, Standard, Music, Movie. Select a sound mode to achieve ideal sound.

Bass

Press ▼/▲ button to select Bass, then press ◀/▶ button to adjust.

Treble

Press ▼/▲ button to select Treble, then press ◀/▶ button to adjust.

Balance

Press ▼/▲ button to select Balance, then press ◀/▶ button to adjust.

MTS

Press ▼/▲ button to select MTS, then press ◀/▶ button to adjust.

Digital Audio Output

Press ▼/▲ button to select the item Digital Audio Output, then press ◀/▶ button to select the desired digital audio output. Available digital audio output: PCM, Raw and Off.

Surround Mode

Press ▼/▲ button to select the item Surround Mode, then press ◀/▶ button to select On or Off.

AVL

Press ▼/▲ button to select the item AVL, then press ◀/▶ button to select ON or OFF. Auto Volume Level can set the volume automatically adjust corresponding to the input audio.

Time Menu



1. Press ◀/▶ button to select **Time** in the main menu.
2. Press ▼/▲ button to select the option that you want to adjust in the Time menu.
3. Press ◀/▶ button to desired level.
4. When you have changed the settings, you can exit from the menu by pressing MENU.

Sleep Time

Press ▼/▲ button to select Sleep Timer, then press ◀/▶ button to set.

Available Sleep Timer: Off, 5Min, 10Min, 15Min, 30Min, 60Min, 90Min, 120Min, 180Min, 240Min.

Time Zone

Select a Time Zone among: Pacific/Alaska/Hawaii/Eastern/Central/Mountain/Atlantic or Newfoundland.

Daylight Saving Time

Select to turn On/Off daylight saving time.

Setup Menu



1. Press ◀/▶ button to select **Setup** in the main menu.
2. Press ▼/▲ button to select the option that you want to adjust in the Setup menu.
3. Press ◀/▶ button to desired level.
4. When you have changed the settings, you can exit from the menu by pressing MENU.

Menu Language

Press ▼/▲ button to select the item Menu Language, then press ◀/▶ button to adjust. Available Language: English, French, Spanish.

OSD Timeout

Press ▼/▲ button to select OSD Timeout, then press ◀/▶ button to set. Available OSD Timeout: 5Sec., 15Sec., 30Sec., 45Sec., 60Sec..

Closed Caption

Press ▼/▲ button to select Closed Caption, then press **OK** button to enter.

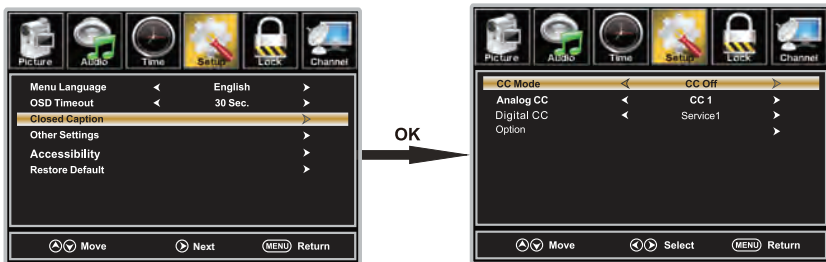

CC Mode

Press ▼/▲ button to select CC Mode, then press ◀/▶ button to select CC Off, CC On, CC on Mute.

MENU OPERATION

Analog CC

Press ▼/▲ button to select Analog CC, then press ◀/▶ button to select.

Available Analog CC: CC1, CC2, CC3, CC4, Text1, Text2, Text3, Text4.

Digital CC

Press ▼/▲ button to select Digital CC, then press ◀/▶ button to select Service1, Service2, Service3, Service4, Service5, Service6.

Option

Press ▼/▲ button to select Option, then press ▶ button enter submenu.

Other Settings

Press ▼/▲ button to select Other Settings, then press **OK** button to enter.

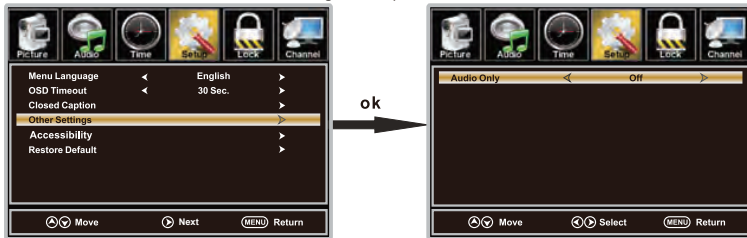

Audio Only

Press ▼/▲ button to select Audio Only, then press ◀/▶ button to set On or Off.

Accessibility

Press ▼/▲ button to select Accessibility, then press ◀/▶ button to set On or Off.

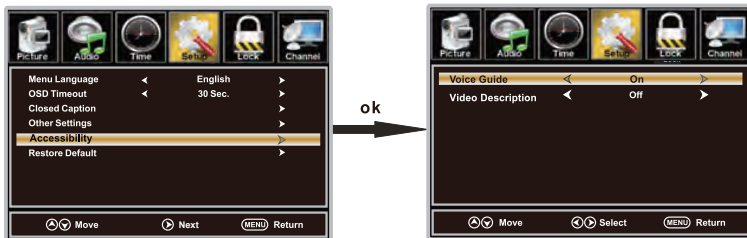

Restore Default

Press ▼/▲ button to select Restore Default, then press **ok** button to select No or Yes.

Change power on options or reset TV to factory default. (0000)

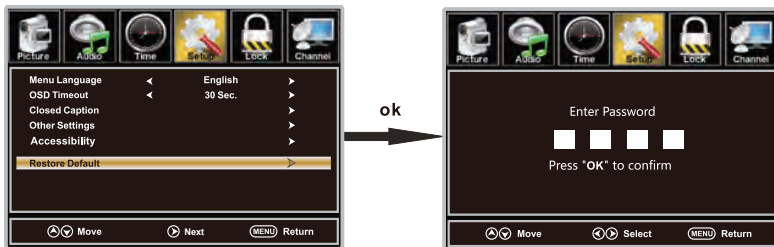

Lock Menu

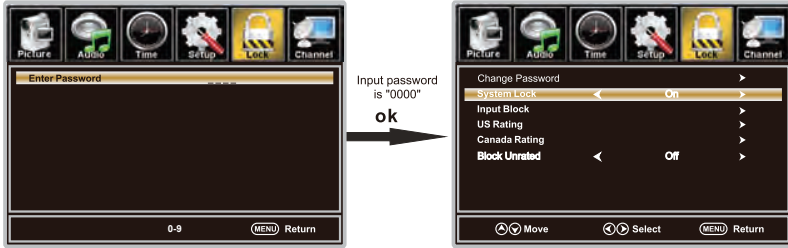

1. Press ◀/▶ button to select **Lock** in the main menu.
 2. Press ▼/▲ button to select the option that you want to adjust in the Lock menu.
 3. Press ◀/▶ button to desired level.
 4. When you have changed the settings, you can exit from the menu by pressing MENU.
- Input password to enter, default password is "0000".

Change Password

Press ▼/▲ button to select Change Password, then press **ok** button to adjust the value. a sub menu will appear as below. If the password is changed, all of the passwords in the menu will be changed at the same time.

Note: If you forget your password, you can use "8899" to enter any menu locked.

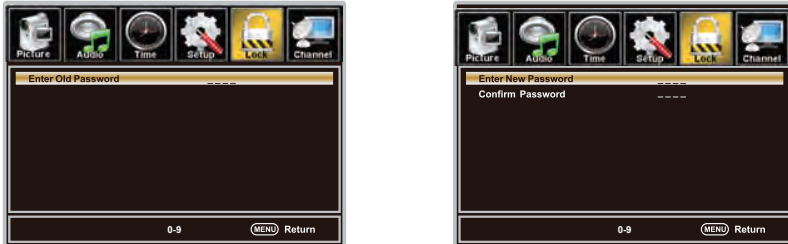

System Lock

Press ▼/▲ button to select System Lock, then press ◀/▶ button to set On or Off.
Only available when "System Lock" is "On".

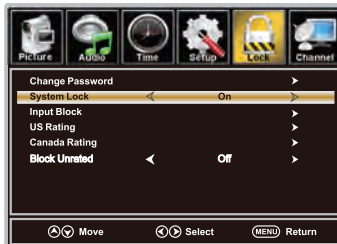

MENU OPERATION

Input Block

Press ▼/▲ button to select Input Block, then press ◀/▶ button to enter.

Press ◀/▶ button to select Unblock or Block the input sources.

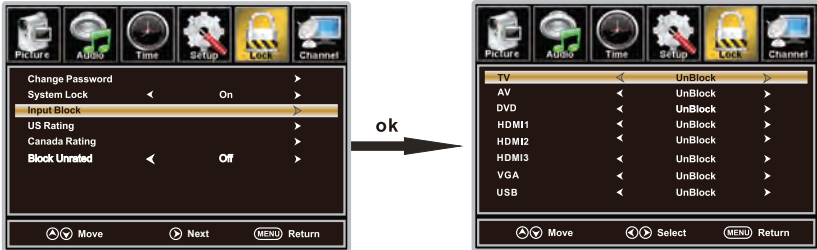

US Rating

Press ▼/▲ button to select US Rating, then press ◀/▶ button to enter. A sub menu will appear as below.

The TV rating composes of two aspects: age-based and content-based.

This system defines the rating control which comes from MPA rules.

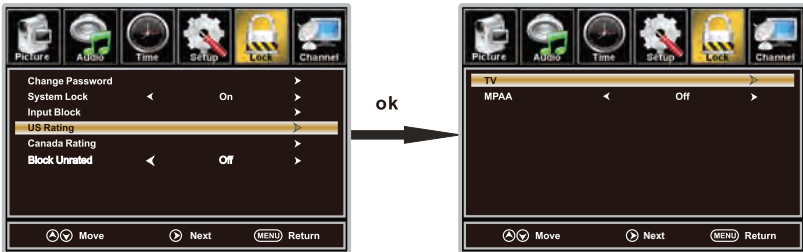

Canada Rating

Press ▼/▲ button to select Canada Rating, then press ◀/▶ button to enter. Press ◀/▶ button to select.

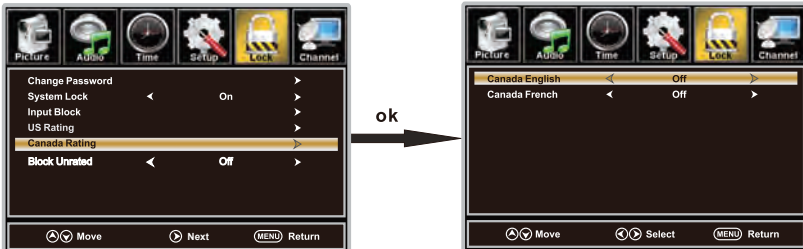

Canada English

Press ▼/▲ button to select Canada English, then press ◀/▶ button to set.

Available Canada English: Off, C, C8+, G, PG, 14+, 18+.

Canada French

Press ▼/▲ button to select Canada French, then press ◀/▶ button to set.

Available Canada French: Off, G, 8ans+, 13ans+, 16ans+, 18ans+.

Channel Menu

Note: This menu is only shown when the input source is TV.



1. Press ◀/▶ button to select **Channel** in the main menu.
2. Press ▼/▲ button to select the option that you want to adjust in the Channel menu.
3. Press ◀/▶ button to desired level.
4. When you have changed the settings, you can exit from the menu by pressing MENU.

Signal Type

Press ▼/▲ button to select Signal Type, then press ◀/▶ button to set. Available Signal Type: Air, Cable.

Auto Scan

Press ▼/▲ button to select Auto Scan, then press **ok** button to search channel.

A Channel Search Menu will appear as below.



Favorite

Press ▼/▲ button to select Favorite, then press **ok** button to scan the Favorite channel list.



MENU OPERATION

Channel List

Press **▼/▲** button to select Channel List, then press **ok** button to scan the Channel List.



Show/Hide

Press **▼/▲** button to select Show, then press **ok** button to enter .

Show or hide the channels in your program list.

Channel Number

Press **▼/▲** button to select Channel Number, then press **◀/▶** button to adjust.

Channel Label

Press **▼/▲** button to select Channel Label, then press **ok** button to enter.

Create labels for channels, up to 7 characters.



Setup Menu

For VGA Mode :

1. Press ◀/▶ button to select **Setup** in the main menu.
2. Press ▼/▲ button to select VGA Settings, then press **ok** button to enter.
A sub menu will appear as below.



H-Pos

Press ▼/▲ button to select H-Pos, then press ◀/▶ button to adjust.

V-Pos

Press ▼/▲ button to select V-Pos, then press ◀/▶ button to adjust.

Clock

Press ▼/▲ button to select Clock, then press ◀/▶ button to adjust.

Phase

Press ▼/▲ button to select Phase, then press ◀/▶ button to adjust.

Auto

Press ▼/▲ button to select Auto, then press **ok** button to enter.
Adjust to the PC signal timing automatically.

1. PICTURE menu and description are the same as that for TV mode.
2. Audio Language in AUDIO menu is invalid.
3. TIME menu and description are the same as that for TV mode.
4. Close Caption in SETUP menu is invalid.
5. US, Canada, RRT Setting and Reset RRT in LOCK menu is invalid
6. PC mode has no CHANNEL menu.

Note: The operation and description of the hot key are programmable on your remote control.

USB Menu

Note: Before operating Media menu, Plug in USB device, then press SOURCE button to set the Input Source to USB.
Press ▲/▼ button to select USB in the Source menu, then press OK button to enter.

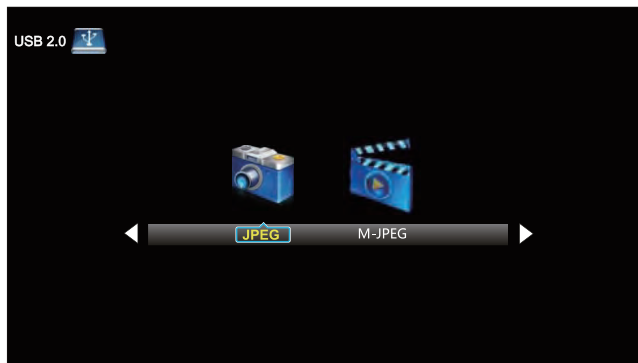

Press ◀/▶ button to select the option you want to adjust in the main Media menu, then press OK button to enter.

Press ◀/▶ button to select JPEG in the main menu, then press OK button to enter.
Press Exit button to return back to the previous menu.

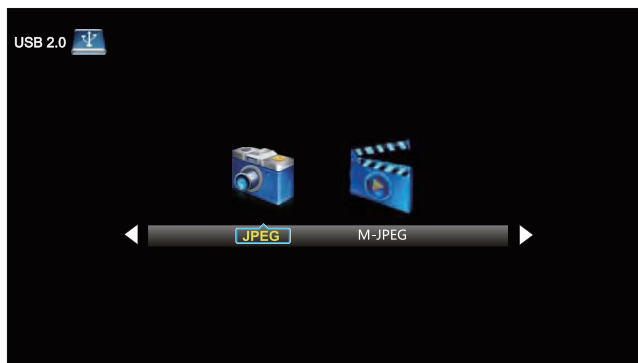

Press ◀/▶ button to select drive disk you want to watch, then press OK button to enter.
Press ◀/▶ button to select Return option to go back to the previous menu.

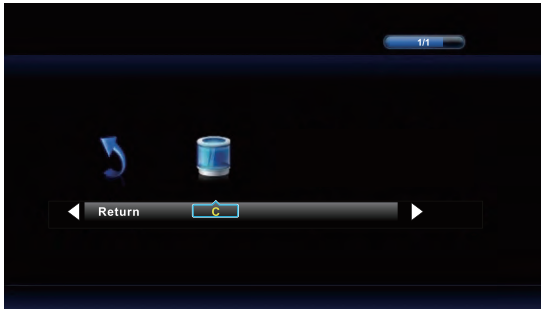

Press ◀/▶ button to select the file you want to watch in the file selecting menu, then press OK button to display picture.
When highlighting the option you select, the file information will appear on the right and picture will be previewed in the center.

Press ◀/▶ button to select M-JPEG in the main menu, then press OK button to enter.
Press Exit button to return back to the previous menu.



Press ◀/▶ button to select drive disk you want to watch, then press OK button to enter.
Press ◀/▶ button to select Return option to go back to the previous menu.

When highlighting the option you select, the file information will appear on the right and Movie will be previewed in the center.

Press OK button to play the selected movie.
Press display button to show select menu in the bottom.
Press ◀/▶ button to select menu in the bottom you want to run, then press OK button to operate.

Preparation before playing disc

- The display language is set to English. Please refer to setup operation.
- Most functions are operated by the remote control or use the buttons on the front panel.

Preparation

- Turn the TV on and select DVD as the TV input.
- Turn on any related system power if the player has been connected to amplifier equipment, etc.

PLAY

1. Turn on the power, the display shows "LOADING". (Note: the disc information appears after several seconds if a disc has been inserted. Otherwise NO DISC appears.)
2. To insert a disc, place the disc with the printed label side facing the back, into the DVD slot. The disc will automatically be loaded into the player.
3. To remove the disc, press the OPEN/CLOSE button and the disc will eject.
4. Press PLAY on playback disc. You may also start playback according to the MENU screen once the MENU displays. Press ENTER button to start playback. Some discs may play automatically once loaded.

Disc Type	Disc Size (Diameter)	Recorded Time	Recorded Content	Remarks
DVD	12 cm	Single side: 120 mins. Approx Double side: 240 mins. Approx	DVD format: Compressed digital audio and video	
Super VCD	12 cm	45 mins. Approx	MPEG2 Compressed digital audio and video	Includes SVCD
VCD	12 cm	74 mins. Approx	MPEG1 Compressed digital audio and video	Includes: VCD2.0/VCD1.1 VCD1.0/DVCD
CD	12 cm	74 mins. Approx	CD-DA: Digital audio	
HD-CD	12 cm	75 mins. Approx	HD-DA: Digital audio	
MP3/JPEG	12 cm	600 mins. Approx	Digital audio	

NOTE: Also supports DVD-R, CD-R, CD-RW playback

WARNING! DO NOT INSERT OR PLAY 8 CM DISCS, THEY WILL GET STUCK!

Region Code 1

As it is usual for DVD movies to be released at different times in different regions of the world, all players have region codes and discs that have an optional region code. If you load a disc of a different region code into your player you will see the region code notice on the screen. The disc will not playback and should be unloaded. The region code for this player is 1 (refer to the symbols).



- **STOP**

Press STOP button to stop playing (TV show "▶, ■"). When playback is stopped the unit keeps in memory the point where STOP was pressed (resume function). Press PLAY again, and play will resume again at this point. Press the STOP button twice, the resume function will be cancelled. The resume function is suitable for discs showing playing time during playback.

- **PRESS ◀/NEXT ▶▶**

Press PREV button or NEXT button on the remote control when playing a disc, a chapter (DVD) or a track (CD) to skip backward or forward correspondingly each time the button is pressed.

Note: When skipping backward, playback starts at the beginning of the previous track, NOT the beginning of the current track.

- **FB◀◀/FF▶▶**

Press the FB/FF button on the remote control during playback, the disc will be played forward or backward correspondingly. The forward or reverse speed is relatively slow at first. When pressed again, the speed becomes faster. The more times the buttons are pressed, the faster the Fast Forward or Reverse speed will be. There are five levels of speed: X2, X4, X8, X16 and X32. To return to normal play, press the PLAY button on the player or the remote control.

- **SETUP**

Press the SETUP button during play, the player will enter into still picture mode. If the button is pressed again the disc is advanced by one frame (step). When the button is continually pressed, there will be consecutive frame advance. To return to normal play, press the PLAY button on the player or the remote control.

- **PAUSE**

Press the pause button to stop playing. Restore play by pressing the PLAY button again.

- **NUMBER (0-9, 10+) Buttons**

Press the number (0-9) buttons, to go directly to the desired track or chapters while a disc is being played. For a track or chapter over 10, press 10+ first and then the 0-9 button.

- **MUTE**

Press the MUTE button during play, the player shows mute and there is no audio output (silence). Press again to cancel MUTE.

- **VOL+/VOL-Press**

the VOL+/VOL- button to change the volume for audio output.

- **A-B**

Press the A-B button during playback at the point where repeat play is to commence (A), then press again at the point where repeat play is to be concluded (B). Repeat playback between point (A) and point (B) starts. Press A-B button once more where TV screen appears REP OFF to return to normal play.

- **REPEAT**

Press the repeat button to choose to repeat play chapter or title (DVD) and play single audio or full disc (VCD, CD, MP3). Note: Some VCDs do not have repeat function with PBC ON state.

- **SLOW**

When playing SVCD, VCD, DVD discs, press SLOW to select slow speed playing. Press PLAY/PAUSE to resume to normal play.

- **GO TO**

During play, press the GO TO button on the remote control. You can search the disc based on its title/ chapter/track. Press the GO TO button and a search menu will be displayed. Use the ◀ or ▶ button to select the search item/time/title/chapter. The selection will be shown as highlighted. Use the number button to select the search item time/title/chapter, and press the ENTER button to play.

For example:

- Time search (press "GO TO" button twice while playing a DVD): To search 16 min 50 seconds, input 1, 6, 5 and 0. To search 1 hour 14 minutes: input 1, 1, 4, 0, 0. Title/chapter search: To search title 1, chapter 2, input 1 in the highlight title column, move the cursor right to the highlighted area and input 2.

Notes:

- For some DVD discs which cannot be searched, "invalid" will appear on the TV screen.
- Input the time, title and chapter of the disc to be searched.
- For VCDs with the PBC mode ON, it can only search for a time.

- **AUDIO**

Press AUDIO button to switch the audio output among L/L, R/R and L/R.

- **MENU**

Press MENU button to show the setup information of DVD disc source.

- 

Press OPEN/CLOSE when power is on and insert disc with label towards the back.
Press OPEN/CLOSE to close.

- **TITLE**

When playing the DVD, press TITLE to return to the main title page.

- **SUBTITLE (FOR DVD AND SUPER VCD DISCS)**

To change the subtitle language, refer to Language Setup (page 28).

• Supporting DVD Format

1. Play (for DVD/Super VCD/VCD/CD/CD-G/HD-CD and MP3/JPEG discs). For DVD disc, press the **II** button from the root or title menu. While playing the DVD, play a favourite title directly by the title selection by pressing the **TITLE** button. For Super VCD and VCD discs, while playing the disc, play a favourite track by using numeric buttons. For CD, CD-G and HD-CD discs, while playing the disc, play a favourite track by using numeric buttons. For MP3/JPEG discs, play a favourite track by using numeric buttons from the content menu. If the input track numbers are not valid, it will not function.

Note: From track 1-10, use numeric buttons directly; for tracks over 10, Press 10+ button first. (e.g. Track 15, press 10 + 5).

2. Previous/Next (for DVD/Super VCD/VCD/CD/CD-G/HD-CD and MP3/JPEG discs)

While playing the disc:

Press **◀◀** button to play the previous Title/Chapter/Track.

Press **▶▶** button to play the next Title/Chapter/Track.

For Super VCD and VCD discs, in PBC OFF status;

If current track is the first one, press **▶▶** button to stop the playback.

If the current track is the last one, press **◀◀** button to stop the playback.

For DVD discs, the above functions may vary due to different DVD disc's structure.

3. Forward /Backward (for DVD/Super VCD/CD/CD-G/HD-CD and MP3)

While playing the disc, you can use the skip forward or backward function.

There are 4 speeds for forward. Press **▶▶▶▶** to toggle between different speeds in sequence.

(FORWARD X2/FORWARD x4/FORWARD X8/FORWARD X20/Play).

Press **▶▶** to resume normal speed.

For CD, HD-CD, MP3, backward also has audio output.

For DVD discs, if moving backward to the first title/chapter, it will resume from the beginning.

For Super VCD and VCD discs, in PBC ON status, if moving backward to the first track, it will start from the beginning.

NOTE: During Forward or Backward functions, the sound will be off.

4. Pause (for DVD/Super VCD/VCD/CD/CD-G/HD-CD and MP3/JPEG discs)

FOR CD, CD-G, HD-CD and MP3/JPEG discs, press the **⏸** button to pause; press the **▶▶** button to resume. For DVD, Super VCD, VCD discs, press the **⏸** button to pause; press the **▶▶** button to resume.

5. Repeat (for DVD/Super VCD/VCD/CD/CD-G/HD-CD and MP3/JPEG discs)

Press **REPEAT** button once to display the current repeat mode.

For Super VCD, VCD, CD, CD-G, HD-CD, discs, while playing in sequence, you may use the repeat playback. There are 2 repeat modes, press **REPEAT** to toggle between different modes in sequence. (REPEAT (OFF)/REPEAT (1)/REPEAT (ALL)).

For DVD discs, you may setup the repeat playback mode. There are 3 repeat modes, press **REPEAT** to toggle between different modes in sequence (REP: (OFF)/REP: (CHAPTER)/REP: (TITLE)/REP: (ALL)).

For MP3/JPEG discs, while playing the disc, you may use the repeat playback. There are 3 repeat modes, press **REPEAT** to toggle between different modes in sequence (REPEAT (OFF)/REPEAT (DIR)/REPEAT(ALL)).

6. INFO (for DVD/Super VCD/VCD/CD/CD-G/HD-CD and MP3/JPEG discs)

Press **INFO** button to activate the on screen roll-down menu for the current Title, Chapter, Time, and other information.

• **Supporting DVD Format**

For DVD discs with 5 pages, press INFO button :

Once

Title Elapsed
TT: 01/08 CH:01/01
0:00:47

Twice

Title Remain
TT: 01/08 CH:01/01
0:04:47

Three times

Chapter Elapsed
TT: 01/08 CH:01/01
0:00:16

Four times

Chapter Remain
TT: 01/08 CH:01/01
0:04:41

Five times

Display off

7. GOTO (for DVD/Super VCD/VCD/CD/CD-G/HD-CD and MP3/JPEG discs)

This function allows you to play your favorite Title/Chapter/Track. Press **GOTO** button to activate the on screen scroll-down menu to edit. According to the highlighted area, input your favorite Title/Chapter/Track number using the numeric buttons or input the playback time. After editing, press **OK** to start. If the input is invalid, it will not function.

Note: While editing, the **GOTO** button does not function.
If in PBC ON status, this function will switch to OFF.

8. Audio (for VCD/CD/CD-G/HD-CD and MP3/JPEG discs)

Press Audio button once to display current audio mode.
Press again to toggle between different audio modes in sequence.
For CD/VCD/MP3/HD-CD discs: (stereo/monoL/monoR).

Note: Switching to Auto L/R audio channel may vary due to different disc contents.
Bilingual VCD discs can use the Audio button to switch between different languages.

9. Mute (for DVD/Super VCD/VCD/CD/CD-G/HD-CD and MP3/JPEG discs)

Press MUTE button to mute the audio output, there will be an onscreen symbol to indicate "MUTE".
Press again to cancel, or press VOL+/VOL- to cancel and adjust the volume.
In case there is no audio output, press MUTE button to cancel mute.

10. Repeat A-B (for DVD/Super VCD/VCD/CD/CD-G/HD-CD and MP3 discs)

When playing DVD, VCD, CD disc, press the A-B button to repeat a certain content. Press the A-B button at the start point (A) and again at the end point (B) to select the repeat section.
Press the A-B button a third time to cancel the A-B repeat function and return to normal play.

11. Volume (for DVD/Super VCD/VCD/CD/CD-G/HD-CD and MP3/JPEG discs)

Press VOL +/VOL - buttons to adjust the output volume.

• MP3 / JPEG Playback

After loading the MP3/JPEG disc, it will start to scan for the stored MP3/JPEG folders. The folder will display the MP3 contents automatically and start to play the first file (highlighted file).

Use the navigation buttons to check for your favourite folder and playback the first file or move to your favourite file.

NOTE:

Press the ◀ / ▶ buttons to move the highlight to folders, documents or mode selection.

Press the numeric buttons to select the contents directly. For numbers over 10, press the - button first (eg. for file number 15, press - and 5).

When playing MP3 files, there is no picture display, only audio output.

When playing or pausing with picture playback, you may use the navigation buttons to flip/rotate the picture.

- ▲ button to flip horizontally
- ▼ button to flip vertically
- ◀ button to rotate left 90°
- ▶ button to rotate right 90°

When playing or pausing with picture playback, you may use ChanDVD MENU button to enter preview mode to display 12 pictures. Press ◀◀ / ▶▶ buttons to select next/previous page or press numeric buttons to view the corresponding pictures.

The maximum JPEG image size that can be displayed is 1280 x 1024.

Basic Operation

Press the Power button on the TV or the remote control, then press the INPUT button to select DVD mode.

If there is no disc in the DVD player the screen will show "NO DISC".

Insert Disc according to picture next to disc slot.

Do not touch the playing surface.

Hold the disc around the outside with your fingers and place the disc into the slot. The player will automatically draw the disc into the player.

To "Eject" the disc, press the EJECT button on the TV or the "▲" button on the remote control.

DVD Setup Mode

- Setup Mode provides the menu for the configuration of General Setup Page, Audio Setup Page, Dolby Digital, Setup, Preference Page.
- Item selection in the Setup Menu is done by using the Navigation Arrows, SETUP button and the OK button.
- Press the SETUP button first, enter into SETUP menu, then press the DIRECTION RIGHT button, you can enter into the next Sub-menu.
- Press the SETUP button again to exit the Setup Menu.

General Setup

TV Display

- 4:3 Pan Scan

This is selected when the DVD player is connected to a normal TV. Wide-screen images are shown on the screen, but with some parts cut automatically.



OSD Language

This is used to select the OSD language.



Screen Saver

Start the screen saver, the screen saver image will appear when the player stops or the picture is frozen for a few minutes. This saver can keep the screen from being damaged.

- **On** (Start the screen saver)
- **Off** (Remove the screen saver).





Audio

If a language listed below is recorded on the disc, you can play the sound in such language. If not, the language recorded will be used.



Subtitle

If a language listed below is recorded on the disc, you set the subtitle to be displayed in such language. If not, the language recorded will be used.



Disc Menu

If a language listed below is recorded on the disc, you can set the Menu to be displayed in such language. If not, the language recorded will be used.



DVD FUNCTIONS



10. Troubleshooting

Please check if you can solve problems by troubleshooting yourself.

Troubleshooting	Control
No signal	Please check that all cables are correctly plugged in.
No color shades	Adjust the contrast, the color and the brightness.
Stain on the screen	May be the result from a lighting signal from car, motor, neon light and other electrical devices or appliances.
Double or multiple display image	May be the result of an electrical wave disturb from other TV, Computer and Game machine or Radio.
Snow on the screen	The cables of the antenna are not correctly plugged in.
The remote control does not work	Please check the batteries order and alignment. Check that the IR of the remote control is not hidden by something.
"Zip" made noise on TV cover	Even if the display image is correct, the noise may come from an unsteady fixation of the panel.
No sound	Make sure that you have not press the MUTE button of the remote control.

- Do not use your TV in areas that are too hot or too cold, because the cabinet may warp or the screen may malfunction. Your TV works best in temperatures that are comfortable to you.
- Storage temperatures are 32° to 122°F(0° to 50°C).
- Working temperatures are 32° to 95°F(0° to 35°C).
- Do not place your TV in direct sunlight or near a heat source.
 - minimum 5cm distances around the apparatus for sufficient ventilation;
 - the ventilation should not be impeded by covering the ventilation openings with items, such as newspapers, table-cloths, curtains, etc.;
 - no naked flame sources, such as lighted candles, should be placed on the apparatus;
 - attention should be drawn to the environmental aspects of battery disposal.



FCC STATEMENT

This device complies with Part 15 of the FCC Rules. Operation is subject to the following two conditions:

1. This device may not cause harmful interference, and
2. This device must accept any interference received, including interference that may cause undesired operation. Changes or modifications not expressly approved by the party responsible for compliance could void the user's authority to operate the equipment.

NOTE: This equipment has been tested and found to comply with the limits for a Class B digital device, pursuant to Part 15 of the FCC Rules. These limits are designed to provide reasonable protection against harmful interference in a residential installation. This equipment generates uses and can radiate radio frequency energy and, if not installed and used in accordance with the instructions, may cause harmful interference to radio communications. However, there is no guarantee that interference will not occur in a particular installation. If this equipment does cause harmful interference to radio or television reception, which can be determined by turning the equipment off and on, the user is encouraged to try to correct the interference by one or more of the following measures:

1. Reorient or relocate the receiving antenna.
2. Increase the separation between the equipment and receiver.
3. Connect the equipment into an outlet on a circuit different from that to which the receiver is connected.
4. Consult the dealer or an experienced radio/TV technician for help.

FCC Radiation Exposure Statement

This equipment complies with FCC radiation exposure limits set forth for an uncontrolled environment. This equipment should be installed and operated with minimum distance 20cm between the radiator & your body.



www.westinghouseelectronics.com

Westinghouse Electronics
Eastvale, CA USA