



**BURG  
WÄCHTER**

secu **ENTRY**

# Electronic door Lock

Pincode

Basic

Fingerprint

Innovative door  
access - safely and  
easily controlled via  
your smartphone



ENTRY Pincode · ENTRY Fingerprint · ENTRY Basic

en Assembly and User Manual

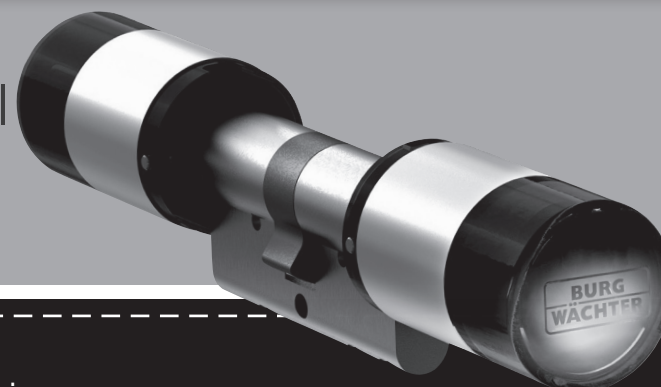

BURG-WÄCHTER KG  
Altenhofer Weg 15  
58300 Wetter  
Germany

## Structure

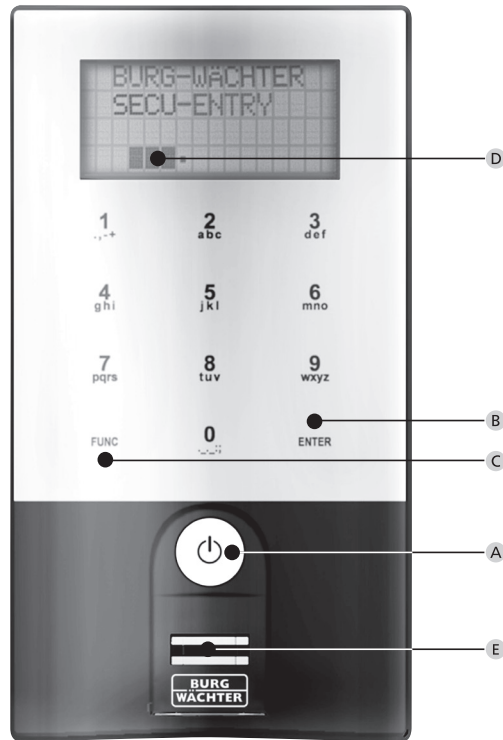

secuENTRY Keypad FP

## Illustration

### A On key

Activation of the keypad for the entry of opening code

### B Enter key

Selection of a menu item

### C Function key

The function key provides for a variety of actions depending on the current status of the keypad. The display indicates, which function is active

### 1) Access to the menu for programming

When the "Func:M" symbol is displayed, the menu can be reached by pressing the "Func" key. In the menu, the keys "1" and "2" can be used as a scroll function to navigate through its structure.

### 2) Deleting an entry action

When the "Func:C" symbol is displayed, the last entry can be cancelled by pressing the "FUNC" key.

### 3) Entry to previous programming level/Back

When you are in the menu, the symbol "Func:<" is displayed. By pressing the "FUNC" key, you return into the menu structure on the next higher level.

### D Battery indicator

■■■■ Battery full [ \ ] Battery empty

The display indicates battery statuses of the cylinder unit and the keypad unit. The indication on the display concerns the batteries with the lowest status. In case a battery is empty, the display indicates as follows:

### Replace battery in keypad or replace battery in knob.

When the battery has been replaced and then the opening code entered twice, the currently lowest battery status is displayed. When only a single battery set is replaced, the display can still indicate an "incomplete" status, despite the replacement. In case you do not replace the batteries in spite of the replacement indication, you will have to enter the valid opening code once more in order to open the door. At the same time, the inner knob LED flashes 5 x 5 times. You can still open the door in this way approx. 50 times. Then it can only be opened using the administrator code.

Now the batteries must be replaced, otherwise the door cannot be opened any more.

### E Fingerscan sensor

To open or register the particular finger.

Dear customer,

Thank you very much for your decision for the secuENTRY electronic lock system manufactured by BURG-WÄCHTER.

This system has been developed and manufactured using the latest technical potential and satisfies high security requirements.

The electronic cylinder can be used easily without any drilling in any door prepared for profile cylinder up to a door thickness of 130 mm (67.5/62.5), measured at the central detent bolt, and is perfectly appropriate for new installation as well as for retrofitting.

Depending on the specific system, various opening media are available. With systems containing a keypad, user administration is additionally integrated. You can find out more on the following pages.

**Attention! Just a light pressure by your finger is required to operate the keypad, similarly to modern high quality touchscreen mobile phones!**

**Important:** Please read the entire User Manual before you start programming. We hope you enjoy your new locking system.

## General information about secuENTRY

secuENTRY is available in three versions:

- ENTRY BASIC
- ENTRY PINCODE
- ENTRY FINGERPRINT

In the set configurations ENTRY PINCODE and ENTRY FINGERPRINT, the keypad is already registered in the cylinder.

Similarly, the attached transponders are already registered in the cylinder and can be applied immediately.

### Administrator code/QR code

The QR Code is required for both the setup of opening options using the BURG-WÄCHTER KeyApp and for the subsequent attaching and registration of a keypad or a cylinder.

In ENTRY Pincode and ENTRY Fingerprint, the administrator code is factory-set to 1-2-3-4-5-6 (please never forget to change it).

**Attention! In case you lose your administrator code and/or your QR code, any reprogramming and any use of administrator functions becomes impossible. Please store it carefully!**

*Our hint: The QR code can also be stored in an electronic form as a scanned file or a photograph on a protected data carrier.*

### Examples of additional functions using the optional ENTRY 5750 software:

- User administration
- Assignment of authorisations
- History function

### Power supply

- 2 x MIGNON LR6 AA ALKALINE for the keypad
- 1 x lithium battery (CR123A) for the cylinder

## Optical signalling

Optical signalling in the form of a LED is incorporated in the knob on the outer side of the door.

This LED informs you on the following:

- 1 x brief: cylinder coupled
- 2 x brief: cylinder uncoupled
- 1 x brief, 1 x long, 2 sec pause, repeating: lock in programming mode
- 5 x briefly, 2 sec pause, repeating at 20 sec: battery in cylinder empty

## Technical data

<b>Blocking times</b>	After 3 x wrong code is entered 1 minute, then always 3 minutes
<b>Display</b>	Adjustable to 12 languages
<b>Permissible ambient conditions*</b>	15 °C / +50 °C/ up to 95 % rel. air humidity (noncondensing); as a result of extreme temperature changes, the display can react slowly or darken.
<b>Protection class</b>	Protection class keypad PINCODE IP65 Protection class keypad Fingerprint IP55 Protection class cylinder IP65

\* In case the temperature exceeds the specified range, a corresponding warning message is indicated on the display. Provide for an appropriate corrective action!

## These are the different QR codes:



- 1 Keypad (SN; MAC; AES; Type)
- 2 Cylinder (SN; MAC; AES; ADM)
- 3 Transponder (UID; BW; Type)

**Attention! If you have purchased the ENTRY Basic set, the "Type" field contains the number of the corresponding transponder.**

## Opening

secuENTRY can be operated, depending on the equipment configuration, using a 6 digit numerical code, the BURG-WÄCHTER KeyApp, with fingerprints or by a transponder.

### Opening with PIN code

- Activate the keypad using the key
- Enter the 6 digit PIN code (factory-set to 1-2-3-4-5-6). The display indicates "Please use rotating knob!" and the LED integrated in the cylinder flashes once when the opening is successful.
- Turn the cylinder knob

### Opening with transponder

- Hold the transponder from the front at no more than 1 cm from the cylinder knob. The LED integrated in the cylinder flashes once when the opening is successful.
- Turn the cylinder knob

Bitte beachten Sie, dass die Tastatur bei dem Öffnungsvorgang mit einem Transponder vorher nicht über die -Taste eingeschaltet werden darf!

### Opening with fingerprint

- Schalten Sie die Tastatur über die Taste ein
- Move the registered finger from the top to the bottom centrally over the sensor. The display indicates "Please use rotating knob!" and the LED integrated in the cylinder flashes once when the opening is successful.
- Turn the cylinder knob

### Opening with BURG-WÄCHTER KeyApp

- Hold your smart device in front of the cylinder knob and press the opening button of the KeyApp.
- The LED integrated in the cylinder flashes once when the opening is successful.
- Turn the cylinder knob

## BURG-WÄCHTER KeyApp

You can download the BURG-WÄCHTER KeyApp from the App Store or the Google Play Store. For this purpose, simply enter the search item "secuENTRY" or "KeyApp".

Compatible with Samsung Galaxy S4, S4 mini, S5 and S5 mini from Android 4.3 KitKat or 5.0 Lollipop, Apple iPhone 4S, 5, 5S, 6, 6P from IOS 8.1.3.

Please check under:

<https://www.burg.biz/international>

whether other Smartphones are compatible with the app.

## ENTRY Pincode

### General information

The electronic cylinder is operated by entering a PIN code. Additionally, the lock can also be operated using the BURG-WÄCHTER KeyApp or a transponder.

### Contents of the delivery

- |   |                          |
|---|--------------------------|
| 1 QR code keypad                          | 11 Rubber shell          |
| 2 Keypad                                  | 12 Assembly aid          |
| 3 Adapter set                             | 13 Disconnecting pliers  |
| 4 Inner knob                              | 14 Tx (size 8)           |
| 5 QR code transponder                     | 15 Forend screw          |
| 6 Transponder                             | 16 Allen key (size 3)    |
| 7 Fixing materials keypad                 | 17 QR code cylinder      |
| 8 Fixing materials keypad (adhesive pads) | 18 cylinder              |
| 9 Cylinder extension                      | 19 Wall mounting plate   |
| 10 Adapter screws                         | 20 Sight protection film |

### Functions

- Total number of users: up to 50
- A transponder can also be assigned to every PIN code user (except administrator)

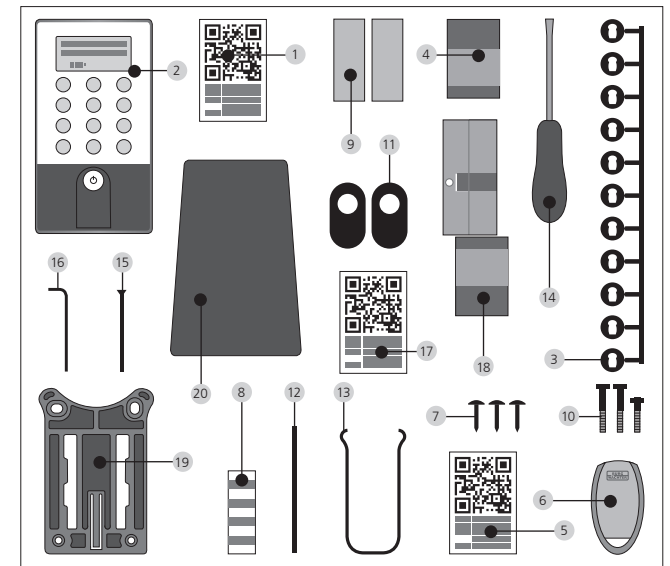

## ENTRY Fingerprint

### General information

The electronic cylinder is operated using a scanned finger. Up to 24 fingers can be programmed using the keypad. The users are created separately (USER XXX\_FP). If a code and/or a transponder should be additionally assigned to a user, it is to be created separately. Additionally, the lock can also be operated using a PIN code, the BURG-WÄCHTER KeyApp or a transponder.

### Contents of the delivery

- |   |                          |
|---|--------------------------|
| 1 QR code keypad                            | 11 Rubber shell          |
| 2 keypad                                    | 12 Assembly aid          |
| 3 Adapter set                               | 13 Disconnecting pliers  |
| 4 Inner knob                                | 14 Tx (size 8)           |
| 5 QR code Transponder                       | 15 Forend screw          |
| 6 Transponder                               | 16 Allen key (size 3)    |
| 7 Fixing materials 1 keypad                 | 17 QR-Code Zylinder      |
| 8 Fixing materials 2 keypad (adhesive pads) | 18 Cylinder              |
| 9 Cylinder extension                        | 19 Wall mounting plate   |
| 10 Adapter screws                           | 20 Sight protection film |

**Attention! The fingerprint sensor must not be cleaned with detergents. Please use a slightly moistened cloth for this purpose.**

### Functions:

- Total number of users: up to 50, out of whom number of fingerprints: up to 24
- A transponder can also be assigned to every PIN code user (except administrator)

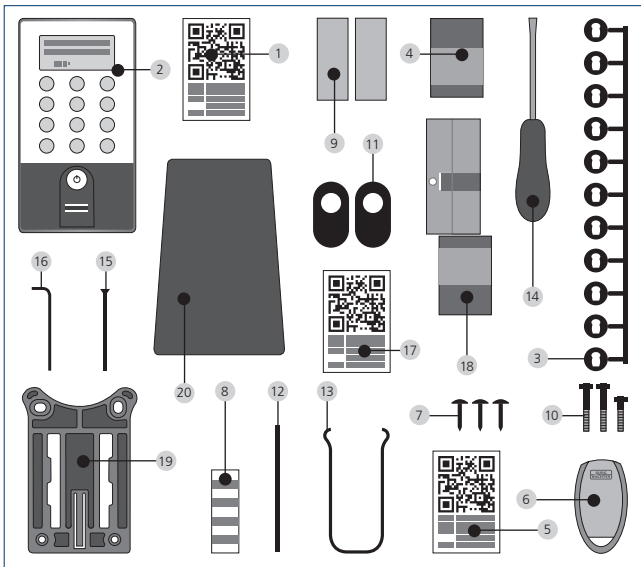

## ENTRY Basic

### General information

The electronic cylinder is operated using a transponder. The transponder should be positioned in front of the cylinder knob. Subsequent programming of additional transponders can be done using a secuENTRY keypad or the ENTRY software. The operating range of a transponder is up to 1 cm.

### Contents of the delivery

- |                         |                         |
|-------------------------|-------------------------|
| 1 Adapter set           | 11 Assembly aid         |
| 2 Inner knob            | 12 Disconnecting pliers |
| 3 QR code transponder 1 | 13 Rubber shell         |
| 4 Transponder 1         | 14 QR code cylinder     |
| 5 QR code transponder 2 | 15 Cylinder             |
| 6 Transponder 2         |                         |
| 7 Cylinder extension    |                         |
| 8 Adapter screws        |                         |
| 9 Allen key             |                         |
| 10 Forend screw         |                         |

### Functions

- Total number of users: up to 50

Optional locking media:

- ENTRY KP PIN
- ENTRY KP FP (up to 24 fingerprints possible)

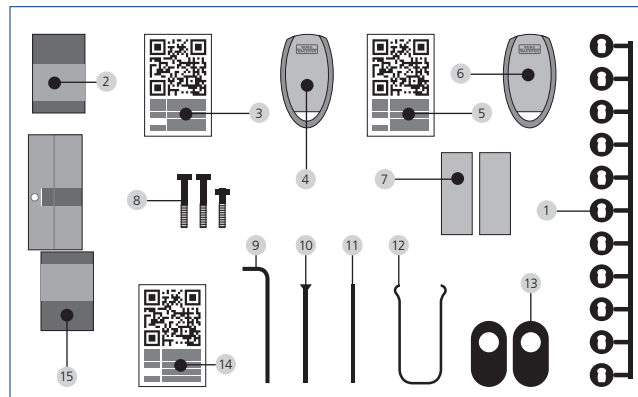

## Basic indication of the menu functions

When the "Func:M" symbol is displayed, the menu can be reached by pressing the "FUNC" key. In the menu, the keys "1" and "2" can be used as a scroll function to navigate through the menu structure. The (Enter) key can be used to reach the next menu level.

## Structure of the menu

Code change menu  
 Sprache/Language menu  
 Administrator menu  
     Create user menu  
         Create: Code  
         Create: Transponder  
         Create: Fingerprint  
 Assign transponder menu  
 Delete menu  
 Additional functions menu  
     Date adjustment → not available in the standard version  
     Time adjustment => not available in the standard version  
 Setup menu  
     Register  
     Reorganise  
     FP reset menu  
 Info menu

## Description of the menu

The following text described the functions for the products **ENTRY Pincode** and **ENTRY Fingerprint**.

## Menu Code change

### Changing the administrator code and the user codes

- Activate the keypad using the  $\odot$  key
  - Then press FUNC
  - 'Menu/Code Change' is
  - Confirm your selection using  $\leftrightarrow$
  - Now you can use the keys 1 or 2 to scroll until the administrator / user, whose user code should be changed, is displayed
  - Confirm with  $\leftrightarrow$
  - Enter the code valid so far (existing code) and press  $\leftarrow$
  - Enter the new code and confirm it with  $\leftrightarrow$
  - Repeat your entry and confirm it again with  $\leftrightarrow$ .
- "Code change accomplished" is displayed after a correct entry

## Language menu Language set up

- Activate the keypad using the  $\odot$  key
- Then press FUNC, 'Menu/Code Change' is displayed
- Scroll using the 2 key till reaching the above menu item
- Confirm with  $\leftarrow$
- Use the keys 1 or 2 to scroll until the required language is displayed
- Confirm with  $\leftarrow$

## Menu administrator

### Various submenus are available under the Administrator menu

#### Submenu create user with code

- Activate the keypad using the  $\odot$  key
- Then press FUNC, 'Menu/Code Change' is displayed
- Scroll using the 2 key till reaching the 'Administrator menu'
- Confirm with  $\leftarrow$ . The "Create User" menu item appears
- Confirm with  $\leftarrow$
- Scroll using the 2 key till reaching the "Create User: Code" item
- Confirm with  $\leftarrow$
- Enter the administrator code in order to acquire the authorisation for programming
- The next free memory cell is indicated (e.g. USER.003)
- Enter the 6 digit code and confirm it 2 x with  $\leftarrow$
- "Data has been saved" is displayed

#### Submenu create user with transponder

- Activate the keypad using the  $\odot$  key
- Then press FUNC, 'Menu/Code Change' is displayed
- Scroll using the 2 key till reaching the 'Administrator menu'
- Confirm with  $\leftarrow$ . The "Create User" menu item appears
- Confirm with  $\leftarrow$
- Scroll using the 2 key till reaching the "Create User: Transponder" item
- Confirm with  $\leftarrow$
- Enter the administrator code in order to acquire the authorisation for programming
- Hold the transponder in front of the knob
- "Data has been saved" is displayed

#### Submenu create user with Fingerprint

(This function is only active with ENTRY Fingerprint and with the ENTRY KP FP keypad)

- Activate the keypad using the  $\odot$  key
- Then press FUNC, 'Menu/Code Change' is displayed
- Scroll using the 2 key till reaching the 'Administrator menu'
- Confirm with  $\leftarrow$ . The "Create User" menu item appears
- Confirm with  $\leftarrow$
- Scroll using the 2 key till reaching the "Create User: Fingerprint" item
- Confirm with  $\leftarrow$
- Enter the administrator code in order to acquire the authorisation for programming

- "Register finger" is displayed
- Move the finger to be registered several times centrally over the sensor (the number of moves is indicated on the display)
- "User\_XXX\_FP successfully registered" is displayed

#### Submenu assign transponder

Using this function, you can subsequently assign a transponder to an already existing user. For this purpose, proceed as follows:

- Activate the keypad using the  $\odot$  key
- Then press FUNC, 'Menu/Code Change' is displayed
- Scroll using the 2 key till reaching the 'Administrator menu'
- Confirm with  $\leftarrow$
- Scroll using the 2 key till reaching the "Assign Transponder" item
- Enter the administrator code in order to acquire the authorisation for programming
- Scroll till reaching the user, to whom you intend to assign a transponder, and confirm 2 x with  $\leftarrow$
- Hold the transponder directly in front of the knob and use the keypad to confirm with  $\leftarrow$
- "Data has been saved" is displayed

#### Submenu Delete

Using this menu, you can delete a user or a transponder.

- Activate the keypad using the  $\odot$  key
- Then press FUNC, 'Menu/Code Change' is displayed
- Scroll using the 2 key till reaching the 'Administrator menu'
- Confirm with  $\leftarrow$
- Scroll using the 2 key till reaching the "Delete" item
- Enter the administrator code in order to acquire the authorisation for programming
- Scroll till reaching the user or the identification medium (transponder) you wish to delete and confirm your selection 2 x with  $\leftarrow$
- "Data has been deleted" is displayed

#### Time Functions submenu (Premium only)

This is intended for setting the time and date

#### Setting the time:

Not available as a standard function.

#### Setting the date:

Not available as a standard function.

#### Setup submenu

General system settings

#### Register

After a replacement of the cylinder or the keypad, the two units have to be newly aligned, so that they can resume communication. **Attention! Before registering a keypad, the ENTRY cylinder must be awakened. This is done by opening the lock once with a transponder. Then you have 1min time for the login process.**

#### Registration of a keypad

- Activate the keypad using the  $\odot$  key
- Then press FUNC, 'Menu/Code Change' is displayed
- Scroll using the 1 or 2 key till reaching the 'Administrator menu'
- Confirm with  $\leftarrow$
- Scroll using the 1 or 2 key until reaching the "Setup" menu item
- Confirm with  $\leftarrow$
- Enter the admin code of the unit to be registered
- "Data has been saved" is displayed after a successful registration

**Attention! Make sure that no other powered secuENTRY unit is placed within a direct reach of the device when registering a new keypad or a new cylinder, as such unit could be mistakenly addressed instead of the intended one. When in doubt, disconnect such units from power before the registration (remove batteries).**

#### Reorganise

The use of this function is recommended when several users have been deleted.

- Activate the keypad using the  $\odot$  key
- Then press FUNC, 'Menu/Code Change' is displayed
- Scroll using the 2 key till reaching the 'Administrator menu'
- Confirm with  $\leftarrow$
- Scroll using the 2 key until reaching the "Setup" menu item
- Confirm with  $\leftarrow$
- The "Reorganise" menu item appears
- Confirm with  $\leftarrow$
- Enter the administrator code in order to acquire the authorisation for programming
- "Reorganisation in progress" is displayed

#### Submenu FP Reset

(This function is only active with ENTRY Fingerprint and with the ENTRY KP FP keypad) All the stored fingerprints are deleted, however, the corresponding users are retained. Please select this menu and follow the instructions on the display in case of repeated error functions related to the use of fingerprints.

#### Info menu

The version and serial number of the system are displayed using this function.

For security reasons, the complete serial number is indicated only in the administrator mode.

- Activate the keypad using the  $\odot$  key
- Then press FUNC, 'Menu/Code Change' is displayed
- Scroll using the 2 key till reaching the 'Info' menu
- Confirm with  $\leftarrow$ . The serial numbers of the keypad (EA) and of the cylinder (AA) are displayed.

**Remark:** For security reasons, the serial number (AA) of the cylinder is not completely displayed before the entry of a valid administrator code.

## Installation instructions for the secuENTRY cylinder

Please read these Installation Instructions carefully before the assembly and then store them at a safe place.

### Remark:

The base size of the cylinder is 30 mm per side. When shipped, the cylinder has, on its inner side, the base length of 30mm, with the outer knob already mounted. The cylinder is provided with an adapter set allowing for adaptation of the cylinder to door thicknesses of up to 130 mm (67.5/62.5) measured at the central detent bolt). The adapter set provides appropriate screws for different adapter lengths.

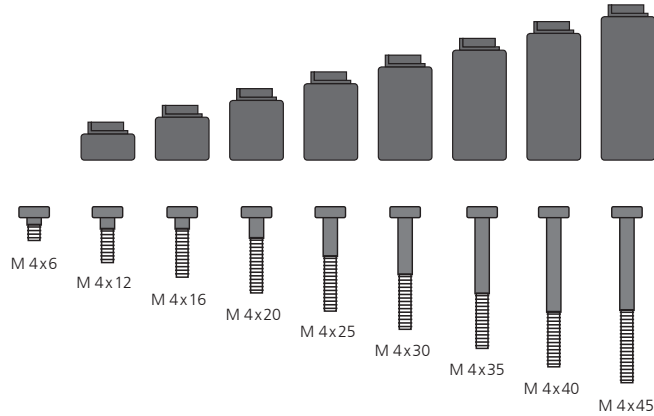
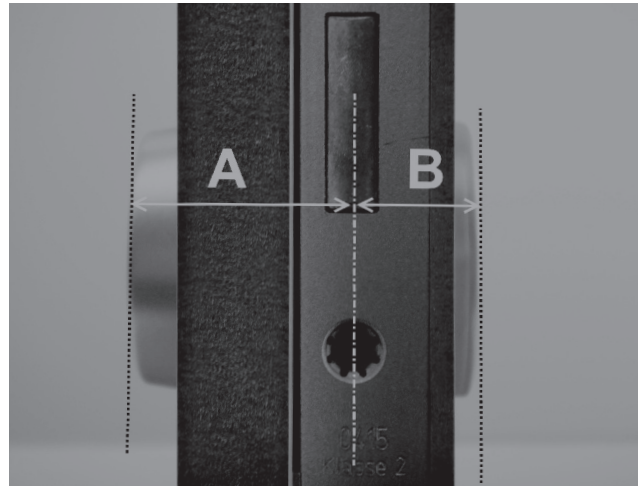

Fig. 1: Illustration of the adapter and corresponding screws (1:1 illustration on a separate sheet)



Adapter	No Adapter	1	2	3	4
<b>Dimension A; B</b>	<= 29mm	29,5 – 34mm	34,5 – 38,5mm	39 – 42,5mm	43 – 47,5mm
<b>Screw</b>	M4 x 6	M4 x 12	M4 x 16	M4 x 20	M4 x 25
Adapter	5	6	7	8	
<b>Dimension A; B</b>	48 – 52,5mm	53 – 57,5mm	58 – 62,5mm	63 – 67,5mm	
<b>Screw</b>	M4 x 30	M4 x 35	M4 x 40	M4 x 45	

Tab. 1: Required adapters

**Attention! Attention shall be paid to prevent the inner knob from being bumped, as the knob can break in such case. The lock shall not be greased or oiled.**

### Proceed as follows to assemble the system:

Attach the cylinder to the door in order to determine whether an adapter is required. Alternatively, the door incl. fittings can be measured (dimensions A; B). When using rubber shells for profile cylinder holes, you should always add 2mm to the actual size.

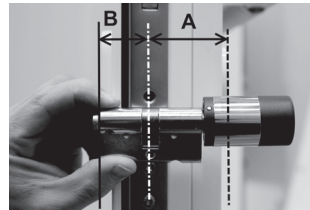

**Mounting for doors with thickness incl. fittings which are less than 29mm per side and for which the cylinder can be moved from outside to inside through the profile cylinder hole.**

1 Slide the cylinder from outside to inside through the profile cylinder hole.

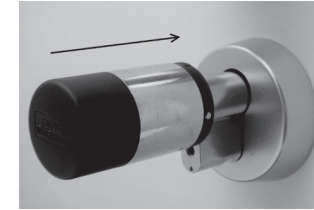

2 Fix the cylinder using the forend screw.

3 Put the inner knob on the cylinder or on the appropriate adapter and fasten it with the corresponding screw. Table 1 provides the required dimensions.



4 Push the sleeve on the inner knob and snap it in.

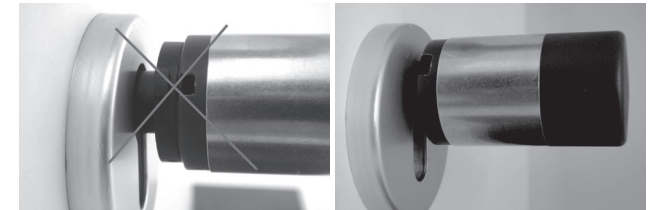

**Mounting for doors which thickness incl. fittings exceeds 29mm per side.**

1 Use the disconnecting pliers to push the knob latches together and pull the sleeve off.

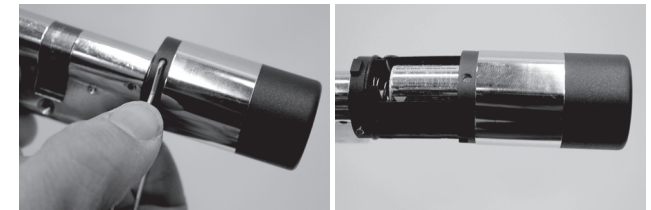

2 Carefully pull off the plug.

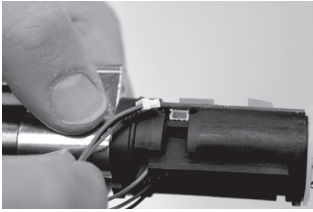

3 Remove the screw.



**Attention! Be careful not to damage the circuit board or the cable!**

4 Pull the knob from the cylinder and slide the cable from the sleeve.

5 Choose the appropriate adapter for the outside and snap it on. Table 1 provides the required dimensions.

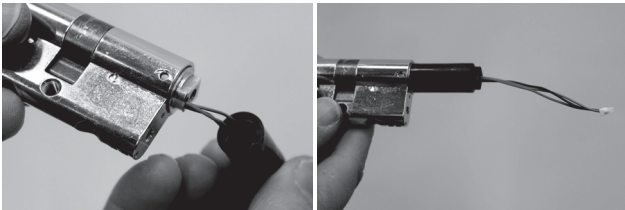

6 Slide the assembly aid on the plug and, together with the cylinder and the adapter, slide it from inside into the mortise lock.

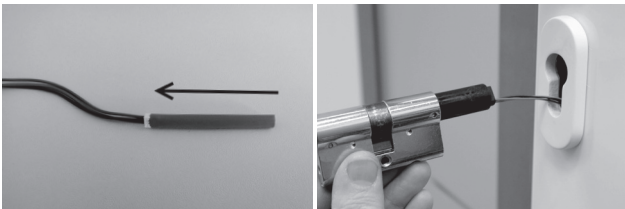

**Attention! Do not pinch or damage the cable!**

7 Fix the cylinder using the forend screw.



8 If required, install the cylinder extension (inside/outside) and mark it where aligned with the fitting. The cylinder extension prevents a stress on the cylinder.

9 Remove the cylinder extension, use a saw to shorten it to the required length and mount it back finally.

10 Use the assembly aid to slide the cable through the outer knob.

**Attention! Do not pinch or damage the cable!**

11 Snap the adapter onto the cylinder.



12 Hold the cable tight and lead it through the nut.

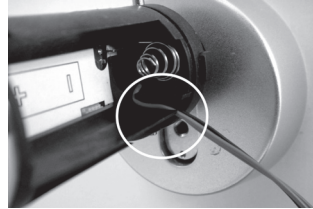

**Attention! The cable must not overlap and must be completely stowed in the pocket!**

13 Use the attached Allen key to fasten the appropriate screw.



**Attention! Do not pinch or damage the cable!**

14 Connect the cable with the plate using the plug and stow the remaining cable in the side pocket intended for this purpose.



15 Inset the battery with the correct polarity and snap on the sleeve.  
**Please remember: The fixing is possible in just one position!**

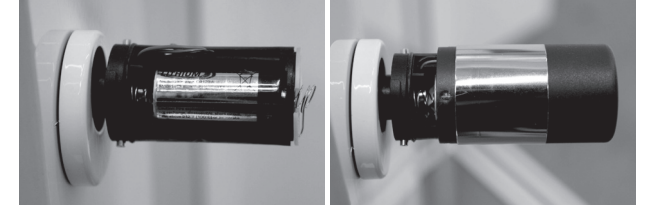

16 Put the inner knob on the cylinder or on the appropriate adapter and fasten it with the corresponding screw. Table 1 provides the required dimensions.

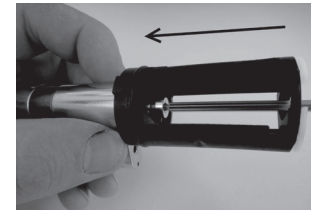

17 Place the sleeve and snap it in.

## Installation instructions for secuENTRY keypad

The keypad is only included in ENTRY Pincode and ENTRY Fingerprint sets.

**Attention! Please remember that the keypad should not be attached to the door itself, otherwise it would transmit shocks when the door is being shut.**

**The membrane affixed to the keypad rear side should not be sealed with glue and/or any other substance under any circumstances! Exchange of air must also be possible after the installation!**

- Determine the installation place for the keypad. For that purpose, enter the opening code (e.g. PIN code, fingerprint, ...) at the desired mounting place and check whether the lock opens.
- Place the keypad correspondingly.

You can then decide whether you want to glue the wall holder directly on the wall or whether you prefer having it screwed on. The slotted holes in the wall holder provide for an exact alignment.

If you decide for gluing the wall holder, please be sure to provide for clean surfaces free from fat, oil and silicon films and any other impurities. Remove completely the protective film from the included adhesive pads, attach all the pads on the wall holder and then press it firmly to the required position. When mounting in colder temperatures, please remember that the full adhesive force cannot be achieved before 72 hours in 20°C, with warmth accelerating the process (e.g. in 65°C, the full adhesive force will be achieved in one hour).

When attaching the holder plate on the coloured sight protection film, the above described conditions relating to cleanliness of surfaces and firmness of the adhesive pad should be observed.

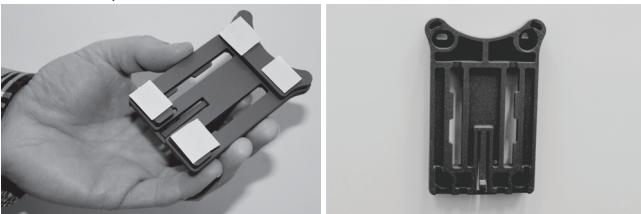

To provide for a bubble-free application of the colour sight protection film, please proceed as follows:

- Pour some water with a couple of drops of dishwashing detergent into a glass, stir it cautiously free of foam, and then use it to moisture gently the surface, on which the film is to be applied.
- Start pulling off the white protective sheet from 1 cm of film and straighten it out. To change the position, lift this surface carefully and attach it again as required.
- Then swipe the adhesive film, e.g. with a plastic spatula, out from the contact surface in the direction of protective sheet still attached.

**Attention! Do not use more liquid than absolutely necessary.**

- Slide the keypad in from above until the locking peg of the mounting plate engages into the keypad housing. In this way, the keypad is protected against undesired removal.
- Perform a function test of the unit with the door open. For this purpose, enter repeatedly a valid opening code (e.g. PIN code, fingerprint, ...).



## Battery replacement for secuENTRY keypad

- Remove the housing cover on the bottom side by loosening the 2 screws (Torx 8).



- Pull the battery compartment lid downwards until it disengages and replace the batteries.

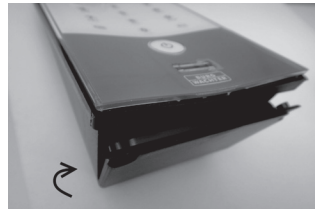

**When inserting the new batteries, be careful to observe the correct polarity as indicated on the housing.**



- To close the battery compartment, first press the battery compartment lid close to the screw holes to make them slide into the recesses, then snap

the bottom side into position by pressing on it.

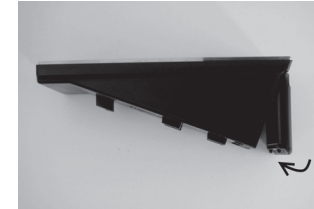

- Fasten the battery compartment lid with screws.



**Attention! Make sure that no moisture enters the keypad when replacing the battery.**

## Cleaning instruction for secuENTRY keypad

The surface finish of the keypad prevents adherence of impurities. Dust or dirt can be removed from the surfaces using a damp cloth. **No alcohol-based detergents (spirit, SIDOLIN® etc.) or aggressive detergents (acetone etc.) may be used, as they can damage the surface or the sensor.**



### Battery replacement for secuENTRY cylinder

- Use the included tool to push the knob latches together and pull the knob sleeve off.

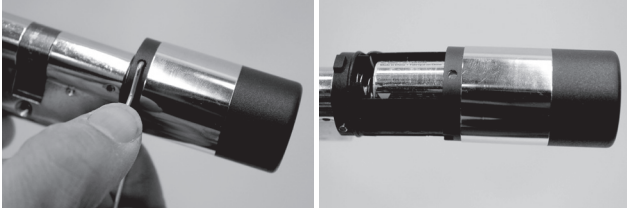

- Replace the battery while carefully adhering to correct polarity.



- Slide the knob sleeve carefully back to the position.  
**Please remember: The fixing is possible in just one position!**

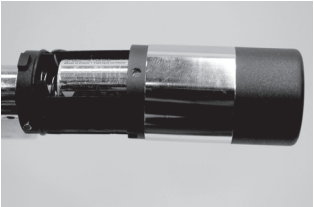

**Attention! Make sure that the cable is not squeezed. Make sure that the O-ring sits in the correct position.**

- Let the sleeve snap back into place.

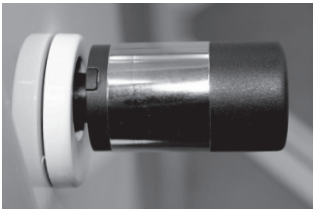

### Dismantling of the secuENTRY keypad from the wall holder

- Remove the housing lid on the bottom side by loosening the 2 screws (Torx 8).



- Pull the battery compartment lid downwards until it disengages.



- Press the latch using a narrow tool (e.g. flat-bladed screwdriver) downwards and slide the keypad upwards.

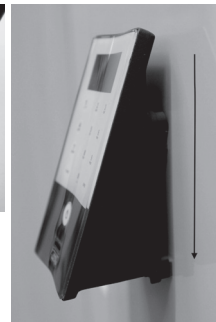

### Interference with Bluetooth devices

Bluetooth devices use the same frequency band (2.4GHz) as WiFi devices. This can cause interference leading to errors or even to communication failure. In such case, any devices not required should be kept disconnected from power.

### Warranty

In order to be able to provide you with perfectly flawless and high quality products and an optimal support when you need servicing or repair, we need you to present faulty or defective devices to your vendor together with a valid administrator code and the QR code(s), with the original purchase document attached.

When you return a device component based on your right of withdrawal from the purchase agreement, such component must be adjusted to factory settings and the seal on the cylinder and on the knob must be intact. In case of noncompliance with this, the warranty becomes invalid.

### Disposal of the device

Dear customer,  
Please help us avoid unnecessary waste. Should you ever intend to dispose of this device, please bear in mind that many components of the device contain precious materials, which can be recycled.



Please be aware that electrical and electronic equipment and batteries shall not be disposed of as household waste, but rather collected separately. Please obtain information on the collecting points for electrical waste from the responsible authority of your municipality.



If you have any questions concerning the EC declaration of conformity, please use [info@burg.biz](mailto:info@burg.biz)