



secu **ENTRY**

Initial setup secuENTRY sE-Key 7713

en



Setup with app
BURGsmart



Video instructions

Simple instructions on the setup and operation of your secuENTRY components. Follow the QR code or go to...

<https://t1p.de/burgsmart-app>

BURG-WÄCHTER KG
Altenhofer Weg 15
58300 Wetter
Germany

www.burg.biz

Contents index

en English 2

Further languages at:

www.burg.biz

Foreword

Dear Customer,

Thank you very much for deciding on the secuENTRY sE-Key 7713.

The system was developed in Germany according to the most modern technical capabilities and fulfils the latest high safety requirements.

The sE-Key 7713 is setup and operated using the free smart-phone app *BURGsmart*. The transmission is wireless, the cylinder uses the modern Bluetooth 5.2 standard.

! Important:

Please read the entire operating instructions before you start the installation.

We hope you enjoy your new locking system!

Set contents

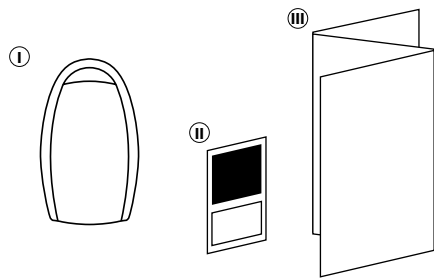

Fig. 1

①	sE-Key 7713 radio key
②	QR-Code sticker
③	warranty and disposal instructions

QR code sticker

The QR code (I) are required later when setting up the set using the BURG-WÄCHTER BURGsmart app (Fig. 1).

! Attention:

Neither the QR codes nor the factory-generated administrator code are stored by BURG-WÄCHTER. Recovery is not possible if the codes are lost. It is important to keep the QR code stickers enclosed with the set in a safe place. We further recommend that you photograph the stickers and also archive them digitally.

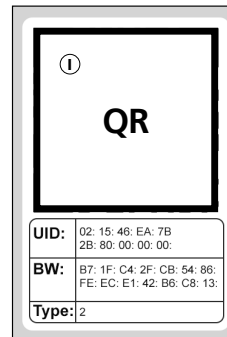

QR code sticker
sE-Key 7713 radio key
Fig. 1

Technical data - radio key sE-Key 7713

Radio key power supply	1x CR 2430 (Knopfzelle)
Permitted ambient conditions	-15 °C/+50 °C / up to 95 % relative humidity (non-condensing)
Radio standard	Bluetooth 5.2 LE
Transmission power	≤ 10 dBm
Frequency range	2.4 - 2.483 GHz
Range	Approx. 4 m

Activation

The sE-Key radio key is integrated as an opening media in a variety of ways, depending on the secuENTRY product. Please select the type of setup to suit your secuENTRY product:

Setup with the BURGsmart app: Page 2

This setup mode requires:

- Smartphone with installed *BURGsmart* app
- QR code (enclosed with this radio key)

Setup via display keypad: Page 5

This setup mode requires:

- secuENTRY Display keypad (e.g. *ENTRY 7722 Keypad FP*)

Setup via secuENTRY Windows software: Page 6

This setup mode requires:

- secuENTRY Windows-Software (e.g. *ENTRY 7783 Software pro*)
- QR-Code (provided with this radio key transponder)

! Attention: When using the transponder, please note that the respective programming is stored on the secuENTRY hardware components. Following programming, however, this will not automatically appear in the other setup or usage media. This means that an sE-key set up using the keypad does not appear in the BURGsmart app user profile or in the software. The maximum number of possible opening media entries depends on the cylinder used. The relevant information can be found in the cylinder specifications.

Setup with the BURGsmart app

This setup mode requires:

- Smartphone with installed *BURGsmart* app
- QR code (enclosed with this radio key)

! Note:

This product is a supplementary article to a secuENTRY cylinder or set, which means that the cylinder, the BURGsmart app and their functions are assumed to be present and familiar to the user. In case you should require any corresponding information, please refer to the secuENTRY instructions for your cylinder/set or go to our website (see link on the title page).

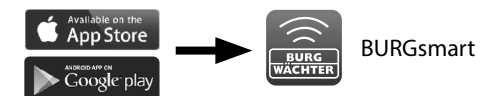

Fig. 1

I - User

- 1 Tap "My System" in the bottom left-hand corner of the BURGsmart app main screen (Fig. 1).
- 2 Tap on the menu item "I - User" (Fig. 2).

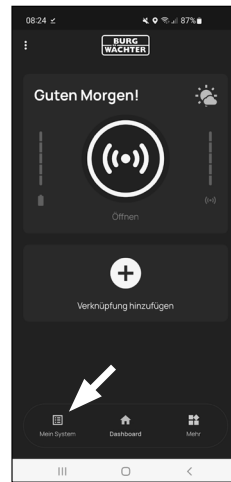

Fig. 1

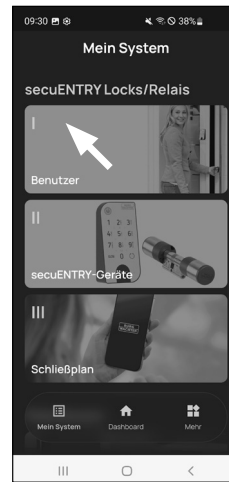

Fig. 2

- 3 A list of the users that have already been created is displayed. Tap the user for which you want to set up the radio key (Fig. 2).
- 4 An overview of the user data appears. Select "Access data/ sE-Key" to save your transponder as the opening media. Tap on the QR code symbol to the right of the "Enter sE-Key" field (Fig. 5).

Note: The "Enter sE-Key" field edits entries that already exist, which means that the field has no function without an entry. Instead, tap the QR code symbol to the right of it.

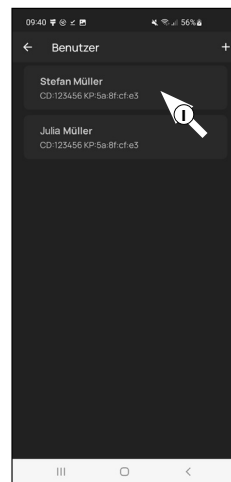

Fig. 3

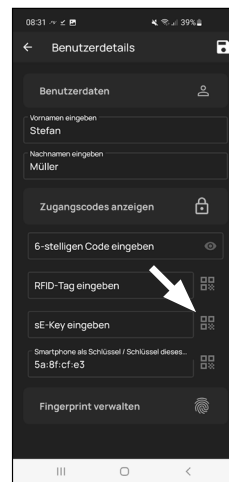
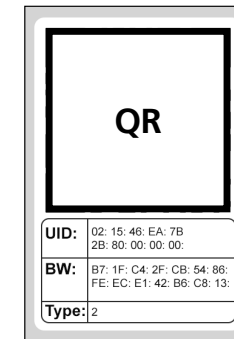

Fig. 4

- 5 The capture window of the camera opens and you may be asked to confirm the app's access to the camera. Scan the QR code supplied with the radio key (Fig. 5) using the smartphone camera.
- 6 After scanning the QR code, a message appears with data regarding your transponder, confirm this with "OK" at the bottom right (Fig. 6).



QR code sticker
sE-Key 7713 radio key
Fig. 5



Fig. 6

- 7 This takes you back to the user details window. In the "Enter sE-Key" field you now see that the transponder has been stored (I) (Fig. 7). Tap the "Save" symbol in the top right-hand corner (II) (Fig. 7).
- 8 You can now leave the menu (I - User).

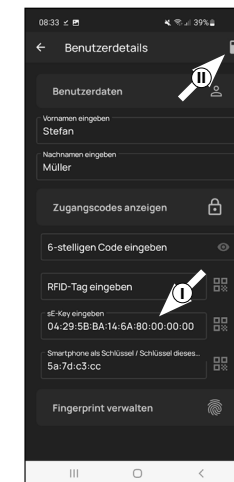

Fig. 7

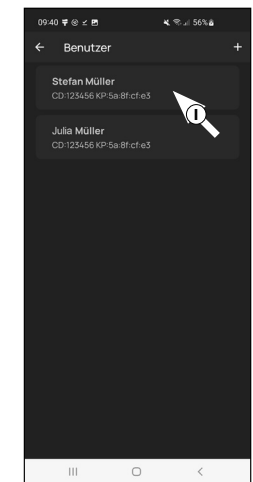

Fig. 8

II - secuENTRY Units

- Note:** This point is not relevant for setting up the sE-Key 7713 radio key. Consequently, you can skip this and continue directly to the next chapter.

III - Locking plan

- Use this menu to define the locking plan, namely which user is allowed to open which lock. The data is then transferred to the cylinder.
- Open the "My System" menu (I) (Fig. 1).
- Tap on the fourth menu item "III - Locking plan" (Fig. 1).
- A table is displayed consisting of the existing cylinders (horizontal) and the configured users (vertical) (Fig. 2). Select the checkbox where you wish to authorise the respective user to use the corresponding lock (I) (Fig. 2) and then click on the button "Save changes" (II) (Fig. 2).



Fig. 1

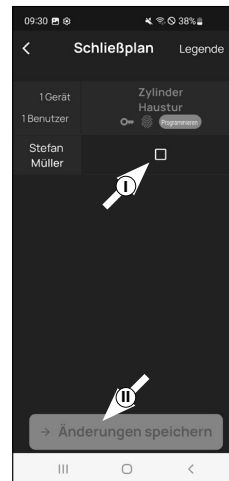

Fig. 2

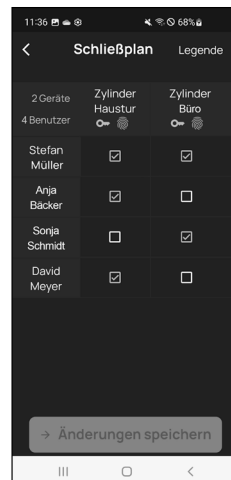

Fig. 3

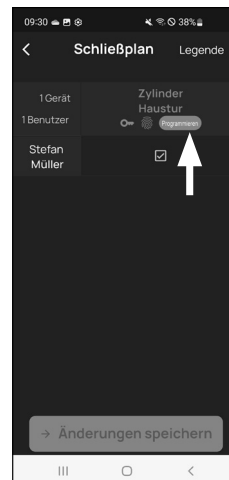

Fig. 4

! For info: This table is of interest when you have several cylinders and users. This allows you to clearly determine in one step who is allowed to access which cylinder. Fig. 3 provides an example of what a completed table with corresponding cylinders and users might look like.

! Attention: The following step requires the smartphone, keypad and cylinder to be in direct proximity to each other (Bluetooth range).

- If any changes have been made to the locking plan, the display of the respective cylinder appears red and the „Program“ button is displayed. This indicates that the settings have not yet been transferred to the cylinder. To do this, tap the red „Program“ button for the respective cylinder (Fig. 4).

- Here you will be asked to verify yourself with your administrator code. Enter the code and confirm with "OK" (Fig. 5).

! Note: The factory administrator code can be found on the QR code sticker of the cylinder under "ADM" (Fig. 9).

- The data will be transferred. A confirmation will appear after a brief moment and at the same time a request to now assign the keypad. Tap on the confirmation message (Fig. 6).

- Select the required keypad (Fig. 7).

- You will be asked to set the keypad to programming mode (Fig. 8). Instructions on how to do this can be found in the chapter "Setting the keypad into programming mode" on page 3. As soon as the keypad is in programming mode, indicated by the LEDs on the keypad flashing continuously, tap the "LEDs flashing continuously, continue" key in the app (Fig. 8).

- Nach einem kurzen Moment erhalten Sie eine Rückmeldung, dass die Daten übertragen wurden. Bestätigen Sie mit „OK“.

The setup is now completed.

Repeat the steps in the respective chapters if you wish to integrate further components into your system at a later date, change access data or create additional users.

Please note: All changes and additions are carried out within the app and must then be transferred to the respective secuENTRY component. This last chapter, "Locking plan" (page 3) must be completed in each case in order to be able to use them in your components.

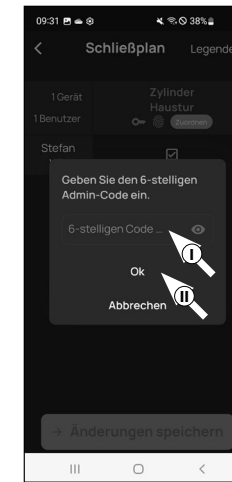

Fig. 5

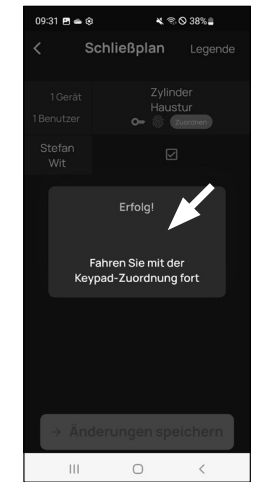

Fig. 6

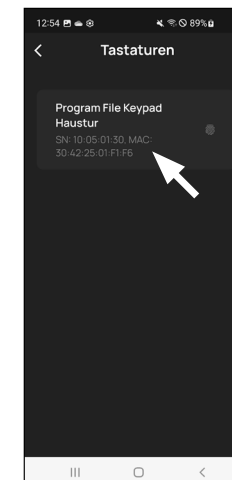
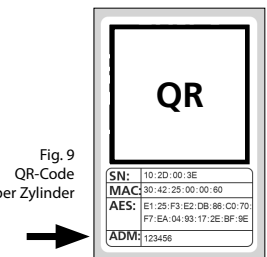

Fig. 7



Fig. 8

Fig. 9
QR-Code
Aufkleber Zylinder



Setup via display keypad:

This setup mode requires:

- ENTRY 5711 Keypad PIN, ENTRY 5712 Keypad FP or ENTRY 7722 Keypad FP

! Note:

This product is a supplementary article to a secuENTRY cylinder or set, which means that the cylinder, the keypad and their functions are assumed to be present and familiar to the user. In case you should require any corresponding information, please refer to the secuENTRY instructions for your cylinder/set or go to our website (see link on the title page).

- 1 Switch on the keypad using the ⏻ key (Fig. 1).
- 2 Press **FUNC**, "Menu/Code Change" appears as the first menu item of this submenu.

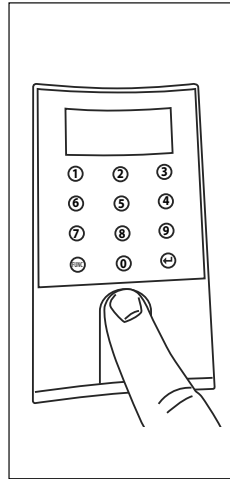

Fig. 1



Fig. 2

- 3 Scroll using the 2 key until the "Administrator" menu item appears. Confirm with ⏪ .

- 4 The "Create user" menu item appears. Confirm with ⏪ .

- 5 Scroll with the 2 key until you reach the menu item "Create: sE-Key". Confirm with ⏪ (Fig. 2).

- 6 Enter your administrator code to acquire the authorisation for programming.

- ! **Note:** Provided you have not changed it, the factory administrator code can be found in your cylinder documentation. The factory-assigned administrator code can be found next to the abbreviation "ADM" on the QR code sticker (Fig. 5).

- 7 Press the sE key 1x (Fig. 3), the logon process starts and lasts at least 7 seconds.

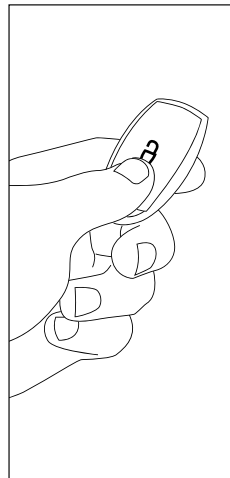

Fig. 3



Fig. 4

- 8 "Data has been saved" appears in the display (Fig. 4).

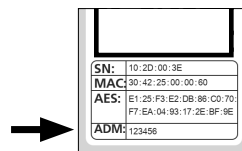

Fig. 5

Cylinder QR code sticker

Assigning a transponder using the display keypad

This function enables assigning a transponder to an existing user at a later date.

- 1 Switch on the keypad using the ⏻ key.
- 2 Press **FUNC** (Fig. 6), "Menu/Code Change" appears as the first menu item of this submenu.
- 3 Scroll using the 2 key until the "Administrator" menu item appears. Confirm with ⏪ .
- 4 The "Create user" menu item appears. Confirm with ⏪ (Fig. 7).
- 5 Scroll using the 2 key until the "Assign transponder" menu item appears. Confirm with ⏪ .
- 6 Enter your administrator code to acquire the authorisation for programming.

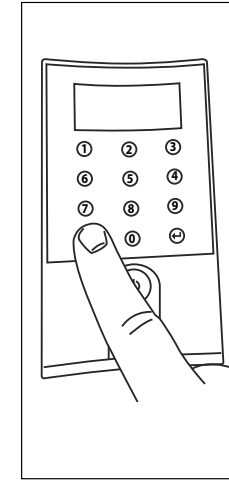

Fig. 6



Fig. 7

- ! **Note:** Provided you have not changed it, the factory administrator code can be found in your cylinder documentation. The factory-assigned administrator code can be found next to the abbreviation "ADM" on the QR code sticker (Fig. 10).

- 7 Scroll to the user to which you want to assign a transponder and confirm twice with ⏪ .

- 8 Press the sE key 1x (Fig. 3), the logon process starts and lasts at least 7 seconds.

- 9 "Data has been saved" appears in the display (Fig. 9).

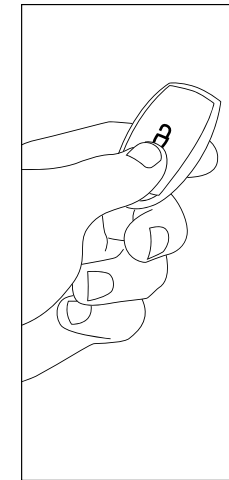

Fig. 8



Fig. 9

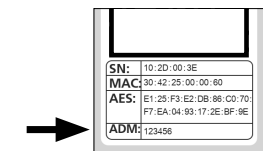

Fig. 10

QR code sticker Cylinder

Setup via secuENTRY Windows software

This setup mode requires:

- ENTRY 7083 Software pro, and/or ENTRY 7783 Software pro
- QR-Code (provided with this radio key)

! Note:

Detailed instructions on how to set up opening media via the secuENTRY software can be found in the instructions for the software itself or on our website www.burg.biz.

Opening the secuENTRY lock with the sE-Key 7713 radio key

- 1 Hold the sE-Key within the Bluetooth range of the cylinder (max. 4m) in the direction of the cylinder and press the surface of the transponder (Fig. 1).
- 2 You receive a visual feedback by a red LED lighting up on the transponder. The cylinder is now released and the lock can be opened (fig. 2) or locked (fig. 3).

- ! **Note:** Depending on the door stop, the direction of rotation may be reversed.

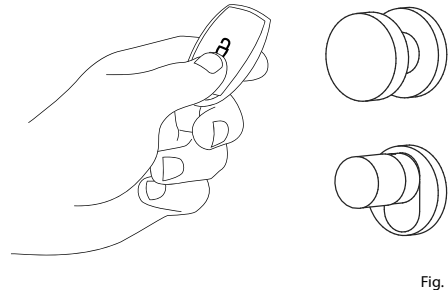

Fig. 1

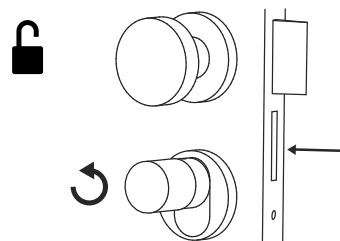

Fig. 2

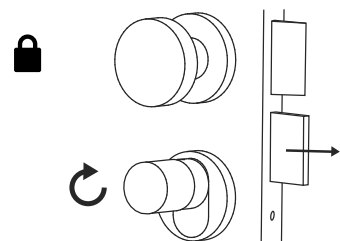

Fig. 3

Replacing the batteries

If the cylinder release is delayed by approx. 3 - 7 seconds when using the sE-Key 7713 active transponder and the red LED on the transponder is flashing, this indicates that the batteries in the transponder are weak and should be replaced as soon as possible. For this purpose, proceed as follows:

- 1 Loosen the screw on the bottom of the transponder (Fig. 1) and remove the cover (Fig. 2).

- 2 Remove the old batteries and dispose of them appropriately.

- ! **Tip:** Instructions for proper disposal can be found on page 8 of these instructions.

- 3 Insert a new CR 2430 button cell battery. Ensure that the smooth side (+) faces outwards (Fig. 3). This correct position is also marked in the housing.

- 4 Close the cover and screw it back on tightly (Fig. 4).

- ! **Tip:** If the release of the cylinder is delayed by 3 - 7 seconds, but the red LED on the transponder is **not** flashing, this may be an indication that the batteries in the cylinder are running low. Check in the BURGsmart app whether they need to be replaced.

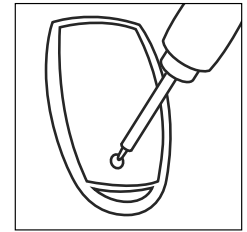

Fig. 1

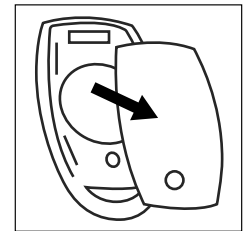

Fig. 2

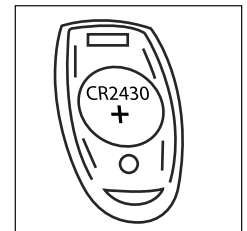

Fig. 3

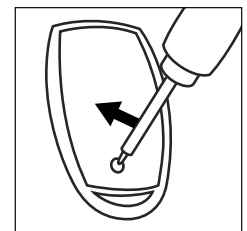

Fig. 4

Compatibility with other secuENTRY products

Whether for one front door, several doors or a complete locking system: Simply configure your individual unit with the secuENTRY modular system.

Your sE-Key 7713 radio key can be used as an add-on for the following components:



Fig. 1

ENTRY home 5000 CYL

Program up to 6 identification media. 1 master administrator code (when using a ENTRY keypad) and five more users with sE-Key 7713 radio keys or Smartphones as electronic keys.

Article number:
400348250002

Further information
can be found on
our website:

www.burg.biz



Fig. 1

ENTRY easy 7600 CYL

Program up to 2,000 identification media, of which max. 300 fingerprints.

Article number:
4003482506004

Further information
can be found on
our website:

www.burg.biz



Fig. 1

ENTRYpro 7000 CYL

Program up to 2,000 identification media, of which max. 300 fingerprints. Can also be used as an anti-panic cylinder: with freewheel and panic function FZG* as standard pursuant to guideline FZG**, edition 2020-07-06 issued by PIV.

Article number:
4003482571309

Further information
can be found on
our website:

www.burg.biz



Fig. 2

ENTRYpro 7010 TWIN

Program up to 2,000 identification media, of which max. 300 fingerprints. Can also be used as an anti-panic cylinder: with freewheel and panic function FZG* as standard pursuant to guideline FZG**, edition 2020-07-06 issued by PIV.

Article number:
4003482571408

Further information
can be found on
our website:

www.burg.biz



Fig. 3

ENTRYpro 7030 HALF

Half cylinder Program up to 2,000 identification media, of which max. 300 fingerprints. Can also be used as an anti-panic cylinder: with freewheel and panic function FZG* as standard pursuant to guideline FZG**, edition 2020-07-06 issued by PIV.

Article number:
4003482571606

Further information
can be found on
our website:

www.burg.biz



Fig. 6

secuENTRY Add-on ENTRY 7171 Relay

Control unit for switching external electronic devices (shutters, barriers, light sources, etc.).

Article number:
4003482506707

Further information
can be found on
our website:

www.burg.biz



Fig. 10

secuENTRY Windows-Software ENTRY 7783 Software Pro

Designed specifically for companies and public authorities. Allowing the management of up to 2,000 users and up to 1,000 doors per client (database) or up to 500 doors in hotel mode.

Article number:
4003482507834

Further information
can be found on
our website:

www.burg.biz

* Complies with the requirement of the class of panic function F2 and FZG according to DIN18252:2018-05

** Tested by the Prüfinstitut Schlösser und Beschläge Velbert (PIV)

Warranty

In order to deliver a flawless and high quality product to you and to better assist you in case of service or repair, it is necessary that faulty or defective devices along with the valid administrator code and the QR code(s) be presented to your dealer together with the original documentation.

When returning goods due to your right of withdrawal, all parts of the appliance must also be in their factory settings. Failure to comply with this will invalidate the warranty.

Disposal of the device

Dear customer,

Please help to reduce waste. Should you intend to dispose of this device at any time, please remember that many components of this device contain valuable materials that can be recycled.



Please note that electrical and electronic devices as well as batteries must not be disposed of with household waste but rather apart from it or separately. Please obtain information on the collecting points for electrical waste from the responsible authority of your city/municipality.



BURG-WÄCHTER KG hereby declares that this device complies with the Directives 2014/53/EU, (RED) and 2011/65/EU (RoHS).

The complete text of the EU Declaration of Conformity is available at the following Internet address <https://burg.biz/pages/eu-konformitaetserklaerung>.

Notes



secuENTRY
sE-Key 7713

BURG-WÄCHTER KG
Altenhofer Weg 15
58300 Wetter
Germany

www.burg.biz

BD Ersteinrichtung sE-Key 7713 DE HBG/SWI 120723

www.burg.biz