



MX108 双模键鼠用户手册

MX108 Wireless Keyboard & Mouse Combo
User Manual

快速开始指南 ▶

Quick Start Guide

感谢您购买及使用本产品



为了给您带来更好的使用体验，在使用产品前请仔细阅读本说明书，并请妥善保管，以便日后参观。

包装内容

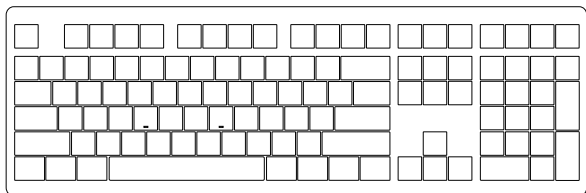

系统需求

Windows®XP / Vista / 7 / 8 / 10或更高版本

安装步骤

将键盘电源开关拨至ON处，电脑USB口插入产品接收器，即可完成2.4G连接并使用。

独立指示灯

状态	指示灯位置	指示方式
NUM	独立指示灯1	开启白光常亮
CAPS	独立指示灯2	开启白光常亮
电量指示灯	独立指示灯3	低电白灯闪烁/充电红灯常亮/充满红灯灭

MX108 组合键功能

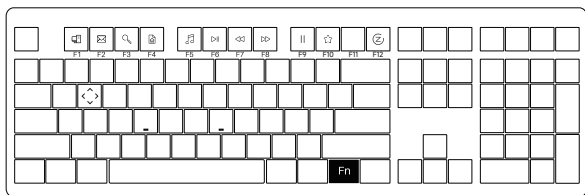

Fn+	F1	我的电脑
	F2	电子邮件
	F3	= Windows搜索
	F4	浏览器主页
	F5	多媒体播放器

Fn+	F6	播放 / 暂停
	F7	上一首
	F8	= 下一首
	F9	停止
	F10	收藏

Fn+	F11	刷新
	F12	一键休眠
	W	= 将WASD与上下左右调换

MX108 系统功能 (Mac)

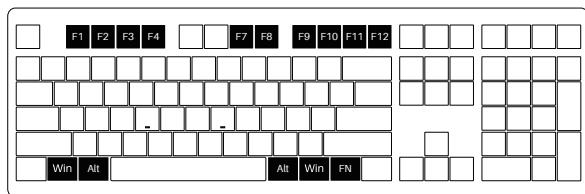

F1	降低显示屏亮度
F2	增加显示屏亮度
F3	开放任务控制
F4	呼出Siri

F7	向后跳(音频)
F8	暂停/播放(音频)
F9	向前跳过(音频)
F10	静音

F11	调低音量
F12	调高音量
左Win	Option
左Alt	Command

右Alt	Command
右Win	Option

Fn + (F1 ~ F12)
F1 ~ F12

MX108 系统功能 (Windows)

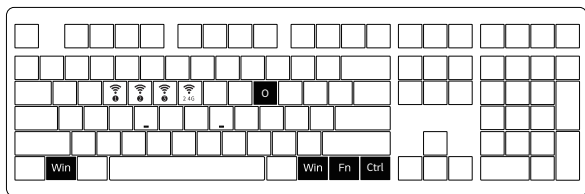

Fn+	E	=	蓝牙设备1
	R	=	蓝牙设备2

Fn+	T	=	蓝牙设备3
	Y	=	2.4G无线设备

菜单键
长按 FN + 右Ctrl 3秒

锁Win键
FN + 左Win

恢复出厂设置
长按 左Win + 右Win 5秒

WIN系统 ⇌ MAC系统
长按 Fn + O 3秒

蓝牙配对

键盘开机后，按下FN+E/R/T进入蓝牙模式，长按FN+E/R/T组合键3S，
键盘进入对码状态，三颗指示灯快闪，连上后指示灯常亮2S，
如果没有连上设备指示灯熄灭，键盘进入睡眠。

2.4G配对

键盘开机后，按下FN+Y进入2.4G模式，再按下FN+Y组合键3S进入配对模式后，
三颗指示灯快闪，插入接收器，配对成功后退出对码指示灯恢复正常。
找不到配对设备30s后退出对码模式，三颗指示灯熄灭，键盘进入睡眠。

MX108蓝牙+2.4G双模鼠标说明

产品外观

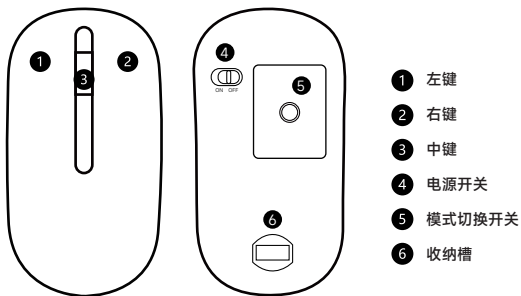

型号	MX108	模式	BT+2.4G无线鼠标
长度	114mm	电压	内置锂电池 3.7V/300mAh
高度	33mm	充电	USB5.0V
宽度	60mm	回报率	蓝牙:133 / 2.4G:125
重量	约84g	使用距离	10m 360°
尾灯	红色	DPI	无DPI键，默认1200
模式切换	短按切换2.4G 指示灯亮绿色 再短按切换蓝牙模式 指示灯亮蓝色	2.4G配对	左右键按住上电 绿色指示灯快闪
		蓝牙配对	按住配对键3秒进入配对 配对时长2分钟
系统	WIN2000/Win7/ Win8/ Win10/Android/IOS/Mac 等操作系统	按键功能	*左/右按钮 *电源开关/模式切换 *滚动按钮

MONGS GEEK 保修和服务声明

1. MONGS GEEK 为中国大陆的客户提供一个保修。对于其他地区，请联系您的卖家（MonsGeek 分销商）以了解具体的保修政策。
2. 如果保修期到期，客户需要支付维修费用。如果用户喜欢自己修理键盘，MonsGeek 也会提供说明。用户应对自行修复过程中发生的任何损失承担全部责任。
3. 在未经制造商/卖方指示的情况下拆开键盘将立即导致保修无效
4. 官方售后服务时间为每周一至周五上午10:00至下午18:00
节假日以国家法定节日休息为准。
5. 退货和保修政策在不同的平台上可能有所不同，并在购买时取决于具体的经销商。

公司：深圳银宸科技有限公司

地址：深圳市宝安区松岗街道碧头第一工业区朗碧路33号

电话：0755-23216420

网址：www.monsgeek.cn

产地：中国·深圳

Company: Shenzhen Yinchen Technology Co., Ltd

Address: 33 Langbi Rd, Bitou First Industrial Zone, Bao'an District, Shenzhen, China



WARNING:

Water and Beverages can't be poured into the Keyboard.



中国制造/Made in China

**注意
事项**

人为损坏不局限于键盘进水、高处坠落、过度用力拉扯线材等，键盘为电子产品请按照电子产品保护方式爱惜使用。

Packing List

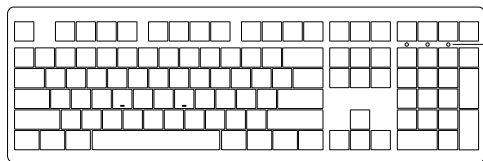

LED Indicator

1. Num
2. Caps
3. Battery Level Indicator

System Requirement

Windows®XP / Vista / 7 / 8 / 10 or higher version

Connectivity Method

Turn the keyboard power switch to the ON position and insert the USB receiver into an available USB port to complete the 2.4G connection and start using it.

Independent Indicator

Status	Indicator Position	LED Indicator
Num	LED Indicator 1	Steady white
Caps	LED Indicator 2	Steady white
Low Battery	LED Indicator 3	Slow flashing white LED
Charging		Steady red
Fully Charged		Steady red → Light off

MX108 HotKeys

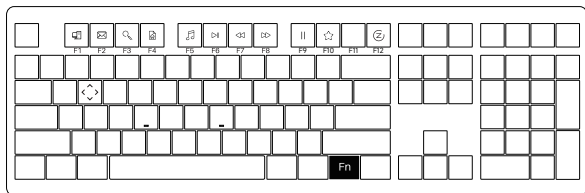

Fn+	F1	My computer	Fn+	F6	Play/Pause	Fn+	F11	Refresh
	F2	E-mail		F7	Previous song		F12	One-Key Hibernate
	F3	Windows search		F8	Next song	=	W	Swap W A S D with ↑ ↓ ← →
	F4	Browser homepage		F9	Stop			
	F5	Multimedia player		F10	Bookmark			

MX108 System Commands (Mac)

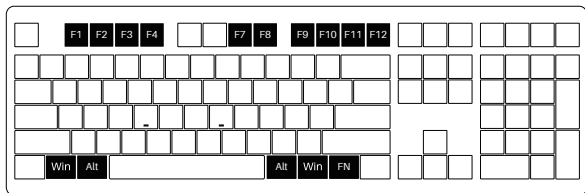

F1	Decrease display brightness	F7	Skip back (Audio)	F11	Volume down
F2	Increase display brightness	F8	Pause/Play (Audio)	F12	Volume up
F3	Open mission control	F9	Skip forward (Audio)	Left Win	Option
F4	Activate Siri	F10	Mute	Left Alt	Command
Right Alt	Command	Fn + (F1 ~ F12)			
Right Win	Option	F1 ~ F12			

MX108 System Commands (Windows)

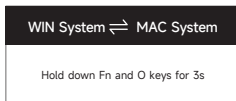
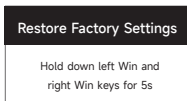
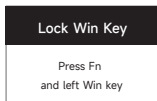
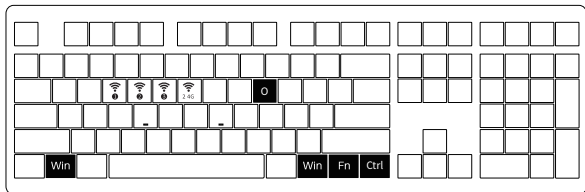

Bluetooth Pairing

After turning on the keyboard, press FN+E/R/T to enter Bluetooth mode. Press and hold the FN+E/R/T combination key for 3 seconds to put the keyboard in pairing mode, with three LED indicator lights flashing quickly. Once the connection is established, the indicator light will stay on for 2 seconds. If the device fails to connect, the indicator light will turn off and the keyboard will enter sleep mode.

2.4G Pairing

After turning on the keyboard, press FN+Y to enter 2.4G mode. Then press and hold the FN+Y combination key for 3 seconds to enter pairing mode, with the three indicator lights flashing quickly, and insert the USB receiver. Once pairing is successful, the LED indicator lights will return to normal. If no available device is found within 30 seconds, the three LED indicator lights will turn off, and the keyboard will enter sleep mode.

MX108 Bluetooth + 2.4G Wireless Mouse Overview

Specifications

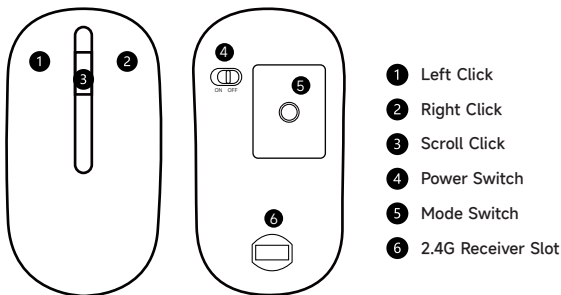

Model	MX108	Mode	BT + 2.4G Wireless
Length	114mm	Voltage	Built-in lithium battery: 3.7V/300mAH
Width	33mm	Charge	USB 5.0V
Height	60mm	Polling Rate	Bluetooth: 133Hz 2.4G: 125Hz
Weight	≈84g	Wireless Distance	10m 360°
LED Indicator	Red	DPI	Default 1200
Mode Switch	Short press to switch to 2.4G mode. (The indicator light will be green) Short press again to switch to Bluetooth mode. (The indicator light will be blue)	2.4G Pairing	Press left and right clicks to power on. (The green indicator flashes quickly)
		Bluetooth Pairing	Press and hold the pairing button for 3 seconds to enter pairing mode. (Pairing duration is 2 minutes)
Operating Systems	WIN2000/Win7/Win8/Win10/ Android/IOS/Mac	Key Functions	* Left/Right click * Power switch/Mode switch * Scroll click

MONSGEEK Warranty and Service Statement

1. MONSGEEK offers a One-Year warranty for customers in mainland China.
For other regions, please contact your seller (MonsGeek distributor) for specific warranty details.
2. If the warranty period expires, customers are responsible for repair costs.
MONSGEEK provides instructions for self-repair if preferred, but users assume full responsibility for any losses incurred during the process.
3. Disassembling the keyboard without manufacturer/seller's instruction will void the warranty immediately.
4. Return and warranty policies may vary across platforms and are subject to the specific distributor's terms at the time of purchase.

Company: Shenzhen Yinchen Technology Co., Ltd

Address: 33 Langbi Rd, Bitou Community 1st Industrial Zone, Bao'an District, Shenzhen, China

Tel: 0755-23216420

Website: www.monsgeek.com

Origin: Shenzhen, China



WARNING:
Water and Beverages can't be
poured into the Keyboard.



[instagram.com/akkogear](https://www.instagram.com/akkogear)



[facebook.com/akkogear](https://www.facebook.com/akkogear)

中国制造/Made in China



[tiktok.com/@akkogear](https://www.tiktok.com/@akkogear)

Precautions

Man-made damage is not limited to immersion, falling off, and pulling off the wires with excessive forces, etc.

 MONSGEEK