



### DISPLAY

|                      |   |
|----------------------|---|
| Diagonal Size        | 70" 4K, 75" 4K, 86" 4K  |
| Screen Type          | TFT LCD (Direct LED Backlight)  |
| Aspect Ratio         | 16:9  |
| Display Area         | 70" 4K: 1541 x 868 mm (60.7 x 34.2 in)<br>75" 4K: 1652 x 930 mm (65 x 36.6 in)<br>86" 4K: 1895 x 1066 mm (74.6 x 41.9 in) |
| Display Colours      | 1.07 Billion  |
| Resolution           | 4K UHD (3840 x 2160 @ 60 Hz)  |
| Response Time        | 8 ms  |
| Panel Refresh Rate   | 60 Hz   |
| LED Lifespan         | 50,000 hours  |
| LCD Viewing Angle    | 178°  |
| Brightness           | 70" 4K: 380 cd/m2<br>75" 4K: 380 cd/m2<br>86" 4K: 400 cd/m2   |
| Contrast Ratio       | 4000:1  |
| Ambient Light Sensor | Yes   |
| Glass Hardness       | 9H (pencil), 7 (Mohs)   |
| Glass Type           | Heat-tempered, Anti-Glare   |

### INTERACTIVITY

|                                |  |
|--------------------------------|--|
| Angled Centre Console          | Yes, with Power, Volume Control, Menu, Freeze, No Touch, Source Selection Buttons                                |
| Touch Technology               | Vellum™ Writing Technology   |
| Continuous Touch Points        | 20   |
| Touch Resolution               | 32768 x 32768 px   |
| Response Time                  | ≤5 ms  |
| Touch Accuracy                 | 1 mm   |
| Tracking Rate                  | 6 m/s  |
| Scan Rate                      | 200 Hz   |
| Gestures and Edge Swipes       | Windows® Supported   |
| Eraser Included (block eraser) | 1  |
| Pens Included                  | 4 with Rear Erasing Feature  |
| Pen Type                       | Battery-less Pen   |
| Pen Holder                     | Integrated Full-length Pen Tray  |
| Pen Tip Diameter               | 3 mm   |
| Pen and Touch Differentiation  | Yes  |
| Pen Identities                 | 2  |
| Palm Detection                 | Yes  |
| Annotation Over Any Source     | Yes  |
| Classroom Essential Apps       | Including Whiteboard, Annotate, Timer, Spinner, Screen Capture, Screen Share, Browser, PDF Reader, Media Players |
| Compatibility                  | Windows® 8 to 10; OS X® 10.8 to 10.11<br>macOS® Sierra 10.12.1 or later;<br>Linux® Ubuntu® 18.04 LTS; Chrome OS™ |

### CONNECTIVITY

|  |  |
|--|--|
| OPS Slot                                 | 1  |
| HDMI® In (Rear)                          | 2 (2.0)  |
| HDMI In (Front)                          | 1 (2.0)  |
| USB-A 2.0 (Rear)                         | 2  |
| USB Touch (Type B) (Rear)                | 3  |
| USB Touch (Type B) (Front)               | 1  |
| USB-A 3.0 (faster data transfer) (Rear)  | 2  |
| USB-A 3.0 (faster data transfer) (Front) | 2  |
| LAN In (RJ45)                            | 1x 10/100/1000 Mbps                            |
| LAN Out (RJ45)                           | 1x 10/100/1000 Mbps                            |
| RS-232                                   | Yes  |
| Wake-on-LAN                              | Yes  |
| Wi-Fi® Module                            | Included, IEEE® 802.11a/b/g/n/ac Wireless, 2x2 |
| Bluetooth®                               | Yes (4.2)                                      |
| DP In                                    | 1 (1.2)  |
| HDMI Out                                 | 1 (2.0)  |
| VGA In                                   | 1  |
| VGA Audio In                             | 1  |
| CVBS                                     | 1  |
| Mic In (3.5 mm)                          | 1  |
| Headphone                                | 1  |
| Proximity Sensor for Warm Boot           | Yes  |

### COMPUTING

|                             |   |
|-----------------------------|---|
| Operating System            | Android™ Oreo 8                                   |
| RAM                         | 4 GB  |
| Internal Storage            | 64 GB (32 GB x2)                                  |
| CPU                         | Quad Core: (2) ARM Cortex A73, (2) ARM Cortex A53 |
| GPU                         | ARM Mali-G51 MP4                                  |
| Remote Over-the-Air Updates | Yes   |
| Promethean Panel Management | Yes   |

### AUDIO

|   |  |
|---|--|
| Dual Front Facing, Bass Enhanced Speakers | 70" 4K: 2 x 15 Watts<br>75" 4K: 2 x 15 Watts<br>86" 4K: 2 x 20 Watts |
|---|--|

### POWER

|                             |  |
|-----------------------------|--|
| Power Requirements          | 100V - 240V AC                               |
| Power Consumption (Maximum) | 70" 4K: 215W<br>75" 4K: 280W<br>86" 4K: 370W |
| Power Consumption (Standby) | <=0.5 W                                      |
| Ultra-Quiet Fanless Design  | Yes  |

### ENVIRONMENTAL

|                       |                                    |
|-----------------------|------------------------------------|
| Operating Temperature | 0°C to 40°C (32°F to 104°F)        |
| Storage Temperature   | -15°C to 55°C (-5°F to 131°F)      |
| Operating Humidity    | 20% to 80% non-condensing humidity |
| Storage Humidity      | 20% to 90% non-condensing humidity |

### PHYSICAL SPECIFICATIONS

|                       |  |
|-----------------------|--|
| Panel Dimensions      | 70" 4K: 1668 x 1033 x 95 mm (65.7 x 40.7 x 3.7 in)<br>75" 4K: 1764 x 1089 x 109 mm (69.4 x 42.9 x 4.3 in)<br>86" 4K: 2014 x 1231 x 109 mm (79.3 x 48.5 x 4.3 in)     |
| Packed Dimensions     | 70" 4K: 1796 x 1145 x 278 mm (70.7 x 45.1 x 11.0 in)<br>75" 4K: 1895 x 1200 x 278 mm (74.6 x 47.2 x 11.0 in)<br>86" 4K: 2140 x 1350 x 278 mm (84.3 x 53.1 x 11.0 in) |
| Net Weight            | 70" 4K: 53 kg (117 lbs)<br>75" 4K: 60 kg (132 lbs)<br>86" 4K: 75 kg (165 lbs)  |
| Packed Weight         | 70" 4K: 75.5 kg (166.4 lbs)<br>75" 4K: 85.5 kg (188.5 lbs)<br>86" 4K: 101.6 kg (224.0 lbs)   |
| Wall Mount Dimensions | 1010 x 720 x 52 mm (39.8 x 28.3 x 2.0 in)  |
| VESA Mount Point      | 70" 4K: 600 x 400 mm (23.6 x 15.7 in)<br>75" 4K: 800 x 400 mm (31.5 x 15.7 in)<br>86" 4K: 800 x 400 mm (31.5 x 15.7 in)  |

### COMPLIANCE & CERTIFICATION

|                           |  |
|---------------------------|--|
| Regulatory Certifications | CE, FCC, IC, UL, CUL, CB, RCM            |
| Energy Star Certified     | 70" 4K: Yes<br>75" 4K: Yes<br>86" 4K: No |

### EDUCATION SOFTWARE LICENSE

|  |          |
|--|----------|
| ActivInspire® Professional Single User | Included |
|--|----------|

### PACKED CONTENTS

|                   |  |
|-------------------|--|
| What's in the Box | (1) ActivPanel Titanium<br>(1) 3M Length HDMI Cable<br>(1) 3M Length USB cable (A-B)<br>(1) 3M Regional Power Cable<br>(1) Remote Control<br>(2) Batteries for Remote Control<br>(4) ActivPanel Titanium Pens<br>(1) Block Eraser<br>(1) Sealed Antistatic Bag<br>(4) VESA mount screws (M6)<br>(1) Mini PC Bracket with screws<br>(1) Quick Install Guide<br>(1) Promethean Wi-Fi/Bluetooth Module (Ti)<br>(2) Antenna<br>(1) Promethean Wi-Fi/Bluetooth Module (Ti) User Guide<br>(1) Wall Mount |
|-------------------|--|

### INSTALLATION

The installation of this product should be completed by a qualified installer. Use of components not supplied by Promethean or not meeting minimum specifications may impact performance, safety and warranty. For more information, visit [Support.PrometheanWorld.com](http://Support.PrometheanWorld.com).

### WARRANTY

Warranty term and upgrade options vary by region. Contact your local reseller or distributor for information and visit [PrometheanWorld.com/Warranty](http://PrometheanWorld.com/Warranty).

### SUPPORT

For all Promethean products, visit [Support.PrometheanWorld.com](http://Support.PrometheanWorld.com).

## TECHNICAL DRAWINGS

70"

Front

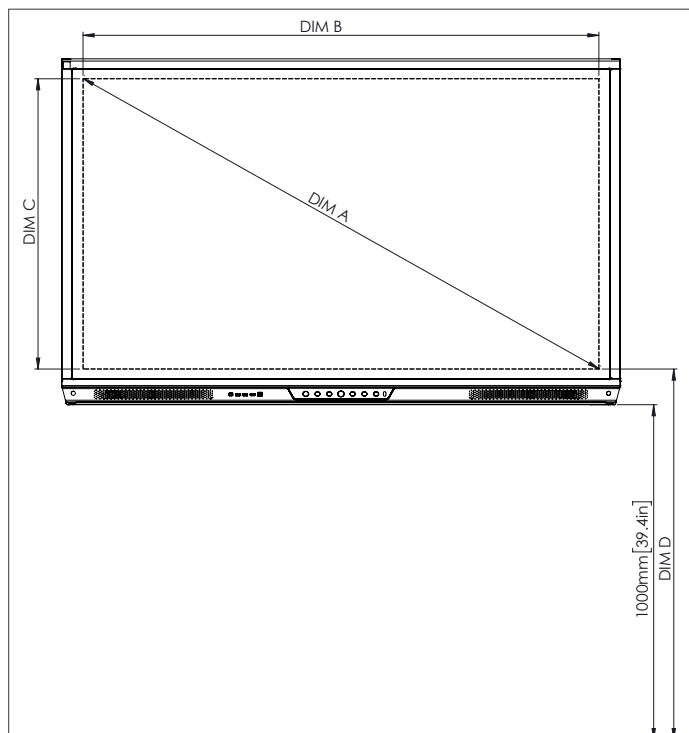

| DIM   | DIMENSION (MM) | DIMENSION (IN) |
|-------|----------------|----------------|
| A     | 1768           | 70.0           |
| B     | 1541           | 60.7           |
| C     | 867            | 34.1           |
| D     | 1107           | 43.6           |
| E     | 136            | 5.4            |
| F     | 67             | 2.6            |
| G     | 1033           | 40.7           |
| H     | 1668           | 65.7           |
| I     | 600            | 23.6           |
| J Min | 157            | 6.2            |
| J Max | 295            | 11.6           |
| K Min | 1157           | 45.6           |
| K Max | 1295           | 51.0           |
| L     | 95             | 3.7            |

Back

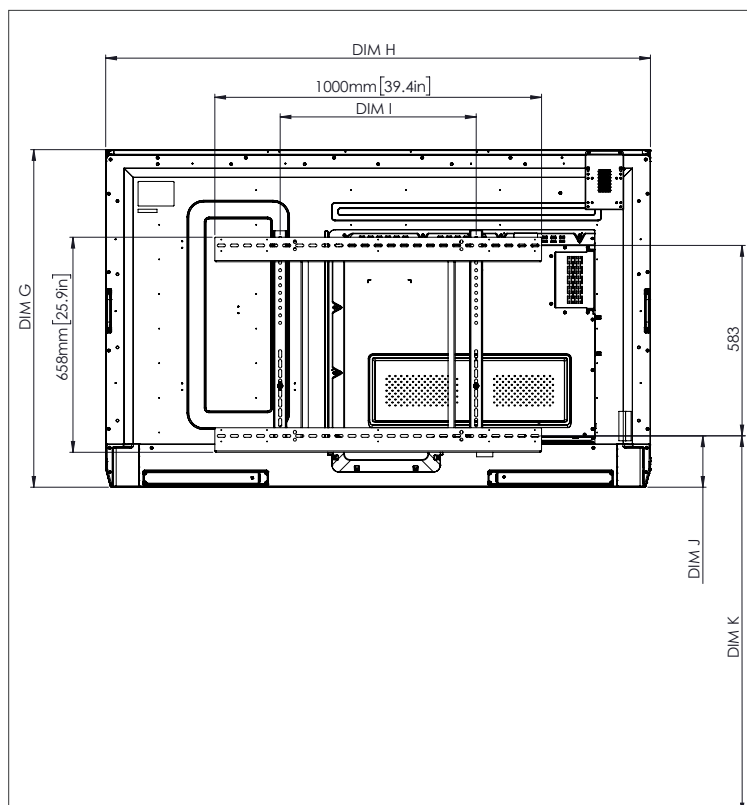

Side

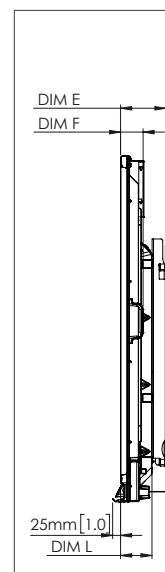

## TECHNICAL DRAWINGS

75"

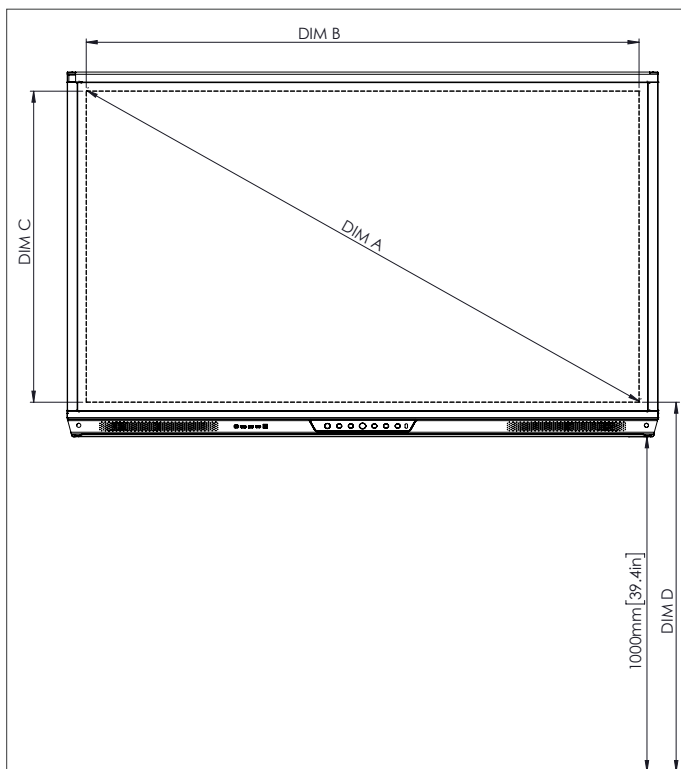

Front

| DIM   | DIMENSION (MM) | DIMENSION (IN) |
|-------|----------------|----------------|
| A     | 1894           | 75.6           |
| B     | 1651           | 65.0           |
| C     | 928            | 36.5           |
| D     | 1103           | 43.4           |
| E     | 133            | 5.2            |
| F     | 67             | 2.6            |
| G     | 1089           | 42.9           |
| H     | 1764           | 69.4           |
| I     | 800            | 31.5           |
| J Min | 214            | 8.4            |
| J Max | 352            | 13.9           |
| K Min | 1215           | 47.8           |
| K Max | 1353           | 53.3           |
| L     | 109            | 4.3            |

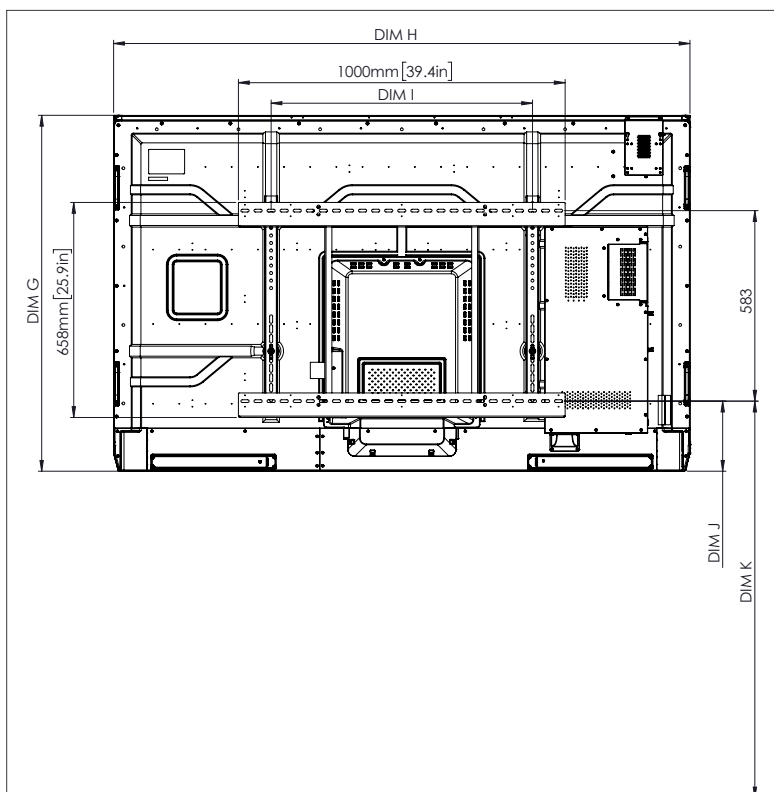

Back

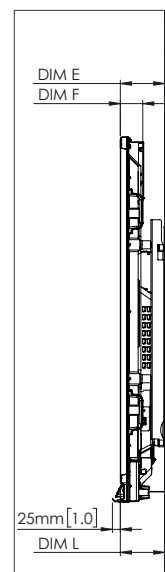

Side

ActivPanel 2019 Titanium SS 04/20 v2.2 EN-INTL

Page 4

© 2020 Promethean Limited. All rights reserved. Promethean Ltd. is owner of a number of trademarks in several jurisdictions across the world including but not limited to Promethean, the Promethean logo, ActivPanel, Titanium, Vellum, and ActivSoundBar. All third-party trademarks (including logos and icons) referenced by Promethean remain the property of their respective owners. Unless specifically identified as such, Promethean's use of third-party trademarks does not indicate any relationship, sponsorship, or endorsement between Promethean and the owners of these trademarks. Applicable Terms and Conditions for warranty and support available at [PrometheanWorld.com/Warranty](http://PrometheanWorld.com/Warranty). All weights and dimensions are approximate. Product specifications are subject to change without notice. [PrometheanWorld.com](http://PrometheanWorld.com).

## TECHNICAL DRAWINGS

86"

Front

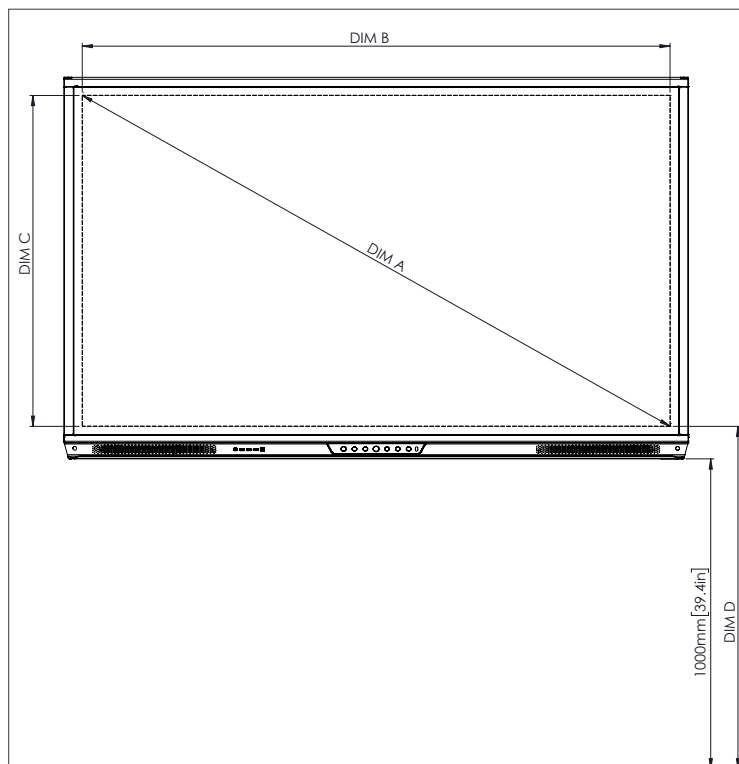

| DIM   | DIMENSION (MM) | DIMENSION (IN) |
|-------|----------------|----------------|
| A     | 2176           | 85.6           |
| B     | 1896           | 74.7           |
| C     | 1067           | 42.0           |
| D     | 1107           | 43.6           |
| E     | 134            | 5.3            |
| F     | 67             | 2.6            |
| G     | 1231           | 48.5           |
| H     | 2014           | 79.3           |
| I     | 800            | 31.5           |
| J Min | 286            | 11.3           |
| J Max | 424            | 16.7           |
| K Min | 1286           | 50.6           |
| K Max | 1424           | 56.1           |
| L     | 109            | 4.3            |

Back

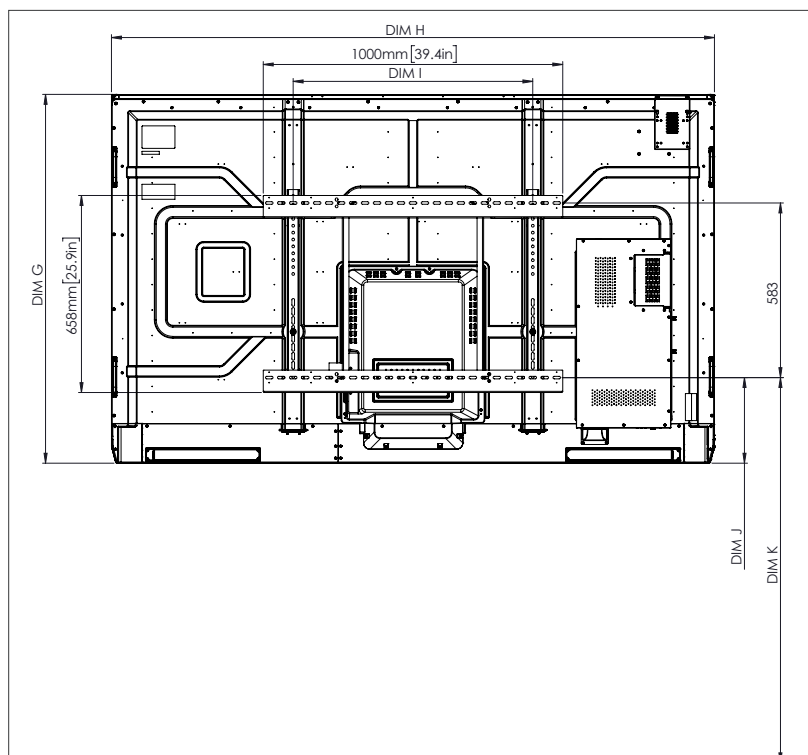

Side

