

BESANTEK Test Box is functional checking for RCD testers, loop testers and insulation/continuity testers.

Features:

- Wide range of operating voltage from AC 210V/50Hz to 250V/50Hz.
- Checks AC voltage.
- Checks RCD tester's test current & time in mA (ms).
- Checks loop testers.
- Checks wiring (Phase, Neutral, Earth).
- Checks continuity.
- Checks insulation (1.2kV maximum).
- Checks UK16th edition.
- Accessories: Instruction manual, carry case, power cord and plug (Euro, US, UK).



BST-CHK01

Technical Specification:

BST-CHK01	
RCD Testing	Range: 10mA at 150ms 30mA at 150ms 150mA at 30ms
Insulation Testing	Range: 1MΩ/9.9MΩ/99MΩ Accuracy: ±1% Max. testing: 1.2kV
Continuity Testing	Range: 0.5Ω/2Ω/10Ω Accuracy: ±0.05Ω/±0.1Ω/±0.2Ω Max. current: 300mA
Loop Testing	Range: Supply Loop/Supply Loop +1Ω Accuracy: 0.45Ω ± 0.05/1.45Ω ± 0.05Ω
Dimensions	330 (L) x 260 (W) x 160 (D) mm
Weight	Approx. 2570g

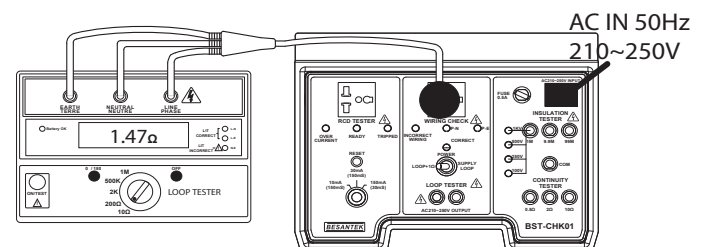
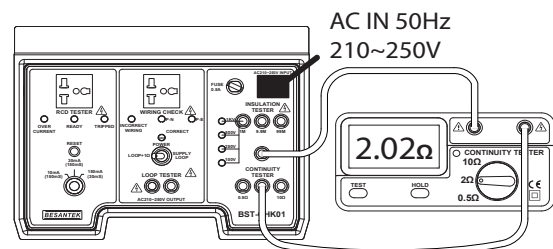
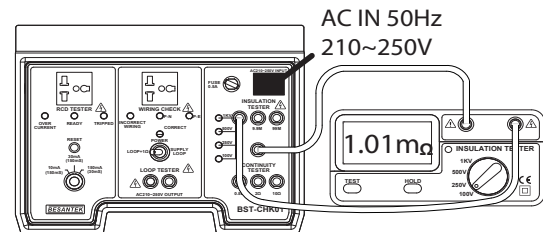
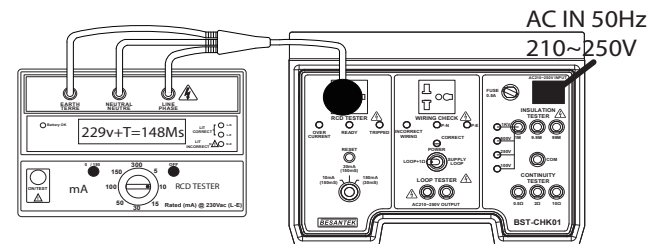

Ordering Information:

- BST-CHK01: Test Box.



Safety Standard:

- EN 61010-1, EN 61326-1