



Notions Box Instructions

1. Unpack your Kit

Each kit has the following items included:

- 1 - Unassembled box
- 2 - Adhesive backed magnets



2. Glue left & back panels to base

Place your box base on a flat surface. The base can go in any orientation you prefer. Take the left panel making sure that the hole is towards the back. Place glue along the indented side of the base and the left panel. Line up and hold until secured. Then, place glue along the indented sides of the back panel.

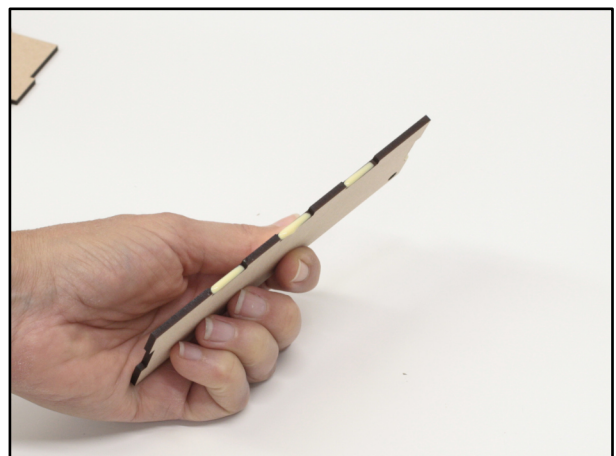
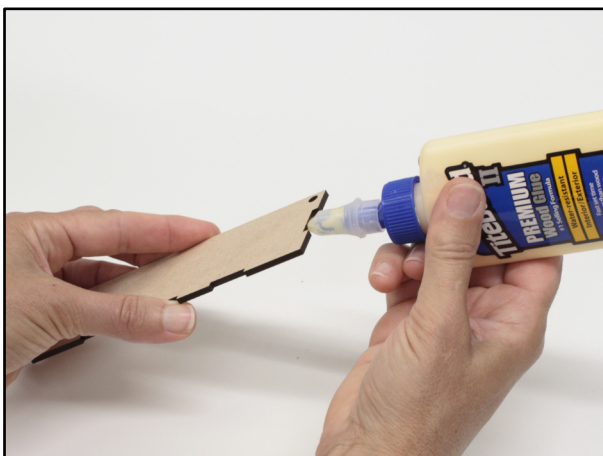
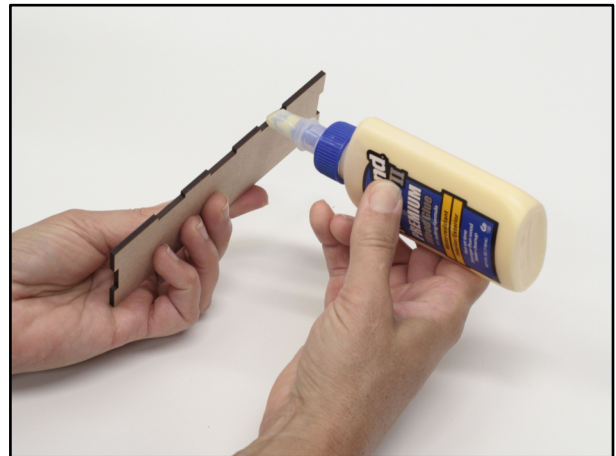

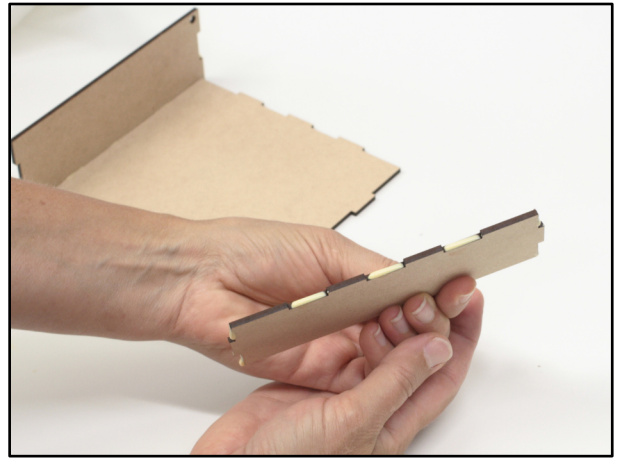
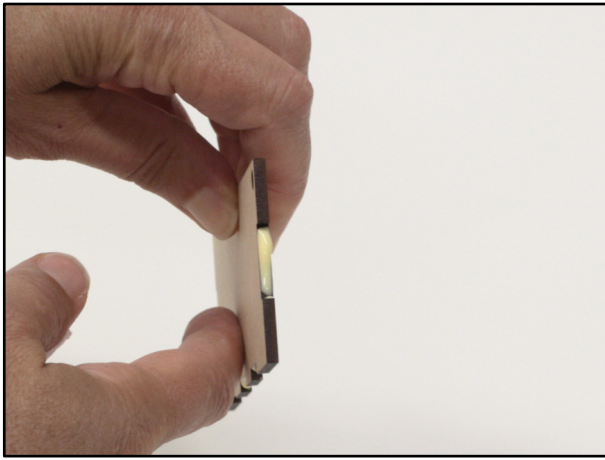

3. Place lid in holes & glue right panel

Place the tab on the lid through the hole on the left panel. Apply glue to right panel and line up, making sure the hole is towards the back. Place the other tab on the lid through the right panel. Let the lid rest on the base.



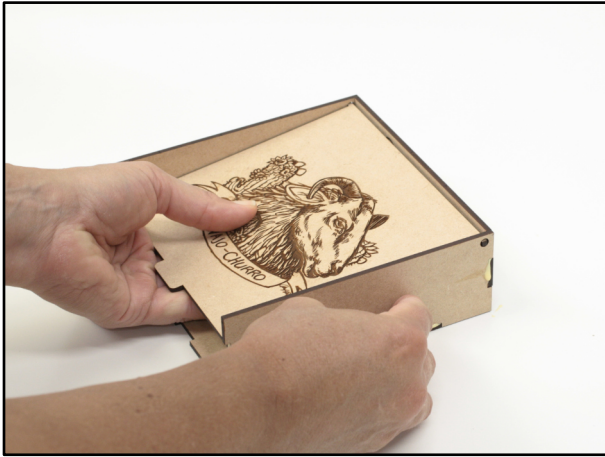

4. Glue front panel

Apply glue to the front panel. Lift up the lid and place front panel. Once front panel is in place, let the lid rest in the notch on the top of the front panel.



5. Clean off excess glue

Wipe off excess glue and let dry.



6. Attach magnets

Remove the paper covering the adhesive on the magnets. Magnets can be used to either secure the lid or you can place them anywhere in the box to secure sewing needles. To secure the lid, place one magnet centered below the notch on the front panel. Place the other magnet on the lid lining up with the magnet on the front. *Note: once magnets are applied please allow 24-36 hours for adhesive to reach full strength, you may want to keep the lid open for a day



Questions? Need help? Contact us at info@alpenglowindustries.com

Follow us!



@alpenglowind



@alpenglow@mstdn.social



@alpenglow.bsky.social