



4K UST Laser Projector Quick Start Guide

PE-LT002



4K
HDR

150"

0.233
Ultra Short Throw

Rec.709

dts HD

Dolby Audio

1

The Parishhone Venus 4K Projector and the projection area require a flat surface to produce an even image. In most cases, a distorted image is caused by an uneven surface such as a curved or textured wall.

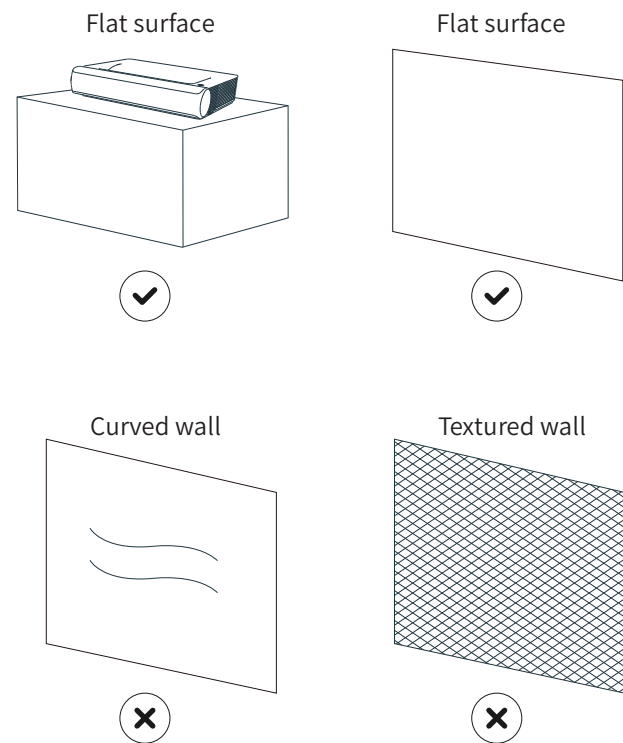

Leave enough cooling space (at least 11.8 inch on each side) for the projector.

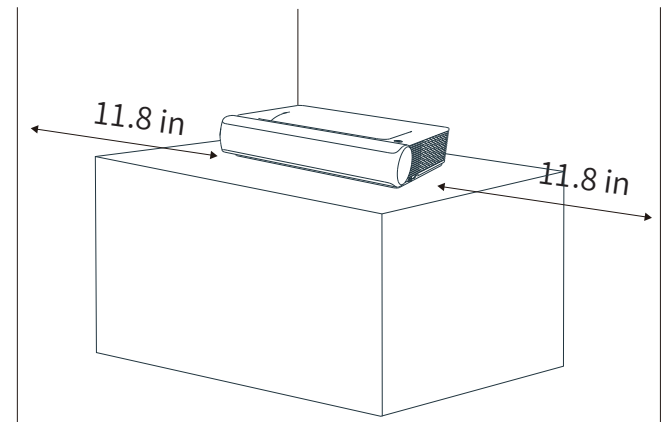

For optimal projection, it is recommended to use in a dark environment. A screen compatible with ultra short throw projectors can be used to enhance your viewing experience.

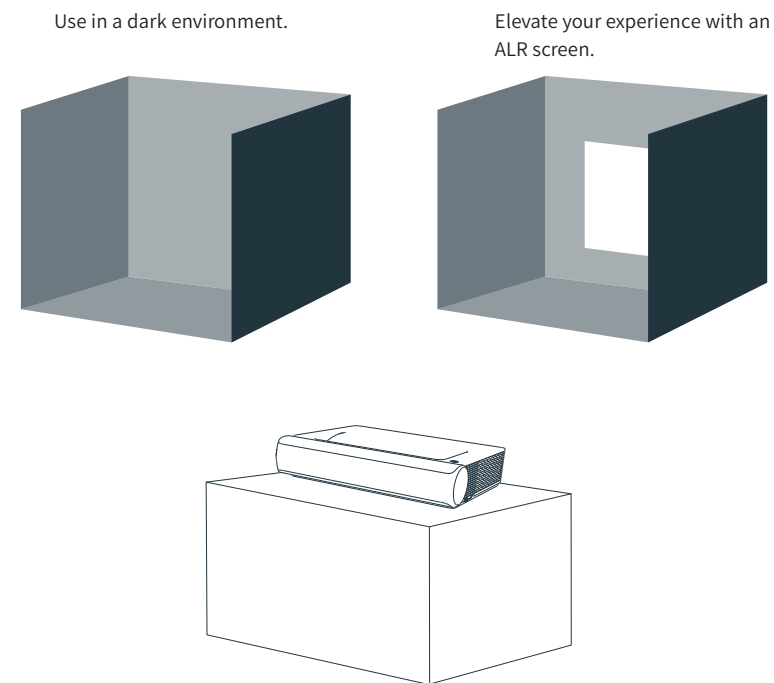

2

Select a system language (default: English). You can select Traditional Chinese, German, French, Italian, Spanish, Japanese, Portuguese, and Arabic.

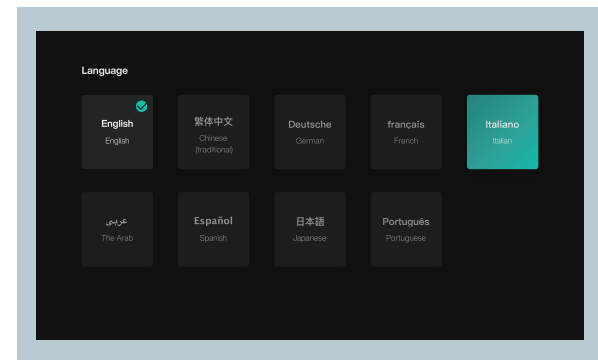

3

Press and hold the **Return** and **Menu** buttons simultaneously for 3 seconds to pair the remote control via Bluetooth. Make sure:
a) the batteries are installed in the remote control
b) the projector is turned on by pressing the power button
c) the remote control is close to the projector (within 5 meters)

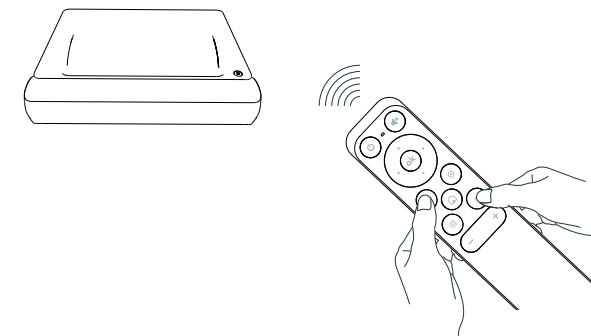
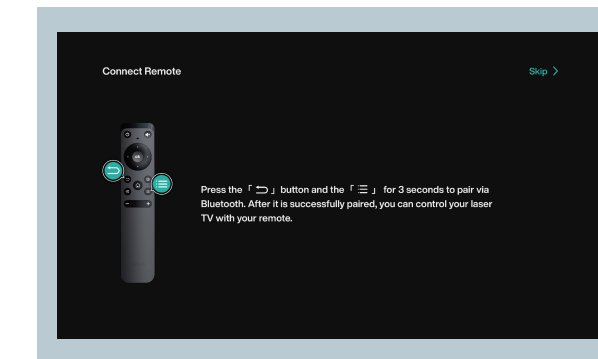

4

Choose and connect to your network of choice.

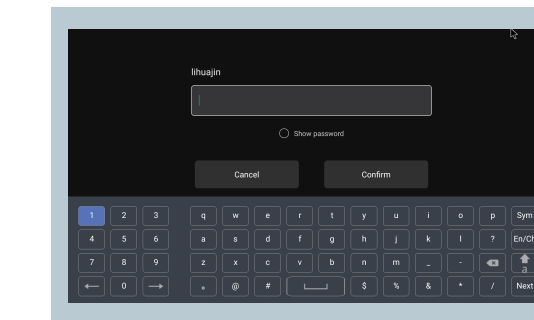



www.parishhone.co

Email

- US: support@parishhone.co
- JP: support.jp@parishhone.co
- DE: support.de@parishhone.co
- UK: support.uk@parishhone.co
- IT: support.it@parishhone.co
- FR: support.fr@parishhone.co
- ES: support.es@parishhone.co

Manufacturer: Shenzhen Danya Technology Co.,Ltd.
 Address: Room 3323, Building C, Galaxy World Phase II, Minle Community, Minzhi Street, Longhua District, Shenzhen

Made in China



5

Fine-tune the projection with Keystone Correction/Electric Focus.

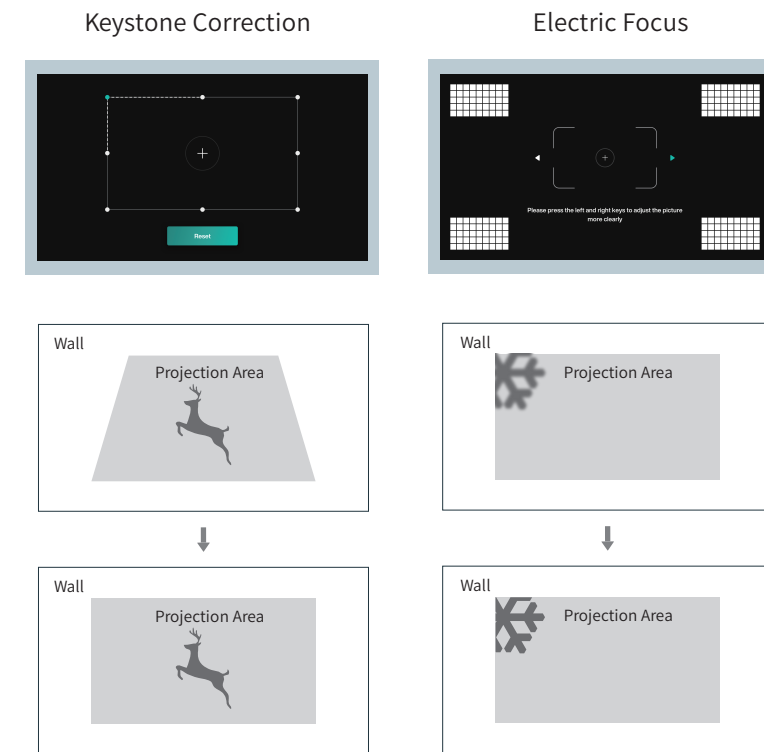

6

Select the time zone and format.

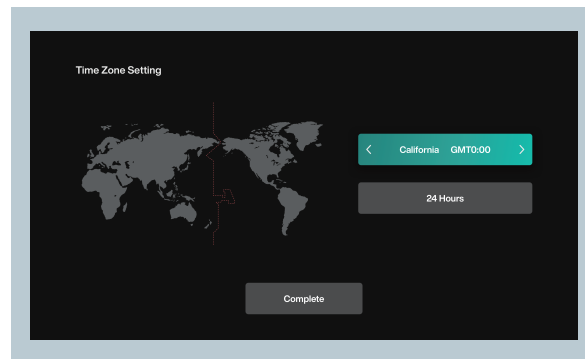

7

Then you can start viewing your files through the HDMI ports/USB ports or get apps from the App Store.

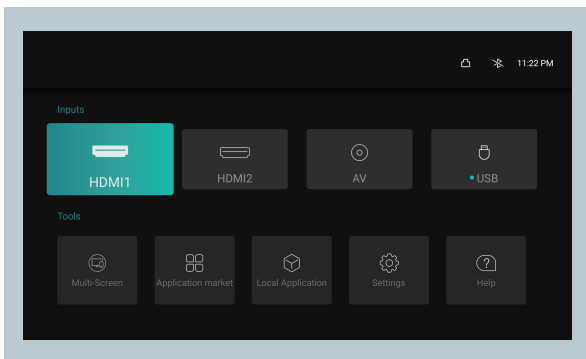

8

In the HDMI interface, press the Menu button to enter the submenu interface. Turn on HDMI 2.0 to support 4K 60 Hz output and HDR10.

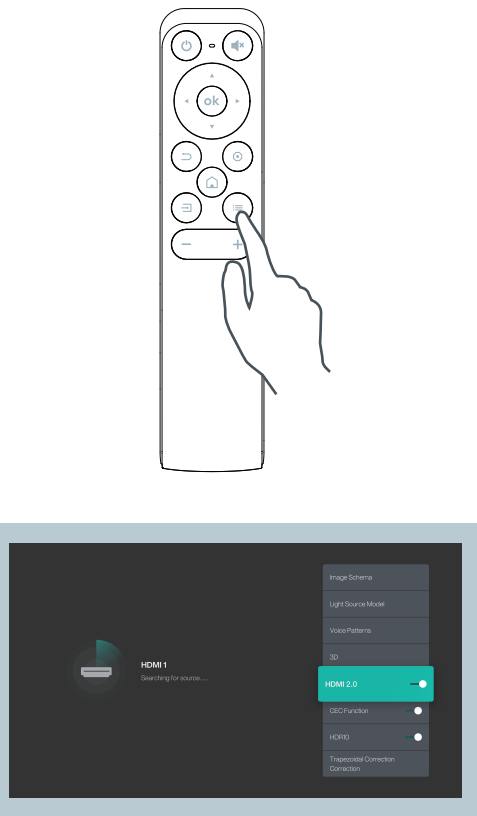

9

Most technical problems can be solved by rebooting the projector. Hold the Power button down until it turns off, then press once to turn on. If the problem persists, perform a Factory Reset: Go to Settings -> General -> Restore Factory Settings.

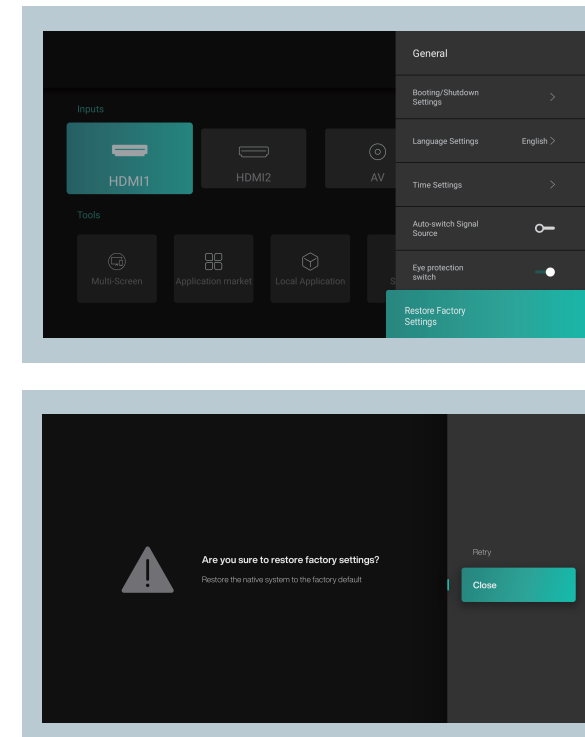

www.parishhone.co

尺寸：120*148mm

折页

材质：128克铜版纸