



ULTRASONIC WARM & COOL MIST HUMIDIFIER

PE-AH016
User Manual

Questions or Concerns?
support@parishhone.co

CONTENTS

IMPORTANT SAFETY INSTRUCTIONS	03
KNOWING YOUR HUMIDIFIER	05
USING YOUR HUMIDIFIER	11
CLEANING AND MAINTENANCE	13
TROUBLESHOOTING	15

01

IMPORTANT SAFETY INSTRUCTIONS

Soothing Mist for
Sweet Dreams



DANGER

BEFORE USING THIS APPLIANCE READ ALL INSTRUCTIONS AND CAUTIONARY MARKINGS IN YOUR USER MANUAL AND ON THE APPLIANCE

READ AND SAVE THESE INSTRUCTIONS



DO NOT touch or hold the mains plug with wet hands.



DO NOT block or cover the nozzle while in operation.



DO NOT let children or pets play with this appliance.

RELATED TO USE

- Always place this appliance on a firm, flat and level surface to avoid dropping or tilt.
- Always place this appliance 2 feet (60 cm) above the floor, 12 inches (30 cm) away from the wall or wooden furniture.
- DO NOT move this appliance while it is on.
- DO NOT attempt to repair any parts on this appliance. Doing so will void your warranty. The inside of this appliance contains no user serviceable parts. All servicing should be performed by qualified personnel only.

SPECIFICATIONS

Model	PE-AH016
Voltage	AC 100-120V 50/60Hz
Power	280W
Water Tank Volume	6.0L / 1.59Gal
Cold Mist Output	100ml/h (Low), 200ml/h (Medium), 300ml/h (High)
Warm Mist Output	200ml/h (Low), 450ml/h (Medium), 650ml/h (High)
Warm Mist Temperature	38°C/100°F(Low)
	46°C/115°F (Medium) 55°C/131°F(High)
Working Time on a Full Tank	10~60 H
Applicable Space	430-753 ft ² /40-70m ²

INTENDED USE

- This appliance is not intended for use by people who have reduced physical, sensory or mental capabilities or lack knowledge to use this appliance unless they are given supervision or instruction by a responsible person.
- Use this appliance only for intended household purposes as described in this User Manual.

ELECTRICITY SAFETY

- To avoid fire hazard, NEVER put the cord under rugs, near heat registers, radiator, stoves, or heaters.
- DO NOT use this appliance if the cord has been damaged to avoid fire or electric hazard.
- Keep the cord out of heavy traffic areas and where it will not be tripped over.

02

KNOWING YOUR HUMIDIFIER

Soothing Mist for Sweet Dreams

Packing List

- 1 x Paris Rhône Ultrasonic Warm & Cool Mist Humidifier
- 3 x Aroma Pad (1 pre-installed)
- 3 x Dustproof Sponge (1 pre-installed)
- 3 x Mineral Absorption Pads (1 pre-installed)
- 1 x Remote Control
- 1 x CR2025 Type Lithium Battery (Installed in the Remote Control)
- 1 x User Manual

Product Diagram

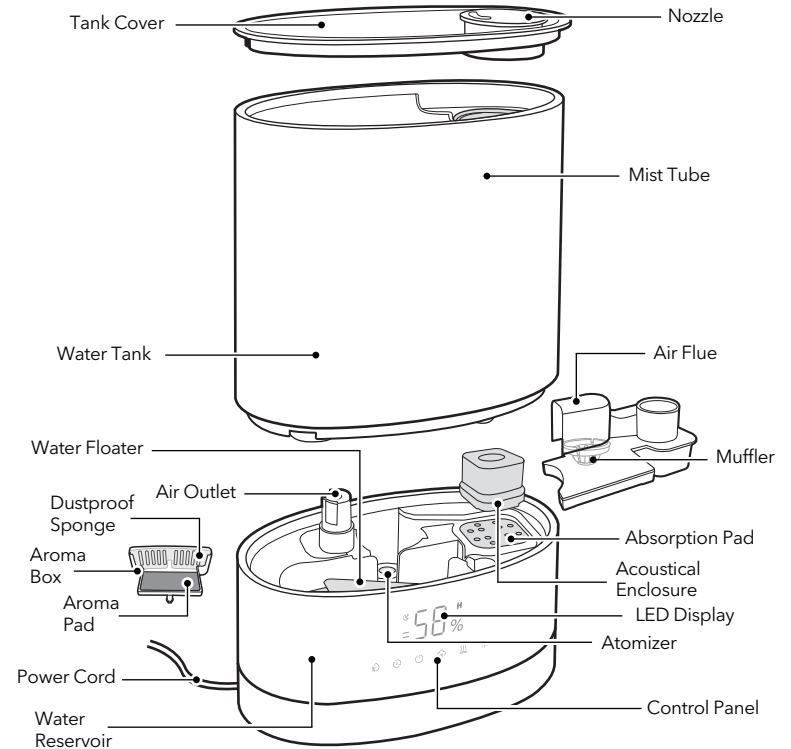

03

USING YOUR HUMIDIFIER

Soothing Mist for Sweet Dreams

Control Panel



Constant Humidity

- Tap to set the desired constant humidity. (ranges: 30%-90%)
- Long press to deactivate constant humidity.



Auto Mode/Sleep Mode

- Tap to enter/exit auto mode.
- Long press to enter/exit sleep mode.



Power ON/OFF

Tap to power on/off.



Mist Level Adjustment

Tap to select low/medium/high mist levels.



Warm Mist

Tap to activate/deactivate warm mist.



Night Light

- Tap to cycle through ON (Medium Brightness) and OFF.
- Long press to select High/Low Brightness.

LED Display



Sleep Mode



Humidity/Time



Mist Level
(High/Medium/Low)

Remote Control

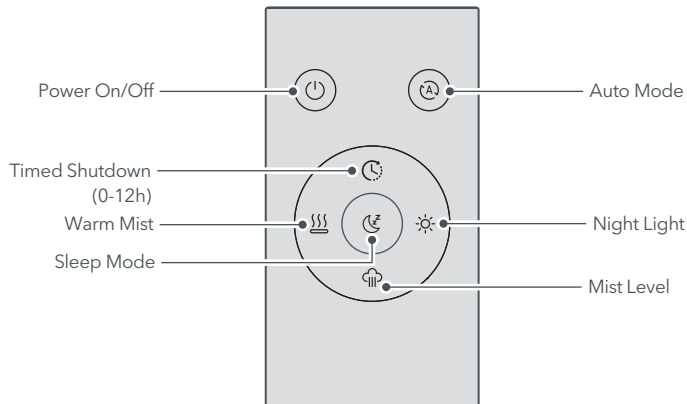

Additional Features



Memory Function

The humidifier is designed with power-off memory function. Without power interruption, it will remember your last settings (except timer setting and sleep mode) once you power it on again.



Tank Lift-up Protection

The humidifier will auto shut down in case that the tank is lift up. After putting it back, it will restart working.



Low Water Protection

The humidifier will auto shut down because of insufficient water. After refilling, it will restart working.

GETTING THE MOST FROM HUMIDIFIER

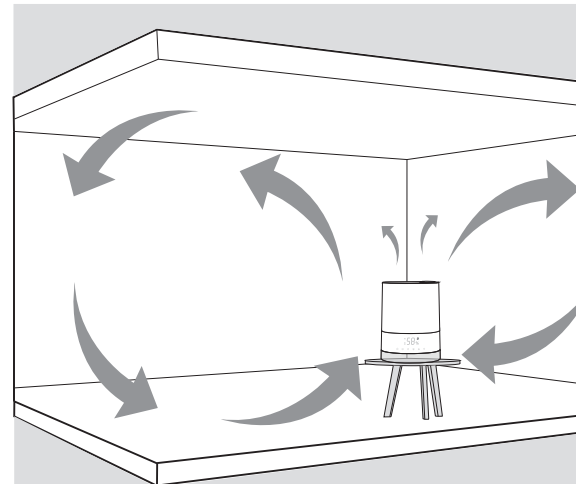

Tips:

Closing doors and windows is conducive to reaching the desired humidity.

Getting Started



- Do not directly drip essential oil into water tank.
- Do not let water enter mist tube to avoid the damage to this appliance.
- Twisting the nozzle can adjust the direction of mist.
- Medium-level warm mist will be activated by default when this appliance is turned on again after power interruption.

1.

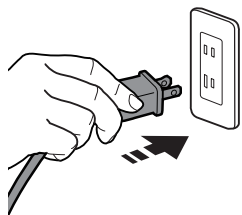

Connect this humidifier to a power source, it will enter standby mode. The LED display and night light will be on for 2 seconds then off.

2.

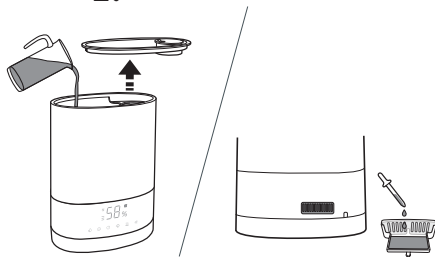

Filling Water

Remove the cover, and fill the water not exceeding the mist tube.

Adding Essential Oil

1. Press the essential oil tray to pop it up.
2. Drip some essential oil on the aroma pad.
3. Push back the essential oil tray until securely locked into place.

Note:

- When constant mode is activated, the humidifier will auto enter standby mode at the preset humidity and auto start working at lower than 5% of the preset humidity.
- When auto mode is activated, the humidifier will auto enter standby mode at 65% humidity and auto start working at lower than 60% humidity. Low, medium or high mist level will be activated automatically based on the environmental humidity.
- The LED display will be off in sleep mode. Tap any button to light it up.

Replacement of Batteries



- Replace with new batteries of the same type when replacement is required.
- When not using the remote control for a long time, please take out the batteries.
- DO NOT attempt to dismantle the batteries.
- DO NOT dispose the batteries in fire, batteries may explode or leak.
- DO NOT use rechargeable batteries.

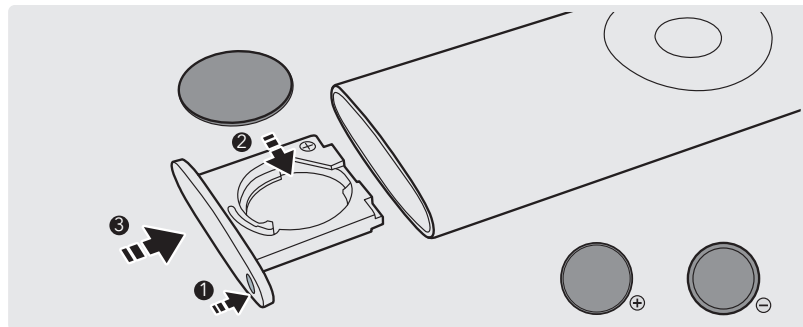

- 1 Press the locking button to pop up the battery holder.
- 2 Replace the battery with the same type (CR2025, 3V), making sure the (+) side facing up.
- 3 Push in the holder until securely locked into place.



WARNING:

Do not ingest battery, Chemical Burn Hazard.

This product contains a coin/button cell battery. If the coin/button cell battery is swallowed, it can cause severe internal burns in just 2 hours and can lead to death. Keep new and used batteries away from children. If the battery compartment does not close securely, stop using this appliance and keep it away from children. If you think batteries might have been swallowed or placed inside any part of the body, seek immediate medical attention. The batteries contain materials, which are hazardous to the environment; they must be removed from the appliance before it is scrapped and that they are disposed of safely.

04

CLEANING AND MAINTENANCE

Soothing Mist for
Sweet Dreams



- Before cleaning, turn this appliance off and unplug it.
- Do not let water splash into the air outlet.



- Remove the water tank and its cover to rinse under tap water.
- Fill some white vinegar or lemon water in the reservoir and let it sit for about 15 minutes, then descale with a cleaning brush.



- Wipe dry with a clean, soft cloth or paper towel.
- Store it in a cool, dry location when not in use for long.

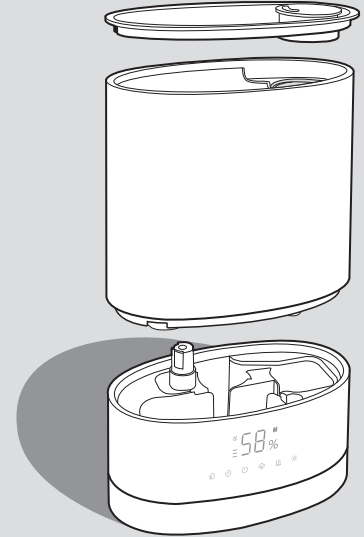

05

TROUBLE-SHOOTING

Soothing Mist for
Sweet Dreams

Remote control is not working.

- Make sure this appliance is connected to a powered electrical outlet.
- Remove the insulating pull tabs prior to use.
- Check that the remote control is powered on and move the obstacles between this appliance and the remote.
- Operate the remote control near or in front of this appliance.

The humidifier does not work.

- This appliance will auto shut down if water is insufficient.
- The water tank isn't well assembled.
- In auto mode, this appliance will enter standby mode at 65% humidity.
- When constant humidity is activated, this appliance will enter standby mode at preset humidity.

There is no air humidification.

- Air inlet/outlet is blocked.
- The water in water reservoir is nearly used up.
- Your room might have too much ventilation. Close doors and windows.

The mist produces an unpleasant smell.

- Change water regularly to avoid hard water deposits.
- Clean this appliance, and leave it at a shady and cool place for 12 hours with the cover detached.

The auto mode is not available.

Water has entered the sensor. In this case, the medium mist level will be activated automatically. 2-8 hours later, auto mode will be available. If not, unplug this appliance and contact Paris Rhône Customer Support.

The troubleshooting guide addresses the most common problems. If problems persist, feel free to contact the Customer Support at

support@parisrhone.co



WARRANTY

Thanks for choosing Paris Rhône Humidifier.

This product is covered with Paris Rhône product and labor warranty for 12 months from the date of its original purchase.

The warranty will not apply in cases of:

- Misuse, dismantling, or repairs performed by unauthorized personnel.
- Any appliance that has been tampered with or used for commercial purpose.
- Use of force, natural hazards, damage caused by external influences.
- Damage caused by non-observance of the User Manual, e.g. connection to an unsuitable mains supply or non-compliance with the instructions.
- Partially or completely dismantled appliances.
- Defects caused by or resulting from damages from shipping or alteration to the product or any of its parts that have been performed by unauthorized personnel.

We can only provide after-sales service for products that are sold by Paris Rhône or Paris Rhône authorized retailers and distributors. If you have purchased your appliance from a different place, please contact your seller for return and warranty issues.

※ **Please have your invoice and order ID ready before contacting Customer Support.**

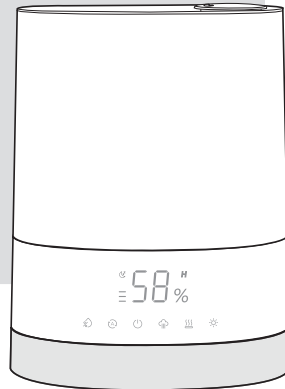

FCC Compliance

This instrument complies with Part 18 of the FCC Rules. Operation is subject to the following two conditions:

- (1) this device may not cause harmful interference, and
- (2) this device must accept any interference received, including interference that may cause undesired operation.



Manufacturer: Shenzhen NearbyExpress Technology Development Co.,Ltd.
Address: Floor 7, Building E, Galaxy World Phase II, Shenzhen, China



support@parishhone.co



www.parishhone.co



MADE IN CHINA

尺寸：120*160cm

装订成册

材质：封面120克铜版纸
内页80克书纸