



1300 736 330
www.medescan.com.au

Visit our YouTube channel for our latest easy to follow instructional videos. Simply search for Medescan on YouTube and subscribe to our channel for the latest products and instruction videos.
You can also scan the QR code for instant access.



Life cycle of product is three years
VER: 351N4FB-20220120-V01

Designed in Australia
Made in China



HEARING AID

Instruction Manual Model: JH-351

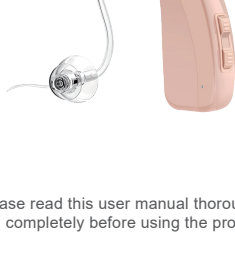

Please read this user manual thoroughly and completely before using the product.

Please read the instructions carefully before operating the product.

Thank you very much for buying our hearing aid. When you see film, watch the play, have meeting, or have classes, the product can help you to hear the sound clearly and loudly. While in forest, if you want to hear very slight sound, it will be a good choice. Please read the instructions carefully before operating the product.

1. NOTICE

- 1.1 What is the hearing loss?
A speech frequency puretone average (average of hearing thresholds at 0.5, 1, 2, and 4 kHz) of greater than 25 dB hearing level (HL) in both ears was defined as hearing loss per World Health Organization criteria, and this is the level at which hearing loss begins to impair communication in daily life. (Extracted from the literature of: World Health Organization prevention of Deafness and Deafness(PBD) program. Prevention of Deafness and Hearing Impaired Grades of Hearing Impairment)
- 1.2 What is the hearing aid?
Jinghao hearing aid was used the air-conduction type to compensate of impaired hearing. It is a wear sound-amplifying device. The fundamental operating principle of hearing aid is to receive, amplify, and transfer sound to the ear drum of a hearing impaired person.

01

II. INTENDED USE

- 2.1 Medical purpose
The hearing aid was intended to compensate of impaired hearing.
- 2.2 Intended patients and environment
The hearing aid expect used indoor and outdoor environment, any patients if need hearing compensated decided by doctor can be using but the patients must over than 36 months old.
- 2.3 Side effects
- For the patients skin sensitive with silicon material, may be caused the ear canal pruritus.
- First use may cause ear canal appear temporary maladjustment, such as slight pain.

III. IMPORTANT SAFETY INSTRUCTIONS

Read all the information in the instruction manual and any other literature included in the case before use the device.

- 3.1 CONTRAINDICATION ⚠ Warning
The device is unsuitable and should not be used in the following situations:
- Patients with chronic suppurative otitis media, congenital ear atresia to banned use;
- This hearing aids only be used for compensating the patients with hearing impairment, do not have hearing therapeutic value.
- The hearing aids can not be used by infants under 36 months old.

02

3.2 WARNINGS ⚠ Warning

- Keep small parts (hearing instrument, battery and detachable parts) that can be swallowed out of children's reach. Dropping, immersing in liquid, strong electromagnetic fields or excessive heat will damage the hearing aids. If parts remain in the ear, please go to see a doctor as soon as possible, do not take it out by yourself.
- 3.3 Notice ⚠ Warning
- Do not use it at high volume for long time. Otherwise it will injure your ear. If you feel uncomfortable, please stop using.
- Please maintain the products all the time, avoid ear plug and sound collecting hole being blocked by foreign objects. It will affect the effect of sound amplifier.
- Avoid shocking, falling the product. Do not keep or use it in environment of humid of high temperature (such as sauna room), to avoid damage the hearing aids.
- Do not throw the scrapped battery as common rubbish, it should be handled by special equipment, to avoid pollute the environment.
- Do not use the product in potential explosive or dangerous environment, to avoid damage the hearing aids.
- Keep the unit away from the children. It will injure him or others, or damage the unit.
- Do not use in an oxygen rich environment, and continue use hearing aids long time, it may damage the device.

03

- Do not set volume levels too high. Listening for extended periods at high volume levels can cause further hearing damage. Special care must be taken because this hearing aids is a high-output type.
- Do not lend your hearing aids to other persons. Using a hearing aids designed for someone else can result in hearing damage.
- Monitor any unusual skin reaction. In some instances, wearing a hearing aids can cause an allergic reaction leading to itchiness or rashes. If you notice any unusual skin condition, stop wearing the hearing aids and see a medical specialist.

- Do not touch the hearing aids to the magnetic thing. Hearing aids may be broken when it is touched to the magnetic thing.
- Be sure to take off the hearing aids when getting a diagnosis or treatment of follows (If you get them with hearing aids worn, hearing aids is broken and is not activated.)
- Do not touch the inside. The inside of the hearing aids contains many delicate parts that are precision adjusted. Never pry the inside of the hearing aids with a needle or similar object, otherwise it will damage the device.

- Do not place in a hot or humid location. You should never leave your hearing aids near heating appliances or in direct sunlight, and you should also avoid humid locations such as bathrooms or near a humidifier, otherwise it will damage the device.
- In a closed car in summer, the temperature can rise to very high levels. Do not leave your hearing aids in a car, otherwise it may damage the device.

04

- Do not use the hearing aids together with a cell phone, otherwise it may increase the noise and affect the sound quality.
- Radiowave emissions from mobile phones can cause noise in the hearing aids or result in reduced volume.
- Please contact the MANUFACTURER:
• for assistance, if needed, in setting up, using or maintaining the HEARING INSTRUMENT; or
• to report unexpected operation or events.

3.4 Specific warnings

Specific warnings / statements
Warning to keep small parts out of children's reach, to avoid swallow the small parts.
Warning not to use in explosive or oxygen-enriched atmospheres, it may damage the device.
Warning that it must only be used by intended person.
Using a hearing aids designed for someone else may result in hearing damage.
Statement about the special needs of particular Patient groups
Warning about common conditions that could damage the device
Warnings that result from the risk management file
Permissible environmental conditions of transport and storage
Each warning/safety contains: nature of Hazard; likely consequences; precautions

05

IV. Contraindications

- Congenital atresia of external ear or deformity of external auditory meatus, a large amount of foreign bodies in external auditory meatus;
- Deafness is unstable, and the degree of hearing loss often fluctuates;
- Complaint with headache, dizziness, earache, tinnitus and other symptoms that are not suitable for adaptation;
- Sudden deafness in the past 3 months; progressive rapid deafness; obvious unilateral deafness or other acute ear disease;
- Effusion in the middle ear and frequent purulence;
- Central deafness; non-organic deafness;
- Patients with acute otitis externa and tympanitis;
- Patients with acute and chronic suppurative otitis media (in the period of purulent infection);
- Patients who are allergic to the material of this product.

IV. Matters needing attention, warnings and tips

- Before fitting the hearing aid, it should go through professional inspection and hearing test, and use it under the guidance of a doctor or a professional fitting technician of hearing aid.
- Pay attention to moisture, shock and high temperature of the product.
- Do not immerse the hearing aid in any liquid. Remove the hearing aid before swimming and shampooing. After swimming or washing, wait for the ear canal to dry before wearing the hearing aid.
- After removing the hearing aid at night, it should be

06

- placed in a case with a desiccant, protected from light, high temperature and high humidity environment, and avoid falling.

5. The external surface of the hearing aid should be kept clean, and the earwax in the earplugs should be cleaned frequently.

6. The function and volume control switch should be used correctly, open and close as lightly as possible, to avoid excessive force and excessive force.

7. Hearing aids should be regularly sent to the fitting center for maintenance and inspection to ensure that the hearing aids are in good condition.

8. If you feel uncomfortable ears during use, please stop using immediately.

9. Please do not put the hearing aid in the reach of infants and young children. If swallowed accidentally, please consult a doctor immediately.

10. Applicable objects: Suitable for people with air-conducting hearing loss of about 30-50dB.

11. Please use hearing aids with hearing aid charging cases.

12. When you do not use hearing aids, please charge the product regularly to avoid battery damage; the recommended charging time interval of hearing aids is ≤28 days;

07

V. KNOW YOUR DEVICE

【Accessory List】

- Hearing Aids: 1 Earplug: 3
Cleaning Tools: 1 Manual: 1
USB Cable: 1 Ear tube(Left & Right): 1

Adapter Specification:
Input: 100-240VAC 0.2A 50/60Hz
Output: 5V \pm 200mA
Not included in the package

- A. Long Press: Switch ON/OFF
Short Press: Change Mode
B. Volume +
C. Volume -



08

If howling happens, please check whether the hearing aid is worn according to the right steps. If the operation is correct but the howling still exists, please switch with bigger size of earplug. The knob can switch the power as well as the volume, and please turn it off when not use.

【Fault self-check】 project	Possible Causes	Solution
Hearing aid has no sound	The button time is too short to start Battery is dead Plugging out the mouth or microphone	Long press the "volume button" for 3 seconds, restart Connect the hearing aid to the charging case for charging Clean the sound port or microphone port
The voice is very weak and unclear	Low battery The volume is too low Earplugs loose	Connect the hearing aid to the charging case for charging Turn up the volume Re-wearing the hearing aid

Table 3: Hearing aid failure self-checking table

09

【How to use hearing aids】

Charging three steps

- The device will be turned off automatically to make for a faster charging time. It's recommended that you turn off the hearing instrument when it's not in use.
- Long press the memory switch button to turn on the device when you want to use the device.
- Charging finished, will turn to GREEN LIGHT.

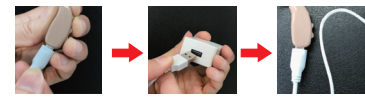

10

Inserting

- Choose one of the three different sizes of earplugs that fits your own, and attach to the end of the sound tube with the connector.

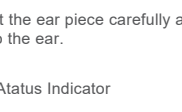

- The other end of the sound pipe is fitted to the ear hook of the host.
2) Carefully push the ear piece in the ear canal

Note: Insert the ear piece carefully and not too deeply into the ear.

Charging Atatus Indicator

- Charging process
- Charging finished

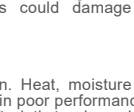

11

VI. MAINTENANCE AND CLEAN

- 6.1 Daily maintenance
It is important to keep your instrument clean and dry. On a daily basis, clean the hearing instruments using a soft cloth or tissue. In order to avoid damage due to humidity or excessive perspiration, the use of a drying kit is recommended.

- 6.2 Care and maintenance
Put it in where children could not reach, dry and no exposed in the sun.
Do not place hearing aids near high-temperature heating areas such as stoves.
Do not leave the microphone in a humid place for a long time.
Do not scratch the microphone with sharp objects to damage to the microphone.
Do not disassemble or attempt any repairs by yourself. Ask the dispenser for repair.

- 6.3 Cleaning
1) Cleaning the earplug
Remove ear wax plugged in the earpiece using stick and brush.

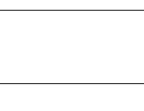

12

- 2) Cleaning hook
Using a soft cloth or tissue wipe off any moisture, perspiration, or debris from the surface of the hook.

Note: Do not use alcohol or other cleaning solvents to clean the hook as this could damage the protective covering.

VII. HEARING aids CARE

Keep your hearing aids clean. Heat, moisture and foreign substances can result in poor performance.

- Use a cleaning brush or soft cloth to clean debris from around the user control, microphone and battery compartment; regularly the receiver, earbud or earplug and wax guard insely.
- Never use water, solvents, cleaning fluids or oil to clean your hearing aids.
- Charging contacts should always be kept clean and dry.

Your hearing professional can provide further information on additional maintenance procedures for your hearing aids, if needed.

Helpful Hints

- Do not take apart your hearing aids or insert the cleaning tools inside them. •When not in use, place your hearing aids in the charger and store.
- In a dry, safe place
- Away from direct sunlight or heat to avoid extreme temperatures
- Where you can easily find them

13

-Safely out of reach from children and pets

Synergy Charger Care
•Keep your charger clean. Heat, moisture and foreign materials can result in poor performance.
-Using the provided cleaning brush keep the charging ports clear of debris.
-Do not use water, solvents or cleaning fluids to clean the charging ports.
-Keep lid closed as much as possible to avoid dust and debris build up.

-Store your charger in a clean and dry location, i.e. a dresser or shelf rather than the bathroom or kitchen.
-To ensure the longest life of your rechargeable hearing aids batteries and the batteries in the charger.
-Fully charge hearing aids batteries every night.

Service and Repair
If, for any reason, your hearing aids and charger do not operate properly, do NOT attempt to fix it yourself. Not only are you likely to violate any applicable warranties or insurance, you could easily cause further damage.
Should your hearing aids and charger fail or perform poorly, check the guide on the next page for possible solutions. If problems continue, contact your hearing professional for advice and assistance. Many common problems may be solved in your hearing professional's office or clinic.

14

Troubleshooting Guide

SYMPTOM	POSSIBLE CAUSES	SOLUTIONS
Not Loud Enough	Blocked tubing/earbud	Wax or replace wax guard as needed
	Hearing change	Contact your hearing professional
	Debris buildup	Clean both microphone and receiver with brush
Inconsistent Performance	Restart required	Place in charger until charging begins and remove -this will power cycle your hearing aids
	Blocked tubing/ earbud	Clean or replace wax guard as needed
Unclear, Distorted Performance	Restart required	Place in charger until charging begins and remove-this will power cycle your hearing aids
	Blocked tubing/ earbud	Clean or replace wax guard as needed
	Defective hearing aids	Contact your hearing professional
Dead Hearing aids	Charge required	Place in your charger the LEDs will become solid

15

Dead Hearing aids	Blocked earbud/tubing	Clean or replace wax guard as needed
	Crimped tubing	Contact your hearing professional
No LED indicator when hearing aids are inserted into the charging port	Incorrect orientation	Connect the micro USB to your charger and plug it into the wall. The on-board battery LEDs will turn on for a few seconds to indicate connection to the power source. If they do not, contact your hearing professional.
	Dead battery	Reposition your hearing aids in the port with the earbud resting in charger reservoir.
Red blinking LED by charging port	Fault occurred	Remove the hearing aids from the charging port, wait until the LED turns off, reinsert. If the red blinking LED persists, contact your hearing professional.
While charging cordless, no LEDs are illuminated	Power off	To refresh LEDs, remove a hearing aids from the charging port for 3 seconds and then reinsert into the charging port. Both the charging port LEDs and the on-board battery LEDs will illuminate after turn it on.

16

Hearing aids whistling in the charger	Incorrect orientation	Turn off the hearing aids. Reposition your hearing aids in the port with the earbud resting in the charger reservoir. Confirm that the charging LED begins to glow.
	Dead battery	Your charger's on-board battery has died. Plug your charger in. If you do not have the cord with you, push and hold the hearing aids's rocker switch for 3 seconds to turn it off. This will conserve the charge in your hearing aids.

17

Please review the following simple communication tips:
For You
•Move closer to and look at the speaker
•Sit face-to-face in a quiet room
•Try different locations to find the best place to listen
•Minimize distractions
•Background noises may be frustrating at first; remember, you have not heard them for a while
•Let others know what you need; keep in mind that people cannot "see" your hearing loss
•Develop realistic expectations of what your hearing aids can and cannot do
•Better hearing with hearing aids is a learned skill combining desire, practice and patience

For Your Family and Friends
Your family and friends are also affected by your hearing loss. Request that they:
•Get your full attention before beginning to speak
•Look at you or sit face-to-face in a quiet room
•Speak clearly and at a normal rate and level; shouting can actually make understanding more difficult
•Rephrase rather than repeat the same words; different words may be easier to understand more difficult
•Rephrase rather than repeat the same words; different words may be easier to understand
•Minimize distractions while speaking

18

IX. TECHNICAL SPECIFICATION

Model	JH-351N
Output_OSPL _{Le} Max.	≤115+3dB
FOG50 MAX Gain	≤42+3dB
EQ Input Noise	≤29dB+3dB
Frequency Range	400Hz-4500Hz
Battery Current	≤2mA
Total Harmonic Distortion	≤7%+3%
Rated Voltage	D.C 3.7V
Operating temperature/humidity	0°C~40°C(32°F-104°F) ≥30%RH, ≤75%RH
Storage temperature/humidity	-10°C~+55°C(14°F-131°F) ≥10%RH, ≤90%RH

Notes:

This hearing aid is produced under the strict quality system of Huizhou JINGHAO of Medical Technology Co., Ltd.

The device fulfills the provisions of the EC directive 93/42/EEC (Medical Device Directive) and the Harmonize Standard as IEC 60601-1, IEC 60601-2-66, IEC 60118-7, IEC 60118-13, EN ISO 10993-1/-5/-10 and EN ISO 14971.

19

X. NORMALIZED SYMBOLS

	Follow operating instructions
	B type applied part
	Disposal in accordance with Directive 2002/96/EC (WEEE)
	Complies with the European Medical Device Directive (93/42/EEC and amended Directive 2007/47/EC. Notified Body is SGS Belgium.
	Manufacturer information
	Date of manufacture
	Serial number
	Warning/ Danger: Improper use might cause serious injuries.
	IP code of the device: this device's grade of against ingress of solid foreign objects – the access probe of $\geq \varnothing 12.5\text{mm}$ shall not penetrate; the grade of waterproof is vertically falling drops shall have no harmful effects.
	Permissible storage and transport temperature and humidity
	Permissible operating temperature and humidity

20

XI. MAINTENANCE, STORAGE AND DISPOSAL

- 11.1 Maintenance
1) We do not authorize any institution or individual to maintain and repair of the product. If you suspect that the products have any questions, please contact the manufacturer or distributor to handle the case.
2) The user must not attempt any repairs to the device or any of its accessories. Please contact the retailer for repair.
3) The operation of the equipment by un-authorized agencies is not allowed and will terminate a warranty.
warning: No modification of this equipment is allowed!

- 11.2 Storage
1) If you Do not use it, turn off the hearing aid, take out the batteries, and then put into the storage case.
2) Do not put the device under the sunshine, high temperature and moist environment or someplace which maybe get in touch with fire or is vulnerable to vibration.
3) Keep the device storage in following environmental ranges:-10~55 C, ≤95%RH, 700-1060hPa

- 11.3 Disposal
Please dispose of the device in accordance with the directive 2002/96/EC – WEEE (Waste Electrical and Electronic Equipment). If you have any queries, please refer to the local authorities responsible for waste disposal.

21

XII. GUARANTEE

We grant you a lifetime guarantee after the date of purchase for two year. Any damage caused by improper handling shall not be covered by the guarantee. Batter and packaging are also excluded from the guarantee. All other damage claims excluded. A guarantee claim must be submitted with the purchase receipt. Please pack your defective instrument well and send with sufficient postage to the distributor.

22