

# xtrovac 100

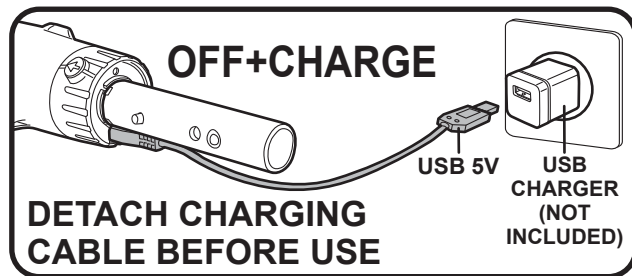
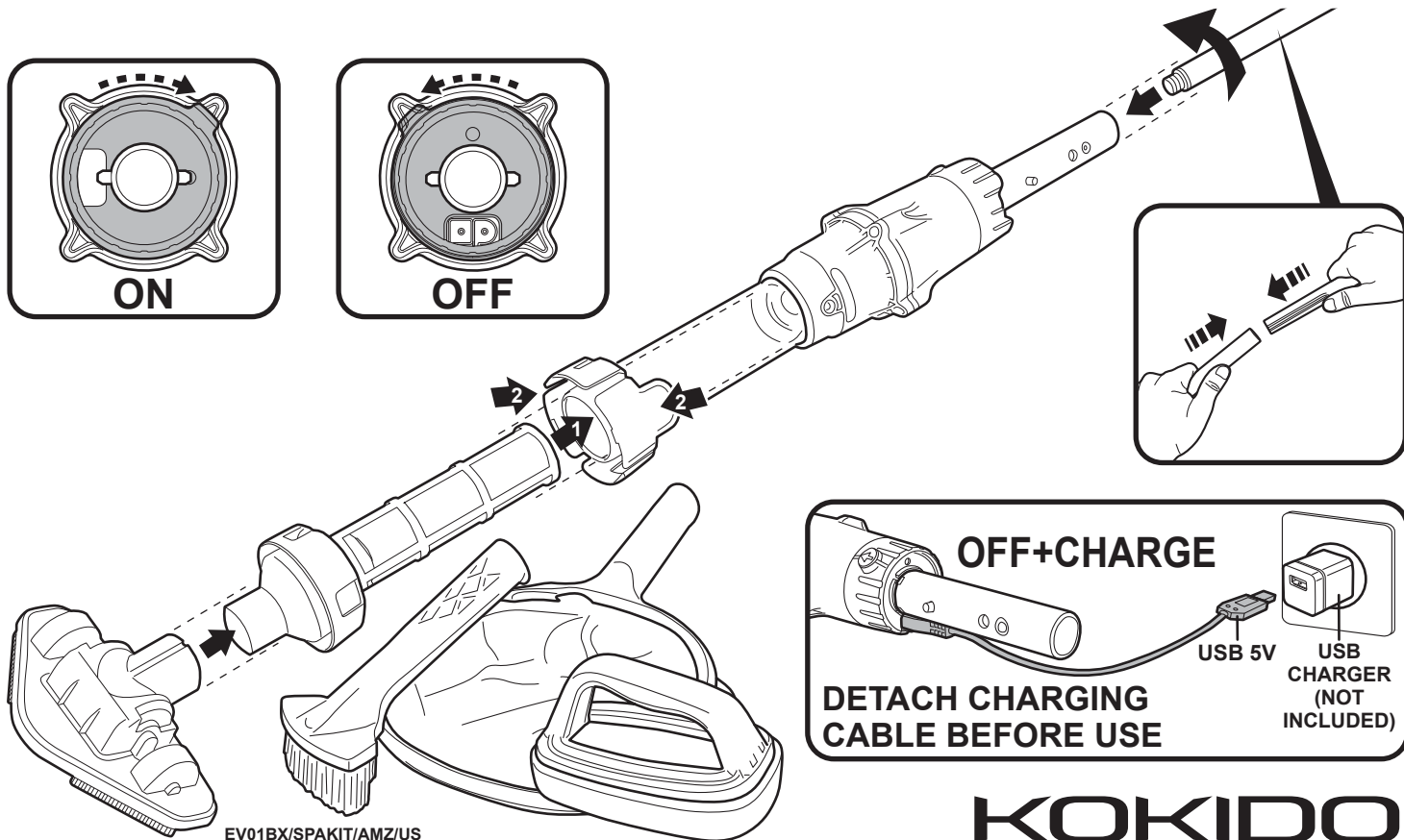
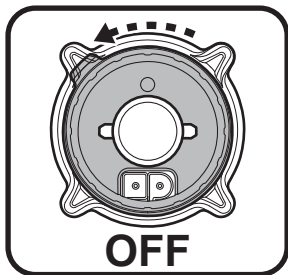
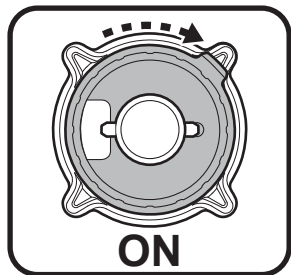

# KOKIDO

## **Customer service info:**

Tel: (866) 683-7672

E-mail: [support@kokido.com](mailto:support@kokido.com)

## **WARNINGS & CAUTIONS**

- 1. Ensure the spa/pool filtration system is OFF 15 mins before using the vacuum.**
- 2. Keep the Spa/Pool Vacuum Cleaner out of reach of children or persons with reduced physical, sensory, or mental capabilities, or lack of experience and knowledge, unless they have been given supervision or instruction.**
- 3. Use only the original charger supplied with the spa/pool vacuum and manufactured by Kokido.**
- 4. Charge and store the vacuum in a shaded dry area.**
- 5. Prior to connecting the charger for charging purposes, verify that the connector and socket are dry and clean.**
- 6. Before operation, disconnect the charging cable.**
- 7. Make sure the spa/pool vacuum is fully immersed in the spa/pool before initiating operation.**
- 8. Under no circumstances should you attempt to disassemble the spa/pool vacuum. Doing so would void the warranty.**
- 9. Do not enter the spa/pool while the spa/pool vacuum is working.**
- 10. The spa/pool vacuum must be charged before storage.**