

Assembly Instruction Manual



Top frame
1 No.



Table bottom wooden plank
1 No.

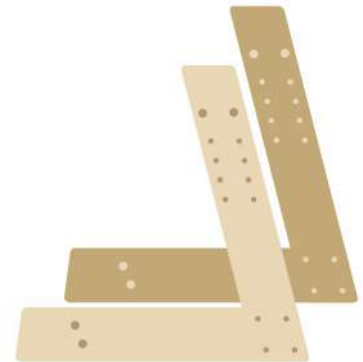

Desk side frame
2 Nos.

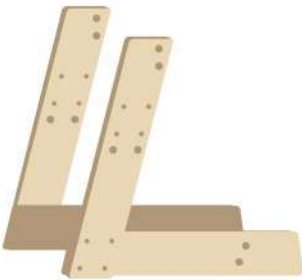

Chair side frame
2 Nos.



Seat
1 No.



Chair back rest
1 No.



chair bottom wooden plank
1 No.



Allen screw
20 - Nos.

Please ensure availability of all materials listed before starting assembly.

Step 1

Attach the table top to the table side frames using Allen screws as shown in the figure.

Adjust the height and table angle by appropriately choosing the screws in the side frame.

Attach the wooden plank at the bottom of the structure assembled.

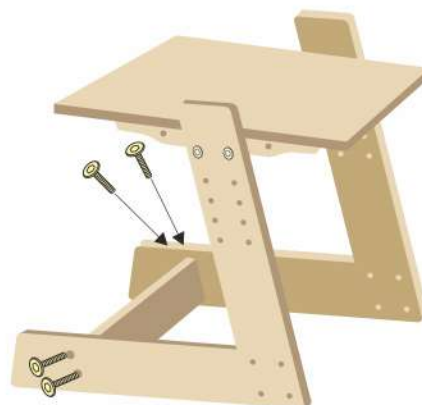

Step 2

Attach the seat using Allen screws as shown in the figure.
Attach the back rest at the top and wooden plank at the bottom of the chair.

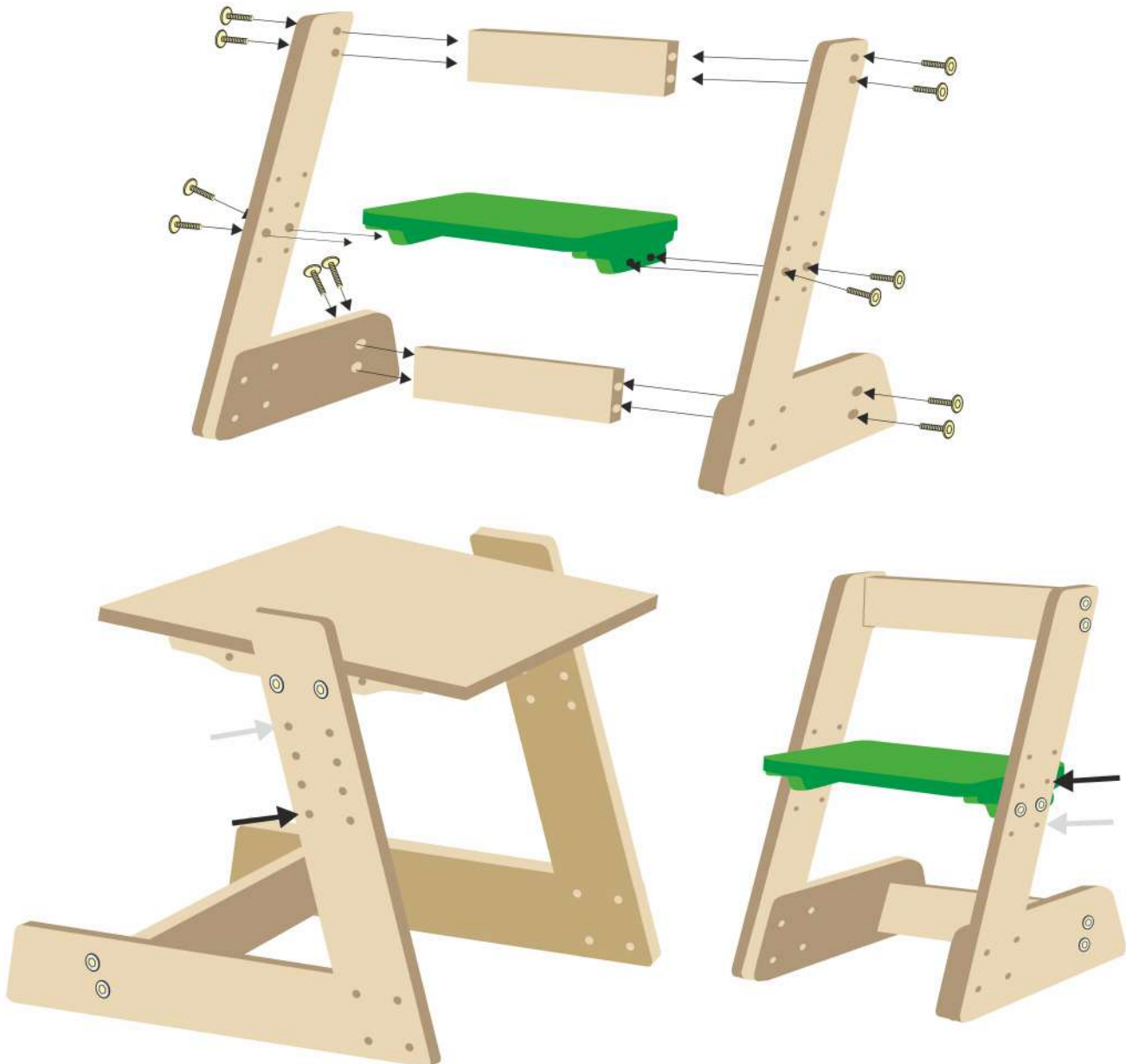

Adjust the height and angle of the table by changing the screw holes accordingly.
Also the chair height shall be adjusted by choosing the right holes.

Now Ready to use...

DO NOT USE CHAIR OR TABLE UNLESS ALL SCREWS ARE TIGHT.