

Play Room Toys

Climbing Playseter >> Jungle GYM Ultimate

Assembly Instruction Manual



**Jungle Gym
Ultimate**



List of Items



Allen screw



Allen key
- 1 No.

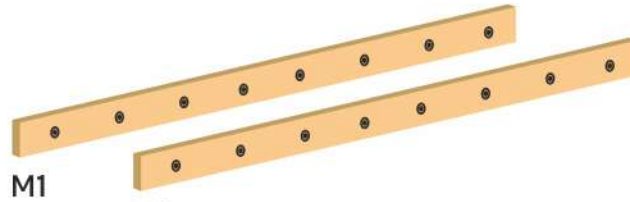

Monkey bar
side support - 2 Nos.



Monkey bar rods - 8 Nos.



P1

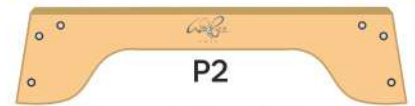

P2

Face plate - 2 Nos.

(1)

(2)

(3-4)

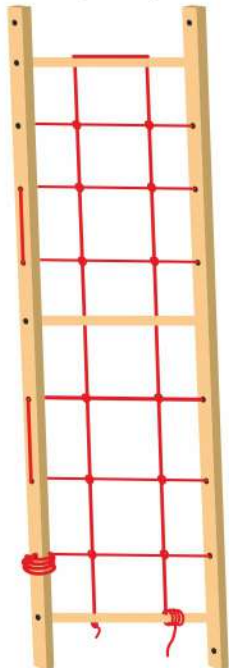
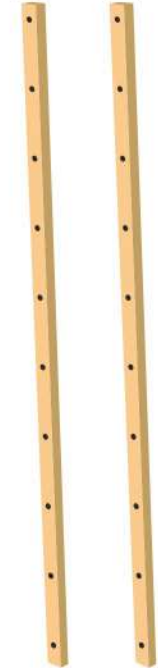

Rope climber

A B C D E



Vertical support
numbered as shown in fig

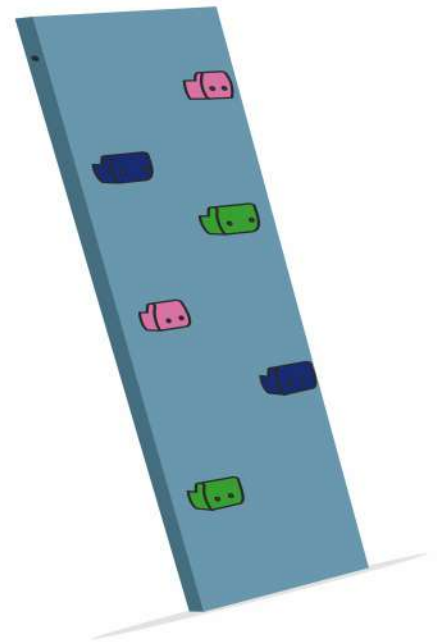

Mountain climber



Beech wood rods
(short) - 8 Nos.



Beech wood rods
(long) - 13 Nos.

● Swing

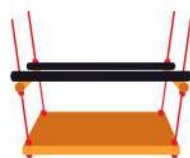

Also Including :-

● Gymnastic ring



● Rope ladder



Please ensure availability of all materials listed before starting assembly.

Step 1

Connect the monkey bar supports using monkey bar rods

- (i) Assemble the structure by fixing the (M1-M2) with 8 beech wood rods using allen screw.

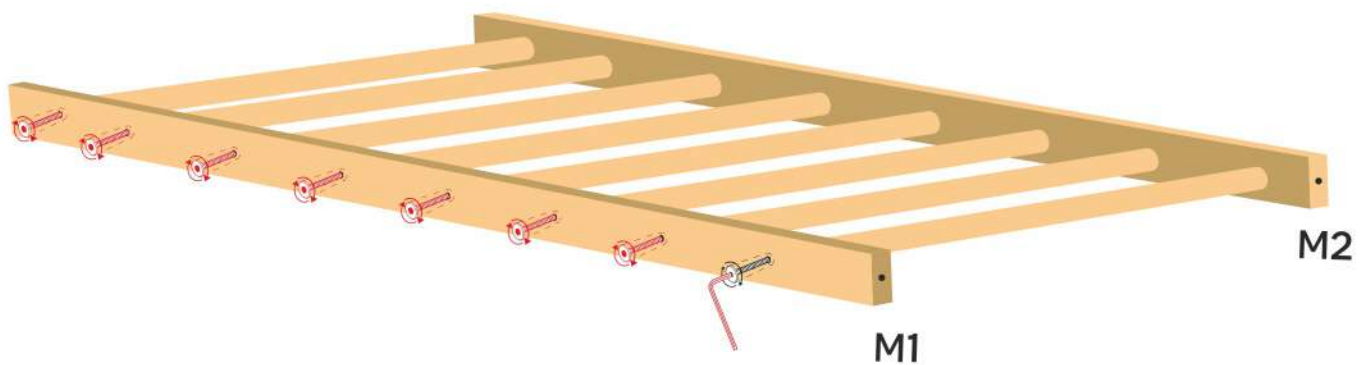
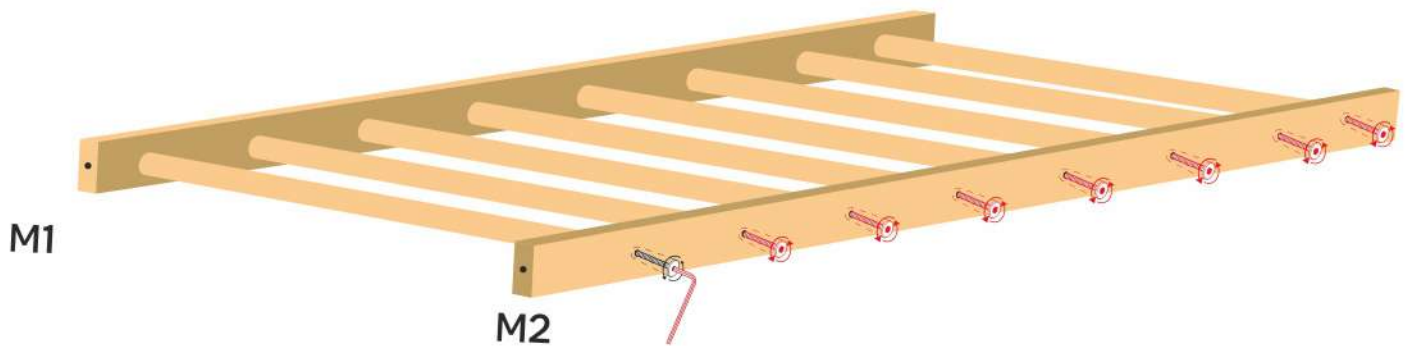

Step 2

Fix the face plate to the monkey bar.

- (i) Remove the screws from the face of the monkey bar and use it to fix the face plate with the monkey bar
- (ii) Screw it on the top two screw holes in the face plate P1 & P2



Step 3

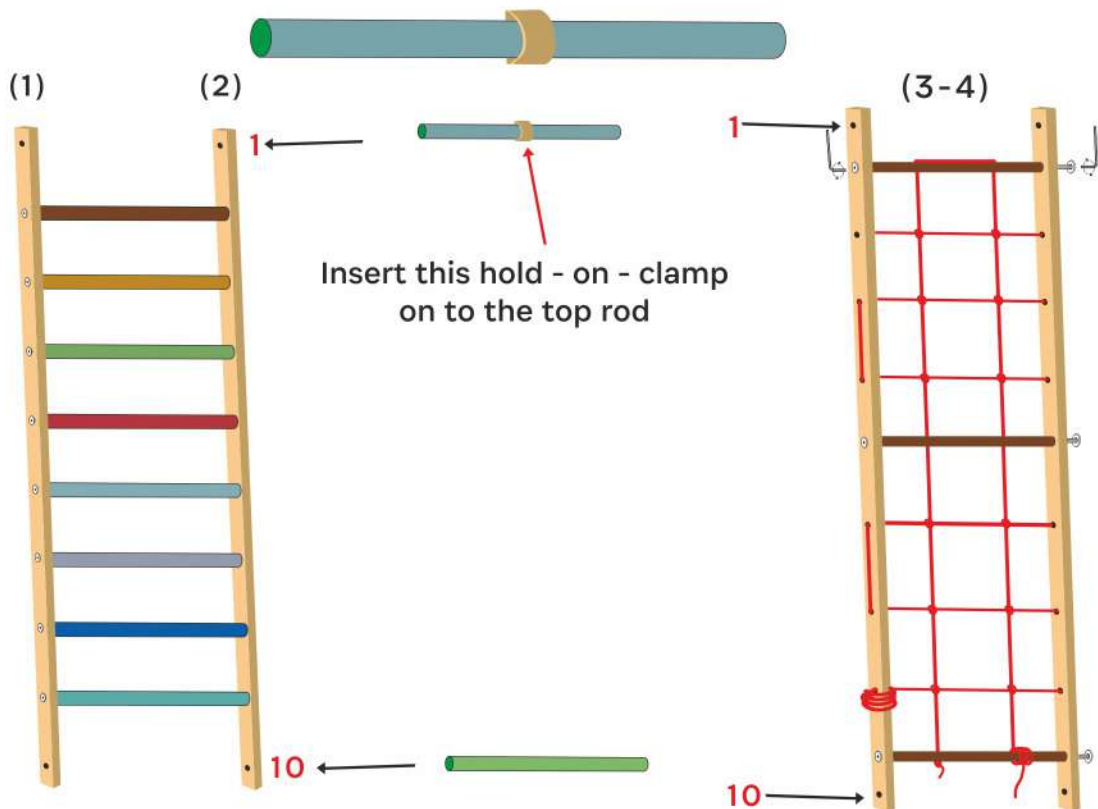

Insert this hold - on - clamp
on to the top rod

Fix 8 small beech wood rods
between (1) and (2),
screw it in 2-9 holes positions,
leaving hole 1 and 10 free

Assemble 2 rods
between (2) and (3),
in hole
positions 1 and 10,

Rope ladder
between (3) and (4)



Step 4

Insert this hold - on - clamp
on to the top rod between B & C

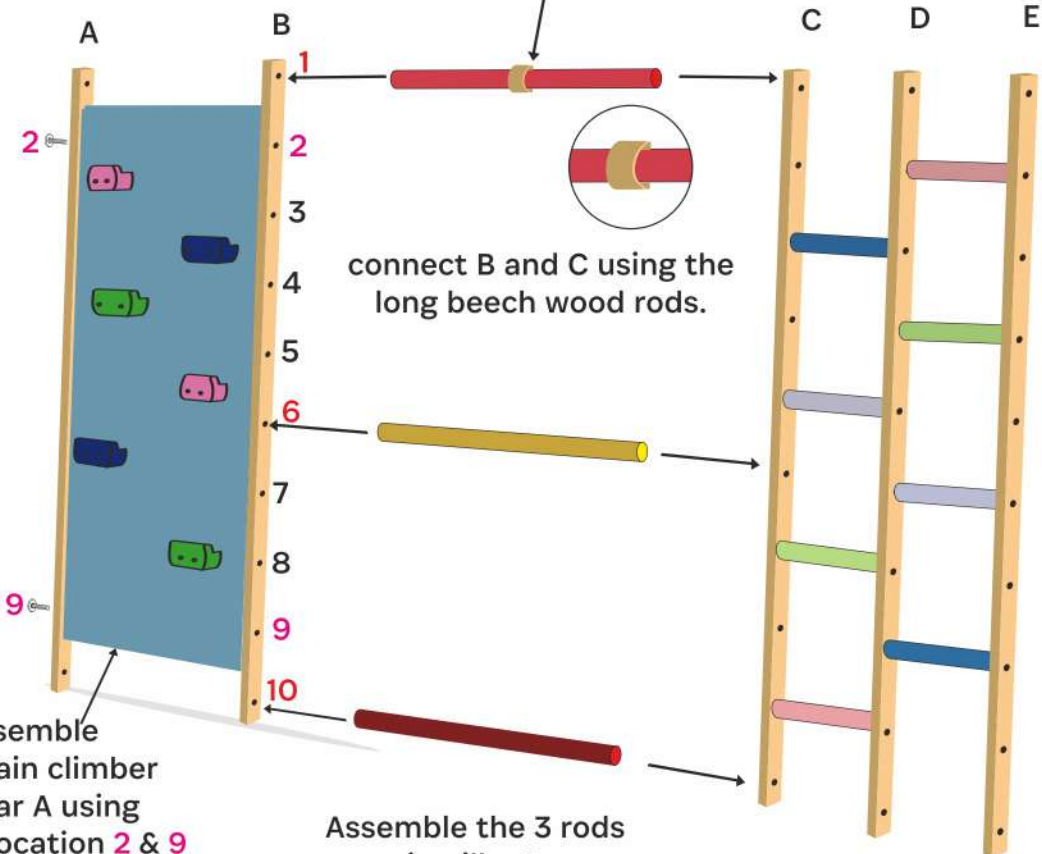

connect B and C using the
long beech wood rods.

Assemble
mountain climber
in pillar A using
bolts in location 2 & 9
Then assemble the
mountain climber to
pillar B using bolts
in position 2 & 9

Assemble the 3 rods
in pillar B
in locations 1, 6, 10

Assemble C, D and E,
The step ladder
as seen in the pic using
small beech wood rods



Step 5

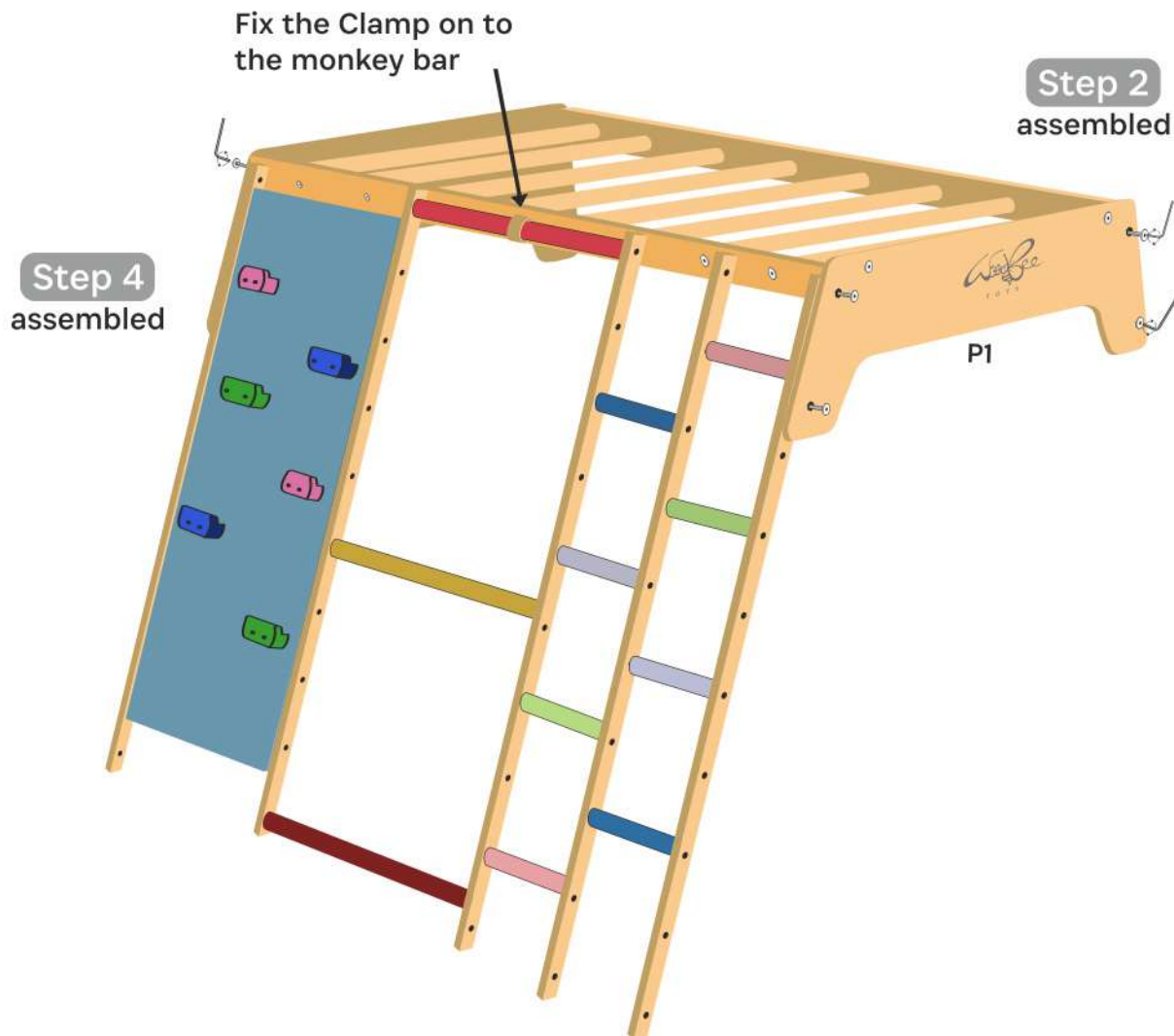

Step 5

Place the structure assembled in Step 4 on one side and attach it with the face plate as shown.

- (i) Align the two screw holes on the face plate with the screw holes on the vertical support.
- (ii) Repeat the same on the other side too.

Step 6

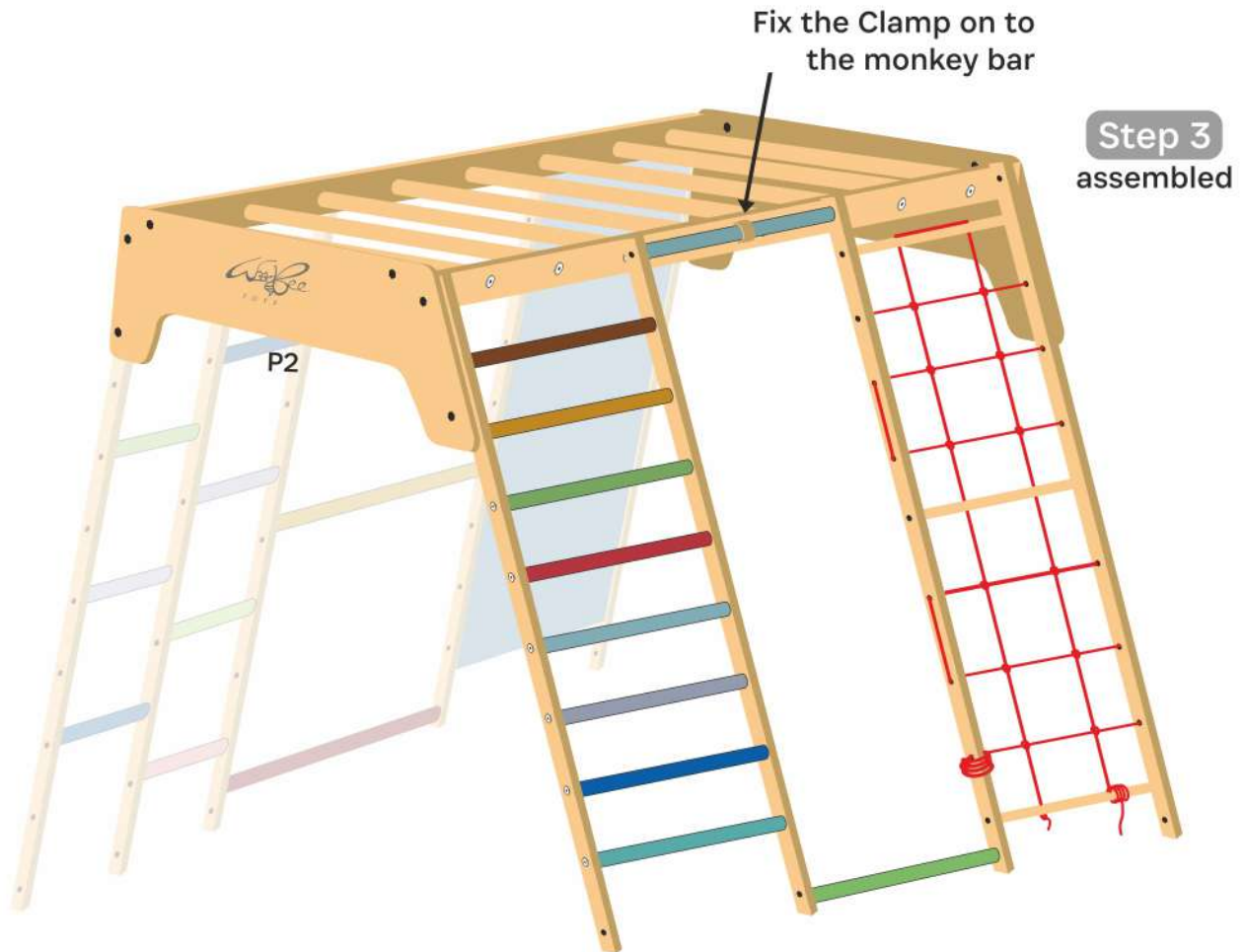

Step 6

Place the structure assembled in Step 3 on the other side and attach it with the face plate as shown.

- (i) Align the two screw holes on the face plate with the screw holes on the vertical support.
- (ii) Place it in such a way that mountain climber is opposite to rope climber
- (iii) Repeat the same on the other side too.

Step 7

Attach the swing, gymnastic ring and rope ladder on to the monkey bar.

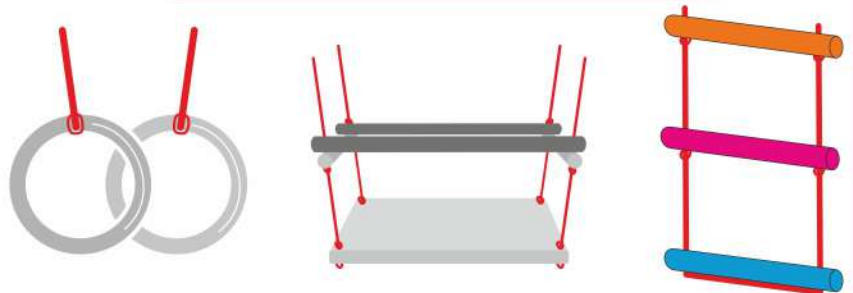

Jungle GYM
Assembly Instruction Manual

**SLIDE
FIXING**

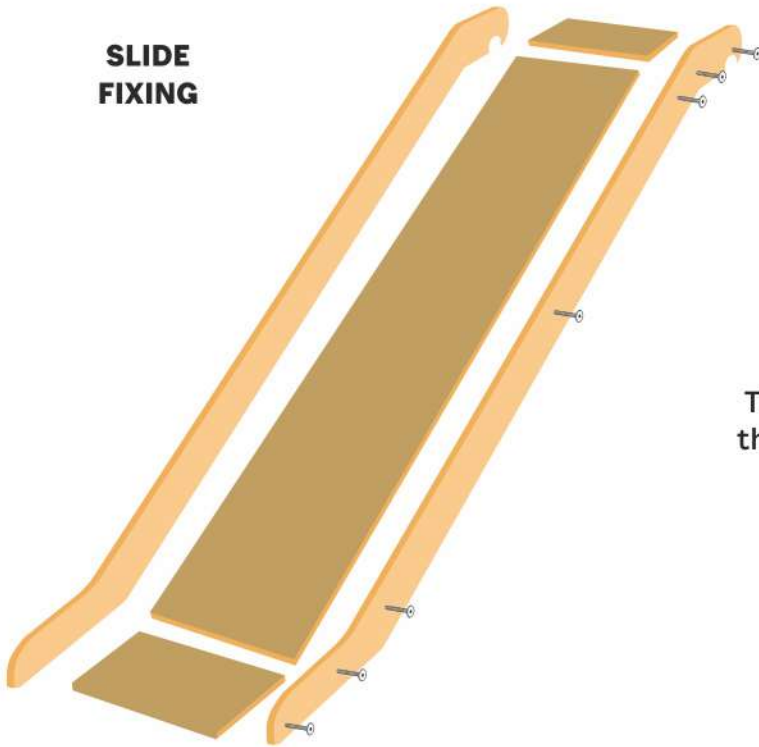

The slide comes as 5 pcs,
two sides and 3 boards

The boards has to be fixed to
the sides using bolts provided

The slide steps

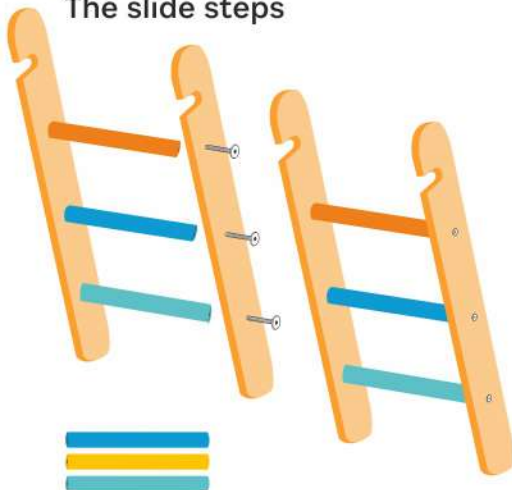

Beech wood rods (short) – 3 Nos.
step frame 2 Nos.

The slide steps has to be fixed
connect two sides with 3 rods
with screw as show in fig.



Jungle GYM
Assembly Instruction Manual



Now Ready to Play...

DO NOT USE GYM UNLESS ALL SCREWS ARE TIGHT.



"Parental supervision
necessary at all times"