

HOW TO MOUNT QUICK MOUNT REAR RACK ON KTM ADVENTURE 250 / 390

STEP 1

Remove two stock bolts from grab rail

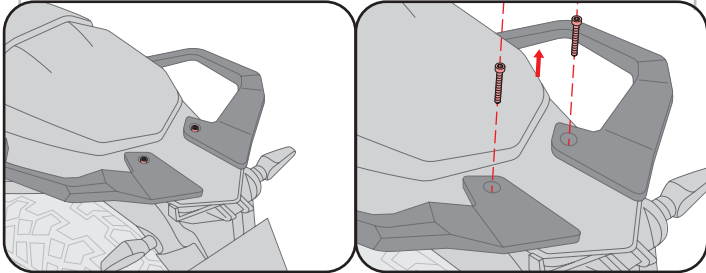

STEP 2

Insert spacers in grab rail holes

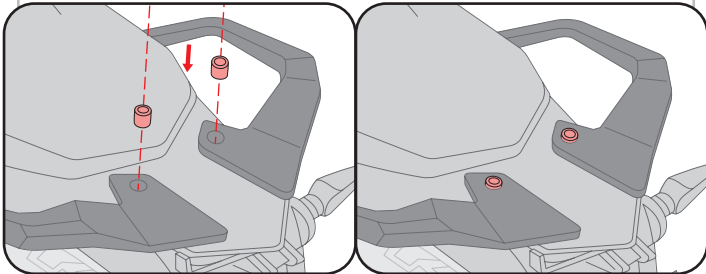

STEP 3

Slide base grabs on the grab rail tail part and match front two holes of base grab with spacers

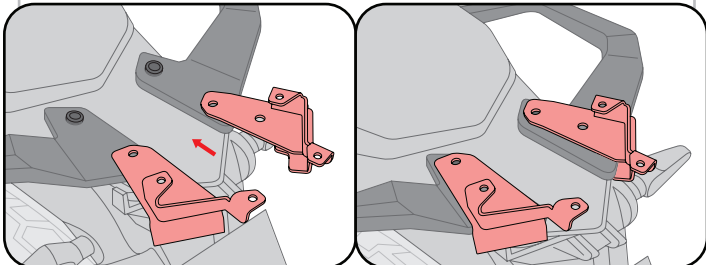

STEP 4

Insert two M8X50mm bolts with nylon washer into the base grabs front holes

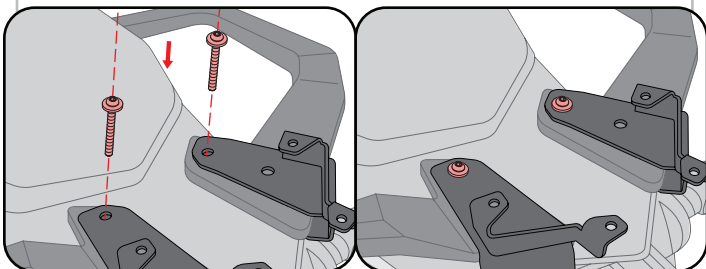

STEP 5

Put four spacers on the base grabs four holes, which is located at raised part of base grabs

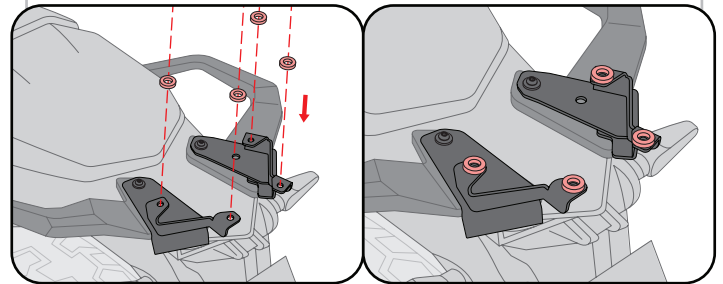

STEP 6

Put quick mount rear rack on spacers and match rear rack holes with spacers and base grabs holes

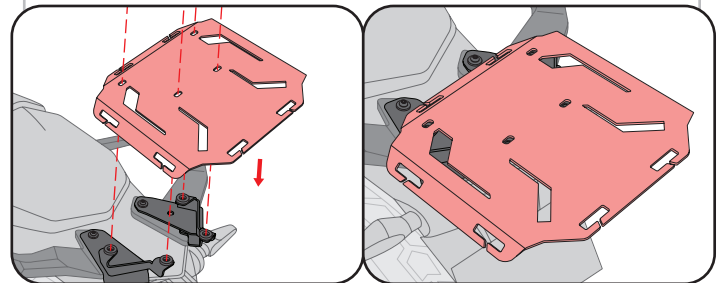

STEP 7

Insert four M6X50mm bolts with SS washers in to the rear rack holes

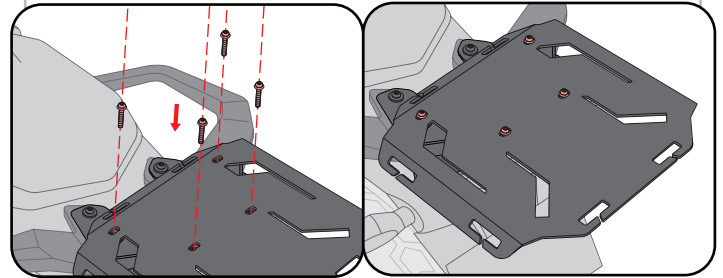

STEP 8

Tighten the four M6 nyloc nuts on the M6X50 bolts

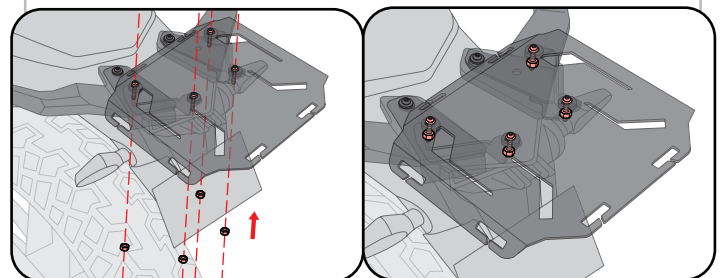

Scan this QR code
to watch more detailed
step by step mounting
instruction video

www.viatergear.com

