



CT15E Corded Electric Quick Guide

This is intended for quick consultation only and does not replace the Use and Maintenance Manual. Before using the machine, read the Use and Maintenance Manual contained in the machine packaging thoroughly and rigorously respect all the instructions.

Presentation/ Operation

1. Fill the detergent tank.



5. Plug in unit & press the ON button.

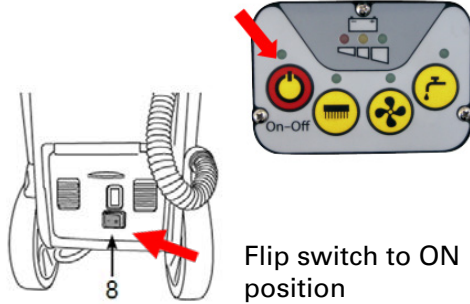

2. Adjust the slope of the handle by pulling the handle release lever.



6. Press the brush button to activate suction and water delivery.



3. Lower the squeegee using the lever.



7. Operate the drive lever.



4. Open the detergent tank tap.



8. Begin working.

9. When you finish cleaning, proceed as follows

- Press the brush button.
- Turn the machine off by pressing the ON button for at least 4 seconds.
- Raise the squeegee.
- Close the detergent tank tap.

For support, contact us!
IPC Eagle
info@ipceagle.com

Daily Maintenance

Empty the dirty water tank.



Check the dirty water tank float is undamaged and clean and moves freely on the pin.



Clean the dirty water tank.



Clean the brush.



Check the squeegee is clean and the blades are not damaged.



Replacing the Squeegee Blades

- release the clip;
- remove the two blade retainers by pushing them towards the outside of the squeegee then extracting them;
- remove the blade;
- reuse the same blade by reversing the edge in contact with the floor until all four edges are worn out, or replace with a new blade, fitting it onto the screws on the body of the squeegee;
- reposition the two blade retainers by centering the widest part of the slots over the fixing screws on the squeegee body, then pushing the blade retainers inwards;
- fasten the clip.

Automatic Brush Replacement

Attaching: insert the brushes under the head, making sure they rest against the alignment bracket. Hold the automatic brush attachment button down until they are attached. Releasing: lift the head using the lift button, then press the release button.

BRUSH MOTOR WILL NOT START	CHECK BRUSH MOTOR FUSE (SEE CHECK BRUSH MOTOR FUSE - TOP RIGHT IMAGE)
THE MACHINE DOES NOT COME ON/START UP	<ul style="list-style-type: none"> • CHECK THE EMERGENCY BUTTON IS NOT PRESSED • CHECK MACHINE IS PROPERLY PLUGGED INTO THE WALL OUTLET • CHECK THE BUILDING'S CIRCUIT BREAKER, RESET BREAKER IF NEEDED.
THE SUCTION MOTOR DOES NOT WORK	<ul style="list-style-type: none"> • CHECK THE DIRTY WATER TANK IS NOT FULL • CHECK THE DIRTY WATER TANK LEVEL SENSOR IS NOT BLOCKED/MALFUNCTIONING • CHECK FUSE (FUSE 3)
THE MACHINE LEAVES THE FLOOR WET	<ul style="list-style-type: none"> • CHECK THE SQUEEGEE BLADES ARE NOT WORN • CHECK THERE IS NO DEBRIS BETWEEN THE TWO SQUEEGEE BLADES • CHECK THERE IS NO DEBRIS IN THE SUCTION HOSE • CHECK THE SUCTION FILTER IS UNDAMAGED AND CLEAN
THE MACHINE LEAVES THE FLOOR DIRTY	<ul style="list-style-type: none"> • CHECK THE TYPE OF BRUSH/PAD/MICROFIBER IN USE IS SUITABLE FOR THE TYPE OF DIRT AND FLOOR
THE MACHINE LEAVES STRIPES OF WET FLOOR	<ul style="list-style-type: none"> • CHECK THE FLOOR HAS BEEN SWEEPED BEFORE USING THE MACHINE • CHECK THERE IS NO DEBRIS BETWEEN THE TWO SQUEEGEE BLADES • CHECK THE SQUEEGEE BLADES ARE NOT WORN • CHECK THE SQUEEGEE IS CORRECTLY ADJUSTED

Other possible reason the brush will not turn: The brush motor thermal cutout has tripped; the motor overheated - remedy is to release the brush lever, press the brush button (LED off), leave the machine to cool down for at least 45 minutes.

Checking the Brush Motor Fuse

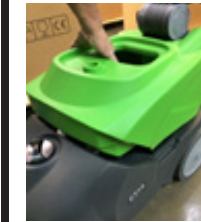

1. Drain the recovery tank. Remove the recovery tank by lifting up.



2. Locate the fast blow brush motor fuse
Fuse 1 - Machine Protection
Fuse 2 - Brush Motor
Fuse 3 - Vac Motor



3. Remove the brush motor fuse.



4. Test fuse with meter



5. Install good motor fuse and reattach fuse cover. Replace recovery tank and test motor

