

Quick Start Guide

99120B/99120D

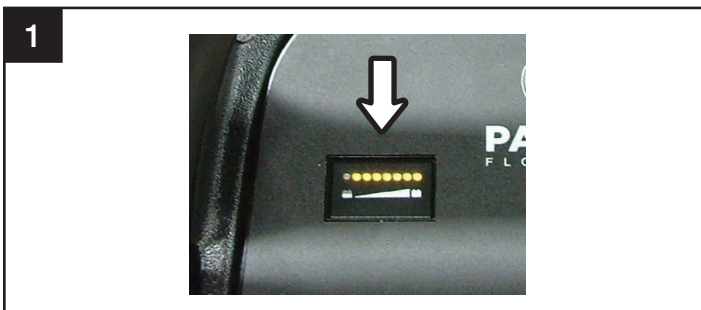

1. Assembly



1 Ensure batteries are fully charged before operating the unit. Refer to the Operations and Maintenance manual for complete charging instructions.

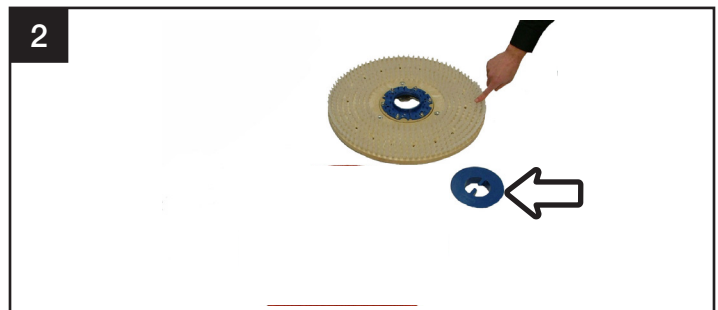

2 Place your pad driver on a work surface and remove the center lock fitting from the pad driver. To do so, unscrew the center lock in a counter-clockwise motion.

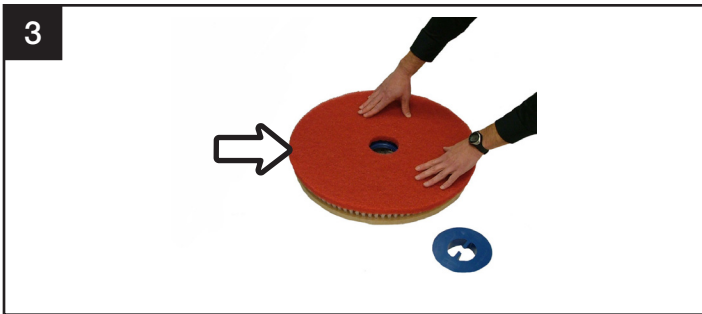

3
Connect the cleaning pad to the disk pad driver by centering it on the driver.

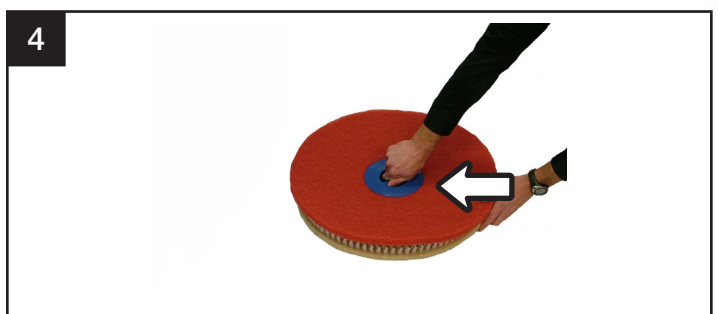

4
Screw on the center lock fitting, making sure that the center lock has compressed the pad and is snug.

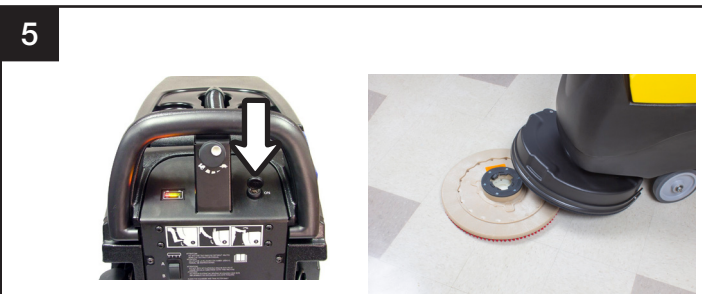

5
Turn the unit ON using the key switch. Push or drive it into position so that the unit's scrub head is centered over the pad driver or brush.

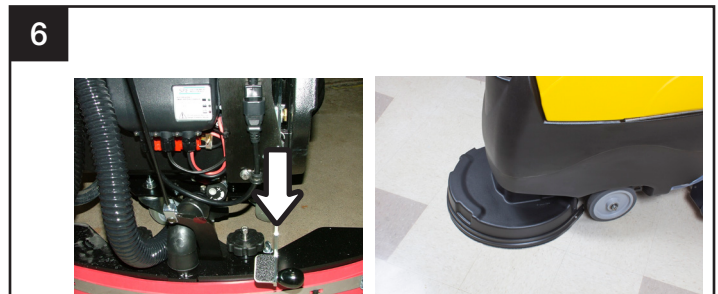

6
Using the foot pedal, lower the scrub deck down onto the pad driver or brush by depressing the pedal while shifting it to the right. Once clear of the lower notch, lifting your foot will lower the scrub deck. Make sure that the shroud completely covers the pad drivers or brush in the lowered position. Should the shroud be resting on a portion of the pad driver or brush, the head is not centered and will not attach properly.

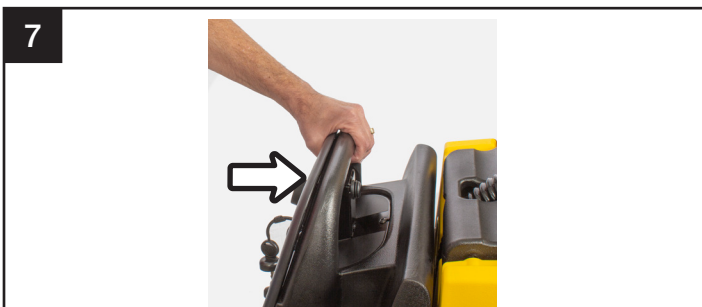

7
The operation is completed by quickly pulsing the activation trigger. This will "click on" the pad driver or brush. If the pad driver or brush do not quickly engage, do not continue pressing the activation trigger. Realign the scrub deck and try the procedure again. When you have the scrub deck aligned properly, you should see a noticeable drop of the scrub deck when lowered and the bristle skirt on the shroud should almost be touching the floor.

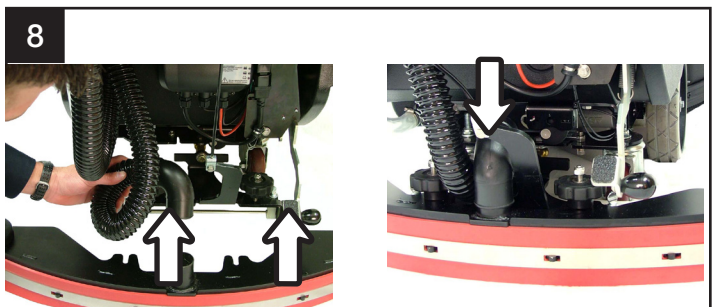

8
Align the squeegee assembly retention slots with the easy-grip knobs then tighten until secure. Attach the recovery hose to the squeegee assembly neck. Make sure to route the loop hose trap between the squeegee assembly neck and the left easy-grip knob.

2. Operating Instructions

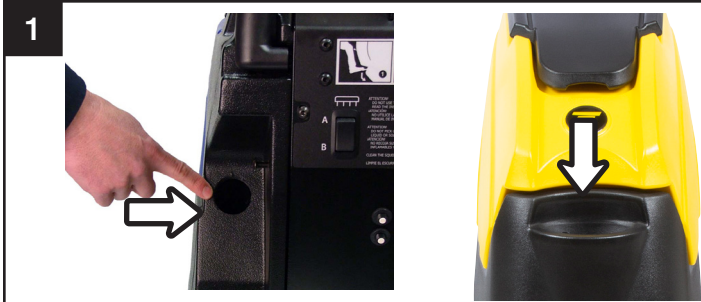

Water and cleaning detergent can be added to the unit's rear hose fill port, located to the left of the control panel. There is also a front fill port that is able to accept hose or bucket filling. Water temperature should not exceed 120°F (50°C).

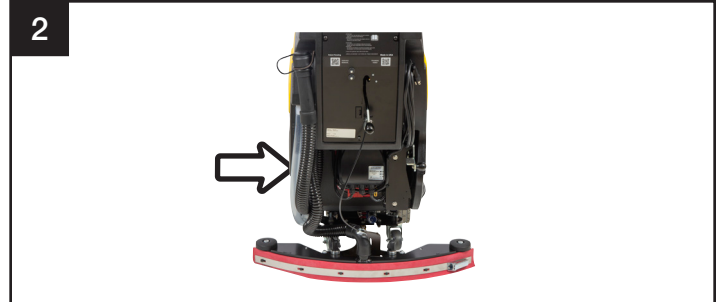

The sight gage hose performs double-duty as the solution drain hose as well. You simply slide the hose off the press fitting and lower the hose to a drain or mop sink.

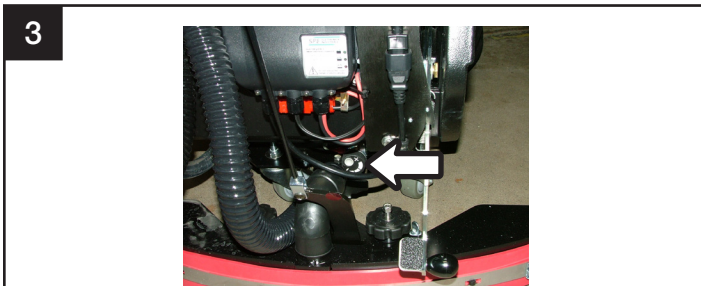

The solution flow rate is adjusted by a control located at the lower rear of the machine.



Turn the key to the ON position. You will see the battery meter on the left side of the upper control panel light up to show the battery charge level.

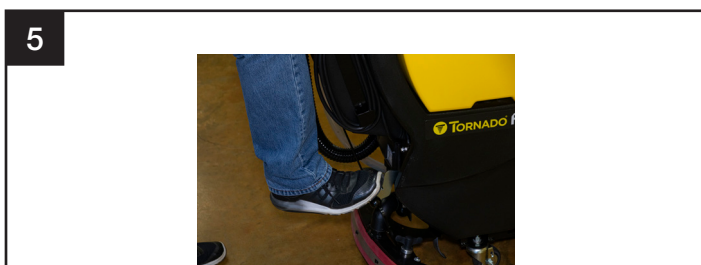

The scrub deck is lowered using the foot pedal at the rear of the unit. Place your foot on the pedal and depress the lever while shifting it to the right. Once clear of the lower notch, lifting your foot will lower the scrub deck into the operating position.

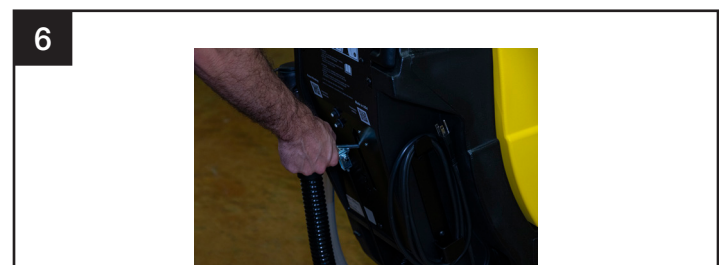

To lower the squeegee, lift the squeegee lever and shift it left to clear the notch. Once clear, lower the squeegee into the recovery position. In doing so, the unit's vacuum motor will activate.



To begin scrubbing, engage the handle trigger. The trigger activates solution flow, the brush motor and traction drive, if equipped. Speed control is easily thumb adjusted and the reverse can be depressed with your fingers on the back side of the control housing.

3. Additional Parts Required

There are no additional part required.