

Your AiDEX™ Continuous Glucose Monitoring System (CGM) includes the following key parts:

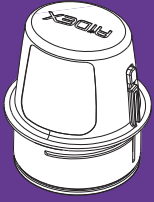

Applicator with built-in sensor



Transmitter

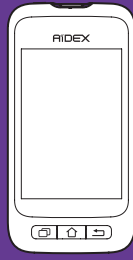

Personal Diabetes Assistant (PDA)/APP



AiDEX™ Continuous Glucose Monitoring System Quick Guide



CE 0197

MicroTech Medical (Hangzhou) Co., Ltd.

1 Sensor Application

Prepare the device:

A Open the package.

B Take out the applicator with built-in sensor by turning counter clockwise.

Select site:

A Select a place on your stomach or upper arm.
Notes: Avoid areas with scars, moles, stretch marks or lumps.

B Clean sensor site with alcohol wipe. Allow site to dry completely before proceeding.

Apply the sensor:

A Place the applicator on desired location. Press the applicator firmly against skin, and press the button to launch the sensor applicator afterwards. Make sure the sensor base adheres to your skin.

B Remove the applicator from skin, leaving the sensor base on your body.

2 Attach Transmitter

- A** Align the transmitter to the sensor base and press firmly to attach it.
Notes: Align and press down on the transmitter connector area first. Then, make sure the far snap hook engages by pressing down over that area if necessary. Make sure that the transmitter and sensor base are similarly oriented before attaching anything.

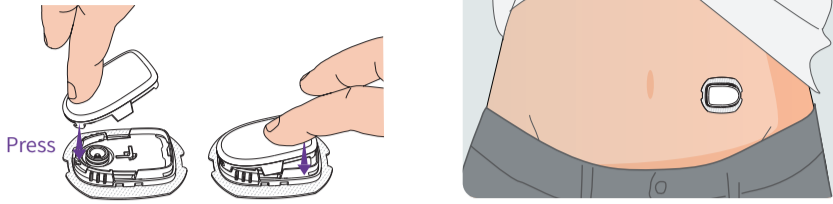

3 Initialize the Sensor on the PDA/App

- A** Choose our Personal Diabetes Assistant (PDA): Please refer to our User Manual for PDA settings.

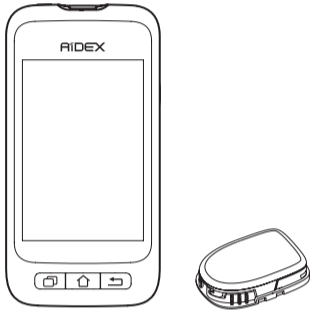

Install our App “AiDEX” on your mobile phone as the receiver. Download AiDEX via QR code:



- B** Locate your transmitter SN on the transmitter box.

Glucose Monitoring Transmitter
 Model No. : G7-T01
 SN XXXXXX
 yyyy-mm-dd

- C** Pair the transmitter with the PDA or Phone App by entering the transmitter SN.



- D** Wait one hour for the sensor to warm up.

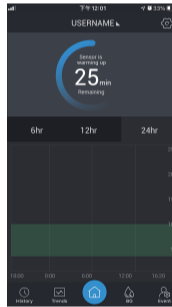

- E** Access your glucose data from the PDA or Phone App.



4 Remove Old Sensor and Start a New Sensor

- A** Carefully pull the tape that holds the sensor from the edge. Slowly peel the sensor until it is completely removed.

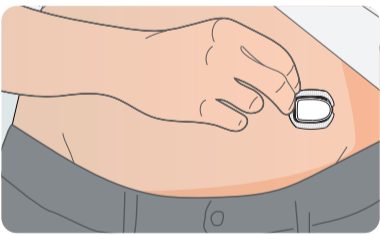

- B** Use warm soapy water to remove any remaining sticky residue.



- C** Press the two release buttons on the sensor base as shown. Pull the transmitter away from the sensor base.

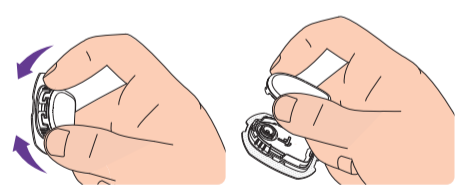

- D** Apply the new sensor as per the procedures described in Step One.



- E** Confirm it is a new sensor using the PDA or Phone App.

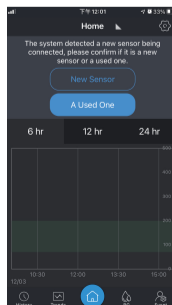

- F** Wait for the sensor to warm up and access your glucose data as before.

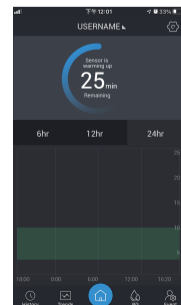

Notes:

- If you resume using an unexpired sensor, you don't have to wait for the sensor to warm up in Point F.
- Applicators and sensors are disposable and meant for single use only. Dispose of the used applicator and sensor according to your local regulations. The Transmitter is reusable.