

Milano 12 Rotorwind

Congratulations on your purchase. Your ORBITA watch winder will provide you with many years of trouble-free service. It comes complete with a 2-year warranty for any defects in materials and/or workmanship. In order to provide you with proper support, and to keep you updated with information on performance enhancements, accessories and new product announcements, we ask that you take a minute to fill out the registration card included with your ORBITA watch winder. Be assured that we will not furnish your name, address or any other information you provide to us to any "third" parties.

EXTENDED WARRANTY PURCHASE

There is always the possibility that any electro-mechanical device may fail due to unforeseen circumstances. ORBITA offers an optional extended warranty providing for an additional 3 year coverage period to insure against such contingencies. If you would like to purchase this option, please fill out the Extended Warranty card included with your watchwinder. You may fax or simply mail the paper work directly to us.

ORBITA[®]
WATCHWINDERS



Milano 12 - Rotorwind

ORBITA[®]
CORPORATION

6740 Netherlands Dr.
Suite D
Wilmington, NC 28405



INSTRUCTION GUIDE

Rotorwind Watch Winders

Congratulations on purchasing your Rotorwind Watch Winder!

This design is unique in that it swings an automatic watch, rather than rotating it, mimicking the natural action of the wrist. Then, with a series of oscillations triggered by a single revolution of a low-current draw-drive motor, power is only needed for a few seconds every 8 or 12 minutes. Extensive beta testing by hundreds of watch collectors owning a variety of automatic watches has validated the concept.

Included In This Box

1. Milano 12 Watch Winder
2. Key (1)
3. Cup Assembly(12)
4. Standard Cushion(12)
5. AC Adapter (PN1334 3-Volt)
6. Warranty Registration
7. Instruction Book

Getting Started

1. Carefully unwrap the protective packaging.
2. Remove the key that is taped to the glass door.
3. Unlock and open the doors.
4. Remove cushions and confirm each module is on by pressing the o/- to the right (-).
5. Slide the cushions back into the cup assembly.
6. Plug in the adapter to junction box located in the rear of the unit .
8. Turn the MASTER power on using power switch (o/- = Off/On).

Mounting Watch on Cushion

1. With the bracelet or strap of the watch **closed**, squeeze and slide the cushion through the watch. The back of the watch should rest against the Orbita logo and the strap should lie on the flat portion of the cushion .

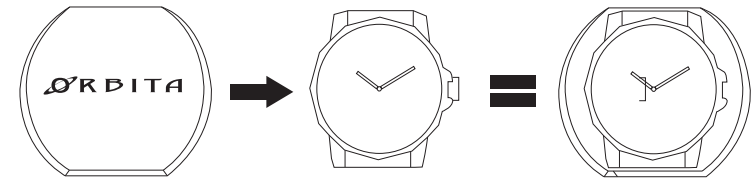

8/12 Minute Switch

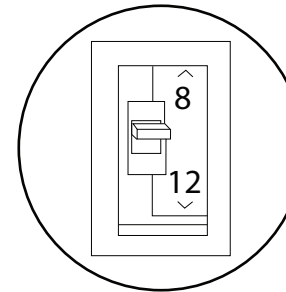

A program switch allows you to select one of two winding cycles: 8 minute (standard program) or 12 minute (extended program). The winding cycle begins every 8 or 12 minutes based on the program selected. Many watches that wind in both directions stay fully wound on the factory preset 8 min. setting. To select the extended program, remove the mounted cup to reveal the program switch opening. Insert a small object (screwdriver, pencil, etc) into the opening and slide the switch to the 12 minute setting. The factory preset position is the 8 minute setting.

Interval Settings (TPD = Turns Per Day)

8 Minute Setting: 1200 -1300 TPD

12 Minute Setting: 800 - 900 TPD