

User Guide

## Digital Tiered Cash Box

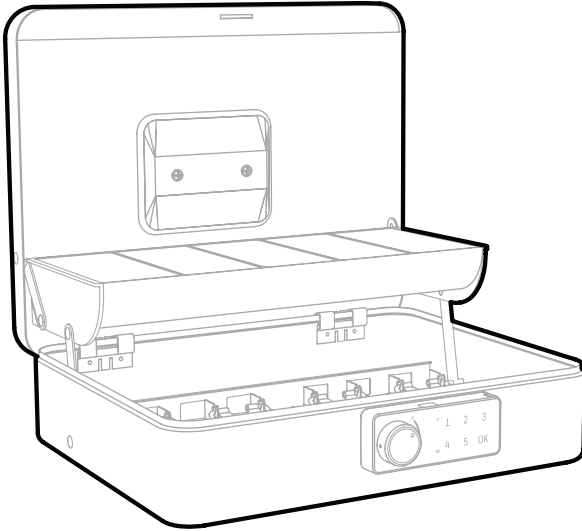

Models 6213DG

### Package Includes:



Deluxe Tiered  
Digital Cash Box



Operation  
Manual



Emergency  
Entry Keys



Access Pin

Please carefully check the above list to confirm all items have been received.  
If any items are missing, please contact Consumer Assistance (see page 9 for contact information).

**Read this manual carefully and never store it inside the safe!**

# INDEX

WELCOME / PROPER CASH BOX USE / CARE AND MAINTENANCE .....	PAGE 3
SETUP & OPERATION / TEST DIGITAL LOCK / PROGRAM A NEW MANAGEMENT PASSCODE .....	PAGE 4
PROGRAM A NEW PASSCODE / TURN ON PUBLIC MODE / TURN OFF PUBLIC MODE .....	PAGE 5
FAKE PIN CODE FUNCTION / TO UNLOCK THE CASH BOX / TO LOCK THE CASH BOX .....	PAGE 6
OPEN CASH BOX WITH OVERRIDE KEY .....	PAGE 7
ORDERING ADDITIONAL OVERRIDE ACCESS KEYS / LOCATING CASH BOX IDENTIFICATION NUMBERS .....	PAGE 8

## WELCOME

Your Honeywell Cash Box will provide years of safe and secure protection for your valuables, important documents and other personal items. All Honeywell safes are designed and built using the highest manufacturing standards to ensure maximum user satisfaction under a variety of conditions. With proper care, your Honeywell cash box will provide peace of mind for many years to come.

Thank you and enjoy!

## PROPER CASH BOX USE

Honeywell Digital Steel Security Cash Boxes are designed to protect important documents, funds, digital media files and other valuables from theft and tampering.

## CARE AND MAINTENANCE

When properly maintained, your Cash Box will continue to operate for many years. In order to ensure optimum performance of your Cash Box, please follow these simple precautions:

**CLEAN HANDS** - Never attempt to operate the digital keypad if your hands have excessive dirt, debris or liquids on them.

**CLEAN CASH BOX** – To clean the surface of your Cash Box, it is recommended that you use a mild cleaner (e.g., window cleaner) to avoid scratching or discoloring the surface. Always wipe dry and NEVER use abrasive cleansers on the cash box or digital keypad.

## SETUP AND OPERATION

### INSTALL BATTERY

1. Open battery compartment. Using fingernail, remove sliding battery compartment (Figure 1). Requires Lithium battery CR2032 (not included).
2. Insert the battery negative side facing out (Figure 2).
3. Re-insert battery compartment. Both the unlock and battery indicators will flash (Figure 3).

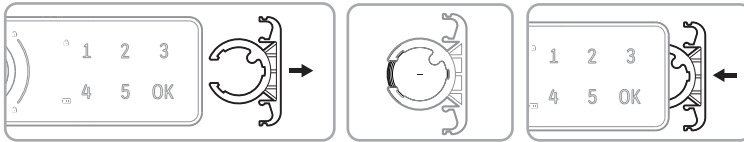

Figure 1

Figure 2

Figure 3

### TEST DIGITAL LOCK

1. With lid open, turn knob left to put locking lid latch in lock position (Figure 1).  
**NEVER STORE KEYS INSIDE CASH BOX!**
2. Enter the preset pass code: "1"- "2"- "3"- "4" + OK (Figure 2).
3. Turn knob to right within 2 seconds (Figure 3).
4. Lock should recede into the unlocked position.

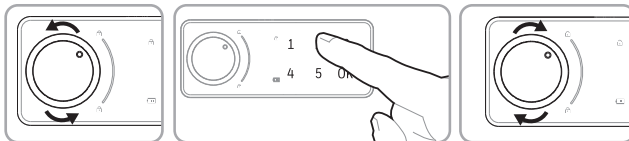

Figure 1

Figure 2

Figure 3

### PROGRAM A NEW MANAGEMENT PASSCODE

1. Input current management code "4"- "3"- "2"- "1" + OK. Tone will sound a long beep and a green unlock indicator light will flash quickly and then stay lit (Figure 1).
2. While the unlock button is lit, quickly press the OK button and hold it for at least 2 seconds; the unlock indicator light will flash.
3. Input your desired access code; press OK. When you hear a long beep the management passcode is set.

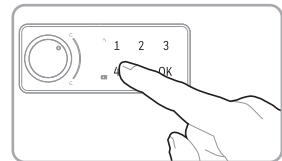

Figure 1

**NOTE: Password can be 4-15 digits.**

**Warning: There is no reset button; please write down your code.**

## PROGRAM A NEW PASSCODE

1. Input current access code "1"- "2"- "3"- "4" + OK.  
Tone will sound a long beep and a green unlock indicator light will flash quickly and then stay lit (Figure 1).
2. While the unlock button is lit, quickly press the OK button and hold it for at least 2 seconds; the unlock indicator light will flash.
3. Input your desired access code; press OK.  
When you hear a long beep the access code is set.

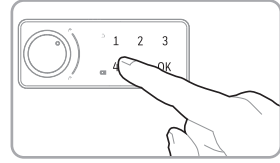

Figure 1

**Warning: There is no reset button; please write down your code.**

**NOTE: Password can be 4-15 digits.**

## TURN ON PUBLIC MODE

1. Input current management passcode + OK. Tone will sound a long beep and a green unlock indicator light will flash quickly and then stay lit.
2. While the unlock button is lit, quickly press the OK button and hold it for at least 2 seconds. The unlock indicator light will flash.
3. Press the OK button again.
4. Input "4 4"; press OK. When you hear a long beep public mode will be active.

### Set a temporary passcode

1. Press the OK button. The unlock indicator light will flash quickly.
2. Input a new passcode.
3. Press OK to unlock. When you hear a long beep the temporary code is set.

**NOTE: Temporary passwords can only be used one time.**

## TURN OFF PUBLIC MODE

1. Input current management passcode + OK. Tone will sound a long beep and a green unlock indicator light will flash quickly and then stay lit.
2. While the unlock button is lit, quickly press the OK button and hold it for at least 2 seconds. The unlock indicator light will flash.
3. Press the OK button again.
4. Input "4 3"; press OK. When you hear a long beep public mode will be deactivated.

## FAKE PIN CODE FUNCTION

### TURN ON/OFF FAKE PIN CODE FUNCTION

1. Input current management passcode + OK. Tone will sound a long beep and a green unlock indicator light will flash quickly and then stay lit.
2. While the unlock button is lit, quickly press the OK button and hold it for at least 2 seconds. The unlock indicator light will flash.
3. Press the OK button again.
4. Input "4 2", press OK. When you hear a long beep fake pin function will be active.  
Or Input "4 1"; press OK. When you hear a long beep sound fake pin function will be deactivated.

**NOTE: With a fake PIN you can input any code(s) before or after the real passcode to prevent the real passcode from being compromised. Maximum 16 digits.**

## TO UNLOCK THE CASH BOX

1. Enter your access code XXXX+OK.
2. Tone will sound a long beep and a green unlock indicator light will turn on. 
3. Turn knob 90 degrees clockwise within the 3 second window to open the lock.

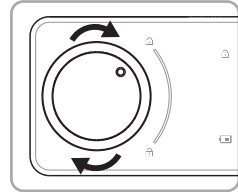

## TO LOCK THE CASH BOX

1. Turn the knob back 90 degrees counter-clockwise to lock position.

**NOTE: When access code is wrong a tone will sound and beep 3 times.  
When lock shows this signal, means low battery. **

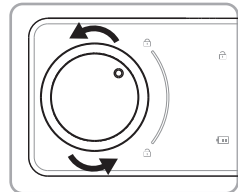

## OPEN CASH BOX WITH OVERRIDE KEY

1. To use override key, safe must be in the locked position. Remove override key cover with access pin. Locate hole on left side of the knob. Carefully place pin into the hole, and gently push pin back towards cash box to remove cover (Figure 1).
2. Insert override key and turn right to unlock cash box (Figure 2).
3. Re-insert override key and turn back to the left to lock the cash box (Figure 3).
4. Carefully reinstall cap. Align cap dot with the word "Lock" as shown (Figure 4).

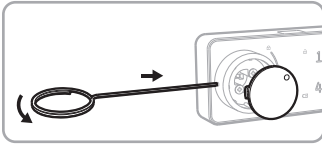

Figure 1

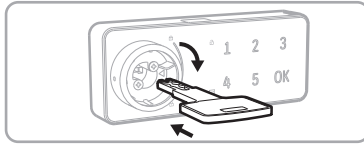

Figure 2

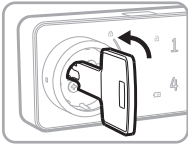

Figure 3

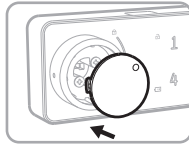

Figure 4