

User Guide

Waterproof Fire Safe



Models 2605, 2607 & 2609

Package Includes;

- 1 - Waterproof Fire Safe
- 1 - Operation Manual
- 2 - Override Access Keys
- 1 - Mounting Kit
- 1 - Removable Shelf
- 4 - Shelf Clips



1-Waterproof Fire Safe



1-Operation
Manual



2 - Override
Access Keys



1-Mounting
Hardware

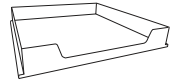

1 - Removable
Shelf

Please carefully check the above list to confirm all items have been received.
If any items are missing, please contact Consumer Assistance. (see page 9 for contact information).

**Read this manual carefully and never store it or the keys
inside the safe!**

DO NOT RETURN SAFE TO STORE

If you are missing parts or have difficulty operating your safe, please contact our Consumer Assistance Department by telephone. Store will not accept returned products without prior authorization.

SAFE IDENTIFICATION RECORD

Safe Model # _____

Safe Serial # _____

Override Access Key # _____

User Code _____

LOCATING SAFE IDENTIFICATION NUMBERS

Safe Serial

Located on the bottom right corner of the safe door frame (Figure 1).

Override Access Key

Engraved on the Head of the key (Figure 2).

Cylinder

Engraved on the lock cylinder (Figures 3).

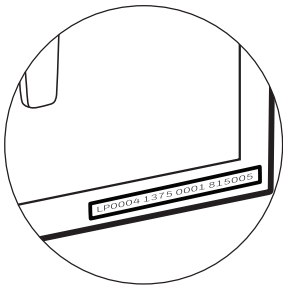

Figure 1

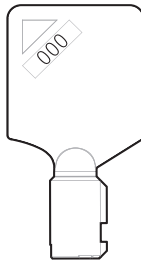

Figure 2

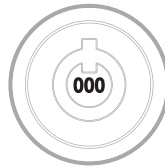

Figure 3

INDEX

WELCOME	PAGE 1
PROPER SAFE USE	PAGE 1
CARE AND MAINTENANCE	PAGE 1
INTERIOR MOISTURE WARNING	PAGE 2
GETTING STARTED.....	PAGE 2
INSTALL BATTERIES	PAGE 2
TESTING DIGITAL LOCK	PAGE 3
PROGRAMMING NEW USER CODE	PAGE 4
TESTING NEW USER CODE	PAGE 4
LOCKING AND UNLOCKING	PAGE 5
TURN SOUND ON AND OFF	PAGE 5
MOTION ALARM SETTINGS	PAGE 5
SECURE LOCKOUT PERIOD	PAGE 6
LOST OR FORGOTTEN USER CODES	PAGE 6
OVERRIDE ACCESS KEY	PAGE 6
REMOVABLE SHELF	PAGE 6
ANCHORING SAFE TO A FLOOR.....	PAGE 7
ORDERING ADDITIONAL OVERRIDE ACCESS KEYS	PAGE 8
LOCATING SAFE IDENTIFICATION NUMBERS	PAGE 8

WELCOME

Your Honeywell Waterproof Fire Safe will provide years of safe and secure protection for your valuables, important documents and other personal items. All Honeywell safes are designed and built using the highest manufacturing standards to ensure maximum user satisfaction under a variety of conditions. With proper care, your Honeywell safe will provide "Peace of Mind" for many years to come.

Thank you and enjoy!

PROPER SAFE USE

Honeywell Waterproof Fire Safes are designed to protect paper documents and files from heat and water damage due to exposure to fire and floods.

Fire Protection

Independent testing verified the interior temperature remains below 350° F (177°C) for 2 hours when outside temperature is up to 1550°F (843°C).

Water Protection

Independent testing verified that the interior remains dry when completely submerged for up to 8 hours with up to 50mm of water above the safe.

IMPORTANT: Before using your new safe, it should be opened and aired out for at least 30 minutes to allow the waterproof seal to decompress and perform as intended.

WARNING: This safe is not intended for the storage of medications, pearls, firearms, ammunition, or combustible items of any kind.

CARE AND MAINTENANCE

When properly maintained, your safe will continue to operate for many years. In order to ensure optimum performance of your safe, please follow these simple precautions:

CLEAN HANDS – Never attempt to operate the digital keypad if your hands have excessive dirt, debris or liquids on them.

CLEAN SAFE – To clean the surface of your safe, it is recommended that you use a mild cleaner (e.g., window cleaner) to avoid scratching or discoloring the surface. Always wipe dry and NEVER use abrasive cleansers on the safe or digital keypad.

MOISTURE – We recommend that you place delicate items such as pictures or intricate jewelry into an air-tight container before storing them in your safe. Avoid placing your safe in areas of high humidity. For optimum performance, the safe should be opened and aired out for at least 20 minutes every two weeks.

For future reference, store this Operation and Installation Guide in a secure area away from the safe.

DO NOT DISCARD!

INTERIOR MOISTURE WARNING

IMPORTANT: For optimum performance, Waterproof Fire Safes should be opened and aired out for at least 30 minutes every two weeks to prevent any build up of moisture inside. It is recommended to occasionally do this for longer periods. This will balance the humidity difference inside and outside and allow any excess moisture trapped inside to escape. If you do not open Waterproof Fire Safes on a regular basis to let them air out, you may begin to notice a musty smell, especially on paperwork. The manufacturer will not be responsible for any damage or loss of items placed in Waterproof Fire Safes due to moisture. Proper care and preventative maintenance of Waterproof Fire Safes is the owner's responsibility. The owner should understand that this is required to assure continued levels of protection and trouble-free performance during the lifetime.

GETTING STARTED

1. Remove override access rubber lock cover (Figure 1).
2. Insert the override access key into the lock until it stops (Figure 2).
3. With the key inserted turn clockwise to the right (Figure 3).
4. Turn the door handle upwards counterclockwise and pull the safe door open (Figure 4 & Figure 5).

IMPORTANT: IF THE HANDLE WILL NOT TURN UPWARDS COUNTERCLOCKWISE, FIRST TURN THE HANDLE SLIGHTLY BACK TO THE LEFT UNTIL IT STOPS, THEN TURN UPWARDS COUNTERCLOCKWISE AGAIN TO OPEN.

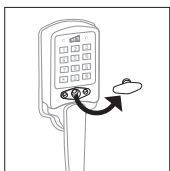

Figure 1

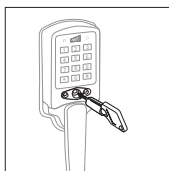

Figure 2

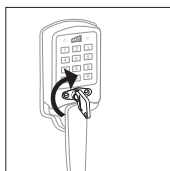

Figure 3



Figure 4

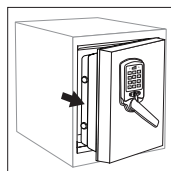

Figure 5

5. Remove override access key and store it in a safe place away from the safe. Replace the cover over the key lock, leave safe door open, and proceed to “Install Batteries”.

INSTALL BATTERIES

The batteries must be installed before using your safe. The battery compartment is located inside the safe on the lock cover panel.

1. Remove battery compartment cover and insert 4 “AA” batteries. Make sure that the batteries are installed in the correct direction with regard to polarity (+ and -). (Figure 1 & Figure 2).
2. Proper installation of the batteries will cause the keypad to beep once, the red and green LED lights will flash twice and the keypad back light will flash once.
3. Replace the battery cover (Figure 3).
4. Leave the door open. Proceed to the “Testing Digital Lock” section on next page.

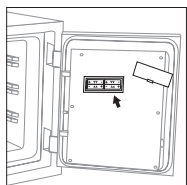

Figure 1

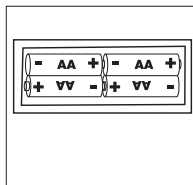

Figure 2

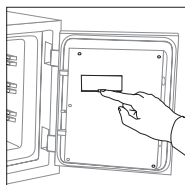

Figure 3

TESTING DIGITAL LOCK

1. With the door open: press and hold the lock release button on the inside edge of the safe door and while holding, turn the handle downward clockwise to place the bolts in the locked position (Figure 1 and Figure 2).
2. Press the * key to activate the digital keypad (Figure 3).

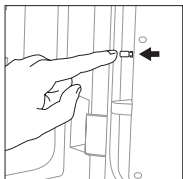

Figure 1

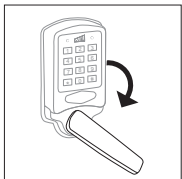

Figure 2

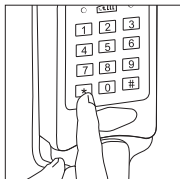

Figure 3

Note: Once the * key is pressed, keypad back-light will turn on for 5 seconds. The keypad will remain active for a period beyond the five seconds even when the back-light turns off. Once any key is pressed, the back-light will come back on again.

3. Enter the preset factory code 159# into the keypad. If entered correctly, the green LED will light and the lock will click. You have 5 seconds to turn the handle upwards counterclockwise placing the bolts into the unlocked position.

Important: If the handle will not turn upwards after the green light comes on, first turn the handle slightly back to the left until it stops, then turn upwards counterclockwise again to open.

4. Press and hold the lock release button on the inside edge of the safe door and while holding, turn the handle downwards clockwise to return the bolts to the locked position
5. Leave the safe door open and proceed to "Programming New User Code".

PROGRAMMING NEW USER CODE

For best security, it is recommended that you immediately change the factory preset code to your own personal user code.

1. Locate and press the reset program button located on the top inside edge of the door (Figure 1).
The red and green LED's will flash and you will have 10 seconds to perform the next 2 steps.
 2. Enter a new 3-8 digit user code followed by the # key. Then immediately repeat the same entry followed by the # key to confirm (Figure 2).
 3. The Green LED will light for 5 seconds indicating you have successfully programmed your new user code (Figure 3).
- Note:** If the red LED lights for 5 seconds and the keypad beeps 3 times, this means that you have made an incorrect entry and must repeat steps 1 and 2.
4. Leave door open and proceed to "Testing New User Code" section.

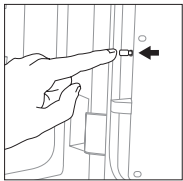

Figure 1

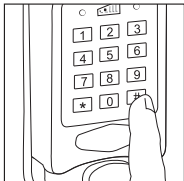

Figure 2

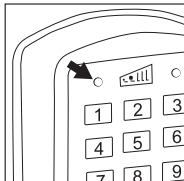

Figure 3

Note: If you wish to change your user code, just repeat steps 1-3. The previous user code will be automatically deleted and the new user code will become active.

TESTING NEW USER CODE

1. With the door open, press the * key to activate the digital keypad (Figure 1).

Note: Once the * key is pressed, keypad back-light will turn on for 5 seconds. The keypad will remain active for a period beyond the five seconds even when the back-light turns off. Once any key is pressed, the back-light will come back on again.

2. Enter your new user code into the keypad followed by the # key. If entered correctly, the green LED will light and the lock will click. You have 5 seconds to open the safe by turning the handle upwards counterclockwise placing the bolts into the unlocked position (Figure 2).

Important: If the handle will not turn upward after the green light comes on, first turn the handle slightly back to the left until it stops, then turn upward counterclockwise again to open.



Figure 1

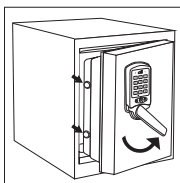

Figure 2

LOCKING AND UNLOCKING THE SAFE

1. Close the safe door and turn handle downward to the left placing the door bolts into the locked position (Figure 1 and Figure 2).

Note: Due to the airtight seal, to close you may have to push inward on the door while turning the handle downward clockwise to place the bolts fully into the locked position.

2. Safe will automatically lock after 5 seconds.
3. Check to ensure safe is locked by attempting to turn the handle to the unlocked position.

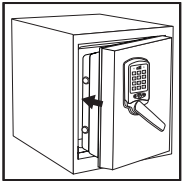

Figure 1

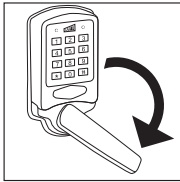

Figure 2

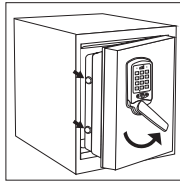

Figure 3

Note: You can record your new user code on the “Digital User Code Record” section on page 9 and then keep this manual in a secure location away from the safe.

TURN SOUND ON AND OFF

If you desire to deactivate the sound on the keypad you can follow the steps below.
Enter # 5 # on the keypad to turn off the sound. Re-enter # 5 # to turn the sound back on.

Note: If when entering your code or programming a new user code you do not hear the key beep, enter # 5 # to activate the sound.

MOTION ALARM SETTINGS

This safe is equipped with a motion sensor alarm that detects sudden jolts, violent shaking and vibrations. If you want to use the alarm feature, you must activate it by following the steps below.

There are three levels of sensitivity to choose from:

- Low Sensitivity
- Medium Sensitivity
- High Sensitivity
- Turn Off Alarm

Setting the motion alarm

1. Open door
2. Press the reset button and press one of the following options for alarm loudness:
 - Low: #1#
 - Medium: #2#
 - High: #3#
 - To turn off the alarm press #0#
3. Your desired alarm settings will be active after the battery lights on the LED go on then off.

SECURE LOCKOUT PERIOD

If the wrong user code is entered 3 consecutive times in a row, the keypad will automatically lockout and will not be able to open the safe with the keypad for 15 minutes. During this period, the safe can be opened and locked with the Override Access key.

LOST OR FORGOTTEN USER CODES

If the user code is lost or forgotten, you may open the safe using the Override Access key and use the red reset button to reprogram the 3-8 digit user code. The instructions for opening the safe with the override access key are located below.

OVERRIDE ACCESS KEY

Your safe is equipped with an Override Access key which allows immediate access in case you forget your user codes or the batteries need to be installed or replaced.

1. Remove override access rubber lock cover (Figure 1).
2. Insert the override access key into the lock until it stops (Figure 2).
3. With the key inserted turn clockwise to the right (Figure 3).
4. Turn the door handle upwards counterclockwise and pull the safe door open (Figure 4 & Figure 5).

IMPORTANT: IF THE HANDLE WILL NOT TURN UPWARDS COUNTERCLOCKWISE, FIRST TURN THE HANDLE SLIGHTLY BACK TO THE LEFT UNTIL IT STOPS, THEN TURN UPWARDS COUNTERCLOCKWISE AGAIN TO OPEN.

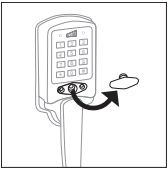

Figure 1

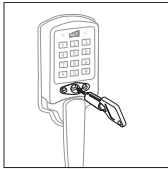

Figure 2

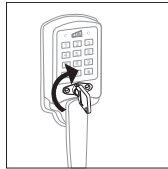

Figure 3



Figure 4

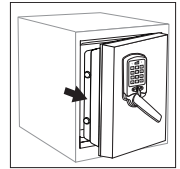

Figure 5

REMOVABLE SHELF

The safe comes with a shelf that can be placed in any of the three preset levels or completely removed if not needed. To remove the shelf, slide it gently out of the safe. To install the shelf, slide it in on any of the three preset levels.

ANCHORING SAFE TO FLOOR

You may bolt your safe to a shelf or floor for added theft protection and resistance to tipping. Your safe has a pre-drilled bolt-down hole in the floor panel and mounting hardware is provided for securing to concrete surfaces. If bolting to wood or metal additional hardware will be needed. Check with your local home center.

To secure your safe to a concrete floor:

1. Select a suitable and convenient location for your safe (Figure 1).
2. Empty the safe and remove the (6) screws securing the mounting hole cover plate (Figure 2).
3. Remove the mounting hole cover plate and gasket along with the cap to uncover the mounting hole (Figure 3).
4. Tilt the safe onto its back side and stick a screwdriver into the hole to punch-out the bottom hole cover plug (Figure 4).
5. Turn safe back onto its feet and place your safe in the desired location for mounting, then make a mark through the hole onto the floor surface creating a drilling guide (Figure 5).
6. Move the safe aside to clear the marked spot for drilling. Then drill a 5/8 in./16mm diameter hole with a depth of 21/8 in./54mm and remove any excess dust (Figure 6 and Figure 7).
7. Insert the supplied expanding Drop-in Anchor into the hole and tap into place using a hammer until even with the floor surface (Figure 8).
8. Hammer a drift punch or phillips head screwdriver into the expanding Drop-in Anchor so that it flares out and firmly locks into place to prevent it from turning when mounting the safe (Figure 9).
9. Place the safe back into position lined up over the hole and secure in place using the provided mounting bolt. Secure bolt tightly using the supplied hexagon wrench (Figure 10).
10. Replace the gasket and mounting plate cover by using a phillips screwdriver to replace the 6 screws to secure the mounting plate into place (Figure 11).

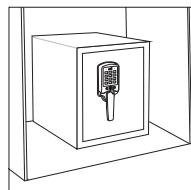

Figure 1

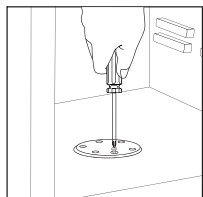

Figure 2

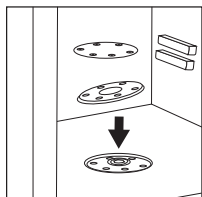

Figure 3

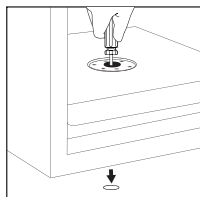

Figure 4

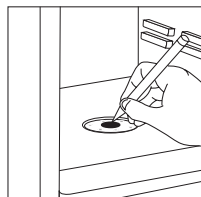

Figure 5

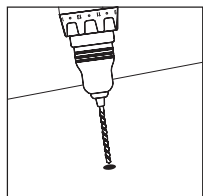

Figure 6

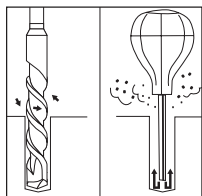

Figure 7

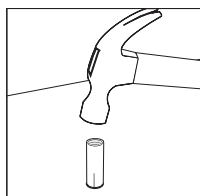

Figure 8

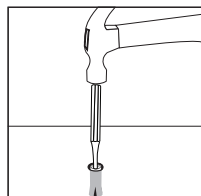

Figure 9

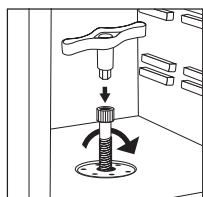

Figure 10

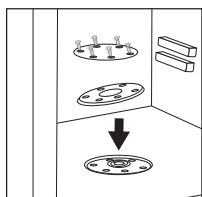

Figure 11

Important: Bolting/unbolting of the unit is at the consumer's expense and discretion. LH Licensed Products, Inc. is not responsible for any costs incurred if the unit has to be replaced.

If you have any questions about mounting the safe, please check with your local home center/hardware retailer or independent contractor.

ORDERING ADDITIONAL OVERRIDE ACCESS KEYS

The following information is required to obtain a Key:

1. PROOF OF OWNERSHIP (1 of 2 Options Below)

SALES RECEIPT & IDENTIFICATION - INTERNATIONAL ORDERS ONLY!

- Copy of sales receipt showing Store, Date & Product Description.
- Copy of your picture I.D. (Drivers license, passport, regular I.D.).

PRODUCT OWNERSHIP VERIFICATION FORM

If sales receipt is not available, contact us by email or telephone to request a "Product Ownership Verification Form".

2. CONTACT & PRODUCT INFORMATION

CONTACT INFORMATION

- Name & Mailing Address
- E-mail address (If Available)
- Telephone Number
- Best Time to Contact You

PRODUCT INFORMATION

- Safe Model #
- Safe Serial #

3. METHOD OF PAYMENT

- Telephone: Visa or MasterCard
- Mail: Check or Money Order

NOTE: For pricing please contact Consumer Assistance. Contact information is located on the back cover of this manual.

Terms subject to change without prior notification.

LOCATING SAFE IDENTIFICATION NUMBERS

SERIAL NUMBER

Located on lower right corner on front of safe. (Figure 1)
Do Not Remove Safe I.D. Tags!

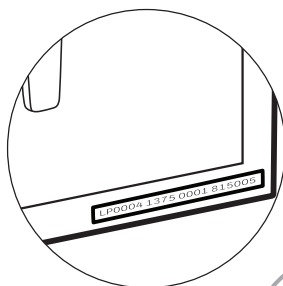

Figure 1

KEY NUMBER

3 Digit Number engraved on the lock cylinder (Figure 2).

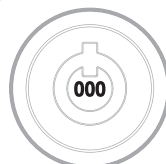

Figure 2