



Inswing Vault Door Installation Instructions

Tools Needed:

Level, ratchet driver, 7/32 allen wrench, 3/16 allen wrench, drill, phillips bit, 5/32 drill bit

Vault door rough opening 82" x 40"

Vault Door Installation in Existing Wall

1. Wall thickness should be 8.0-11.5" (including sheet rock)
2. If the removable interior clamshell trim pieces are bolted to the main door frame, please remove before installation
3. Place vault door and exterior frame in wall opening
4. Push vault door and frame securely against wall.
5. Open the door. Extend the three 3/8-16 x 1.75 allen head set screws on each side of the door frame and the two on the top until they barely make contact with the wall
6. Place the two interior clamshell trim pieces to the left and right sides of the frame by placing the clam shell between the frame and the wall. Make sure the clamshell is tight against the wall
7. Attach the clamshell to the frame using the supplied 3/8-16 x 1 button head socket cap screw
8. Install the top interior clamshell in the same manner as the sides
9. Double check the door is secure and opens freely. Actuate the door locking mechanism to ensure none of the locking pins contact the frame and that the handle rotates freely
10. With the door in the open position, check the internal release. Extend the locking pins and lock the door. Test the release and the interior handle for proper functionality
11. Once the door is secure and opens freely, drill 8 pilot holes for the self-tapping sheet metal screws through the existing holes in each side and top of the frame using the 5/32 drill bit.
12. Drive 8 self-tapping sheet metal screws, 12-14 x 1", through the existing holes in each side and top of the frame and into the pilot holes. This secures the interior and exterior frames together.

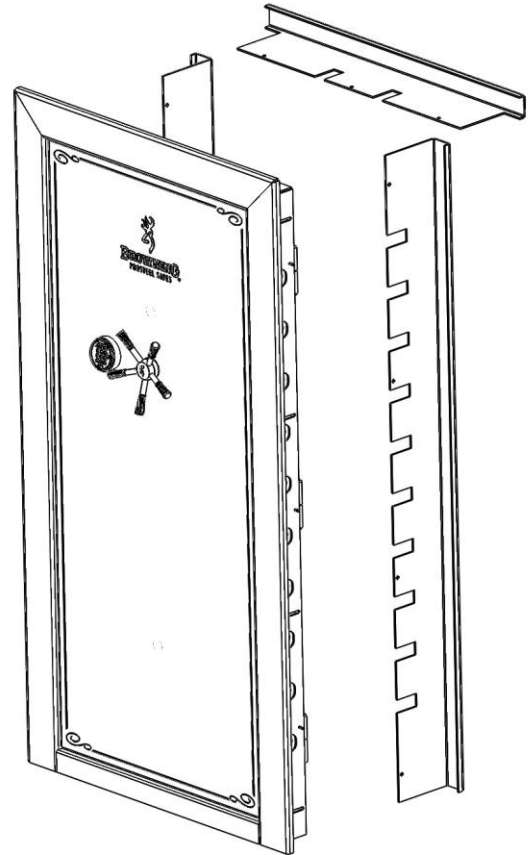



Outswing Vault Door Installation Instructions

Tools Needed:

Level, ratchet driver, 7/32 allen wrench, 3/16 allen wrench, drill, phillips bit, 5/32 drill bit

Vault door rough opening 82" x 40"

Vault Door Installation in Existing Wall

1. Wall thickness should be 8.0-11.5" (including sheet rock).
2. If the removable interior clamshell trim pieces are bolted to the main door frame, please remove before installation.
3. Place vault door and exterior frame in wall opening.
4. Push vault door and frame securely against wall.
5. Open the door. Extend the three 3/8-16 x 1.75 allen head set screws on each side of the door frame and the two on the top until they barely make contact with the wall.
6. Place the two interior clamshell trim pieces to the left and right sides of the frame by placing the clam shell between the frame and the wall. Make sure the clamshell is tight against the wall.
7. Attach the clamshell to the frame using the supplied 3/8-16 x 1 button head socket cap screw.
8. Install the top interior clamshell in the same manner as the sides.
9. Double check the door is secure and opens freely. Actuate the door locking mechanism to ensure none of the locking pins contact the frame and that the handle rotates freely.
10. With the door in the open position, check the internal release. Extend the locking pins and lock the door. Test the release and the interior handle for proper functionality.
11. Once the door is secure and opens freely, drill 8 pilot holes for the self-tapping sheet metal screw through the existing holes in each side and top of the frame using the 5/32 drill bit.
12. Drive 8 self-tapping sheet metal screws, 12-14 x 1", through the existing holes in each side and top of the frame and into the pilot holes. This secures the interior and exterior frames together.

