

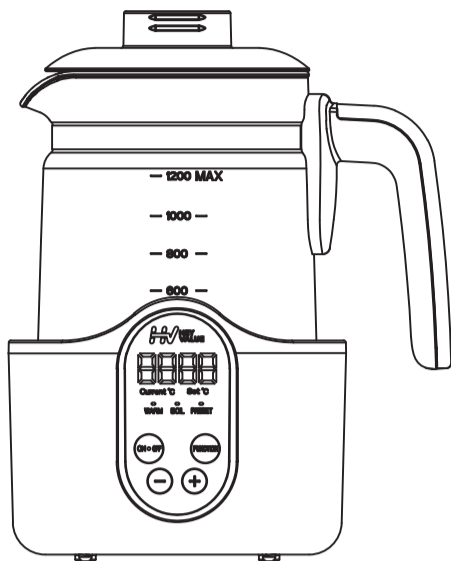

## INSTANT WARMER USER MANUAL



## HEARTFELT THANK YOU

Thank you so much for purchasing from us and placing your trust in our brand. Heyvalue - designed with everyday value. Heyvalue committed to creating modern and thoughtful baby products. We are always passionate and devote to making the ideal products show care and love. Choose HEYVALUE, enjoy your parenthood.

For any questions or issues, please email us:

[Support@heyvaluestore.com](mailto:Support@heyvaluestore.com)

Or SMS **HEYVALUE** to **(833)524-0498**

We will go above and beyond to resolve any customer issue within 24 hours.



Best Regards,  
Jessie  
Founder of HEYVALUE

2

## FEATURES

No more waiting to warm up formula! Simply pour the warm water from HEYVALUE instant warmer into your bottle, scoop the formula and shake. Replaces Traditional Baby Bottle Warmers.

### Touch Control

35-95°C (95-203°F) Temperature control, built in Semiconductor sensing probe & External NTC temperature control probe. Set the desired temperature you need.

### Boil Function

Just choose Boil Function the instant warmer will work as electric kettle be ready to use for tea, oatmeal, coffee, pasta and much more.

### Preset

Choose Preset Function and schedule in advance, feed your baby whenever you need.

## SPECIFICATIONS

Product Name	Instant Warmer
Model	K115
Rated Voltage	120V
Rated Power	600W
Capacity	1.2L
Packing	1pc
Origin	China
Executive Standard	FCC and FDA
Recommended Room Temperature	15°C~30°C
Recommended Humidity	50%~80%

3

## DANGEROUS

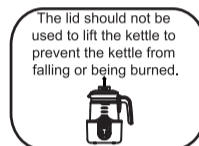
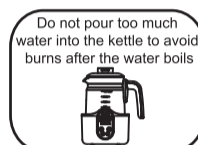
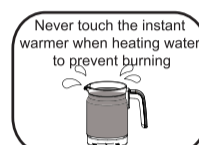
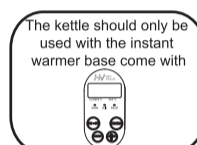

\*If the machine is out of work, please contact HEYVALUE Service Team directly and never fix that by yourself.  
\*Never sterilize this product by microwave.

## WARNING

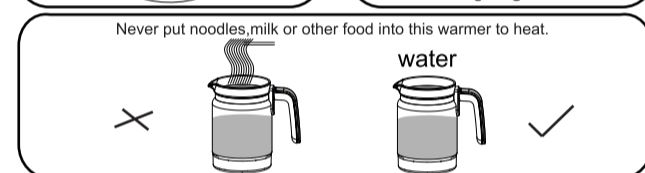
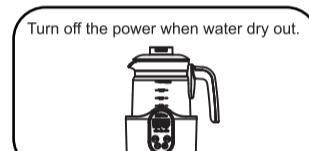
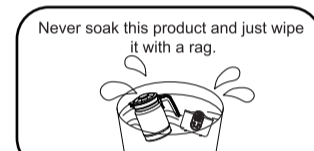

4

## ATTENTION

- \* Before connecting the power supply, make sure that the supply voltage is the same as required voltage for the instant warmer.
- \* Make sure that plug the product in a grounded outlet well.
- \* Keep the power cord away from high temperature or sharp objects. Do not use this product if power cord or product is damaged.
- \* Please unplug the power and wait for it to cool down before cleaning.
- \* Please don't fill the kettle with carbonated drinks.
- \* It is normal if there remains smell of material out of box. Please clean the product according to the user manual before using it for first time.
- \* Unplug the power when not in use, dry in time after cleaning it.
- \* This product is for indoor use only.

## PANEL DESCRIPTION



- “ON/OFF” Button: Turn ON/Turn OFF;
- “KEEP WARM” Button: Keep warm at target temperature all day and night till water dry out;
- “BOIL” Button: Boil Water;
- “PRESET” Button: set the time/temperature to warm water in advance;

**\*Note:**  
Due to differences in regional atmospheric pressure, the boiling point may be lower or higher than 100°C(212°F).

## OPERATION

- \* Before use, make sure the instant warmer is clean.
- \* When using it for the first time, please boil the water and pour it out for sterilizing.
- \* Do not add water beyond the maximum level to prevent burning.
- \* Food should not be heated for too long.
- \* Before feeding, shake the milk well and make sure the temp is suitable for feeding by sprinkling a few drops of formula on the inside of your waist.

5

## CLEANING

- 1) Please unplug the power and wait for it to cool down before cleaning.
- 2) Never soak this product and just wipe it with a rag

## DESCALING

**It is recommended to descale the instant warmer every four weeks to ensure it continues to work efficiently.**

1. Mix 10g citric acid cleaner with 200ml/7oz of cold water to descale the instant warmer. Turn on the instant warmer, select the “BOIL” function then wait for 2-3 minutes after boiling, the descaling is completed.

2. Mix 50ml/1.7 oz of white vinegar with 100ml/3.5oz of cold water to descale the instant warmer. Switch on the instant warmer, select the “BOIL” function then wait for 10 minutes after boiling. Leave the solution in the instant warmer until all scale has dissolved.

### NOTE:

- 1) Never dry out.
- 2) Do not use other types of descalers.

**If you still see traces of scale after rinsing, repeat the descaling procedure.**

7

## OPERATION

It is highly recommended to use purified or distilled water to prevent scales. When you plug in the power, you will hear a “Beep” sounds, screen light up for 2 seconds then shut off.

1. **ON/OFF:** Touch the ON/OFF button, power light is on and screen shows “----”. The product will automatically shut off if there is no operation within 30 seconds.
2. **Warm:** Touch “FUNCTION” button to choose the “WARM” function. The device will keep water warm at set temperature. Adjust the temperature by “+”, “-” and adjustable range is 35-95°C (95-203°F). Press “+” or “-” once to change 1 °C, long press to fast forward. The default set temperature is 45°C (113°F). It will beep 6 times when current temperature reach set temperature. It will remember last times setting temperature if power haven't been unplug ever since.
3. **Boil:** Touch “FUNCTION” button to choose the “BOIL” function. The instant warmer will first boil water then keep water warm at your set temperature. The instant warmer will start to work after the set temperature on the screen flash 3 times. After the water is boiled, the device will beep 6 times and automatically enters the “Keep Warm” mode. During the working process, if you press the “ON/OFF” button, it will stop working.
4. **Preset:** Touch “FUNCTION” button to choose the “PRESET” function. Then press the “+” or “-” button once to enter the preset mode. The time can be adjusted from 0 to 24 hours, short press one time to change one hour, long press to fast forward. The preset function light flashes and the screen shows the time you set. After adjusting the time:

A: Press the “FUNCTION” button again to choose boil or warm function you want to preset. It will enter the preset state 3 seconds and the screen will display the countdown. The selected function light and the “PRESET” light are both on continuously. After the countdown is over, preset light will be off, device will beeps 6 times to remind you the machine starts working.

B: Press the “ON /OFF ” to stop working.

C: Product will shut down if there no operation within 30s.

6

## WARRANTY & CUSTOMER SERVICE

**HEYVALUE** strives for user friendly products for newborn and household items. We aim not only to create a product, but also an item that is filled with care love from us to our customers. If you have any issues at all, please contact us directly at [support@heyvaluestore.com](mailto:support@heyvaluestore.com) and we will help you out.

Or SMS **HEYVALUE** to **(833)524-0498**



## Registry Warranty

At **HEYVALUE** we only produce first class level products, but please registry your warranty just in case at:

<https://heyvaluestore.com/warranty>



8