

2024

Price List
Version 4-A



Brands by Page #

Pg. 1 - 6  | Forever Hardware Pricing

Pg. 7 - 18  | Coastal Bronze Pricing

Pg. 19 - 22  | Seaside Shutter Hardware Pricing

Pg. 23 - 24  | HRVents Pricing

Pg. 25 - 32  | Hardware International Pricing

Retail Price List - 2024

Terms & Conditions

Ordering Information

Place orders via Email or Fax:
Email: Orders@CoastalBronze.com
Fax: 1 (888) 778-7889
Please contact us for minimum order quantity depending on the product.

Pricing Information

All prices shown are List/Retail in US (\$) Dollars. Shipping and Handling will be billed on Invoice. Prices are subject to change without notice. Due to M.A.P., all vendors must not sell below 15% off of List/Retail Price.

Claims

All claims for defective merchandise, billing, damage, loss, or shipping errors must be made with 10 business days after receipt.

Drop Ship Policy

Coastal Bronze does Drop Ship for customers. However, customer takes full responsibility for product shipped to non-original business address. Additional charges may apply.

Payment

Terms are Credit Card or Net 30 with approval.
All Payments made to:
Coastal Bronze
1103 Lawrence Drive, Ste A
Newbury Park, CA 91320
Coastal Bronze reserves the right to change terms at any time. Finance charges may apply for late payments or Credit Cards.
\$20 will be charged for NSF checks.

Shipping Information

Coastal Bronze will use the best way available at ship time.
Rush fulfillment (24 hours) available for \$50 or 10% net, whichever is greater.

Cancellations

Orders may be cancelled prior to shipping. If the order has already shipped, customers can return with a 10% restocking fee. Custom order cancellations require approval.

Returns

All returns must be issued an RGA number. COD Shipments will not be accepted. Customer pays return freight/shipping charges.

Unopened: 60 Days to Return;
10% Restocking Fee

Opened/Undamaged: 60 Days to Return; 20% Restocking Fee. After 60 days RGAs are subject to approval.

Installed/Damaged: Not Returnable

Limited Warranty

5 Year Warranty: for defects on all non-locking goods from Invoice date.

1 Year Warranty: for defects and craftsmanship on all locking goods.

2 Year Finish Warranty: See full terms/conditions for full warranty.

For warranty to be applicable product must be regularly maintained. If active, it must be lubricated and operated occasionally to prevent buildup or damage.

These warranties extend to the original purchaser and original installation site only.

These terms and conditions have been simplified for this price list.

See www.CoastalHardware.com/pages/terms for more details & more information on maintenance and care.

www.CoastalHardware.com

P: 1-877-227-6603 | E: Orders@CoastalBronze.com | F: 1-888-778-7889

FOREVER HARDWARE



Modern Smooth Bronze Gate, Door, & Cabinet Hardware

Please visit our website for the most up-to-date product list. New products and finishes are regularly added.

www.CoastalHardware.com/pages/new-products

or

www.ForeverHardware.com

www.CoastalHardware.com

1103 Lawrence Drive, Ste A, Newbury Park, CA 91320

P: 1-877-227-6603 | **E:** Orders@CoastalBronze.com | **F:** 1-888-778-7889

Finishes & Samples

The entire product line is available in the 4 finishes below. Simply add a dash and the finish letter to the end of any SKU.

Example: F1-400-25-DUM --> F1-400-25-DUM-C



All finishes can be ordered as a physical sample chip at no cost, just pay freight. Please contact us for availability.

(M) Midnight	(C) Champagne	(P) Platinum	(E) Espresso
Stocked	6-8 Weeks	6-8 Weeks	Stocked
5-7 Days	Lead Times		5-7 Days

See terms and conditions for preventative maintenance instructions and warranty information.

Forever Hardware - Retail Price List - 2024

SKU	Price	F1's - Name / Description
F1-101-00-LH	\$383.00	Passage Drop Bar Latch - 5" - LH
F1-101-00-RH	\$383.00	Passage Drop Bar Latch - 5" - RH
F1-400-00-BAR-LH	\$354.00	Case Latch - Bar Side Only - Square - LH
F1-400-00-BAR-RH	\$354.00	Case Latch - Bar Side Only - Square - RH
F1-400-00-SET-LH	\$551.00	Case Latch - Drop Bar Set - Square - LH
F1-400-00-SET-RH	\$551.00	Case Latch - Drop Bar Set - Square - RH
F1-400-00-DUM	\$396.00	Case Latch Square - Dummy Set
F1-401-00-BAR-LH	\$354.00	Case Latch - Bar Side Only - Arch - LH
F1-401-00-BAR-RH	\$354.00	Case Latch - Bar Side Only - Arch - RH
F1-401-00-SET-LH	\$551.00	Case Latch - Drop Bar Set - Arch - LH
F1-401-00-SET-RH	\$551.00	Case Latch - Drop Bar Set - Arch - RH
F1-401-00-DUM	\$396.00	Case Latch Arch - Dummy Set
F1-405-00-BAR-LH	\$354.00	Case Latch - Bar Side Only - Bevel - LH
F1-405-00-BAR-RH	\$354.00	Case Latch - Bar Side Only - Bevel - RH
F1-405-00-SET-LH	\$551.00	Case Latch - Drop Bar Set - Bevel - LH
F1-405-00-SET-RH	\$551.00	Case Latch - Drop Bar Set - Bevel - RH
F1-405-00-DUM	\$396.00	Case Latch Beveled - Dummy Set
F1-410-00-BAR-LH	\$317.00	Case Latch Narrow - Bar Side Only - Square - LH
F1-410-00-BAR-RH	\$317.00	Case Latch Narrow - Bar Side Only - Square - RH
F1-410-00-SET-LH	\$511.00	Case Latch Narrow - Drop Bar Set - Square - LH
F1-410-00-SET-RH	\$511.00	Case Latch Narrow - Drop Bar Set - Square - RH
F1-410-00-DUM	\$387.00	Case Latch Narrow - Dummy Set
F1-420-00-BAR-LH	\$382.00	Case Latch BS 2" - Bar Side Only - Square - LH
F1-420-00-BAR-RH	\$382.00	Case Latch BS 2" - Bar Side Only - Square - RH
F1-420-00-SET-LH	\$586.00	Case Latch BS 2" - Drop Bar Set - Square - LH
F1-420-00-SET-RH	\$586.00	Case Latch BS 2" - Drop Bar Set - Square - RH
F1-420-00-DUM	\$409.00	Case Latch Square BS 2" - Dummy Set
F1-500-00-BAR-LH	\$366.00	Drop Bar on Vertical Plate - Bar Side Only - LH
F1-500-00-BAR-RH	\$366.00	Drop Bar on Vertical Plate - Bar Side Only - RH
F1-500-00-SET-LH	\$527.00	Drop Bar on Vertical Plate - Set - LH
F1-500-00-SET-RH	\$527.00	Drop Bar on Vertical Plate - Set - RH
F1-500-00-DUM	\$323.00	Vertical Plate - Dummy Set
F1-550-00-BAR-LH	\$366.00	Horizontal Drop Bar - BS 2" - Bar Side Only - LH
F1-550-00-BAR-RH	\$366.00	Horizontal Drop Bar - BS 2" - Bar Side Only - RH
F1-550-00-SET-LH	\$527.00	Horizontal Drop Bar - BS 2" - Set - Square - LH
F1-550-00-SET-RH	\$527.00	Horizontal Drop Bar - BS 2" - Set - Square - RH
F1-550-00-DUM	\$323.00	Horizontal Plate BS 2" - Dummy Set
F1-555-00-BAR-LH	\$366.00	Horizontal Drop Bar - BS 2-3/8" - Bar Side Only - LH
F1-555-00-BAR-RH	\$366.00	Horizontal Drop Bar - BS 2-3/8" - Bar Side Only - RH
F1-555-00-SET-LH	\$527.00	Horizontal Drop Bar - BS 2-3/8" - Set - Square - LH

Please see our website for more new products, finishes, and information.

P: 1-877-227-6603 | **E:** Orders@CoastalBronze.com | **F:** 1-888-778-7889

Forever Hardware - Retail Price List - 2024

SKU	Price	F1's - Name / Description
F1-555-00-SET-RH	\$527.00	Horizontal Drop Bar - BS 2-3/8" - Set - Square - RH
F1-555-00-DUM	\$323.00	Horizontal Drop Bar - BS 2-3/8" - Dummy Set
SKU	Price	F2's - Name / Description
F2-200	\$51.00	Standard Gate Latch - Specify Straight or Offset Catch
F2-220	\$88.00	Heavy Gate Latch - Specify Straight or Offset Catch
F2-230	\$138.00	Drop Bar with Knob - 8"
F2-235	\$135.00	Drop Bar without Knob - 8"
F2-240	\$92.00	Small Drop Bar with Knob - 6-1/4"
F2-250	\$21.00	Mortise Strike for Drop Bars & Case Latches
F2-260	\$27.00	Reverse Mortise Strike, 1-3/4" Door
F2-261	\$27.00	Reverse Mortise Strike, 2-1/4" Door
F2-262	\$27.00	Reverse Mortise Strike, 3" Door
F2-300	\$110.00	Thumb Latch Square - 8"
F2-301	\$98.00	Pull Handle Square - 8"
F2-305	\$110.00	Thumb Latch Arch - 8"
F2-306	\$98.00	Pull Handle Arch - 8"
F2-307	\$199.00	Thumb Latch on Back Plate - 8"
F2-307-DUM	\$199.00	Pull on Back Plate - 8" Dummy
F2-309	\$274.00	Thumb Latch on Back Plate - 12"
F2-309-DUM	\$274.00	Pull on Back Plate - 12" Dummy
F2-312	\$46.00	Thumb Latch Rectangular - 8-1/4"
F2-313	\$38.00	Rectangular Pull - 8-1/4"
F2-315	\$27.00	5" Extension Kit for All Single Thumb Latches
F2-330-A	\$364.00	Double Handle Thumb Latch Arch - 1-1/2"-1-7/8"
F2-335-A	\$364.00	Double Handle Thumb Latch Arch - 2"-2-3/8"
F2-340-A	\$364.00	Double Handle Thumb Latch Arch - 2-1/2"-2-7/8"
F2-345-A	\$364.00	Double Handle Thumb Latch Arch - 3"-3-3/8"
F2-347-A	\$364.00	Double Handle Thumb Latch Arch - 3-1/2"-3-7/8"
F2-348-A	\$364.00	Double Handle Thumb Latch Arch - 4"-6-1/2"
F2-330-S	\$364.00	Double Handle Thumb Latch Square - 1-1/2"-1-7/8"
F2-335-S	\$364.00	Double Handle Thumb Latch Square - 2"-2-3/8"
F2-340-S	\$364.00	Double Handle Thumb Latch Square - 2-1/2"-2-7/8"
F2-345-S	\$364.00	Double Handle Thumb Latch Square - 3"-3-3/8"
F2-347-S	\$364.00	Double Handle Thumb Latch Square - 3-1/2"-3-7/8"
F2-348-S	\$364.00	Double Handle Thumb Latch Square - 4"-6-1/2"
F2-400	\$92.00	Bar Latch
F2-410	\$60.00	Gate Mortise Lock Plates - 2 Piece Set
F2-420	\$138.00	Locking Bar Latch - 6"
F2-500	\$95.00	Surface Slide Bolt - 5"
F2-501	\$102.00	Surface Slide Bolt - 6"

Please see our website for more new products, finishes, and information.

P: 1-877-227-6603 | **E:** Orders@CoastalBronze.com | **F:** 1-888-778-7889

Forever Hardware - Retail Price List - 2024

SKU	Price	F2's - Name / Description
F2-510	\$18.00	Mortise Strike for Slide Bolts
F2-550	\$59.00	Gate Stop
F2-552	\$45.00	Gate Stop Heavy - Edge Mount
F2-560	\$16.00	Door Stud - Round - 1-1/4"
F2-565	\$11.00	Door Stud - Round - 1"
F2-570	\$16.00	Door Stud - Square - 1-1/4"
F2-575	\$11.00	Door Stud - Square - 1"
F2-800	\$350.00	Cane Bolt - 20" - 4" Throw
F2-800-K	\$19.00	Cane Bolt Keeper - Universal
F2-800-S	\$19.00	Cane Bolt Keeper - Square
F2-805	\$30.00	Cane Bolt Floor Cup
F2-808	\$113.00	Cane Bolt Ground Disk
F2-810	\$407.00	Cane Bolt - 23" - 8" Throw - Long Throw
SKU	Price	F4's - Name / Description
F4-250	\$123.00	Pintle on Plate
F4-310	\$298.00	T-Band Hinge - Comes with Pintle On Plate
F4-312	\$298.00	Band Hinge - 12" - Comes with Pintle On Plate
F4-317	\$379.00	Band Hinge - 17" - Comes with Pintle On Plate
F4-324	\$483.00	Band Hinge - 24" - Comes with Pintle On Plate
F4-330	\$521.00	Band Hinge - 30" - Comes with Pintle On Plate
F4-380-LH	\$558.00	Loose Pin Band Hinge 18" -With Pintle - LH
F4-380-RH	\$558.00	Loose Pin Band Hinge 18" -With Pintle - RH
F4-381-LH	\$844.00	Loose Pin Band Hinge 30" -With Pintle - LH
F4-381-RH	\$844.00	Loose Pin Band Hinge 30" -With Pintle - RH
F4-410	\$59.00	Template Hinge - 4" x 4" - Button Tip
F4-420	\$75.00	Template Hinge - 4-1/2" x 4-1/2" - Button Tip
F4-423	\$160.00	Heavy Cast Butt Hinge - 4-1/2" X 4-1/2" - Button Tip
F4-430	\$168.00	Heavy Cast Butt Hinge - 5" X 4-1/2" - Button Tip
F4-445	\$63.00	T-Hinge Band - 5-3/4"
F4-446	\$113.00	T-Hinge Band - Long - 11-3/4"
F4-455	\$160.00	Spring Hinge - PVD - 4-1/2" x 4-1/2"
F4-500	\$241.00	Heavy Duty H-Hinge 4-7/8" x 7" - Button Tip
SKU	Price	F6's - Name / Description
F6-100-00-DUM	\$290.00	Square Plate - 5" x 2-3/4" x 1/4" - Dummy Set
F6-100-00-PAS	\$315.00	Square Plate - 5" x 2-3/4" x 1/4" - Passage Set
F6-104-00-DUM	\$290.00	Arch Plate - 5" x 2-3/4" x 1/4" - Dummy Set
F6-104-00-PAS	\$315.00	Arch Plate - 5" x 2-3/4" x 1/4" - Passage Set
F6-105-00-DUM	\$290.00	Beveled Plate - 5" x 2-3/4" x 1/4" - Dummy Set
F6-105-00-PAS	\$315.00	Beveled Plate - 5" x 2-3/4" x 1/4" - Passage Set
F6-400-00-DUM	\$396.00	Case Dummy - Square - Dummy Set

Please see our website for more new products, finishes, and information.

P: 1-877-227-6603 | **E:** Orders@CoastalBronze.com | **F:** 1-888-778-7889

Forever Hardware - Retail Price List - 2024

SKU	Price	F6's - Name / Description
F6-400-00-PAS	\$420.00	Case Passage - Square - Passage Set
F6-401-00-DUM	\$396.00	Case Dummy - Arch - Dummy Set
F6-401-00-PAS	\$420.00	Case Passage - Arch - Passage Set
F6-405-00-DUM	\$396.00	Case Dummy - Bevel - Dummy Set
F6-405-00-PAS	\$420.00	Case Passage - Bevel - Passage Set
F6-500	\$247.00	Deadbolt - Single Cylinder - Square - w/Cover
F6-500-D	\$301.00	Deadbolt - Double Cylinder - Square - w/Cover
F6-520	\$225.00	Deadbolt - Single Cylinder - Small Square - w/Cover
F6-520-D	\$279.00	Deadbolt - Double Cylinder - Small Square - w/Cover
F6-530	\$204.00	Deadbolt - Single Cylinder - Round
F6-530-D	\$258.00	Deadbolt - Double Cylinder - Round
SKU	Price	F8s - Name / Description
F8-300-2	\$24.00	Section Pull - 2"
F8-300-4	\$33.00	Section Pull - 4"
F8-692	\$21.00	Cabinet Knob Bevel Square Base - 1-1/4"
F8-695	\$21.00	Cabinet Knob Flat Top - 1-1/4"
F8-710	\$21.00	Cabinet Knob Beveled - 1-1/4"
F8-720	\$21.00	Cabinet Knob Square - 1-1/4"
F8-731	\$24.00	Cabinet Pull Square - 4" cc
F8-741	\$24.00	Cabinet Pull Twist - 4" cc
F8-830-3	\$24.00	Cabinet Pull Curved - 3" cc
F8-830-4	\$25.00	Cabinet Pull Curved - 4" cc
F8-830-6	\$27.00	Cabinet Pull Curved - 6" cc
F8-830-9	\$32.00	Cabinet Pull Curved - 9" cc
F8-835-12-A	\$91.00	Appliance Pull Curved - 12" cc
F8-844-3	\$24.00	Bar Pull - 3" cc
F8-844-4	\$25.00	Bar Pull - 4" cc
F8-844-6	\$27.00	Bar Pull - 6" cc
F8-844-9	\$32.00	Bar Pull - 9" cc
F8-844-12-A	\$91.00	Appliance Bar Pull - 12" cc
F8-845-3	\$24.00	Tapered Bar Pull - 3" cc
F8-845-4	\$25.00	Tapered Bar Pull - 4" cc
F8-845-6	\$27.00	Tapered Bar Pull - 6" cc
F8-845-9	\$32.00	Tapered Bar Pull - 9" cc
F8-845-12-A	\$91.00	Appliance Tapered Bar Pull - 12" cc
F8-855-3	\$24.00	Flat Top Pull - 3" cc
F8-855-4	\$25.00	Flat Top Pull - 4" cc
F8-855-6	\$27.00	Flat Top Pull - 6" cc
F8-855-9	\$32.00	Flat Top Pull - 9" cc
F8-855-12-A	\$91.00	Appliance Flat Top Pull - 12" cc

Please see our website for more new products, finishes, and information.

P: 1-877-227-6603 | **E:** Orders@CoastalBronze.com | **F:** 1-888-778-7889



The logo features the word "Coastal" in a blue, stylized font with a wave-like underline. Below it, the word "BRONZE" is written in a blue, spaced-out, sans-serif font. The background is a technical drawing of a gate or door with various dimensions and callouts. Dimensions include $\frac{5}{8}$ " and $\frac{1}{2}$ ". Callouts include circled letters B, C, D, and numbers 2, 3, 4. A note "3/16 REF" is also present.

Solid Textured Bronze Gate, Door, Shutter, & Cabinet Hardware

Please visit our website for the most up-to-date product list. New products and finishes are regularly added.

www.CoastalHardware.com/pages/new-products

NON-LATCH SIDE

SIDE OF GATE

LATCH SIDE

www.CoastalHardware.com
1103 Lawrence Drive, Ste A, Newbury Park, CA 91320
P: 1-877-227-6603 | E: Orders@CoastalBronze.com | F: 1-888-778-7889

Finishes

We are excited to introduce 3 new custom finishes to our Coastal Bronze line:
Platinum, Champagne, & Midnight.

These new finishes are custom order only with a **30% upcharge** from list price.
The new finishes are **~8 week lead time** and have a **\$300 minimum order amount**.



If selecting the Original Finish, no finish code is needed, simply use the base SKU.
Simply add a dash and the finish letter to the end of any SKU.

Example: 60-110 --> 60-110-C

(Original Finish)	(P) Platinum	(C) Champagne	(M) Midnight
Stocked	8 Weeks	8 Weeks	8 Weeks
5-7 Days	Lead Times		

Coastal Bronze - Retail Price List - 2024

SKU	Price	20's - Name / Description
20-105	\$20.00	Non-Active Strap Hinge - 5" - Spear
20-108	\$35.00	Non-Active Strap Hinge - 8" - Spear
20-112	\$68.00	Non-Active Strap Hinge - 12" - Spear
20-115	\$94.00	Non-Active Strap Hinge - 15" - Spear
20-120	\$155.00	Non-Active Strap Hinge - 20" - Spear
20-125	\$210.00	Non-Active Strap Hinge - 25" - Spear
20-140-S	\$146.00	Non-Active Band Hinge - 10" - Spear
20-140-A	\$146.00	Non-Active Band Hinge - 10" - Arch
20-140-B	\$146.00	Non-Active Band Hinge - 10" - Bean
20-145-S	\$213.00	Non-Active Band Hinge - 15" - Spear
20-145-A	\$213.00	Non-Active Band Hinge - 15" - Arch
20-145-B	\$213.00	Non-Active Band Hinge - 15" - Bean
20-150-S	\$303.00	Non-Active Band Hinge - 22" - Spear
20-150-A	\$303.00	Non-Active Band Hinge - 22" - Arch
20-150-B	\$303.00	Non-Active Band Hinge - 22" - Bean
20-155-S	\$377.00	Non-Active Band Hinge - 28" - Spear
20-155-A	\$377.00	Non-Active Band Hinge - 28" - Arch
20-155-B	\$377.00	Non-Active Band Hinge - 28" - Bean
20-250	\$123.00	Pintle on Plate
20-251	\$74.00	Screw-In Pintle - 3-1/2"
20-251-H	\$134.00	Screw-In Pintle - 5-1/2" - Heavy
20-252-LH	\$154.00	Jamb Pintle - LH
20-252-RH	\$154.00	Jamb Pintle - RH
20-254	\$155.00	Through Post Pintle
20-255	\$242.00	Pintle in Pipe
20-255-H	\$306.00	Pintle in Pipe - Heavy
20-305	\$124.00	Edge Mount Hinge
20-310	\$176.00	T-Band Hinge
20-312-S	\$176.00	Band Hinge - 12" - Spear
20-312-A	\$176.00	Band Hinge - 12" - Arch
20-312-B	\$176.00	Band Hinge - 12" - Bean
20-317-S	\$257.00	Band Hinge - 17" - Spear
20-317-A	\$257.00	Band Hinge - 17" - Arch
20-317-B	\$257.00	Band Hinge - 17" - Bean
20-324-S	\$360.00	Band Hinge - 24" - Spear
20-324-A	\$360.00	Band Hinge - 24" - Arch
20-324-B	\$360.00	Band Hinge - 24" - Bean
20-330-S	\$435.00	Band Hinge - 30" - Spear
20-330-A	\$435.00	Band Hinge - 30" - Arch
20-330-B	\$435.00	Band Hinge - 30" - Bean

Coastal Bronze - Retail Price List - 2024

SKU	Price	20's - Name / Description
20-350-S	\$178.00	Band Hinge - Small - 12" - Spear - Set with Pintle (20-260)
20-350-A	\$178.00	Band Hinge - Small - 12" - Arch - Set with Pintle (20-260)
20-350-B	\$178.00	Band Hinge - Small - 12" - Bean - Set with Pintle (20-260)
20-380-S-LH	\$629.00	Loose Pin Band Hinge - 17" - Spear - LH
20-380-S-RH	\$629.00	Loose Pin Band Hinge - 17" - Spear - RH
20-380-A-LH	\$629.00	Loose Pin Band Hinge - 17" - Arch - LH
20-380-A-RH	\$629.00	Loose Pin Band Hinge - 17" - Arch - RH
20-380-B-LH	\$629.00	Loose Pin Band Hinge - 17" - Bean - LH
20-380-B-RH	\$629.00	Loose Pin Band Hinge - 17" - Bean - RH
20-381-S-LH	\$844.00	Loose Pin Band Hinge - 30" - Spear - LH
20-381-S-RH	\$844.00	Loose Pin Band Hinge - 30" - Spear - RH
20-381-A-LH	\$844.00	Loose Pin Band Hinge - 30" - Arch - LH
20-381-A-RH	\$844.00	Loose Pin Band Hinge - 30" - Arch - RH
20-381-B-LH	\$844.00	Loose Pin Band Hinge - 30" - Bean - LH
20-381-B-RH	\$844.00	Loose Pin Band Hinge - 30" - Bean - RH
20-390	\$887.00	Driveway Gate Hinge - Edge Mount - 16-1/2"
20-391	\$699.00	Driveway Gate Hinge - Edge Mount - 6-1/2"
20-400	\$951.00	Driveway Gate Hinge - 30" - Spear - Flush Mount
20-405	\$951.00	Driveway Gate Hinge - 30" - Spear - Jamb Mount
20-413	\$200.00	Non-Active Band Hinge - 13" - Spear - Flare 4"
20-422	\$285.00	Non-Active Band Hinge - 22" - Spear - Flare 4"
20-500	\$241.00	Heavy Duty H-Hinge - 4-7/8" x 7" - Bolt
20-501	\$241.00	Heavy Duty H-Hinge - 4-7/8" x 7" - Countersunk
SKU	Price	30's - Name / Description
30-100	\$247.00	Deadbolt - Single Cylinder - Square - w/Cover
30-100-D	\$301.00	Deadbolt - Double Cylinder - Square - w/Cover
30-100-SL	\$392.00	Deadbolt - Single Cylinder Self Latch - Square - w/Cover
30-110	\$247.00	Deadbolt - Single Cylinder - Arch - w/Cover
30-110-D	\$301.00	Deadbolt - Double Cylinder - Arch - w/Cover
30-110-SL	\$392.00	Deadbolt - Single Cylinder Self Latch - Arch - w/Cover
30-120	\$247.00	Deadbolt - Single Cylinder - Euro - w/Cover
30-120-D	\$301.00	Deadbolt - Double Cylinder - Euro - w/Cover
30-120-SL	\$392.00	Deadbolt - Single Cylinder Self Latch - Euro - w/Cover
30-150	\$210.00	Deadbolt - Single Cylinder - Round
30-150-D	\$263.00	Deadbolt - Double Cylinder - Round
30-150-SL	\$290.00	Deadbolt - Single Cylinder Self Latch - Round
30-200	\$226.00	Deadbolt - Single Cylinder - Small - Square - w/Cover
30-200-D	\$280.00	Deadbolt - Double Cylinder - Small - Square - w/Cover
30-200-SL	\$306.00	Deadbolt - Single Cyl. Self Latch - Small - Square - w/Cover
30-250	\$108.00	Patio Bolt - Square Plate

Deadbolts requires thickness and backset.

P: 1-877-227-6603 | **E:** Orders@CoastalBronze.com | **F:** 1-888-778-7889

Coastal Bronze - Retail Price List - 2024

SKU	Price	30's - Name / Description
30-251	\$108.00	Patio Bolt - Arch Plate
30-252	\$108.00	Patio Bolt - Euro Plate
30-265	\$204.00	Deadbolt - Single Cylinder - Square
30-265-D	\$258.00	Deadbolt - Double Cylinder - Square
30-265-SL	\$285.00	Deadbolt - Single Cylinder - Self Latch - Square
30-270	\$204.00	Deadbolt - Single Cylinder - Arch
30-270-D	\$258.00	Deadbolt - Double Cylinder - Arch
30-270-SL	\$285.00	Deadbolt - Single Cylinder Self Latch - Arch
30-275	\$204.00	Deadbolt - Single Cylinder - Euro
30-275-D	\$258.00	Deadbolt - Double Cylinder - Euro
30-275-SL	\$285.00	Deadbolt - Single Cylinder Self Latch - Euro
30-290	\$215.00	Deadbolt - Single Cylinder - Square - Large
30-290-D	\$269.00	Deadbolt - Double Cylinder - Square - Large
30-290-SL	\$296.00	Deadbolt - Single Cylinder Self Latch - Square - Large
30-400	\$118.00	Butt Hinge - 4" X 4" - Button Tip
30-401	\$118.00	Butt Hinge - 4" X 4" - Ball Tip
30-402	\$118.00	Butt Hinge - 4" X 4" - Steeple Tip
30-405	\$168.00	Butt Hinge - 5" X 4-1/2" - Button Tip
30-406	\$168.00	Butt Hinge - 5" X 4-1/2" - Ball Tip
30-407	\$168.00	Butt Hinge - 5" X 4-1/2" - Steeple Tip
30-408	\$181.00	Butt Hinge - 5" X 5" - Button Tip
30-409	\$49.00	Template Hinge - 3-1/2" x 3-1/2" - Button Tip
30-410	\$56.00	Template Hinge - 4" x 4" - Button Tip
30-420	\$65.00	Template Hinge - 4-1/2" X 4-1/2" - Button Tip
30-423	\$151.00	Butt Hinge - 4-1/2" X 4-1/2" - Button Tip
30-423-H	\$172.00	Butt Hinge - 4-1/2" X 4-1/2" - Heavy Duty - Button Tip
30-424	\$151.00	Butt Hinge - 4-1/2" X 4-1/2" - Ball Tip
30-425	\$151.00	Butt Hinge - 4-1/2" X 4-1/2" - Steeple Tip
30-428	\$295.00	Butt Hinge - 6" X 6" - Button Tip
30-430	\$395.00	Butt Hinge - 8" X 8" - Button Tip
30-435	\$124.00	Bifold Hinge - Button Tip
30-440	\$63.00	Gate T-Hinge - Button Tip
30-455	\$160.00	Stainless Spring Hinge - 4-1/2" x 4-1/2" - PVD
30-456	\$142.00	Stainless Spring Hinge - 4" x 4" - PVD
30-465	\$24.00	Cabinet H-Hinge
SKU	Price	40's - Name / Description
40-100-B	\$46.00	Thumb Latch - 7-1/2" - Bean - Slim
40-100-H	\$46.00	Thumb Latch - 8-1/2" - Heart - Slim
40-100-S	\$46.00	Thumb Latch - 8-1/2" - Spear - Slim

Deadbolts requires thickness and backset.

P: 1-877-227-6603 | **E:** Orders@CoastalBronze.com | **F:** 1-888-778-7889

Coastal Bronze - Retail Price List - 2024

SKU	Price	40's - Name / Description
40-105-B	\$38.00	Pull Handle - 7-1/2" - Bean - Slim
40-105-H	\$38.00	Pull Handle - 8-1/2" - Heart - Slim
40-105-S	\$38.00	Pull Handle - 8-1/2" - Spear - Slim
40-300-S	\$110.00	Thumb Latch - 8" - Spade
40-300-B	\$110.00	Thumb Latch - 8" - Bean
40-310-S	\$198.00	Thumb Latch - 10" - Spade
40-310-B	\$198.00	Thumb Latch - 9-1/4" - Bean
40-315	\$27.00	Extension Kit - 5" - For All Thumb Latches
40-330	\$364.00	Double Handle Thumb Latch - 8" - Spade - 1-1/2"-1-7/8"
40-335	\$364.00	Double Handle Thumb Latch - 8" - Spade - 2"-2-3/8"
40-340	\$364.00	Double Handle Thumb Latch - 8" - Spade - 2-1/2"-2-7/8"
40-345	\$364.00	Double Handle Thumb Latch - 8" - Spade - 3"-3-3/8"
40-347	\$364.00	Double Handle Thumb Latch - 8" - Spade - 3-1/2"-4"
40-348	\$364.00	Double Handle Thumb Latch - 8" - Spade - 4-1/8"-6-1/2"
40-350	\$489.00	Double Handle Thumb Latch - 10" - Spade - 1-1/2"-1-7/8"
40-355	\$489.00	Double Handle Thumb Latch - 10" - Spade - 2"-2-3/8"
40-360	\$489.00	Double Handle Thumb Latch - 10" - Spade - 2-1/2"-2-7/8"
40-365	\$489.00	Double Handle Thumb Latch - 10" - Spade - 3"-3-3/8"
40-367	\$489.00	Double Handle Thumb Latch - 10" - Spade - 3-1/2"-4"
40-368	\$489.00	Double Handle Thumb Latch - 10" - Spade - 4-1/8"-6-1/2"
40-400-S	\$98.00	Pull Handle - 8" - Spade
40-400-B	\$98.00	Pull Handle - 8" - Bean
40-410-S	\$198.00	Pull Handle - 10" - Spade
40-410-B	\$198.00	Pull Handle - 9-1/4" - Bean
40-700	\$228.00	Bar Pull Handle - 11-1/2" cc
40-700-D	\$500.00	Bar Pull Handle - 11-1/2" cc - Back to Back
40-710	\$179.00	Bar Pull Handle - 8" cc
40-710-D	\$402.00	Bar Pull Handle - 8" cc - Back to Back
40-725	\$340.00	Bar Pull Handle - 16-1/2" cc
40-725-D	\$723.00	Bar Pull Handle - 16-1/2" cc - Back to Back
40-730	\$81.00	Bar Pull Handle - 8" cc - Euro Bar
40-800	\$168.00	Finger Pull with Handle - Set - 8-7/8" - w/40-730 Pull
40-801	\$255.00	Finger Pull with Handle - Set - 8-7/8" - w/40-710 Pull
40-802	\$168.00	Finger Pull with Handle - Set - 8-7/8" - w/80-825 Pull
SKU	Price	50's - Name / Description
50-100	\$138.00	Drop Bar - 7-1/2" - Square - with Knob
50-125	\$135.00	Drop Bar - 7-1/2" - Square
50-130	\$95.00	Drop Bar - 6-1/2" - Spear - Reverse Bevel
50-135	\$95.00	Drop Bar - 6-1/2" - Square - Reverse Bevel

Coastal Bronze - Retail Price List - 2024

SKU	Price	50's - Name / Description
50-145	\$92.00	Drop Bar - 6-1/2" - Square - with Knob
50-147	\$92.00	Drop Bar - 6-1/2" - Square
50-150	\$92.00	Drop Bar - 6-1/2" - Spear
50-200	\$51.00	Gate Latch - Straight Catch
50-201	\$51.00	Gate Latch - Straight Catch - Lockable
50-205	\$51.00	Gate Latch - Offset Catch
50-206	\$51.00	Gate Latch - Offset Catch - Lockable
50-220	\$88.00	Gate Latch - Straight Catch - Heavy Duty
50-221	\$88.00	Gate Latch - Offset Catch - Heavy Duty
50-240	\$52.00	Standard Gate Stop - Slim
50-250	\$59.00	Standard Gate Stop - Heavy
50-251	\$59.00	Face Gate Stop
50-252	\$45.00	Edge Gate Stop
50-260	\$72.00	Standard Gate Stop - Extended
50-300	\$353.00	Floor Gate Stop - Heavy
50-400	\$92.00	Bar Latch
50-410	\$60.00	Gate Mortise Lock Plates - 2 Piece Set
50-420	\$138.00	Lockable Bar Latch - 6"
50-450	\$56.00	Lockable Hasp - 6"
50-500	\$21.00	Jamb Catch for Drop Bar
50-510	\$55.00	Reverse Bevel Catch for Drop Bar
50-520	\$57.00	Two Way Bevel Catch for Drop Bar
50-600	\$433.00	Cannon Ball Door Closer - 5lb
50-605	\$613.00	Cannon Ball Door Closer - 9lb
50-699	\$48.00	Cabin Hook - 3"
50-700	\$58.00	Cabin Hook - 4-1/2"
50-705	\$71.00	Cabin Hook - 7-1/2"
50-710	\$87.00	Cabin Hook - 10-1/2"
SKU	Price	60's - Name / Description
60-100-00-LH	\$383.00	Passage Drop Bar Latch - 7" - LH
60-100-00-RH	\$383.00	Passage Drop Bar Latch - 7" - RH
60-101-00-LH	\$383.00	Passage Drop Bar Latch - 5" - LH
60-101-00-RH	\$383.00	Passage Drop Bar Latch - 5" - RH
60-105	\$45.00	Ring on Plate - 2"
60-110	\$166.00	Ring Turn on Plate - 3-1/2"
60-200	\$246.00	Ring Turn on Plate - 4-3/4"
60-350-00-LH	\$490.00	Drop Bar on Wide Plate - Euro - LH - Set

Thickness required for gate latch sets.

P: 1-877-227-6603 | **E:** Orders@CoastalBronze.com | **F:** 1-888-778-7889

Coastal Bronze - Retail Price List - 2024

SKU	Price	60's - Name / Description
60-350-00-B-LH	\$176.00	Non-Drop Bar Side Only - On Wide Plate - Euro - LH
60-350-00-F-LH	\$354.00	Drop Bar Side Only - On Wide Plate - Euro - LH
60-350-00-RH	\$490.00	Drop Bar - On Wide Plate - Euro - RH - Set
60-350-00-B-RH	\$176.00	Non-Drop Bar Side Only - On Wide Plate - Euro - RH
60-350-00-F-RH	\$354.00	Drop Bar Side Only - On Wide Plate - Euro - RH
60-360-00-LH	\$490.00	Drop Bar - On Wide Plate - Arch - LH - Set
60-360-00-B-LH	\$176.00	Non-Drop Bar Side Only - On Wide Plate - Arch - LH
60-360-00-F-LH	\$354.00	Drop Bar Side Only - On Wide Plate - Arch - LH
60-360-00-RH	\$490.00	Drop Bar - On Wide Plate - Arch - RH - Set
60-360-00-B-RH	\$176.00	Non-Drop Bar Side Only - On Wide Plate - Arch - RH
60-360-00-F-RH	\$354.00	Drop Bar Side Only - On Wide Plate - Arch - RH
60-361-00-LH	\$810.00	Drop Bar Side - Double - Wide Plate - Arch - LH - Set
60-361-00-RH	\$810.00	Drop Bar Side - Double - Wide Plate - Arch - RH - Set
SKU	Price	70's - Name / Description
70-100	\$511.00	Grill - 14" x 14" - 2 Bar x 3 Bar
70-110	\$467.00	Grill - 14" x 14" - 2 Bar x 2 Bar
70-115	\$242.00	Grill - 14" x 14" - 1 Bar x 1 Bar
70-150	\$726.00	Grill - Curved - Four Point Design
70-200	\$74.00	Window Latch
70-202-LH	\$67.00	Sash Lock - LH
70-202-RH	\$67.00	Sash Lock - RH
70-203	\$68.00	Window Latch - Rat Tail
70-210	\$70.00	Window Stay - 10"
70-212	\$82.00	Window Stay - 12"
70-300	\$134.00	Shutter Bolt - 6-1/2" - Throw 2"
70-300-14	\$210.00	Door Surface Bolt - 14"
70-300-20	\$242.00	Door Surface Bolt - 20"
70-300-24	\$277.00	Door Surface Bolt - 24"
70-500-LH	\$72.00	Shutter Dog - 7" - LH
70-500-RH	\$72.00	Shutter Dog - 7" - RH
70-501	\$75.00	Shutter Dog - 6" - English Rat Tail
70-600	\$207.00	New York Style - 1-1/4" Offset - Paired Set - Pintle Included
70-610	\$242.00	New York Style - 2-1/4" Offset - Paired Set - Pintle Included
70-620	\$110.00	Shutter T-Hinge - 1-1/4" Offset - Pintle Included
70-625	\$128.00	Shutter T-Hinge - 2-1/4" Offset - Pintle Included
70-650	\$129.00	Bahama Shutter Strap - Single - Pintle Included
70-655	\$205.00	Bahama Shutter Strap - Double - Pintle Included
70-680	\$156.00	Bahama Shutter Stay - 20"
70-700	\$130.00	Shutter Strap - 1-1/4" Offset - Pintle Included
70-710	\$149.00	Shutter Strap - 2-1/4" Offset - Pintle Included

Thickness required for gate latch sets.

P: 1-877-227-6603 | E: Orders@CoastalBronze.com | F: 1-888-778-7889

Coastal Bronze - Retail Price List - 2024

SKU	Price	70's - Name / Description
70-800-LH	\$55.00	Jamb Mount Pintle - 1-1/4" Offset - LH
70-800-RH	\$55.00	Jamb Mount Pintle - 1-1/4" Offset - RH
70-805-LH	\$62.00	Jamb Mount Pintle - 2-1/4" Offset - LH
70-805-RH	\$62.00	Jamb Mount Pintle - 2-1/4" Offset - RH
SKU	Price	80's - Name / Description
80-100	\$326.00	Cane Bolt - 20" - 5-1/2" Throw
80-100-32	\$475.00	Cane Bolt - 32" - 5-1/2" Throw
80-100-48	\$590.00	Cane Bolt - 48" - 5-1/2" Throw
80-102	\$56.00	Cane Bolt Locking Plate
80-103	\$113.00	Cane Bolt Ground Disk
80-104	\$28.00	Cane Bolt Floor Cup 1-1/2"
80-105	\$30.00	Cane Bolt Floor Cup 3"
80-110	\$379.00	Cane Bolt - 23" - 8" Throw - Long Throw
80-115	\$914.00	Cane Bolt - 25" - 1" Diameter Rod - Heavy Duty
80-200	\$197.00	Barrel Bolt - 8" - Lockable
80-800	\$31.00	Round Knob - On Plate
80-810	\$31.00	Oval Knob - On Plate
80-820	\$31.00	Cabinet Pull - 4" cc - Surface Mount
80-823	\$31.00	Cabinet Bar Pull - 4" cc
80-824	\$45.00	Cabinet Bar Pull - 6" cc
80-825	\$74.00	Cabinet Bar Pull - 8" cc
80-826	\$116.00	Cabinet Bar Pull - 12" cc
80-827	\$171.00	Cabinet Bar Pull - 17" cc
80-828	\$53.00	Cabinet Utility Pull - 6-1/2"
80-829	\$38.00	Cabinet Utility Pull - 5-1/2"
80-830	\$33.00	Cabinet Bin Pull - 3-3/8" cc - Surface Mount
80-831	\$25.00	Cabinet Pull - 4" cc - Arch
SKU	Price	90's - Name / Description
90-100	\$163.00	Surface Slide Bolt - 8"
90-105	\$95.00	Surface Slide Bolt - 5"
90-110	\$18.00	Mortise Plate for Slide Bolt - 5" & 8"
90-111	\$18.00	Mortise Plate for Slide Bolt - 6-1/2"
90-112	\$18.00	Mortise Plate for Slide Bolt - 4"
90-114	\$20.00	Universal Strike for Slide Bolt - 4" & 6-1/2"
90-115	\$20.00	Universal Strike for Slide Bolt - 5" & 8"
90-200	\$73.00	Surface Slide Bolt - 4"
90-500	\$11.00	Door Stud - 1" - Square
90-505	\$2.00	Door Stud - 1/4" - Square
90-510	\$16.00	Door Stud - 1-1/4" - Square

Door Hardware requires thickness and backset.

P: 1-877-227-6603 | **E:** Orders@CoastalBronze.com | **F:** 1-888-778-7889

Coastal Bronze - Retail Price List - 2024

SKU	Price	90's - Name / Description
90-520	\$11.00	Door Stud - 1" - Crest
90-560	\$11.00	Door Stud - 1" - Round
90-810	\$38.00	Door Stud - 2" - Square
90-860	\$38.00	Door Stud - 2" - Round
SKU	Price	100's - Name / Description
100-00-PAS	\$315.00	Square Plate - 5" - Passage
100-00-PIN	\$315.00	Square Plate - 5" - Privacy
100-00-DUM	\$290.00	Square Plate - 5" - Dummy
102-00-PAS	\$315.00	Square Plate - 5" - Offset Passage
102-00-DUM	\$290.00	Square Plate - 5" - Offset Dummy
105-00-PAS	\$296.00	Square Plate - 2-3/4" - Passage
105-00-DUM	\$269.00	Square Plate - 2-3/4" - Dummy
110-00-PAS	\$395.00	Square Plate - 8" - Passage
110-00-PIN	\$395.00	Square Plate - 8" - Privacy
110-00-DUM	\$369.00	Square Plate - 8" - Dummy
110-00-MOR	\$1,007.00	Square Plate - 8" - Mortise Entry
110-00-DBL	\$1,060.00	Square Plate - 8" - Mortise Double Cylinder Entry
120-00-PAS	\$520.00	Square Plate - 11" - Passage
120-00-PIN	\$520.00	Square Plate - 11" - Privacy
120-00-PRI	\$547.00	Square Plate - 11" - Privacy Bolt
120-00-DUM	\$493.00	Square Plate - 11" - Dummy
120-00-PAT	\$547.00	Square Plate - 11" - Patio Bolt
120-00-ENT	\$653.00	Square Plate - 11" - Entry
120-00-DOU	\$704.00	Square Plate - 11" - Double Cylinder Entry
120-00-MOR	\$1,086.00	Square Plate - 11" - Mortise Entry
120-00-DBL	\$1,121.00	Square Plate - 11" - Mortise Double Cylinder Entry
125-00-PPO	\$242.00	Square Plate - 12" - Plate Only
125-00-PUL	\$388.00	Square Plate - 12" - With Bar Pull
130-00-MOR	\$1,310.00	Square Plate - 18" - Mortise Entry - Thumb Latch
130-00-DUM	\$971.00	Square Plate - 18" - Dummy
SKU	Price	200's - Name / Description
200-00-PAS	\$315.00	Arch Plate - 5" - Passage
200-00-PIN	\$315.00	Arch Plate - 5" - Privacy
200-00-DUM	\$290.00	Arch Plate - 5" - Dummy
210-00-PAS	\$395.00	Arch Plate - 8" - Passage
210-00-PIN	\$395.00	Arch Plate - 8" - Privacy
210-00-DUM	\$369.00	Arch Plate - 8" - Dummy
210-00-MOR	\$1,007.00	Arch Plate - 8" - Mortise Entry
210-00-DBL	\$1,060.00	Arch Plate - 8" - Mortise Double Cylinder Entry
220-00-PAS	\$520.00	Arch Plate - 11" - Passage

Door Hardware requires thickness and backset.

P: 1-877-227-6603 | **E:** Orders@CoastalBronze.com | **F:** 1-888-778-7889

Coastal Bronze - Retail Price List - 2024

SKU	Price	200's - Name / Description
220-00-PIN	\$520.00	Arch Plate - 11" - Privacy
220-00-PRI	\$547.00	Arch Plate - 11" - Privacy Bolt
220-00-DUM	\$493.00	Arch Plate - 11" - Dummy
220-00-PAT	\$547.00	Arch Plate - 11" - Patio Bolt
220-00-ENT	\$653.00	Arch Plate - 11" - Entry
220-00-DOU	\$704.00	Arch Plate - 11" - Double Cylinder Entry
220-00-MOR	\$1,086.00	Arch Plate - 11" - Mortise Entry
220-00-DBL	\$1,121.00	Arch Plate - 11" - Mortise Double Cylinder Entry
225-00-PPO	\$242.00	Arch Plate - 12" - Plate Only
225-00-PUL	\$388.00	Arch Plate - 12" - With Bar Pull
230-00-MOR	\$1,310.00	Arch Plate - 18" - Mortise Entry - Thumb Latch
230-00-DUM	\$971.00	Arch Plate - 18" - Dummy
SKU	Price	300's - Name / Description
300-00-PAS	\$315.00	Euro Plate - 5" - Passage
300-00-PIN	\$315.00	Euro Plate - 5" - Privacy
300-00-DUM	\$290.00	Euro Plate - 5" - Dummy
310-00-PAS	\$395.00	Euro Plate - 8" - Passage
310-00-PIN	\$395.00	Euro Plate - 8" - Privacy
310-00-DUM	\$369.00	Euro Plate - 8" - Dummy
310-00-MOR	\$1,007.00	Euro Plate - 8" - Mortise Entry
310-00-DBL	\$1,060.00	Euro Plate - 8" - Mortise Double Cylinder Entry
320-00-PAS	\$520.00	Euro Plate - 11" - Passage
320-00-PIN	\$520.00	Euro Plate - 11" - Privacy
320-00-PRI	\$547.00	Euro Plate - 11" - Privacy Bolt
320-00-DUM	\$493.00	Euro Plate - 11" - Dummy
320-00-PAT	\$547.00	Euro Plate - 11" - Patio Bolt
320-00-ENT	\$653.00	Euro Plate - 11" - Entry
320-00-DOU	\$704.00	Euro Plate - 11" - Double Cylinder Entry
320-00-MOR	\$1,086.00	Euro Plate - 11" - Mortise Entry
320-00-DBL	\$1,121.00	Euro Plate - 11" - Mortise Double Cylinder Entry
325-00-PPO	\$242.00	Euro Plate - 12" - Plate Only
325-00-PUL	\$388.00	Euro Plate - 12" - With Bar Pull
330-00-MOR	\$1,310.00	Euro Plate - 18" - Mortise Entry - Thumb Latch
330-00-DUM	\$971.00	Euro Plate - 18" - Dummy Entry
SKU	Price	400's - Name / Description
400-00-S-LH	\$551.00	Case Latch - Drop Bar Set - LH
400-00-S-RH	\$551.00	Case Latch - Drop Bar Set - RH
400-00-DUM	\$396.00	Case Latch - No Bar - Dummy Set
400-00-BAR-LH	\$354.00	Case Latch - Bar Side Only - LH
400-00-BAR-RH	\$354.00	Case Latch - Bar Side Only - RH

Door Hardware requires thickness and backset.

P: 1-877-227-6603 | **E:** Orders@CoastalBronze.com | **F:** 1-888-778-7889

Coastal Bronze - Retail Price List - 2024

SKU	Price	500's - Name / Description
500-10	\$106.00	Privacy Bolt
500-25	\$36.00	Door Stop
500-30	\$38.00	Door Stop - Floor
500-50	\$36.00	Edge Pull
500-55	\$51.00	Pocket Door Pull - 4" - Arched
500-57	\$51.00	Pocket Door Pull - 4" - Square
500-58	\$89.00	Pocket Door Pull - 8-7/8" - Square
500-60	\$163.00	Door Knocker - 3-1/2" Diameter
500-61	\$235.00	Door Knocker - 4-3/4" Diameter
500-65	\$70.00	Door Bell - Arch
500-68	\$70.00	Door Bell - Square
SKU	Price	900's - Name / Description
900-00-PAS	\$428.00	Hourglass Plate - 9" - Passage
900-00-DUM	\$404.00	Hourglass Plate - 9" - Dummy
SKU	Price	1000's - Name / Description - Components
1000-010	\$11.00	Dummy Spindle
1000-050	\$4.00	Spindles
1000-100	\$54.00	Bar Pull Back-to-Back Kit
1000-110	\$32.00	Request Keyed Alike - Each Deadbolt
1000-150-H	\$3.00	Lag - Hex - 1-1/2" Long - 5/16" Wide
1000-150-S	\$4.00	Lag - Square - 1-1/2" Long - 5/16" Wide
1000-151-H	\$8.00	Lag - Hex - 2-1/2" Long - 5/16" Wide
1000-151-S	\$6.00	Lag - Square - 2-1/2" Long - 5/16" Wide
1000-200-K/L	\$46.00	Spring Latch - 2" Backset
1000-234-K/L	\$46.00	Spring Latch - 2-3/4" Backset
1000-238-K/L	\$46.00	Spring Latch - 2-3/8" Backset

Door Hardware requires thickness and backset.

P: 1-877-227-6603 | **E:** Orders@CoastalBronze.com | **F:** 1-888-778-7889



Brass Shutter Hardware

Seaside Shutters Hardware Brand Pricing

Please visit our website for the most up-to-date product list. New products and finishes are regularly added.

www.CoastalHardware.com/pages/new-products

www.SeasideShutters.com

1103 Lawrence Drive, Ste A, Newbury Park, CA 91320

P: 1-877-227-6603 | **E:** Orders@CoastalBronze.com | **F:** 1-888-778-7889

Finishes

Polished Brass
03



Unlacquered Brass
03UN



Antique Brass
05



Oil-Rubbed Bronze
10B



Satin Nickel
15



Black
US19



(Stocked Finish)

US19/Black is the **only** stocked finish.

All other finishes are considered **custom**. They have special pricing in the price list under "Custom".

Custom finishes are not returnable except for defective product.

Custom products & finishes have a 6-8 week lead time on average. Please contact us for rush orders.

Most hinges, pintles, and shutter dogs sold individually. Only New York Straps are paired.

Simply add a dash and the finish letter to the end of any SKU.

Example: S7-100--> S7-100-10B

Polished Brass (03) 6-8 Weeks	Unlacquered Brass (03UN) 6-8 Weeks	Antique Brass (05) 6-8 Weeks
Oil-Rubbed Bronze (10B) 6-8 Weeks	Satin Nickel (15) 6-8 Weeks	Black (19) Stocked 5-7 Days
Lead Times		

See terms and conditions for preventative maintenance instructions and warranty information.

Seaside Shutters - Retail Price List - 2024

SKU	Price	Custom	S2's - Name / Description
S2-100-19	\$48.00	\$60.00	Arch Strap - 10" Long - 0" Offset
S2-101-19	\$52.00	\$65.00	Arch Strap - 10" Long - 3/4" Offset
S2-102-19	\$53.00	\$66.00	Arch Strap - 10" Long - 1-1/4" Offset
S2-103-19	\$55.00	\$69.00	Arch Strap - 10" Long - 2-1/4" Offset
S2-200-19	\$61.00	\$76.00	Arch Strap - 14" Long - 0" Offset
S2-201-19	\$62.00	\$78.00	Arch Strap - 14" Long - 3/4" Offset
S2-202-19	\$65.00	\$81.00	Arch Strap - 14" Long - 1-1/4" Offset
S2-203-19	\$67.00	\$83.00	Arch Strap - 14" Long - 2-1/4" Offset
S2-300-19	\$48.00	\$60.00	Bean Strap - 10" Long - 0" Offset
S2-301-19	\$52.00	\$65.00	Bean Strap - 10" Long - 3/4" Offset
S2-302-19	\$53.00	\$66.00	Bean Strap - 10" Long - 1-1/4" Offset
S2-303-19	\$55.00	\$69.00	Bean Strap - 10" Long - 2-1/4" Offset
S2-400-19	\$61.00	\$77.00	Bean Strap - 14" Long - 0" Offset
S2-401-19	\$62.00	\$78.00	Bean Strap - 14" Long - 3/4" Offset
S2-402-19	\$65.00	\$81.00	Bean Strap - 14" Long - 1-1/4" Offset
S2-403-19	\$67.00	\$83.00	Bean Strap - 14" Long - 2-1/4" Offset
S2-450-19	\$52.00	\$65.00	Arch Strap - 10" Long - 3/4" Offset - Reverse
S2-451-19	\$53.00	\$66.00	Arch Strap - 10" Long - 1-1/4" Offset - Reverse
S2-460-19	\$62.00	\$78.00	Arch Strap - 14" Long - 3/4" Offset - Reverse
S2-461-19	\$65.00	\$81.00	Arch Strap - 14" Long - 1-1/4" Offset - Reverse
S2-510-19	\$43.00	\$54.00	Bean Strap - 10" Dummy
S2-514-19	\$57.00	\$71.00	Bean Strap - 14" Dummy
S2-610-19	\$43.00	\$54.00	Arch Strap - 10" Dummy
S2-614-19	\$57.00	\$71.00	Arch Strap - 14" Dummy
SKU	Price	Custom	S3's - Name / Description
S3-100-19	\$83.00	\$103.00	New York Strap - 0" Offset - Paired
S3-101-19	\$85.00	\$106.00	New York Strap - 3/4" Offset - Paired
S3-102-19	\$88.00	\$110.00	New York Strap - 1-1/4" Offset - Paired
S3-103-19	\$90.00	\$113.00	New York Strap - 2-1/4" Offset - Paired
S3-200-19	\$33.00	\$42.00	Arch Strap - T-Hinge - 0" Offset
S3-201-19	\$37.00	\$46.00	Arch Strap - T-Hinge - 3/4" Offset
S3-202-19	\$38.00	\$47.00	Arch Strap - T-Hinge - 1-1/4" Offset
S3-203-19	\$40.00	\$49.00	Arch Strap - T-Hinge - 2-1/4" Offset
SKU	Price	Custom	S4's - Name / Description
S4-400-19	\$24.00	\$30.00	Pintle - 3/4" Offset
S4-410-19	\$29.00	\$37.00	Pintle - 1-1/4" Offset
S4-420-19	\$34.00	\$43.00	Pintle - 2-1/4" Offset
S4-440-19	\$38.00	\$47.00	Pintle - 3/4" Offset - Double
S4-500-LH/RH-19	\$57.00	\$71.00	Jamb Pintle - 1-1/4" Offset - Specify LH/RH
S4-510-LH/RH-19	\$61.00	\$76.00	Jamb Pintle - 2-1/4" Offset - Specify LH/RH
S4-600-19	\$31.00	\$39.00	Screw-In Pintle

Stock Seaside Products come in US19 Black. "Custom" is any other finish (Not US19) and has a 6-8 week lead time.

P: 1-877-227-6603 | **E:** Orders@CoastalBronze.com | **F:** 1-888-778-7889

Seaside Shutters - Retail Price List - 2024

SKU	Price	Custom	S4s - Name / Description
S4-700-19	\$22.00	\$27.00	Drive-In Pintle
S4-710-19	\$6.00	\$6.00	Strap Pintle - Pin Kit
SKU	Price	Custom	S5's - Name / Description
S5-104-19	\$32.00	\$40.00	Cabin Hook - 4-1/2"
S5-107-19	\$42.00	\$53.00	Cabin Hook - 7-1/2"
S5-110-19	\$49.00	\$62.00	Cabin Hook - 10-1/2"
S5-115-19	\$63.00	\$80.00	Cabin Hook - 15"
S5-120-19	\$78.00	\$98.00	Cabin Hook - 20"
S5-200-19	\$42.00	\$53.00	Window Stay - 10"
S5-205-19	\$47.00	\$59.00	Window Stay - 12"
S5-210-19	\$45.00	\$56.00	Window Latch
S5-240-19	\$89.00	\$112.00	Bahama Window Stay - 20"
SKU	Price	Custom	S6's - Name / Description
S6-204-19	\$65.00	\$81.00	Slide Bolt - 4"
S6-206-19	\$88.00	\$110.00	Slide Bolt - 6"
S6-308-19	\$71.00	\$89.00	Slide Bolt - 6" Long Throw - 2" - with Knob
S6-310-19	\$96.00	\$119.00	Slide Bolt - 6" Long Throw - 1-1/4"
S6-330-19	\$24.00	\$30.00	Flip Latch
S6-500-19	\$17.00	\$22.00	Mortise Strike - for S6-204 & S6-308
S6-501-19	\$17.00	\$22.00	Mortise Strike - for S6-206
S6-505-19	\$19.00	\$24.00	Universal Strike - for S6-204 & S6-308
S6-506-19	\$20.00	\$26.00	Universal Strike - for S6-206
SKU	Price	Custom	S7's - Name / Description
S7-100-LH/RH-19	\$33.00	\$42.00	Shutter Dog - S - Specify LH/RH
S7-110-19	\$30.00	\$38.00	Shutter Dog - English Rat Tail
S7-120-19	\$37.00	\$46.00	Shutter Dog - Propeller
S7-130-LH/RH-19	\$37.00	\$46.00	Shutter Dog - Georgian Side - Specify LH/RH
S7-140-19	\$38.00	\$47.00	Shutter Dog - Rat Tail
S7-150-19	\$38.00	\$47.00	Shutter Dog - Georgian
S7-160-19	\$31.00	\$39.00	Shutter Dog - Propeller Round
S7-170-LH/RH-19	\$38.00	\$47.00	Shutter Dog - Diamond Side - Specify LH/RH
S7-180-19	\$102.00	\$128.00	Shutter Dog - French
S7-190-19	\$16.00	\$20.00	Shutter Dog Bar Mount
S7-195-19	\$16.00	\$20.00	Shutter Dog Stand Off
S8-100-19	\$31.00	\$39.00	Square Post
S8-300-LH/RH-19	\$62.00	\$78.00	Horizontal Bar - Offset - Specify LH/RH
S8-325-19	\$62.00	\$78.00	Horizontal Bar
S8-400-19	\$20.00	\$26.00	Ring Pull Plate - 2" x 1-1/4"
S8-410-19	\$22.00	\$22.00	Bullet Catch - 1-1/4"
S8-415-19	\$33.00	\$33.00	Bullet Catch - 3-1/4"
S8-420-19	\$35.00	\$35.00	Bullet Catch - 2-3/4"

Stock Seaside Products come in US19 Black. "Custom" is any other finish (Not US19) and has a 6-8 week lead time.

P: 1-877-227-6603 | **E:** Orders@CoastalBronze.com | **F:** 1-888-778-7889

HR VENTS

Brass & Iron Vents

HRVents Brand Pricing

Please visit our website for the most up-to-date product list. New products and finishes are regularly added.

www.CoastalHardware.com/pages/new-products

www.HRVents.com

1103 Lawrence Drive, Ste A, Newbury Park, CA 91320

P: 1-877-227-6603 | **E:** Orders@CoastalBronze.com | **F:** 1-888-778-7889

HRVents - Retail Price List - 2024

SKU	Price	Iron Vents - Name / Description
XX-210-A-19	\$53.00	Cast Iron Vent - Any Style - Black - 2-1/4" x 10"
XX-212-A-19	\$63.00	Cast Iron Vent - Any Style - Black - 2-1/4" x 12"
XX-214-A-19	\$70.00	Cast Iron Vent - Any Style - Black - 2-1/4" x 14"
XX-310-A-19	\$66.00	Cast Iron Vent - Any Style - Black - 3" x 10"
XX-410-A-19	\$69.00	Cast Iron Vent - Any Style - Black - 4" x 10"
XX-412-A-19	\$74.00	Cast Iron Vent - Any Style - Black - 4" x 12"
XX-414-A-19	\$82.00	Cast Iron Vent - Any Style - Black - 4" x 14"
XX-610-A-19	\$87.00	Cast Iron Vent - Any Style - Black - 6" x 10"
XX-612-A-19	\$89.00	Cast Iron Vent - Any Style - Black - 6" x 12"
XX-614-A-19	\$94.00	Cast Iron Vent - Any Style - Black - 6" x 14"
SKU	Price	Brass Vents - Name / Description
XX-210-C-**	\$59.00	Cast Brass Vent - Any Style/Finish - 2-1/4" x 10"
XX-212-C-**	\$67.00	Cast Brass Vent - Any Style/Finish - 2-1/4" x 12"
XX-214-C-**	\$82.00	Cast Brass Vent - Any Style/Finish - 2-1/4" x 14"
XX-310-C-**	\$68.00	Cast Brass Vent - Any Style/Finish - 3" x 10"
XX-410-C-**	\$81.00	Cast Brass Vent - Any Style/Finish - 4" x 10"
XX-412-C-**	\$85.00	Cast Brass Vent - Any Style/Finish - 4" x 12"
XX-414-C-**	\$100.00	Cast Brass Vent - Any Style/Finish - 4" x 14"
XX-610-C-**	\$106.00	Cast Brass Vent - Any Style/Finish - 6" x 10"
XX-612-C-**	\$120.00	Cast Brass Vent - Any Style/Finish - 6" x 12"
XX-614-C-**	\$134.00	Cast Brass Vent - Any Style/Finish - 6" x 14"

When Ordering - Replace (XX) for Any Style - Replace (**) for Any Finish

Style	Sizes	Metal	Finish
01 - Legacy Classic	210 - 2-1/4" x 10"	A - Iron	03 - Polished Brass
02 - Oriental	212 - 2-1/4" x 12"	C - Brass	05 - Antique Brass
03 - Victorian	214 - 2-1/4" x 14"		10 - Oil-Rubbed Bronze
04 - Contemporary	310 - 3" x 10"		15 - Brushed Nickel
05 - Mission	410 - 4" x 10"		19 - Black (Iron Only)
06 - Scroll	412 - 4" x 12"		26 - Polished Chrome
07 - Legacy Scroll	414 - 4" x 14"		
08 - Art Deco	610 - 6" x 10"		
	612 - 6" x 12"		
	614 - 6" x 14"		



This product would be a Legacy Classic 4" x 12" made of Brass with an Antique Brass Finish



HARDWARE
INTERNATIONAL

New Bronze Appliance Pulls

Stocked & Ready to Ship



A Coastal Bronze Product Line



H A R D W A R E I N T E R N A T I O N A L

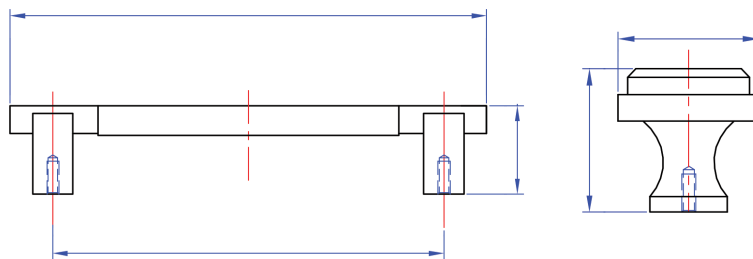

Bronze & Brass Cabinet Hardware

Hardware International Price List

Please visit our website for the most up-to-date product list. New products and finishes are regularly added.

www.CoastalHardware.com/pages/new-products

www.HardwareInternational.com

1103 Lawrence Drive, Ste A, Newbury Park, CA 91320

P: 1-877-227-6603 | **E:** Orders@CoastalBronze.com | **F:** 1-888-778-7889

Bronze Finish Options

Available for SKU's starting with: 01 - 04

Platinum (Base) | Espresso (Accent) | **(PE)**



Champagne (Base) | Espresso (Accent) | **(CE)**



Espresso (Base) | Platinum (Accent) | **(EP)**



Espresso (Base) | Champagne (Accent) | **(EC)**



Available for SKU's starting with: 05 - 16

Espresso | **(E)**



Champagne | **(C)**



Platinum | **(P)**



Brass Finish Options

Available for SKU's starting with: 05 - 16

Satin Nickel | **(SN)**



Polished Nickel | **(PN)**



Polished Chrome | **(PC)**



New 2024 Finishes

Satin Brass | **(SB)**



Black | **(BL)**



Hardware International - Retail Price List - 2024

SKU	Bronze	Brass	Size	01 - Two-Tone - Edge - Name / Description
01-103	\$34.00	N/A	3" cc	Contemporary Square Base Handle
01-104	\$43.00	N/A	4" cc	Contemporary Square Base Handle
01-196	\$39.00	N/A	96mm cc	Contemporary Square Base Handle
01-106	\$75.00	N/A	6" cc	Contemporary Square Base Handle
01-109	\$103.00	N/A	9" cc	Contemporary Square Base Handle
01-112	\$184.00	N/A	12" cc	Contemporary Square Base Handle
01-118-A*	\$622.00	N/A	18" cc	Contemporary Square Base Handle - Appliance
01-124-A*	\$829.00	N/A	24" cc	Contemporary Square Base Handle - Appliance
01-203	\$34.00	N/A	3" cc	Contemporary Round Base Handle
01-204	\$43.00	N/A	4" cc	Contemporary Round Base Handle
01-296	\$39.00	N/A	96mm cc	Contemporary Round Base Handle
01-206	\$75.00	N/A	6" cc	Contemporary Round Base Handle
01-209	\$103.00	N/A	9" cc	Contemporary Round Base Handle
01-212	\$184.00	N/A	12" cc	Contemporary Round Base Handle
01-218-A*	\$622.00	N/A	18" cc	Contemporary Round Base Handle - Appliance
01-224-A*	\$829.00	N/A	24" cc	Contemporary Round Base Handle - Appliance
01-501	\$16.00	N/A	1"	Contemporary Square Pyramid Knob
01-502	\$23.00	N/A	1-1/4"	Contemporary Square Pyramid Knob
01-503	\$32.00	N/A	1-1/2"	Contemporary Square Pyramid Knob
01-601	\$12.00	N/A	1"	Contemporary Round Knob
01-602	\$22.00	N/A	1-1/4"	Contemporary Round Knob
01-603	\$31.00	N/A	1-1/2"	Contemporary Round Knob
01-701	\$12.00	N/A	1-1/2"	Contemporary T-Knob Square Base
01-801	\$12.00	N/A	1-1/2"	Contemporary T-Knob Round Base
SKU	Bronze	Brass	Size	02 - Two-Tone - Angle - Name / Description
02-103	\$35.00	N/A	3" cc	Contemporary Banded Handle
02-104	\$45.00	N/A	4" cc	Contemporary Banded Handle
02-196	\$41.00	N/A	96mm cc	Contemporary Banded Handle
02-106	\$88.00	N/A	6" cc	Contemporary Banded Handle
02-109	\$113.00	N/A	9" cc	Contemporary Banded Handle
02-112	\$195.00	N/A	12" cc	Contemporary Banded Handle
02-118-A*	\$658.00	N/A	18" cc	Contemporary Banded Handle - Appliance
02-124-A*	\$878.00	N/A	24" cc	Contemporary Banded Handle - Appliance
02-501	\$19.00	N/A	1"	Contemporary Banded Knob
02-502	\$25.00	N/A	1-1/4"	Contemporary Banded Knob
02-503	\$29.00	N/A	1-1/2"	Contemporary Banded Knob
02-601	\$14.00	N/A	1"	Contemporary Square Flat Knob

All 01 through 04 Two-Tone Products are available in 4 finishes: EP, PE, CE, & EC
 See Page 27 of the Price List for Full Finish Variations & Options
 Back-to-Back Available by Request - All Asterisk (*) Items are Special Order

Hardware International - Retail Price List - 2024

SKU	Bronze	Brass	Size	02 - Two-Tone - Angle - Name / Description
02-602	\$21.00	N/A	1-1/4"	Contemporary Square Flat Knob
02-603	\$26.00	N/A	1-1/2"	Contemporary Square Flat Knob
SKU	Bronze	Brass	Size	03 - Two-Tone - Angle - Name / Description
03-103	\$27.00	N/A	3" cc	Contemporary Bevel Top Handle
03-104	\$32.00	N/A	4" cc	Contemporary Bevel Top Handle
03-196	\$29.00	N/A	96mm cc	Contemporary Bevel Top Handle
03-106	\$47.00	N/A	6" cc	Contemporary Bevel Top Handle
03-203	\$27.00	N/A	3" cc	Contemporary Flat Top Handle
03-204	\$32.00	N/A	4" cc	Contemporary Flat Top Handle
03-296	\$29.00	N/A	96mm cc	Contemporary Flat Top Handle
03-206	\$47.00	N/A	6" cc	Contemporary Flat Top Handle
03-502	\$26.00	N/A	1-1/2"	Contemporary Rectangular Knob
SKU	Bronze	Brass	Size	04 - Two-Tone - Curve - Name / Description
04-103	\$31.00	N/A	3" cc	Contemporary Bar Handle
04-104	\$35.00	N/A	4" cc	Contemporary Bar Handle
04-196	\$34.00	N/A	96mm cc	Contemporary Bar Handle
04-106	\$47.00	N/A	6" cc	Contemporary Bar Handle
04-109	\$73.00	N/A	9" cc	Contemporary Bar Handle
04-112	\$130.00	N/A	12" cc	Contemporary Bar Handle
04-118-A*	\$439.00	N/A	18" cc	Contemporary Bar Handle - Appliance
04-124-A*	\$585.00	N/A	24" cc	Contemporary Bar Handle - Appliance
04-501	\$15.00	N/A	1-1/2"	Contemporary Round T-Knob
04-601	\$15.00	N/A	3/4"	Contemporary Finger Pull
04-701	\$16.00	N/A	7/8"	Contemporary Cone Knob
04-702	\$22.00	N/A	1-1/8"	Contemporary Cone Knob
04-703	\$27.00	N/A	1-3/8"	Contemporary Cone Knob

All 01 through 04 Two-Tone Products are available in 4 finishes: EP, PE, CE, & EC

See Page 27 of the Price List for Full Finish Variations & Options

Back-to-Back Available by Request - All Asterisk (*) Items are Special Order

Hardware International - Retail Price List - 2024

SKU	Bronze	Brass	Size	05 - Single Tone - Mission - Name / Description
05-103	\$27.00	\$15.00*	3" cc	Flared Flat Handle
05-104	\$27.00	\$17.00	4" cc	Flared Flat Handle
05-196	\$26.00	\$16.00 *	96mm cc	Flared Flat Handle
05-106	\$39.00	\$24.00	6" cc	Flared Flat Handle
05-109	\$65.00	\$39.00	9" cc	Flared Flat Handle
05-112	\$108.00	\$65.00	12" cc	Flared Flat Handle
05-118-A*	\$364.00*	\$218.00*	18" cc	Flared Flat Handle - Appliance
05-124-A*	\$486.00*	\$290.00*	24" cc	Flared Flat Handle - Appliance
05-501	\$13.00	\$8.00	1"	Flat Square Knob
05-502	\$15.00	\$9.00	1-1/4"	Flat Square Knob
05-503	\$30.00	\$18.00	1-1/2"	Flat Square Knob
SKU	Bronze	Brass	Size	06 - Single Tone - Mission - Name / Description
06-103	\$20.00	\$12.00*	3" cc	Flat Handle
06-104	\$24.00	\$15.00*	4" cc	Flat Handle
06-196	\$23.00	\$13.00*	96mm cc	Flat Handle
06-106	\$37.00	\$22.00*	6" cc	Flat Handle
06-109	\$60.00	\$36.00*	9" cc	Flat Handle
06-112	\$104.00	\$62.00*	12" cc	Flat Handle
06-118-A*	\$352.00*	\$211.00*	18" cc	Flat Handle - Appliance
06-124-A*	\$469.00*	\$281.00*	24" cc	Flat Handle - Appliance
06-501	\$13.00	\$8.00	1"	Pyramid Knob
06-502	\$21.00	\$12.00	1-1/4"	Pyramid Knob
06-503	\$26.00	\$16.00	1-1/2"	Pyramid Knob
SKU	Bronze	Brass	Size	07 - Single Tone - Renaissance - Name / Description
07-103	\$20.00	\$12.00*	3" cc	Round Handle
07-104	\$24.00	\$15.00*	4" cc	Round Handle
07-196	\$23.00	\$13.00*	96mm cc	Round Handle
07-106	\$33.00	\$20.00*	6" cc	Round Handle
07-109	\$77.00	\$47.00*	9" cc	Round Handle
07-112	\$154.00	\$92.00*	12" cc	Round Handle
07-118-A*	\$482.50*	\$310.00*	18" cc	Round Handle - Appliance
07-124-A*	\$643.50*	\$413.00*	24" cc	Round Handle - Appliance
07-501	\$20.00	\$10.00	1-1/8"	Egg Knob
07-502	\$25.00	\$16.00	1-1/4"	Egg Knob
07-601	\$13.00	\$8.00*	1"	Mushroom Knob
07-602	\$20.00	\$12.00	1-1/4"	Mushroom Knob
07-603	\$26.00	\$16.00	1-1/2"	Mushroom Knob

All 05 through 16 Single Tone Products are available in 8 Finishes: P,C, E, SN, PN, PC, BL, & SB
P,C, & E are **Bronze** Finishes - SN, PN, PC, BL, & SB are **Brass** Finishes
See Page 27 of the Price List for Full Finish Variations & Options
Back-to-Back Available by Request - All Asterisk (*) Items are Special Order

Hardware International - Retail Price List - 2024

SKU	Bronze	Brass	Size	08 - Single Tone - Renaissance - Name / Description
08-103	\$22.00	\$13.00*	3" cc	Flared Base Round Handle
08-104	\$26.00	\$16.00	4" cc	Flared Base Round Handle
08-196	\$24.00	\$15.00*	96mm cc	Flared Base Round Handle
08-106	\$37.00	\$22.00	6" cc	Flared Base Round Handle
08-109	\$70.00	\$42.00	9" cc	Flared Base Round Handle
08-112	\$134.00	\$81.00	12" cc	Flared Base Round Handle
08-118-A*	\$452.00*	\$273.00*	18" cc	Flared Base Round Handle - Appliance
08-124-A*	\$603.00*	\$363.00*	24" cc	Flared Base Round Handle - Appliance
08-501	\$16.00	\$9.00*	1"	Stepped Round Knob
08-502	\$19.00	\$11.00	1-1/4"	Stepped Round Knob
08-503	\$24.00	\$15.00	1-1/2"	Stepped Round Knob
08-602	\$20.00	\$12.00	1-1/4"	Button Round Knob
08-603	\$26.00	\$16.00	1-1/2"	Button Round Knob
SKU	Bronze	Brass	Size	09 - Single Tone - Mission - Name / Description
09-103	\$13.00	\$8.00*	3" cc	Twist Handle
09-196	\$25.00	\$15.00*	96mm cc	Twist Handle
09-105	\$30.00	\$17.00*	5" cc	Twist Handle
09-108	\$49.00	\$28.00*	8" cc	Twist Handle
09-112	\$68.00	\$39.00*	12" cc	Twist Handle
09-118-A*	\$352.00*	\$263.00*	18" cc	Twist Handle - Appliance
09-124-A*	\$469.00*	\$344.00*	24" cc	Twist Handle - Appliance
09-501	\$17.00	\$12.00	1-3/8"	Oblong Knob
09-502	\$30.00	\$16.00	1-7/8"	Oblong Knob
SKU	Bronze	Brass	Size	10 - Single Tone - Natural - Name / Description
10-103	\$15.00	\$9.00*	3" cc	Ridged Handle
10-196	\$28.00	\$12.00*	96mm cc	Ridged Handle
10-105	\$38.00	\$24.00*	5" cc	Ridged Handle
10-108	\$65.00	\$39.00*	8" cc	Ridged Handle
10-112	\$167.00	\$101.00*	12" cc	Ridged Handle
SKU	Bronze	Brass	Size	11 - Single Tone - Natural - Name / Description
11-103	\$39.00	\$22.00*	3" cc	Bamboo Handle
11-104	\$44.00	\$25.00	4" cc	Bamboo Handle
11-196	\$41.00	\$22.00*	96mm cc	Bamboo Handle
11-106	\$80.00	\$45.00	6" cc	Bamboo Handle
11-109	\$144.00	\$82.00	9" cc	Bamboo Handle
11-112	\$191.00	\$108.00	12" cc	Bamboo Handle
11-118-A*	\$646.00*	\$365.00*	18" cc	Bamboo Handle - Appliance

All 05 through 16 Single Tone Products are available in 8 Finishes: P,C, E, SN, PN, PC, BL, & SB

P,C, & E are **Bronze** Finishes - SN, PN, PC, BL, & SB are **Brass** Finishes

See Page 27 of the Price List for Full Finish Variations & Options

Back-to-Back Available by Request - All Asterisk (*) Items are Special Order

Hardware International - Retail Price List - 2024

SKU	Bronze	Brass	Size	11 - Single Tone - Natural - Name / Description
11-124-A*	\$861.00*	\$486.00*	24" cc	Bamboo Handle - Appliance
11-501	\$17.00	\$10.00*	1"	Octagon Knob
11-502	\$25.00	\$16.00*	1-1/4"	Octagon Knob
11-503	\$34.00	\$20.00*	1-1/2"	Octagon Knob
SKU	Bronze	Brass	Size	12 - Single Tone - Natural - Name / Description
12-103	\$22.00	\$13.00	3" cc	Twig Handle
12-196	\$27.00	\$15.00*	96mm cc	Twig Handle
12-105	\$39.00	\$24.00	5" cc	Twig Handle
12-108	\$73.00	\$44.00	8" cc	Twig Handle
12-112	\$234.00	\$138.00	12" cc	Twig Handle
12-118-A*	\$791.00*	\$467.00*	18" cc	Twig Handle - Appliance
12-124-A*	\$1055.00*	\$621.00*	24" cc	Twig Handle - Appliance
SKU	Bronze	Brass	Size	13 - Single Tone - Deco - Name / Description
13-115	\$16.00	\$10.00*	1-1/2" cc	Textured Handle
13-102	\$28.00	\$17.00*	2" cc	Textured Handle
13-103	\$43.00	\$26.00*	3" cc	Textured Handle
13-502	\$18.00	\$11.00*	1-1/4"	Textured Square Knob
13-503	\$28.00	\$17.00*	1-1/2"	Textured Square Knob
13-602	\$16.00	\$9.00*	1-1/4"	Textured Round Knob
13-603	\$24.00	\$15.00*	1-1/2"	Textured Round Knob
SKU	Bronze	Brass	Size	14 - Single Tone - Deco - Name / Description
14-115	\$17.00	\$10.00*	1-1/2" cc	Ridged Handle
14-102	\$28.00	\$17.00*	2" cc	Ridged Handle
14-103	\$44.00	\$26.00*	3" cc	Ridged Handle
SKU	Bronze	Brass	Size	15 - Single Tone - Cont. - Name / Description
15-118-A*	\$430.00*	N/A	18" cc	Contemporary Pull - Appliance
SKU	Bronze	Brass	Size	16 - Single Tone - Deco - Name / Description
16-501	\$28.00	\$17.00	3-1/2" cc	Circular Bin Pull
16-502	\$35.00	\$22.00	4-1/4" cc	Flat Round Bin Pull
SKU	Bronze	Brass	Size	17 - Single Tone - Deco - Name / Description
17-118-A*	\$586.00*	N/A	18" cc	Section Pull - Appliance

All 05 through 16 Single Tone Products are available in 8 Finishes: P,C,E,SN, PN,PC,BL, & SB

P,C, & E are **Bronze** Finishes - SN,PN,PC,BL, & SB are **Brass** Finishes

See Page 27 of the Price List for Full Finish Variations & Options

Back-to-Back Available by Request - All Asterisk (*) Items are Special Order



FOREVER HARDWARE
A Coastal Bronze Product Line

Gate by Williams Gate Works



Coastal
B R O N Z E

Contact us for your next
custom hardware project.