



Thermo Sash IIIe

Congratulations on your purchase of one of the finest pet door made, featuring the exclusive EnduraFlap.



Installation Instructions



For replacement flaps and parts or other quality pet products, visit

PetProSupplyCo.com

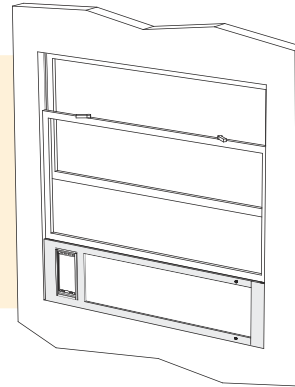

PARTS LIST

- 1 - Thermo Sash IIIe
- 1 - Foam Weather Strip (top and bottom of pet door)
- 1 - Center Post Weather Seal Strip (vinyl strip)

These images are representative. Appearance of your pet door may vary slightly depending on model.

1 STEP ONE

Loosen the thumb screws at the end of the sash. This allows the spring mechanism to move freely side to side.

Note: Re-tighten the thumb screws after step 3.

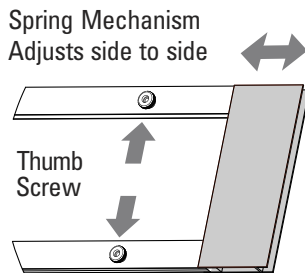

2 STEP TWO

Cut the foam weather strip with scissors to the length of the sash. Peel back the paper on the foam to expose the adhesive. Install the foam strip in the channels on both the top and the bottom of the sash.

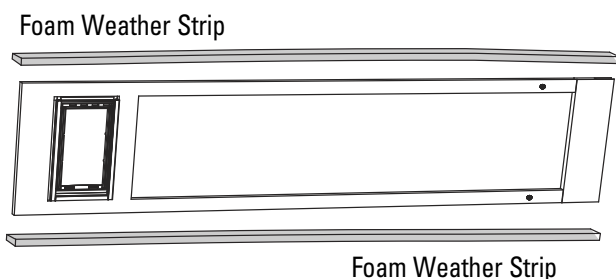

3 STEP THREE

Insert the sash into the window track. Push against the spring mechanism and swing the opposite end into the opposite window track. Gently release. Tighten the thumb screws.

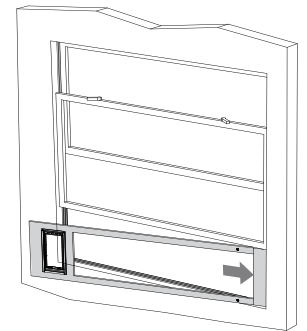

4 STEP FOUR

Mount the vinyl weather strip. This strip prevents air leaking between the window frame. This vinyl weather strip seals the gap produced between the two windows when raised to accommodate the sash. (Figure A)

Note: Trim to fit as needed with scissors.

Window Locking options:

For a permanent lock, install a wood screw in the track immediately above the window on both sides. For a temporary lock, place a removable wooden dowel in both tracks above the window. (Detail 1)

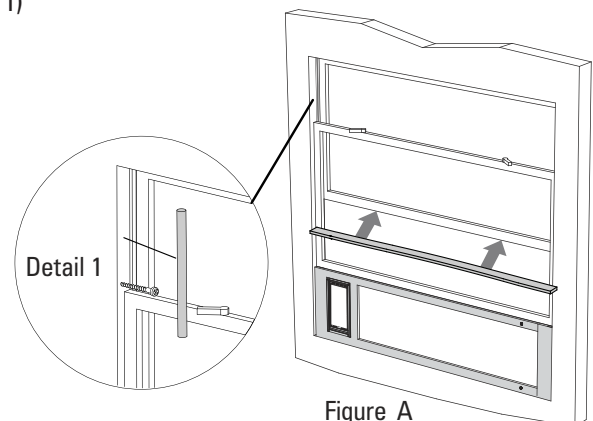

Thermo Sash IIIe

Installation Tips

Tricks and Work-a-Rounds

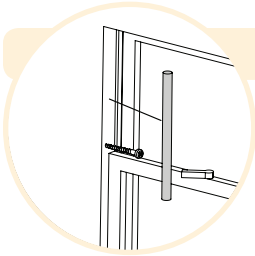

I didn't get a window lock with my Thermo Sash IIIe.

Locking solutions for sash windows are simple: If you want to semi-permanently lock the window down onto the pet door, insert a wood screw in each window track just above the window. Keep the screw heads protruding far enough so that the window can not be opened past them. (shown) If you want to keep the window locked but still want to occasionally open it, cut a wooden dowel to the proper length and install in the window track just above the window. (shown)

The window turns out to be a little too wide/narrow.

My window turns out to be a little too wide/narrow for the Thermo Sash IIIe to fit in. The Thermo Sash IIIe has a built in 'anti-whoops' to allow for small measurement errors. If your window is up to 3/4" too wide, you can order an extension piece from Patio Pacific, Inc. If the window is up to 3/4" too narrow, you can shorten the flanges at the spring end with a hacksaw.

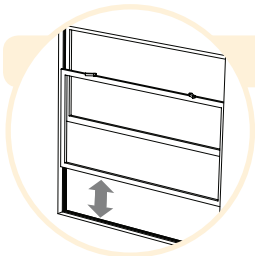
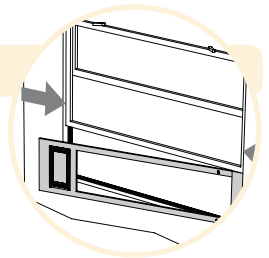

My window does not open enough.

My window won't raise high enough to accept the pet door. There's no fix for this except to exchange the pet door for a smaller one.

My window track is too narrow to accept the panel.

If your track is wide enough to accept one end but not the other (the spring mechanism makes that end about 1/8" thicker than the other end) the solution is simple: Just squeeze the flanges together until they fit. Use two 2"x4" boards to press the ends together for a neat result. If the track is too narrow for this solution, you'll either have to figure out a way of bracketing the pet door in place or give up.

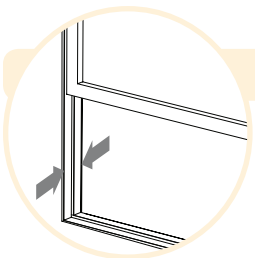
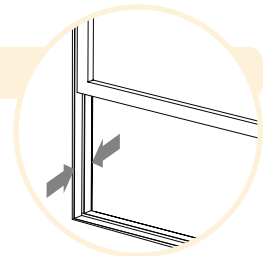

I want the pet door at the other end.

If you prefer that your pet opening be at the opposite end of the Thermo Sash IIIe, simply remove the screws holding the flap/frame assembly, reverse the panel and reinstall the assembly.



For replacement flaps and parts or other quality pet products, visit

PetProSupplyCo.com

