

TECHNICAL SPECIFICATIONS

2001 Side tables

Ramón Úbeda & Otto Canalda
2017



COMPONENTS, MATERIALS and FINISHES:
TOPS Ultra-clear tempered glass with mirror finish.
BASES. Pyrex tubes with mirror finish.

DIMENSIONES Y PESOS:

- ∅ 45 x 45h cm - 7,5 Kg
- ∅ 65 x 35h cm - 16,5 Kg
- ∅ 65 x 25h cm - 16,5 Kg

PACKAGING:
Wooden box.

CLEANING and MAINTENANCE:
Clean with glass cleaning products.

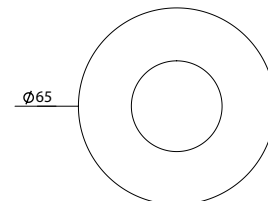
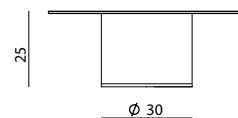
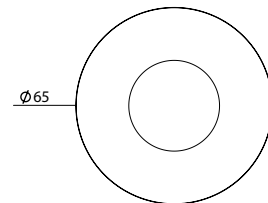
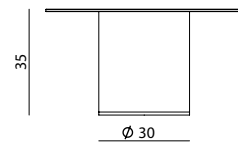
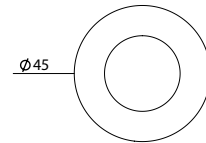
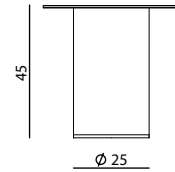

MEDIDAS EN CM

ACTUALIZACIÓN: 15/05/17
FT-55-CS



BD Barcelona Design
Ramon Turró, 126 / 08005 Barcelona
Tel +34 93 458 69 09 / Fax +34 93 207 36 97
bd@bdbarcelona.com / www.bdbarcelona.com

Oficina Técnica
Carretera Capellades / km 22,750
Narcís Monturiol, 7 / Pol. Ind Sesrovires
Sant Esteve de Sesrovires / 08635 Barcelona
Tel +34 93 771 30 51 / Fax +34 93 771 32 32