

HUMIDIFIER

Model No: JSF1W

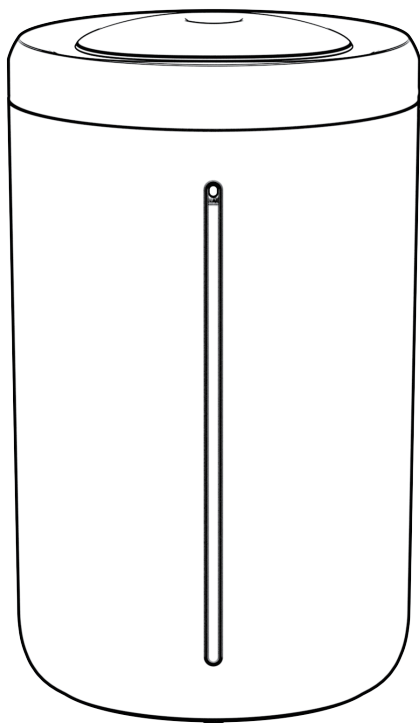

Content

Product Appearance	1
Internal Structure	1
Instructions for Use	2
The Use of Keys	3
Specifications	3
Maintenance and Tips	6
Matters Needing Attention	6
Packing List	6
After-Sales Information	7

Product Appearance

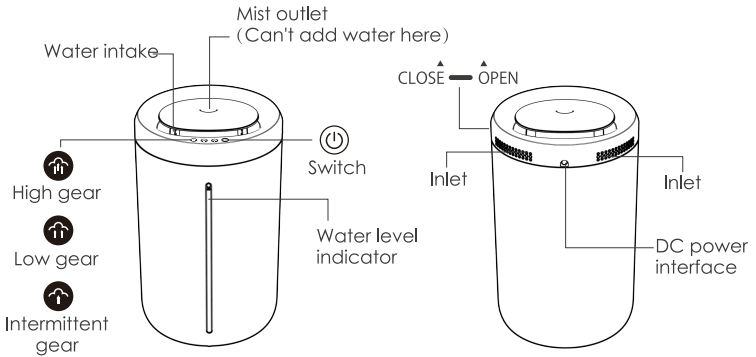

Internal Structure

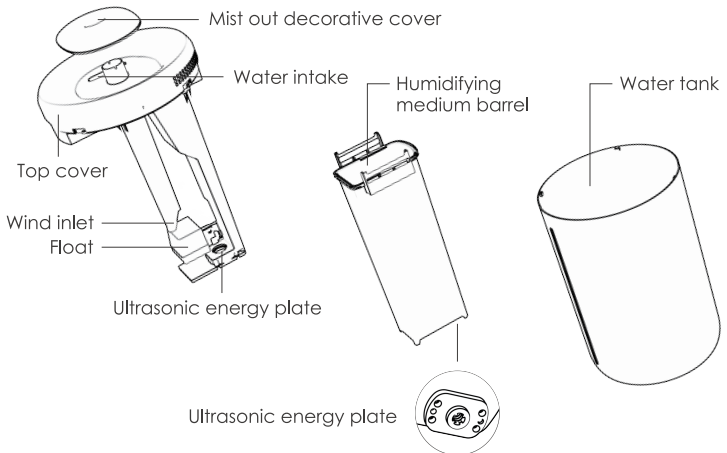

Instructions for Use

1. Before use:



Remove the top cover

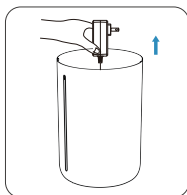

Take out the adapter

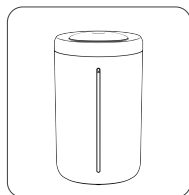

reset successfully

Please remove the cover first and take out the adapter in the water tank before you use the item.

2. Before use

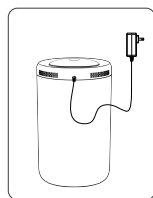
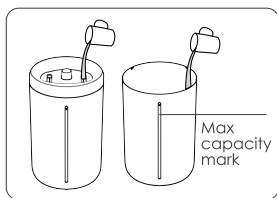
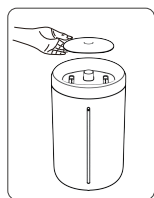

1. Place the humidifier on a solid and even surface and remove the tank cover or decorative cover.









2.1 The decorative cover can be removed, and water can be directly added to the water tank from the two water inlets of the upper cover. This method of adding water is easy to operate.

2.2 The entire upper cover can be removed, and water can be added into the water tank.

3. Do not exceed the maximum capacity mark.

4. Put the tank cap on, make sure all parts are fastened firmly, connect the power and turn on the device.

The Use of Keys

1. Plug the DC24V power on the back of the humidifier and turn it on. At this time, the power indicator lights up (about 0.1 seconds), indicating that the humidifier is already in power-on standby state.
2.  Touch the power induction control switch on the front of the humidifier, the atomization starts, it is in a continuous working state with high atomization volume,  and the indicator light is on.
3.  Touch the switch again. The low atomization amount works continuously,  the humidifier is in continuous working state.
light on
4.  Keep touching the switch, Low atomization volume intermittent work indicator  light on, The humidifier works for 20 seconds and stops for 10 seconds
5.  Press the touch switch again to stop the humidifier
6. Night light: in each working state of atomization, Long press the switch (1-2 seconds) the indicator light is on, The night light is on; press again  (1-2 seconds) to turn off the night light.

Specifications

Model	JSF1W	Product name	Humidifier
Product size	High 11.6in/295mm Diameter 7.2in/182mm	The amount of fog	110-250ML/h
Operating frequency	24V 1.7MHZ	Power cord length	4.9in/1.5m
Adapter input IN PUT	100-240V ~ 50/60Hz	Water tank capacity	1.2gallon/4.5L
Power	15.6W	Use ambient temperature	10 ~ 40 °C
Adapter OUT PUT	24V  650mA	Suitable for indoor area	215-322 ft ²
Product Weight	1056g	Run time	18-40h

Maintenance and Tips

1. Maintenance

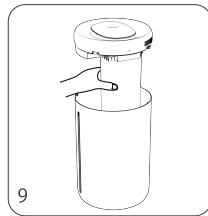
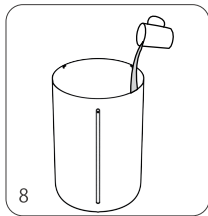
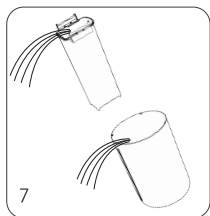
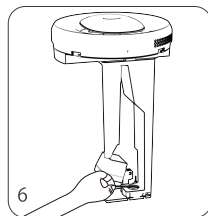
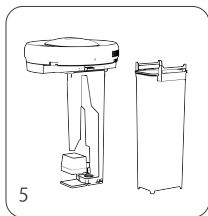
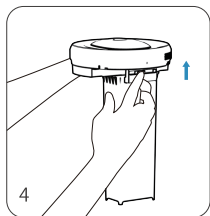
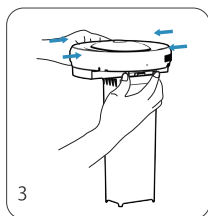
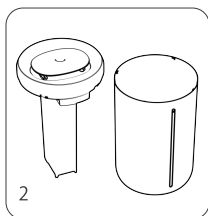
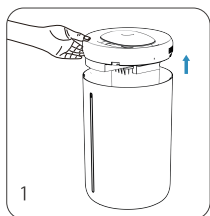

1. Remove the top cover. take out the humidifier;
 2. According to the introduction of (3-1) and (3-2), squeeze the switch base of the humidifying device with the thumb and middle finger to bend it, lift the upper surface of the humidifying device with the index finger, and then the Remove the middle barrel.
 3. Press the upper surface of the humidifier down firmly into the switch base until it clicks.
- (1). Please clean the water tank, humidifier cover, atomizer and internal parts in direct contact with water regularly.

- Turn off and unplug the humidifier before cleaning;
- Pour out all the water in the water tank and humidifier;
- Add some clean water to the tank and mid-pass.
- Use a soft brush (cotton swab) to clean the ultrasonic energy board; use a soft cloth to wipe the internal parts such as the water tank, humidifier, silicone valve, float, etc.

(2). Pour the water tank into the sink. Wash the water tank 2-3 times with clean water, pour the water carefully;

- Dilute a small amount of kitchen detergent in warm water, wipe the unit case with a soft cloth, then clean water;
- During maintenance, do not use medical thinner phenyl ethanol, otherwise it will damage the screen printing logo;
- When not in use for a long time, sterilize, dry, and store in a well-ventilated, dry place.

(3). Please change the water tank frequently and add water correctly.

Please do not add water directly through the hood, as water may accidentally enter the fan and PCBA and damage the humidifier.

Follow the instructions to disassemble the humidifier and empty the water storage tank.

(4). When cleaning, please be careful not to let water enter the air outlet;

4. Install the humidifier correctly into the tank and place the top cover.

2.Tips

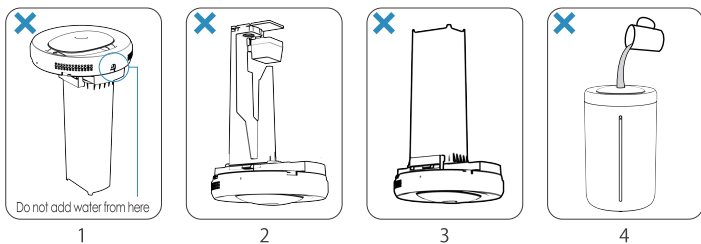

1.1-4 shows that in the process of operation and maintenance, it is forbidden to reverse or tilt the humidifier, do not add water to the power outlet, and do not add water to the mist outlet, which will easily damage the humidifier.

2. When there is no water in the water tank, the water shortage protection device will automatically disconnect the atomization circuit. At this time, there is no mist spraying out of the mist outlet, and the indicator and lighting flashes 5 times to enter the standby state. After adding water, restart the power to continue spraying.

3. Do not exceed the maximum capacity mark.
4. Regularly clean the outer surface of the humidifier to prevent dust from gathering. Clean the tuyere with a soft brush (cotton swab)
5. Pure water is recommended, if the water quality is poor, or the reservoir is dirty, the humidifier may not operate even if the water level is high enough to operate normally. Empty the water tank and rinse the middle bucket and its parts. After reinstalling, it will be back to normal.

Matters Needing Attention

1. If the power cord is damaged, it must be replaced by the manufacturer, its service agent, or a similarly qualified person, to avoid danger.
2. When filling water or cleaning, please unplug the unit.
3. When cleaning the humidifier, do not use corrosive liquids such as acid and alkali. Alcohol, water and other neutral liquids The body must be used for cleaning and maintenance.
4. Recommended working environment temperature of humidifier: 10-40C, relative humidity less than 80%RH. The temperature of the water must not exceed over 40 degrees Celsius.
5. After use, please empty the reservoir to avoid bacterial growth.
6. The atomizing device is strictly prohibited from scratching to avoid damage;
7. Do not place the power adapter in water, damp or humid places to prevent electric shock
8. Please add water to the measuring cup, do not exceed the maximum water level line, do not add water when the product is in use.

Packing List

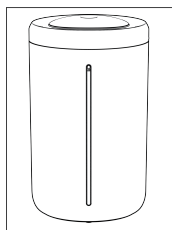

Humidifier X1



User Manual X1

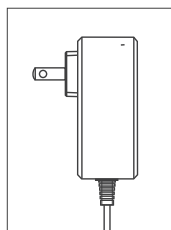

Adapter X1

After-Sales Information

customer service

Our customer service team is ready to help you if you have any questions or concerns.

 support@myameifu.com

 1-833-638-3838

 www.myameifu.com



A **A** **E** **I** **F** **U**