

# disassembly & recycling instructions

## stacking/guest chair: plastic seat & back



omseating

### applicable chair series

OM5 Active™  
Werksy®  
Tibidi™  
ST  
SG

### recommended tools

Safety Glasses  
Work Gloves  
Flat Head Screw Driver  
Phillips Screw Driver  
Socket Wrench Set  
Allen Wrench Set  
Utility Knife  
Steel Putty Knife

### recyclable material

**A** Leg Frame — Steel  
**B** Bottom Cover — Plastic  
**C** Seat Shell — Plastic  
**D** Upholstery Liner — Plastic  
**E** Arms — Plastic  
**F** Glides — Plastic  
**G** Hardware — Steel

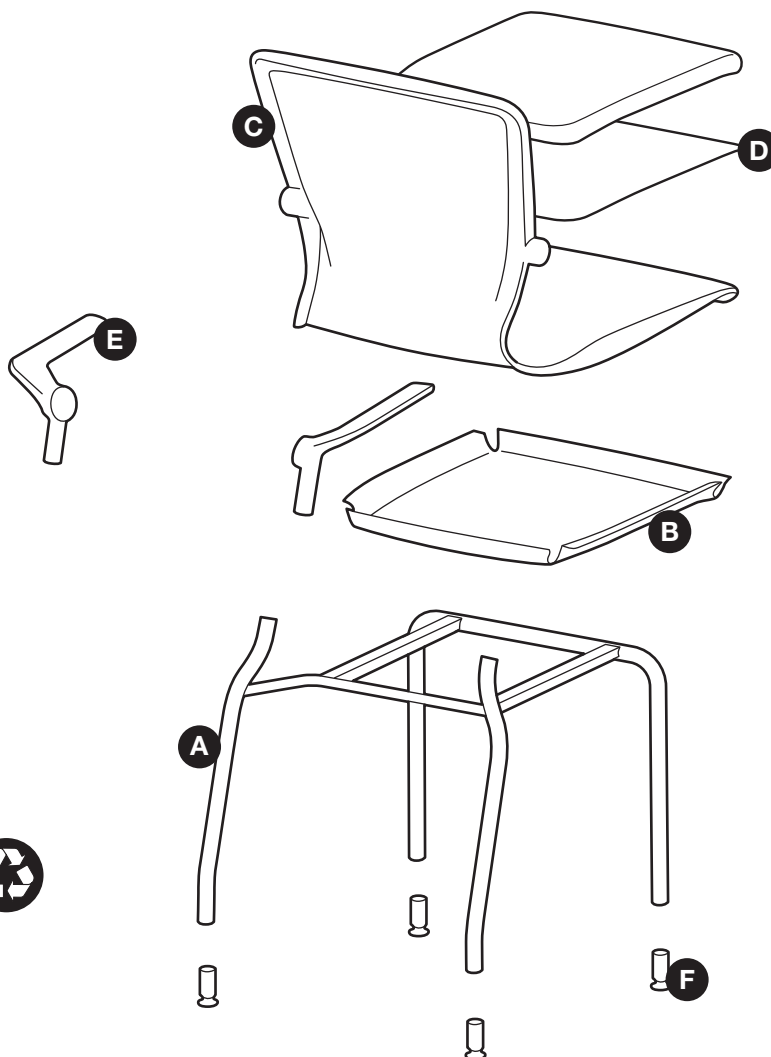

### steps to disassemble

- 1 Start by laying the chair on its back.
- 2 Pull or unscrew the glides **(F)** off the leg frame. Use a flat head or phillips head screw driver if needed.
- 3 Separate the bottom cover **(B)** from the leg frame **(A)** with a phillips head screw driver or allen wrench.
- 4 Locate any screws holding the arms **(E)** to the leg frame or seat shell, remove the screws and pull off arms.
- 5 Remove the leg frame from the seat shell **(C)** with a screw driver and allen wrench.
- 6 Remove the upholstery liner **(D)** from the seat shell with a screw driver.
- 7 Remove the fabric from the seat with a utility knife.
- 8 Separate foam from the upholstery liner with putty knife.

# disassembly & recycling instructions

## task chair: plastic seat & back

### applicable chair series

OM5 Active™  
Werksy®

### recommended tools

Safety Glasses  
Work Gloves  
Flat Head Screw Driver  
Phillips Screw Driver  
Socket Wrench Set  
Allen Wrench Set  
Hammer (Sledge preferred)  
Pipe Wrench (24 inch preferred)  
Utility Knife  
Steel Putty Knife  
Magnet

### recyclable material

**A** Base — Plastic or Aluminum  
**B** Seat Frame — Steel  
**C** Bottom Cover — Plastic  
**D** Seat Shell — Plastic  
**E** Mechanism — Steel or Aluminum  
**F** Cylinder — Steel  
**G** Upholstery Liner — Plastic  
**H** Arms — Plastic  
**I** Hardware — Steel

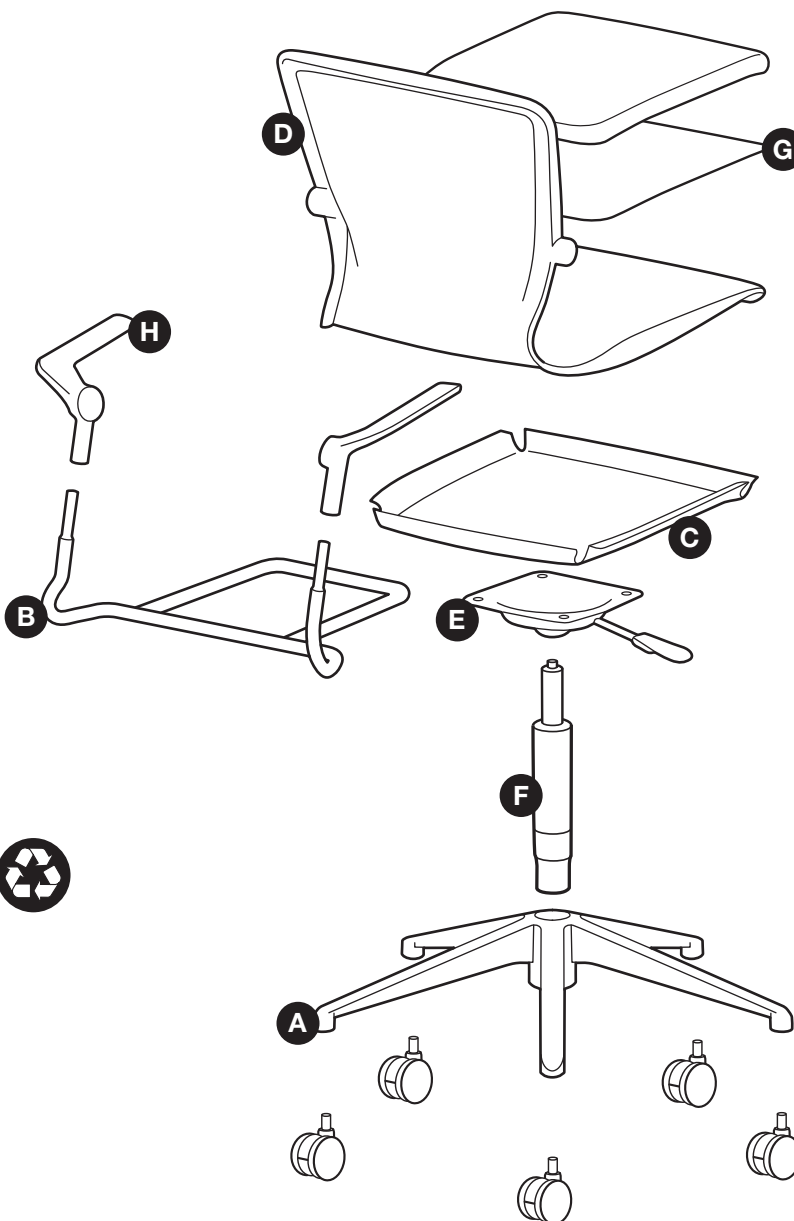

### steps to disassemble

- 1 Start by laying the chair on its back.
- 2 Pull the casters off the base. Use a flat head screw driver if needed to pry them loose.
- 3 Separate the base **(A)** from the cylinder **(F)** by striking the bottom of the cylinder housing with a hammer.
- 4 For stool models, remove the footring from the cylinder by loosening the handwheel. If no handwheel is found, twist the entire footring.
- 5 If the mechanism **(E)** has an aluminum body (a magnet will not attract to it), remove the cylinder from the mechanism.  
Use a pipe wrench to twist the piston inserted into the mechanism housing. If the mechanism is steel (a magnet will attract to it), the cylinder and mechanism can be recycled together.
- 6 Locate four bolts holding the mechanism to the seat, and remove them with a screw driver or socket wrench.
- 7 Remove the bottom cover **(C)** from the seat shell **(D)** with an allen wrench.
- 8 Remove the seat frame **(B)** from the seat shell with a screw driver and allen wrench.
- 9 Remove the arms **(H)** from the seat frame with a screw driver and allen wrench.
- 10 Remove the upholstery liner **(G)** from the seat shell with a screw driver.
- 11 Remove the fabric from the seat with a utility knife.
- 12 Separate foam from the upholstery liner with putty knife.