

Thermapen® ONE



Operating Instructions

UK Patent No GB 2504936, US Patent No US 9470560
 German Utility Patent DE 202013103605 U1
 EC Regd.Des.No. 002535161-0003, EC Regd.Des.No. 002535161-0005
 Designed to meet BS EN 61010, BS EN 60529



Manufactured in Britain by
 Electronic Temperature Instruments Ltd
 01903 202151 · sales@etiltd.com · thermapen.co.uk

545-5100/22.07.21

INSTRUMENT OPERATION - The instrument is switched on by unfolding the probe and turned off by folding the probe until fully located into the rubber probe retainer. The probe should not be rotated more than 180 degrees as damage will occur. It is recommended to store the probe in the closed position, when not in use. This instrument will automatically sleep if no movement is detected; any movement such as handling or using the instrument will cause the unit to wake up.

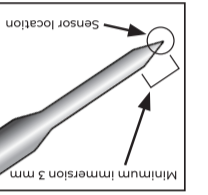
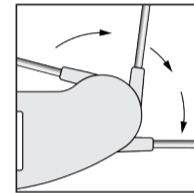

Apply the tip of the probe to the substance, minimum or surface to be measured. The sensor is located at the tip of the probe, therefore the minimum depth insertion should be 3 mm. The probe tip is very sharp and therefore caution should be taken when using. Care should also be taken when closing the probe after taking hot temperatures as the probe may remain hot.

INTELLIGENT BACKLIGHT - This instrument features a light sensor which will automatically turn the backlight on in low light conditions. The backlight will remain on for 10 seconds and automatically turn off if no movement is detected.

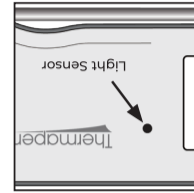

INSTRUMENT CONFIGURATION - This instrument has two small buttons inside the battery cover: MENU, which is used to enter, save settings and exit the menu and SET, which is used to select the desired settings. To alter any of the settings, open the battery cover using a Pozzi (PZ1) screwdriver to gain access to the buttons. Open the probe to turn the unit on. Settings are saved once 'End' is displayed. To abort settings, close the probe. Press the MENU button to cycle through the following settings:

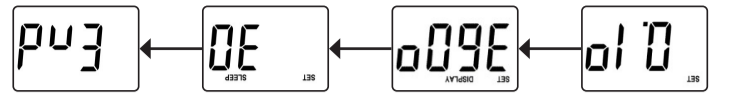

Menu Cycle (Default settings shown)

RESOLUTION - Press the MENU button so that '0.1°' or '1°' is displayed, press the SET button to select the required display.

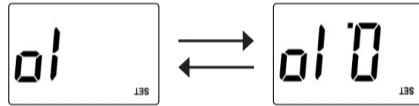

SCREEN ROTATION - Press the MENU button until 'Display' is shown, use the SET button to scroll through and select rotation.

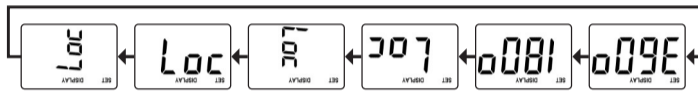

AUTO OFF/SLEEP MODE - Press the MENU button until 'SLEEP' is displayed and use the SET button to scroll through the time delays, selectable from 10 to 180 seconds in 10 second increments. Alternatively you can select 'OFF' which inhibits sleep mode.

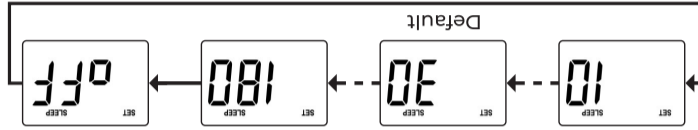

INSTRUMENT CLEANING - Clean the instrument regularly with an anti-bacterial probe wipe to avoid potential food-borne bacteria growth. **WARNING:** IPA and other solvents may cause damage to the case and screen of this instrument.

BATTERY REPLACEMENT - A low battery symbol '⏻' will appear when the battery (1 x AAA) needs replacing, in this condition the backlight is set to a low level to save battery life. The instrument continues to measure accurately but we recommend that the battery is changed as soon as possible. To replace the battery, loosen the battery cover screw using a Pozzi (PZ1) screwdriver to remove the battery cover. Replace with a single AAA battery noting the polarity. Tighten the battery cover screw until the battery cover is snug onto the seal. Do not over-tighten. For further information on changing the battery visit thermapen.co.uk.

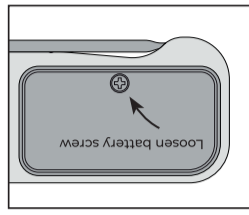
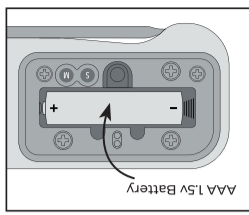

GUARANTEE - This instrument carries a five-year guarantee against defects in either components or workmanship. During this period, products that prove to be defective will, at the discretion of ETI, be either repaired or replaced without charge. This guarantee does not apply to probes, where a six-month period is offered. The product guarantee does not cover damage caused by fair wear and tear, abnormal storage conditions, incorrect use, accidental misuse, abuse, neglect, misapplication or modification. Full details of liability are available within ETI's Terms & Conditions of Sale at etiltd.com/terms. In line with our policy of continuous development, we reserve the right to amend our product specification without prior notice.

ERROR MESSAGES

- 'Lo' will be displayed if you are measuring below the instrument's range.
- 'Hi' will be displayed if you are measuring above the instrument's range.
- 'Err' will be displayed if the probe develops a fault. If the error message remains, contact our service department for further assistance.

ADVERTENCIA: El alcohol isopropílico (IPA) y otros disolventes pueden causar daños en la carcasa y la pantalla de este instrumento.

REEMPLAZO DE LA BATERÍA - Aparecerá un símbolo de batería baja '⏻' indicando que debe sustituir la batería (1 x AAA). En esta condición, la retroiluminación funcionará a bajo nivel para ahorrar batería. El instrumento continúa funcionando, pero para mantener la precisión le recomendamos sustituir las baterías lo antes posible. Para sustituir la pila, es necesario aflojar la tapa del compartimento de la pila con un destornillador Pozzi (PZ1) para retirarla. Cambie la pila por otra del tipo AAA, teniendo en cuenta la polaridad. Apriete el tornillo de la tapa del compartimento de la pila hasta que se ajuste con cierta holgura a la junta. No apretar demasiado. Para obtener más información sobre el cambio de pila, visite thermapen.co.uk.

MENSAJES DE ERROR

- 'Lo' aparecerá en la pantalla si está midiendo por debajo del rango del instrumento.
- 'Hi' indicará que está midiendo por encima del rango del instrumento.
- 'Err' en la pantalla advierte que hay un fallo en la sonda. Si el mensaje de error persiste, póngase en contacto con nuestro departamento de servicio al cliente para obtener ayuda.

