



NOTE: General user advice

Not following these instructions may result in physical injury, damage to the product or damage to the environment!

IMPORTANT SAFETY INSTRUCTIONS

Make sure that the materials used and the installation procedures follow local building codes and safety standards. The information provided in this manual in no way exempts the user of responsibility to follow all applicable codes or safety standards. This document provides instructions for EV Hover and should not be used for any other product. Before installation or use of this product, review this manual carefully and consult with a licensed contractor, licensed electrician, or trained installation expert to make sure of compliance with local building codes and safety standards.

Do not use hoses or power washers on the frame components as this may remove the powder coating.

Do not swing from or add any unexpected load to EV Hover. Only use in conjunction with a certified electric vehicle charge cable.

To prevent damage to EV Hover and avoid trapping fingers, **do not cut cable straps until after installation.**

To prevent serious injury or death, make sure all screws are tight and the device is secured to the wall.

To prevent serious injury or death, make sure that the electric power socket is grounded.

To reduce the risk of personal injury, do not bend the arms or brackets when installing or cleaning EV Hover. Do not insert foreign objects into the EV Hover mechanisms.

There are no user-serviceable components in the EV Hover. Servicing and repairs are only to be carried out by EV Hover personnel. Maximum load 10lbs.

WARNING



FINGER TRAP HAZARD

Be aware of a finger trap hazard at all times. Be aware that the fingers of the operator or installer can get trapped as the arm closes and extends.



STRANGULATION HAZARD

Children can strangle themselves on your EV charging cable

- Children can climb furniture to reach the EV Hover
- Shorten cables to prevent reach and keep all cables out of the reach of children
- Always wrap the cables around the Hook and keep them out of reach of children
- Keep all small parts, components and packaging away from children as they pose a potential choking hazard which may result in serious injury or death. Please reference all warning tags and labels in the instructions.



RISK OF ELECTRIC SHOCK

Basic precautions should always be followed when using electrical products in conjunction with EV Hover.

- This device should be supervised when used around children
- Do not use this product if your EV cable is frayed, has broken insulation, or any other signs of damage
- Do not use this product with an EV cable that is broken, cracked, open, or shows any other indication of damage
- The electrical socket you will connect your charging cable to must be grounded

TOOLS YOU WILL NEED

- 3/16" Allen Wrench
- Dead Blow Hammer
- Deep Well 1/2" Socket Wrench
- Scissors
- Pliers
- #2 Phillips Head Screwdriver
- *may need step stool*

CHECK EV HOVER PARTS BEFORE COMMENCING

Carefully unpack the EV Hover box and confirm you have received all the parts and tools, and they have not been damaged during transit. Contact EV Hover Customer Support if you find anything damaged from shipment, before installation.

EV HOVER PARTS THAT CAME WITH ORIGINAL UNIT

- [1] EV Hover
- [2] Wall Mount Bracket
- [3] 4 Velcro Straps
- [4] 4 ¼" x 2 ½" - 7/16" Hex Head Lag Bolts
- [5] Instruction Manual
- [6] 4 Number 8 x ⅜" Sheet Metal Screws
- [7] 2 ¼" - 20 x ¾" Button Head Socket Cap Screw
- [8] 2 ¼" - 20 x ½" Button Head Socket Cap Screw
- [9] Hook
- [17] Steel Tube

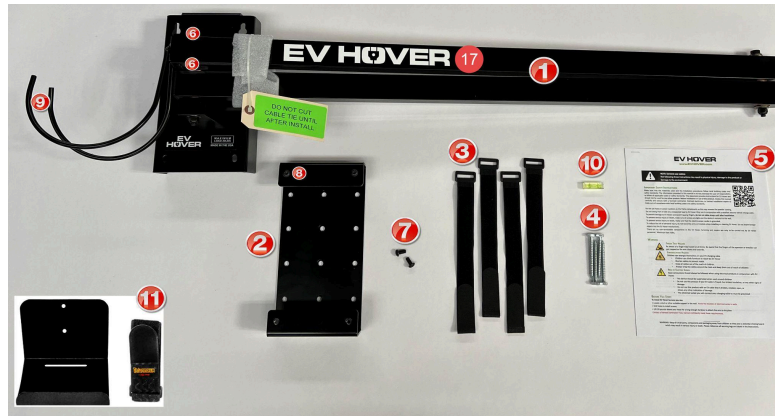

Tools Provided

- [10] Level

Optional

- [11] Adapter Wall Bracket

EV HOVER EXTENDER PARTS

- [6] 4 Number 8 x ⅜" Sheet Metal Screws (Replacement)
- [12] Aluminum Extension Tube
- [13] Plastic End Cap
- [14] Conical Washer
- [15] Stainless Steel Flat Washer
- [16] Shoulder Bolt
- [18] Lock Nut

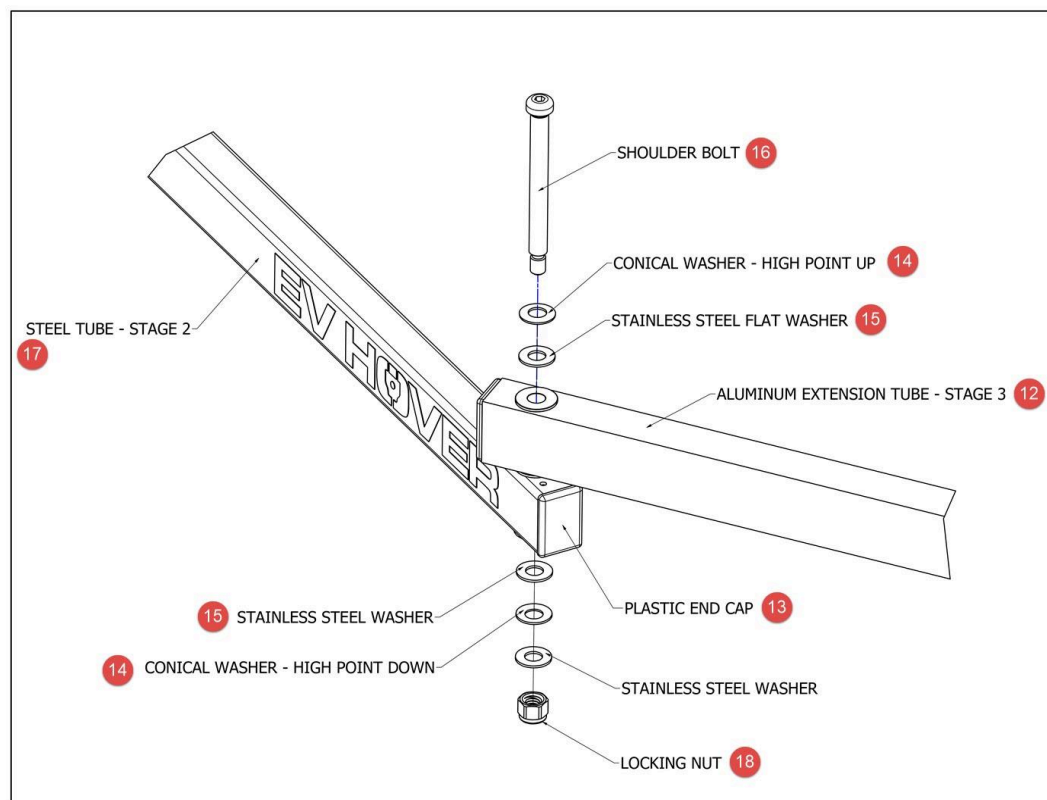

INSTALLATION NOTES

- To ensure the success of the installation, be sure to read the instructions and study the pictures carefully
- Make sure that your installation location will not allow the EV Hover arm to come into contact with any object, and that there is a minimum clearance of 6 inches from the top of the arm to the ceiling or nearest object. Ensure when folded away, the arms will not come into contact with your vehicle or any other object, hooks, or screws or any other hazard that might disrupt the operation of the arm opening and closing
- Make sure that all connections and screws are secured tightly

- Because of EV Hover’s natural movement, some connections may loosen. It is recommended that you check the fasteners monthly and ensure they are secured. If they are loose, tighten.

Note: The important safeguards and instructions given in this manual are not meant to cover all possible conditions and situations that may occur. It must be understood that common sense, caution and care are factors, which cannot be built into any product.

STEP 1 - REMOVE EV HOVER FROM WALL MOUNT BRACKET [2]

- A. Secure the EV Hover arms by wrapping with painters tape.
- B. Remove the EV Hover unit from the wall and place it on a table.

STEP 2 - ATTACH THE EXTENDER

- C. Remove the four (4) #8 Sheet Metal Screws [6] and slide off the hook [9]. Discard the four screws (new screws are provided) and save the hook [9] for reattachment later.
- D. Press the provided Plastic Cap [13] into the end of the Steel Tube [17]- use a dead blow hammer for best results.
- E. Thread a Conical Washer [14] (high point toward the head to the bolt) and a Stainless Steel Washer [15] into the Shoulder Bolt [16].
- F. Thread the Shoulder Bolt [16] through the Aluminum Extension Tube [12] and then through the Steel Tube [17].
- G. Now thread a Stainless Steel Washer [15], a Conical Washer [14] (high point down), and another Stainless Steel Washer [15] onto the bottom portion of the Shoulder Bolt [16]. Note that the last Stainless Steel Washer [15] barely engages the Shoulder Bolt [16].
- H. Finally thread the Lock Nut [18] onto the thread of the Shoulder Bolt [16].
- I. Tighten the Lock Nut [18] using a deep well 1/2” Socket Wrench while securing the top of the Shoulder Bolt [16] with a 3/16” Allen Wrench. Make sure to apply pressure to the last Stainless Steel Washer [15] with the Socket Wrench to keep the washer [15] engaged on the shoulder bolt [16]. If the washer [15] slips off the shoulder bolt [16], slightly loosen the lock nut [18] and try again.
- J. Tighten the Lock Nut [18] firmly against the shoulder of the Shoulder Bolt [16]. Ensure that the last Stainless Steel washer [15] is centered and engaged onto the body of the Shoulder Bolt [16].
- K. Using the new #8 Sheet Metal Screws [6], reinstall the hook [9] onto the end of the Aluminum Extension Tube [12]. Since the Steel Tube [17] is slightly smaller than the Aluminum Tube [12], it may be necessary to bend the top and bottom flanges of the hook [9] slightly with a pair of pliers for a good fit.

STEP 3 - REINSTALL THE EV HOVER ONTO THE WALL

- L. Collapse the EV Hover Unit into the most compact state. Wrap painter’s tape around arms to secure them in place.
- M. Hang the EV Hover [1] back onto the wall mount bracket [2] by placing the keyholes of the EV Hover onto the Cap Screws [7] that were previously installed on the top of the wall mount bracket [2].
- N. Insert the Cap Screws [8] through the bottom holes of the EV Hover into the wall mount bracket and tighten.
- O. Cut through the tape with scissors and extend the arms.

STEP 4 - REINSTALL THE EV HOVER ONTO THE WALL

- P. Install the velcro straps by wrapping them around the cable and EV Hover, leaving room for movement. Next, adjust your cable to the appropriate length allowing enough length for the end of your charger cable to hang down below the hook to reach your vehicle and then tighten the velcro straps. Adjust the hook [9] as needed by squeezing or pulling apart.

Congratulations, your EV Hover is fully functional and ready to go!

EV Hover does not require routine maintenance however, periodic inspections should be conducted to ensure that all parts remain in good working order and no damage exists. Do not attempt to open, disassemble, repair, tamper with, or modify any components of the products – the products are not user serviceable. Contact EV Hover for any repairs.

TERMS OF WARRANTY

The warranty applies only when the product is used in accordance to the specified conditions and for the intended purposes, following all manufacturer’s recommendations. A one-year warranty is provided on EV Hover purchases by Versatility Tool Works & Manufacturing Company. Please contact help@evhover.com with your proof of purchase.