

Tiller

Quick Start Guide

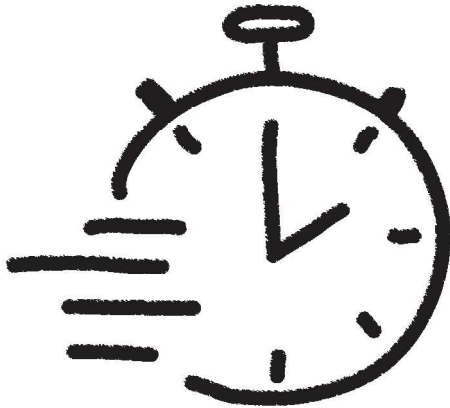

A STEP BY STEP GUIDE TO GET ROAD-READY

IN THE BOX



15mm Spanner



Belt Tensioning
Pin Spanner

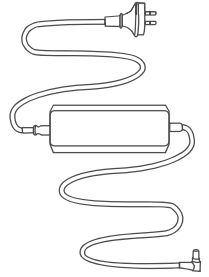

Charger

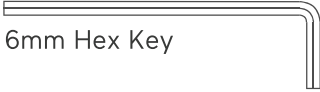

6mm Hex Key



Torque it up tool



5mm Hex Key

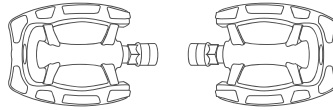

Pedals



4mm Hex Key



Medium strength
threadlocker



3mm Hex Key

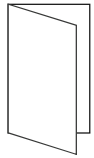

Rider Manual

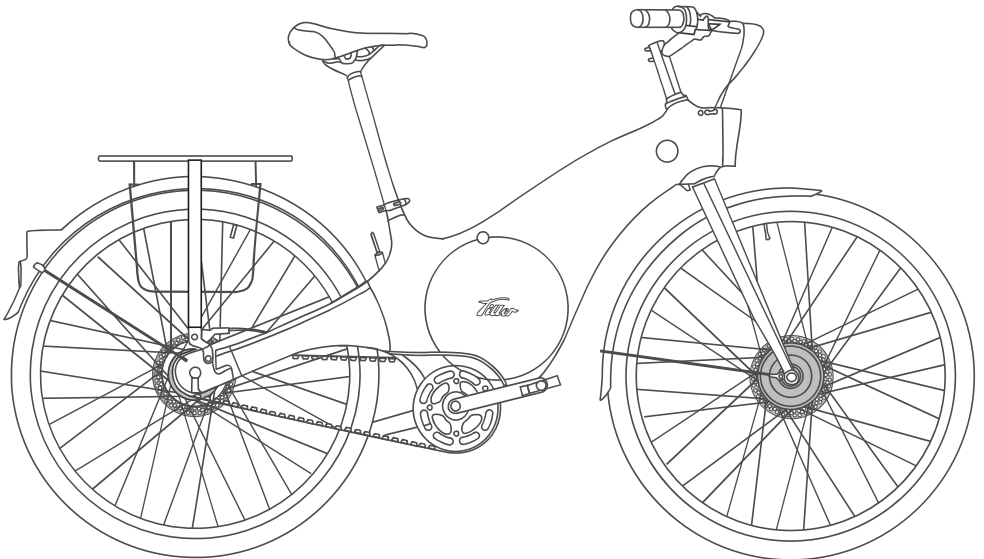

FOUNDERS EDITION ROADSTER

UNBOXING

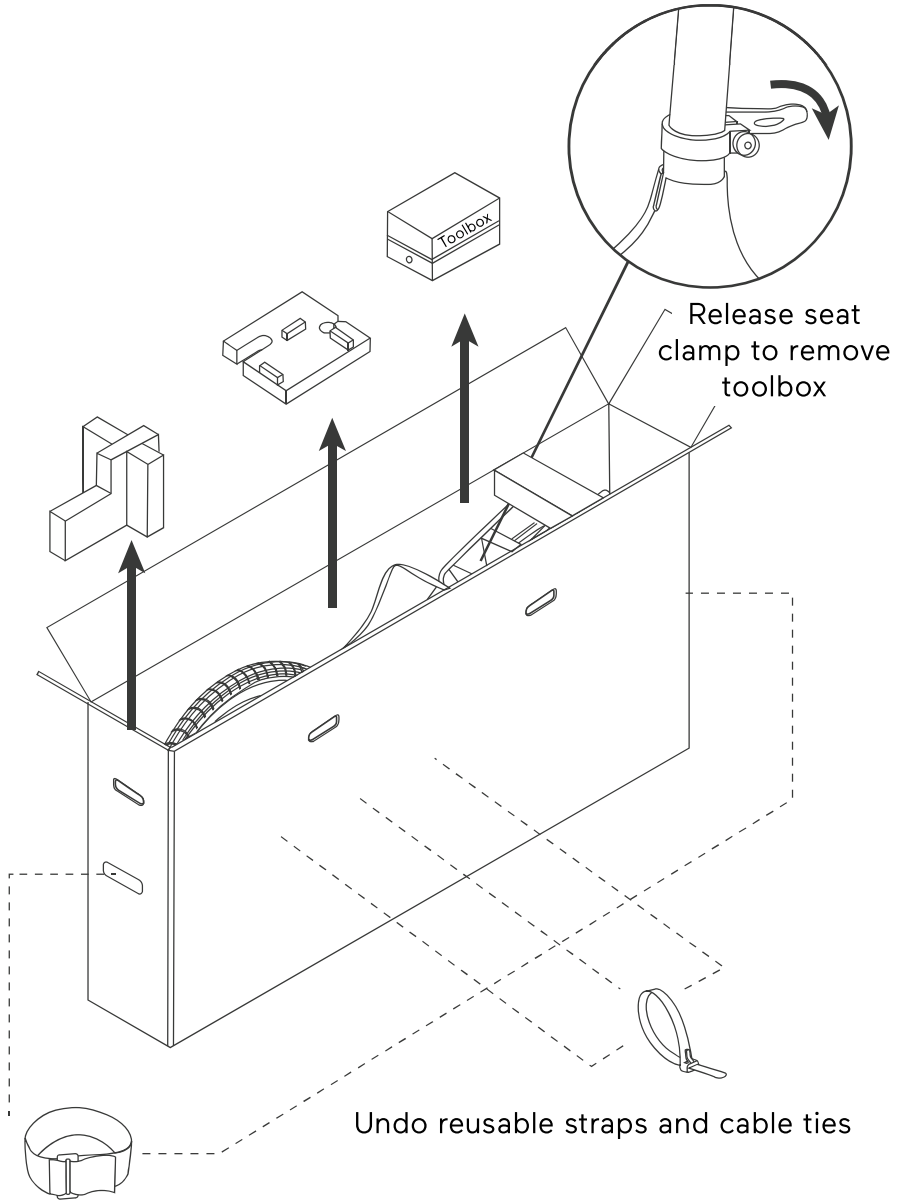

WARNING - Roadster minus front wheel is 23kg
We recommend a two person lift

UNBOXING

1 Lift box flaps and push box body to carefully slide the wheel out, avoiding contact with the frame

2 Lift the Roadster out of the box and sit it on the fork with the stand deployed. Take care to not damage the handlebar cable

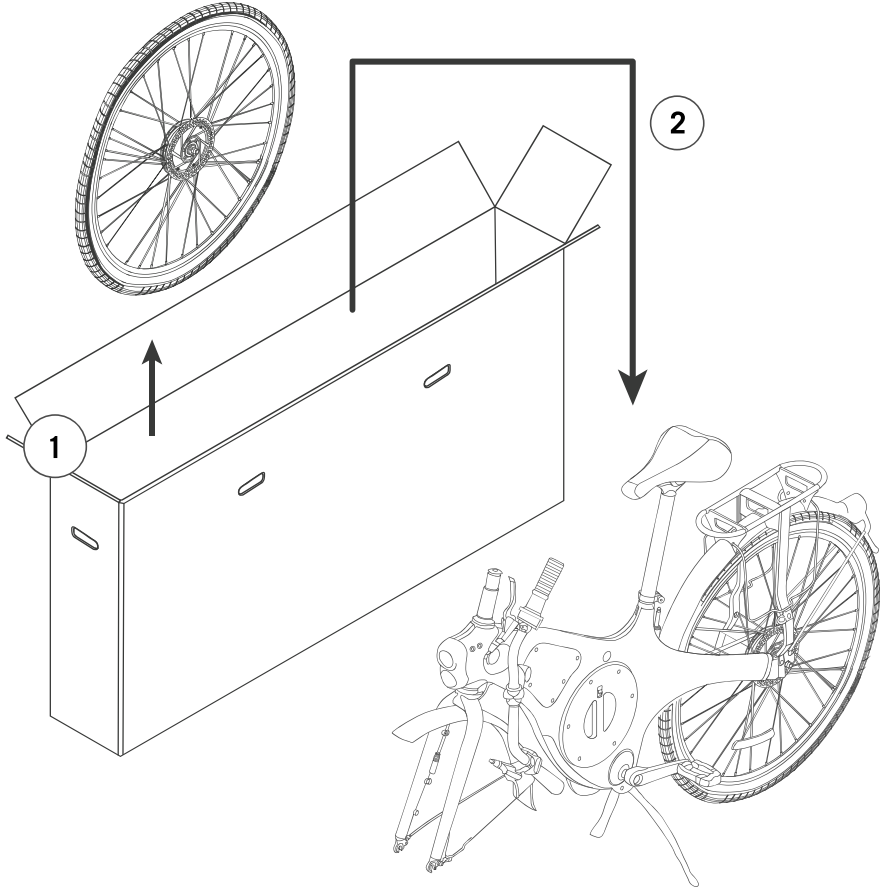

ATTACHING HANDLEBARS

- 1 Ensure handlebars are centered and rotated to a comfortable position

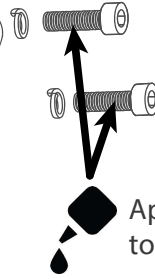
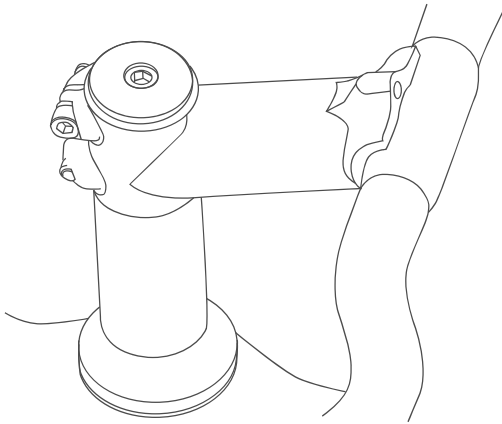

Apply threadlocker to screws



5mm Hex Key
8-10 Nm

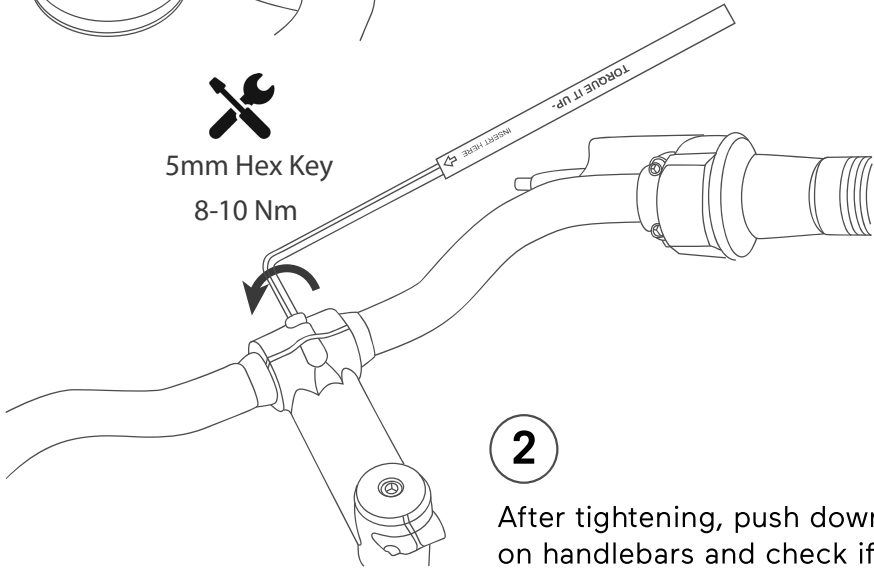

- 2 After tightening, push down on handlebars and check if handlebars can rotate



WARNING - Do not flip the Roadster upside down, may damage control switch

REMOVE PROTECTORS

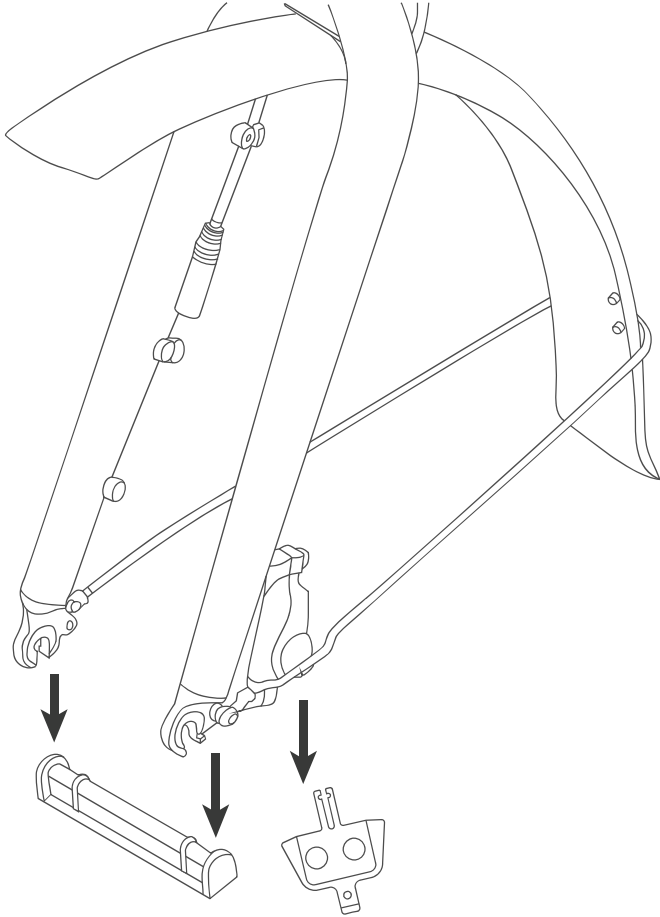

FIT FRONT AXLE TO FORKS

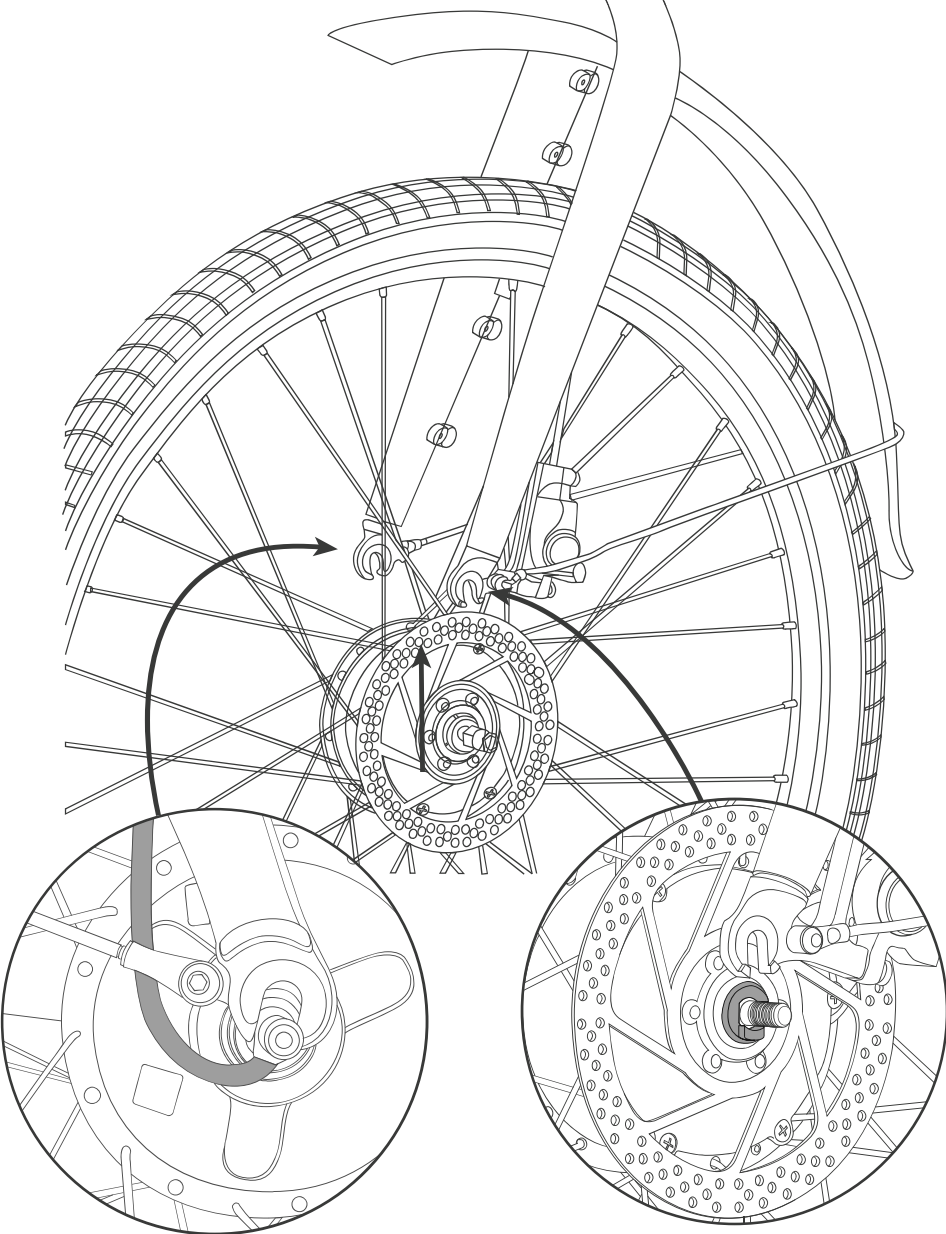

SCREW ON NUTS

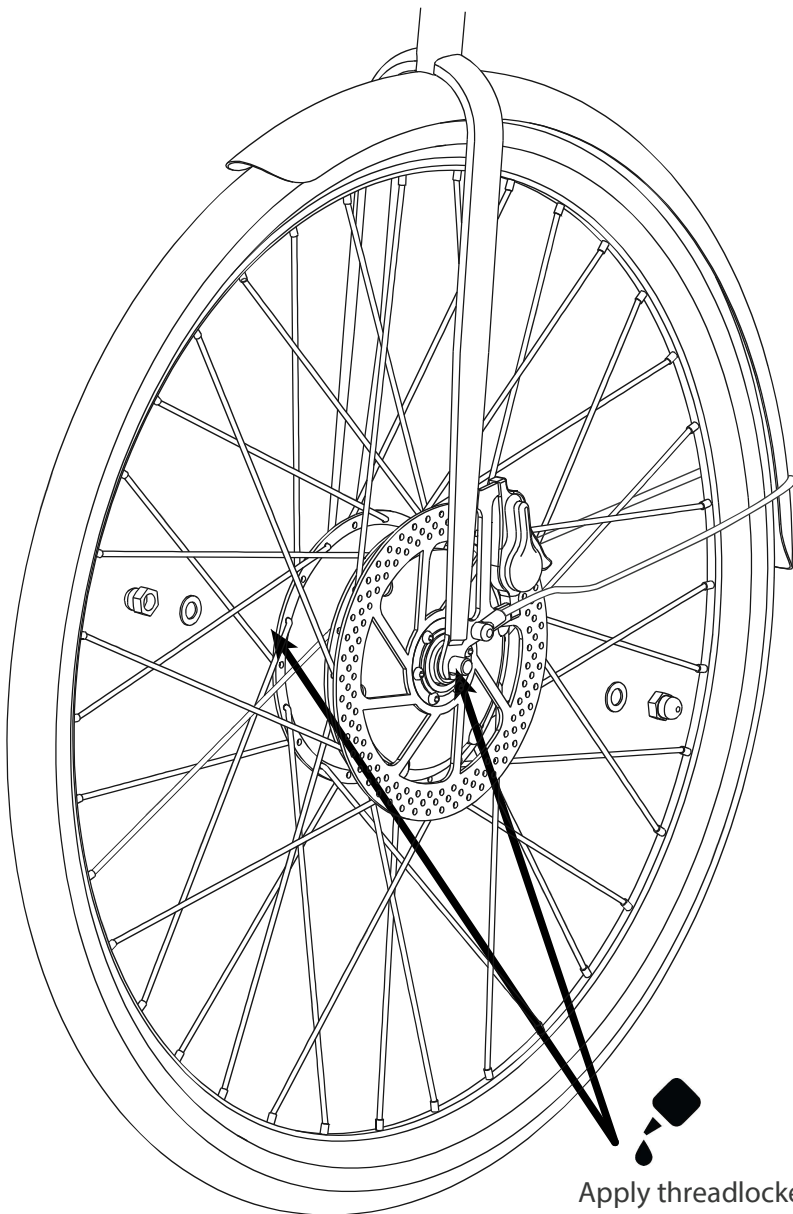

Apply threadlocker
to axle threads on
both sides

TIGHTEN FRONT WHEEL NUTS

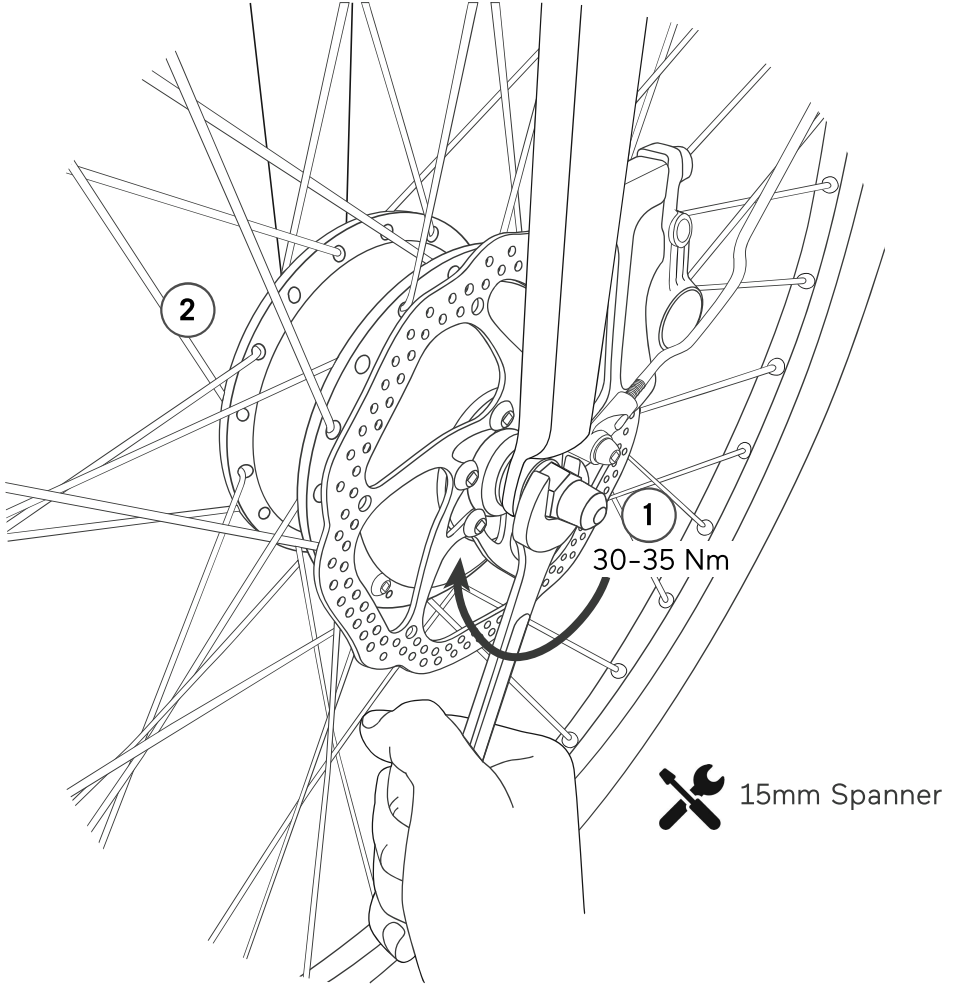

CONNECT MOTOR CABLE

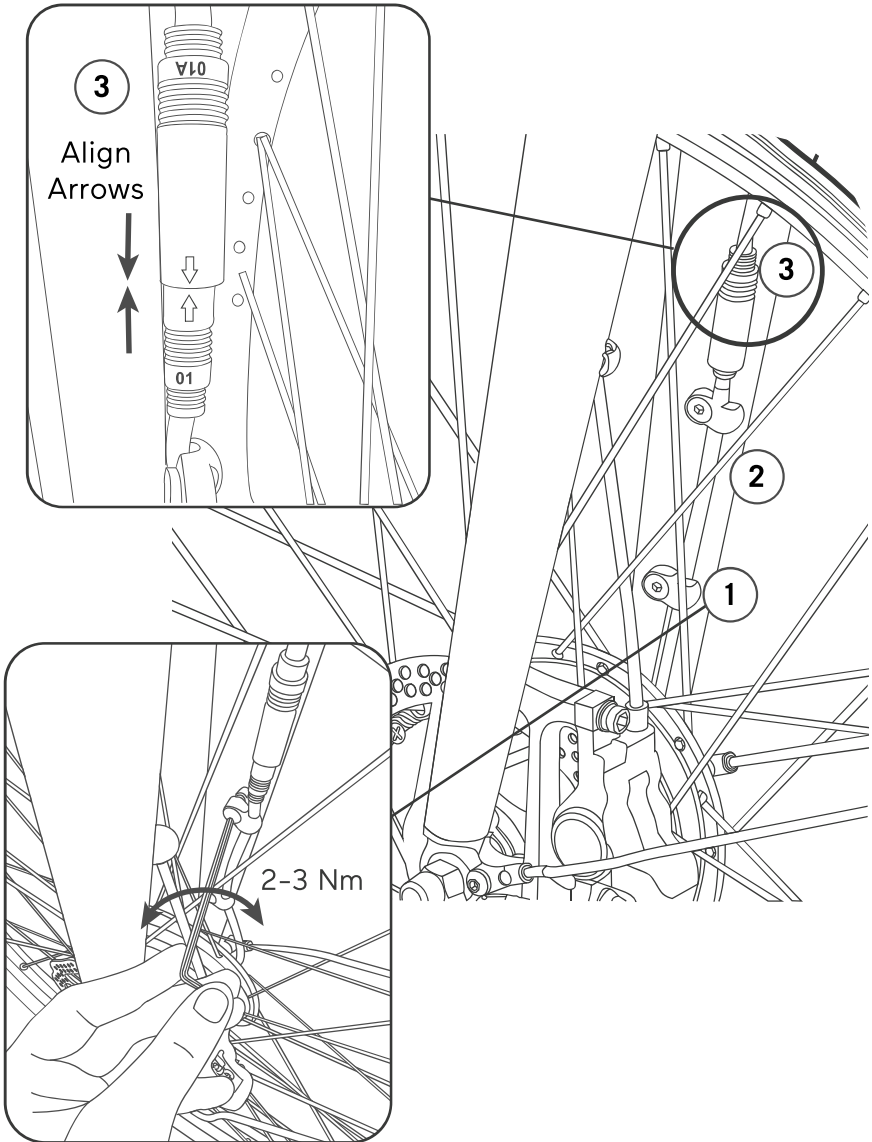

ATTACH PEDALS

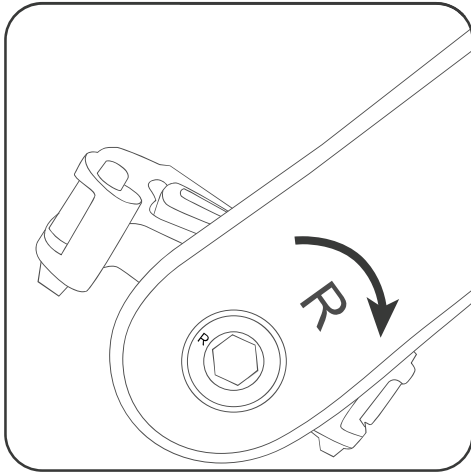

Right Pedal

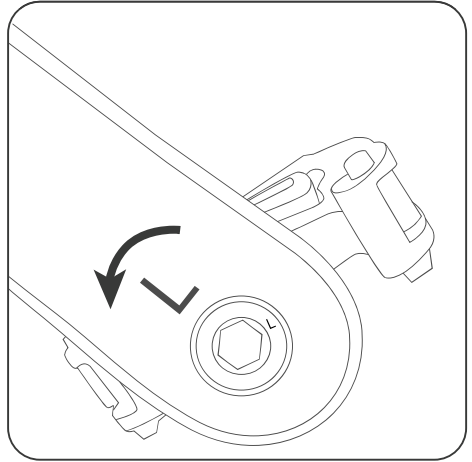

Left Pedal

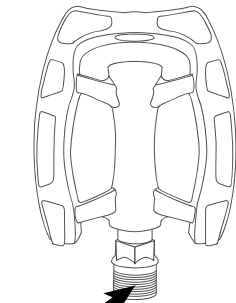

Apply threadlocker
to axle threads on
both pedals

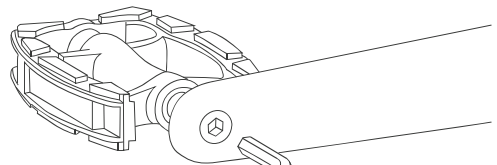

35 Nm



6mm Hex Key

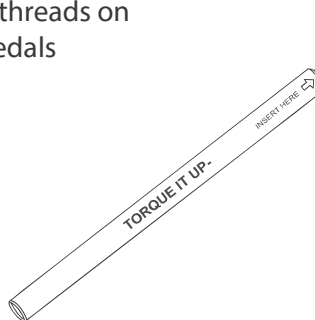

ADJUST SEAT HEIGHT, TILT & POSITION

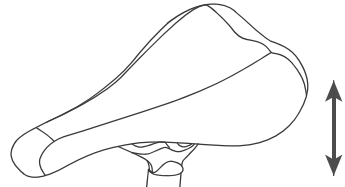

Seat Height

- 1 Release the seatpost clamp and slide seat to desired height

Close the seatpost clamp to hold the position securely

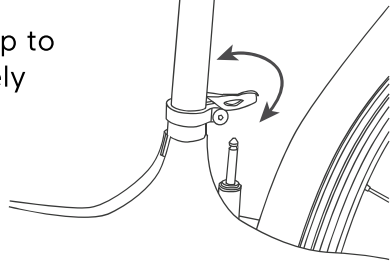

Seat Tilt & Position

- 2 Loosen the bolt in the seat clamp using the 6mm Hex Key until the seat can be easily tilted and slides forwards/backwards



6mm Hex Key

20 Nm

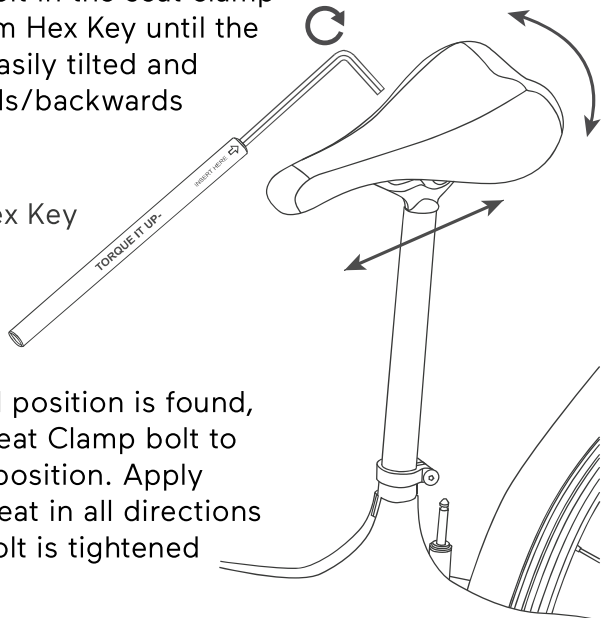

Once desired position is found, tighten the Seat Clamp bolt to securely set position. Apply pressure to seat in all directions to check if bolt is tightened correctly

DOWNLOAD APP AND TURN ON

Download the Tiller Rides app by scanning the QR codes below or searching for 'Tiller Rides' in the App Store / Google Play

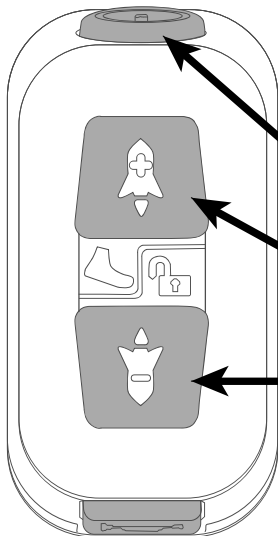

To turn your Roadster on for the first time, long press these 3 buttons

POWER

ASSIST PLUS

ASSIST MINUS

Follow the in-app instructions to complete the setup of your Roadster

USING CONTROL SWITCH

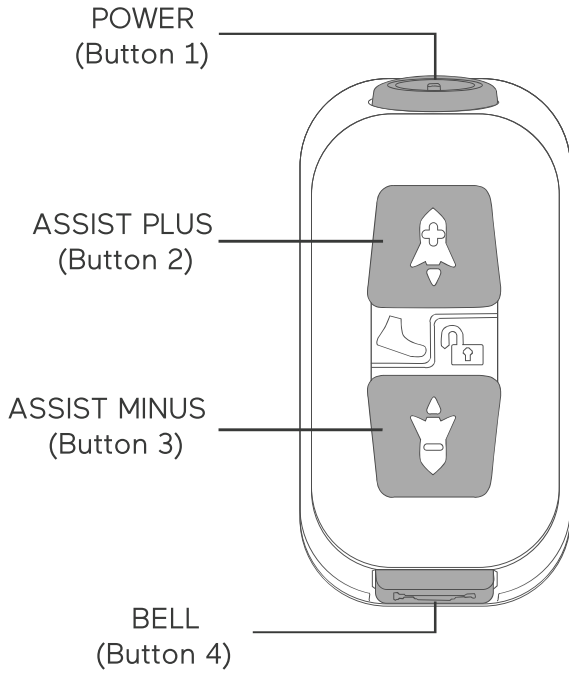

Button	Button Number	Short Press	Long Press (only while stationary)
Power	1	Light Mode Toggle	Power ON/OFF
Assist Plus	2	Assist UP	Walk Assist
Assist Minus	3	Assist DOWN	QT Lock Toggle
Bell	4	Warning Bell	Arm

SAFETY CHECKS

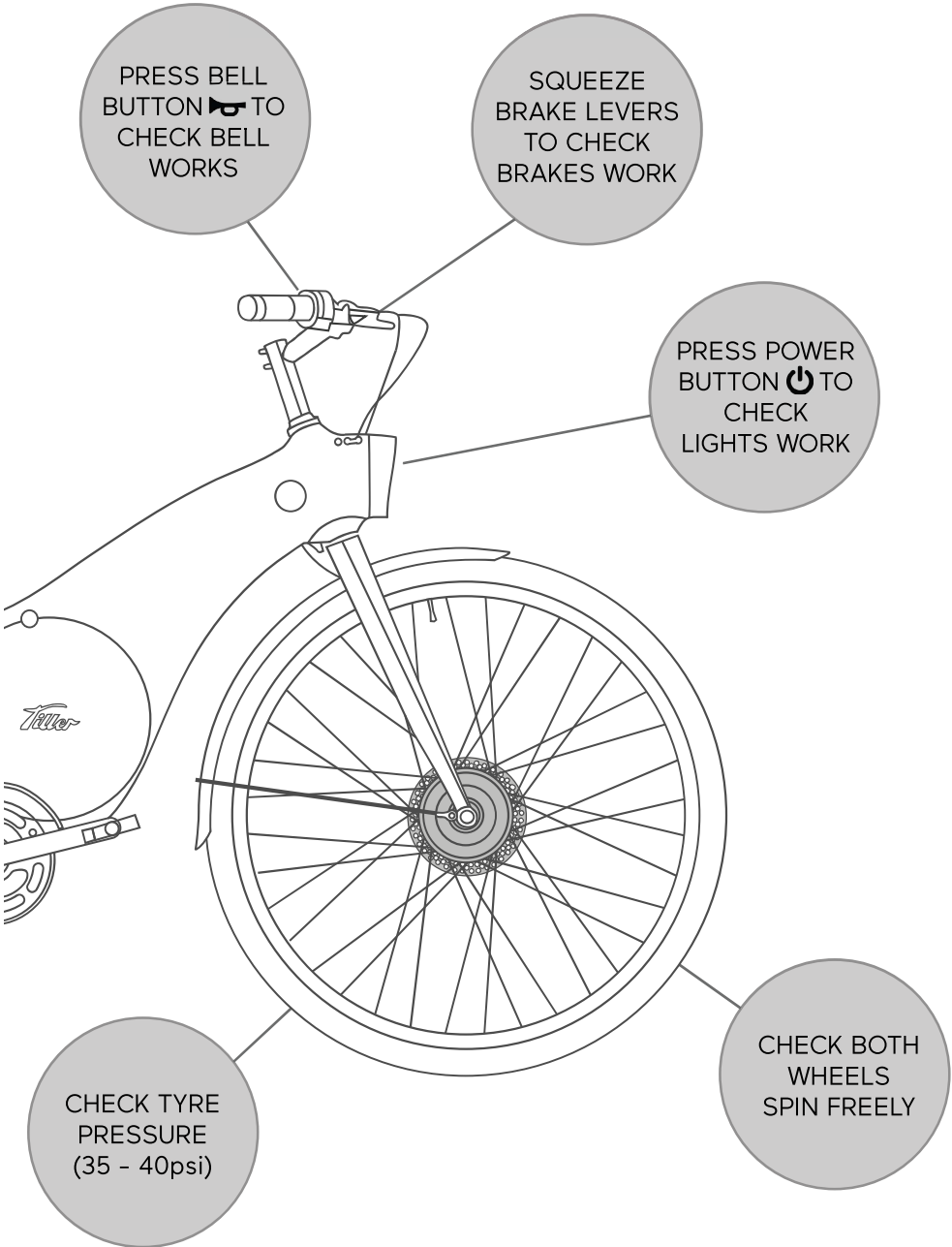

REMOVING / INSTALLING BATTERY

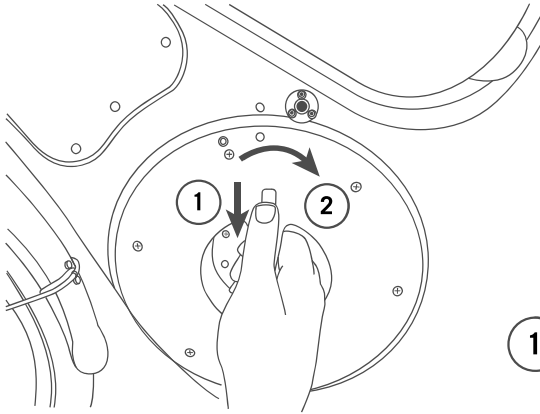

To remove batterypack

- 1 Slide batterypack lever downwards
- 2 Rotate the batterypack clockwise
- 3 Carefully pull the batterypack away from the roadster

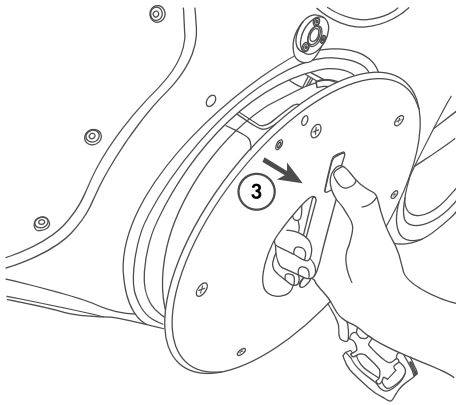

To install batterypack

- 1 Align the batterypack & frame markings
- 2 Insert the batterypack into the frame
- 3 Rotate the batterypack anti-clockwise till the batterypack 'clicks' into place

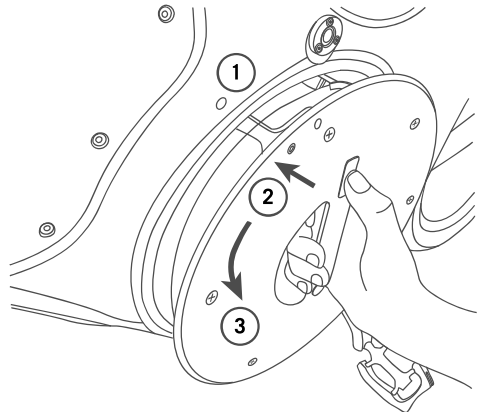

USING THE QUICKTETHER

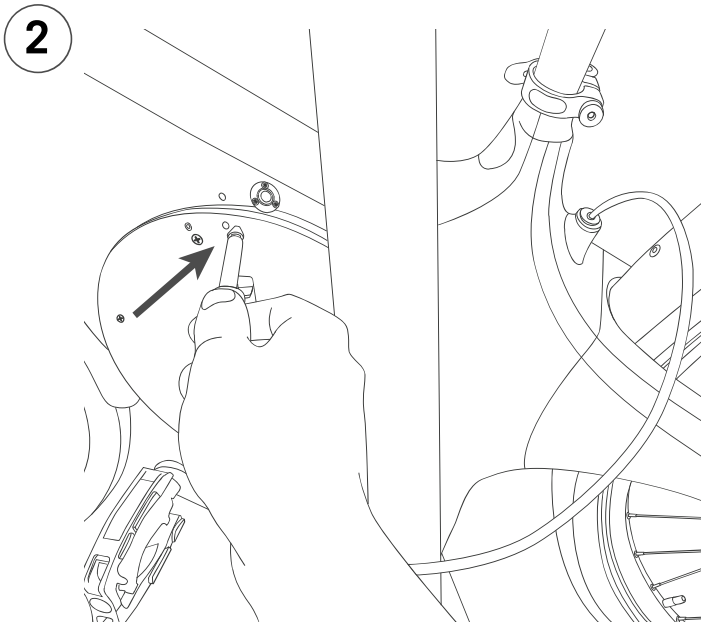
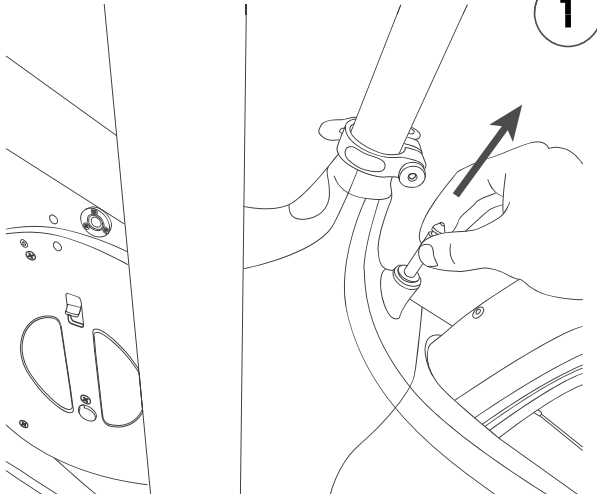

To unlock, hold Assist Minus  Button or enter the code if armed

Tiller



ENJOY THE RIDE!