



**Installation
Instructions**

**HARLEY DAVIDSON 1986 - Current
Softail 2-into-2 Traditional
EXHAUST SYSTEM**

Rev: 7-7-2015

TOOLS REQUIRED

- 5/16" Box/ End Wrench
- 1/2" Box/End Wrench
- 1/4" Ratchet and 6" Extension
- 1/2" Socket 1/4" Drive
- 3/8" Ratchet with 9/16" Socket
- Flat Blade Screw Driver
- 3/16" Allen Wrench
- 5/16" Nut Drive
- Snap Ring Pliers
- Hi-Temp Silicone Sealer

ITEMS SUPPLIED

Description	Part #	Qty
Front Header		1
Rear Header		1
Front Heat Shield		1
Rear Heat Shield		1
Mounting Bracket	25-00310	1
5/16-18 x 3/4" Hex Bolt	35-00003	4
5/16 Flat Washer	35-00007	4
5/16-18 Nylok Nut	35-00005	4
3/8" Flat Washer	35-00037	2
3/8-16 x 2 3/4" Socket Head Bolt	25-00307	1
2 1/4" Stainless Hose Clamp	16-00285	7
O2 Sensor 18mm Bung Plug	35-00083BA	2
James Exhaust Gaskets	20-00003	1pr
1/2" Spacer	29-00028B	2
3/8-16 x 1 1/4 Hex Bolt	35-00032	2
Instructions & Warranty		1

PLEASE NOTE

Our warranty applies only when the system is installed correctly and used for its intended purpose. Warranty does not apply when damage is the result of normal wear and tear, improper use, neglect or incorrect engine configuration. Please inspect *PRIOR* to installation. See warranty notice in box for more information.

TUNING

Adjustment of fuel injection is **REQUIRED** to optimize performance and minimize chrome discoloration. We recommend that adjustment of fuel injection be performed by **QUALIFIED** technicians on a dynamometer utilizing an Exhaust Gas Analyzer.

Thank you for buying a RINEHART exhaust system. We are committed to providing you a quality product that with the proper installation and care will last you for many years to come.

Please be sure to read the instructions fully and inspect all components of your new system before installation. If you do not have an understanding of how to remove your stock system, or how to install the RINEHART exhaust system you should seek the advice and/or skill of a professional mechanic. Please keep all OEM parts as some may be used for the installation of the RINEHART exhaust system. If you are installing the system and are not the owner, please return these instructions to the owner as they contain important information that may be required at a later date.

If you have questions pertaining to the installation, please contact our technical service department: 1.877.264.8282 or visit www.rineharttracing.com.

Exhaust systems manufactured by Rinehart Racing are non-catalyst. A stock catalyst exhaust system cannot be replaced with a non-catalyst exhaust system. Please verify the application with your dealer before purchase.

INSTALLATION INSTRUCTIONS

1. If applicable, unplug the rear OEM O2 sensor located under the oil tank on right side of the bike. Feed wire through frame. Note the wire routing it will be reinstalled later.
2. If applicable, unplug the front OEM O2 sensor. Remove the nylon tie holding the wire to the frame.
3. On all models with floor boards, loosen the floor board mounting bolts. This will provide better access to the exhaust system.
4. Remove the OEM exhaust system along with the stock rear mounting bracket and studs if applicable.
5. Remove the OEM exhaust flanges and cir-clips. Be careful as both the exhaust flanges and the cir-clips will be reused (replace damaged cir-clips). We recommend the use of snap ring pliers.
6. Install the OEM exhaust flanges and cir-clips on Rinehart system.
7. Install the new mounting bracket (supplied) using (2) 3/8-16 x 1 1/4" hex bolts and 3/8" flat washers (supplied) finger tighten. Place the spacers between the bracket and the frame.
8. If applicable, remove OEM O2 sensors from the front and rear OEM exhaust and install in your new system. Hint: apply a small amount of anti-seize to the threads on the sensors before installing. Torque to 32ft. lbs.
9. Remove the OEM gaskets and install (supplied) James Exhaust Gaskets.
10. Install the front header and (2) OEM flange nuts finger tight.
11. Slide (2) 5/16-18 x 3/4" bolts (supplied) into the mount tab on rear of pipe. Align bolts with frame mounting bracket. Insert bolts through the bracket and install 5/16" flat washers and 5/16" Nylok nuts (supplied) finger tight.
12. If applicable, re-connect the OEM front O2 sensor and zip tie away from engine.
13. If applicable, re-connect the OEM rear O2 sensor under the oil tank and zip tie away from engine.
14. Install rear header and (2) OEM flange nuts finger tight. Note: On 1986-1999 models it might be necessary to remove the reflector from the front frame rail.
15. Insert and finger tighten the 3/8-16 frame mounting bracket bolts on the rear header.
16. Align both pipes so they are parallel with each other and parallel to the lower frame rail and tighten the flange nuts first (torque 8-10 ft lbs.) and then tighten the 5/16-18 Nylok Nuts (torque 13-15ft. lbs.) in the rear mounting bracket.
17. Install heat shield clamps (supplied) in both front and rear (2) heat shields. Install heat shields and tighten all heat shield clamps. Be sure to position the clamps so the bolts are hidden from view.
18. Tighten the floorboard mounting bolts if so equipped.
19. Using the 3/8-16 x 2 3/4" bolt provided to reattach the right rear foot peg if so equipped, directly to the frame.

Important! Wipe down complete system with glass cleaner **before** starting bike to remove any finger prints or dirt.

Note: Finger prints that are not removed before running will become permanently etched in the pipes.

CLEANING

Never use harsh chemicals or any type of abrasive material to clean the chrome or ceramic coating on this exhaust system. We recommend using a soft non-abrasive cloth with a mild detergent such as liquid dish soap.

CONTACT US

Rinehart Racing
Phone 1-877-264-8282
www.rinehartracing.com

Check all mounting fasteners after first ride and again at all service intervals.

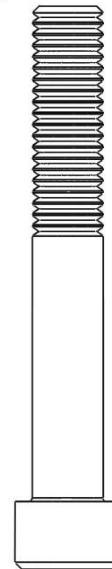
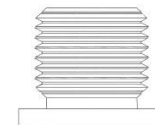
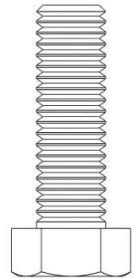
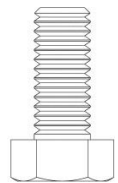
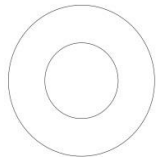
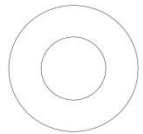
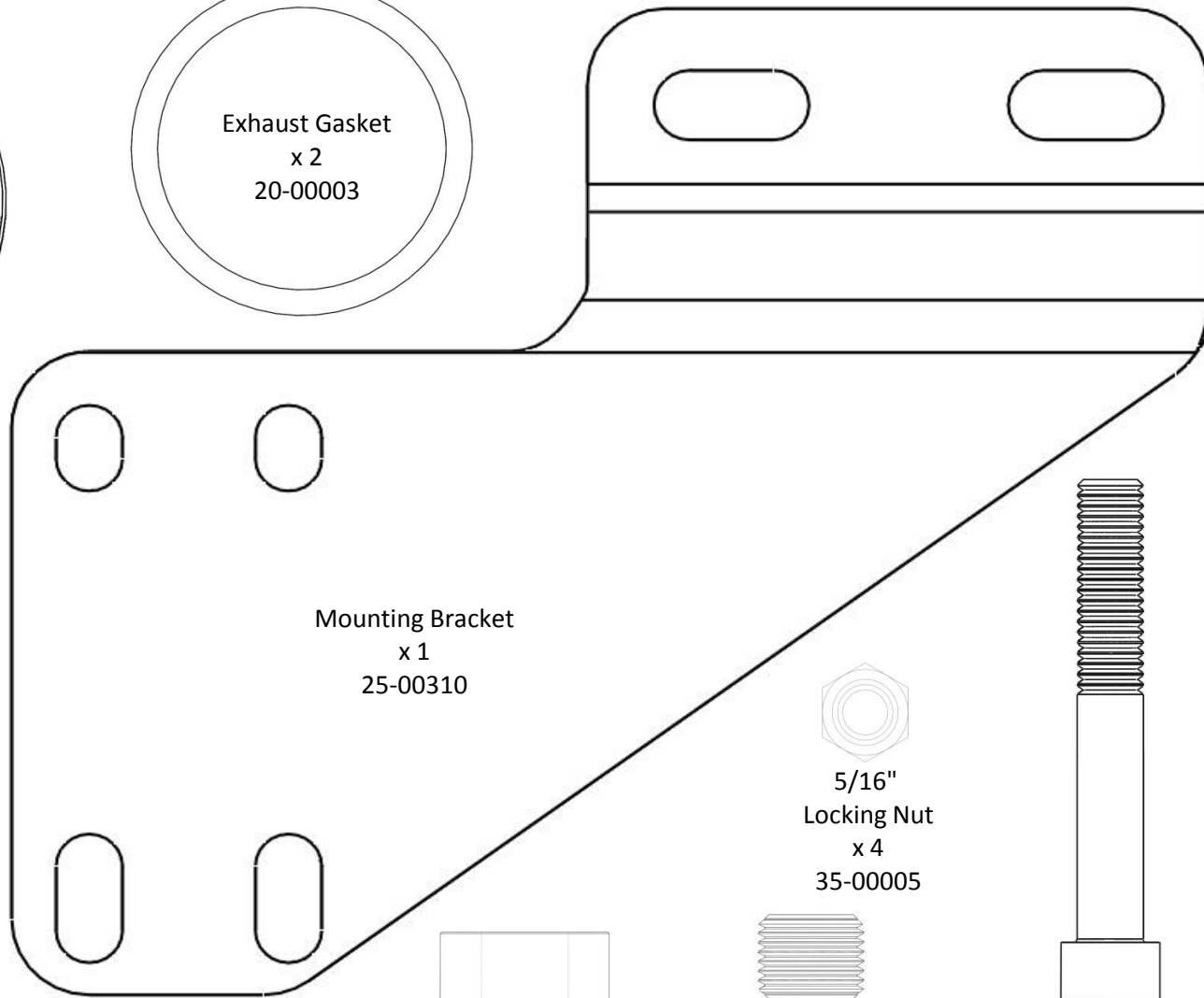
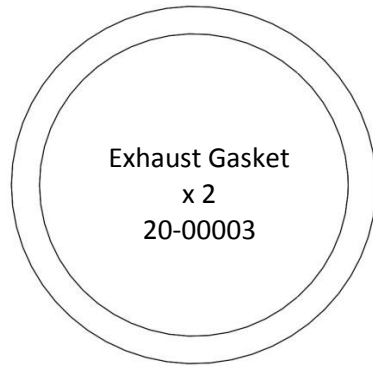

Rev. 9-25-2014