

---

# trent&steele

## INSTRUCTION MANUAL



**Citrus Juicer**  
**Model no. TS217**

---

## Important Safety Reminders

1. Read all instructions carefully before you use the appliance
2. Always disconnect the appliance from the supply if it is left unattended and before assembling, disassembling or cleaning
3. This appliance is not intended for use by persons (including children) with reduced physical, sensory or mental capabilities, or lack of experience and knowledge, unless they have been given supervision or instruction concerning use of the appliance by a person responsible for their safety.
4. Children should be supervised to ensure that they do not play with the appliance.
5. If the supply cord is damaged, it must be replaced by the manufacturer, its service agent or similarly qualified persons in order to avoid a hazard.
6. This appliance is intended to be used in household and similar applications such as :
  - staff kitchen areas in shops, offices and other working environments;
  - farm houses;
  - by clients in hotels, motels and other residential type environments;
  - bed and breakfast type environments.
7. Make sure that the voltage on the appliance's rating plate corresponds to the voltage on your mains supply meter.
8. Do not immerse the motor unit in water nor rinse it under the tap, Clean the motor unit with a damp cloth.
9. Unplug the appliance before cleaning or when you do not use it.
10. If the appliance malfunctions or if the mains cord or the plug is damaged, discontinue use. Return it to the manufacturer or authorized service agent to repair. Do not take it apart by yourself.
11. Do not use the appliance outdoors.
12. Do not hang the cord on the table edge. Do not let the mains cord touch hot surface or hang down where a child could grab it.
13. The appliance is designed for home use.
14. Keep 15 seconds of rest periods between operations.

---

15. If the juicer has been continuously used for 3 minutes, it may need time to cool down completely before restarting.

## Parts

- |                      |             |               |                   |
|----------------------|-------------|---------------|-------------------|
| 1. Transparent cover | 2. Big cone | 3. Small cone | 4. Filter A       |
| 5. Filter B          | 6. Jug      | 7. Motor unit | 8. Power cord set |

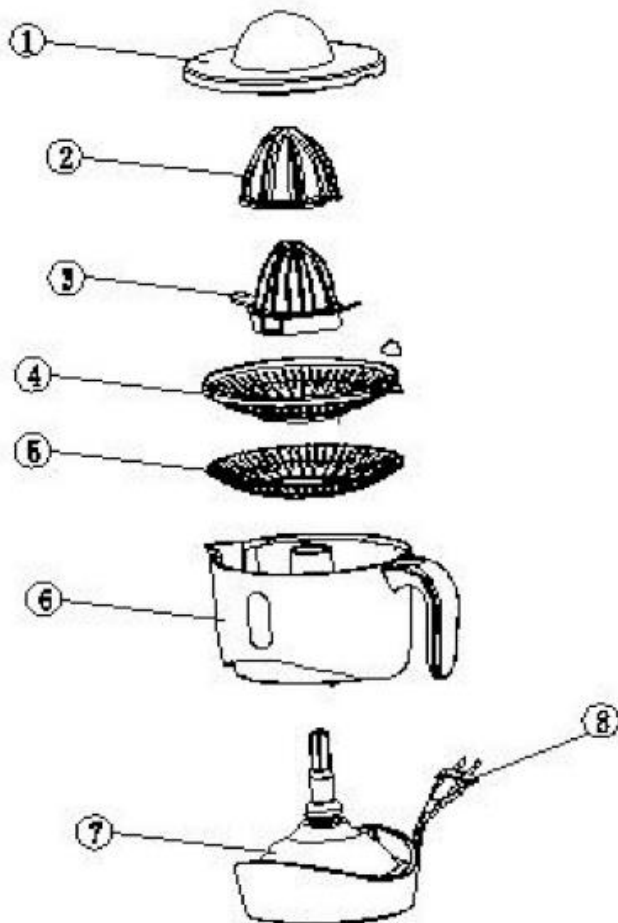

---

## How to use and clean your juicer

1. Put the jug (6) on the motor unit (7), (Fig1), turn it clockwise to lock in place.
  2. Put the filter A (4) on the filter B (5), turn it left and right to lock it in position. Put the small cone (3) on the shaft of the motor unit (Fig2).
  3. Plug in the appliance.
  4. Cut your citrus fruit (e.g. orange) into 2 pieces.
  5. Gently press each half of the orange on the cone. The citrus press will start operating automatically by turning to the right and to the left (Fig3).
- Note:** If the orange is too big, use the big cone. Put the big cone on the small one. The 2 gaps on the big cone must be locked on the 2 wings on the small cone.
6. Once done, unplug the Juicer, remove the cone(s), filter A and filter B (Fig4). Wash them thoroughly with water (Fig5-6), put the cover on, dry them with a cloth and store.

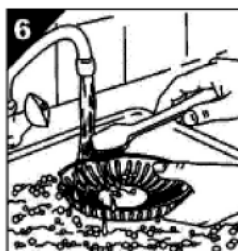
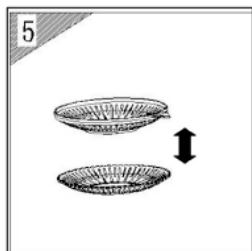
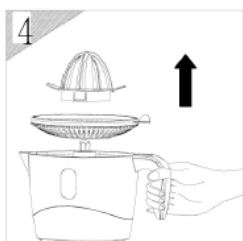
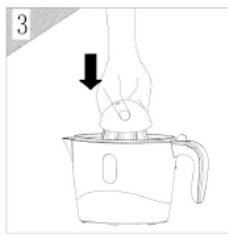
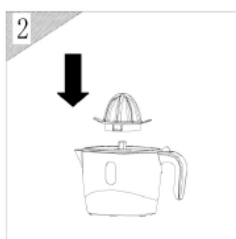
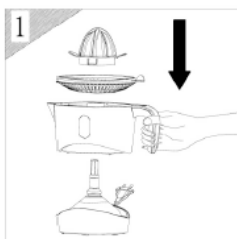

Specs: **AC 220-240V 50Hz 30W (0.5L)**