

此页不打印，仅展示说明书尺寸。

**This page is not printed, only shows the size of the manual.**

说明书尺寸: 105x150mm

**Instruction manual size: 105x150mm**



# CAR VENT MOUNT WITH WIRELESS CHARGING

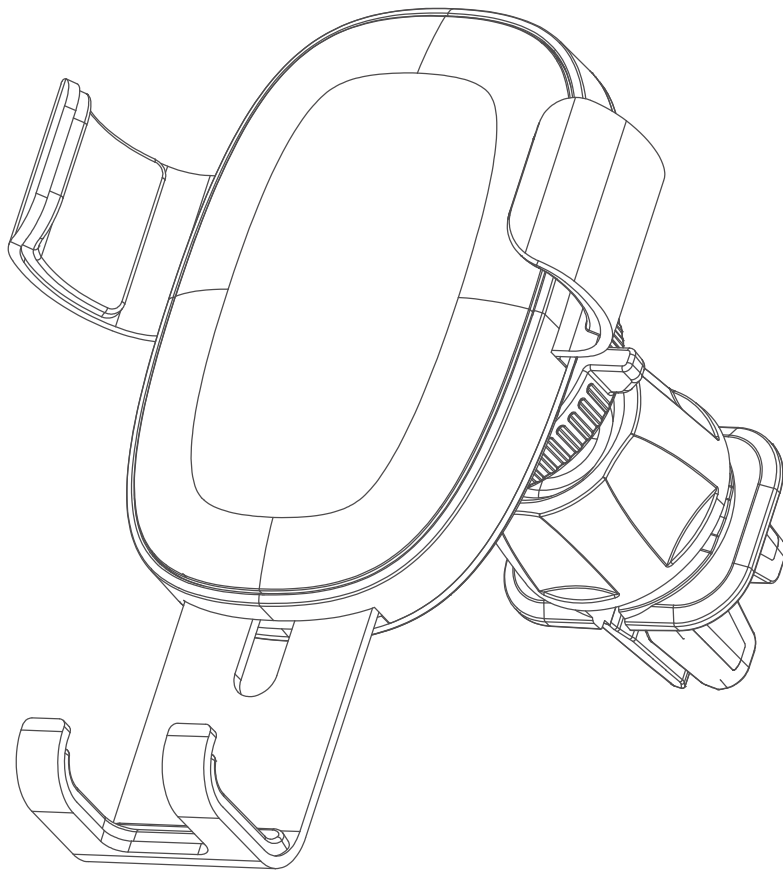

MODEL: 390385

## USER MANUAL



# 1 Welcome

---

## 2 Your Car Vent Mount with Wireless Charging

2.1 In The Box

2.2 Front View

2.3 Side View

---

## 3 Quick Setup

3.1 Connect Your Wireless Charger

3.2 Charging Your Smartphone

---

## 4 Fast Charging

4.1 Power Requirements

4.2 Charging Do's and Don'ts

---

## 5 Technical Specifications

---

## 6 UK Declaration



# 1 Welcome

Thank you for choosing this Goodmans product. We've been making electrical products for the British people for over 90 years. Each of our products have been carefully designed to be great at what they do and this one is no exception. We hope you enjoy your Goodmans Wireless Car Phone Charger and Holder.

## 2 Your Car Vent Mount with Wireless Charging

### **2.1 In The Box**

Carefully remove the unit from the packaging.  
Inside the box you will find:

- 1 x Car Vent Mount with Wireless Charging
- 1 x Type-C cable
- Quick Start Guide
- Instruction Manual
- Safety & Guarantee Booklet



## 2.2 Product View

### **A** Qi Charging Location

Used to charge your Qi enabled device.

### **B** Securing Arms

Used to secure your device.

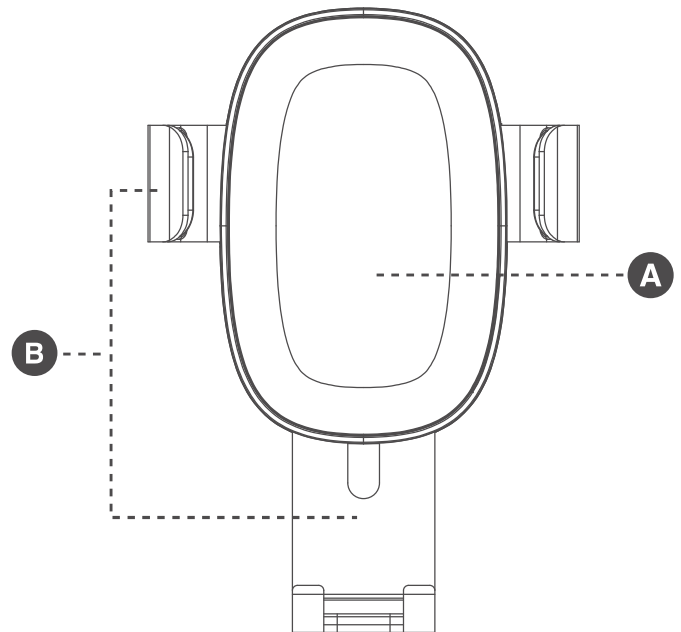

## 2.3 Side View

### **C** LED Indicator Light

Illuminates when charging

### **D** Type-C Input port

Used to power the wireless charger.

### **E** Angle Adjustment

Tighten to secure holder

### **F** Clip

### **G** Type-C Connector

### **H** USB-A to Type-C Cable

### **I** USB Connector

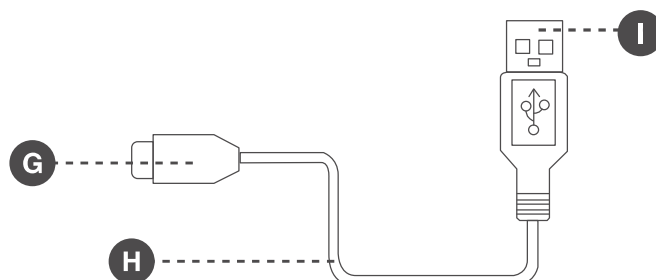
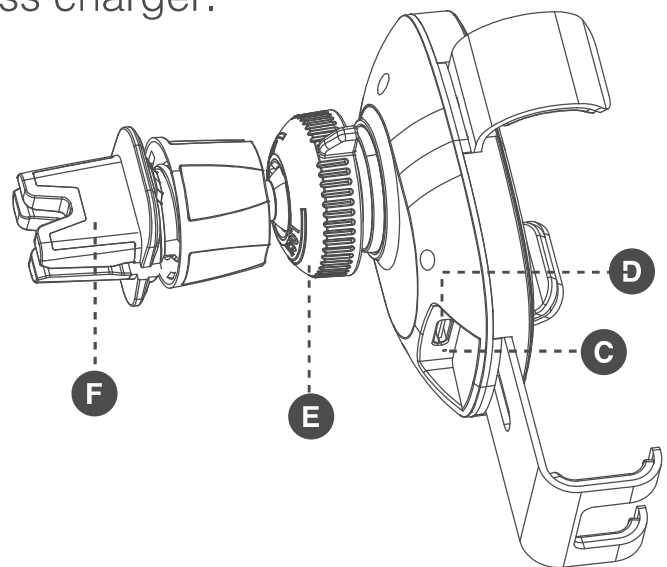



## 3 Quick Setup

### 3.1 Connect Your Wireless Charger

1. Please use the USB connection cable that is included. Connect the cable to the Type-C input port on the wireless charger.
2. Connect the other end to your USB cable to a suitable USB connection in your vehicle.
3. When connected successfully, the Green LED indicator light will flash 3 times.

### 3.2 Charging Your Smartphone

1. Loosen the nut of the clip. Open the clip and fix to a suitable vent in your dashboard. Adjust to the desired angle and then tighten the nut.
2. Using the cable provided, connect the Type-c into the charging port on the car mount and the other end into a suitable USB port.
3. Place your Smart Phone into the holder. Make sure your phone is placed centrally in the holder. The arms of the holder will grip your device.
4. The LED charge indicator will illuminate green when successfully charging.
5. Loosen the nut at the back to change the angle of the holder.

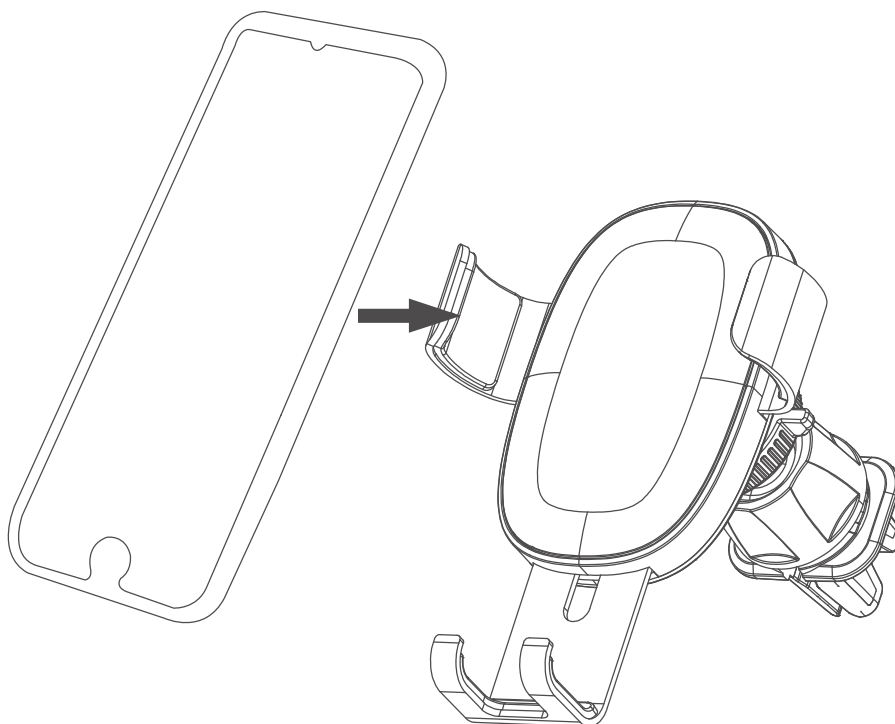



## 4 Fast Charging

### 4.1 Power Requirements

To enable the fast charge feature, connect the in car wireless charger to a Qualcomm Quick Charge car charger. This type of charger must be purchased separately.

*Even if your smartphone does not have Qi charging capability the Wireless Charger can still be used as a car phone holder.*

### 4.2 Charging Do's and Don'ts

1. For standard wireless charging you can use any car charger port with a 5V 2A output.
2. If your device supports fast charging we recommend that you use a car charger that has Qualcomm® Quick Charge™ technology.
3. Do not use in a hot, humid or corrosive environment.
4. Do not place and credit or debit cards in the charger.
5. Please keep the wireless charger at least 20cm away from any implantable medical devices (pacemakers, implantable cochlear, etc.)
6. Keep away from children.
7. Do not use a metal case for your smartphone when using the wireless charger.
8. For optimum charging times make sure that your device is not in a protective case that is more than 2mm thick, and that it is positioned centrally over the wireless charger.
9. Always ensure your phone is securely held when placed in the holder.



## 5 Technical Specifications

<b>Model Number</b>	390385
<b>Input</b>	5V $\equiv$ 2.0A 9V $\equiv$ 1.67A(fast charge)
<b>Output</b>	5W / 7.5W / 10W (fast charge)
<b>Dimensions</b>	W104*D109*H104mm
<b>Weight</b>	100g

## 6 UK Declaration

This product is intended for use within UK.

This appliance complies with the below listed UK directives.

Electromagnetic Compatibility Regulations 2016

Electrical Equipment (Safety) Regulations 2016

Radio Equipment Regulations 2017

The Restriction of the Use of Certain Hazardous Substances  
in Electrical and Electronic Equipment Regulations 2012

The complete declaration of conformity is available upon request for  
relevant enquiries.

The “Qi” Symbol is a trademark of the wireless power consortium.





## Information on Waste Disposal for Consumers of Electrical & Electronic Equipment



This mark on a product and/or accompanying documents indicates that when it is to be disposed of, it must be treated as Waste Electrical & Electronic Equipment (WEEE).

Any WEEE marked waste products must not be mixed with general household waste, but kept separate for the treatment, recovery and recycling of the materials used.

For proper treatment, recovery and recycling; please take all WEEE marked waste to your Local Authority Civic waste site, where it will be accepted free of charge.

If all consumers dispose of Waste Electrical & Electronic Equipment correctly, they will be helping to save valuable resources and preventing any potential negative effects upon human health and the environment of any hazardous materials that the waste may contain.



Made in China

**B&M Retail Limited, Dakota Drive, Speke, Liverpool, L24 8RJ, UK**  
Centz Stores 7 Limited, 5 Old Dublin Road, Dublin, A94 K1H5, Ireland

# Goodmans