

SL12 Hanging Light

Product Features

- Hanging, pendant luminaire for downlighting
- Single source LED chip for greater lux control
- Adjustable lumen output
- Sleek, patented design
- Frosted lens and hex lens included
- Surface mount available (sold separately)
- Design complies with IDA guidelines for dark sky preservation

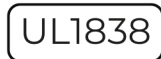

Specifications

Rev. 04/2024

Luminaire Type: Dedicated Low Voltage LED
Color Temperature: 2700K / 3000K
Material: Marine-Grade Virgin Brass with a UV Coating
Finish: Antique Bronze
Wattage: 0W - 5.2W
Field Angle: 100°

Lumen Output: 0 lm - 175 lm
Operating Voltage: 9V - 15V AC
Light Source: CREE LED
Color Rendering Index: 96+
TM-30 Rf: 94
TM-30 Rg: 102

Wire Lead: 15' 18AWG
Mounting: Ring on top of luminaire for hanging
Lens: Frosted Lens & Hex Lens
Accessories: Surface Mount, Grippl@ SS Cable Hanging Kit (all sold separately)
Listing: ETL
Standard: UL 1838
Rating: IP65

Product Drawings

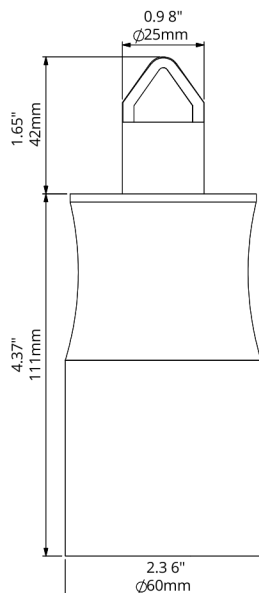

Adjustable Driver Settings at 15V Input

Settings	Lumens	VA	Lm/W
5 pins up (max)	175 lm	7.39 VA	33.64
4 pins up	130 lm	5.36 VA	35.77
3 pins up	85 lm	3.36 VA	37.38
2 pins up	40 lm	1.80 VA	35.68
1 pin up	15 lm	1.03 VA	27.30
0 pins up (min)	0 lm	0.0 VA	0.0

(Pins located on driver)