

Cable Strut Kit



Designed specifically for spanning installations and bracing applications. NOT suitable for use in chlorinated / swimming pool environments.

FEATURES / BENEFITS

- The light duty 1/8" version is ideal for suspending lightweight electrical services, ductwork and signage - up to 70 lbs per span
- The heavy duty 1/4" version is perfect for suspending M&E or HVAC services, or where a long Cable Strut is required - up to 220 lbs per span
- Supplied as ready-to-use kits including two fasteners, specific length of cable, and lock / release key
- Fast installation, reducing time spent working at height
- Quarter turn locking mechanism in the fastener prevents dynamic movements
- Easily tensioned using the Gripple D6 CTI Tensioning Tool (1/4" Cable Strut only)

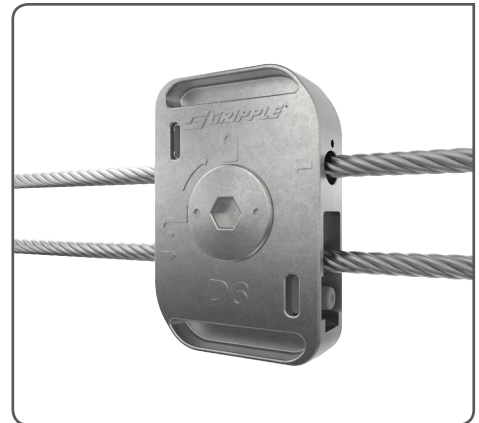

INSTALLATION & ADJUSTMENT

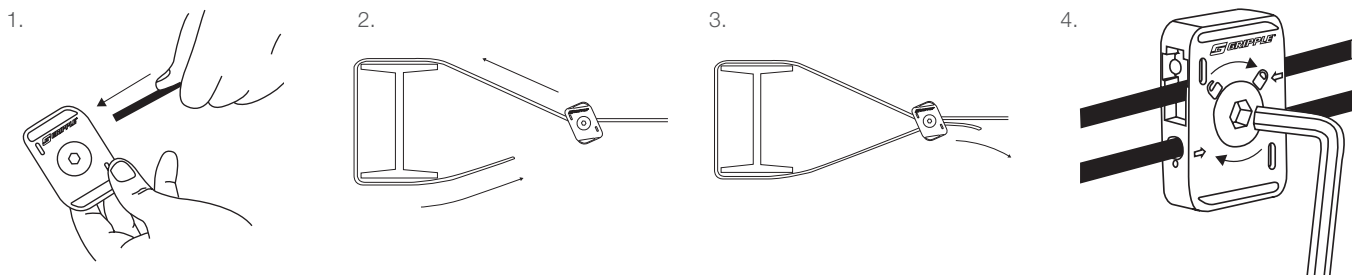

SPECIFICATION

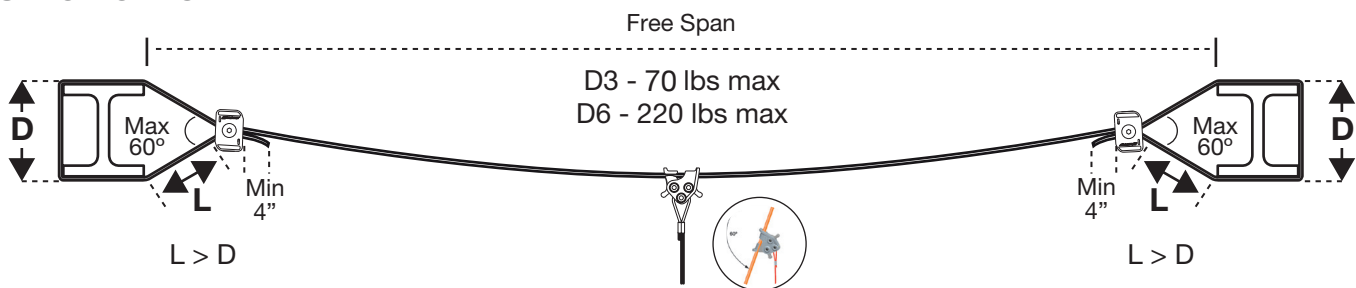

SUBMITTAL INFORMATION

Load Rating:

- D3 - up to 70 lbs vertical load per span
Connection type: 1/8" C-Clip
Not suitable for use with any Tensioning Tool
- D6 - up to 220 lbs vertical load per span
Connection type: 1/4" C Clip
Can be used with the D6 CTI Tensioning Tool

Fastener Material:

Ceramic rollers and stainless springs for optimum corrosion resistance

Cable Specifications:

- D3 - Galvanized 7x7 1/8" steel cable
(For Outdoor Use-CTO) Zinc Aluminum ZnAL
Coated Carbon Steel 1x19 1/8 cable
- D6 - Galvanized 7x19 1/4" steel cable
(For Outdoor Use-CTO) Zinc Aluminum ZnAL Coated
Carbon Steel 7x19 1/4" cable

AVAILABLE ACCESSORIES



CTI D6
Tensioning
Tool



1/8"
C-Clip



1/4"
C-Clip

For more options on available products please contact us or visit www.gripple.com

PI-CABLE-STRUT-KIT-US

www.gripple.com

Gripple's policy is one of continuous development and innovation. We therefore reserve the right to alter specifications, etc. without notice.



Gripple Inc | 1611 Emily Lane | Aurora, IL 60545 | USA

Tel +1 866 474 7753 Fax +1 800 654 0689 Email grippleinc@gripple.com