

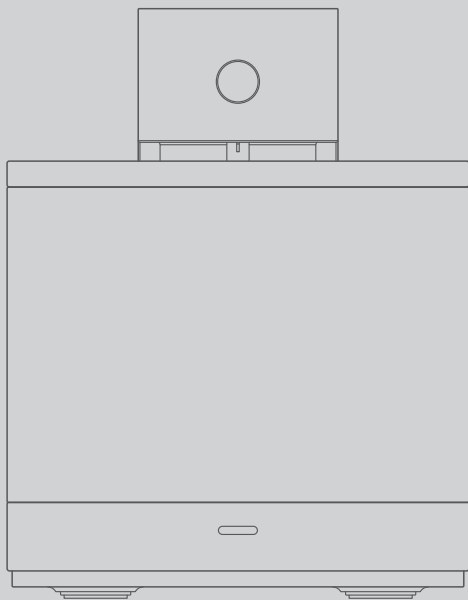

Waterdrop | **PAWAii**

Wireless Water Fountain Pro



User Manual

Please read and keep this manual safe for future reference.

 +1(833)810-3600(U.S.)  support@pawaii.com

(If there is any problem during use, please contact our customer service for help instantly.)

Specifications

Product Name: Wireless Water Fountain Pro

Product Model: WDWFO3W-W/PWF03W-R

Filter Model: PWF03FU

Product Weight: 2.65 lb/1200g

Charging Time: 3-4h (5V/2A)

Product Dimensions: 10.5*5.7*7.2 inches / 266*145*182 mm

Operating Mode: Plug-in / Battery-operated

Battery Capacity: 5000 mAh

Nominal Voltage/Current: 5V^{DC}, 2A

Rated Power: 1.2W

Water Tank Capacity: 2L / 8 cups

Product Main Parts Description

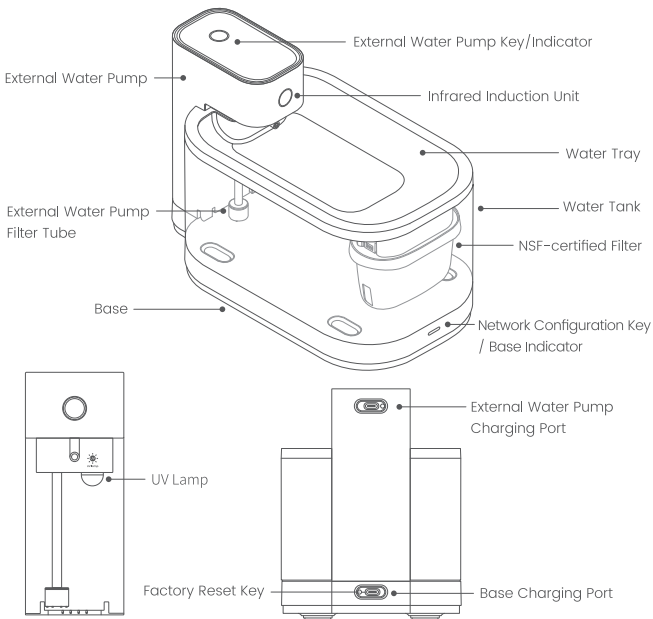

Parts List

TYPE-C Charging Cable (No Adapter), Manual

Installation Instructions

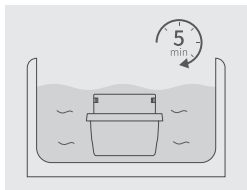

Step 1: Remove the filter and tear off the heat shrinkage film on its surface. Soak the filter in a clean bowl of water for 5 minutes.

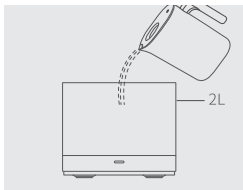

Step 2: After cleaning the water tank and tray, put the tank on the base and add 2L of fresh water.

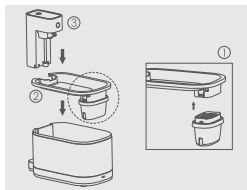

Step 3: Assemble the soaked filter with the water tray and place them on the water tank. Install the external water pump onto the water tank.

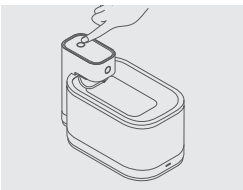

Step 4: Hold the on-off key for 3 seconds to turn on the device. It is recommended that the device be fully charged or plugged in before using it.

Note: To ensure the accuracy of the weighing data, please do not place the device on soft ground.

Operating Mode

• **Battery-operated Mode:** Device unplugged, battery supplies power.

• **Plug-in Mode:** Device plugged, charger supplies power.

Here are more differences between both modes:

Operating Mode	Battery-operated Mode	Plug-in Mode
Power Supply	Battery	Charger
Drinking Report on APP	Drinking time, drinking duration, drinking intake; real-time monitoring and data update every 4 hrs	Drinking time, drinking duration, drinking intake; monitoring and data update in real-time
APP accessibility	/	Power on/off, manual dispensing, filter countdown reset, cleaning countdown reset all doable via the APP
APP Reminder	Filter replacement reminder, water level reminder, power shortage reminder, and error reminder; real-time monitoring and data update every 4 hrs	Filter replacement reminder, water level reminder, power shortage reminder, and error reminder; monitoring and data update in real-time
Weighing Data Reset	/	To reset the weighing data, place the fountain on a hard floor and connect the base to a power cord. Next, remove the external water pump, water tank, and water tray at the same time. The reset is done once the green indicator of the network configuration key flashes twice.

Battery-operated Mode

Indicator Light Instructions

External Water Pump Indicator Light

Indicator Status	Device Status
Blue Light Always On	Water dispensing & UV irradiation normal
Green Light Flashes	Battery is recharging
Green Light Always On	Battery is fully-recharged
Red Light Always On	Low battery
Yellow Light Flashes	Filter lifespan \leq 3 days (Press the key at the top four times to reset the filter countdown.)

Base Indicator Light

Indicator Status	Device Status
White Light Flashes	The device is trying to connect to the network./The device goes offline.
White Light Always On	The device has finished network configuration.
Lights Off	Device off/Wi-Fi modules on standby. (Under the battery-operated mode, the device's indicator light of Wi-Fi stays off except for the data reporting period, which occurs once every 4 hours.)

APP Connection

1. Please scan the QR code to download and install the Pawaii App.
2. The fountain automatically enters the network configuration setting once you turn it on for the first time.
3. Ensure your mobile phone's Wi-Fi and Bluetooth are on, then open the Pawaii App. Click the "+" icon on the homepage to add your device, and bind the device according to the instructions.



⚠ Note:

- **Please power on the fountain in advance before conducting network configuration.**
- You can only configure your device under the 2.4GHz Wi-Fi connection. Please confirm that your router operates in the 2.4GHz band if you experience difficulties connecting.
- The water intake data will be reported in real-time under plug-in mode.
- The water intake data will be reported once every four hours under battery-operated mode.

• Manual Network Configuration:

It is best to do a manual configuration when switching networks. To do this, hold the network configuration key/base indicator for 3 seconds and enter the system after a beep sound. Then click the "+" icon on the homepage to add your device.

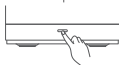

APP Function

- Drinking time, drinking duration, drinking intake; real-time monitoring and data update every 4 hours.
- Power on/off, manual dispensing, filter countdown reset, cleaning countdown reset all doable via the APP.
- Filter replacement reminder, water level reminder, power shortage reminder, and error reminder; data update every 4 hours.

Operation Modes of External Water Pump

Power On/Off: Hold the key at the top for 3 seconds.

Auto Dispensing: The fountain dispenses water once every hour and dispenses automatically once sensing pet's presence.

Manual Dispensing: Press the key at the top to dispense water once when the device is on.

Filter Countdown Reset: Press the key at the top four times to reset the filter countdown.

⚠ Note:

- The fountain AUTOMATICALLY repels floating hair once every 8 hours. It will repel floating hair and residue in 1 minute. The flow of water would increase during the period, as well as the operating sound, which is normal.

Recharging Instructions

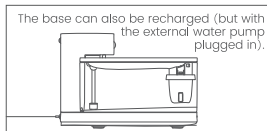
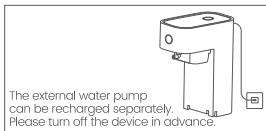

⚠ Note:

- The base cannot be recharged separately.
- Do not recharge the external water pump and base simultaneously.
- When the battery power is too low, the device will automatically shut down and enter a hibernation state. To wake it, press and hold the key for 3 seconds, and the red indicator will flash 5 times.
- Do not recharge the device with an adapter exceeding 5V/2A.

Cleaning and Maintenance

Please clean the filter, external water pump filter tube, water tray, water tank, and other parts every 7 days.

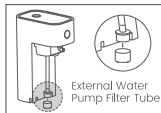
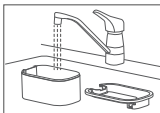
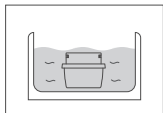

Note: Please turn the device off a few minutes before washing. The external water pump can be wiped but do not soak in water. The metal docking area between the external water pump and the base must be kept dry.

Filter Replacement

1. The filter must be replaced every 30 days. The yellow light will flash if the filter lifespan is shorter than 3 days.

2. After replacing the filter, tap the external water pump key four times consecutively to reset the filter lifespan. Once the reminder lights are off, the filter restarts its new round of 30-day countdown.

Follow the steps below to replace a new filter:



Step 1: Remove the filter and tear off the heat shrinkage film on its surface. Then soak the filter in water for 5 minutes.



Step 2: Pick up the external water pump and water tray, and remove the old filter.

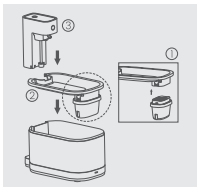

Step 3: Install the new filter and place the water tray and external water pump back in that order.



Step 4: Reset the filter lifespan on the device or APP after the replacement is complete.

Note: When the device is shut down, the countdown of filter's lifespan will still continue.

Plug-in Mode

Indicator Light Instructions

External Water Pump Indicator Light

Indicator Status	Device Status
Blue Light Always On	Water dispensing & UV irradiation normal
Green Light Flashes	Battery is recharging
Green Light Always On	Battery is fully-recharged
Red Light Always On	Low battery
Yellow Light Flashes	Filter lifespan \leq 3 days (Press the key at the top four times to reset the filter countdown.)

Base Indicator Light

Indicator Status	Device Status
White Light Flashes	The device is trying to connect to the network./The device goes offline.
White Light Always On	The device has finished network configuration.
Lights Off	Device off/Wi-Fi modules on standby. (Under the battery-operated mode, the device's indicator light of Wi-Fi stays off except for the data reporting period, which occurs once every 4 hours.)

APP Connection

1. Please scan the QR code to download and install the Pawai App.
2. The fountain automatically enters the network configuration setting once you turn it on for the first time.
3. Ensure your mobile phone's Wi-Fi and Bluetooth are on, then open the Pawai App. Click the "+" icon on the homepage to add your device, and bind the device according to the instructions.



ⓘ Note:

- Please power on the fountain in advance before conducting network configuration.
- You can only configure your device under the 2.4GHz Wi-Fi connection. Please confirm that your router operates in the 2.4GHz band if you experience difficulties connecting.
- The water intake data will be reported in real-time under plug-in mode.
- The water intake data will be reported once every four hours under battery-operated mode.

• Manual Network Configuration:

It is best to do a manual configuration when switching networks. To do this, hold the network configuration key/base indicator for 3 seconds and enter the system after a beep sound. Then click the "+" icon on the homepage to add your device.

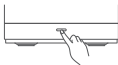

APP Function

- Drinking time, drinking duration, drinking intake; real-time monitoring and data update every 4 hours.
- Power on/off, manual dispensing, filter countdown reset, cleaning countdown reset all doable via the APP.
- Filter replacement reminder, water level reminder, power shortage reminder, and error reminder; data update every 4 hours.

Operation Modes of External Water Pump

Power On/Off: Hold the key at the top for 3 seconds.

Auto Dispensing: The fountain dispenses water once every hour and dispenses automatically once sensing pet's presence.

Manual Dispensing: Press the key at the top to dispense water once when the device is on.

Filter Countdown Reset: Press the key at the top four times to reset the filter countdown.

ⓘ Note:

• The fountain AUTOMATICALLY repels floating hair once every 8 hours. It will repel floating hair and residue in 1 minute. The flow of water would increase during the period, as well as the operating sound, which is normal.

Recharging Instructions

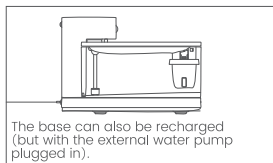
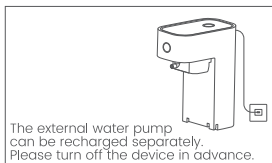

ⓘ Note:

- The base cannot be recharged separately.
- Do not recharge the external water pump and base simultaneously.
- When the battery power is too low, the device will automatically shut down and enter a hibernation state. To wake it, press and hold the key for 3 seconds, and the red indicator will flash 5 times.
- Do not recharge the device with an adapter exceeding 5V/2A.

Cleaning and Maintenance

Please clean the filter, external water pump filter tube, water tray, water tank, and other parts every 7 days.

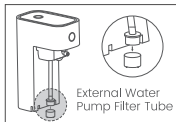
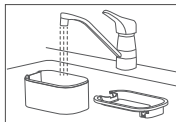
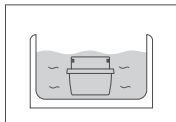

ⓘ Note: Please turn the device off a few minutes before washing. The external water pump can be wiped but do not soak in water. The metal docking area between the external water pump and the base must be kept dry.

Filter Replacement

1. The filter must be replaced every 30 days. The yellow light will flash if the filter lifespan is shorter than 3 days.

2. After replacing the filter, tap the external water pump key four times consecutively to reset the filter lifespan. Once the reminder lights are off, the filter restarts its new round of 30-day countdown.

Follow the steps below to replace a new filter:

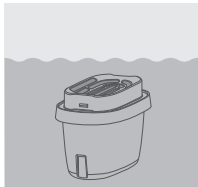

Step 1: Remove the filter and tear off the heat shrinkage film on its surface. Then soak the filter in water for 5 minutes.

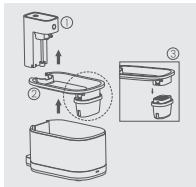

Step 2: Pick up the external water pump and water tray, and remove the old filter.

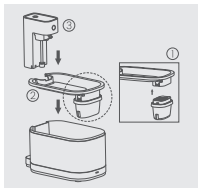

Step 3: Install the new filter and place the water tray and external water pump back in that order.

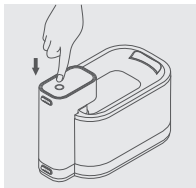

Step 4: Reset the filter lifespan on the device or APP after the replacement is complete.

⚠ Note: When the device is shut down, the countdown of filter's lifespan will still continue.

Weighing Data Reset

To reset the weighing data, place the base of the fountain on hard floors and connect it to a power cord, and remove the external water pump, water tank and water tray at the same time. The reset is complete once the green indicator of the network configuration key flashes twice. Please reset it every time the device is repositioned.

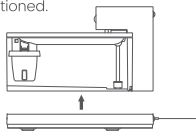

Factory Reset

Press and hold the reset key (you may need tools to activate the key) for 3 seconds to reset the device after a beep sound.

Note: The reset requires the placement of external water pump onto the base.

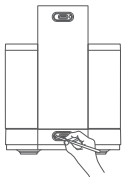

Common Issues and Solutions

1. Why is the pump not working?

- Ensure there is sufficient water in the tank.
- Check the APP for water pump failure reminders.

2. Why is the flow rate slow?

- Check the filter lifespan.
- Clean the filter and the external water pump filter tube.

3. Why is the reported drinking water intake data inaccurate?

- Ensure the base is not suspended or tilted.
- Note that the water fountain needs to be placed on hard and leveled ground.
- This will automatically reset the weighing data to zero.

4. Why is the device displaying offline?

- The equipment's power supply is interrupted, and the battery has run out under the battery-operated mode. In this case, kindly recharge it in time.
- Network outage occurs at home (possibly due to network provider failure, etc.). When this happens, the device remains operational, but the latest status and data of the device will not be accessible from the APP.

Built-in Battery Notice

1. The built-in battery is not removable. Please do not attempt to remove it so that the battery is not degraded or damaged. In severe cases, this may expose you to thermal safety hazards, resulting in fires and injuries.
2. If the product is not in use and will not be powered on for a long time, please recharge it at least once every 3 months.
3. Recharge the battery as soon as possible when there is insufficient power to protect battery life.
4. It is advisable to avoid usage at low temperatures. Otherwise, battery power will drop.
5. Do not expose the battery to any direct heat source, including direct fire or sunlight.
6. In the case of removal, the removed battery must be scrapped.
7. Do not place the fountain or battery in fire, water, or other liquid. This is to avoid any risk of explosion.
8. Do not dispose of lithium-ion batteries in household waste. Please follow local environmental laws and regulations.
9. Do not burn or expose the batteries to a high heat of more than 140 °F (60 °C). Please keep the battery away from the reach of children.

User Safety Instructions

1. Do not allow children to play in or around pet drinking fountains. Monitor closely when the device is used near a child.
2. Do not use the fountain if your pet is out of reach to the water tray or is physically disabled.
3. Do not place any foreign objects in the water tank.
4. Do not remove any of the components except where described in this user manual.
5. Do not use the pet drinking fountain for other purposes.
6. Do not pour other liquids aside from water into the tank.
7. Do not operate the device if it has failed or is damaged. Don't try to fix the device yourself. For further help and clarifications, please get in touch with our customer service.
8. If the device is not used for a long time, turn it off and unplug it for safety reasons.
9. Power the device off before cleaning and maintenance.
10. Ensure that the power adapter and wire plug are not exposed to water while cleaning.
11. This product is for indoor use only.
12. This product is not designed for use without water and should not be used as such.
13. To avoid tripping, do not place power cables in your walkway at home.
14. The filter must be replaced at least once a month or when the flow rate drops significantly. For two or more cats, you may need to replace the filter more frequently to prevent quick clogging.
15. Do not place the components of this fountain in a dishwasher to avoid deformation.
16. Do not expose the UV light directly to human and animal eyes.
17. When using the product, place it on hard horizontal ground and do not overturn it.

Warning

1. Please properly handle all packaging materials. Keep plastic and pet bags away from children to prevent the possible risk of suffocation.
2. Do not block the outlet while the device is in operation.
3. Do not put the product or its components into water or fire. If this happens unexpectedly, stop use and get it out immediately.
4. When recharging, do not let pets bite wires to avoid electricity leakage or electric shock.
5. Do not plug in the device if water is in the docking area or the plug. When the plug gets wet during use, turn off the socket on the wall first.
6. Do not use this device in the bathroom.



This device complies with part 15 of the FCC Rules. Operation is subject to the following two conditions: (1) This device may not cause harmful interference, and (2) this device must accept any interference received, including interference that may cause undesired operation. Any changes or modifications not expressly approved by the party responsible for compliance could void the user's authority to operate the equipment.



• This appliance can be used by children aged from 8 years and above and persons with reduced physical, sensory or mental capabilities or lack of experience and knowledge if they have been given supervision or instruction concerning use of the appliance in a safe way and understand the hazards involved.

• Children shall not play with the appliance.



• Cleaning and user maintenance shall not be made by children without supervision.

• Appliances must only be supplied at safety extra low voltage corresponding to the marking on the appliance.

• The battery must be removed from the appliance before it is scrapped; the appliance must be disconnected from the supply mains when removing the battery; the battery is to be disposed of safely.

• This appliance contains batteries that are non-replaceable.

Waterdrop | PAWAIi



Please scan the QR code to
download & install the Pawai App.

Pawai Inc.

E-mail: support@pawai.com

Tel: +1(833)810-3600(U.S.)

Address: 251 Little Falls Drive, City of Wilmington, County of New Castle, DE 19808

Made in China V006