



Fork Owner's Manual

DVOSUSPENSION.COM

ENGLISH	2	ESPAÑOL	26
FRANÇAIS	10	日本語	42
DEUTSCH	18	中文	50
ITALIANO	26		

Congratulations!

Thank you for purchasing DVO Suspension for your mountain bike. DVO Suspension products are designed by riders for riders. It is very important for your safety that you follow the guidelines, instructions and set-up information provided in this owner's manual or on our website.

DVO TECH

Go to <http://tech.dvosuspension.com> for setup, service guides and tuning information. DVO Tech has detailed information and articles on suspension setup and tuning to help you understand how suspension works and how each adjustment affects the performance of your fork and shock. Detailed step by step instructions and videos are available to show you how to properly perform service jobs such as changing seals and oil to more advanced tasks like damper services. DVO Tech also has a forum where you can communicate with DVO technicians and search a database of questions and answers.

WARNING

Failure to comply with these warnings and instructions may cause
SERIOUS INJURY, DEATH, or DAMAGE TO YOUR PRODUCT.

Be sure to read this manual carefully before using your DVO suspension. Throughout this manual, reference is made that "an accident" could occur. Any accident may cause damage to the product, **SERIOUS INJURY, OR DEATH.**

These instructions contain important information about the correct installation, guidelines for set-up, service and maintenance of your suspension. Nevertheless, please be informed that special knowledge and tools are essential to install, service and to maintain DVO Suspension. Common mechanical knowledge may not be sufficient to repair, service or maintain your suspension. Therefore we strongly recommend getting your suspension installed, serviced and/or maintained by a trained and qualified bicycle mechanic. Improper installation, service or maintenance can result in an accident.

Forks and rear shocks contain fluids and air under extreme pressure. **DO NOT** attempt to disassemble any portion of a DVO Suspension product unless instructed to do so by a DVO Suspension authorized technician.

Only use genuine DVO Suspension replacement parts. Modification, improper service, or the use of aftermarket replacement or spare parts may result in an accident and **VOIDS** the warranty of your product.

DVO Suspension forks and rear shocks are designed for the usage by a single rider only. **DO NOT** use DVO Suspension products on any motorized bicycle, or motorized vehicle.

Always be equipped with proper safety gear. This includes a properly fitted and fastened helmet. According to your riding style you should use additional safety protection. Make sure your equipment is in flawless condition.

Make sure you select the correct fork and rear shock according to your frame manufacturer specification. Installing suspension that does not match the geometry of your frame could result in a failure of the suspension itself and void the suspension warranty. Installing a fork or rear shock not designed for your frame will change the geometry and handling of your bike. Learn how to ride and train your skills. Know your limits and never ride beyond those.

Study all other manuals provided with your bicycle and make yourself familiar with all components mounted to your bike.

Fork Installation

WARNING

DVO Suspension strongly recommends that your fork be installed by a trained and qualified bicycle mechanic. Special knowledge and tools are essential to properly install DVO Suspension forks. Common mechanical knowledge may not be sufficient to install a DVO Suspension fork. If you intend on installing the fork by yourself, the whole job needs to be inspected by a trained and qualified bicycle mechanic. Please note, that improperly installed forks are extremely dangerous and cause damage to the product, serious injury or even death.

1. If changing a fork on an existing bicycle, remove the front wheel and brake from your fork. After, remove the headset crown race from the fork.
 2. Using a headset race installer, install the headset crown race on new steer tube. Make sure it is firmly against the fork crown leaving no space between the crown race and the fork crown. (Refer to your headset manufacturer's instructions to make sure the crown race is properly installed)
 3. Measure the steer tube length of existing fork and transfer this measurement to your new fork steer tube. If you do not have an existing fork to measure you must install the fork into the bicycle's head tube with the complete headset, stem and spacers. (Refer to your stem manufacturer's instructions to be sure there will be enough clamping surface for the stem.) In this case you may need to cut your steer tube slightly shorter (3mm) to allow enough clamping surface so that the stem cap bolt can pull up on the steer tube, ensuring a snug and proper fit.
 4. If it is necessary to cut the steer tube, **MEASURE TWICE CUT ONCE.** It is recommended that a cutting guide be used when cutting the steer tube.
 5. Install the star nut into the steer tube using a star nut installation tool to the proper depth.
 6. Install the fork into the frame head tube. Tighten the star nut bolt so that there is no play or drag in the headset when turning the steer tube.
Dual Crown Fork : Install the steering bumpers onto the upper tubes. Use a torque wrench to tighten all top and lower crown pinch bolts to **7Nm**.
 7. Install the front brake according to the manufacturer's instructions and make sure you adjust the brake pads properly. Ensure that brake line length is the correct length to not effect steering or compression and extension of the fork.
NOTE: Rotor size must be between 160mm-203mm
 8. Install the front brake hose through the cable guide. Make sure the hose is routed on the inside of the leg. Use a 2mm allen key and torque to 3nm to secure hose and cable guide.
-  All DVO Suspension forks come with a threadless steer tube. Do not add a thread to it! DVO Suspension fork steer tubes are for one-time press fit only which cannot be removed. Do not try to replace the steer tube with a threaded steer tube. This will void the warranty of your fork.

Wheel Installation

Please make sure you have the correct wheel size for your fork model.

15mm Quick Release Installation

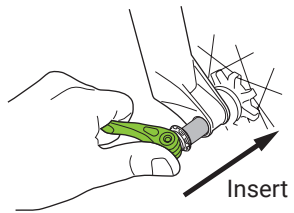

1. Make sure the hub fits into the drop outs, then insert the thru axle from the non-disc side. Slide in the axle until it makes contact with the threads of the axle bolt on the disc side.

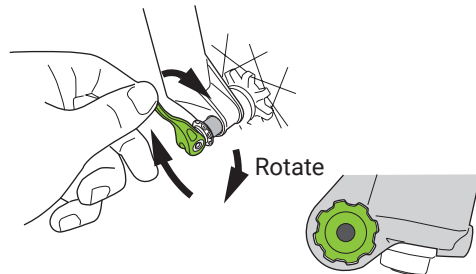

2. Rotate the axle lever clockwise until there is a small gap between the lever bolt and dropouts on the non-disc side. If the axle bolt is not sitting inside the grooves release tension on the axle and line up the axle bolt so that you can lightly press it into the grooves.

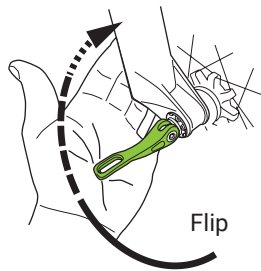

3. To secure the axle, position the lever in the open position. When you flip the lever half way you should feel resistance and the lever bolt should be touching the drop out. Flip the lever to the closed position by hand strength only. The lever should feel very secure. DO NOT USE ANY TOOLS FOR LEVERAGE.

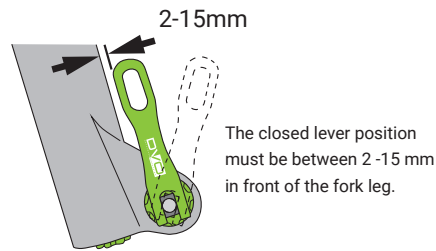

⚠ WARNING
Do not rotate the axle lever while it is in the closed position. This can cause the axle to loosen up and result in an accident, personal injury or death.

4. If there is too much or too little resistance adjust the axle bolt on the disc side. Unthread the axle 3 full turns then push the axle to the drive side. This will push the axle bolt out so you can adjust it. If the axle has too much tension then turn the axle bolt counter clock wise. If the axle did not have enough tension then turn the axle bolt clock wise. Rotate axle lever clockwise again and secure lever until there is proper tension in the closed position.

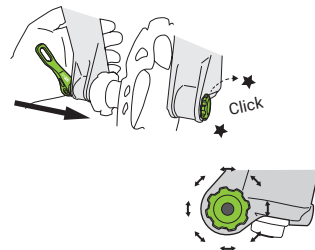

5. Remove bike from stand. With the front brake on, lightly rock the bike back and forth to ensure the headset preload is at the appropriate torque value. THERE SHOULD BE NO PLAY IN THE HEADSET.

15mm Thru-Axle Installation

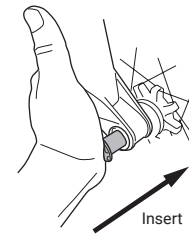

1. Insert the axle through the drive-side dropouts and hub.

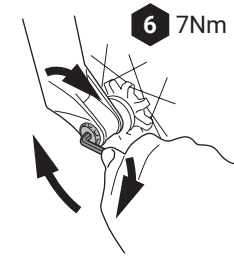

2. Use a 6 mm hex wrench to torque the axle to 7 Nm.

20mm Pinch Axle Installation

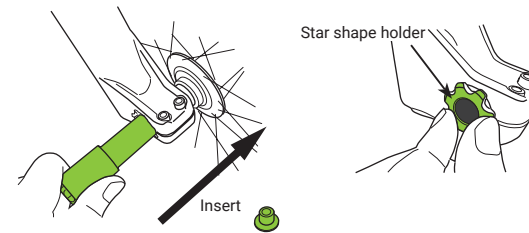

1. Install the front wheel into the dropouts and insert the axle and align the star shape holder, through the dropouts and hub.

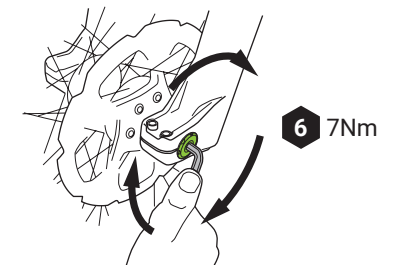

2. Use a 6 mm hex wrench to torque the axle nut to 7 Nm.

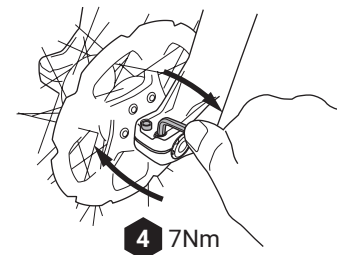

3. Use a 4 mm hex wrench to torque the two pinch bolts on the non-drive side dropouts to 7 Nm.

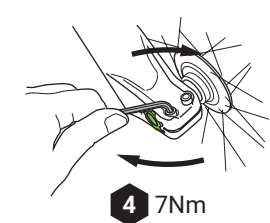

5. Use a 4 mm hex wrench to torque the two pinch bolts on the drive side dropouts to 7 Nm.

4. Compress the fork a couple of times to ensure that the lower leg has settled into its low-friction point.

Fender Installation

All DVO forks comes with an integrated fender that can be used during muddy or sandy conditions.

Single Crown Fork

1. Using a 3mm allen key (ball end recommended), carefully thread in the 2 snap-in bolts into the lower holes on the rear of the arch and torque to 3Nm. Once these have been installed these bolts do not have to be removed. *Be careful to not scratch the stanchions during installation.

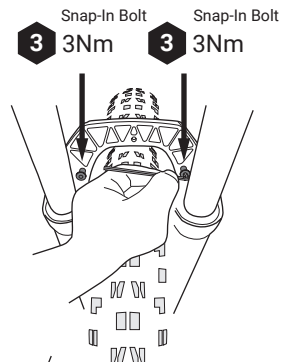

2. Line up the fender with the snap-in bolts and press down until secure. Fender will "snap" into place. **BE SURE TO APPLY PRESSURE OVER THE MOUNT BOLT AND NOT THE TAIL OF THE FENDER.**

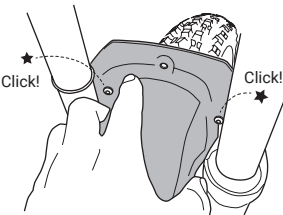

3. Using a 3mm allen key, insert the fender mount bolt into the center of the arch and torque to 3Nm. There should be no play between the fender and the arch.

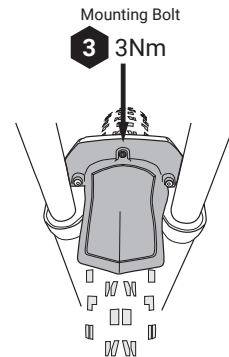

Fender Removal

Unthread the center mount bolt first. Then pull the fender upwards to release it from the lower snap-in bolts. **DO NOT PULL UP** on the tail of the fender. The snap-in bolts will stay threaded into the arch.

Dual Crown Fork

Using a 2.5mm allen key, insert the fender mount bolt, torque to 3Nm. There should be no play between the fender and the arch.

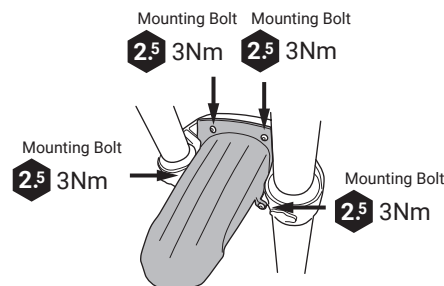

Tire Clearance

Make sure you have the correct wheel size size for your fork. Each tire and manufacturer has a different outer diameter (tire width and height). Therefore the clearance between your tire and fork needs to be checked to make sure it does not come in contact with any part of the fork.

⚠ WARNING

Inadequate tire clearance will result in an accident, personal injury or death

Tire Clearance Test:

1. Release all air from your fork.
2. Compress your fork completely.
3. Measure the distance between the top of the tire and the bottom of the crown or fender. Make sure this gap is **NO LESS** than 6mm! Exceeding maximum tire size will cause the tire to jam against the bottom of the crown when the fork is fully compressed.

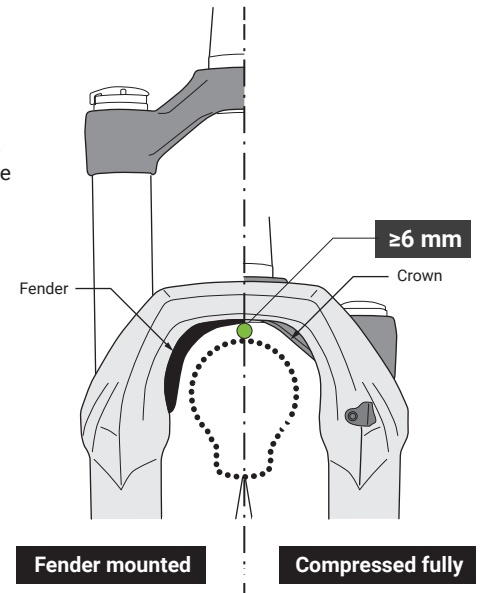

Service & Maintenance

⚠ WARNING

Failure to properly maintain your fork will result in an accident, personal injury or death.

We recommend all DVO Suspension service should be performed by a qualified bicycle mechanic. Service information and detailed instructions can be found at <http://tech.dvosuspension.com> or by contacting your local DVO Suspension dealer or distributor.

Terrain, location and riding ability can greatly affect the interval in which maintenance should be performed. Always inspect your products, and lean towards caution if maintenance is in question. When in doubt, consult a qualified bicycle mechanic, or contact DVO Suspension directly.

Minimum Recommended Service Items	Interval
Check Air Pressure	Before Every Ride
Inspect Stanchion Tube for Scratches	Before Every Ride
Clean Stanchion Tubes	After Every Ride
Check Torque Settings	25 Hours
Remove Lower, Clean/Inspect Bushing & Change Oil	50 Hours
Service Air Spring Assembly	100 Hours
Service Damper Cartridge	100 Hours

Recommended Max Torque Specifications

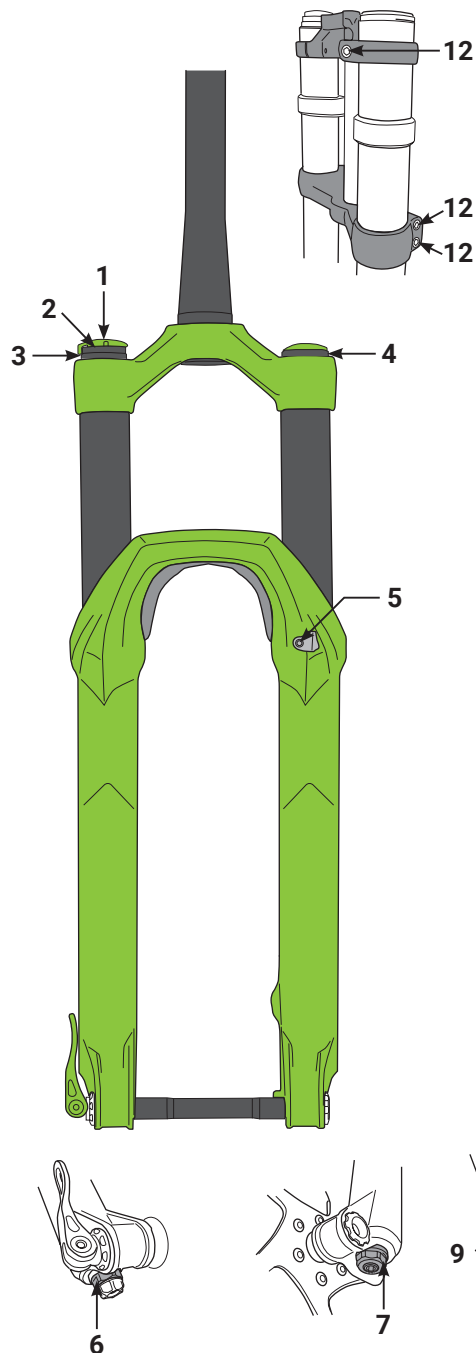

	Part	
1	Compression Knob Screw	3 Nm 26.5 in.lbf
2	Compression Loader	9 Nm 80 in.lbf
3	Top Plug Damper Cartridge	15 Nm 132 in.lbf
4	Top Plug Air Cartridge	15 Nm 132 in.lbf
5	Cable Guide Bolt	3 Nm 26.5 in.lbf
6	Rebound Foot Nut	10 Nm 88 in.lbf
7	OTT Foot Nut	10 Nm 88 in.lbf
8	Fender Mount Bolt	3 Nm 26.5 in.lbf
9	Fender Snap-in Bolts	7 Nm 62 in.lbf
10	15 mm Tool Type Axle	7 Nm 62 in.lbf
11	20 mm Tool Type Axle	7 Nm 62 in.lbf
12	Pinch bolt	7 Nm 62 in.lbf

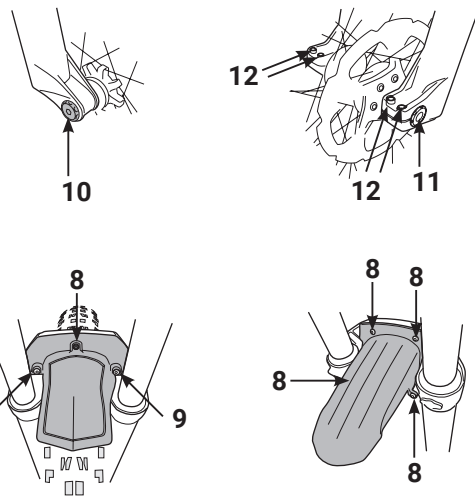

Limited Two (2) Year Warranty

If any component of your DVO Suspension product is found to be defective in materials or workmanship within the term of this Limited Two Year Warranty (the "Agreement"), the defective component will be repaired or replaced, at the option of DVO Suspension free of charge, within thirty (30) days after receipt of the Suspension product by an authorized DVO Suspension dealer, freight prepaid, together with the original retail invoice or other evidence of the date of purchase.

NOT COVERED:

This warranty does not cover damage resulting from accidents, alteration, neglect, misuse, abuse, or improper use, lack of reasonable or proper maintenance, improper assembly, repairs improperly performed or replacement parts or accessories not conforming to DVO Suspension's specifications, modifications not recommended or approved in writing by DVO Suspension activities such as acrobatics, stunt jumping, ramp riding, racing, commercial use, and / or normal wear or deterioration occasioned by the use of the product. Items subject to normal wear or deterioration include but are not limited to oil, dust seals, oil seals, and bushings. In addition, this warranty is void in the event that the forks are used with any rental bicycles, unless DVO Suspension provided prior approval in writing for such use. This warranty also does not include any expenses related to the transportation of the DVO Suspension product to or from an authorized DVO Suspension dealer, labor costs to remove the DVO Suspension product from the bicycle, or compensation for inconvenience or loss of use while the DVO Suspension product is being repaired. This warranty will be automatically void if serial number of the DVO Suspension product is altered, erased, defaced or otherwise subject to any tampering.

PURCHASER.

This warranty is made by DVO Suspension with only the original purchaser of the DVO Suspension product and does not extend to any third parties. The rights of the original purchaser under this warranty may not be assigned.

TERM.

The term of this warranty shall commence on the date of purchase and shall continue for a period of two (2) years from the date of the original purchase.

PROCEDURE.

In event of a defect covered by this warranty, the purchaser should contact an authorized DVO Suspension dealer or a DVO Suspension Service Center.

ENTIRE AGREEMENT.

This warranty supersedes any and all oral or express warranties, statements or undertakings that may previously have been made, and contains the entire agreement between the parties with respect to the warranty of this DVO Suspension product. Any and all warranties not contained in this warranty are specifically excluded.

DAMAGES.

Except as expressly provided by this warranty, DVO Suspension SHALL NOT BE RESPONSIBLE FOR ANY INCIDENTAL OR CONSEQUENTIAL DAMAGES ASSOCIATED WITH THE USE OF THE DVO SUSPENSION PRODUCT OR A CLAIM UNDER THIS AGREEMENT, WHETHER THE CLAIM IS BASED ON CONTRACT, OR OTHERWISE.

The foregoing statements of warranty are exclusive and lieu of all other remedies. Some states do not allow the exclusion or limitation of incidental or consequential damages, so this limitation or exclusion may not apply to you.

DISCLAIMER.

ANY IMPLIED WARRANTY OF MERCHANTABILITY OR FITNESS FOR A PARTICULAR PURPOSE AND ALL IMPLIED WARRANTIES ARISING FROM A COURSE OF DEALING, USAGE OF TRADE, BY STATUTE OR OTHERWISE, IS HEREBY STRICTLY LIMITED TO THE TERM OF THIS WRITTEN WARRANTY. This Agreement shall be the sole and exclusive remedy available to the purchaser with respect to this purchase. In the event of any alleged breach of any warranty or any legal action brought by the purchaser based on alleged negligence or other tortious conduct by DVO Suspension the purchaser's sole and exclusive remedy will be repair or replacement of defective materials as stated above. No dealer and no other agent or employee of DVO Suspension is authorized to modify, extend or enlarge this warranty.

WARNING.

Always install, repair and use your DVO Suspension product in strict compliance with its owner's manual.

OTHER RIGHTS.

This warranty gives you the specific legal rights, and you have also other rights which vary from state to state (USA only).

APPLICABLE LAW.

Any disputes arising out of this agreement or the use of this DVO Suspension product will be governed by the laws of the country of United States and will be decided by the Courts of California.

Félicitations!

Merci d'avoir choisi DVO Suspension pour votre vélo tout terrain. Les produits DVO sont dessinés par des riders pour des riders. Il est très important pour votre sécurité de suivre les indications, instructions et procédures de réglage se trouvant dans le manuel d'utilisation ou sur notre site web.

DVO TECH

Connectez-vous à <http://tech.dvosuspension.com> pour l'installation, le guide d'entretien et des informations pour de réglages. DVO Tech a des informations détaillées et des articles sur l'installation et les réglages de suspensions pouvant vous aider à comprendre son fonctionnement et l'effet des différents réglages sur la performance de votre fourche ou amortisseur. Des instructions détaillées et des vidéos sont disponibles pour vous guider pas à pas pour faire des interventions comme changer les joints et l'huile de votre fourche, ou pour un travail plus avancé comme intervenir sur le damper. DVO Tech a aussi un forum où vous pouvez communiquer avec un technicien DVO et accéder à une base de données de questions réponses.

⚠ ATTENTION!

Ne pas respecter ces instructions peut causer **DES BLESSURES GRAVES OU MORTELLES** ou **ENDOMMAGER VOTRE PRODUIT**.

Prenez soin de bien lire et comprendre ce manuel avant d'utiliser votre suspension DVO. Tout au long de ce manuel nous faisons référence à « un accident » pouvant arriver. Tout accident peut causer des dommages à votre produit, **DES BLESSURES GRAVES OU MORTELLES**.

Ces instructions contiennent des informations importantes concernant l'installation correcte, ajustements et réglages, et maintenance de votre suspension. Toutefois soyez informé que des connaissances et outils spéciaux sont essentiels pour installer, entretenir et maintenir les suspensions DVO. De général connaissances en mécanique peut être insuffisant pour réparer, entretenir et maintenir votre suspension. Nous recommandons donc fortement d'avoir votre suspension installée, entretenue et/ou maintenue par un mécanicien cycle qualifié. Une installation, entretien ou maintenance non conforme peut causer un accident.

Fourches et amortisseurs contiennent des fluides et de l'air comprimé à très haute pression. **NE PAS** essayer de désassembler aucune partie d'une suspension DVO sauf si vous y êtes invité par un technicien certifié DVO Suspension.

Utiliser uniquement des pièces détachées d'origine DVO Suspension. Toutes modifications, entretien non conforme, ou utilisation des pièces détachées non d'origine DVO Suspension peut causer un accident et **ANNULER** la garantie de votre suspension.

Les fourches et amortisseurs DVO Suspension sont conçus pour être utilisés par un seul cycliste seulement. **NE PAS** utiliser les Suspensions DVO pour une bicyclette ou véhicule motorisé de quelque sorte que ce soit. Toujours porter les équipements de protection appropriés. Cela inclut un casque à la bonne taille et attache. En fonction de votre style de conduite vous devrez porter des protections supplémentaires.

Assurez vous que votre équipement de protection est en parfaite condition.

Assurez-vous de choisir la fourche ou amortisseur en fonction de votre cadre, et des données constructeur de celui-ci. Installer une suspension ne correspondant pas à la géométrie de votre cadre peut entraîner une défaillance de votre suspension et annuler la garantie. Installer une fourche ou amortisseur qui n'est conçu pour votre cadre changera la géométrie et le comportement de votre vélo. Apprenez à rider votre vélo et entraînez-vous. Connaissez vos limites et ne les dépassez pas.

Étudiez les autres manuels fournis avec votre vélo et familiarisez-vous avec tous les composants montés sur celui-ci.

Installation De La Fourche

⚠ ATTENTION!

DVO Suspension recommande vivement que votre fourche soit installée par un mécanicien cycle formé et qualifié. Des connaissances et outils spéciaux sont essentiels pour installer une suspension DVO correctement. Des connaissances mécaniques générales peuvent être insuffisantes pour installer une fourche DVO Suspension. Si vous tentez d'installer la fourche vous-même, faites vérifier votre travail par un mécanicien cycle formé et qualifié. Merci de noter qu'une fourche mal installée est extrêmement dangereuse et cause des dommages au produit, blessures graves voir mortelles.

1. Si vous remplacez la fourche d'un actuel vélo, démontez la roue avant et le frein de votre fourche. Ensuite démontez le cône de fourche de la couronne.
 2. À l'aide d'un emmanche cône de fourche installez le cône de fourche sur le nouveau tube pivot. Assurez-vous qu'il est fermement en appui contre la couronne ne laissant aucun espace entre la couronne et le cône. (Consultez le manuel d'installation de votre jeu de direction pour vous assurer que le cône est installé correctement.)
 3. Mesurez la longueur du tube pivot de votre ancienne fourche et appliquez cette dimension à votre DVO Diamond tube pivot. Si vous n'avez pas l'ancienne fourche comme référence, vous devez installer la fourche sur votre vélo avec le jeu de direction complet, potence et entretoises (référez-vous au manuel d'installation de votre potence pour être sûr d'avoir assez de surface de serrage). Dans ce cas vous devrez peut-être couper votre tube pivot 3mm plus court pour avoir suffisamment de surface de serrage et permettre au boulon du bouchon de potence de comprimer l'assemblage pour assurer un parfait ajustement.
 4. S'il est nécessaire de couper le tube pivot, **MESUREZ DEUX FOIS, COUPER UNE SEULE**. Il est recommandé d'utiliser un guide de coupe pour couper le tube pivot.
 5. Installez l'étoile de direction à l'aide d'un outil de montage d'étoile de direction pour la bonne profondeur.
 6. Installez la fourche DVO Diamond dans le tube de direction. Serrez le bouchon de direction jusqu'à ce qu'il n'y est plus de jeu dans la direction sans que celles-ci soit dure quand vous tournez.
- Dual Crown Fork : Install the steering bumpers onto the upper tubes. Use a torque wrench to tighten all top and lower crown pinch bolts to 7Nm.**
7. Installez le frein avant selon les instructions du constructeur. Assurez-vous de bien ajuster les plaquettes. Vérifiez que les câbles et durites sont suffisamment longs pour ne pas interférer avec l'amplitude de la direction ou le débattement de la fourche. **NOTE** : La taille du disque de frein doit être entre 160mm-203mm
 8. Passez la durite dans le guide. Assurez-vous que la durite passe à l'intérieur du fourreau inférieur. Utiliser une clé Allen 2mm et serrez à 3nm de couple pour sécuriser la durite dans le guide.

- ⊘ Toutes les fourches DVO Suspension sont livrées avec un tube pivot non fileté. **Ne pas essayer d'y ajouter un filetage!** Les fourches DVO Suspension ont un tube pivot conçu pour être pressé une seule fois et ne peut plus être démonté. N'essayez pas de remplacer le tube pivot avec un tube pivot fileté. Cela annulerait la garantie de votre fourche et résulterait à une défaillance du produit ou causerait des blessures graves ou la mort du cycliste.

Installation De La Roue

Please make sure you have the correct wheel size for your fork model.

15mm Quick Release Installation

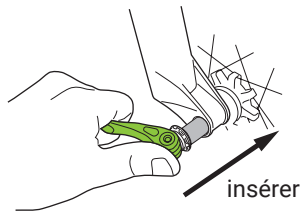

1. Vérifiez que le moyeu s'ajuste bien entre les pattes de fourche, puis insérez l'axe depuis le coté opposé du disque de frein. Couissez l'axe jusqu'au contact du filetage de l'écrou du coté disque.

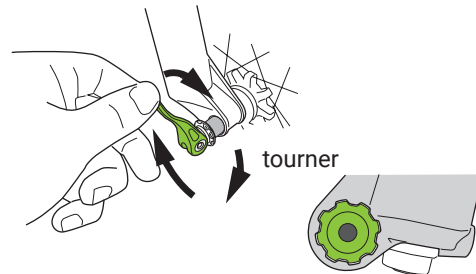

2. Tournez l'axe dans le sens des aiguilles d'une montre jusqu'à obtenir un petit espace entre le levier de serrage et la patte de fourche cote opposé du disque de frein. L'écrou de l'axe doit rentrer parfaitement dans son logement. Si ce n'est pas le cas desserrez l'axe, alignez l'écrou en le poussant légèrement dans son logement.

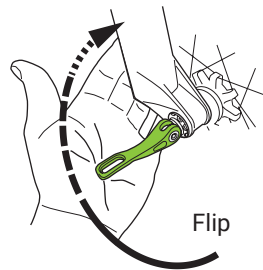

3. Pour sécuriser l'axe, commencez avec le levier en position ouverte. Quand vous basculez le levier vous devez sentir une résistance à mi-distance et le levier doit toucher la patte de fourche. Basculez le levier en position fermée à la force de la main seulement. Le levier doit sentir fermement sécurisé. NE PAS UTILISER D'OUTILS POUR FAIRE LEVIER.

4. Si trop ou pas assez de résistance, ajustez l'écrou d'axe du coté disque de frein. Desserrez l'axe de 3 tours et poussez l'axe pour dégager l'écrou de son logement et ajustez-le. Si l'axe a trop de tension, tournez l'écrou dans le sens opposé des aiguilles d'une montre. Si l'axe n'a pas assez de tension tournez l'écrou dans le sens des aiguilles d'une montre. Tournez l'axe dans le sens des aiguilles d'une montre de nouveau et sécurisez le levier en position fermée.

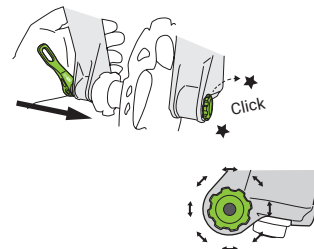

5. Enlevez le vélo du stand. En freinant du frein avant pousser le vélo d'avant en arrière pour vérifier que le jeu de direction est bien ajusté. IL NE DOIT PAS Y AVOIR DE JEU DANS LA DIRECTION.

15mm Tool Type Axle Installation

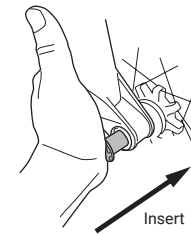

1. Insert the axle through the drive-side dropouts and hub.

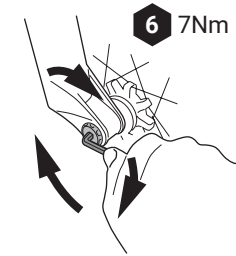

2. Use a 6 mm hex wrench to torque the axle to 7 Nm.

20mm Pinch Axle Installation

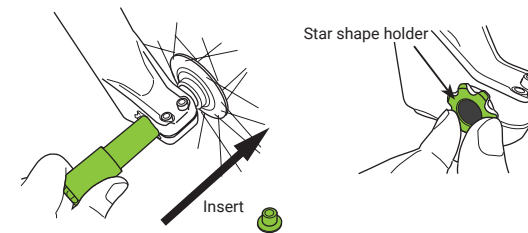

1. Install the front wheel into the dropouts and insert the axle and align the star shape holder, through the dropouts and hub.

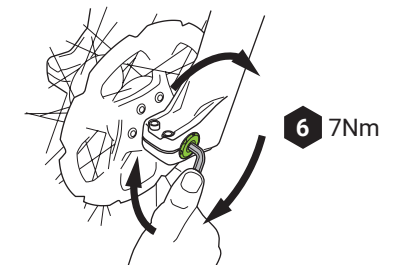

2. Use a 6 mm hex wrench to torque the axle nut to 7 Nm .

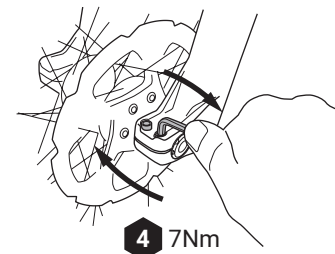

3. Use a 4 mm hex wrench to torque the two pinch bolts on the non-drive side dropouts to 7 Nm.

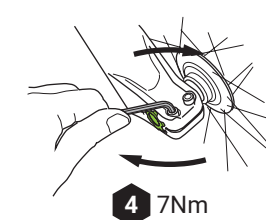

5. Use a 4 mm hex wrench to torque the two pinch bolts on the drive side dropouts to 7 Nm.

4. Compress the fork a couple of times to ensure that the lower leg has settled into its low-friction point.

Installation Du Garde-Boue

La DVO Diamond est livrée avec un garde boue intégré pouvant être utilisé dans des conditions boueuse ou sablonneuse.

For more details about tire clearance, please visit DVO TECH <http://tech.dvosuspension.com/setup>

Single Crown Fork

1. Utilisant une clé Allen 3mm (bout arrondi recommandé), doucement tournez les 2 boulons snap-in dans les deux trous du bas de l'arche et serrez les à 3Nm de couple. Une fois installés ces boulons n'ont pas besoin d'être enlevés. Attention de ne pas rayer les plongeurs pendant l'installation.

2. Alignez le garde-boue avec le deux boulons snap-in et pousser vers le bas jusqu'à ce que le garde-boue prenne place. ASSUREZ VOUS D'APPLIQUER LA PRESSION A L'APLOMB DES BOULONS NON SUR L'EXTREMITÉ DU GARDE-BOUE.

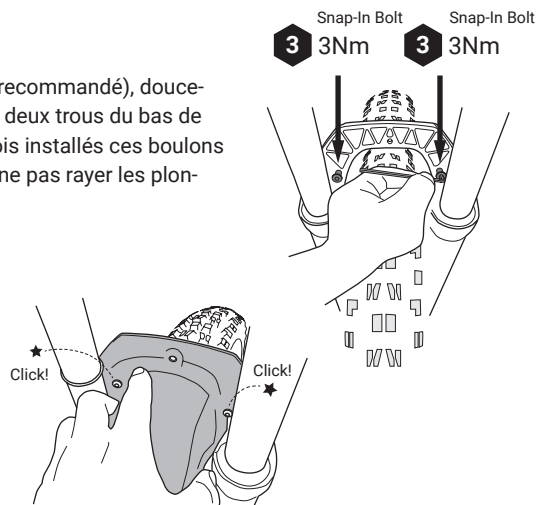

3. A l'aide d'une clé Allen 3mm, insérez le boulon d'assemblage dans le trou fileté situé au milieu de l'arche et serrez-le au couple de 3Nm. Il ne doit pas y avoir de jeu entre le garde-boue et l'arche.

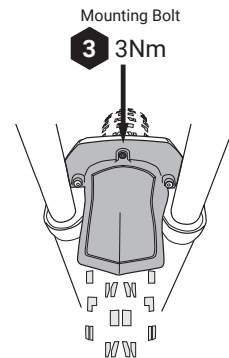

ENLEVER LE GARDE BOUE

Desserrez le boulon d'assemblage au centre de l'arche. Puis tirez le garde-boue vers le haut pour le dégager des boulons snap-in. NE PAS TIRER PAR L'EXTREMITÉ DU GARDE-BOUE. Les boulons snap-in resteront sur la fourche.

Dual Crown Fork

Using a 2.5mm allen key, insert the fender mount bolt, torque to 3Nm. There should be no play between the fender and the arch.

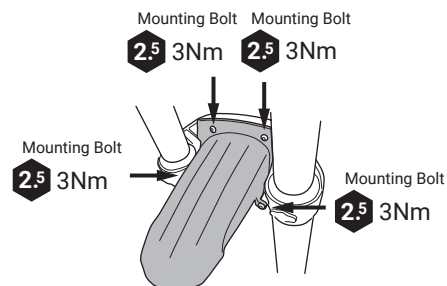

Passage Du Pneu

assurez-vous que vous avez la taille de la roue correspondante à votre modèle de fourche. Chaque pneu a un diamètre extérieur différent (largeur et hauteur du pneu). Par conséquent, l'espace entre le pneu et la fourche doit être vérifié pour s'assurer qu'il n'entre pas en contact avec une quelconque partie de la fourche.

⚠ ATTENTION!

Un dégagement du pneu d'une manière inadéquate entraînera un accident, des blessures ou la mort.

1. Evacuer l'air de votre fourche.
2. Comprimer complètement la fourche.
3. Mesurer la distance entre le dessus du pneu et le fond du Té Inférieur. Assurez-vous que cet écart n'est pas inférieur à 6 mm! En dépassant la taille maximale du pneu, ce dernier risque de se coincer contre le fond du té lorsque la fourche est complètement comprimée.

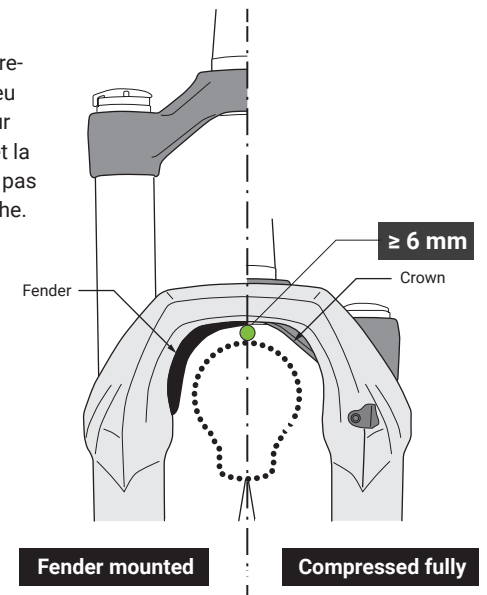

Service et maintenance

⚠ ATTENTION!

Ne pas maintenir votre fourche correctement causera un accident, des blessures graves ou mortelles

Nous recommandons que tous les entretiens de votre suspension DVO doivent être effectués par un mécanicien cycle qualifié. Les informations à propos de l'entretien sont disponibles sur : <http://tech.dvosuspension.com> ou en contactant votre DVO Suspension revendeur ou distributeur.

Le type de terrain, l'endroit où vous ridez et votre habileté peut grandement affecter l'intervalle entre les entretiens. Toujours inspecter votre produit et avancer votre entretien si nécessaire. Si vous avez le moindre doute, consultez un mécanicien cycle qualifié ou contactez directement DVO Suspension.

Minimum Recommended Service Items	Intervalle
Vérifier la pression atmosphérique	Avant chaque course
Inspecter le tube à rayures pour les rayures	Avant chaque course
Tuyaux de bardage propres	Après chaque course
Vérifier les paramètres de couple	25 Heures
Retirer les abaisssements, nettoyer / inspecter la douille et changer l'huile	50 Heures
Ensemble de ressort à air de service	100 Heures
Cartouche d'amortisseur de service	100 Heures

Spécifications maximales de couple recommandées

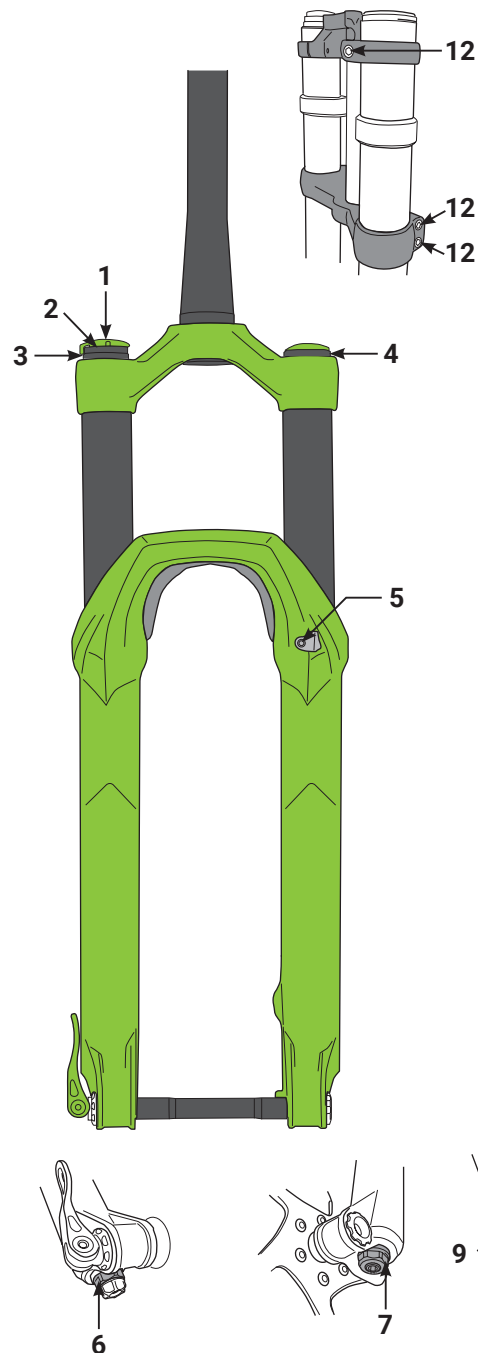

	Part	
1	Vis à bouton de compression	3 Nm 26.5 in.lbf
2	Chargeur à compression	9 Nm 80 in.lbf
3	Cartouche d'amortisseur	15 Nm 132 in.lbf
4	Cartouche d'air enfichable	15 Nm 132 in.lbf
5	Boulon de guidage de câble	3 Nm 26.5 in.lbf
6	Reboud foot nut	10 Nm 88 in.lbf
7	Nut de pied OTT	10 Nm 88 in.lbf
8	Fender mount boulon	3 Nm 26.5 in.lbf
9	Boulons à encliquetage Fender	7 Nm 62 in.lbf
10	Type d'outil 15 mm essieu	7 Nm 62 in.lbf
11	Axe de type outil de 20 mm	7 Nm 62 in.lbf
12	Boulon de pincement	7 Nm 62 in.lbf

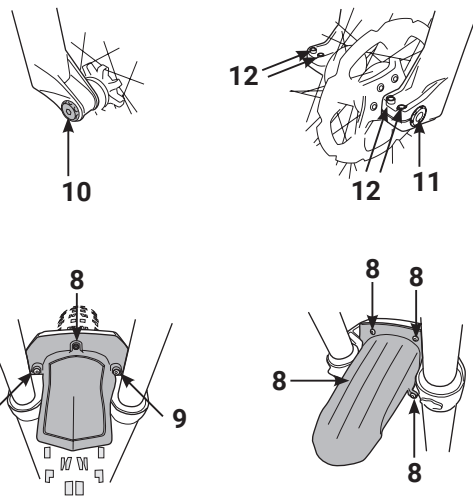

DEUX (2) ANS DE GARANTIE LIMITEE

Si un composant de votre produit Suspension DVO est défectueux matériel ou fabrication), selon les termes de cette garantie limitée de deux ans (le "Contrat"), le composant défectueux sera réparé ou remplacé, par Suspension DVO sans aucune charge, dans les trente (30) jours après réception du produit par un revendeur agréé de suspension DVO, port payé, avec la facture originale d'achat ou toute autre preuve de la date d'achat.

PAS COUVERT: Cette garantie ne couvre pas les dommages résultant d'accidents, de modification, de négligence, d'abus ou de mauvaise utilisation, un manque d'entretien approprié, un montage incorrect, des réparations mal effectuées ou des pièces de rechange ou d'accessoires non conformes aux spécifications Suspension DVO, des modifications non recommandées ou approuvées par écrit de la part des activités suspension DVO telles que l'acrobatie, le saut de falaise, la rampe, la course, l'utilisation commerciale et / ou de l'usure normale ou la détérioration occasionnée par l'utilisation du produit. Les articles soumis à une usure normale ou à la détérioration comprennent, mais ne sont pas limités à l'huile, les joints d'étanchéité, les joints d'huile et les bagues. En outre, cette garantie ne s'applique pas dans le cas où les fourches sont utilisées sur des vélos de location, sauf si Suspension DVO a donné son approbation préalable par écrit pour cette utilisation. Cette garantie ne couvre pas les frais liés au transport du produit de Suspension DVO ou auprès d'un revendeur Suspension DVO autorisé, les coûts de main-d'oeuvre pour retirer le produit de Suspension DVO du vélo, ou une compensation pour les inconvénients ou une perte d'usage tandis que le produit Suspension DVO est réparé. Cette garantie sera automatiquement annulée si le numéro de série du produit Suspension DVO est altéré, effacé, rendu illisible ou modifié.

ACHETEUR: Cette garantie est faite par Suspension DVO uniquement pour l'acheteur du produit de suspension DVO et ne s'étend pas à des tiers. Les droits de l'acheteur sous cette garantie ne peuvent être cédés.

ACCORD: La durée de cette garantie débute à la date d'achat et se poursuivra pendant une période de deux (2) ans à compter de la date de l'achat initial.

PROCEDURE: En cas de défaut couvert par cette garantie, l'acheteur doit communiquer avec un revendeur autorisé de Suspension DVO ou un centre de services de Suspension DVO.

ACCORD INTEGRAL: Cette garantie remplace toute garantie implicite ou explicite, des déclarations ou des engagements

qui, auparavant, auraient été faits, et contient l'intégralité de l'accord entre les parties en ce qui concerne la garantie de ce produit Suspension DVO. Toutes les garanties qui ne figurent pas dans la présente garantie sont expressément exclues.

DEGATS: Sauf dans les cas expressément prévus par la présente garantie, Suspension DVO NE SERA PAS RESPONSABLE DES DOMMAGES DIRECTS OU INDIRECTS DE L'UTILISATION DE LA SUSPENSION DVO OU UNE DEMANDE EN VERTU DE CETTE ENTENTE, SI LA RECLAMATION REPOSE SUR UN CONTRAT, UN PREJUDICE OU AUTRE. Les déclarations de garantie ci-mentionnées sont exclusives et annulent et remplacent tous les autres recours. Certains états n'autorisent pas l'exclusion ou la limitation des dommages indirects ou consécutifs, la limitation ou l'exclusion peut ne pas s'appliquer pour vous.

AVERTISSEMENT: TOUTE GARANTIE IMPLICITE DE QUALITÉ MARCHANDE OU D'ADEQUATION A UN USAGE PARTICULIER ET TOUTE GARANTIE IMPLICITE PROVENANT DE LA CONDUITE DES AFFAIRES, DE L'USAGE DU COMMERCE, DE LA LOI OU AUTRE, EST STRICTEMENT LIMITÉE À LA DURÉE DE CETTE GARANTIE ÉCRITE. Le présent Accord est le seul et unique recours exclusif de l'acheteur à l'égard de cet achat. En cas de violation présumée de toute garantie ou toute action en justice intentée par l'acheteur sur la base d'une négligence présumée ou autre comportement délictueux par Suspension DVO, le seul et unique recours de l'acheteur sera la réparation ou le remplacement du matériel défectueux comme indiqué ci-dessus. Aucun revendeur ou agent ou employé de Suspension DVO n'est autorisé à modifier ou étendre la présente garantie.

AVERTISSEMENT: Installer, réparer et utiliser le produit de Suspension DVO en se conformant uniquement au manuel du propriétaire.

AUTRES DROITS: Cette garantie vous donne des droits légaux spécifiques, et vous avez également d'autres droits qui varient d'un État à l'autre (uniquement aux USA).

LOI APPLICABLE: Tout litige découlant du présent contrat ou de l'utilisation de ce produit Suspension DVO sera régi par les lois du pays des Etats-Unis et sera réglé par les tribunaux de la Californie.

Herzlichen Glückwunsch!

Vielen Dank, dass Sie sich für ein DVO Suspension Produkt entschieden haben. DVO Suspension Produkte wurden von Fahrern für Fahrer entworfen. Es ist für Ihre Sicherheit sehr wichtig, dass Sie den folgenden Richtlinien, Anweisungen und Setup Informationen folgen, welche in dieser Bedienungsanleitung oder auf unseren Internet-Plattformen zu finden sind.

DVO TECH

Besuchen Sie <http://tech.dvosuspension.com> für Installations- und Service- Anleitungen, sowie Tuning Informationen. DVO Tech beinhaltet detaillierte Informationen zum Thema Fahrwerkseinstellung und Tuning, um Ihnen die Funktionsweise der Federelemente nahezubringen und Auswirkungen jeder Einstellung an Ihrem Fahrrad zu erläutern. Detaillierte Schritt-für-Schritt Anweisungen und Videos sind ebenfalls verfügbar, um Ihnen einfache Service-Aufgaben wie zum Beispiel einen Öl- bzw. Dichtungswechsel, bis hin zu schwierigen Tätigkeiten wie einen Dämpferservice, nahe zu bringen. DVO Tech besitzt ebenfalls ein Forum, in welchem Sie mit einem DVO Techniker kommunizieren können und eine Datenbank mit Problemlösungen finden.

⚠️ WARNUNG

Wenn Sie diese Warnungen und Anweisungen nicht befolgen, kann es zu **SCHÄDEN AN IHREM PRODUKT, ERNSTEN VERLETZUNGEN** oder zum **TOD** führen.

Lesen Sie vor der ersten Verwendung Ihrer Feder- gabel unbedingt dieses Handbuch sorgfältig durch. Überall in diesem Handbuch wird der Verweis gemacht, dass es zu einem „Unfall“ kommen könnte. Jeder Unfall kann dem Produkt Schaden zuführen, zu **ERNSTEN VERLETZUNGEN** oder sogar dem **TOD** führen.

Diese Anweisungen enthalten wichtige Informa- tion über den richtigen Einbau, Richtlinien für die Einstellung, sowie Wartung und Instandhaltung Ihrer Federgabel. Beachten Sie bitte dennoch, dass spezielle Kenntnisse und Werkzeuge notwendig sind, um ihre DVO Federgabel einzubauen und instand zu halten. Allgemeine mechanische Kenntnisse können für Reparaturen, Serviceaufgaben oder die Instand- haltung ihrer DVO Federgabel nicht ausreichend sein. Deshalb empfehlen wir ausdrücklich, ihre DVO Federgabel von einem erfahrenen und qualifizierten Zweirad Mechaniker einbauen, instand halten oder warten zu lassen. Eine unpassende Instandhaltung, Wartung oder Service kann einen Unfall zur Folge haben.

Federgabeln und Dämpfer enthalten Flüssigkeiten und Luft, welche unter extremem Druck stehen. Versuchen Sie **NICHT**, irgendwelche Teile eines DVO Suspension Produktes auseinander zu nehmen, wenn Sie nicht von einem autorisierten DVO Techni- ker dazu aufgefordert wurden.

Verwenden Sie nur originale DVO Ersatzteile. Mod- ifikationen, unsachgemäßer Service, oder der Geb-

rauch von Aftermarket Austausch.- beziehungsweise Ersatzteilen kann zu Unfällen führen und die Garantie Ihrer Federgabel für **NICHTIG** erklären.

DVO Federgabeln und Dämpfer sind nur für die Ver- wendung an einem Fahrrad vorgesehen. Verwenden Sie DVO Suspension Produkte an **KEINEM** motoris- ierten Rad oder motorisierten Fahrzeug.

Seien Sie immer mit der richtigen Sicherheitsaus- rüstung ausgestattet. Dies schließt einen richtig sit- zenden und befestigten Helm mit ein. Gemäß Ihrem Fahrstil sollten Sie zusätzlichen Sicherheitsschutz verwenden. Stellen Sie sicher, dass Ihre Ausrüstung zu jeder Zeit im fehlerfreiem Zustand ist.

Stellen Sie sicher, dass Sie die richtige Gabel gemäß der Spezifikationen Ihres Rahmenherstellers ausgewählt haben. Der Einbau einer Gabel, die der Geometrie Ihres Rahmens nicht entspricht könnte zu einem versagen der Federgabel und zur Nichtigkeit der Garantie dieser führen. Der Einbau einer nicht geeigneten Federgabel hat eine Änderung der Geometrie und Fahreigenschaften Ihres Fahrrades zur Folge. Lernen Sie mit Ihrer neuen Federgabel zu fahren und erweitern Sie ihre Fähigkeiten. Beachten Sie hierbei jedoch Ihre Grenzen und überschreiten Sie diese nicht.

Studieren Sie alle anderen Handbücher, die mit Ihrem Fahrrad geliefert worden sind und machen Sie sich mit allen an Ihrem Fahrrad ver- bauten Komponenten vertraut.

For detailed instructions and videos, visit dvosuspension.com

Gabel Einbau

⚠️ WARNUNG

DVO Suspension empfiehlt stark, dass Ihre Gabel von einem erfahrenen und qualifizierten Zweirad Mechaniker eingebaut wird. Spezielle Kenntnisse und Werkzeuge sind notwendig, um DVO Federgabeln richtig einzubauen. Allgemeine mechanische Kenntnisse sind nicht ausreichend, um eine DVO Federgabel einzubauen. Wenn Sie beabsichtigen, den Einbau der Gabel selbst durchzuführen, muss die ganze Arbeit von einem erfahrenen und qualifizierten Zweirad Mechaniker geprüft werden. Bitte beachten Sie, dass unpassend eingebaute Gabeln äußerst gefährlich sind und der Gabel Schaden sowie zu ernststen Verletzungen oder sogar dem Tod des Nutzers führen kann.

1. Wenn Sie die Gabel an einem existierenden Fahrrad wechseln, entfernen sie zunächst das Vorder- rad und die Bremse, anschließend entfernen Sie den Gabelkonus von der alten Gabel.
2. Verwenden Sie einen Gabelkonus-Aufschläger, um den Gabelkonus auf den neuen Gabelschaft zu montieren. Stellen Sie sicher, dass kein Spalt zwischen Gabelkonus und Gabelkrone vorzufinden ist. (Beachten Sie außerdem die Montagehinweise des Steuersatz Herstellers)
3. Messen Sie die Länge des Gabelschaftes der alten Gabel und übertragen Sie diese auf den Gabelschaft Ihrer neuen DVO Diamond Federgabel. Wenn Sie keine alte Gabel zum messen des Gabelschaftes besitzen müssen Sie die Gabel inklusive Steuersatz, Spacer und Vorbau im Rahmen montieren. (beachten Sie die Anleitung des Vorbau-Herstellers, damit dieser genügend Klemmfläche am Gabelschaft hat). Im Anschluss müssen Sie eventuell den Gabelschaft etwas kürzen (3mm), um genug Klemmraum zu erhalten, damit sich der Gabelschaft beim anziehen der Steuersatzkappe im Steuersatz fixiert.
4. In dem Fall, dass der Gabelschaft gekürzt werden muss: **MESSEN SIE LIEBER ZWEIMAL**, bevor Sie den Gabelschaft endgültig kürzen. Es wird Ihnen empfohlen dabei eine Sägehilfe zu verwenden, damit der Gabelschaft sauber und gerade gekürzt wird.
5. Montieren Sie die Steuersatzkralle im neuen Gabelschaft mit Hilfe eines Werkzeuges zum ein- schlagen der Steuersatzkralle mit definierter Einschlagtiefe.
6. Bauen Sie nun Ihre neue DVO Diamond Gabel in den Rahmen ein. Ziehen Sie die Steuersatz- schraube so fest, dass beim Bewegen des Gabelschaftes kein Spiel mehr im Steuersatz festzustellen ist.
7. Richten Sie im Anschluss den Lenker und Vorbau aus. Fixieren Sie die Schrauben mit den vom Hersteller vorgeschriebenen Drehmomenten.
8. Montieren Sie die Vorderradbremse gemäß der Anleitung des Herstellers. Stellen Sie sicher, dass die Bremsbeläge richtig ausgerichtet sind. Stellen Sie außerdem sicher, dass die Bremsleitung die ideale Länge vorweist und das lenken sowie die Funktion der Gabel nicht einschränkt.
Bemerkung: Der Brems Scheibendurchmesser muss zwischen 160mm-203mm betragen.
9. Befestigen Sie die vordere Bremsleitung an der Kabelführung. Stellen Sie sicher, dass die Bremslei- tung an der Innenseite der Gabel entlang führt. Benutzen Sie anschließend ein 2mm Inbus Schlüssel um die Bremsleitung an der Kabelführung mit einem Drehmoment von 3Nm zu fixieren.

- ⊘ Alle DVO Federgabeln kommen mit einem gewindelosen Gabelschaft. Fügen Sie kein Gewinde hinzu! Der Gabelschaft wurde speziell eingepresst und kann daher nicht entfernt werden. Versuchen Sie nicht, den Gabelschaft durch einen Gewindegabelschaft zu ersetzen. Dies würde zur Nichtigkeit der Garantie Ihrer Gabel und zu einem Defekt des Produktes führen. Außerdem kann dies zu ernste Verletzungen oder sogar dem Tod des Nutzers führen.

Lauftrad Montage

Please make sure you have the correct wheel size for your fork model.

15mm Quick Release Installation

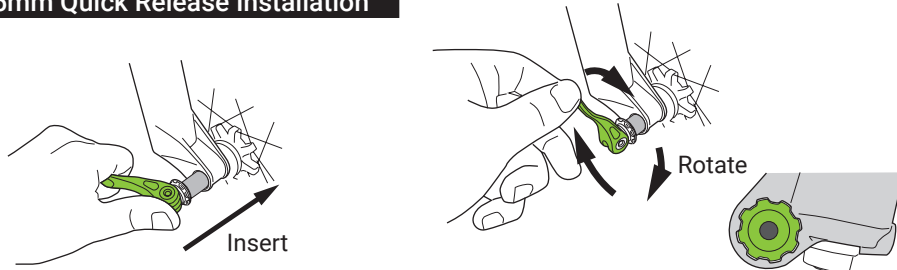

1. Stellen Sie sicher, dass die Nabe in die Ausfallenden passt und führen Sie im Anschluss die Steckachse von der Bremsen abgewendeten Seite in die Gabel. Führen Sie die Achse soweit ein, bis diese mit dem Gewinde auf der Scheibenbremsseite in Kontakt kommt.

2. Drehen Sie den Schnellspanner im Uhrzeigersinn bis nur noch ein kleiner Spalt zwischen der Schnellspannschraube und dem Ausfallende auf der Schnellspanner Seite zu sehen ist. Die Achsschraube sollte sauber in den Nuten der Ausfallenden sitzen. Falls diese nicht sauber sitzt, entspannen Sie die Achse ein wenig um diese leicht zu korrigieren. Die Achsschraube wird sich nun beim erneuten Festziehen von selbst fixieren.

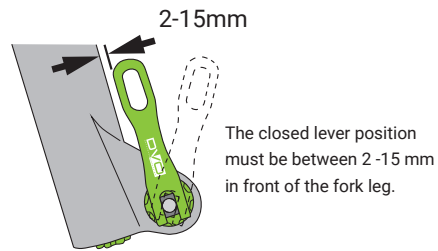
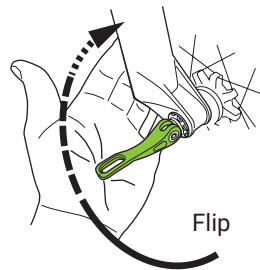

3. Um die Steckachse zu sichern, positionieren Sie den Schnellspanner in die geöffnete Position. Wenn Sie nun den Schnellspanner zur Hälfte schließen, sollten Sie einen Widerstand spüren. Außerdem muss dabei die Schnellspannschraube das Ausfallende berühren. Bewegen Sie den Schnellspanner in die geschlossene Position nur mit Ihrer Muskelkraft, sodass er sich Sicher anfühlt. NUTZEN SIE KEIN WERKZEUG ZUM SPANNEN!

4. Stellen Sie die Achsschraube auf der Bremsenseite ein wenn der Widerstand zu hoch oder zu gering ist. Drehen Sie die Achse 3 volle Umdrehungen und drücken Sie diese zur Antriebsseite. Dies wird die Achsmutter herausdrücken um eine Verstellung zu ermöglichen. Hat die Achse zu viel Spannung, müssen Sie die Achsmutter gegen den Uhrzeigersinn drehen. Hat diese zu wenig Spannung müssen Sie die Achsmutter im Uhrzeigersinn drehen. Drehen Sie im Anschluss den Schnellspanner wieder im Uhrzeigersinn und schließen ihn. Wiederholen sie diesen Vorgang bis die richtige Spannung eingestellt ist.

5. Nehmen Sie ihr Rad in die Hand und bewegen es leicht bei gezogener Vorderradbremse vor und zurück um sicher zu stellen, dass bei gegebener Vorspannung und Drehmoment kein Spiel festzustellen ist. ES DARF KEIN SPIEL IM STEUERSATZ VORHANDEN SEIN.

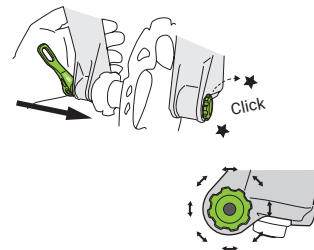

⚠️ WARNUNG
Do not rotate the axle lever while it is in the closed position. This can cause the axle to loosen up and result in an accident, personal injury or death.

15mm Tool Type Axle Installation

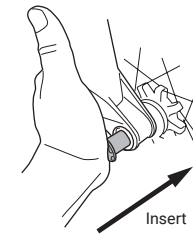

1. Insert the axle through the drive-side dropouts and hub.

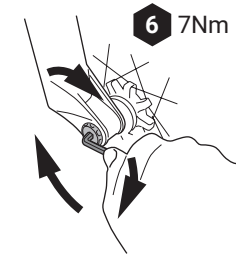

2. Use a 6 mm hex wrench to torque the axle to 7 Nm.

20mm Pinch Axle Installation

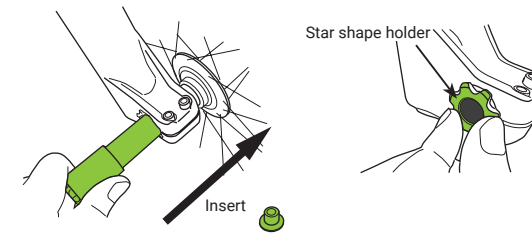

1. Install the front wheel into the dropouts and insert the axle and align the star shape holder, through the dropouts and hub.

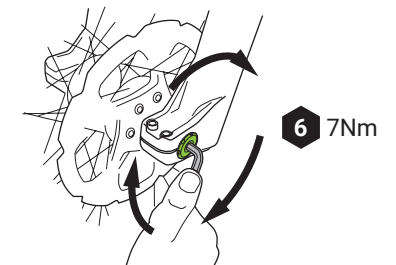

2. Use a 6 mm hex wrench to torque the axle nut to 7 Nm.

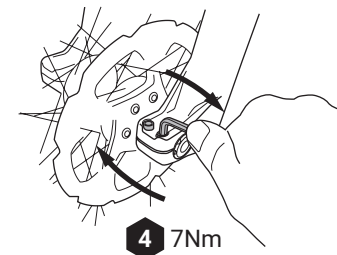

3. Use a 4 mm hex wrench to torque the two pinch bolts on the non-drive side dropouts to 7 Nm.

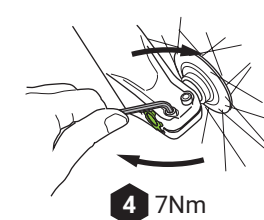

5. Use a 4 mm hex wrench to torque the two pinch bolts on the drive side dropouts to 7 Nm.

4. Compress the fork a couple of times to ensure that the lower leg has settled into its low-friction point.

Fender Montage

Die DVO produkt kommt mit einem integrierten Fender, der bei schlammigen oder sandigen Bedingungen eingesetzt werden kann.

Single Crown Fork

1. Verwenden Sie einen 3mm Inbus-Schlüssel (ein Kugelkopf wird empfohlen). Montieren Sie vorsichtig die Snap-In Schrauben in die 2 unteren Gewindebohrungen auf der Rückseite des Bogens mit einem Drehmoment von 3Nm. Wenn diese Schrauben einmal montiert sind müssen sie nicht mehr entfernt werden. Seien Sie während der Montage vorsichtig, um die Standrohre nicht zu beschädigen.

2. Richten Sie den Fender an den Snap-In Schrauben aus und drücken Sie ihn nach unten bis er gesichert ist. Der Fender "springt" von alleine an seinen Platz. **ACHTEN SIE DARAUF, DENDRUCK NUR ÜBER DEN SCHRAUBEN AUFZUBRINGEN UND NICHT AM ENDE DES FENDERS.**

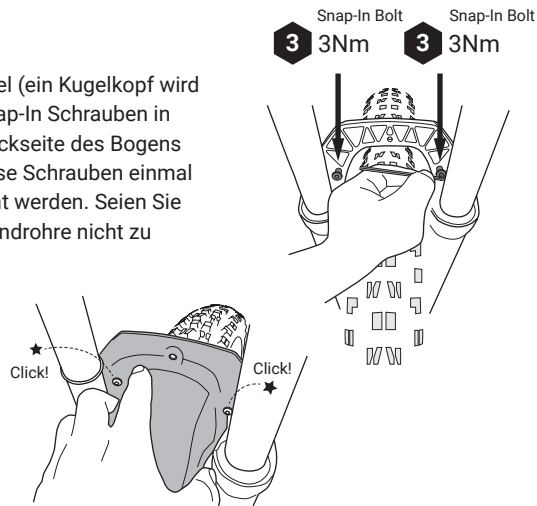

3. Verwenden Sie einen 3mm Inbus-Schlüssel und montieren Sie die Fender Befestigungsschraube in der mittig sitzenden Gewindebohrung auf der Rückseite des Bogens mit einem Drehmoment von 3Nm. Es darf kein Spiel zwischen Fender und Gabelbogen vorhanden sein.

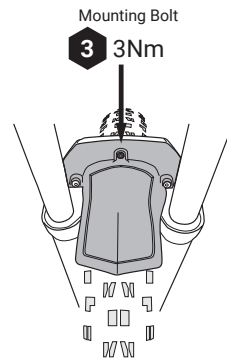

Fender Removal

Entfernen Sie die Befestigungsschraube als erstes. Heben Sie im Anschluss den Fender nach oben, um ihn von den Snap-In Schrauben zu lösen. **HEBEN SIE IHN NICHT** am äußeren Ende hoch. Die Snap-In Schrauben bleiben im Gabelbogen verschraubt.

Dual Crown Fork

Using a 2.5mm allen key, insert the fender mount bolt, torque to 3Nm. There should be no play between the fender and the arch.

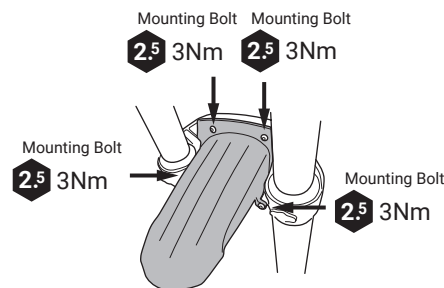

Reifenfreiheit

Der Abstand zwischen Reifen und Gabel muss überprüft werden, um sicherzustellen, dass er nicht mit irgendeinem Teil der Gabel in Berührung kommt. Es sollte mindestens 6mm Abstand zwischen der Oberseite des Reifens und der Unterseite des Bogens und des Kotflügels (falls angebracht) vorhanden sein.

⚠️ WARNUNG

Mangelhafte Reifenfreiheit wird zu einem Unfall, persönlicher Verletzung oder dem Tod führen.

Reifenfreiheit Test

1. Lassen Sie die ganze Luft von Ihrer Gabel ab.
 2. Pressen Sie Ihre Gabel völlig zusammen.
 3. Messen Sie die Entfernung zwischen der Spitze des Reifens und dem Ende des Trägers. Stellen Sie sicher, dass diese Lücke NICHT weniger als 6 mm ist!
- Außerordentliche maximale Reifengröße wird den Reifen veranlassen, gegen das Ende des Trägers zu verklemmen, wenn die Gabel völlig zusammengepresst wird.

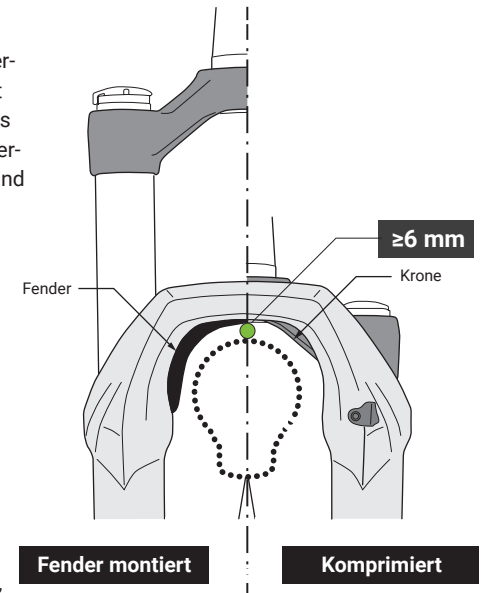

Dienst & Unterstützen

⚠️ WARNUNG

MANGELHAFTER WARTUNG KANN ZU EINEM UNFALL, VERLETZUNGEN ODER ZUM TOD FÜHREN.

Wir empfehlen, dass der gesamte DVO Federgabelservice von einem qualifizierten Zweirad Mechaniker durchgeführt werden sollte. Serviceinformationen und Anleitungen finden Sie auf <http://tech.dvosuspension.com> oder durch das kontaktieren Ihres lokalen DVO Suspension Händlers bzw. Vertrieb. Terrain, Strecken und der Fahrstil können einen großen Einfluss auf das Intervall haben, in dem eine Wartung durchgeführt werden sollte. Kontrollieren Sie immer Ihre Produkte und neigen zu einer Wartung wenn dies in Frage kommt. Wenn Sie Zweifel haben, kontaktieren Sie einen qualifizierten Zweirad Mechaniker oder DVO Suspension direkt.

Mindestens empfohlene Serviceartikel	Intervall
Luftdruck prüfen	Vor jeder Fahrt
Inspektion des Rührrohres für Kratzer	Vor jeder Fahrt
Saubere Rungenrohre	Nach jeder Fahrt
Drehmomenteinstellungen prüfen	25 Stunden
Absenken entfernen, die Buchse reinigen / prüfen und Öl wechseln	50 Stunden
Betriebsluftfederanordnung	100 Stunden
Service Dämpferpatrone	100 Stunden

Recommended Max Torque Specifications

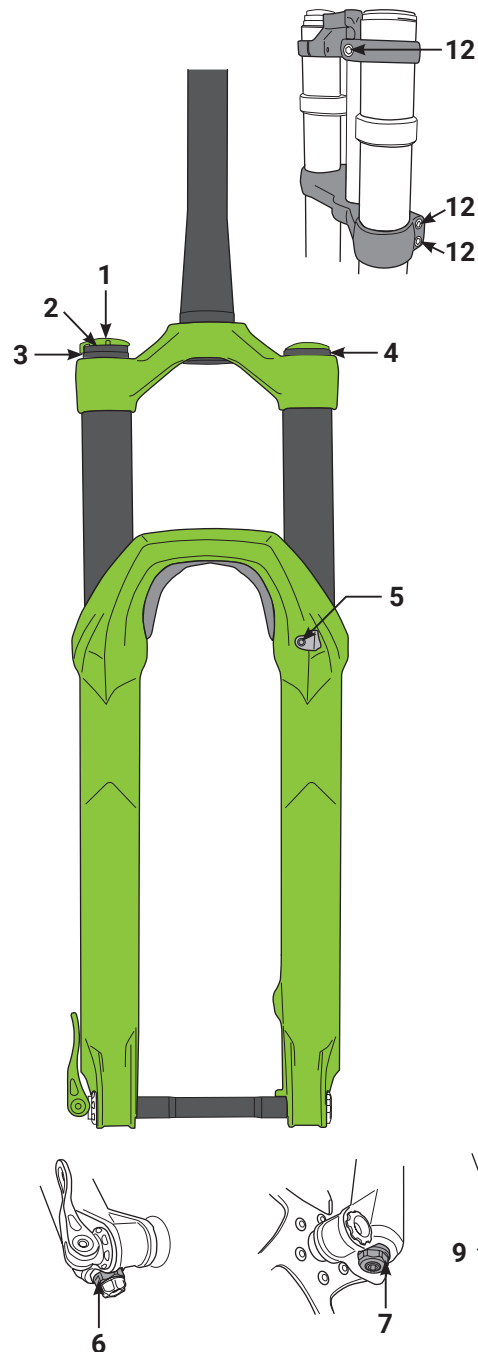

	Teil	Sollwert
1	Druckknopfschraube	3 Nm 26.5 in.lbf
2	Kompressionslader	9 Nm 80 in.lbf
3	Top Stecker Dämpfer Patrone	15 Nm 132 in.lbf
4	Top Stecker Luftpatrone	15 Nm 132 in.lbf
5	Kabelführungsschraube	3 Nm 26.5 in.lbf
6	Zuggstufen Schraube	10 Nm 88 in.lbf
7	OTT Schraube	10 Nm 88 in.lbf
8	Fender Mount Schrauben	3 Nm 26.5 in.lbf
9	Fender Snap-in Schrauben	7 Nm 62 in.lbf
10	15 mm Achsschraube	7 Nm 62 in.lbf
11	20 mm Achsschraube	7 Nm 62 in.lbf
12	Klemmschraube	7 Nm 62 in.lbf

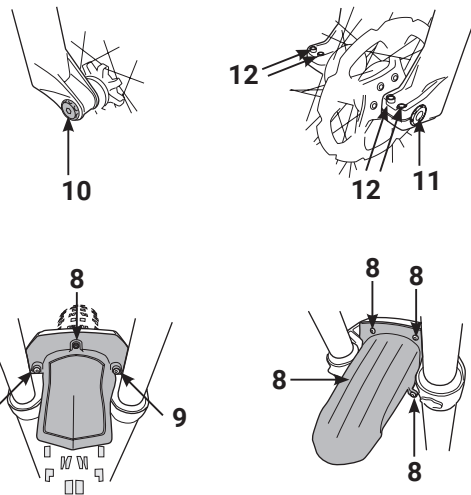

BESCHRÄNKTE ZWEI (2) JAHRE GARANTIE

Wenn irgendwelcher Bestandteil Ihres DVO Federgabelproduktes in Materialien oder fachmännischer Arbeit innerhalb der Dauer dieser beschränkten zweijährigen Garantie fehlerhaft (die "Abmachung") gefunden wird, wird der fehlerhafte Bestandteil repariert, oder in der Option der DVO Federgabel kostenlos, innerhalb von dreißig (30) Tagen nach der Einnahme des Federgabelproduktes von einem autorisierten DVO Federgabellieferanten, Fracht vorausbezahlt, zusammen mit der ursprünglichen Einzelrechnung oder den anderen Beweisen des Einkaufsdatums ersetzt.

NICHT BEDECKT: Diese Garantie bedeckt Schaden nicht, der sich aus Unfällen, Modifizierung, Vernachlässigung, Missbrauch oder unpassendem Gebrauch ergibt, Mangel an der angemessenen oder richtigen Wartung, dem unpassenden Zusammenbau, Reparaturen unpassend durchgeführten oder Ersatzteilen oder Zusätzen, die sich nicht den Spezifizierungen der DVO Federgabel, Modifizierungen nicht empfohlen oder genehmigt schriftlich durch DVO Federgabeltätigkeiten wie Akrobatik, Stunt-Springen, Rampe fahren, Rennen, der kommerzielle Gebrauch und / oder normales Tragen oder durch den Gebrauch des Produktes verursachter Verfall anpassen. Die Eigentumsvorbehaltware schließt dem normalen Tragen oder Verfall ein, aber wird auf Öl, Klappenantrieb, Öldichtung und Buchsen nicht beschränkt. Außerdem ist diese Garantie nichtig, falls die Gabeln mit irgendwelchen Mieträdern verwendet werden, wenn DVO Federgabel vorherige Billigung schriftlich für solchen Gebrauch nicht zur Verfügung gestellt hat. Diese Garantie schließt auch keine Ausgaben ein, die mit dem Transport des DVO Federgabelproduktes zu oder von einem autorisierten DVO Federgabellieferanten, Arbeitskosten verbunden sind, um das DVO Federgabelprodukt vom Rad, oder die Entschädigung für die Unannehmlichkeit oder den Nutzungsschaden zu entfernen, während das DVO Federgabelprodukt repariert wird. Diese Garantie wird automatisch nichtig sein, wenn die Seriennummer des DVO Federgabelproduktes verändert, gelöscht, verunstaltet wird oder wenn Sie sonst irgendwelchem Herumbasteln vornehmen.

KÄUFER: Diese Garantie wird durch die DVO Federgabel mit nur dem ursprünglichen Käufer des DVO Federgabelproduktes gemacht und streckt sich bis zu keine Dritten aus. Die Rechte auf den ursprünglichen Käufer laut dieser Garantie dürfen nicht zugeteilt werden.

FRIST: Die Dauer dieser Garantie soll mit dem Einkaufsdatum anfangen und soll auf die Dauer von zwei (2) Jahren von dem ursprünglichen Kauf weitergehen.

VERFAHREN: Im Ereignis eines durch diese Garantie bedeckten Defekts sollte sich der Käufer mit einem autorisierten DVO Federgabellieferanten oder einem DVO Federgabellieferantenzentrum in Verbindung setzen.

KOMPLETTE ABMACHTUNG: Diese Garantie ersetzt irgendwelchen und alle mündlichen oder ausdrücklichen Garantien, Erklärungen oder Aussagen, das vorher gemacht worden sind, und enthält die komplette Abmachung zwischen den Parteien in Bezug auf die Garantie dieses DVO Federgabelproduktes. Irgendwelche und alle in dieser Garantie nicht enthaltenen Garantien werden spezifisch ausgeschlossen.

SCHÄDEN: Außer, wie ausdrücklich zur Verfügung gestellt, durch diese Garantie soll DVO Federgabel FÜR KEINE BEILÄUFIGEN ODER FOLGESCHÄDEN VERANTWORTLICH SEIN, die MIT DEM GEBRAUCH DES DVO FEDERGABELPRODUKTES ODER EINES ANSPRUCHS LAUT DIESER ABMACHTUNG vereinigt sind, EGAL OB DER ANSPRUCH AUF DEM VERTRAG, DEM KLAGBAREN DELIKT ODER SONSTEN BASIERT. Die vorhergehenden Behauptungen der Garantie sind ersetzen alle anderen Rechtsmittel. Einige Staaten erlauben den Ausschluss oder die Beschränkung von beiläufigen oder Folgeschäden nicht, so können diese Beschränkung oder Ausschluss nicht für Sie gelten.

VERZICHTERKLÄRUNG: JEDE IMPLIZIERTE GARANTIE DER MARKTFÄHIGKEIT ODER EIGNUNG ZU EINEM BESONDEREN ZWECK UND ALLE IMPLIZIERTEN GARANTIEN, die AUS VERHANDELN, HANDELSBRAUCH DURCH DAS STATUT ODER SONSTIGES ENTSTEHEN, WERDEN HIERMIT AUF DIE DAUER DIESER SCHRIFTLICHEN GARANTIE AUSSCHLIESSLICH BESCHRÄNKT. Diese Abmachung soll das alleinige und exklusive Rechtsmittel sein, das für den Käufer in Bezug auf diesen Kauf verfügbar ist. Im Falle jeder angeblichen Garantieverletzung oder jedes gerichtlichen Vorgehens, das vom Käufer gebracht ist, der auf der angeblichen Nachlässigkeit oder anderen unerlaubten Handlung mit der DVO Federgabel gestützt ist, wird das alleinige und exklusive Rechtsmittel des Käufers Reparatur oder Ersatz von fehlerhaften Materialien, wie oben angegeben, sein. Kein Lieferant und kein anderer Agent oder Angestellter der DVO Federgabel werden bevollmächtigt, diese Garantie zu modifizieren, zu erweitern oder zu vergrößern.

WARNUNG: Installieren Sie immer, reparieren Sie und verwenden Sie Ihr DVO Federgabelprodukt streng gemäß Handbuches des Eigentümers.

ANDERE RECHTE: Diese Garantie gibt Ihnen die spezifischen gesetzlichen Rechte, und Sie haben auch andere Rechte, die sich vom Staat bis Staat (die USA nur) ändern.

ANWENDBARES GESETZ: Irgendwelche Streitigkeiten, die aus dieser Abmachung oder dem Gebrauch dieses DVO Federgabelproduktes entstehen, werden durch die Gesetze des Staates der USA geregelt und werden von den Gerichten Kaliforniens entschieden.

Congratulations!

Thank you for purchasing DVO Suspension for your mountain bike. DVO Suspension products are designed by riders for riders. It is very important for your safety that you follow the guidelines, instructions and set-up information provided in this owner's manual or on our website.

DVO TECH

Go to <http://tech.dvosuspension.com> for setup, service guides and tuning information. DVO Tech has detailed information and articles on suspension setup and tuning to help you understand how suspension works and how each adjustment affects the performance of your fork and shock. Detailed step by step instructions and videos are available to show you how to properly perform service jobs such as changing seals and oil to more advanced tasks like damper services. DVO Tech also has a forum where you can communicate with DVO technicians and search a database of questions and answers.

WARNING

Failure to comply with these warnings and instructions may cause
SERIOUS INJURY, DEATH, or DAMAGE TO YOUR PRODUCT.

Be sure to read this manual carefully before using your DVO suspension. Throughout this manual, reference is made that "an accident" could occur. Any accident may cause damage to the product, **SERIOUS INJURY, OR DEATH.**

These instructions contain important information about the correct installation, guidelines for set-up, service and maintenance of your suspension. Nevertheless, please be informed that special knowledge and tools are essential to install, service and to maintain DVO Suspension. Common mechanical knowledge may not be sufficient to repair, service or maintain your suspension. Therefore we strongly recommend getting your suspension installed, serviced and/or maintained by a trained and qualified bicycle mechanic. Improper installation, service or maintenance can result in an accident.

Forks and rear shocks contain fluids and air under extreme pressure. **DO NOT** attempt to disassemble any portion of a DVO Suspension product unless instructed to do so by a DVO Suspension authorized technician.

Only use genuine DVO Suspension replacement parts. Modification, improper service, or the use of aftermarket replacement or spare parts may result in an accident and **VOIDS** the warranty of your rear shock.

DVO Suspension forks and rear shocks are designed for the usage by a single rider only. **DO NOT** use DVO Suspension products on any motorized bicycle, or motorized vehicle.

Always be equipped with proper safety gear. This includes a properly fitted and fastened helmet. According to your riding style you should use additional safety protection. Make sure your equipment is in flawless condition.

Make sure you select the correct fork and rear shock according to your frame manufacturer specification. Installing suspension that does not match the geometry of your frame could result in a failure of the suspension itself and void the suspension warranty. Installing a fork or rear shock not designed for your frame will change the geometry and handling of your bike. Learn how to ride and train your skills. Know your limits and never ride beyond those.

Study all other manuals provided with your bicycle and make yourself familiar with all components mounted to your bike.

Fork Installation

WARNING

DVO Suspension strongly recommends that your fork be installed by a trained and qualified bicycle mechanic. Special knowledge and tools are essential to properly install DVO Suspension forks. Common mechanical knowledge may not be sufficient to install a DVO Suspension fork. If you intend on installing the fork by yourself, the whole job needs to be inspected by a trained and qualified bicycle mechanic. Please note, that improperly installed forks are extremely dangerous and cause damage to the product, serious injury or even death.

1. If changing a fork on an existing bicycle, remove the front wheel and brake from your fork. After, remove the headset crown race from the fork.
 2. Using a headset race installer, install the headset crown race on new steer tube. Make sure it is firmly against the fork crown leaving no space between the crown race and the fork crown. (Refer to your headset manufacturer's instructions to make sure the crown race is properly installed)
 3. Measure the steer tube length of existing fork and transfer this measurement to your new fork steer tube. If you do not have an existing fork to measure you must install the fork into the bicycle's head tube with the complete headset, stem and spacers. (Refer to your stem manufacturer's instructions to be sure there will be enough clamping surface for the stem.) In this case you may need to cut your steer tube slightly shorter (3mm) to allow enough clamping surface so that the stem cap bolt can pull up on the steer tube, ensuring a snug and proper fit.
 4. If it is necessary to cut the steer tube, **MEASURE TWICE CUT ONCE.** It is recommended that a cutting guide be used when cutting the steer tube.
 5. Install the star nut into the steer tube using a star nut installation tool to the proper depth.
 6. Install the fork into the frame head tube. Tighten the star nut bolt so that there is no play or drag in the headset when turning the steer tube.
Dual Crown Fork : Install the steering bumpers onto the upper tubes. Use a torque wrench to tighten all top and lower crown pinch bolts to **7Nm**.
 7. Install the front brake according to the manufacturer's instructions and make sure you adjust the brake pads properly. Ensure that brake line length is the correct length to not effect steering or compression and extension of the fork.
NOTE: Rotor size must be between 160mm-203mm
 8. Install the front brake hose through the cable guide. Make sure the hose is routed on the inside of the leg. Use a 2mm allen key and torque to 3nm to secure hose and cable guide.
-  All DVO Suspension forks come with a threadless steer tube. Do not add a thread to it! DVO Suspension fork steer tubes are for one-time press fit only which cannot be removed. Do not try to replace the steer tube with a threaded steer tube. This will void the warranty of your fork.

Wheel Installation

Please make sure you have the correct wheel size for your fork model.

15mm Quick Release Installation

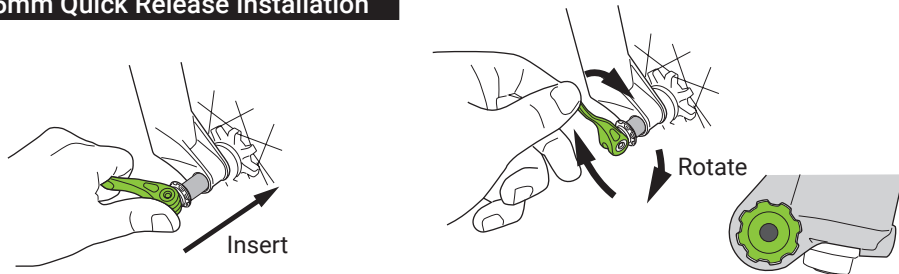

1. Make sure the hub fit into the drop outs, then insert the thru axle from the non-disc side. Slide the axle until it makes contact with the threads of the axle bolt on the disc side.

2. Rotate the axle lever clockwise until there is a small gap between the lever bolt and dropouts on the non-disc side. If the axle bolt is not sitting inside the grooves release tension on the axle and line up the axle bolt so that you can lightly press it into the grooves.

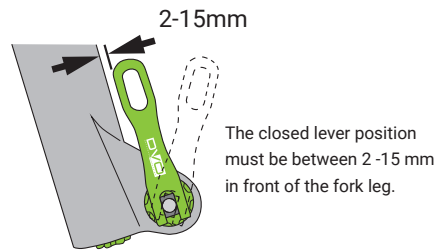
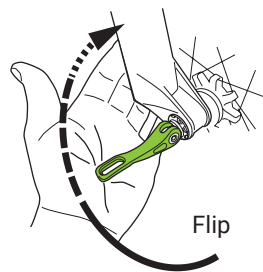

3. To secure the axle, position the lever in the open position. When you flip the lever half way you should feel resistance and the lever bolt should be touching the drop out. Flip the lever to the closed position by hand strength only. The lever should feel very secure. DO NOT USE ANY TOOLS FOR LEVERAGE.

⚠ WARNING
Do not rotate the axle lever while it is in the closed position. This can cause the axle to loosen up and result in an accident, personal injury or death.

4. If there is too much or too little resistance adjust the axle bolt on the disc side. Unthread the axle 3 full turns then push the axle to the drive side. This will push the axle bolt out so you can adjust it. If the axle has too much tension then turn the axle bolt counter clock wise. If the axle did not have enough tension then turn the axle bolt clock wise. Rotate axle lever clockwise again and secure lever until there is proper tension in the closed position.

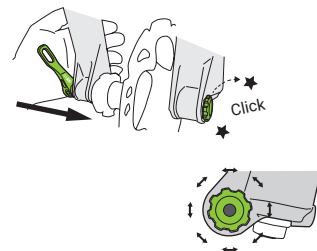

5. Remove bike from stand. With the front brake on, lightly rock the bike back and forth to ensure the headset preload is at the appropriate torque value. THERE SHOULD BE NO PLAY IN THE HEADSET.

15mm Tool Type Axle Installation

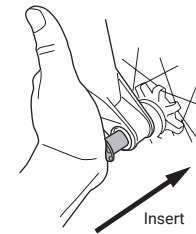

1. Insert the axle through the drive-side dropouts and hub.

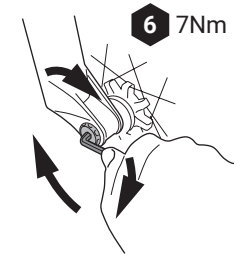

2. Use a 6 mm hex wrench to torque the axle to 7 Nm.

20mm Pinch Axle Installation

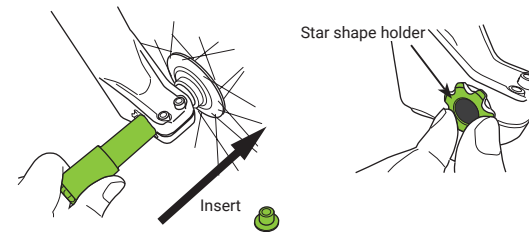

1. Install the front wheel into the dropouts and insert the axle and align the star shape holder, through the dropouts and hub.

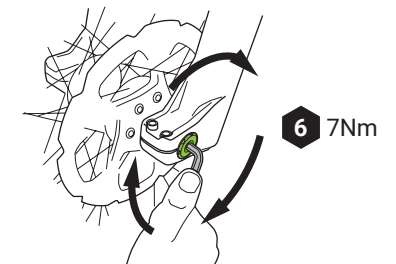

2. Use a 6 mm hex wrench to torque the axle nut to 7 Nm .

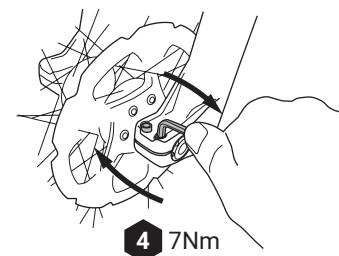

3. Use a 4 mm hex wrench to torque the two pinch bolts on the non-drive side dropouts to 7 Nm.

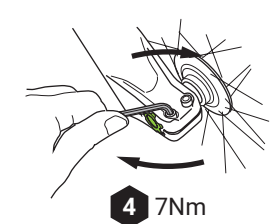

5. Use a 4 mm hex wrench to torque the two pinch bolts on the drive side dropouts to 7 Nm.

4. Compress the fork a couple of times to ensure that the lower leg has settled into its low-friction point.

Fender Installation

All DVO forks comes with an integrated fender that can be used during muddy or sandy conditions.

Single Crown Fork

1. Using a 3mm allen key (ball end recommended), carefully thread in the 2 snap-in bolts into the lower holes on the rear of the arch and torque to 3Nm. Once these have been installed these bolts do not have to be removed. *Be careful to not scratch the stanchions during installation.

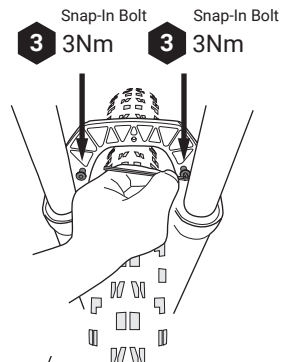

2. Line up the fender with the snap-in bolts and press down until secure. Fender will "snap" into place. BE SURE TO APPLY PRESSURE OVER THE MOUNT BOLT AND NOT THE TAIL OF THE FENDER.

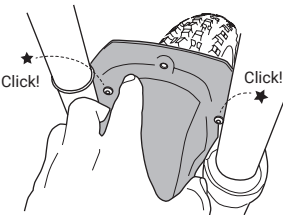

3. Using a 3mm allen key, insert the fender mount bolt into the center of the arch and torque to 3Nm. There should be no play between the fender and the arch.

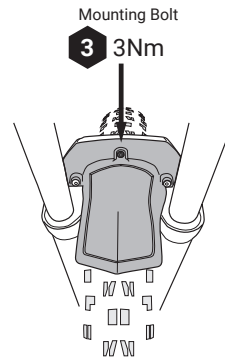

Fender Removal

Unthread the center mount bolt first. Then pull the fender upwards to release it from the lower snap-in bolts. DO NOT PULL UP on the tail of the fender. The snap-in bolts will stay threaded into the arch.

Dual Crown Fork

Using a 2.5mm allen key, insert the fender mount bolt, torque to 3Nm. There should be no play between the fender and the arch.

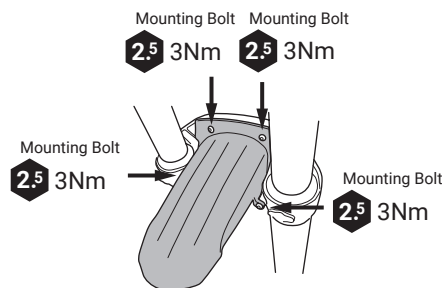

Tire Clearance

The clearance between your tire and fork needs to be checked to make sure it does not come in contact with any part of the fork. There should be at least 6mm of clearance between the top of the tire and the bottom of the arch and fender (if installed).

⚠ WARNING

Inadequate tire clearance will result in an accident, personal injury or death

For more details about tire clearance, please visit DVO TECH <http://tech.dvosuspension.com/setup>

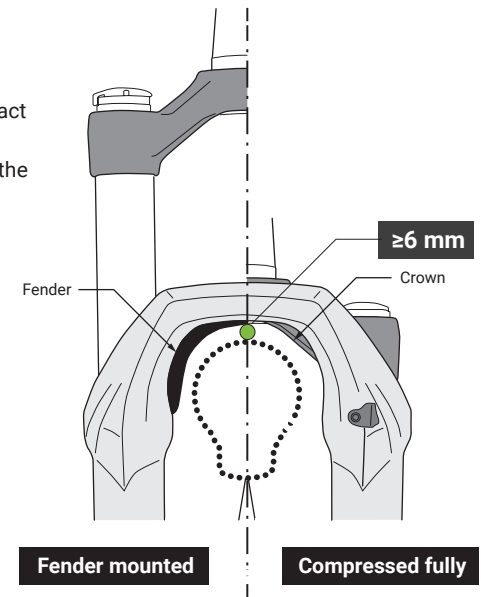

Service & Maintenance

⚠ WARNING

Failure to properly maintain your fork will result in an accident, personal injury or death.

We recommend all DVO Suspension service should be performed by a qualified bicycle mechanic. Service information and detailed instructions can be found at <http://tech.dvosuspension.com> or by contacting your local DVO Suspension dealer or distributor.

Terrain, location and riding ability can greatly affect the interval in which maintenance should be performed. Always inspect your products, and lean towards caution if maintenance is in question. When in doubt, consult a qualified bicycle mechanic, or contact DVO Suspension directly.

Elementi di servizio consigliati minimi	Intervallo
Controllare la pressione dell'aria	Prima di ogni corsa
Ispezionare il tubo di fissaggio per i graffi	Prima di ogni corsa
Pulire i tubi di fissaggio	Dopo ogni giro
Controllare le impostazioni della coppia	25 ore
Rimuovere abbassare, pulire / ispezionare la boccola e sostituire l'olio	50 ore
Assemblare la molla pneumatica	100 ore
Cartuccia ammortizzatore di servizio	100 ore

Recommended Max Torque Specifications

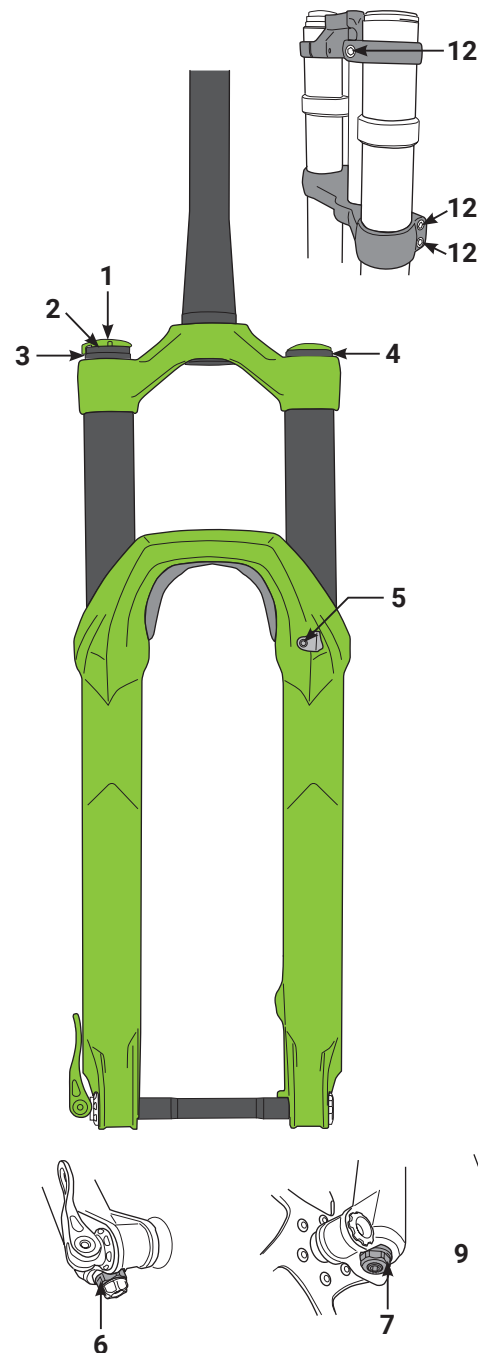

	Parte	valore specificato
1	Viti a vite di compressione	3 Nm 26.5 in.lbf
2	Caricatore di compressione	9 Nm 80 in.lbf
3	Cartuccia ammortizzatore superiore	15 Nm 132 in.lbf
4	Cartuccia d'aria a tappo superiore	15 Nm 132 in.lbf
5	Bullone guida cavo	3 Nm 26.5 in.lbf
6	Dado del piede di rimbalzo	10 Nm 88 in.lbf
7	Dado piede OTT	10 Nm 88 in.lbf
8	Bullone di montaggio del parafrangente	3 Nm 26.5 in.lbf
9	Bulloni a scatto Fender	7 Nm 62 in.lbf
10	Asse tipo utensile da 15 mm	7 Nm 62 in.lbf
11	Asse tipo utensile da 20 mm	7 Nm 62 in.lbf
12	Bullone a pinza	7 Nm 62 in.lbf

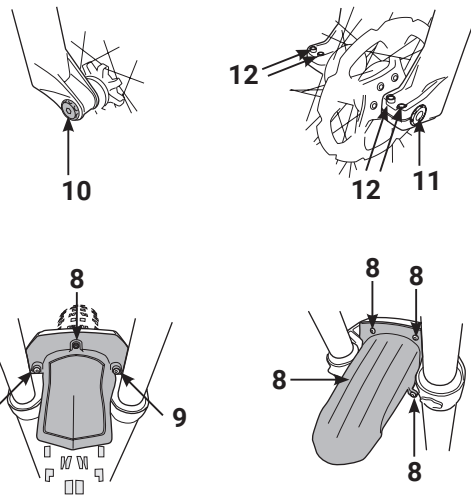

GARANZIA LIMITATA DI DUE (2) ANNI

Se qualsiasi componente del prodotto DVO Suspension è stato trovato difettoso nel materiale o manodopera entro il termine di questa Garanzia Limitata di Due Anni ("Accordo"), il componente difettoso sarà riparato o sostituito, a discrezione di DVO Suspension, gratuitamente, entro trenta (30) giorni dalla ricezione del prodotto Suspension da parte di un rivenditore autorizzato DVO Suspension, trasporto prepagato, unitamente alla fattura/scontrino di vendita originale o altro documento attestante la data di acquisto.

ESCLUSIONI: La presente garanzia non copre danni derivanti da incidenti, modifiche, negligenza, cattivo uso, abuso o uso improprio, mancanza di manutenzione appropriata o ragionevole, montaggio scorretto, riparazioni non eseguite correttamente o sostituzione di parti ed accessori non conformi alle specifiche di DVO Suspension, modifiche non raccomandate o approvate per iscritto dalle attività di DVO Suspension, quali virtuosismi acrobatici, salti acrobatici, arrampicate, gare, uso commerciale, e/o normale usura e deterioramento derivante dall'uso del prodotto. Gli articoli soggetti alla normale usura o deterioramento includono, ma non sono limitati a, olio, polvere, paraoli e boccole. Inoltre, questa garanzia non è valida nel caso in cui le forcelle siano utilizzate con qualsiasi servizio di noleggio biciclette, a meno che DVO Suspension non lo approvi preventivamente per iscritto a tale uso. Questa garanzia non copre eventuali spese sostenute per il trasporto del prodotto DVO Suspension verso o da un rivenditore autorizzato DVO Suspension, il costo del lavoro per rimuovere il prodotto DVO Suspension dalla bicicletta, o il risarcimento per inconvenienti o mancanza di utilizzo, mentre il prodotto DVO Suspension è in riparazione. Tale garanzia verrà automaticamente annullata se il numero di serie del prodotto DVO Suspension verrà modificato, cancellato, reso illeggibile o comunque manomesso.

ACQUIRENTE: Questa garanzia è fatta da DVO Suspension solo con l'acquirente originale del prodotto DVO Suspension e non si estende a terzi. I diritti spettanti all'acquirente originale ai sensi della presente garanzia non possono essere ceduti.

TERMINE: La durata della presente garanzia decorre dalla data di acquisto e deve continuare per un periodo di due (2) anni dalla data di acquisto originale.

PROCEDURA: In caso di difetto coperto dalla presente garanzia, l'acquirente dovrà contattare il rivenditore autorizzato DVO Suspension o un centro di assistenza DVO Suspension.

INTERO ACCORDO: Questa garanzia sostituisce tutte le

garanzie implicite od esplicite, dichiarazioni o impegni che possono essere stati fatti in precedenza, e contiene l'intero accordo tra le parti con riferimento alla garanzia di questo prodotto DVO Suspension. Tutte le garanzie non contenute in questo documento sono espressamente escluse.

DANNI: Salvo quanto espressamente previsto dalla presente garanzia, DVO Suspension NON SARA' RESPONSABILE PER DANNI DIRETTI O INDIRETTI DERIVANTI DALL'USO DEL PRODOTTO DVO SUSPENSION O RECLAMI SECONDO QUESTO ACCORDO, SE IL RECLAMO E' BASATO SU CONTRATTO, TORTO O ALTRO. Le dichiarazioni di garanzia sopra menzionate sono esclusive e sostituiscono qualsiasi altro mezzo. Alcuni stati non consentono l'esclusione o la limitazione dei danni incidentali o consequenziali, quindi la limitazione o esclusione potrebbe non applicarsi.

DISCLAIMER: QUALSIASI GARANZIA DI COMMERCIALIZZABILITÀ O IDONEITÀ PER UNO SCOPO PARTICOLARE E TUTTE LE GARANZIE IMPLICITE DERIVANTI DA UNA TRATTATIVA, USO COMMERCIALE, PER STATUTO O ALTRO, E' STRETTAMENTE LIMITATA AI TERMINI DELLA PRESENTE GARANZIA SCRITTA. Il presente Accordo è il solo ed esclusivo mezzo a disposizione dell'acquirente per quanto riguarda questo acquisto. In caso di presunta violazione di qualsiasi garanzia o qualsiasi azione legale intentata dall'acquirente sulla base di presunta negligenza o altro comportamento illecito da DVO Suspension, l'unico ed esclusivo effetto per l'acquirente sarà la riparazione o la sostituzione di materiali difettosi, come detto sopra. Nessun rivenditore o agente o dipendente di DVO Suspension è autorizzato a modificare, estendere o ampliare la presente garanzia.

ATTENZIONE: Installare, riparare ed utilizzare il prodotto DVO Suspension in stretta conformità con il suo manuale d'istruzioni.

ALTRI DIRITTI: Questa garanzia fornisce diritti legali specifici e avrà anche altri diritti che variano da stato a stato (solo USA).

LEGGE APPLICABILE: Eventuali controversie derivanti dal presente contratto o dall'utilizzo di questo prodotto DVO Suspension saranno regolate dalle leggi degli Stati Uniti d'America e saranno decise dai tribunali della California.

Congratulations!

Thank you for purchasing DVO Suspension for your mountain bike. DVO Suspension products are designed by riders for riders. It is very important for your safety that you follow the guidelines, instructions and set-up information provided in this owner's manual or on our website.

DVO TECH

Go to <http://tech.dvosuspension.com> for setup, service guides and tuning information. DVO Tech has detailed information and articles on suspension setup and tuning to help you understand how suspension works and how each adjustment affects the performance of your fork and shock. Detailed step by step instructions and videos are available to show you how to properly perform service jobs such as changing seals and oil to more advanced tasks like damper services. DVO Tech also has a forum where you can communicate with DVO technicians and search a database of questions and answers.

WARNING

Failure to comply with these warnings and instructions may cause **SERIOUS INJURY, DEATH, or DAMAGE TO YOUR PRODUCT.**

Be sure to read this manual carefully before using your DVO suspension. Throughout this manual, reference is made that "an accident" could occur. Any accident may cause damage to the product, **SERIOUS INJURY, OR DEATH.**

These instructions contain important information about the correct installation, guidelines for set-up, service and maintenance of your suspension. Nevertheless, please be informed that special knowledge and tools are essential to install, service and to maintain DVO Suspension. Common mechanical knowledge may not be sufficient to repair, service or maintain your suspension. Therefore we strongly recommend getting your suspension installed, serviced and/or maintained by a trained and qualified bicycle mechanic. Improper installation, service or maintenance can result in an accident.

Forks and rear shocks contain fluids and air under extreme pressure. **DO NOT** attempt to disassemble any portion of a DVO Suspension product unless instructed to do so by a DVO Suspension authorized technician.

Only use genuine DVO Suspension replacement parts. Modification, improper service, or the use of aftermarket replacement or spare parts may result in an accident and **VOIDS** the warranty of your rear shock.

DVO Suspension forks and rear shocks are designed for the usage by a single rider only. **DO NOT** use DVO Suspension products on any motorized bicycle, or motorized vehicle.

Always be equipped with proper safety gear. This includes a properly fitted and fastened helmet. According to your riding style you should use additional safety protection. Make sure your equipment is in flawless condition.

Make sure you select the correct fork and rear shock according to your frame manufacturer specification. Installing suspension that does not match the geometry of your frame could result in a failure of the suspension itself and void the suspension warranty. Installing a fork or rear shock not designed for your frame will change the geometry and handling of your bike. Learn how to ride and train your skills. Know your limits and never ride beyond those.

Study all other manuals provided with your bicycle and make yourself familiar with all components mounted to your bike.

Fork Installation

WARNING

DVO Suspension strongly recommends that your fork be installed by a trained and qualified bicycle mechanic. Special knowledge and tools are essential to properly install DVO Suspension forks. Common mechanical knowledge may not be sufficient to install a DVO Suspension fork. If you intend on installing the fork by yourself, the whole job needs to be inspected by a trained and qualified bicycle mechanic. Please note, that improperly installed forks are extremely dangerous and cause damage to the product, serious injury or even death.

1. If changing a fork on an existing bicycle, remove the front wheel and brake from your fork. After, remove the headset crown race from the fork.
 2. Using a headset race installer, install the headset crown race on new steer tube. Make sure it is firmly against the fork crown leaving no space between the crown race and the fork crown. (Refer to your headset manufacturer's instructions to make sure the crown race is properly installed)
 3. Measure the steer tube length of existing fork and transfer this measurement to your new fork steer tube. If you do not have an existing fork to measure you must install the fork into the bicycle's head tube with the complete headset, stem and spacers. (Refer to your stem manufacturer's instructions to be sure there will be enough clamping surface for the stem.) In this case you may need to cut your steer tube slightly shorter (3mm) to allow enough clamping surface so that the stem cap bolt can pull up on the steer tube, ensuring a snug and proper fit.
 4. If it is necessary to cut the steer tube, **MEASURE TWICE CUT ONCE.** It is recommended that a cutting guide be used when cutting the steer tube.
 5. Install the star nut into the steer tube using a star nut installation tool to the proper depth.
 6. Install the fork into the frame head tube. Tighten the star nut bolt so that there is no play or drag in the headset when turning the steer tube.
Dual Crown Fork : Install the steering bumpers onto the upper tubes. Use a torque wrench to tighten all top and lower crown pinch bolts to **7Nm.**
 7. Install the front brake according to the manufacturer's instructions and make sure you adjust the brake pads properly. Ensure that brake line length is the correct length to not effect steering or compression and extension of the fork.
NOTE: Rotor size must be between 160mm-203mm
 8. Install the front brake hose through the cable guide. Make sure the hose is routed on the inside of the leg. Use a 2mm allen key and torque to 3nm to secure hose and cable guide.
-  All DVO Suspension forks come with a threadless steer tube. Do not add a thread to it! DVO Suspension fork steer tubes are for one-time press fit only which cannot be removed. Do not try to replace the steer tube with a threaded steer tube. This will void the warranty of your fork.

Wheel Installation

Please make sure you have the correct wheel size for your fork model.

15mm Quick Release Installation

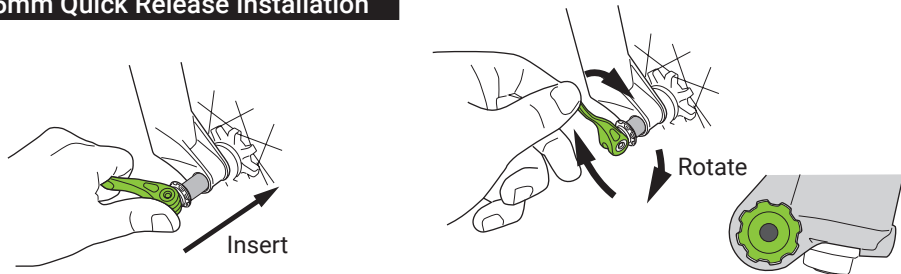

1. Insert the front wheel back onto the bike. Make sure the hub fit into the drop outs, then insert the thru axle from the non-disc side. Slide the axle until it makes contact with the threads of the axle bolt on the disc side.

2. Rotate the axle lever clockwise until there is a small gap between the lever bolt and dropouts on the non-disc side. If the axle bolt is not sitting inside the grooves release tension on the axle and line up the axle bolt so that you can lightly press it into the grooves.

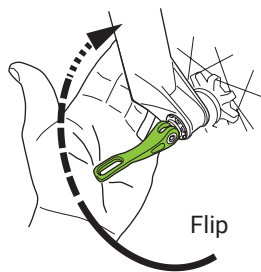

3. To secure the axle, position the lever in the open position. When you flip the lever half way you should feel resistance and the lever bolt should be touching the drop out. Flip the lever to the closed position by hand strength only. The lever should feel very secure. DO NOT USE ANY TOOLS FOR LEVERAGE.

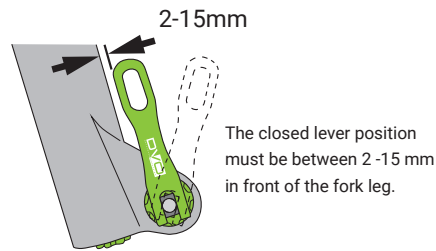

⚠ WARNING
Do not rotate the axle lever while it is in the closed position. This can cause the axle to loosen up and result in an accident, personal injury or death.

4. If there is too much or too little resistance adjust the axle bolt on the disc side. Unthread the axle 3 full turns then push the axle to the drive side. This will push the axle bolt out so you can adjust it. If the axle has too much tension then turn the axle bolt counter clock wise. If the axle did not have enough tension then turn the axle bolt clock wise. Rotate axle lever clockwise again and secure lever until there is proper tension in the closed position.

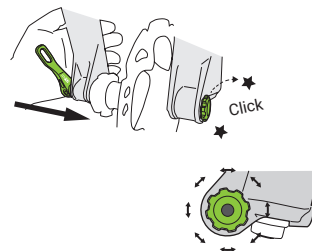

5. Remove bike from stand. With the front brake on, lightly rock the bike back and forth to ensure the headset preload is at the appropriate torque value. THERE SHOULD BE NO PLAY IN THE HEADSET.

15mm Tool Type Axle Installation



1. Install the front wheel into the fork drop outs. Insert the axle through the drive-side dropouts and hub.

2. Use a 6 mm hex wrench to torque the axle to 7 Nm.

20mm Pinch Axle Installation

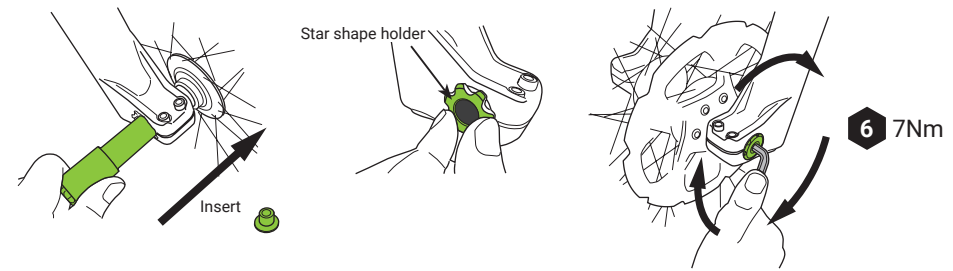

1. Install the front wheel into the dropouts and insert the axle and align the star shape holder, through the dropouts and hub.

2. Use a 6 mm hex wrench to torque the axle nut to 7 Nm .

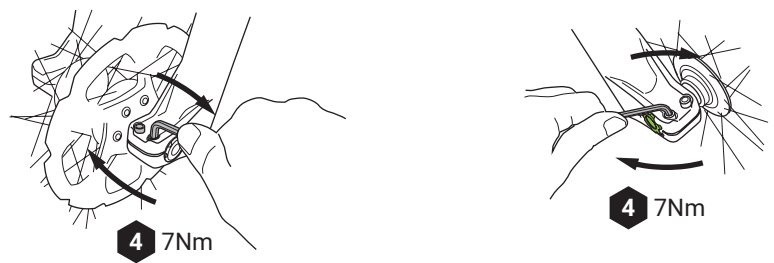

3. Use a 4 mm hex wrench to torque the two pinch bolts on the non-drive side dripouts to 7 Nm.

5. Use a 4 mm hex wrench to torque the two pinch bolts on the drive side dripouts to 7 Nm.

4. Compress the fork a couple of times to ensure that the lower leg has settled into its low-friction point.

Fender Installation

All DVO forks comes with an integrated fender that can be used during muddy or sandy conditions.

Single Crown Fork

1. Using a 3mm allen key (ball end recommended), carefully thread in the 2 snap-in bolts into the lower holes on the rear of the arch and torque to 3Nm. Once these have been installed these bolts do not have to be removed. *Be careful to not scratch the stanchions during installation.

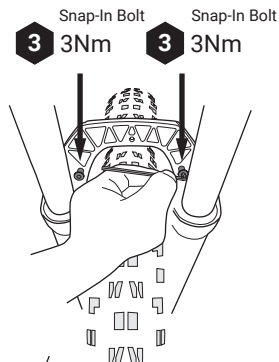

2. Line up the fender with the snap-in bolts and press down until secure. Fender will "snap" into place. BE SURE TO APPLY PRES-SURE OVER THE MOUNT BOLT AND NOT THE TAIL OF THE FENDER.

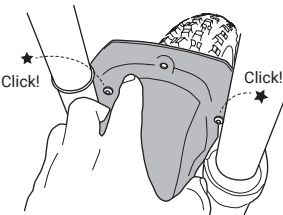

3. Using a 3mm allen key, insert the fender mount bolt into the center of the arch and torque to 3Nm. There should be no play between the fender and the arch.

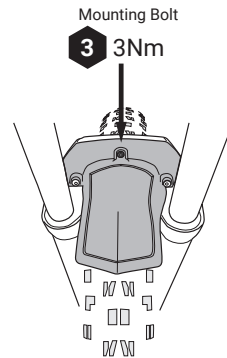

Fender Removal

Unthread the center mount bolt first. Then pull the fender upwards to release it from the lower snap-in bolts. DO NOT PULL UP on the tail of the fender. The snap-in bolts will stay threaded into the arch.

Dual Crown Fork

Using a 2.5mm allen key, insert the fender mount bolt, torque to 3Nm. There should be no play between the fender and the arch.

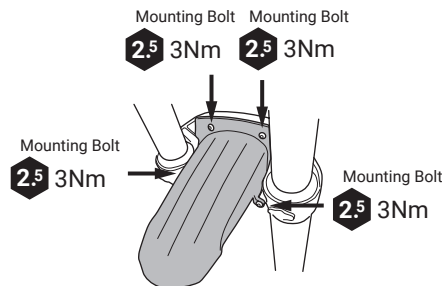

Tire Clearance

The clearance between your tire and fork needs to be checked to make sure it does not come in contact with any part of the fork. There should be at least 6mm of clearance between the top of the tire and the bottom of the arch and fender (if installed).

⚠ WARNING

Inadequate tire clearance will result in an accident, personal injury or death

For more details about tire clearance, please visit DVO TECH <http://tech.dvosuspension.com/setup>

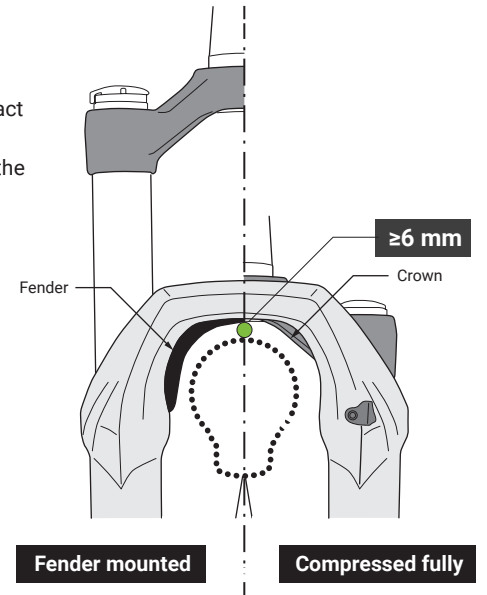

Service & Maintenance

⚠ WARNING

Failure to properly maintain your fork will result in an accident, personal injury or death.

We recommend all DVO Suspension service should be performed by a qualified bicycle mechanic. Service information and detailed instructions can be found at <http://tech.dvosuspension.com> or by contacting your local DVO Suspension dealer or distributor.

Terrain, location and riding ability can greatly affect the interval in which maintenance should be performed. Always inspect your products, and lean towards caution if maintenance is in question. When in doubt, consult a qualified bicycle mechanic, or contact DVO Suspension directly.

Elementos de servicio mínimos recomendados	Intervalo
Compruebe la presión del aire	Antes de cada viaje
Limpie los tubos de soporte	Antes de cada viaje
Después de cada viaje	Después de cada viaje
Compruebe los ajustes de par	25 horas
Remueva las bajas, limpie / inspeccione el buje y cambie el aceite	50 horas
Montaje de resortes de aire de servicio	100 horas
Cartucho del amortiguador de servicio	100 horas

Recommended Max Torque Specifications

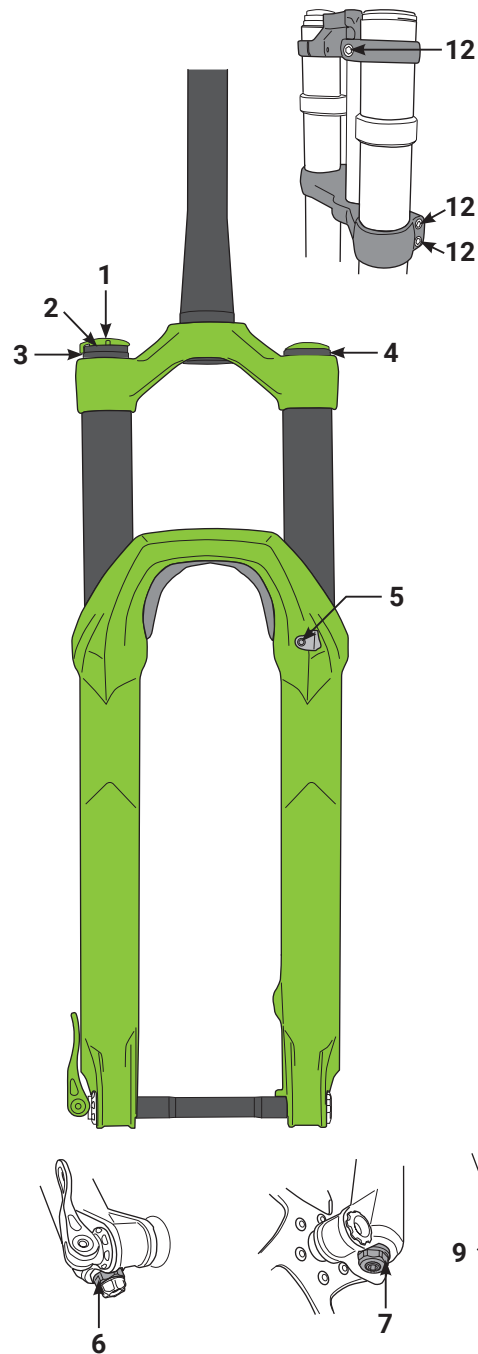

	Part	
1	Tornillo de perilla de compresión	3 Nm 26.5 in.lbf
2	Cargador de compresión	9 Nm 80 in.lbf
3	Cartucho del amortiguador de tapa superior	15 Nm 132 in.lbf
4	Cartucho de aire del tapón superior	15 Nm 132 in.lbf
5	Tornillo de guía de cable	3 Nm 26.5 in.lbf
6	Tuerca de pie rebote	10 Nm 88 in.lbf
7	Tuerca de pie OTT	10 Nm 88 in.lbf
8	Perno de montaje de la defensa	3 Nm 26.5 in.lbf
9	Fender Snap-in Bolts Tornillos de fijación de la defensa	7 Nm 62 in.lbf
10	15 mm Tool Perno del eje	7 Nm 62 in.lbf
11	20 mm Tool Perno del eje	7 Nm 62 in.lbf
12	Perno de fijación del eje	7 Nm 62 in.lbf

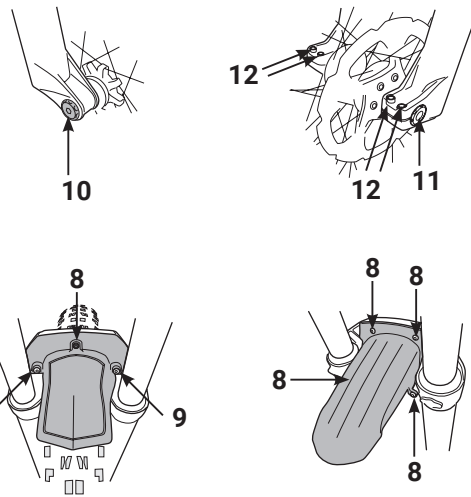

Garantía Limitada De Dos (2) Años

Si se encontrara que cualquier componente de su producto DVO Suspension fuera defectuoso en material o mano de obra dentro de esta Garantía Limitada de Dos Años (el "Acuerdo"), el componente defectuoso será reparado o reemplazado, a opción de DVO Suspension, sin cobro, dentro de treinta (30) días después de la recepción del producto Suspension por un vendedor autorizado de DVO Suspension, portes pagados, junto con la factura de venta original u otra evidencia de la fecha de compra.

NO SE INCLUYE: Esta garantía no cubre daños que resultan de accidentes, alteración, descuido, uso indebido, abuso, o uso inapropiado, falta de mantenimiento razonable o apropiado, ensamblado incorrecto, reparaciones realizadas incorrectamente o piezas o accesorios que no están de acuerdo con las especificaciones de DVO Suspension, modificaciones no recomendadas o aprobadas por escrito por DVO Suspension, actividades tales como acrobacias, trucos de salto, montar rampas, carreras, uso comercial y/o desgaste o deterioro normal ocasionado por el uso del producto. Los ítems que están sujetos a desgaste o deterioro normal incluyen, pero no se limitan a, aceite, tapas de polvo, tapas de aceite, y cojinetes. Además, esta garantía queda invalidada en caso de que se usen las horquillas con cualquier bicicleta de alquiler, a no ser que DVO Suspension dé aprobación previa por escrito para tal uso. Esta garantía tampoco incluye gastos relacionados con el transporte del producto DVO Suspension hacia o desde un vendedor autorizado de DVO Suspension, costos de mano de obra para retirar el producto DVO Suspension de la bicicleta, o compensación por molestias o pérdidas de uso mientras se esté reparando el producto DVO Suspension. Esta garantía quedará automáticamente invalidada si se altera, borra, mutila o de otra manera modifica el número serial del producto DVO Suspension.

COMPRADOR: DVO Suspension provee esta garantía sólo al comprador original del producto DVO Suspension, y no se extiende a terceros. Los derechos del comprador original bajo esta garantía no pueden ser transferidos.

PERÍODO: El período de esta garantía comenzará en la fecha de compra, y continuará por un período de dos (2) años después de la fecha de compra original.

PROCEDIMIENTO: En caso de que haya un defecto cubierto por esta garantía, el comprador debe contactarse con un vendedor autorizado, o con un centro de servicio, de DVO Suspension.

TOTALIDAD DEL ACUERDO: Esta garantía sustituye todos y cualquier garantía oral o implícita, declaraciones o compromisos que se hayan hecho antes, y contiene la totalidad del acuerdo entre las partes con respecto a la garantía de este producto DVO Suspension. Todas y cualquier garantía no incluidas en esta garantía quedan específicamente excluidas. **DAÑOS.** Excepto en la forma provista expresamente por esta garantía, DVO Suspension NO SE RESPONSABILIZARÁ POR DAÑOS INCIDENTALES O CONSECUENTES ASOCIADOS CON EL USO DEL PRODUCTO DVO SUSPENSION O UN RECLAMO BAJO ESTE ACUERDO, YA SEA QUE EL RECLAMO SE BASE EN CONTRATO, AGRAVIO, U OTROS. Las declaraciones de garantía anteriores son exclusivos y sustituyen otros recursos. Algunos estados no permiten la exclusión o limitación de daños incidentales o consecuentes, de modo que es posible que esta limitación o exclusión no se aplique a usted.

DESCARGO DE RESPONSABILIDAD. CUALQUIER GARANTÍA IMPLÍCITA DE COMERCIABILIDAD O APTITUD PARA UN PROPÓSITO ESPECÍFICO, Y CUALQUIER GARANTÍA IMPLÍCITA QUE SURJA DE UN CURSO DE ACCIÓN, USO COMERCIAL, POR ESTATUTO O DE OTRA FORMA, MEDIANTE LA PRESENTE SE LIMITA ESTRICTAMENTE AL PERÍODO DE ESTA GARANTÍA ESCRITA. Este acuerdo será el único y exclusivo recurso disponible al comprador con respecto a esta compra. En caso de un supuesto incumplimiento de cualquier garantía o de una acción legal iniciada por el comprador en base a supuesta negligencia u otras acciones de agravio conducidas por DVO Suspension, el único y exclusivo recurso del comprador será la reparación o sustitución de materiales defectuosos, tal como se indica arriba. Ningún vendedor u otro agente o empleado de DVO Suspension está autorizado a modificar, extender o ampliar esta garantía.

ADVERTENCIA: Siempre debe instalar, reparar y usar su producto DVO Suspension estrictamente de acuerdo con su manual de propietario.

OTROS DERECHOS: Esta garantía le da a usted derechos legales específicos, y es posible que usted también tenga otros derechos, que varían de un estado a otro (sólo para los Estados Unidos).

LEY APLICABLE: Cualquier disputa que surja de este acuerdo o del uso del producto DVO Suspension será gobernada por las leyes del país de los Estados Unidos, y decidida por las cortes de California.

DVO 製品をご購入いただき、ありがとうございます！

この度はDVOサスペンション製品をお選びいただき心より感謝いたします。DVOサスペンション製品はお客様と同様、ライダーのことを知り尽くした同じライダーであるスペシャリストたちによって開発設計されました。本ガイドそして私たちのウェブサイトに、DVO製品を取り付けて使用するための安全上の注意点、メンテナンス、保証に関する重要な情報が含まれています。

DVO TECH(DVO技術情報サイト)

DVOTECH <http://tech.dvosuspension.com> からDVO公式セットアップ、メンテナンス、チューニング情報入手することが出来ます。ここには製品を構成する部品の紹介、より優れたチューニングへのヒントなどの詳細情報を掲載、ビデオによるライダーがチューニングが確実にスキルアップ出来るように設計されています。そしてDVO-TECHをとおしてDVOのスペシャリストと相談、そして過去のFAQを閲覧することが出来ます。

警告

誤った使用は、非常に危険な状態になり、製品の損傷だけでなく致命的な障害または死亡事故を引き起こすことがあります。

DVO製品を使用する前に必ず本マニュアルを注意深くお読みください。本マニュアルの至る所に「事故」の文字があります。あらゆる事故は製品の損傷だけでなく、重度、または致命的な障害を引き起こすことがあります。

本マニュアルは製品を正しい取り付けの手順、サービス、メンテナンスなどの重要な情報が記載されています。しかしながら、DVO製品をベストな状態を維持するために特別な知識やツールは不可欠です。DVO認定の自転車整備士によるサービスおよびメンテナンスをお勧めします。不適切な取り付け・サービスやメンテナンスは事故につながる可能性があります。

DVOリアショックには高圧の液体及び気体が含まれています。DVO認定の自転車整備士から正式に技術教育を受けた者以外、絶対に製品を分解しないでください。

必ずDVO純正の交換部品/消耗部品をご使用ください。改造、適切で無いサービスやアフターマーケット部品の使用は、DVOの製品保証を受けられないばかりでなく、重大な事故につながる恐れがあります。

お買い上げのDVO製品はお一人での乗車を想定していません。DVO製品を原動機付き自転車や車両に使用しないでください。

乗車時には必ずヘルメットやプロテクターを正しく装着してください。さらにあなたの乗車条件により適切な安全装備を別途装備してください。そして装備されたこれらの器具は安全が保たれたものに限ります。

ご使用の自転車とお買い上げのDVO製品の仕様が適切な関係かどうかご確認の上ご使用ください。誤った製品の選択はDVOの製品保証を受けられないばかりか、製品の事故や、重度/または致命的な障害を引き起こすことがあります。フォークやリアショックを交換しますとフレームジオメトリーが変化し、ハンドリングや挙動に影響します。安全が確保された場所でその特性を把握して安全に乗車してください。そして自らの限界を超えるような無理な乗車はしないでください。

自転車に付属の全てのマニュアルをお読みになり、構成部品に熟知した上で自転車をご使用ください。

Fork Installation

警告

DVO 製品をご使用の自転車に取り付けるには専用工具だけでなく、専門技術と知識を持ったDVO認定の自転車整備士に依頼することを強くお勧めします。一般的な知識だけでは適切に組み立てることは出来ないかもしれません。もし、ライダー自ら取り付けようでしたら、取り付け後に必ずDVO認定の自転車整備士に検査の依頼をしてください。誤った取り付けは、非常に危険な状態になり、製品の破損だけでなく致命的な障害または死亡事故を引き起こすことがあります。

1. フォークを交換の場合、現在ご使用のフォーク、ホイール、ブレーキ、ヘッドセットなどを自転車から取り外します。
2. ヘッドセット圧入器具を用いてクラウンレースをフォークのステアチューブに圧入します。クラウン上部とクラウンレースの間に隙間がないことを確認してください。(併せてヘッドセットの取扱説明書を確認して作業してください。)
3. 既存のステアチューブ長を測定し、その長さをフォークのステアチューブに適用し切断してください。もし、新規の自転車組み立ての場合ははじめにヘッドチューブに必要なヘッドセットを取り付け、ステム、ヘッドチューブ、ヘッドセットそして必要に応じてスパーサーを合わせた全長から3mm差し引いた数値がステアチューブの切断位置になります。切断後約400番台の紙やすりで切断面全体を滑らかにしてください。(この作業の時、あわせてヘッドセットの取扱説明書を確認して作業してください。)
4. ステアチューブを切断する際、切断位置の測定を二回行い精度が確認できた時点で切断してください。これが失敗を防ぐDVOからの推奨方法です。
5. ステアチューブ内にスターナットを適切な位置に圧入してください。
6. フォークをヘッドチューブに取り付けます。必要なステム、スパーサー、ヘッドセットを取り付けスターナット付属のボルトをフレームとフォークの間に遊びや抵抗が無くなるように締め付けを調整します。
Dual Crown Fork : Install the steering bumpers onto the upper tubes. Use a torque wrench to tighten all top and lower crown pinch bolts to 7Nm.
7. フロントブレーキをブレーキ取扱説明書に従い適切に取り付けてください。フォークが無負荷時と最大負荷時両方の時に悪影響が出ないようブレーキホース長とルーティングに気をつけてください。
注:ディスクローターサイズは160-203mmの間でご使用ください。
8. ブレーキホースをケーブルガイドに固定します。ホースがロアーケースの内側を通り、ケーブルガイドに到達していることを確認してください。ケーブルガイドは 2.5mmの六角レンチを使用し3Nmの締め付けトルクで固定してください。

⊘ すべてのDVOフォークはネジ無しステアチューブです。フォークのステアチューブには絶対にネジを切ったり、ステアチューブを外したり取り替えたりしないでください。これらの行為はDVOの製品保証を受けられないばかりか、製品の損傷や、致命的な障害または死亡事故を引き起こすことがあります。

車輪の取り付け

Please make sure you have the correct wheel size for your fork model.

15mm Quick Release Installation

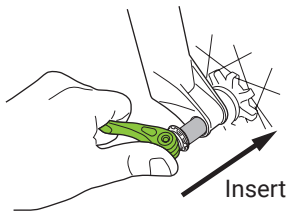

1. ハブが確実にドロップアウトにフィットしているかどうか確認してください。スルーアクセルをディスクローターと反対側のドロップアウトから挿入してください。スルーアクセルをディスクローター側の届くところまで挿入してください。

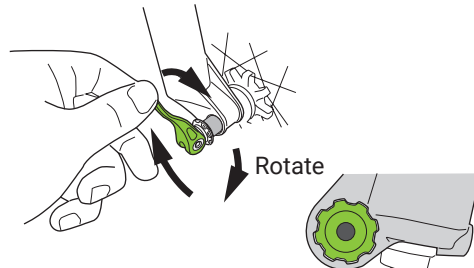

2. アクセルレバーを時計回りに、アクセルレバー付け根にあるボルトとドロップアウトとの隙間が小さくなるまで廻してください。

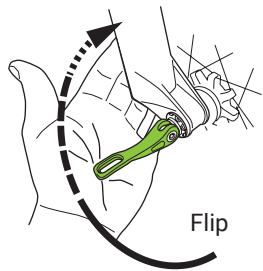

3. To secure the axle, position the lever in the open position. When you flip the lever half way you should feel resistance and the lever bolt should be touching the drop out. Flip the lever to the closed position by hand strength only. The lever should feel very secure. DO NOT USE ANY TOOLS FOR LEVERAGE.

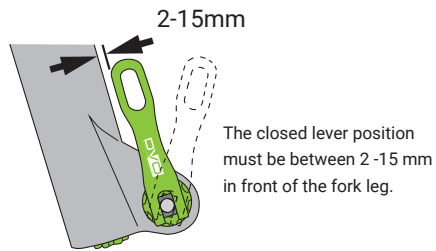

警告
アクセルレバーを回転させてアクセルを固定させないでください!これは誤った固定法でアクセルを確実に固定出来ず、走行中に緩みが生じ結果、傷害事故に留まらず死亡事故に至る恐れがあります。

4. If there is too much or too little resistance adjust the axle bolt on the disc side. Unthread the axle 3 full turns then push the axle to the drive side. This will push the axle bolt out so you can adjust it. If the axle has too much tension then turn the axle bolt counter clock wise. If the axle did not have enough tension then turn the axle bolt clock wise. Rotate axle lever clockwise again and secure lever until there is proper tension in the closed position.

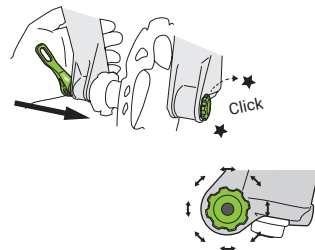

5. Remove bike from stand. With the front brake on, lightly rock the bike back and forth to ensure the headset preload is at the appropriate torque value. THERE SHOULD BE NO PLAY IN THE HEADSET.

15mm Tool Type Axle Installation

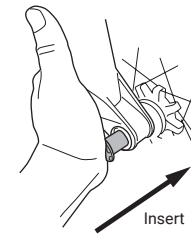

1. Install the front wheel into the fork drop outs. Insert the axle through the drive-side dropouts and hub.

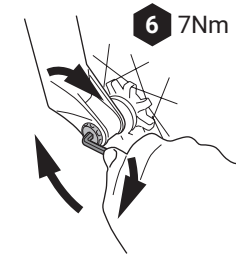

2. Use a 6 mm hex wrench to torque the axle to 7 Nm.

20mm Pinch Axle Installation

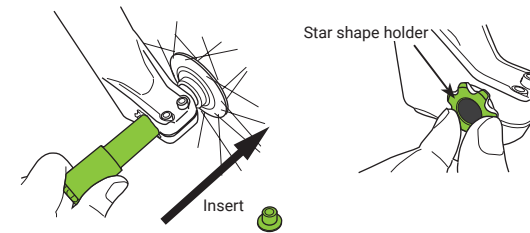

1. Install the front wheel into the dropouts and insert the axle and align the star shape holder, through the dropouts and hub.

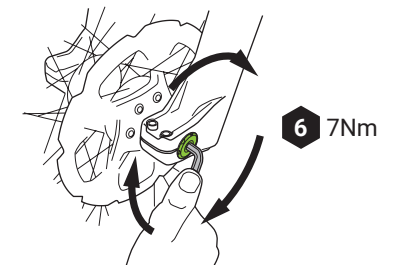

2. Use a 6 mm hex wrench to torque the axle nut to 7 Nm .

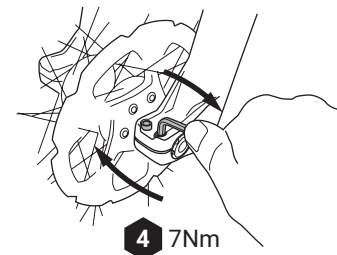

3. Use a 4 mm hex wrench to torque the two pinch bolts on the non-drive side driputos to 7 Nm.

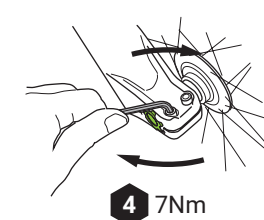

5. Use a 4 mm hex wrench to torque the two pinch bolts on the drive side driputos to 7 Nm.

4. Compress the fork a couple of times to ensure that the lower leg has settled into its low-friction point.

Fender Installation

All DVO forks comes with an integrated fender that can be used during muddy or sandy conditions.

Single Crown Fork

1. Using a 3mm allen key (ball end recommended), carefully thread in the 2 snap-in bolts into the lower holes on the rear of the arch and torque to 3Nm. Once these have been installed these bolts do not have to be removed. *Be careful to not scratch the stanchions during installation.

2. Line up the fender with the snap-in bolts and press down until secure. Fender will "snap" into place. BE SURE TO APPLY PRESSURE OVER THE MOUNT BOLT AND NOT THE TAIL OF THE FENDER.

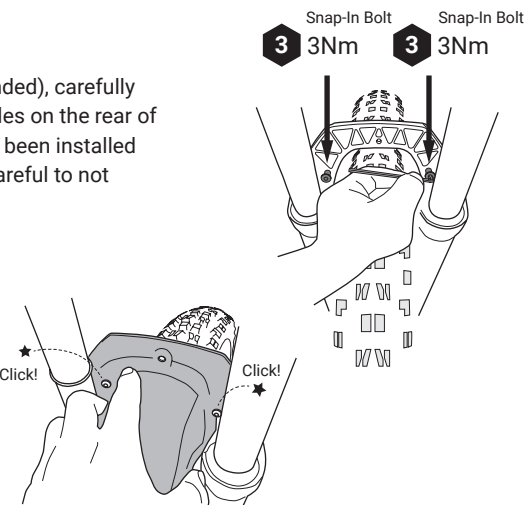

3. Using a 3mm allen key, insert the fender mount bolt into the center of the arch and torque to 3Nm. There should be no play between the fender and the arch.

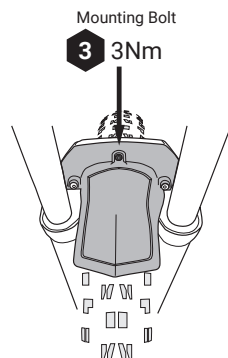

Fender Removal

Unthread the center mount bolt first. Then pull the fender upwards to release it from the lower snap-in bolts. DO NOT PULL UP on the tail of the fender. The snap-in bolts will stay threaded into the arch.

Dual Crown Fork

Using a 2.5mm allen key, insert the fender mount bolt, torque to 3Nm. There should be no play between the fender and the arch.

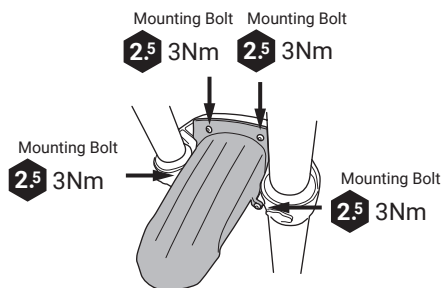

タイヤクリアランス確保

タイヤとフォークのクリアランスは、フォークのどの部分とも接触していないことを確認する必要があります。タイヤの上部とアーチとフェンダー（取り付けしている場合）の間に少なくとも6mmのクリアランスが必要です。

警告
不十分なタイヤクリアランスは傷害事故に留まらず死亡事故に至る恐れがあります。

1. フォークのエアスプリングからエアをすべて抜く。
2. フォークを完全に圧縮する。
3. タイヤの最上部からクラウンの最下部までの距離を測る。隙間が6mm以上であることを確認する。

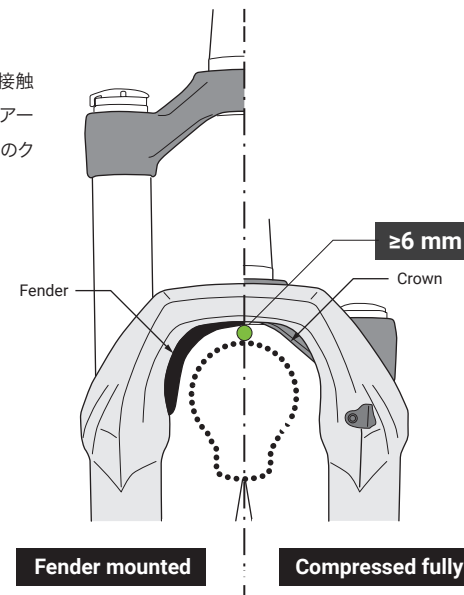

サービス&メンテナンス

警告
誤った使用は、非常に危険な状態になり、製品の破損だけでなく致命的な障害または死亡事故を引き起こすことがあります。

DVO製品のサービスはDVO認定の専門の自転車整備士に依頼することをお勧めします。サービス情報と詳細情報は以下のウェブサイトから若しくはお近くのDVO取扱店まで。

<http://tech.dvosuspension.com>

お使いの製品の使用状況によってメンテナンス頻度が大きく変化します。ご使用の前には必ず検査を行い、常に異常に対し注意を払ってください。異常を感じた場合はDVO認定の自転車整備士もしくはDVOへ直接検査を依頼してください。

最低推奨サービス項目	頻度
エアスプリング圧の確認と必要に応じた調整	毎回の乗車前
スタンションチューブ表面の確認	毎回の乗車前
スタンションチューブ及びダストシール部の清掃	毎回の乗車後
各部締め付けトルクの確認	25時間毎
ロアーケースを外し清掃、プッシュの状態確認そして潤滑用オイルの交換	50時間毎
エアスプリングのサービス(内外部の検査、シーリングの交換を含む再組立)	100時間毎
ダンパーのサービス(内外部の検査、シーリング/オイルの交換を含む再組立)	100時間毎

Recommended Max Torque Specifications

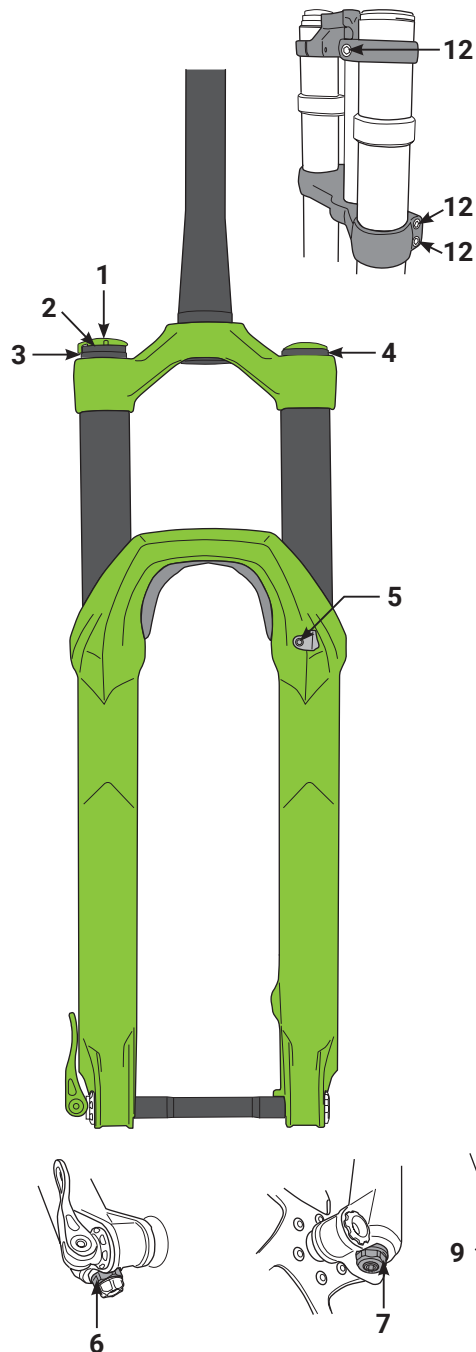

	部位	規定トルク
1	コンプレッションノブ・ネジ	3 Nm 26.5 in.lbf
2	コンプレッション ローダー	9 Nm 80 in.lbf
3	ダンパーカートリッジ上部キャップ	15 Nm 132 in.lbf
4	エアスプリング上部キャップ	15 Nm 132 in.lbf
5	ケーブルガイドボルト	3 Nm 26.5 in.lbf
6	ダンパーカートリッジ下部ボルト	10 Nm 88 in.lbf
7	OTT 下部ボルト	10 Nm 88 in.lbf
8	フェンダー固定ボルト	3 Nm 26.5 in.lbf
9	フェンダースナップイン・ボルト	7 Nm 62 in.lbf
10	15 mm アクセルボルト	7 Nm 62 in.lbf
11	20 mm アクセルボルト	7 Nm 62 in.lbf
12	ピンチボルト	7 Nm 62 in.lbf

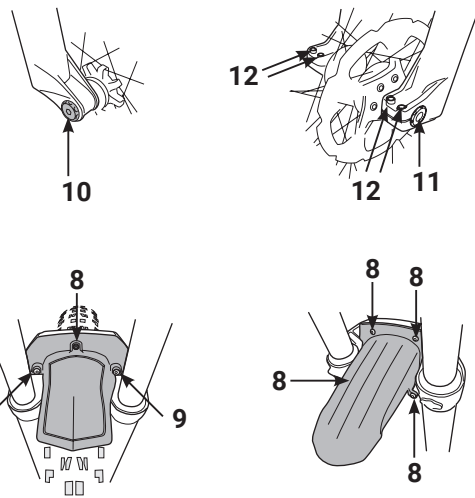

サスペンション製品制限付き 2 年保障

DVOサスペンション構成部品に、材質および製造技術上での欠陥が発見された場合、制限付き2年保障にて(“同意”)、DVOサスペンション正規代理店より購入から30日以内、小売り請求書または購入日の証拠がある場合、運賃前払いでDVOサスペンションが無料で修理又は交換を致します。

保障適用外: 製品が乱用、放置、不当な修理、不適切または不正なサービスやメンテナンス、改造、修正、事故その他、異常または不適切な使用、部品がDVOサスペンションの仕様に見合わないなど、またアクロバット、スタントジャンプ、ランブライディング、レース、商用利用等の不適切な利用法、および製品の使用によって引き起こされる通常の摩耗や劣化に対するの保障はありません。通常の摩耗や劣化の対象項目としては、オイル、ダストシール、オイルシール、ブッシュなどがあります。また、フォークをレンタル自転車に使用した場合、DVOサスペンションが書面で事前に承認 しない限り、保障は無効となります。この保証はまた、許可された正規DVOサスペンション代理店へ、またはそこからのDVOサスペンション製品の輸送に関連する費用、自転車からDVOサスペンション製品を取り外す人件費、又は修理中の不便や損失に関しては、保障が含まれていません。また、機番が変更、消去、汚損または改ざんされたと見なされた場合、保障は自動的に無効となります。

購入者: この保証は、DVOサスペンション製品の当初購入者を対象としており、第三者には適用されません。当初購入者の権利を譲渡してはなりません。

条件: 保障は、購入日から2年間保障有効期限とします。

手順: 保証対象の欠陥が発生した場合、購入者は正規DVOサスペンション代理店またはDVOサスペンションサービスセンターにお問い合わせ下さい。

完全合意: 保障は過去のすべての書面または口頭による明示的または黙示的な了解事項を優先し、DVOサスペンション製品の保証に関する当事者間の完全な合意を含みます。この保証に含まれていない一切の保証は除外されます。

破損: 保証によって提供されるもの以外は、本契約に基づき、DVOサスペンション製品の使用またはその他の請求、不法行為またはその他、付随的または間接的損害に対する責任を負わないものとします。上記は、他の保障全てに代わるのもです。州により、偶発的または必然的な損害の除外または制限を認めていない事があり、この制限または除外が適用されない場合があります。

免責: 特定の目的に対する商品性または適合性の黙示保証は、本契約により厳密にこの書面による保証期間に限定されます。本契約は、購入者が利用できる唯一かつ排他的なものでなければなりません。DVOサスペンションによる、いかなる過失又は不法行為について、購入者からの保障違反又は法的措置が申し立てられた場合、購入者の唯一かつ排他的な救済手段は、上記の通り、修理または材料の交換となります。DVOサスペンション販売店、代理人その他または従業員は、この保証を変更、延長または拡大することを許可されていません。

注意: 組み付け、修理及びDVOサスペンション製品の使用は取扱説明書に厳密に準拠するものとします。

その他: この保証は特定の法的権利、また州の法律に基づく権利がありことを保障します(アメリカに限る)。

適用法: 本契約又はDVOサスペンションに関する争議については、米国の法律に準拠するものとし、カリフォルニア州の裁判所によって判決されます。

恭喜您!

感谢您购买DVO Suspension 產品。DVO Suspension产品是由骑手专为骑手而设计的产品。为确保您的安全, 请遵守本用户手册或我们网站上的指南、说明和安装信息。

DVO TECH (技术信息)

请参考<http://tech.dvosuspension.com>, 以获取安装、维修指南和改装信息。DVO Tech提供了有关悬架安装和调整的详细信息和文章, 以帮助您了解悬架的工作原理。它还指出了各项调整对DVO Suspension产品性能的影响。详细的分步说明和视频向您展示了如何适当执行维修工作(如更换密封和油)及更高级的任务(如阻尼器维修)。DVO Tech还有一个论坛, 您可通过此论坛与DVO技术人员沟通, 並搜索Q&A數據庫。



警告

在使用DVO Suspension产品之前, 请务必仔细阅读本手册。本手册提到了可能发生的“事故”。任何事故都可能导致产品损坏, 或造成严重伤害或死亡。

这些说明包含有关适当安装的重要信息以及DVO Suspension产品的安装、维修和维护指南。但是, 请注意, 安装、维修和维护DVO Suspension产品需要具备专业知识并使用专用工具, 这一点至关重要。常见的机械知识可能不足以用于维修或维护您的产品。因此, 我们强烈建议由经过培训的合格自行车技师安装、维修和/或维护您的产品。不当安装、维修或维护可能会导致事故。

DVO Suspension产品在极压下含有流体和空气。切勿试图拆卸DVO Suspension产品的任何部分, 除非DVO Suspension授权的技术人员指示这样做。

只能使用原装DVO Suspension更换件。改装、不当维修或使用二级市场的更换件或备件可能导致意外事故, 并导致您的DVO Suspension产品质保失效。

DVO Suspension产品仅供单个骑手使用。切勿在任何电动自行车或机动车上安装DVO Suspension产品。

始终佩戴适当的安全防护装备, 包括适当戴好并扣紧头盔。根据您的骑行风格, 您应该佩戴额外的安全防护装备。始终确保您的设备无任何缺陷。

确保根据您的车架、体型和骑行风格选择适当的产品。安装与车架几何形状不匹配的产品可能会导致产品本身发生故障, 并导致产品质保失效。安装DVO Suspension产品将改变自行车的几何形状和操作方式。学习如何骑行并提升您的技能。了解自己的极限, 切勿超越。

阅读自行车随附的所有其他手册, 熟悉自行车上安装的所有组件。

Fork Installation



警告

DVO Suspension strongly recommends that your fork be installed by a trained and qualified bicycle mechanic. Special knowledge and tools are essential to properly install DVO Suspension forks. Common mechanical knowledge may not be sufficient to install a DVO Suspension fork. If you intend on installing the fork by yourself, the whole job needs to be inspected by a trained and qualified bicycle mechanic. Please note, that improperly installed forks are extremely dangerous and cause damage to the product, serious injury or even death.

1. If changing a fork on an existing bicycle, remove the front wheel and brake from your fork. After, remove the headset crown race from the fork.
2. Using a headset race installer, install the headset crown race on new steer tube. Make sure it is firmly against the fork crown leaving no space between the crown race and the fork crown. (Refer to your headset manufacturer's instructions to make sure the crown race is properly installed)
3. Measure the steer tube length of existing fork and transfer this measurement to your new fork steer tube. If you do not have an existing fork to measure you must install the fork into the bicycles head tube with the complete headset, stem and spacers. (Refer to your stem manufacturer's instructions to be sure there will be enough clamping surface for the stem.) In this case you may need to cut your steer tube slightly shorter (3mm) to allow enough clamping surface so that the stem cap bolt can pull up on the steer tube, ensuring a snug and proper fit.
4. If it is necessary to cut the steer tube, MEASURE TWICE CUT ONCE. It is recommended that a cutting guide be used when cutting the steer tube.
5. Install the star nut into the steer tube using a star nut installation tool to the proper depth.
6. Install the fork into the frame head tube. Tighten the star nut bolt so that there is no play or drag in the headset when turning the steer tube.
Dual Crown Fork : Install the steering bumpers onto the upper tubes. Use a torque wrench to tighten all top and lower crown pinch bolts to **7Nm**.
7. Install the front brake according to the manufacturer's instructions and make sure you adjust the brake pads properly. Ensure that brake line length is the correct length to not effect steering or compression and extension of the fork.
NOTE: Rotor size must be between 160mm-203mm
8. Install the front brake hose through the cable guide. Make sure the hose is routed on the inside of the leg. Use a 2mm allen key and torque to 3nm to secure hose and cable guide.



All DVO Suspension forks come with a threadless steer tube. Do not add a thread to it! DVO Suspension fork steer tubes are for one-time press fit only which cannot be removed. Do not try to replace the steer tube with a threaded steer tube. This will void the warranty of your fork.

Wheel Installation

Please make sure you have the correct wheel size for your fork model.

15mm Quick Release Installation

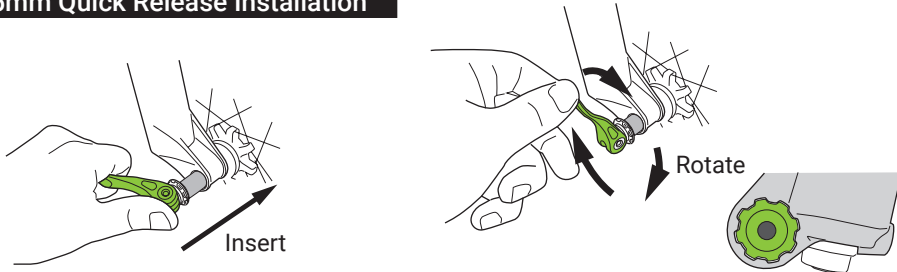

1. Insert the front wheel back onto the bike. Make sure the hub fit into the drop outs, then insert the thru axle from the non-disc side. Slide the axle until it makes contact with the threads of the axle bolt on the disc side.

2. Rotate the axle lever clockwise until there is a small gap between the lever bolt and dropouts on the non-disc side. If the axle bolt is not sitting inside the grooves release tension on the axle and line up the axle bolt so that you can lightly press it into the grooves.

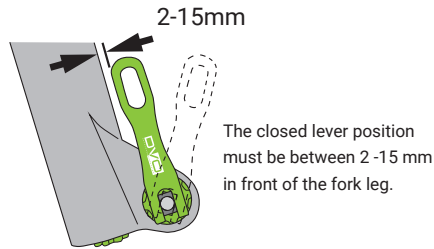
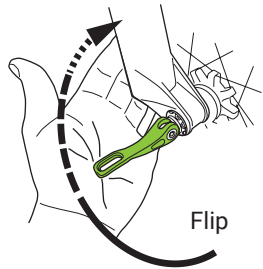

3. To secure the axle, position the lever in the open position. When you flip the lever half way you should feel resistance and the lever bolt should be touching the drop out. Flip the lever to the closed position by hand strength only. The lever should feel very secure. DO NOT USE ANY TOOLS FOR LEVERAGE.

⚠ WARNING
Do not rotate the axle lever while it is in the closed position. This can cause the axle to loosen up and result in an accident, personal injury or death.

4. If there is too much or too little resistance adjust the axle bolt on the disc side. Unthread the axle 3 full turns then push the axle to the drive side. This will push the axle bolt out so you can adjust it. If the axle has too much tension then turn the axle bolt counter clock wise. If the axle did not have enough tension then turn the axle bolt clock wise. Rotate axle lever clockwise again and secure lever until there is proper tension in the closed position.

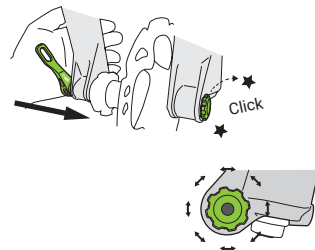

5. Remove bike from stand. With the front brake on, lightly rock the bike back and forth to ensure the headset preload is at the appropriate torque value. THERE SHOULD BE NO PLAY IN THE HEADSET.

15mm Tool Type Axle Installation

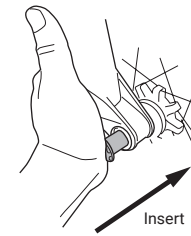

1. Install the front wheel into the fork drop outs. Insert the axle through the drive-side dropouts and hub.

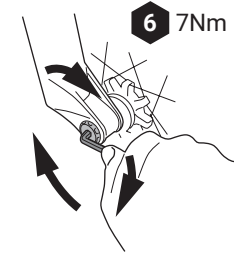

2. Use a 6 mm hex wrench to torque the axle to 7 Nm.

20mm Pinch Axle Installation

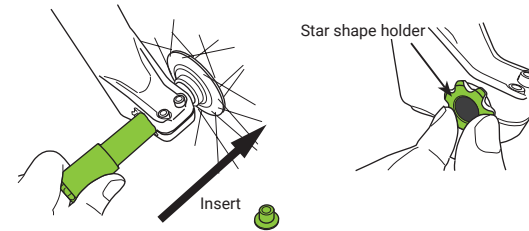

1. Install the front wheel into the dropouts and insert the axle and align the star shape holder, through the dropouts and hub.

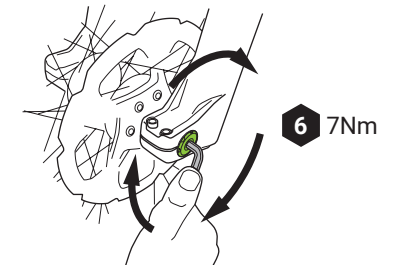

2. Use a 6 mm hex wrench to torque the axle nut to 7 Nm .

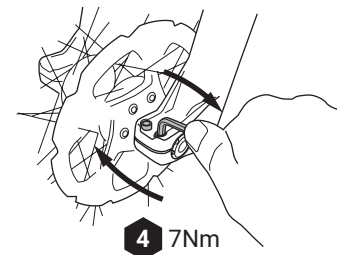

3. Use a 4 mm hex wrench to torque the two pinch bolts on the non-drive side dropouts to 7 Nm.

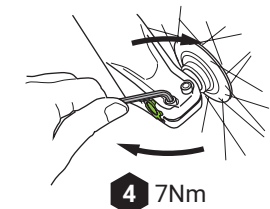

5. Use a 4 mm hex wrench to torque the two pinch bolts on the drive side dropouts to 7 Nm.

4. Compress the fork a couple of times to ensure that the lower leg has settled into its low-friction point.

Fender Installation

All DVO forks comes with an integrated fender that can be used during muddy or sandy conditions.

Single Crown Fork

1. Using a 3mm allen key (ball end recommended), carefully thread in the 2 snap-in bolts into the lower holes on the rear of the arch and torque to 3Nm. Once these have been installed these bolts do not have to be removed. *Be careful to not scratch the stanchions during installation.

Snap-In Bolt 3 3Nm Snap-In Bolt 3 3Nm

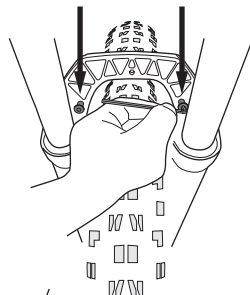

2. Line up the fender with the snap-in bolts and press down until secure. Fender will "snap" into place. BE SURE TO APPLY PRESSURE OVER THE MOUNT BOLT AND NOT THE TAIL OF THE FENDER.

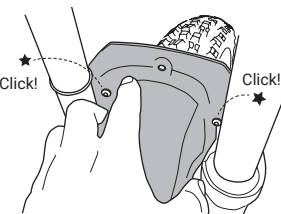

3. Using a 3mm allen key, insert the fender mount bolt into the center of the arch and torque to 3Nm. There should be no play between the fender and the arch.

Mounting Bolt 3 3Nm

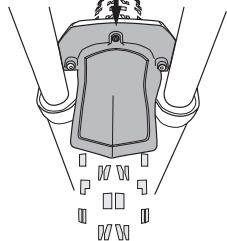

Fender Removal

Unthread the center mount bolt first. Then pull the fender upwards to release it from the lower snap-in bolts. DO NOT PULL UP on the tail of the fender. The snap-in bolts will stay threaded into the arch.

Dual Crown Fork

Using a 2.5mm allen key, insert the fender mount bolt, torque to 3Nm. There should be no play between the fender and the arch.

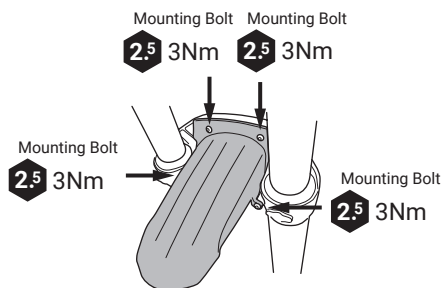

Tire Clearance

The clearance between your tire and fork needs to be checked to make sure it does not come in contact with any part of the fork. There should be at least 6mm of clearance between the top of the tire and the bottom of the arch and fender (if installed).

⚠ WARNING

Inadequate tire clearance will result in an accident, personal injury or death

For more details about tire clearance, please visit DVO TECH
<http://tech.dvosuspension.com/setup>

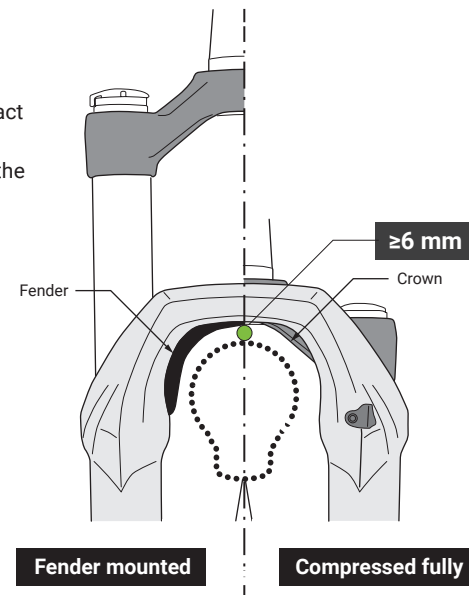

Service & Maintenance

⚠ WARNING

Failure to properly maintain your fork will result in an accident, personal injury or death.

We recommend all DVO Suspension service should be performed by a qualified bicycle mechanic. Service information and detailed instructions can be found at <http://tech.dvosuspension.com> or by contacting your local DVO Suspension dealer or distributor.

Terrain, location and riding ability can greatly affect the interval in which maintenance should be performed. Always inspect your products, and lean towards caution if maintenance is in question. When in doubt, consult a qualified bicycle mechanic, or contact DVO Suspension directly.

最低推荐的服务项目	间隔
检查气压	每次骑乘之前
检查前叉管是否有划痕	每次骑乘之前
清洁前叉管	每次骑乘之后
检查各部扭矩	25小时
清除/检查底管和套筒并更换润滑油	50小时
服务空气弹簧组件(内外部检查, 密封材更换, 再组立)	100小时
服务阻尼组件(内外部检查, 密封材更换/阻尼油更换, 再组立)	100小时

Recommended Max Torque Specifications

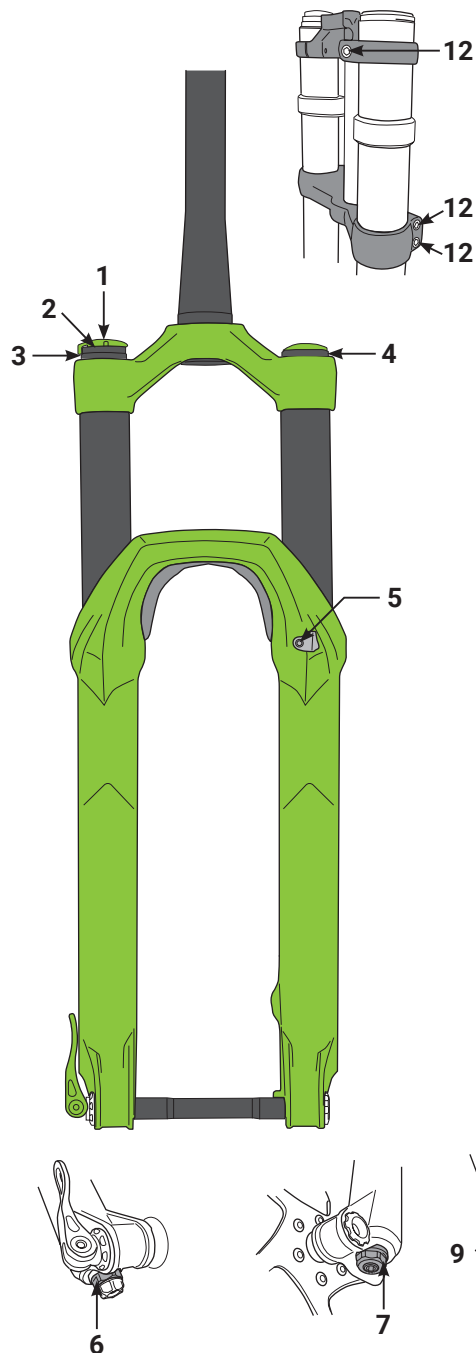

	Part	
1	Compression Knob Screw	3 Nm 26.5 in.lbf
2	Compression Loader	9 Nm 80 in.lbf
3	Top Plug Damper Cartridge	15 Nm 132 in.lbf
4	Top Plug Air Cartridge	15 Nm 132 in.lbf
5	Cable Guide Bolt	3 Nm 26.5 in.lbf
6	Rebound Foot Nut	10 Nm 88 in.lbf
7	OTT Foot Nut	10 Nm 88 in.lbf
8	Fender Mount Bolt	3 Nm 26.5 in.lbf
9	Fender Snap-in Bolts	7 Nm 62 in.lbf
10	15 mm Tool Type Axle	7 Nm 62 in.lbf
11	20 mm Tool Type Axle	7 Nm 62 in.lbf
12	Pinch bolt	7 Nm 62 in.lbf

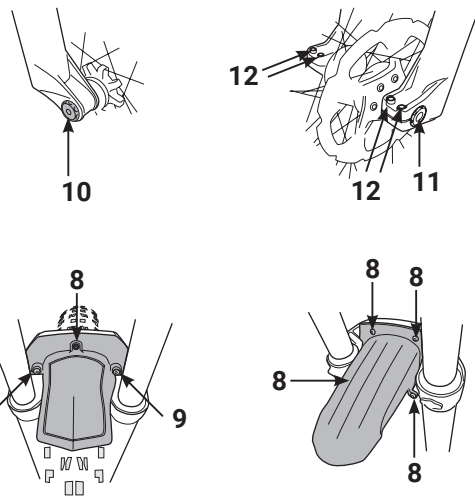

两(2)年有限质保

在本两年有限质保期内(“协议”),如果发现您的DVO Suspension产品的任何部件存在材料或工艺方面的缺陷,则在经授权的DVO Suspension经销商收到Suspension产品(预付运费)以及原始零售发票或注明购买日期的其他证据后的三十(30)天内,DVO Suspension将选择维修或更换有缺陷的部件。

未涵盖:本质保不包括因意外、改装、疏忽、误用、滥用或不当使用、缺乏合理或适当维护、不当组装、不当维修或更换不符合DVO Suspension规格的零件或配件而造成的损坏,以及因DVO Suspension未书面建议或批准的改装(例如杂技、特技跳跃、坡道骑行、赛车、商业使用)和/或因产品正常磨损或退化而造成的损坏。正常磨损或退化的部件包括但不限于油、防尘密封、油封和衬套。此外,如果将前叉用于任何租赁自行车,本质保条款将失效,除非DVO Suspension事先书面批准此类使用。本质保也不包括将DVO Suspension产品运抵经授权的DVO Suspension经销商或从该经销商运出DVO Suspension产品相关的任何费用、从自行车拆除DVO Suspension产品的人工成本或者在维修DVO Suspension产品时对使用不便或损失的补偿。如果DVO Suspension产品的序列号被更改、擦除、损坏或以其他方式被篡改,则本质保将自动失效。

购买者:DVO Suspension只向DVO Suspension产品的原始购买者提供此质保,此质保不适用于任何第三方。原始购买者在本质保下的权利不得转让。

期限:本质保自购买之日起生效,并自原始购买之日起,质保期为两(2)年。

程序:如果存在本质保涉及的缺陷,购买者应联系经授权的DVO Suspension经销商或DVO Suspension服务中心。

完整协议:本质保取代以前可能做出的任何及所有口头或明示质保、声明或承诺,并包含双方就本DVO Suspension产品质保签署的完整协议。本质保未包含的任何和所有质保均明确排除在外。

损害:除本质保明确规定外,DVO Suspension不对与使

用DVO Suspension产品相关的任何偶然性或后果性损害或根据本协议提出的索赔负责,无论索赔是基于合约或其他。上述质保声明是唯一声明,取代所有其他补救措施。某些州不允许排除或限制偶然性或后果性损害,因此,此限制或排除可能不适用于您。

免责声明:针对特定用途的适销性或适用性的任何暗示保证以及在交易过程中按照商业惯例、法规或其他所产生的所有暗示保证,在此严格限于本书面质保的期限。本协议是购买者对本次购买可获得的唯一及独有补救措施。如果发生任何涉嫌违反任何质保的行为或购买者针对DVO Suspension的涉嫌疏忽或其他侵权行为提起任何法律诉讼,购买者采取的唯一及独有补救措施将是上文所述的维修或更换有缺陷的材料。DVO Suspension的经销商和其他代理或员工均无权修改、扩展或扩大本质保。

警告:始终严格按照用户手册安装、维修和使用您的DVO Suspension产品。

其他权利:本质保赋予您特定的法律权利,在不同的州,您还享有其他不同的权利(仅限美国)。

适用法律:由本协议或使用本DVO Suspension产品引起的任何争议,将受美国法律管辖,并由加州法院裁定。

DVO SUSPENSION INC.

29033 Ave. Sherman Suite 203
Valencia CA, 91355 USA

910700-17