

SPINDLE and SKI, INSTALLATION

- **FOR:** Installing the XFR spindle and ski assembly onto the motorcycle.
- **FITS:** XFR Snowbike kit

NOTE: When installing your snowbike kit, it is best to install the spindle and ski assembly first before installing the rear track kit.

INFO: This spindle system is completely universal to all dirt bikes with a 47, 48 or 49mm fork tube diameter. There are no fitment parts needed to install. The spindle will self-adjust to your bike as it is installed. Once installed, there are no additional adjustments. It will only fit on one way.



BIKE DISASSEMBLY:

1. **TEAR DOWN:** Place an adjustable stand under the skid plate and lift up the front of the bike. Remove parts in this order - 1st Fork guards. 2nd Front wheel. 3rd Brake system.

NOTE: You will not be reusing these parts. You will be reusing the wheel axle and nut.

INSTALL THE SPINDLE BODY:

2. Slightly loosen the (6) axle clamp bolts on the spindle just enough to slide the axle through. Place the spindle up to the forks and slide in the factory axle bolt and install the nut finger tight. Tighten the factory axle pinch-clamp bolts on each fork leg. Torque to the factory spec. Next, torque axle bolt nut to the factory spec. NOTE: Do not yet tighten the axle clamp bolts on the spindle. Make them only finger tight. Let the spindle hang there while working on step 3.

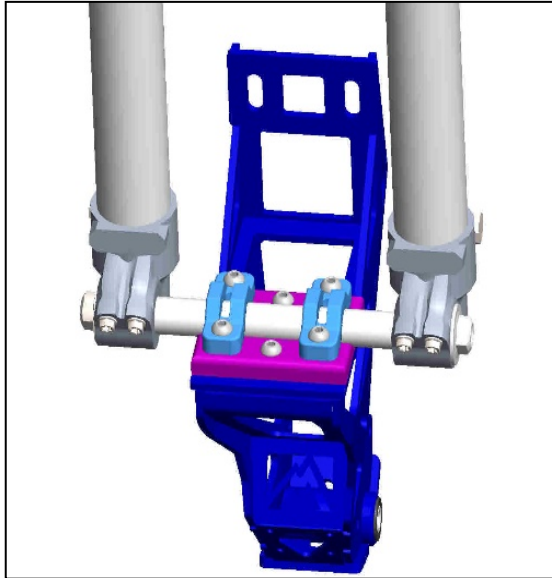

INSTALLING THE FORK CLAMPS & SUPPORT BAR:

3. Disassemble the fork clamp assembly from the packaging. Place the fork clamps onto the fork tubes with the seal reliefs facing up. Place the aluminum half of the clamp on the front side of the fork tubes and the plastic half on the back side. Place the support bar onto the back side of the fork clamps with the brake bracket cut away on the left side. The cut away will fit around the factory brake bracket on the left fork and will only fit on one way. Place the (4) M8 x 60mm long bolts into their holes on the back side of the support bar and thread them into the fork clamps. NOTE: you will need an extended reach 5mm allen/hex key or socket. Make them only finger tight. Center the support bar by looking at both ends to make it even. This will set the centering position of the spindle once attached. Ensure that the fork clamps are positioned as low as they will go on the fork tubes. They should be sitting on the fork base evenly on both sides. Tighten the (4) fork clamp bolts. There is no torque spec for these bolts. Tighten them so that they are firmly snug. Go over them several times to ensure that they are evenly tightened. IMPORTANT: Retighten the fork clamp bolts gain after first ride.

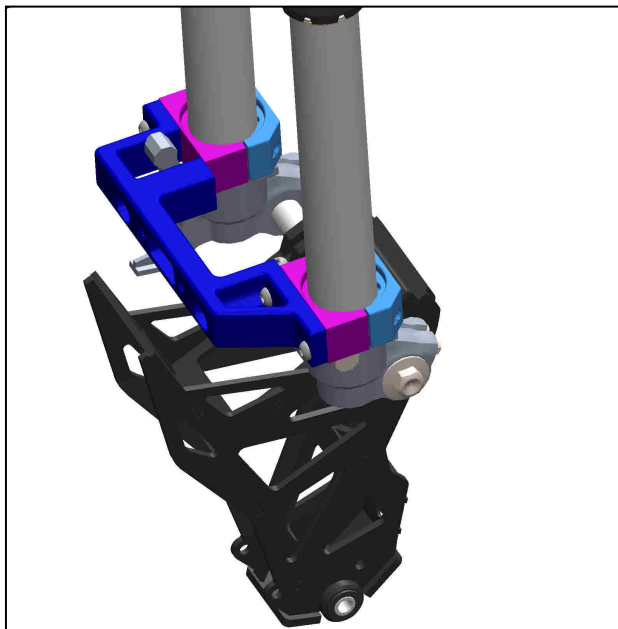

ATTACH SPINDLE TO THE SUPPORT BAR:

4. With the (6) axle clamp bolts only finger tight, rotate the spindle into position and thread in the spindle/support bar bolts (2) M10 x 25mm long socket-head bolts with washers. Make them only finger tight. Square up the spindle to the back side of the support bar. The axle clamp assembly will self-position by sliding in the slotted holes. Next, lightly tighten the axle clamp bolts to firmly seat the assembly before final tightening. Make sure the assembly is situated. Then tighten the (2) spindle/support bar bolts. Torque to 50 FT-LB.
Then finish tightening the (6) bolts on the axle clamp assembly. Torque them to 20 FT-LB. Go over them several times to ensure that they are evenly tightened.



INSTALL FORK GUARDS:

5. Place each fork guard into position onto the front fork clamp and install (2) M8 x 14 mm long button-head bolts into each fork guard. Use Red Loctite on the threads. Torque to 20 FT-LB.

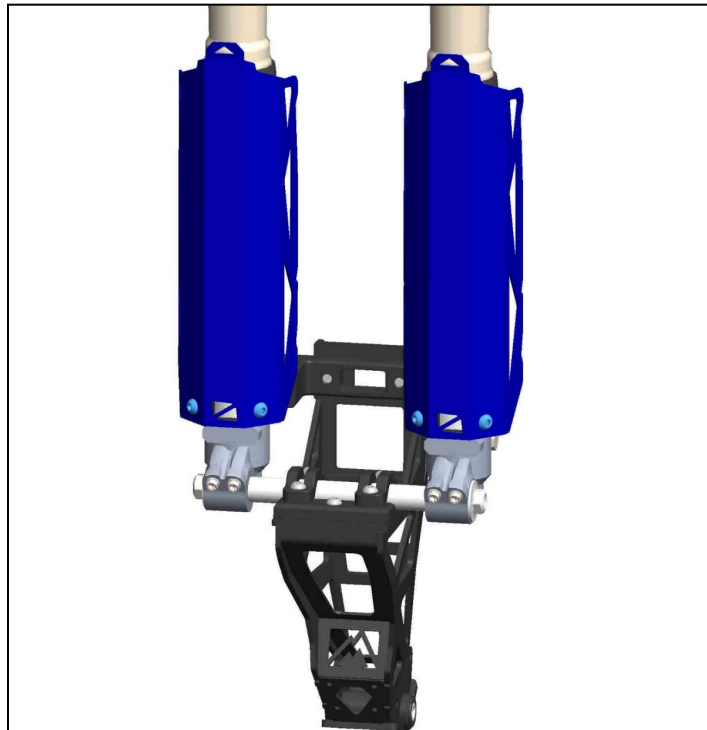

INSTALL SKI:

6. Place the ski onto the spindle and let it sit on the ski-rubber. The thick side of the ski-rubber goes toward the front of the ski. Install a large diameter washer on each side, grease the ski bolt and slide it in. Finish by installing the nylock-nut and torquing it to 40 FT-LB.

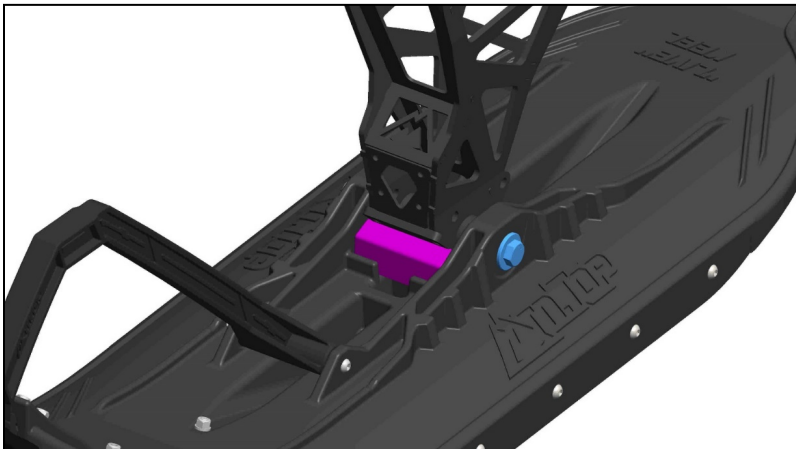

INSTALLING THE FORK GUARD GRAPHICS:

7. Your dealer may have already done this step but if not follow these steps. Wash your hands before installing. Clean the surface where each decal will be placed. Start at the top and peel a small portion of the backing off. This way you can place the graphic and maneuver more easily without it sticking where you do not want it to. Then peel off the remaining amount of backing and finish applying the decal. NOTE: Take note that there is a left and right sticker with the MAKE THE LINE slogan.



IMPORTANT (final inspection):

- Go over the entire assembly to ensure everything is tight and properly situated.
- After the first ride you will need to retighten the (4) fork clamp bolts to ensure that they have not loosened up. They sometimes loosen up as the plastic cushion clamp settles.