

1 Warning

Read user manual in full before use

This user manual provides important and necessary safety, performance and maintenance information. We ask you to read this manual thoroughly before taking your first ride or allowing any child to ride their new balance bike. Always follow all the instructions in the user manual. Please keep the manual for future reference.

1. The Hoozar bike requires adult assembly according to this manual.
2. Regularly check that the wheels, handlebars, break and saddle are securely fastened and avoid any movement during use.
3. Continuous adult supervision is required.
4. The Hoozar balance bike must only be used by one child from the ages of 18 months plus. The maximum weight load is 30kg.
5. The rider should always wear a properly adjusted helmet, any necessary protective clothing and sturdy shoes at all times when using the balance bike. Gloves are always a good idea.
6. The Hoozar balance bike is not a road vehicle and must not be used on public roads. he Hoozar balance bike must never be used near roads or other areas of danger including but not limited to steps, stairs, sloped driveways, motor vehicles, hills, alleys, or swimming pool areas etc.
7. The Hoozar balance bike is intended for use on level and solid ground only. It must not be ridden on steep ground, or downward slopes. Ride only in sufficient daylight.
8. Riding is hard work and children should be physically able to control the bike. The child must be able to control their speed at all times. Mastering the use of the brake in any given hazardous situation is necessary for the brake to be efficient. Parents should teach their children how to use the brake, until the child has acquired the appropriate braking skills. Different surfaces and traction, and varying hazardous situations require the controlled application of braking power.

1

2 Adjust Handle bars

1. Remove all protective packaging from the bike
2. Twist the handlebars so they are at a right angle to the front week and make sure the brake lever is on the left hand side if you were riding the bike

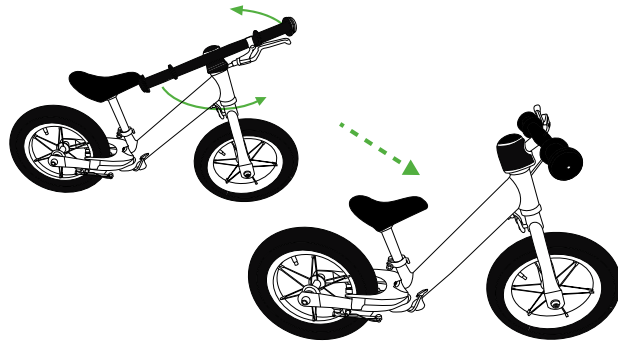

3. Remove the protective neoprene cover (A) and use the allen key provided (B) to tighten the top bolt (C). Don't over-tighten the bolt. If you do, it may damage the bearings. The handle bars should still turn smoothly.

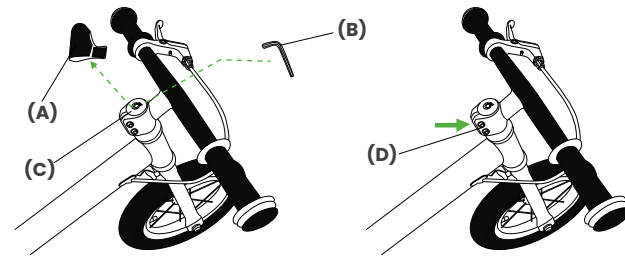

2

4. Use the Allen key to tighten the side bolts insert (D) alternately until they are secure. It's important to do it alternately so both bolts are fully tightened
5. Put the protective neoprene cover back on
6. Before riding test the handlebars are held in place by twisting them side to side. If the handlebars are not secure repeat steps 3 to 7.
7. If the child is a novice at riding balance bikes then attach the steering restrictor to the fork. As your child progresses this can be removed.

3 Adjust the seat

8. The seat should be set at the highest point that the rider can comfortably put both feet flat on the ground.

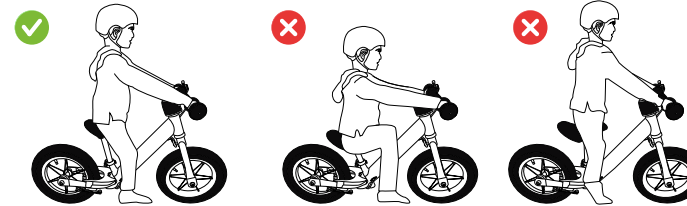

9. Careful not to exceed the maximum seat height of 0.

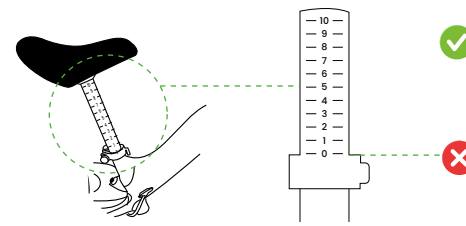

3

10. The quick release seat clamp (E) should be tight to ensure the seat doesn't move. The clamp should be pushed all the way in so it's flush with the clamp collar (F)

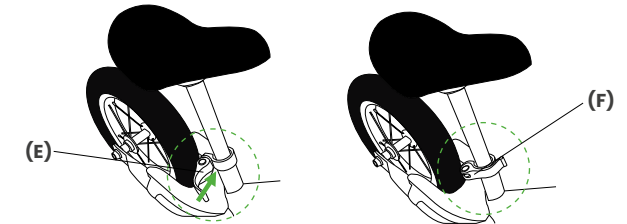

11. If the clamp is too tight or too loose then turn the nut to adjust the tightness (G).

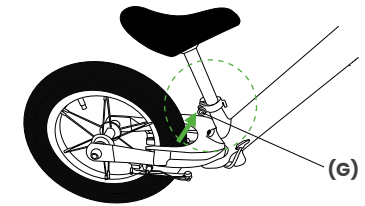

12. If the seat height is set to one of the lowest setting i.e. 8 or above, then ensure the terrain is flat enough so the seat post do not catch on the bumps.

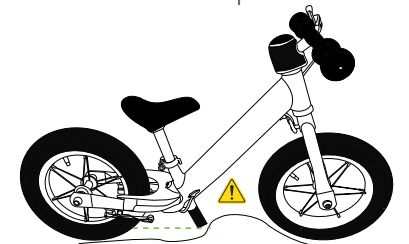

4



Register your bike to get a 3 year Warranty
Visit [Hoozarbikes.co.uk/warranty](https://hoozarbikes.co.uk/warranty). For more information



Free cycle cones
See reverse of packaging information



Win a Hoozar Goodie Bag
Share your photos & videos on social media to be in a chance to win a Hoozar helmet, gloves & Tshirt

Use hashtag #Hoozar

 @Hoozarbikes

 @Hoozarbikes

See full T&Cs at
[Hoozarbikes.co.uk/blog/goodie-bag](https://hoozarbikes.co.uk/blog/goodie-bag)

4 Tyres & brakes

Tyres

The tyres use a Schrader inner tube with the caps removed as the caps can be a choking hazard. The tyres should be pumped up and ready to use however it is important to check them before the first use to ensure the pressure is between 35-50 PSI (2.5-3.5 BAR)

Brakes

One of the most important safety features of your Hoozar bike is the brake. You should check the brake on a regular basis and especially if the bike hasn't been used for quite some time. When the bike arrives follow the steps below, if the bike doesn't pass any of the steps please go to [Hoozarbikes.co.uk/help](https://hoozarbikes.co.uk/help) for tips and tricks on how to adjust the brakes.

1. When the bike arrives give the brake lever a few pulls to check it is working. If the brake lever touches the handle bars then visit [Hoozarbikes.co.uk/help](https://hoozarbikes.co.uk/help) for tips and tricks on how to correct them.
2. Check the brake pads are making contact with the rim rather than the tyre when you pull the brake lever.
3. Check the wheel spins freely when the brake lever IS NOT pulled. The brake pad shouldn't touch the rim or the tyre.

5 Maintenance & liability

Maintenance

Your Hoozar bike will perform better, safer and last longer if the bike is well maintained. We recommend the following

- Brake cable - Oil weekly or after washing or rain
- Wheel bearings - Grease every 6 months

Warranty

All Hoozar products are warranted to be free from defects in materials and workmanship for 12 months from the date of purchase. The frame and forks are warranted for 3 years from the date of purchase if you register your product at [Hoozarbikes.co.uk/warranty](https://hoozarbikes.co.uk/warranty). The warranty only applies when the product is used as intended, under normal conditions and does not apply to damage caused by wear and tear, accidents, water, misuse or neglect. In all cases the warranty is limited to the value of the product. This does not affect your statutory rights.

Liability

The manufacturer and its agents accept no responsibility or liability for death or personal injury except where proven to be as a result of the negligence of the manufacturer or its agents. The manufacturer and its agents accept no responsibility or liability for damage to property or any other loss sustained as a result of possession of or use of the product, whatever the reason or cause, to the fullest extent permitted by Law



Hoozar

Cruz 12 Balance Bike User Manual

 Free kids colouring poster
inside this user manual