

BarumiTM
www.barumiusa.com

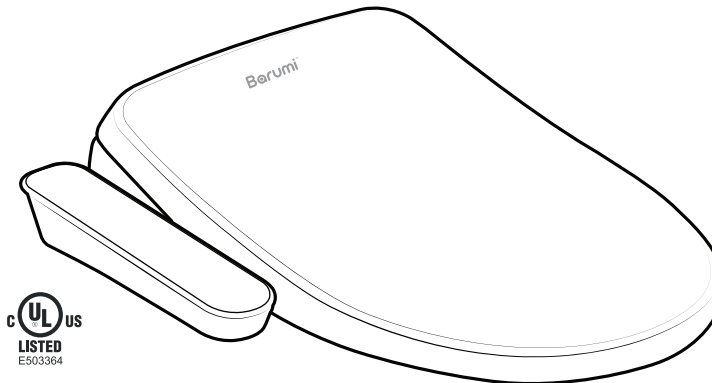

USER MANUAL

EF-BM-4000 • EF-BM-4001

TABLE OF CONTENTS

Safety Instructions	1	Operation Guide	10
Grounding Instructions	3	Maintenance	11
Before You Begin	4	Troubleshooting	12
Installation Procedure	6	Specifications	14
Parts List	9	Warranty	15

- This product is solely intended for households or household-like environments.
- Read all instructions and guidelines thoroughly before installation.
- User should have access to this User Manual at all times during installation and operation.
- For product improvement, designs and specifications are subject to change without prior notice.

SAFETY INSTRUCTIONS

Read all instructions thoroughly before using this product.

DANGER

Negligence, improper use or improper installation of this product may result in electrocution.

- Do not use while taking a bath.
- Do not place or store the product where it can fall or be pulled into the tub or sink.
- Do not submerge the product.
- If the product becomes submerged, unplug it immediately.
DO NOT REACH INTO THE WATER.

WARNING

Any negligence, improper use or improper installation of this product may result in fire, serious injury, death and/or property damage.

- If the power cord is damaged, contact Easyflex for a replacement.
- This product must be connected to a properly grounded electrical outlet.
- This product must be unplugged during installation and maintenance.
- Do not touch the power plug with wet hands.
- Properly connect the power cord to a 120V electrical outlet.
- Keep the cord away from heated surfaces or hot objects.
- Do not operate this product using a damaged or compromised power cord.
- Before removing the unit from the toilet bowl, disconnect the power cord.
- Do not connect other electrical appliances to the same power outlet as this product.
- This product is not a toy. Please make sure children do not play with this product.
- This product is not intended for use by children, the elderly, and the disabled without close supervision.
- Never block the air vents of this product or place it on a soft surface, such as a bed or couch, where the vents may be blocked.

- Keep the air vents free of lint, hair, dust, etc. so air can pass unobstructed.
- Please do not dismantle or take apart this product on your own.
- Do not sleep while sitting on this product. Do not use this product if you are sleepy, drowsy, or on heavy medication.
- Never drop or insert anything into any of the openings or the hose.
- This product is not intended for outdoor use, indoor use only.
- Do not pour heavy amounts of water onto this product.
- Do not use a steam cleaner on this product.
- Keep the unit away from fire or flammable substances.
- Do not use grey water or industrial water as the water supply.
- Be careful for low temperature burns.

CAUTION

Any negligence, improper use or improper installation of this product may result in damage, serious injury, death and/or property damage.

Do not place heavy objects or step on the unit. It can cause product damage or injury.

- To clean the product or remove stains, use a soft, moist cloth with mild detergent. Spraying water or chemical solutions directly onto the product, or the use of harsh scrubbers can cause damage to the product and should be avoided.
- Do not slam down the lid as it may cause damage to the product.
- Do not lean on the lid as it may cause damage to the product.
- If the product has not been used for a long period of time, disconnect the power plug and drain the water tank (old tank water can result in skin irritation).
- Do not twist or pull the connection hoses as it may affect the water supply or cause leakage.
- Do not cover the warm air outlet or insert hands or objects into it. It may cause a burn or electric shock.
- Do not operate the unit if it is malfunctioning, as it may cause a fire or electric shock. Disconnect the power plug and call Easyflex.

GROUNDING INSTRUCTIONS

WARNING

Improper use of the grounding plug can result in an electric shock.

- Use a nominal 120V circuit and GFCI (Ground Fault Circuit Interrupter) outlet.
- Do not use a power supply or wiring equipment beyond its specified rating.
- Do not connect multiple electrical products to the same outlet as the bidet.
- Do not use an ungrounded outlet or extension cord for this product.
- It is imperative that a properly grounded outlet is used. If you are unsure with grounding or don't have a GFCI outlet, contact a qualified electrician to have one installed.

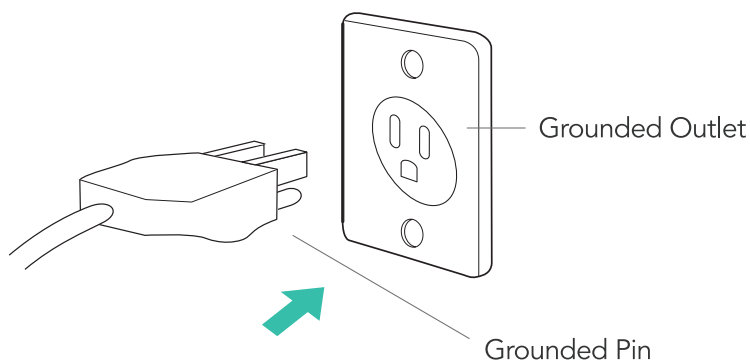

BEFORE YOU BEGIN

WHAT TO EXPECT DURING INSTALLATION THE 3 MAIN STEPS.

STEP 1 PREPARE!

REMOVE THE CURRENT TOILET SEAT

Find the bolt caps at the back of the seat and open them if they're closed.

Next, firmly grip the nut that is fastened to the end of the bolt and begin turning the bolt counterclockwise to unfasten the seat. In some cases, if the nut has wings, you can turn the nut while holding down the bolt.

Depending on your toilet seat, you may need to use a phillips screwdriver and a wrench.

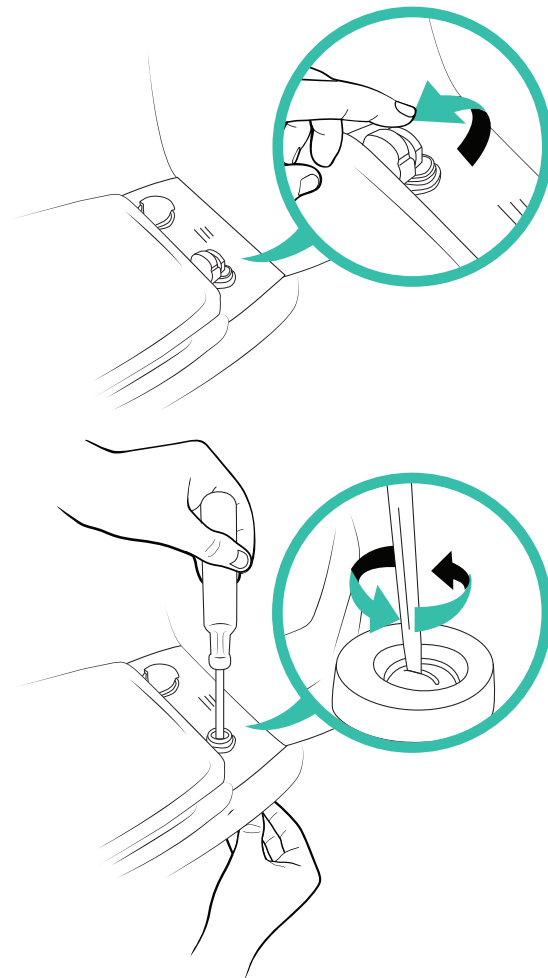

CHECK FOR MISSING PARTS

To ensure your installation is worry-free, please make sure you have all the necessary parts from the factory by referencing the parts list. Set each part aside so you can easily access them during installation.

STEP 2 INSTALL THE POSITIONING BRACKET FIRST!

THE POSITIONING BRACKET MUST BE INSTALLED PROPERLY

Before installing the bidet seat, it is imperative the positioning bracket is installed first AND properly. If this bracket is not positioned and installed properly, your bidet seat will not be aligned with your toilet.

POSITIONING BRACKET

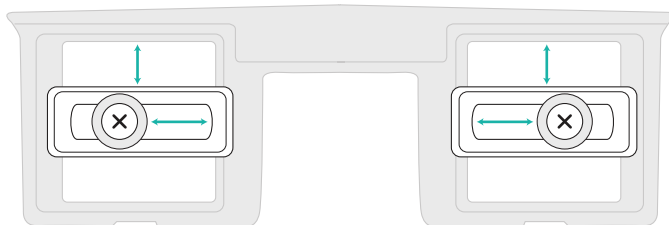

PLEASE NOTE: Your positioning bracket setup may look different from the image above. Please make sure each screw is spaced inside the frame identically to each other.

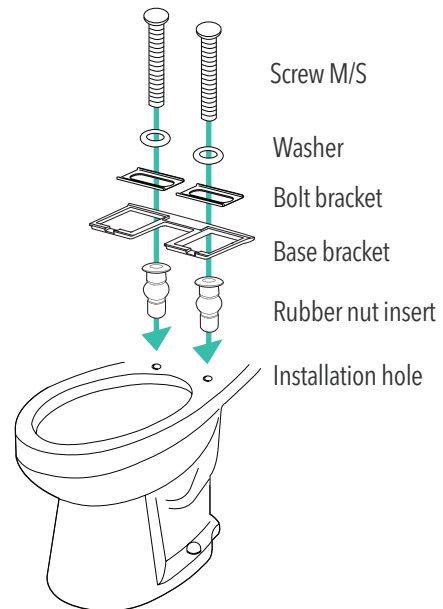

STEP 3 CONNECT THE POWER!

CONNECT TO YOUR BATHROOM OUTLET (BEST OPTION)

If your bathroom is equipped with a grounded electrical outlet (GFCI), plug your power cord into it to turn the bidet on.

OUTLET NOT AVAILABLE

If your bathroom is not equipped with a grounded electrical outlet, an extension cord may be used to connect the power cord to a GFCI outlet. Please use a grounded extension cord.

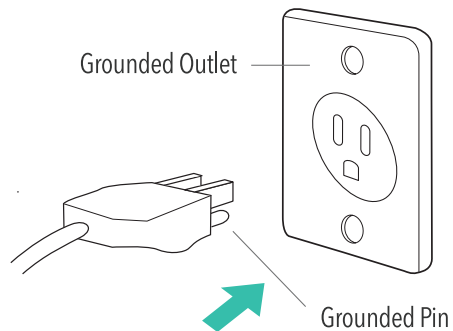

INSTALLATION PROCEDURE

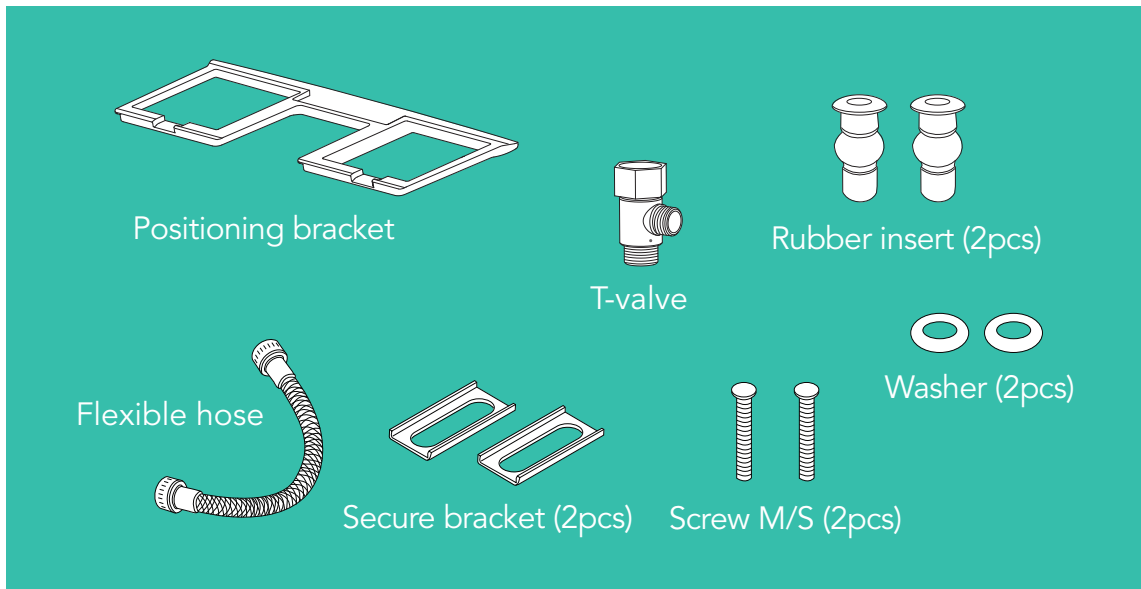

BEFORE INSTALLATION

For optimal performance, please install the product after reading the installation manual thoroughly.

Plug in the water supply only after installation is complete.

01 Separate water supply hose

- 1 Shut off the water valve.
- 2 Drain the toilet tank.
- 3 Disconnect the hose.

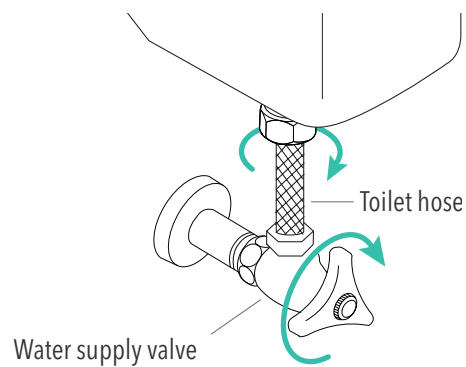

02 Remove the existing toilet seat

Unfasten the nut and remove the toilet seat.

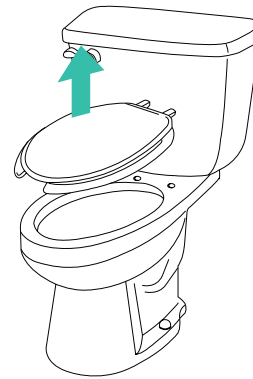

03 Connect the T-valve

Install the T-valve as shown.

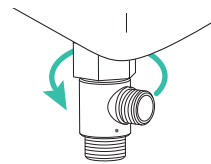
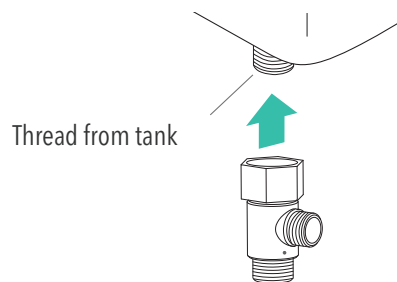

04 Insert the base bracket

- 1 Firmly push the rubber insert into the toilet seat hole.
- 2 Align the positioning bracket with the toilet seat hole.
- 3 Install the following parts to the positioning bracket, in this order: secure bracket, washer, screw M/S.
- 4 Tighten the screw M/S with a screwdriver after making sure the positioning bracket is aligned.

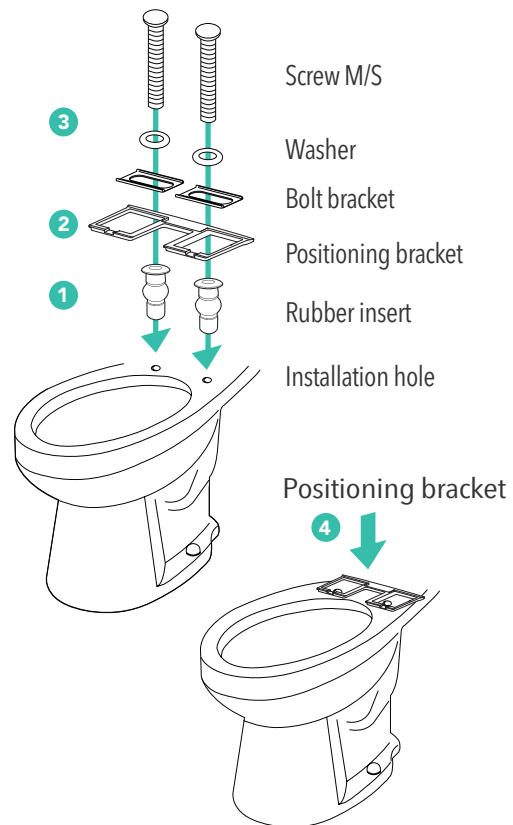

05 Insert bidet body

Insert the main bidet body into the groove on the installed positioning bracket until the fastening hooks “click”.

To remove the bidet body from the positioning bracket, simply pull the lever to unhook the fasteners and pull the bidet body off.

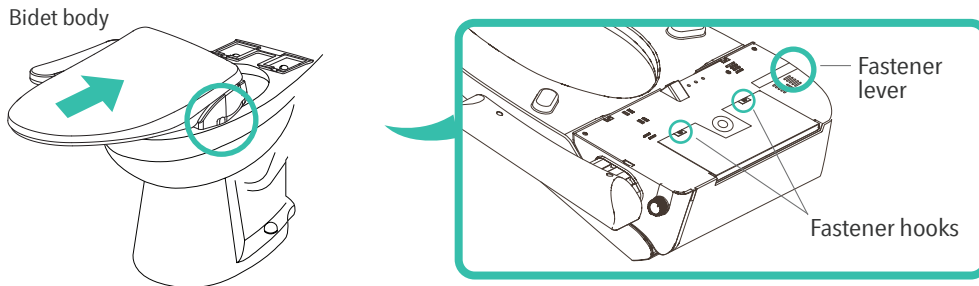

06 Connect the flexible hose

Connect the flexible hose to the T-valve and the main body.

Turn the water supply valve counterclockwise to allow water flow.

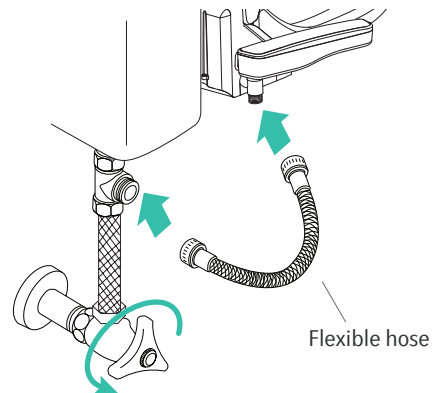

07 Connect the power cord

Plug the power cord into a grounded electrical outlet. If there is no outlet, use a grounded extension power cord.

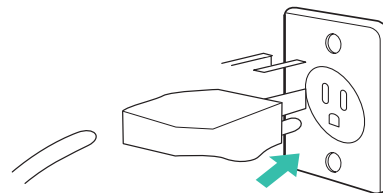

OPERATION CHECK

1. Turn the water supply valve counterclockwise to check for water leakage.
2. Connect the power plug into the electrical outlet.
3. Check the operation of each function.

PARTS LIST

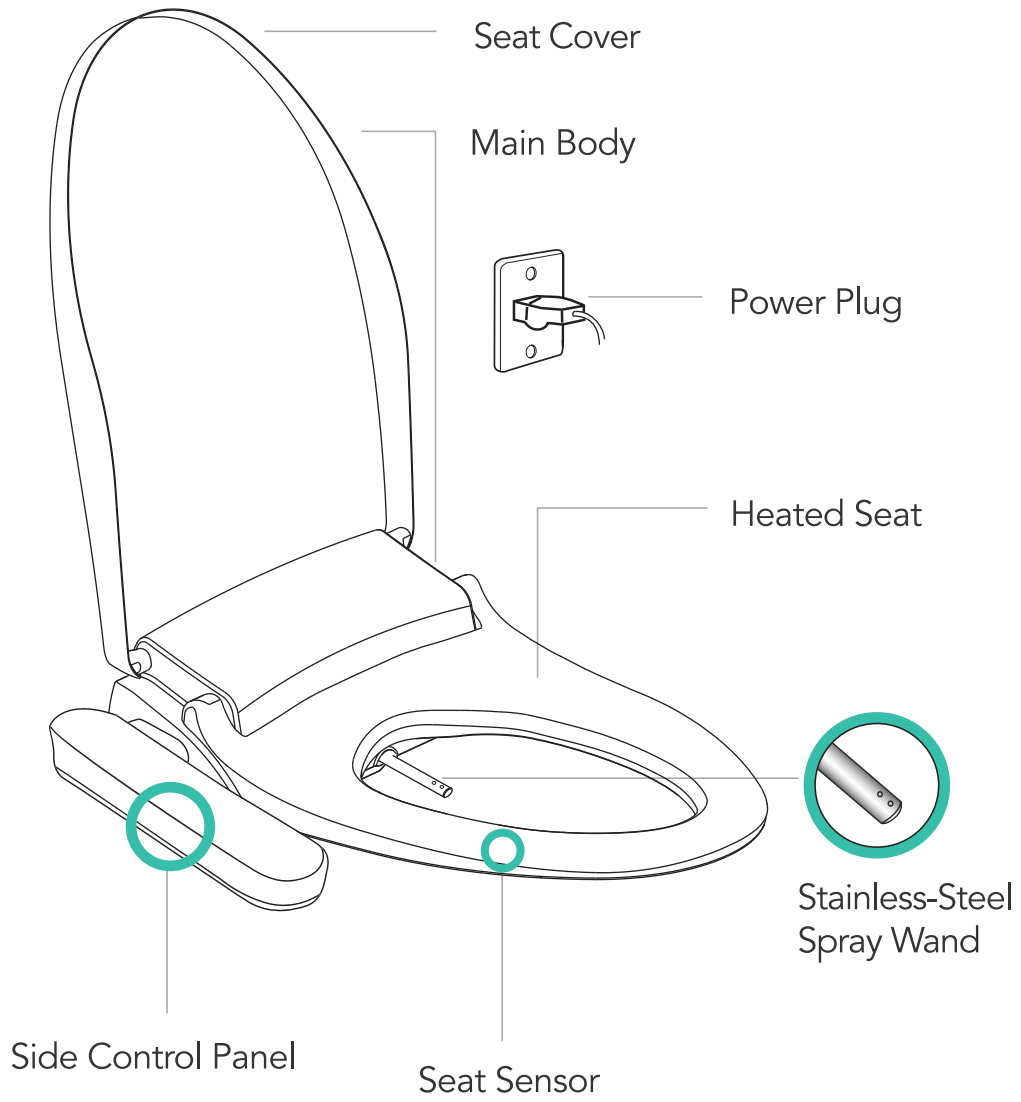

OPERATION GUIDE

STOP

- Press to stop the operation

WASH / Move

- Press once for rear cleaning
- Press twice for spray wand oscillating movement for massaging effect
- Press again to stop cleaning function

BIDET / Move

- Press once for front cleaning for ladies
- Press twice for spray wand oscillating movement for massaging effect
- Press again to stop cleaning function

MULTI

- Press for pulsating cleaning with the water pressure pulsating from strong to soft

DRY

- Press for gentle air drying which lasts for 3 minutes

MASSAGE

- Press during the WASH/BIDET function for pulsating cleaning for a massaging effect
- Press again to stop

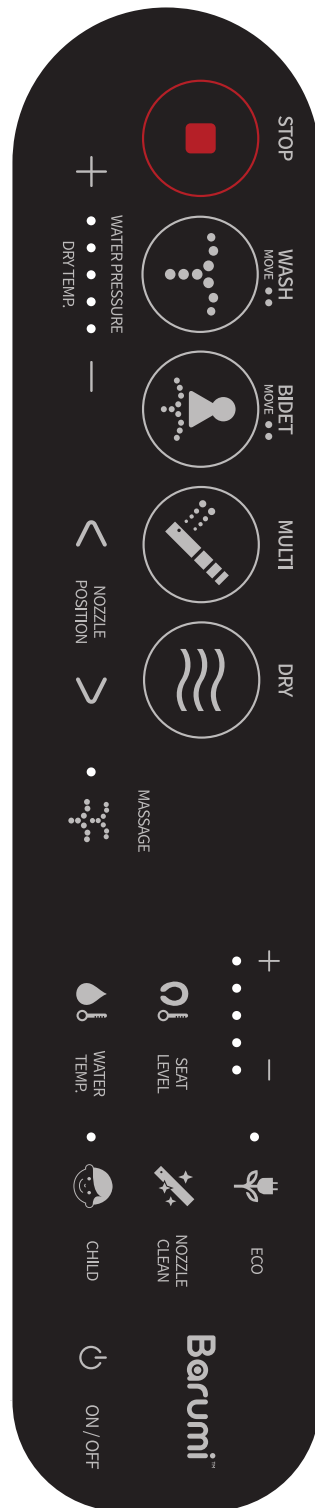

WATER PRESSURE/ DRY TEMPERATURE

- 5 levels of water pressure and dry temperature

SPRAY WAND POSITION ADJUSTMENT

- Controls spray wand position between the front and the rear

SEAT TEMP. (LEVEL) / WATER TEMP.

- 5 levels of water temperature and seat temperature

ECO

- Cuts off the power to the water and seat heaters. Also minimizes power use.

NOZZLE CLEAN (WAND)

- Press to clean the spray wand. Extends out when cleaning and retracts back to its original position after cleaning.

CHILD

- The WASH / BIDET / DRY functions will operate without user detection on the seat

ON / OFF

- Press the button to turn ON or OFF
- ON (short press)
- OFF (press more than 3 seconds)

MAINTENANCE

Power Saving Mode

- Press the ECO button to save energy while the product is not in use.
- Press the ECO button once for general saving mode (green LED light will turn on) and to maintain the preset temperature for 30 minutes after standing up.
- Afterwards, the water heater turns OFF and the seat temperature sets to 86°F (water heater and heat seater turns OFF in 24 hours).
- Press the ECO button twice for strong saving mode (red LED light will turn on) to turn off both the water heater and seat heater.
- To deactivate Power-Save mode, press the ECO button until the LED turns off.
- In the case a user sits down while in a power saving mode, the seat sensor will turn ON, the water heater and seat heater will start working automatically to reach the preset temperature (takes 5 minutes to reach the preset temp).
- When the user stands up, the seat sensor turns OFF and the water heater and seat heater automatically returns to Power-Save mode.
- Washing and drying functions will work under Power-Save mode.

Spray Wand Cleaning*

- To clean manually, use a soft cloth or toothbrush to clean the spray wand.
- Do not use strong acidic or alkaline cleaners or fluoride-based detergents containing abrasive compounds.

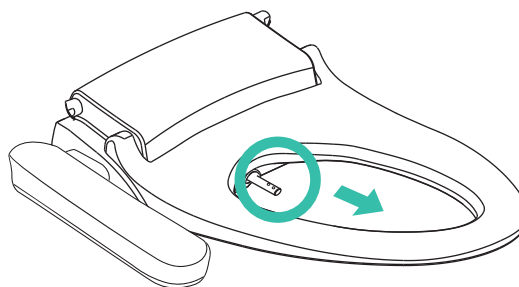

Spray Wand Auto Clean

To auto clean the spray wand, press the cleaning button when the seat is not occupied for 2 minutes.

Spray Wand Manual Clean

Press the cleaning button for 3 seconds. When the wand extends out (for 2 minutes), use a soft, damp cloth or toothbrush to clean.

*The spray wand cleaning function will not work while in Child Mode.

TROUBLESHOOTING

If the product is not operating properly, please refer to the following possible solutions.

Power Supply

Problem	Possible Cause(s)	Solution
The unit is not working	Is the power turned off? Or is the circuit breaker turned off?	Wait until the power is restored, or turn on the circuit breaker
	Is the operation lamp on the lateral control panel turned off?	Plug the power cord into the electrical outlet

WASH, BIDET, MULTI wash functions

Problem	Possible Cause(s)	Solution
Water pressure is weak	Is the water pressure too low?	Increase the water pressure
	Is the strainer clogged?	Clean the strainer
Water is cold	Is the temperature set too low or is the unit turned off?	Adjust the water temperature on the control panel
	Is it in Power-Save mode?	Press the ECO button
Water spray stops during use	Cleaning stops 90 seconds after pressing WASH/BIDET/MULTI buttons.	Press WASH/BIDET/MULTI again.
	The seat sensor isn't detecting human contact	Check the position of the seat sensor (refer to P9)



Heated Seat

Problem	Possible Cause(s)	Solution
The seat does not warm up	Is the seat temperature set too low or is it turned off?	Adjust the seat temperature on the control panel
	Is the product in Power-Save mode?	Press the ECO button



Seat Sensor

Problem	Possible Cause(s)	Solution
The Wash function operates without user detection on the seat	Is there water residue or a wet towel on the seat?	Wipe off the water residue or remove the wet towel



Power Save

Problem	Possible Cause(s)	Solution
The Power-Save function is not working	Is the product unplugged? Or is the power turned off?	Reset the Power-Save mode by pushing the ECO button on the control panel



Self Diagnosis

Problem	Indication	LED on Temperature Control	Symptom
Water supply and water level sensor malfunction		3 LED blinks	Water spray or warm water spray is not working
Water temperature sensor disconnected		5 LED blinks	Warm water spray is not working
Water temperature sensor short-circuit		4 LED blinks	WASH/BIDET functions not working
Water temperature sensor disconnected		2 LED blinks	Seat doesn't warm up
Water temperature sensor short-circuit		1 LED blinks	Seat doesn't warm up

SPECIFICATIONS



Item		Description
Model		EF-BM-4000 EF-BM-4001 MFG Model: DB-210E, DB-210R
Electrical ratings		AC 120V / 60Hz / 864W
Room temperature		32°F - 104°F
Water supply		Direct water connection
Water pressure		98~735 Kpa
Wash	WASH	Max 24 fl. oz/min
	BIDET	Max 27 fl. oz/min
	MULTI	Max 25 fl. oz/min
	Heater capacity	800W
	Water tank volume	20 fl. oz
	Water temperature	Room temperature - 104°F
	Safety device	Thermal fuse, thermostat, water level sensor
Dry	Heater capacity	250W
	Air temperature	Room temperature - 131°F
	Safety device	Thermal fuse, thermostat
Heated seat	Heater capacity	55W
	Seat temperature	Room temperature - 104°F
	Safety device	Thermal fuse
Power cord length		3.9 ft
Product dimension		18.2" x 21" x 5.5" (Elongated) 18.2" x 19.5" x 5.4" (Round)
Product weight		9.9 lbs (Elongated) 9.5 lbs (Round)

WARRANTY

PRODUCT WARRANTY CARD

- We warrant our products to be free from manufacturing defects under normal use and service for a period of one (1) year from the date of purchase. This warranty is provided to the original purchase and cannot be transferred. If the product is used for business and/or commercial purposes, the warranty period changes to 6 months.
- If the product has a defect, please contact Easyflex.

Product Name		Model Name	
Date of Purchase		Serial Number	
Name of Purchase		Duration of Warranty	1 Year Limited Warranty from Purchase

Easyflex, Inc. 1500 N. Western Blvd. Suite 280, Denton, TX 76207 **888-577-8999**