

Rectangle Flag Assembly Guide

Black and Silver Sleeves

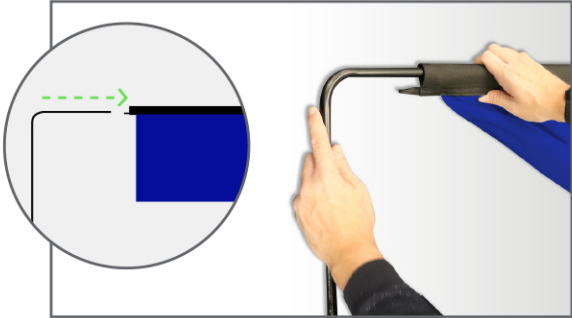

Step 1: Unpack the carry bag and assemble the flag pole by joining the separate pieces together. Simply insert one end of the pole into the other and push them together starting with the largest to the smallest. The horizontal pole (with the right angle bend) should be at the top.



Step 2: Insert the end of the horizontal pole into the bottom rod pocket of the flag fabric. Pull the fabric all the way along the horizontal pole.



Step 3: When you have reached the corner gap, continue weaving the fabric through the pole. Keep pushing the pole and pulling the fabric down until you reach the locking mechanism.



Step 4: Attach the fabric loop to the hook on the locking mechanism.



Step 5: Pull down the flag to the right tension.

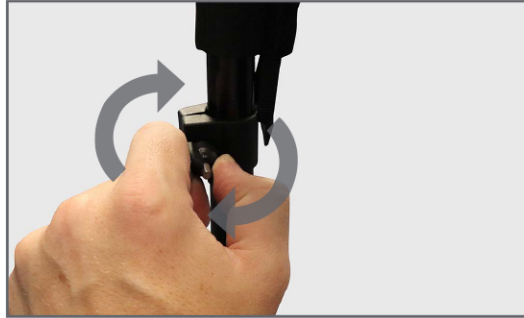

Step 6: Twist the butterfly screw to secure the locking mechanism, and you should now have a great looking Rectangle Flag.