

# RIVIAN R1T BADWATER MOLLE PANEL INSTALL INSTRUCTIONS

Begin by unpacking all components and making sure no parts are missing. If any parts are missing, please contact [sales@range-industries.com](mailto:sales@range-industries.com) and we will remedy the situation ASAP. See list of all parts below:

- 2X Aluminum Molle Panel Support Rails



- 2X Molle Panels



- 4X Mounting Brackets



- 2X Molle Panel Spacers



- 8X 5/16"-18 x 1/2" stainless steel bolts



- 8X 5/16"-18 x 5/8" stainless steel bolts



- 16X 5/16" T-Nuts



## Install Notes:

- Use blue (medium) Loctite or equivalent thread locker on all bolts

## Required Tools:

- 3/16" hex key or 3/16" hex bit with ratcheting wrench



# INSTALL INSTRUCTIONS

Begin by inserting 2x of the spring t-nuts on the inside facing channel next to each rack upright.

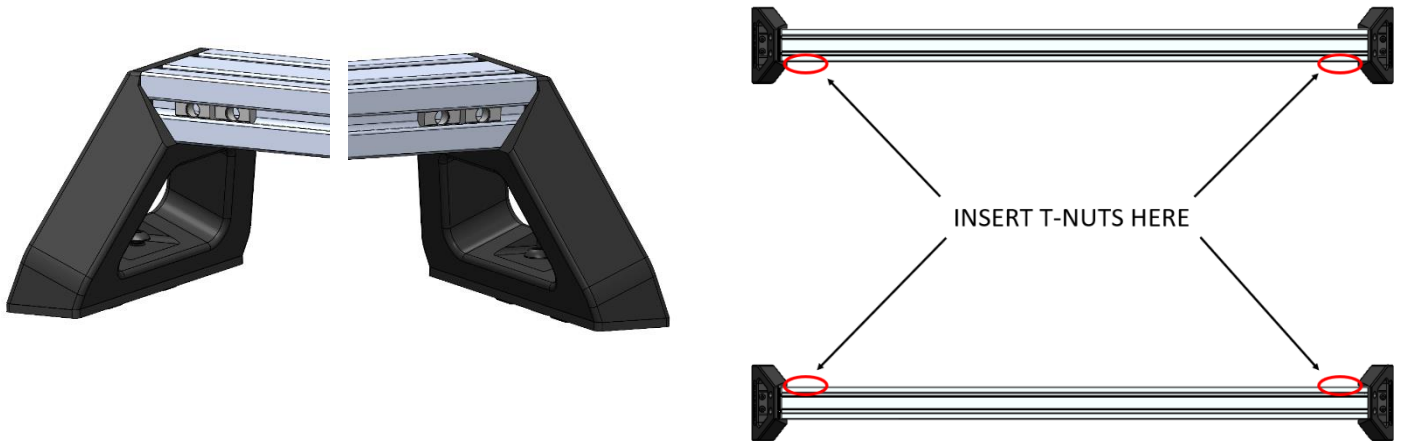

Next we are going to assembly the molle panel sub assemblies. Begin by installing 4x T-Nuts in each of the molle panel support rails.

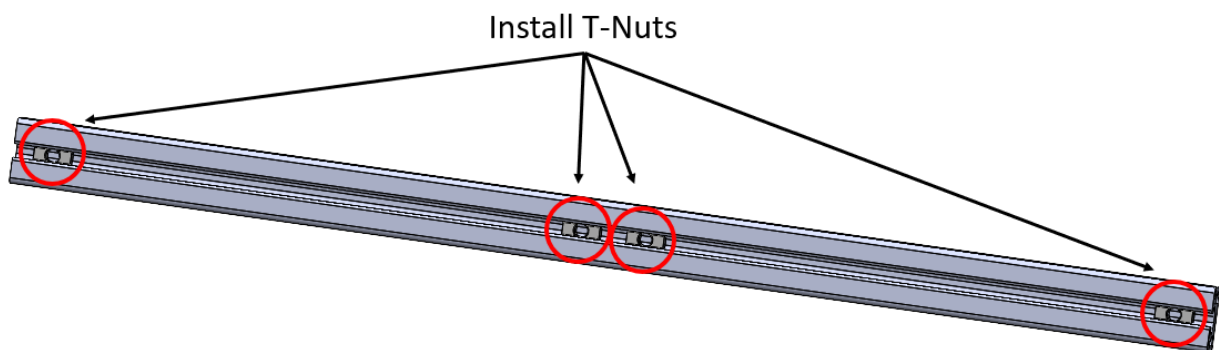

Place the rectangular spacer plate over the two center T-nuts and align the holes with the threads. Next place the molle panel (with edge bend facing down) over the rail and use 2x 5/16"-18 x 5/8"L bolts to attach the molle panel to the support rail. Leave bolts a little loose to allow for final adjustments.

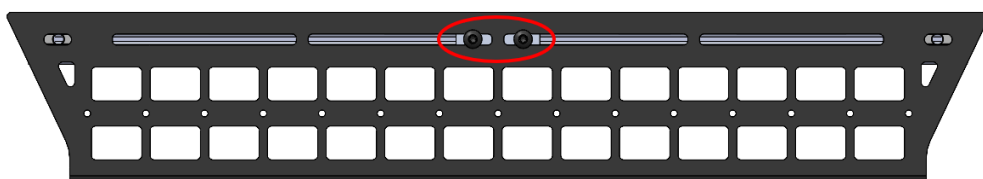
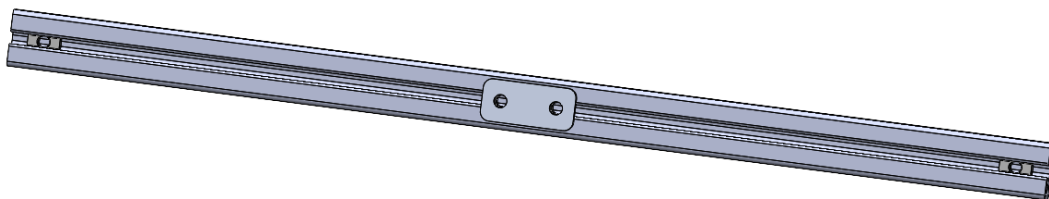

Next attach the mounting brackets to the corners of the molle panel assembly. There are two configurations of mounting bracket (mirrored) so make sure to use the correct one. Position the brackets as shown in the images below. Slide the mounting brackets between the support rail and the molle panel, and secure with a provided 5/16"-18 x 5/8"L. Leave bolts loose so the brackets can be adjusted to fit between the crossbars of the Badwater Rack when installing.

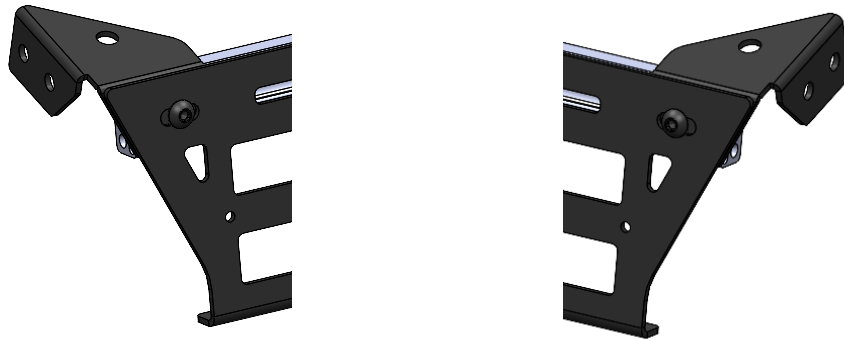
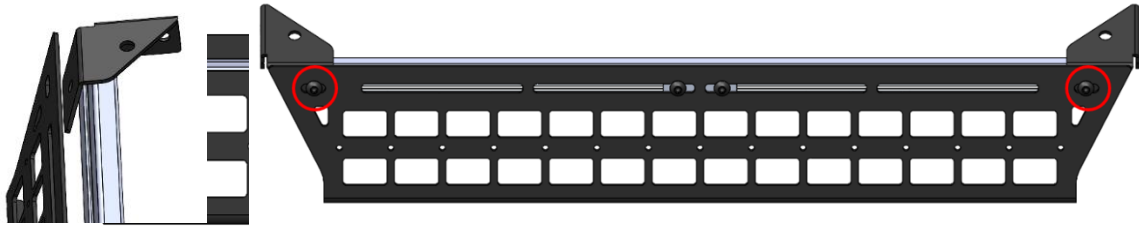

Slide the molle panel assemblies into place on the Badwater Rack, and use 2x 5/16"-18 x 1/2"L bolts at each corner of the rack to fasten them to the crossbars.

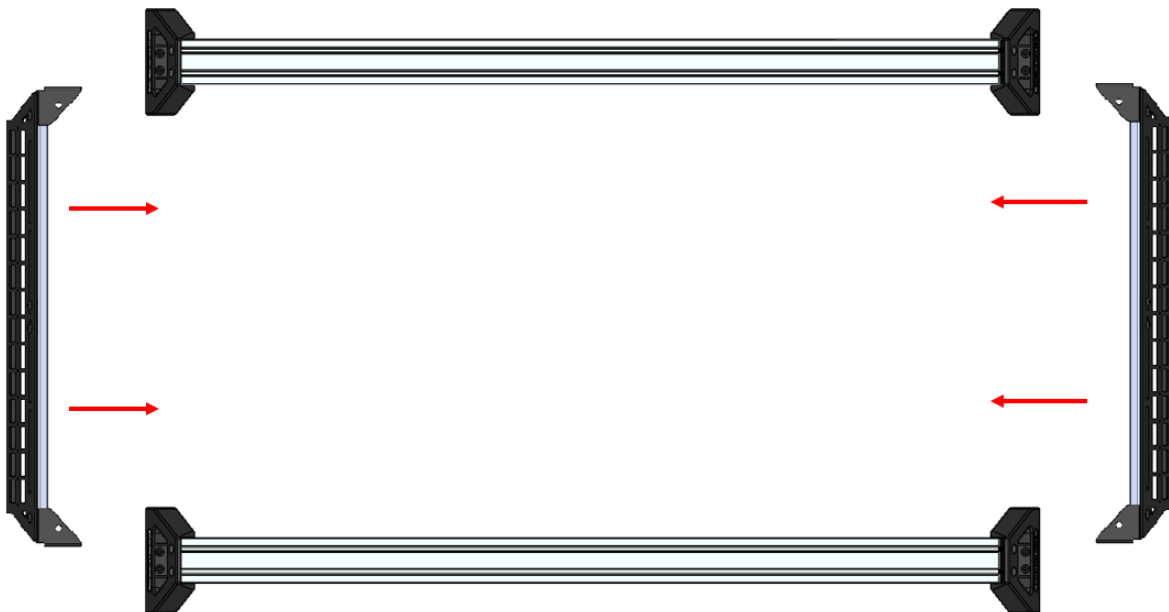

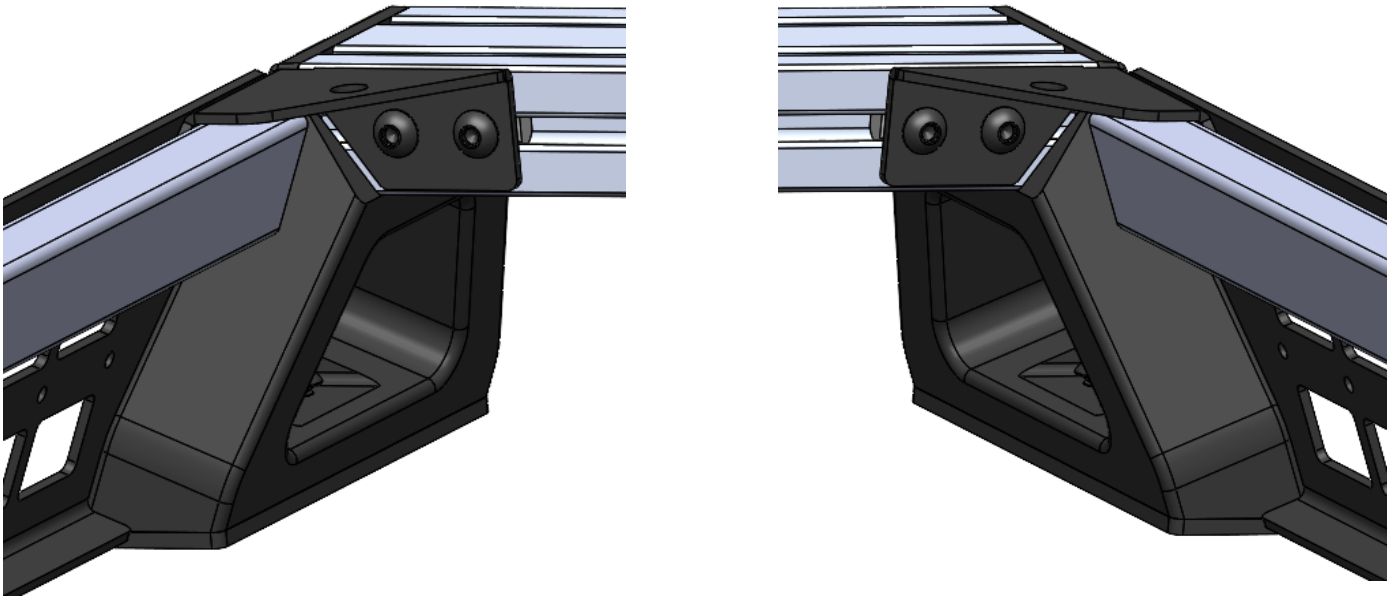

Once the molle panels are in place, center the panels between the crossbars and tighten hardware to lock the position. To finish up the install, go back and tighten all hardware that was left loose during assembly.

## **BOLT CHECK**

After driving with rack installed for 25 miles, re-check hardware to ensure none of the hardware has loosened.

