

# Single Monitor Stand with Overhead Monitor Stand

## *Assembly Guide*

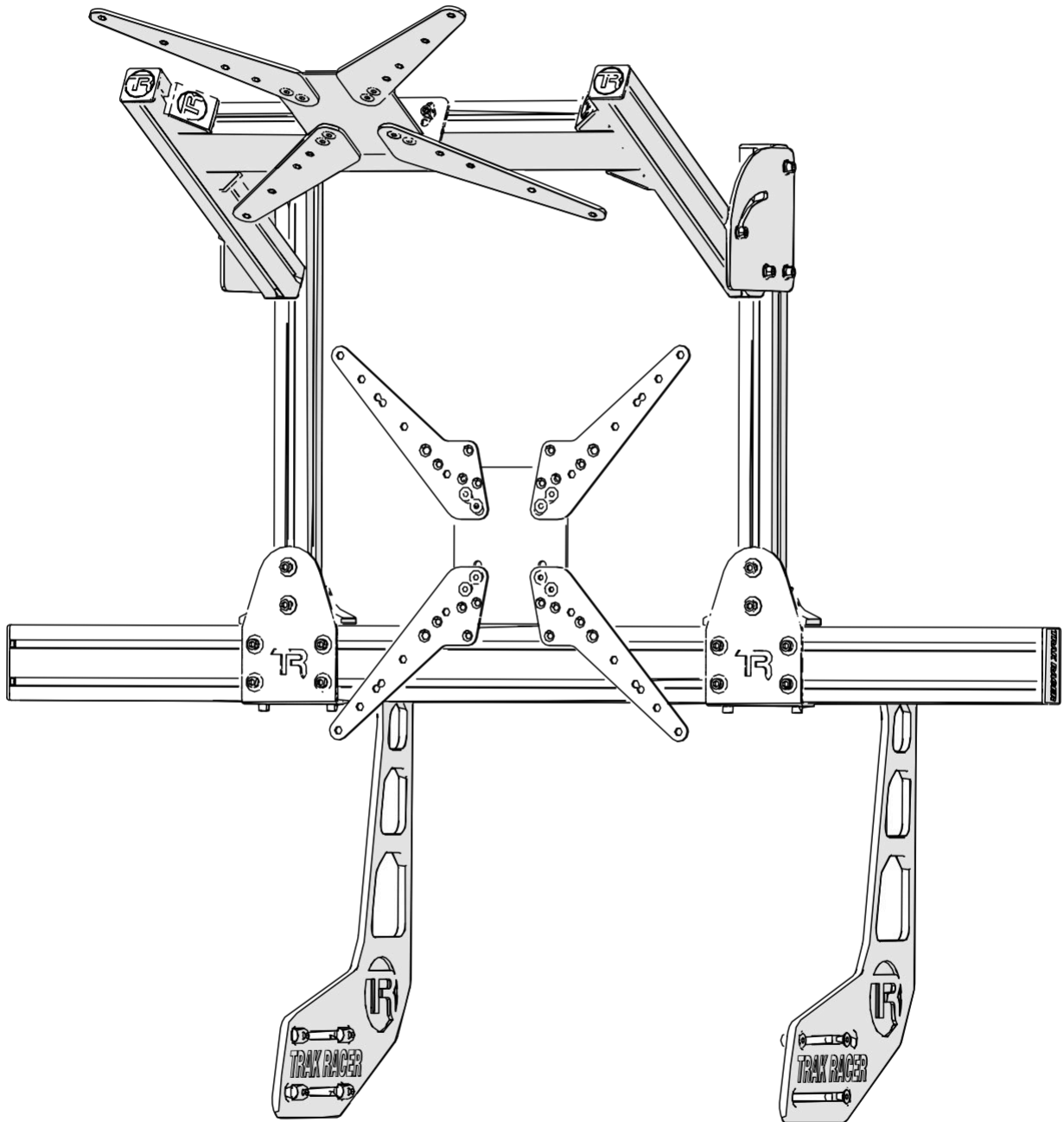

**IMPORTANT:** Different regions may have different models. Please ensure the part number below matches that on your product's box.

**MS-CM-DL2**



**TRAK RACER**

Published Apr 15, 2025

# TABLE OF CONTENTS

3 Symbol Legend

---

4 Assembly Notes

---

7 MS-CM-SIN2

12 TR80-4M4

17 MS-CM-DL2



**IMPORTANT:** Since there are different versions of each product based on your region, please make sure you are using the correct set of instructions. The part number below should match the one on your box.



**IMPORTANT:** Due to the nature of cut aluminum profiles, some metal shavings may remain despite our thorough QA cleaning process. We recommend opening boxes and packaging on a hard surface.



**NOTE:** Some screws and washers may be pre-installed. These are included in the parts list and will need to be loosened and reattached according to the instructions.



Recommended: Two people for the task



Tighten the hardware



Keep the hardware loose for adjustments

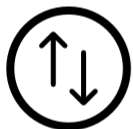

Make the necessary adjustments



Break the tab off the corner bracket



Safety glasses required



Attention/Priority needed



Reserve for the next step



Mirrored components (same on both sides)

# NOTE

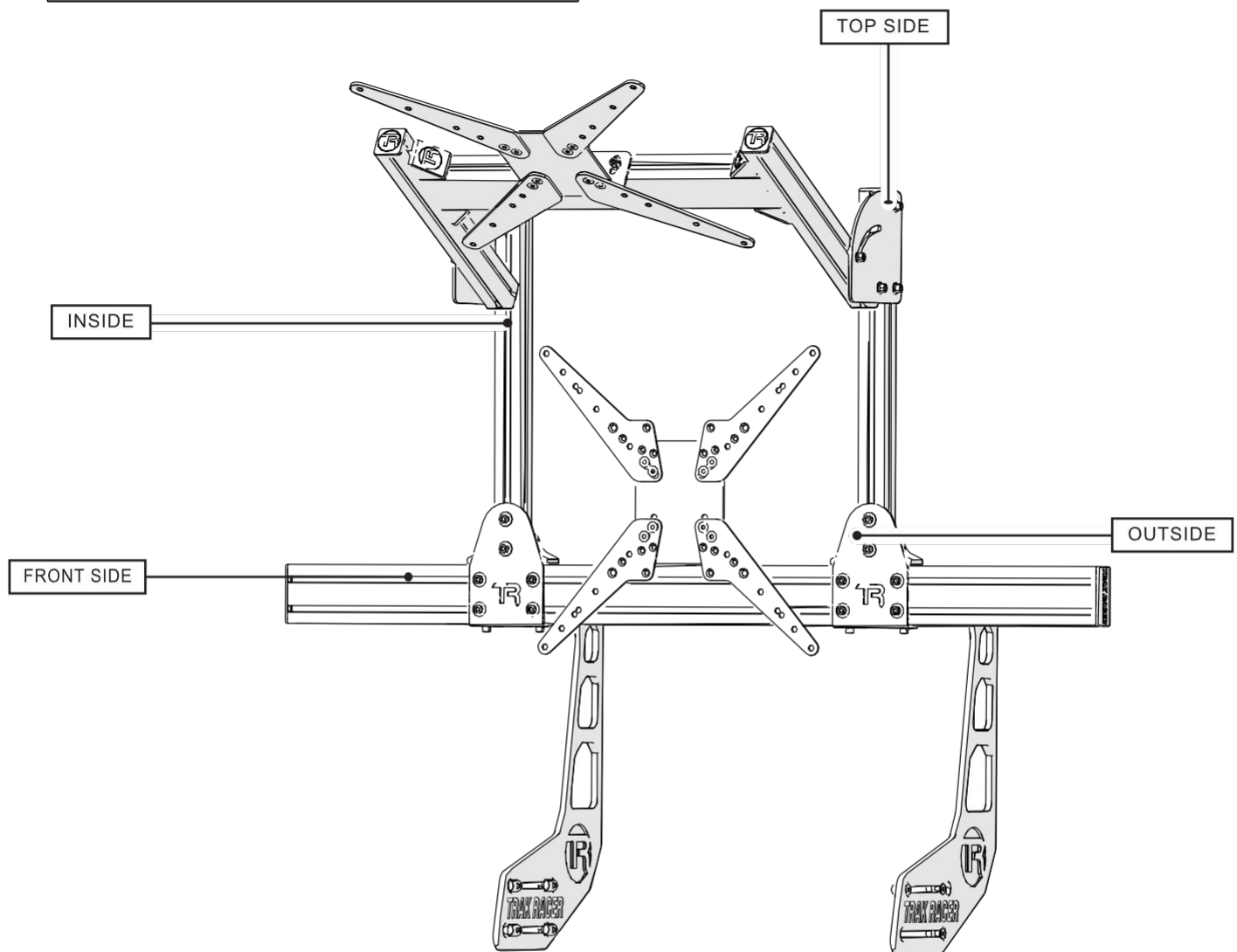

## INSTALLATION ORDER FOR SCREWS & WASHERS

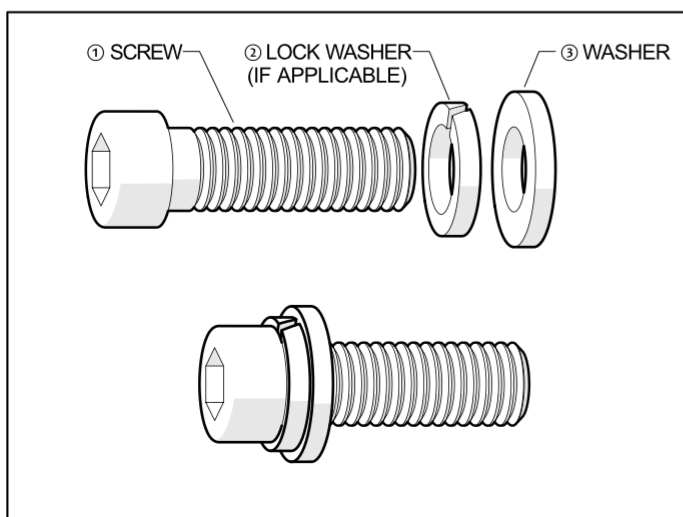

## HOW TO MEASURE SCREWS

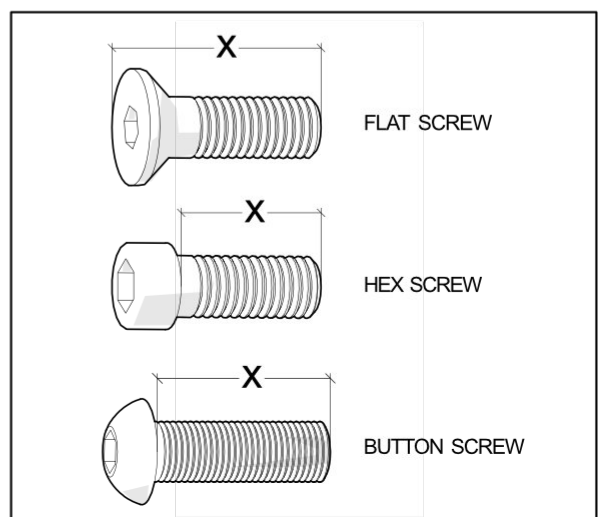

# NOTE

## NS-M8 & NS-M6

Slide T-Nuts into the ends of the profiles. Some must be added early, so follow the steps in this manual carefully.

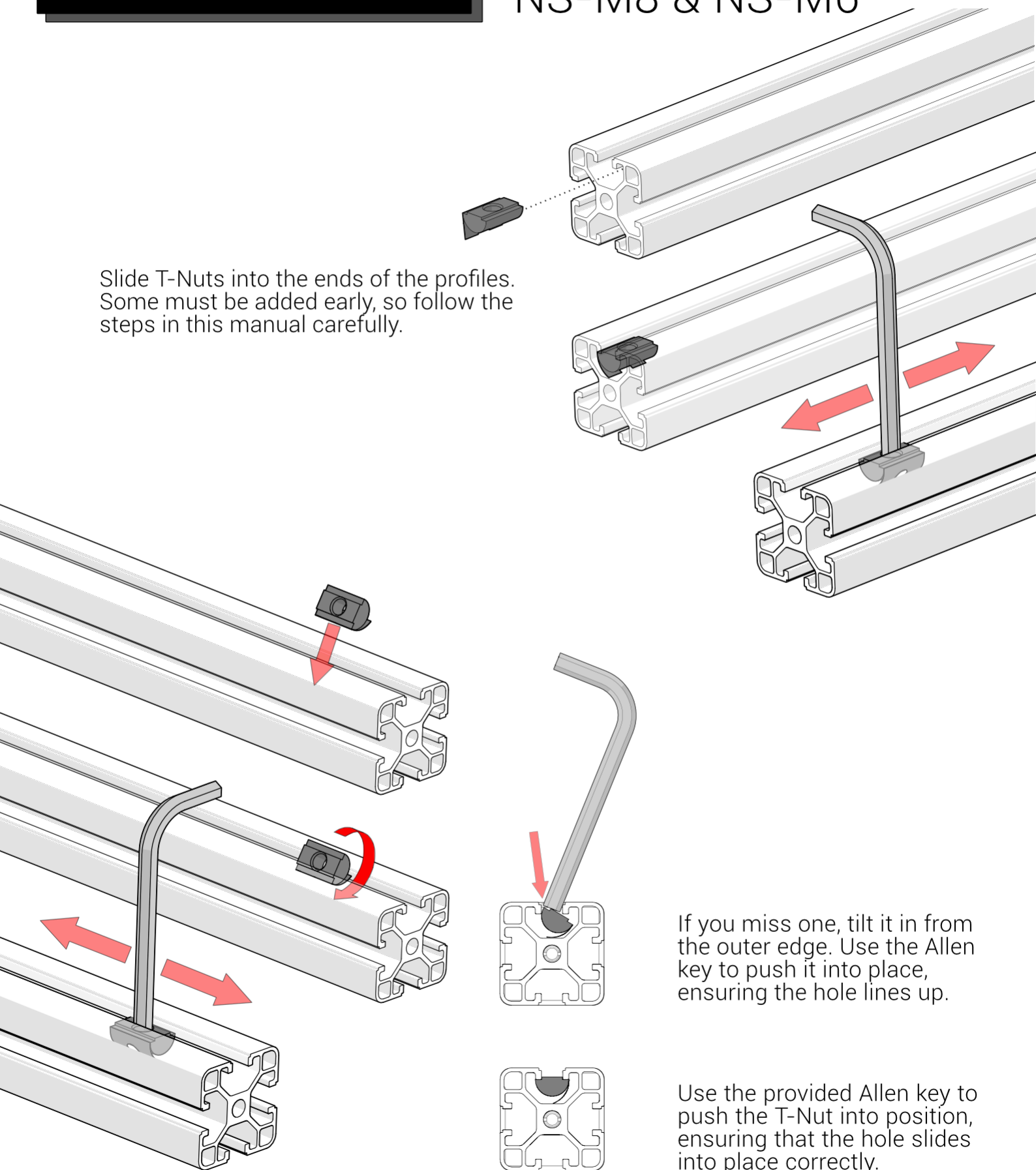

If you miss one, tilt it in from the outer edge. Use the Allen key to push it into place, ensuring the hole lines up.

Use the provided Allen key to push the T-Nut into position, ensuring that the hole slides into place correctly.

# NOTE

## BC-40 & CB-40

These brackets come with guide tabs on the rear. These tabs help align the brackets to the profile when fitted in the same orientation as the profile. When used in the alternate orientation, these tabs are designed to snap off for a flush mount against the profile.

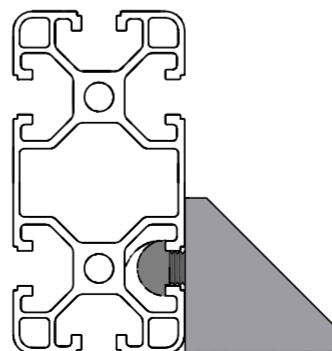
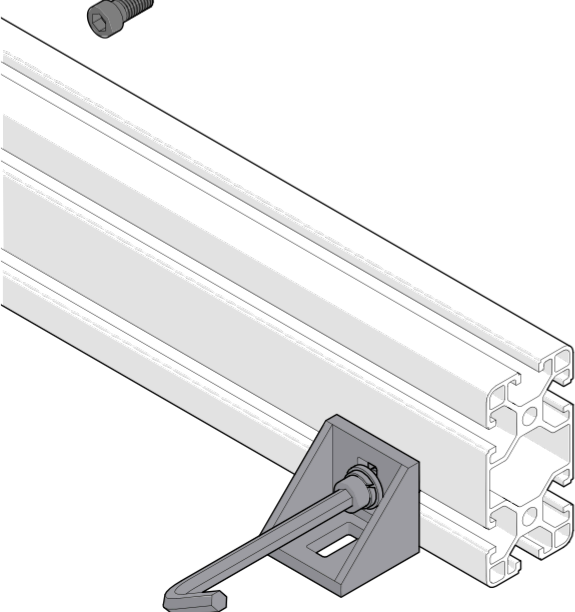
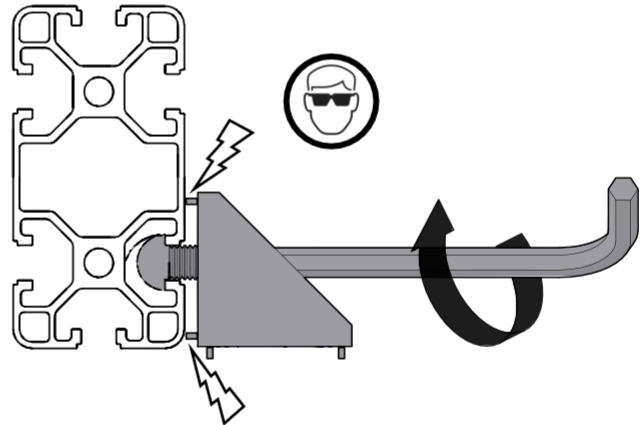
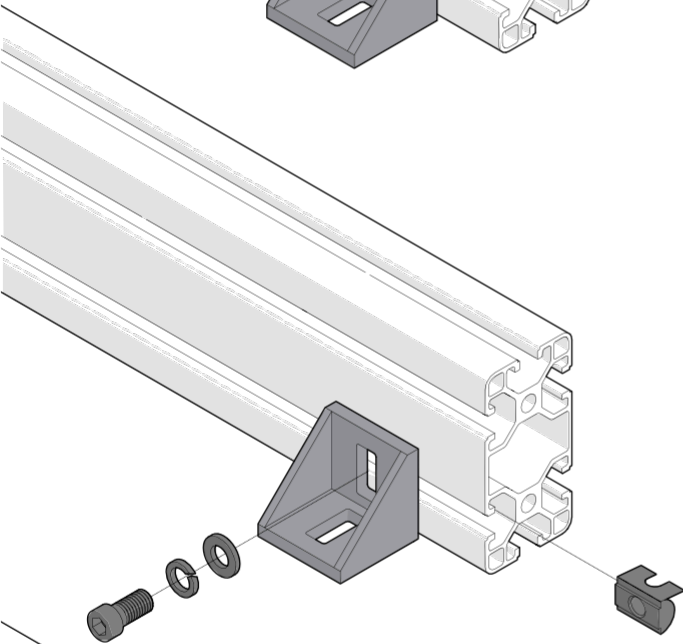
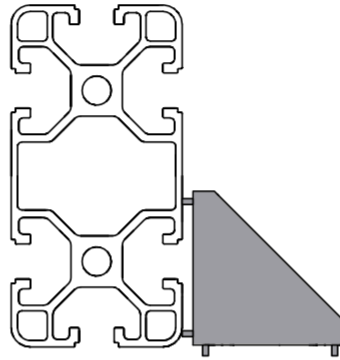
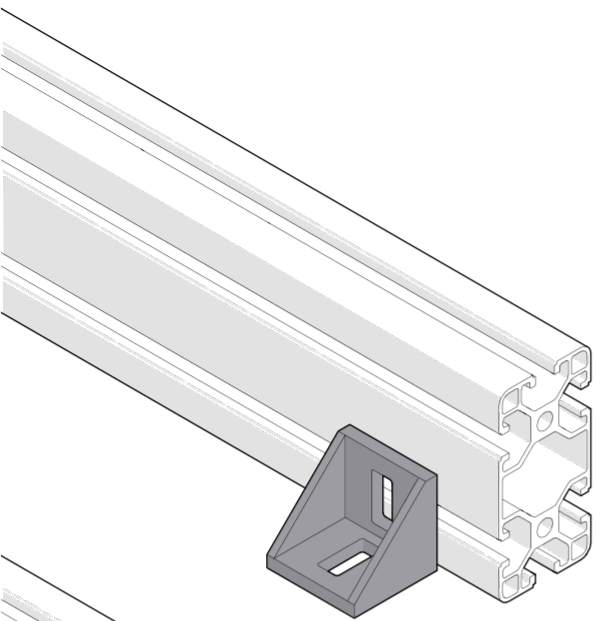

# MOUNTED SINGLE MONITOR STAND - 580MM / 22.8" WIDE

## PART LISTS

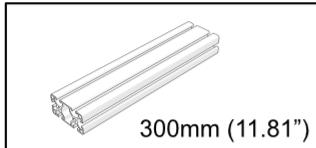
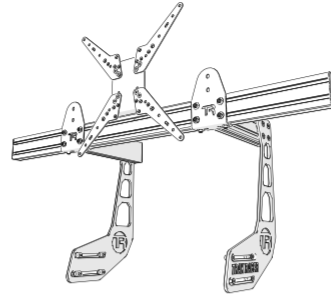

300mm (11.81")

Aluminum Profile

TR-8040-300 x2

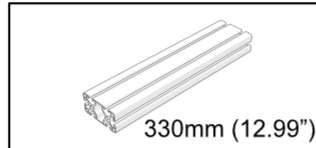

330mm (12.99")

Aluminum Profile

TR-8040-330 x2

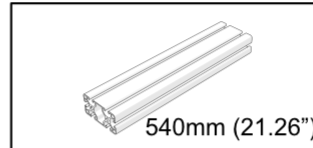

540mm (21.26")

Aluminum Profile

TR-8040-540 x1

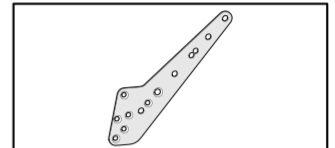

Vesa Extension (Right)

TV-EX-R x2

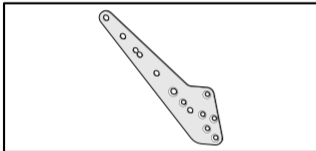

Vesa Extension (Left)

TV-EX-L x2

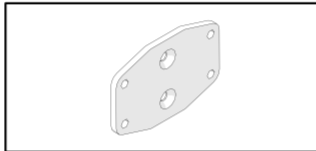

Connecting Bracket Plate

CBP-01 x2

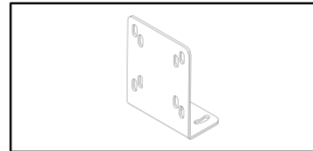

Vesa Mount

TV-VM x1

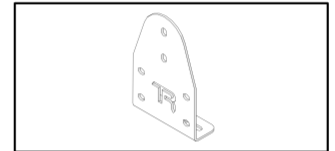

Horizontal Mount  
Connector  
SP-01

x2

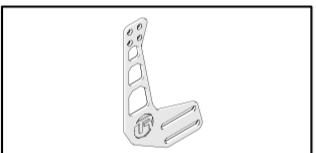

Monitor Side Bracket

MSB x2

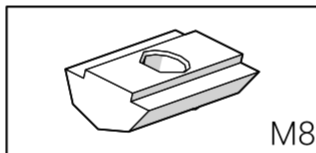

M8

M8 T-Nut

NS-M8 x27



**TRAK RACER**

Logo Sticker

LS x2

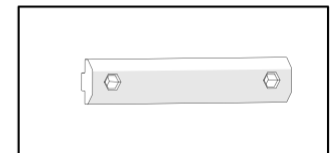

Long Connector T-Nut

LN-M8 x6

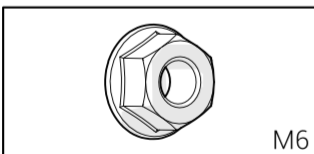

M6

M6 Flange Nut

NL-M6 x8

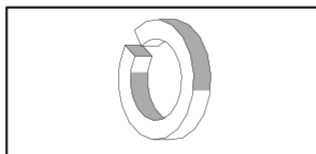

M8 Lock Washer

WL-M8 x23

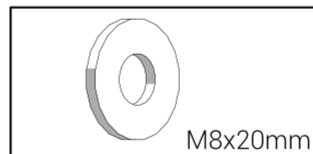

M8x20mm

M8x20 Washer (Flat)

WF-M8-20 x23

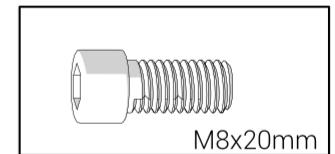

M8x20mm

M8x20 Cap Hex Screw

SH-M8-20 x23

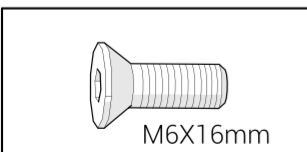

M6X16mm

M6x16 Flat Hex Screw

SF-M6-16 x8

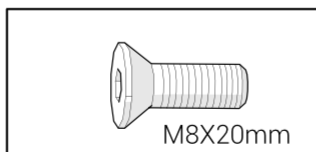

M8X20mm

M8x20 Flat Hex Screw

SF-M8-20 x20

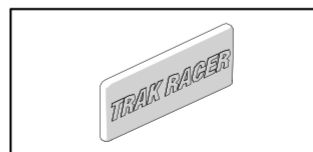

40x80 End Cap

EC-80 x6

\* **NOTE:** Extra hardware may be included as spare parts.

# MS-CM-SIN2





# 1

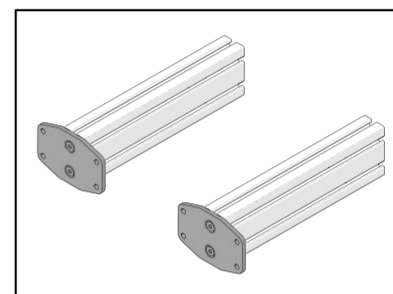
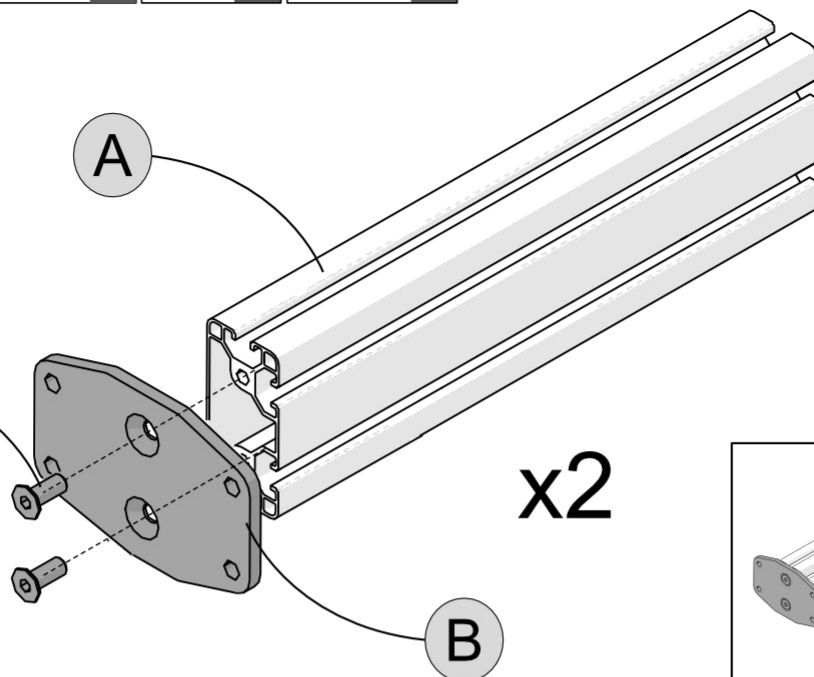
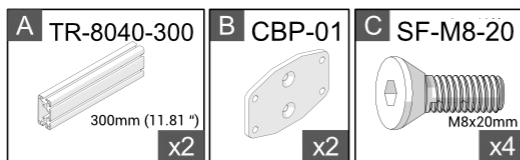

# 2

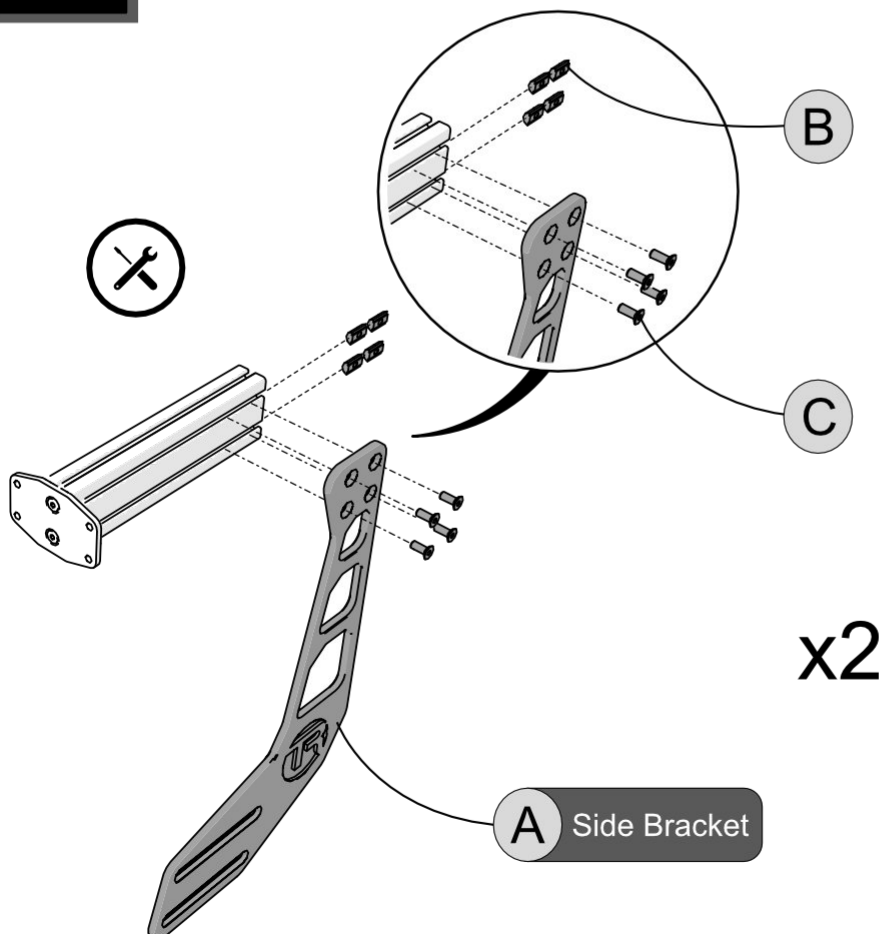
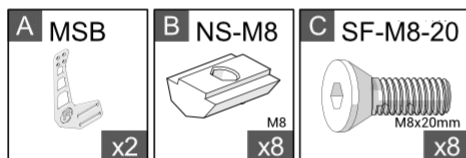

Join part from Step 1 to side bracket (L & R)

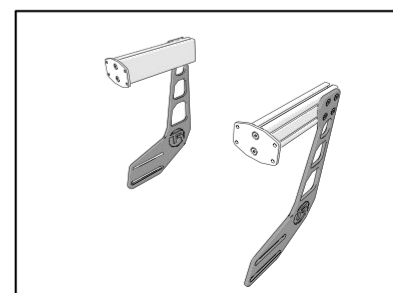



# 3

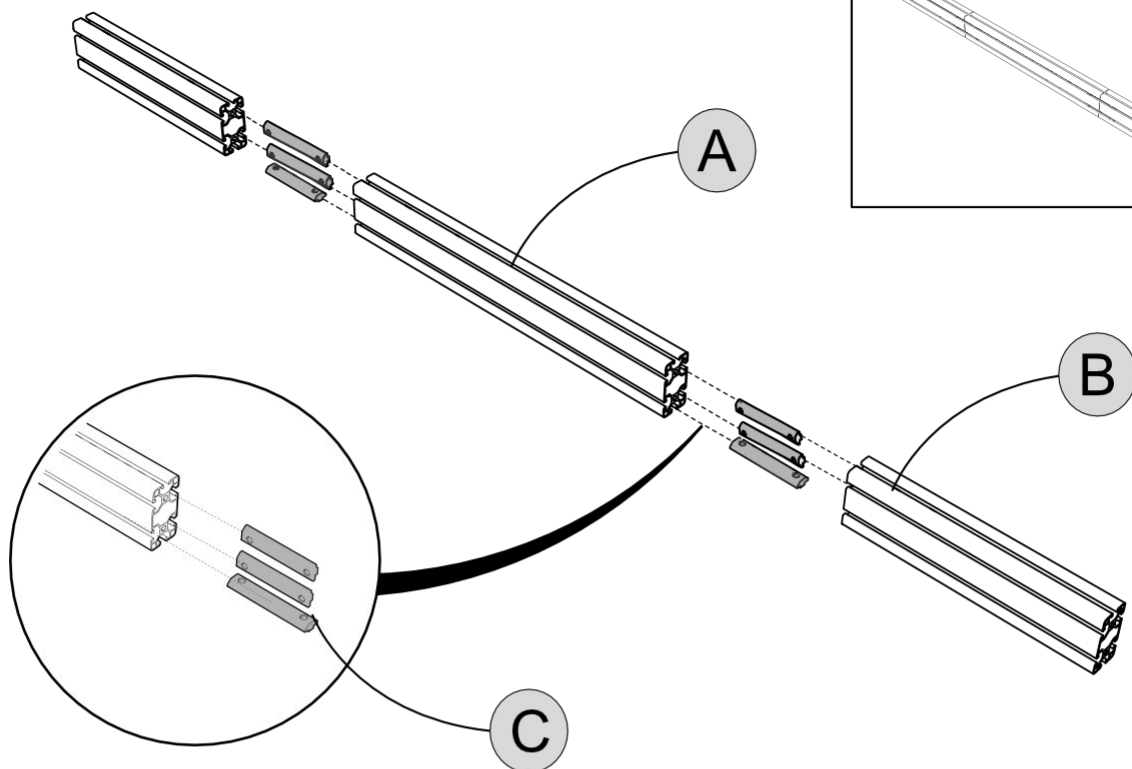

# 4

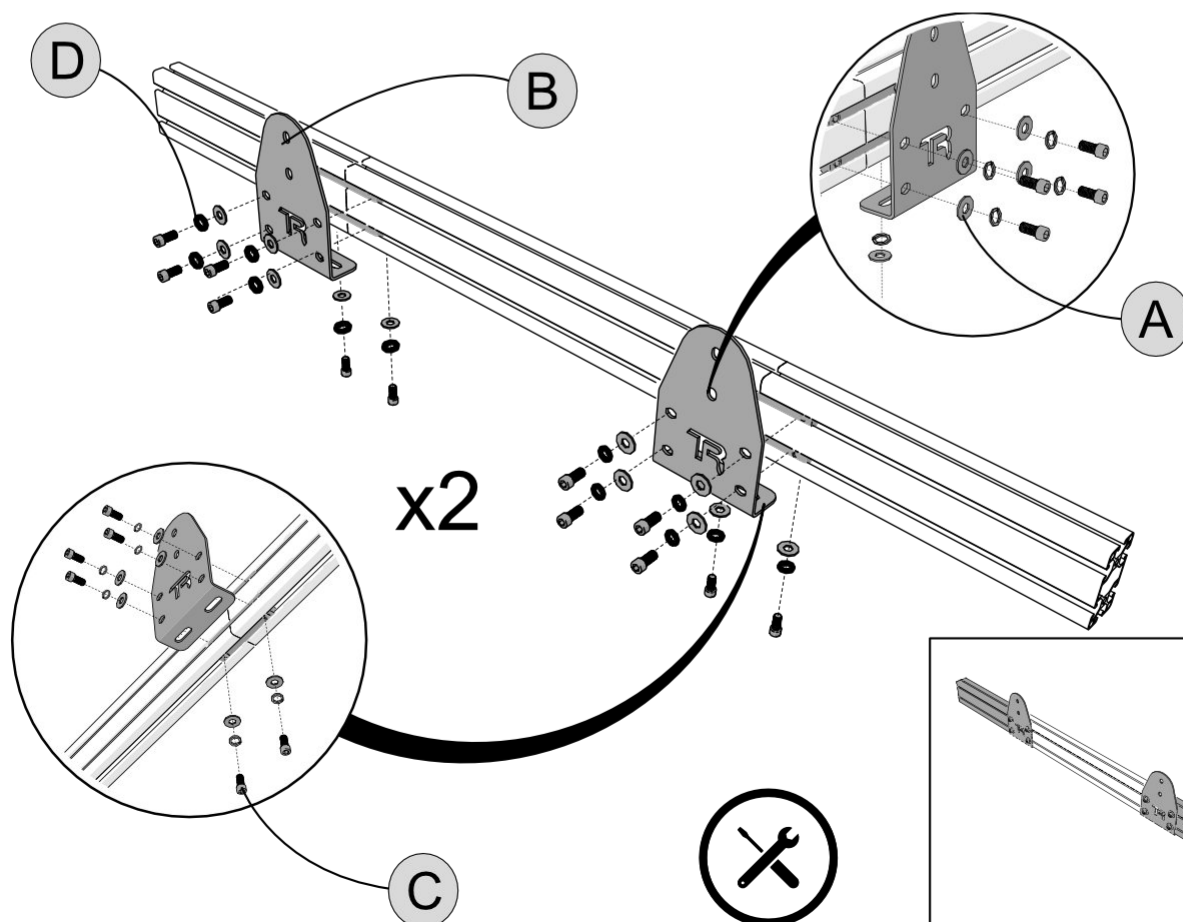
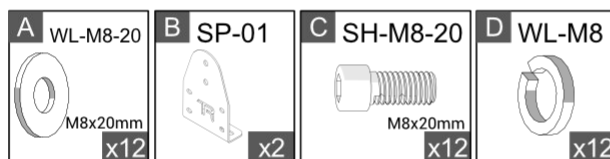

# 5

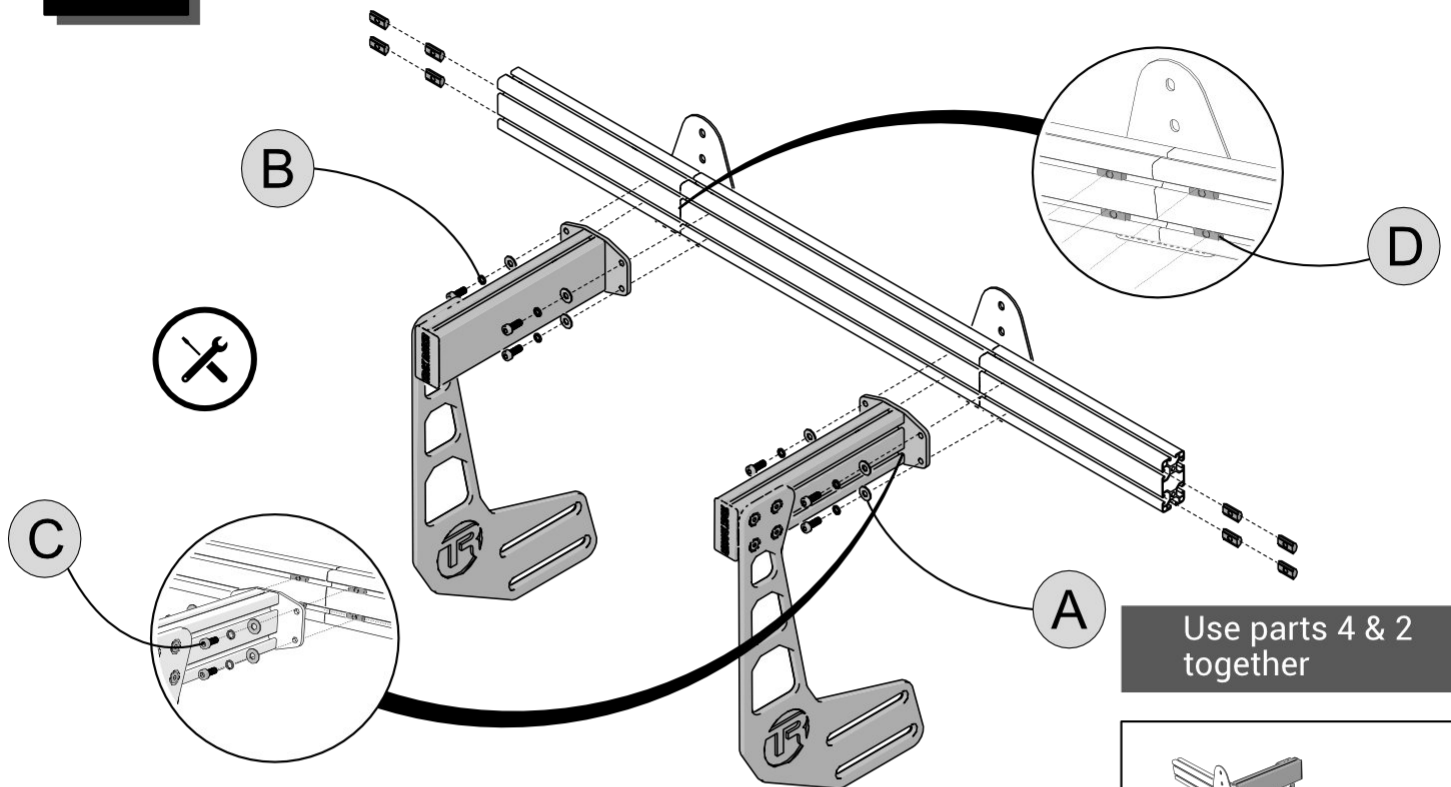
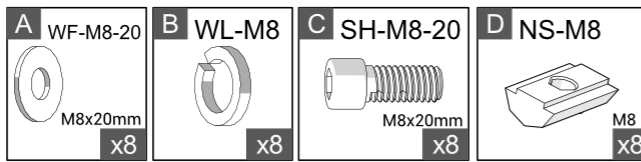

Use parts 4 & 2 together

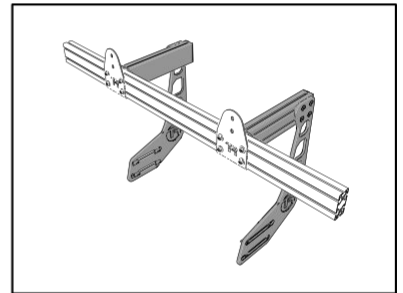

# 6

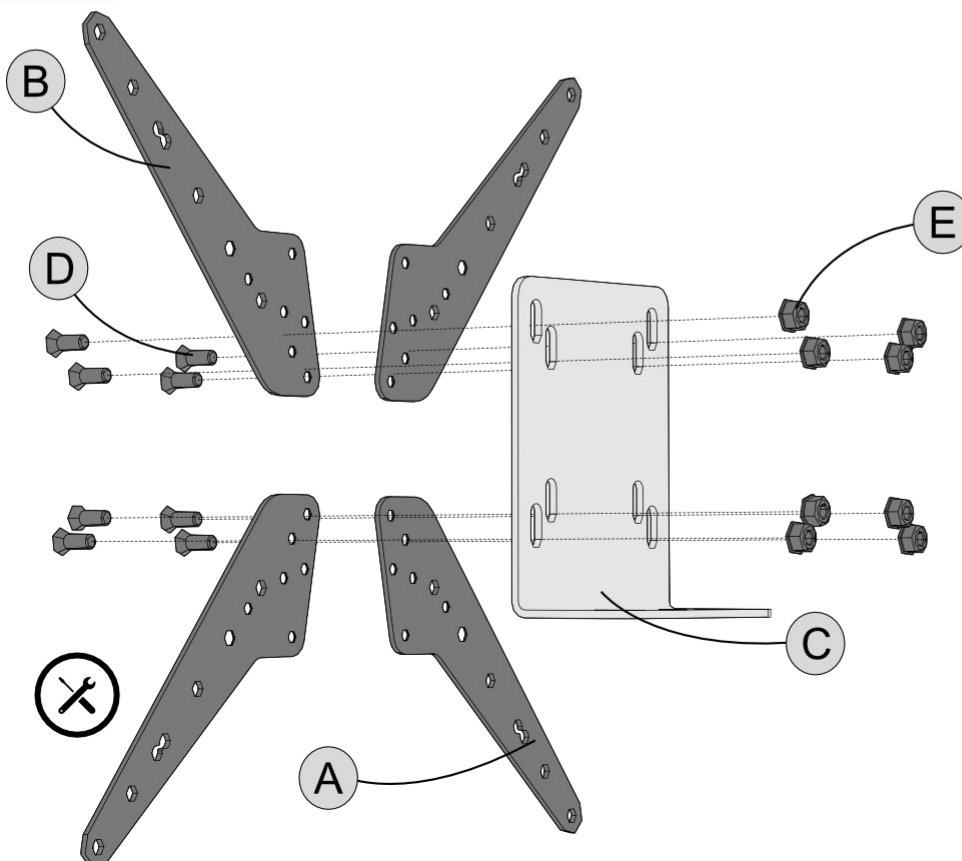
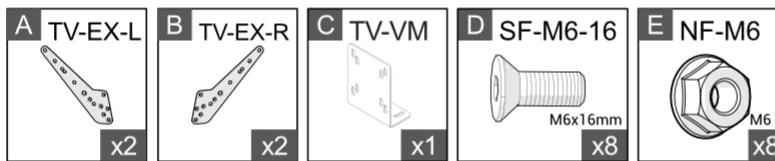

Ignore this step if your monitor does not require these VESA extension plates.

These 4 plates are designed to increase the VESA mounting positions to 200, 300 and 400mm which may not be required for your monitors/TVs.

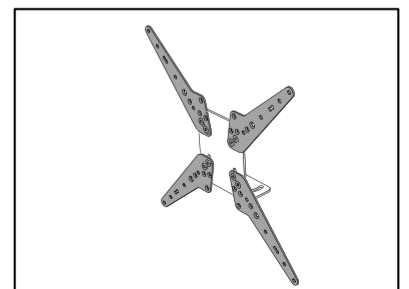

# 7

- |                                    |                      |                                    |                            |
|------------------------------------|----------------------|------------------------------------|----------------------------|
| <b>A</b> WL-M8-20<br>M8x20mm<br>x3 | <b>B</b> WL-M8<br>x3 | <b>C</b> SH-M8-20<br>M8x20mm<br>x3 | <b>D</b> NS-M8<br>M8<br>x3 |
|------------------------------------|----------------------|------------------------------------|----------------------------|

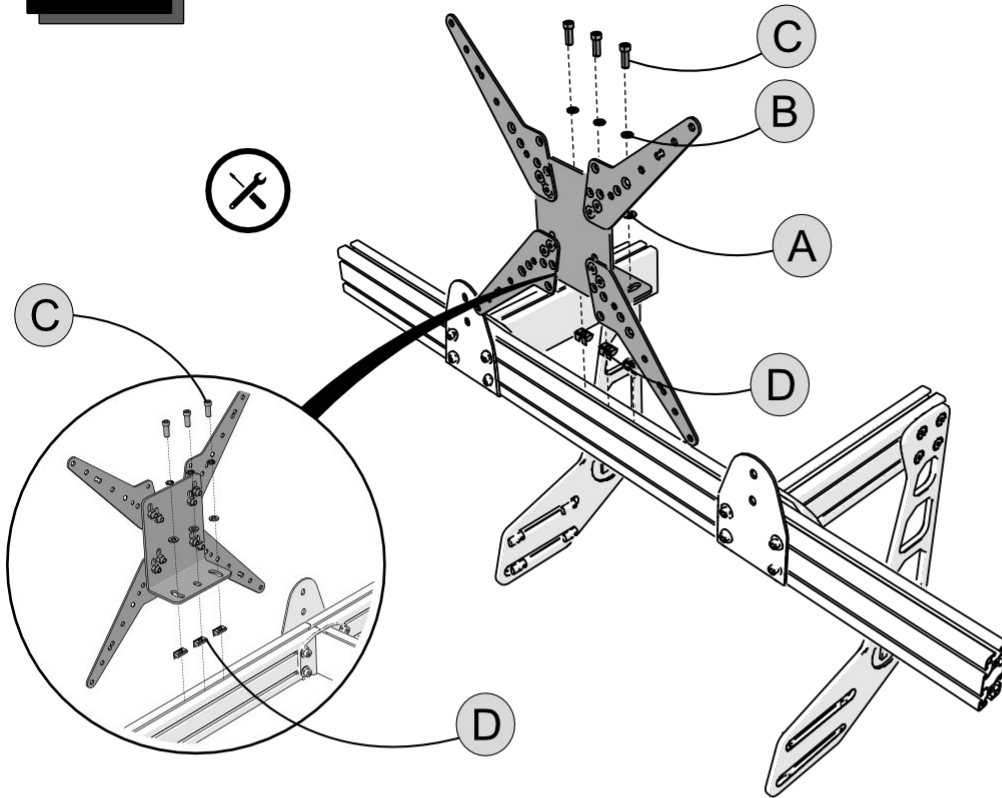

Slide 'D' to the middle First.

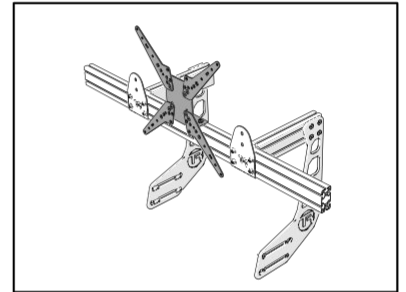

# 8

- |                      |
|----------------------|
| <b>A</b> EC-80<br>x4 |
|----------------------|

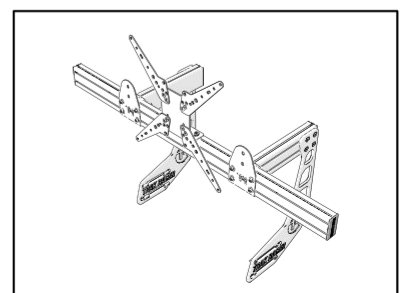
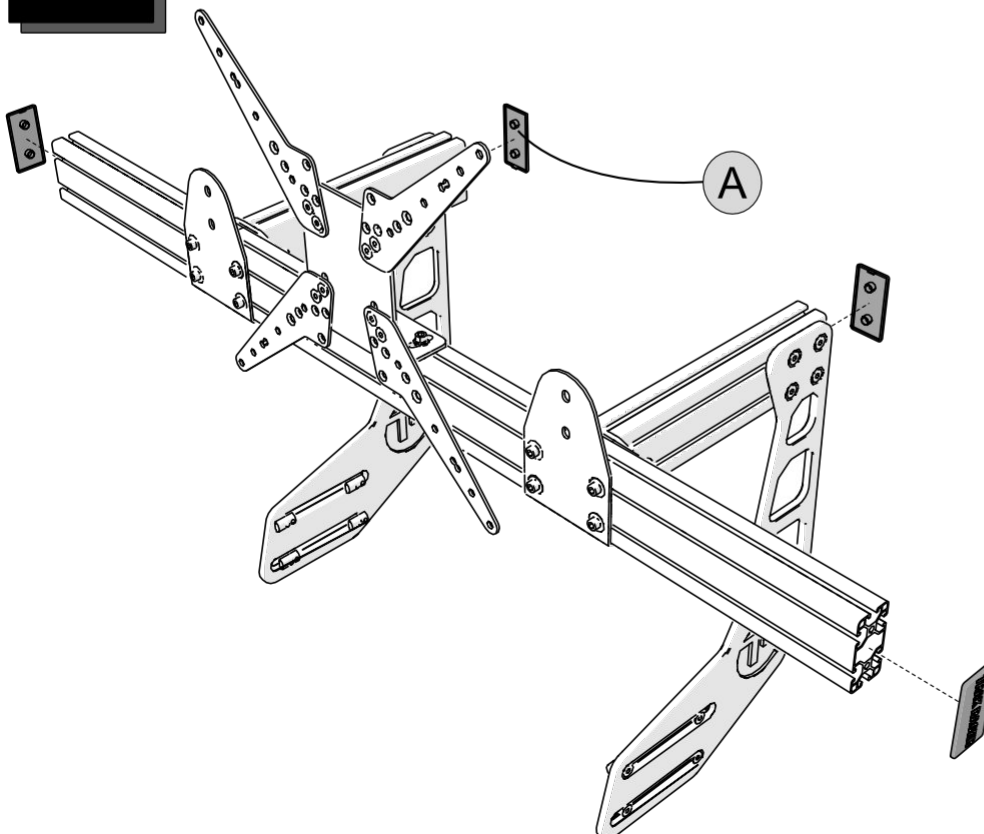

# Overhead Monitor Stand with VESA mount

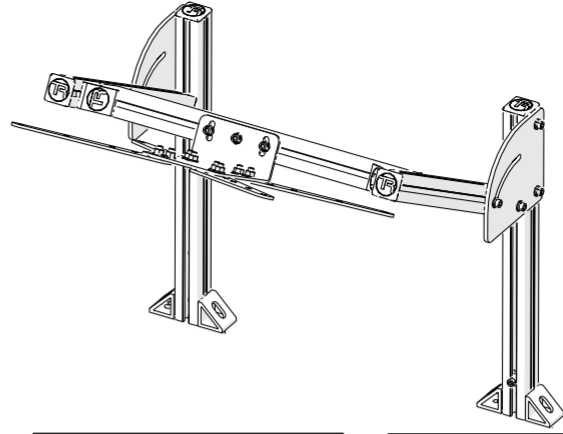

## PART LISTS

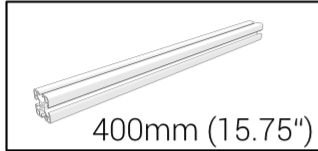

400mm (15.75")

Aluminum Profile

TR-4040-400 x2

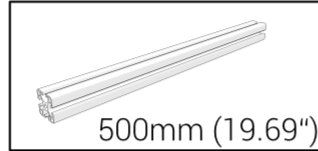

500mm (19.69")

Aluminum Profile

TR-4040-500 x2

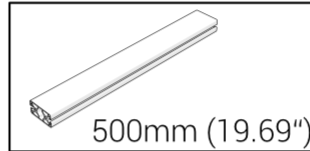

500mm (19.69")

Aluminum Profile

TR-8040-500 x1

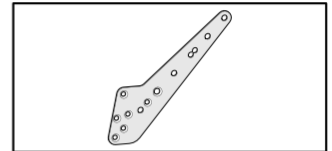

Vesa Extension (Right)

TV-EX-R x2

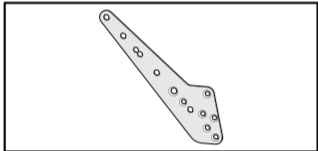

Vesa Extension (Left)

TV-EX-L x2

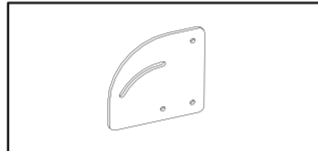

Adjustable Angle Plate

RP-01 x2

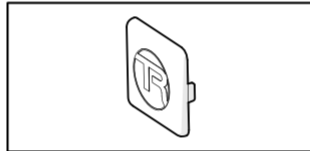

40x40 End Cap

EC-40 x6

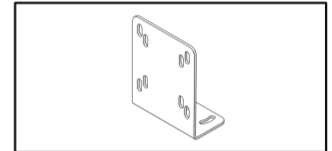

Vesa Mount

TV-VM x1

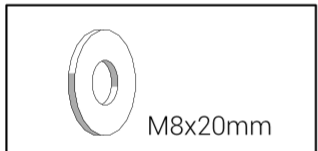

M8x20mm

M8x20 Washer (Flat)

WF-M8-20 x23

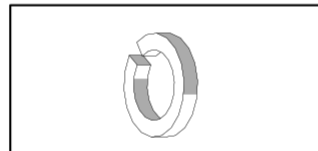

M8 Lock Washer

WL-M8 x23

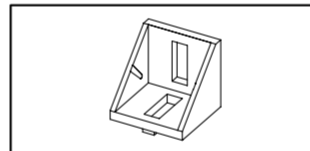

Corner Bracket

BC-40 x4

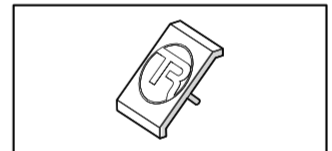

Corner Bracket Cap

BC-40-CAP x4

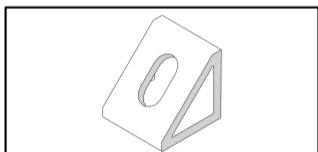

Corner Bracket

BA-40 x4

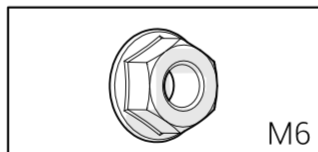

M6

M6 Flange Nut

NF-M6 x8

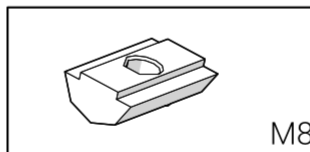

M8

M8 T-Nut

NS-M8 x31

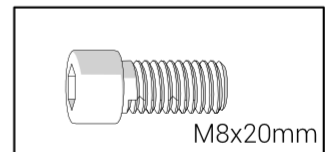

M8x20mm

M8x20 Cap Hex Screw

SH-M8-20 x23

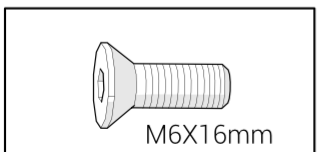

M6x16mm

M6x16 Flat Hex Screw

SF-M6-16 x8

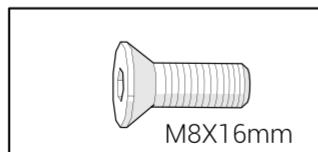

M8x16mm

M8x16 Flat Hex Screw

SF-M8-16 x8

\* **NOTE:** Extra hardware may be included as spare parts

# TR80-4M4



# 1

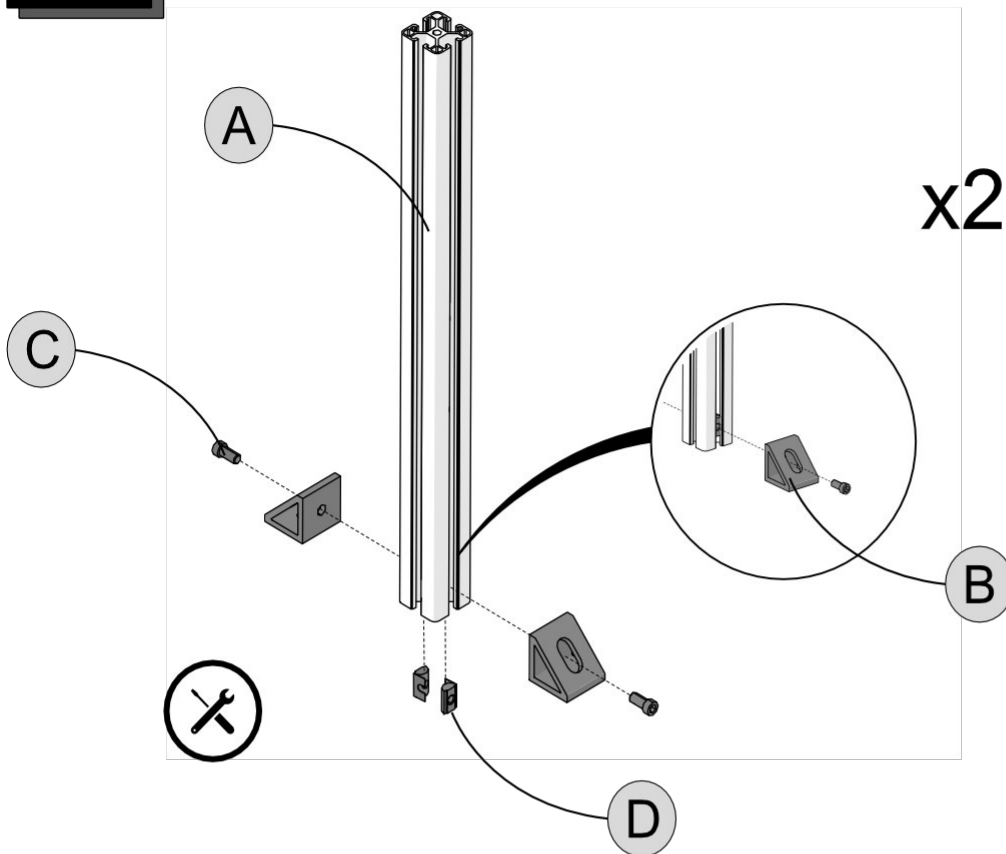
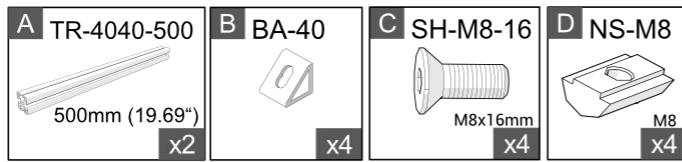

First slide 'D' into position

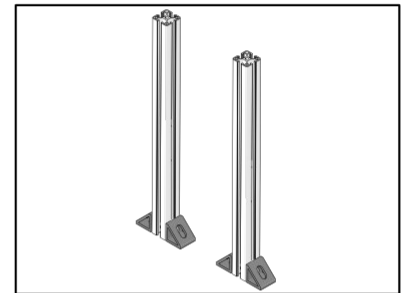

# 2

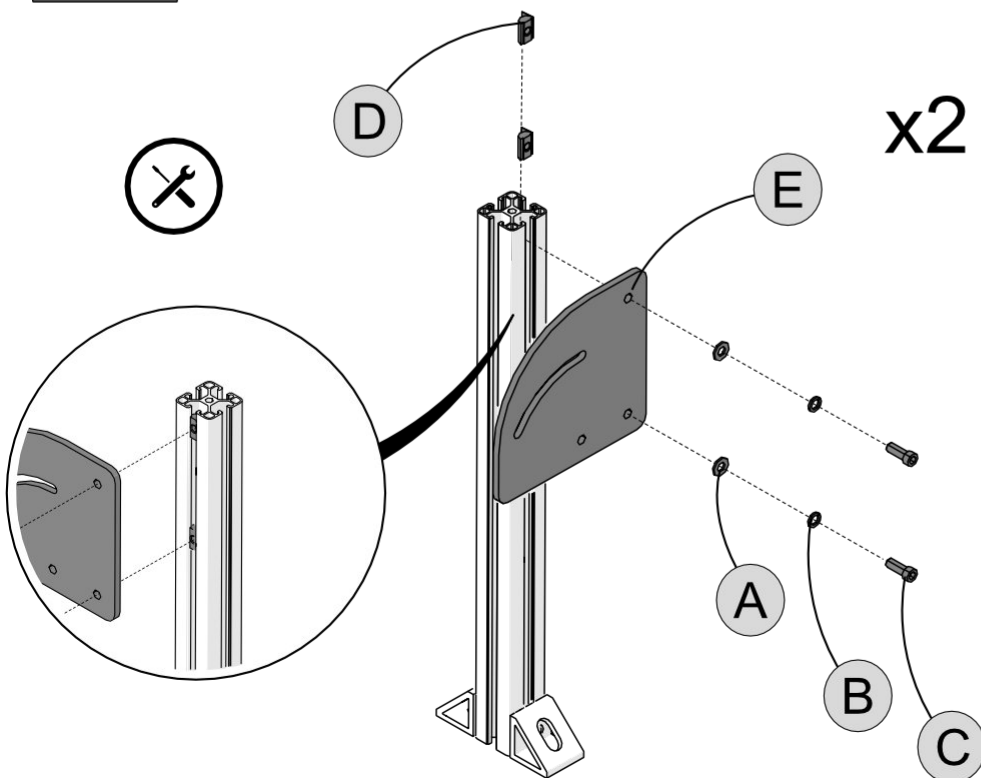
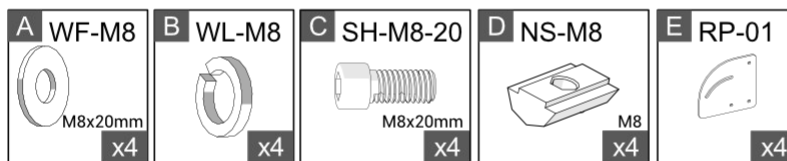

First slide 'D' into position

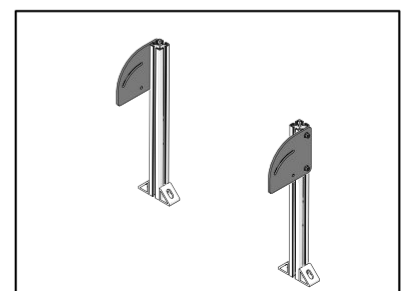

# 3

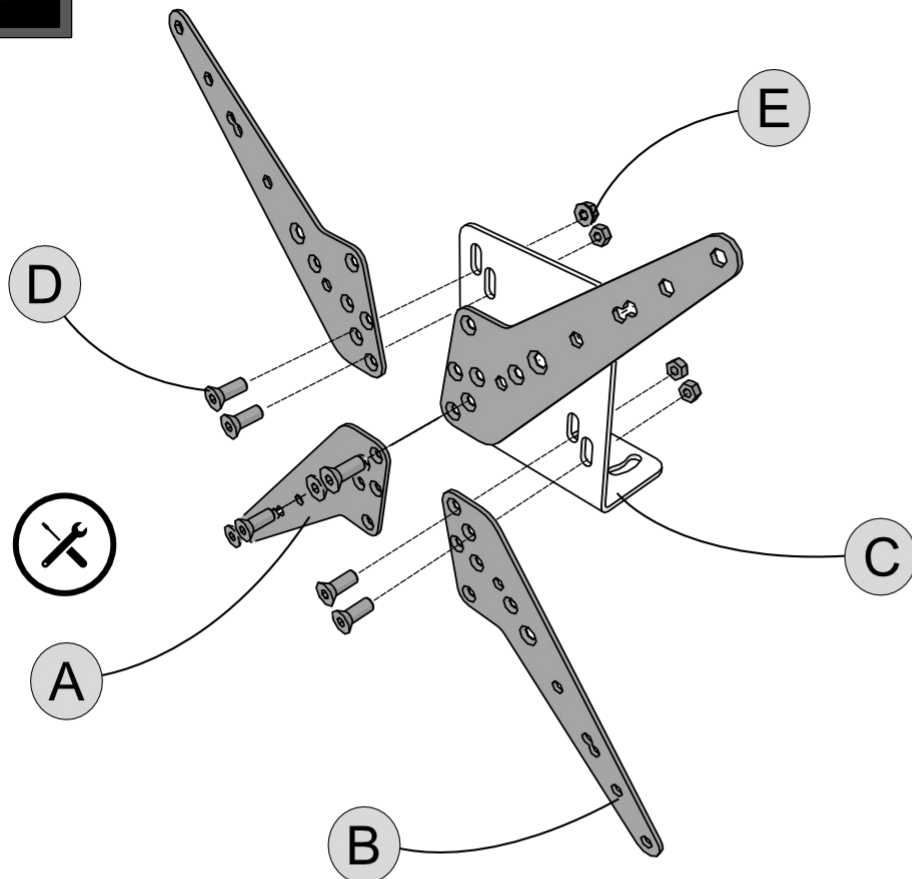
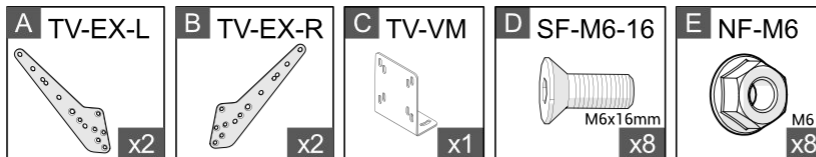

Part 'A' has 2 side variations

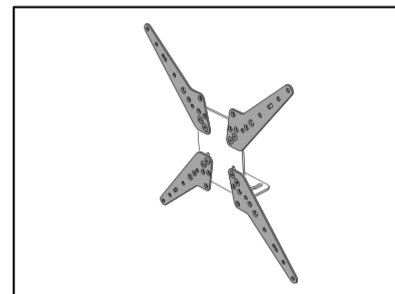

# 4

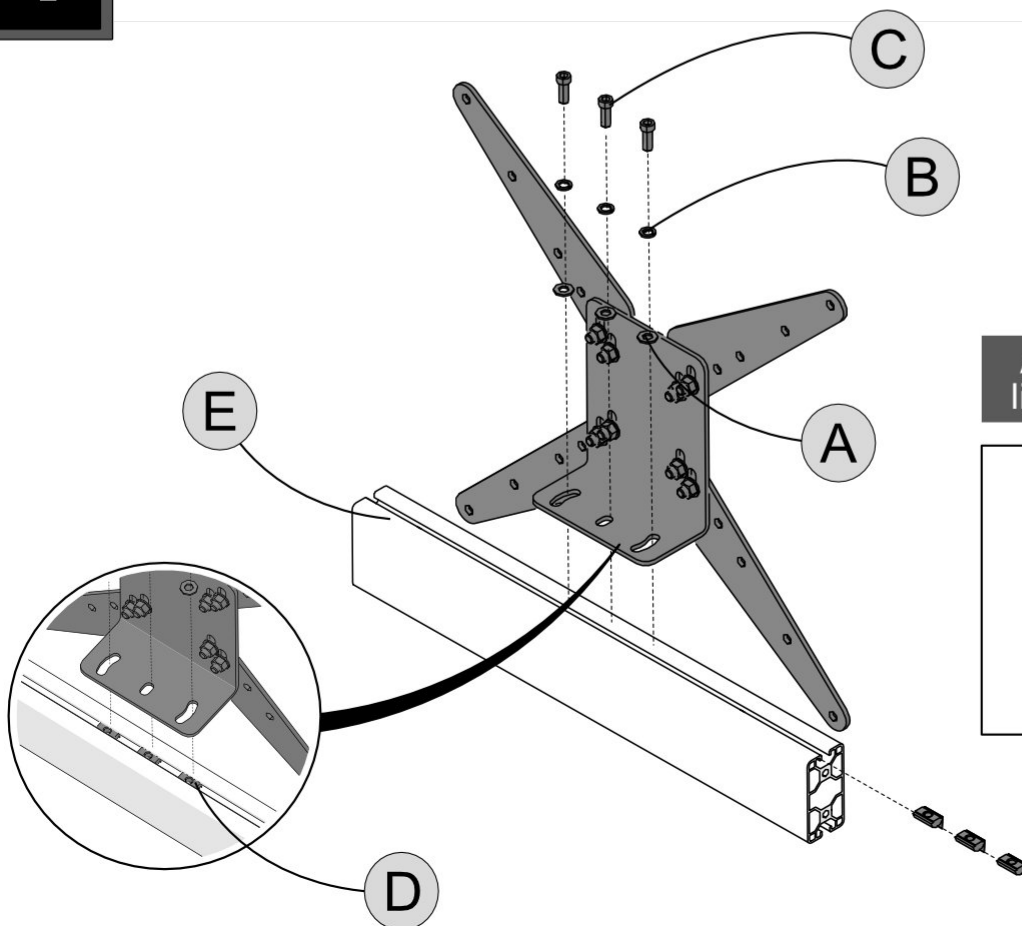
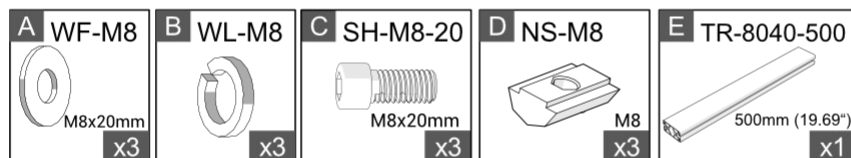

Adjust according to liking/size.

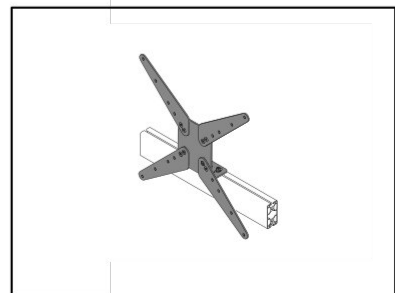

# 5

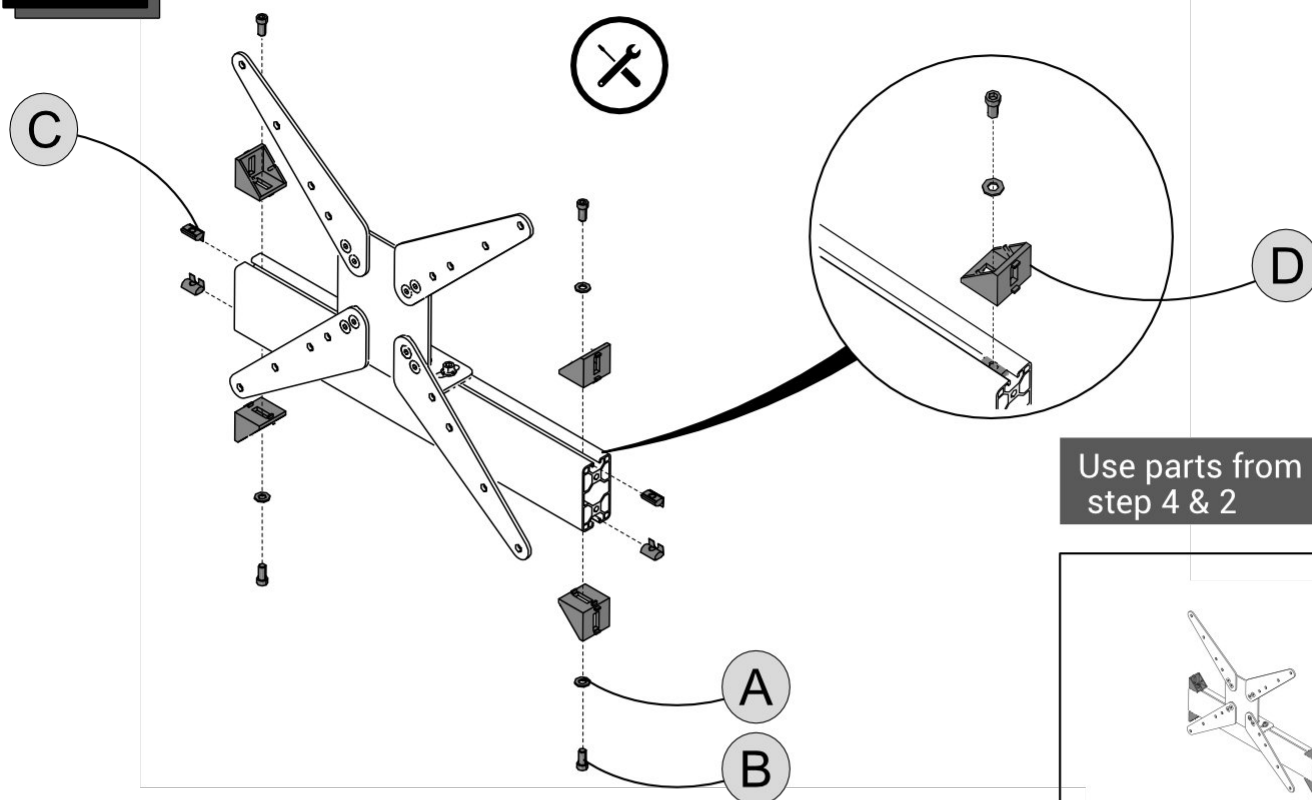
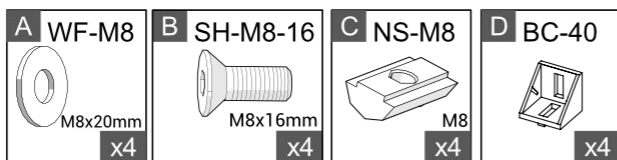

Use parts from  
step 4 & 2

# 6

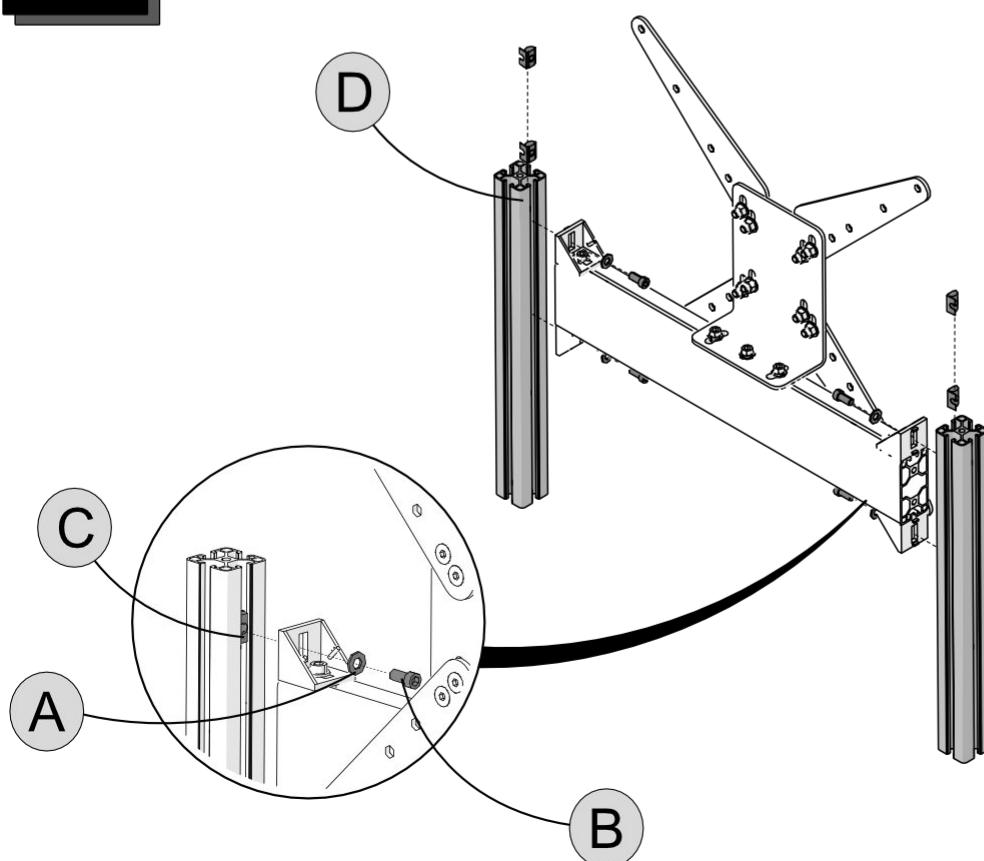
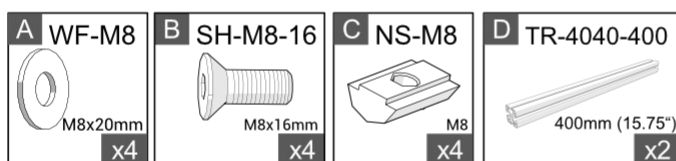



# 7

- |                                 |                      |                                    |                            |
|---------------------------------|----------------------|------------------------------------|----------------------------|
| <b>A</b> WF-M8<br>M8x20mm<br>x4 | <b>B</b> WL-M8<br>x4 | <b>C</b> SH-M8-20<br>M8x20mm<br>x4 | <b>D</b> NS-M8<br>M8<br>x4 |
|---------------------------------|----------------------|------------------------------------|----------------------------|

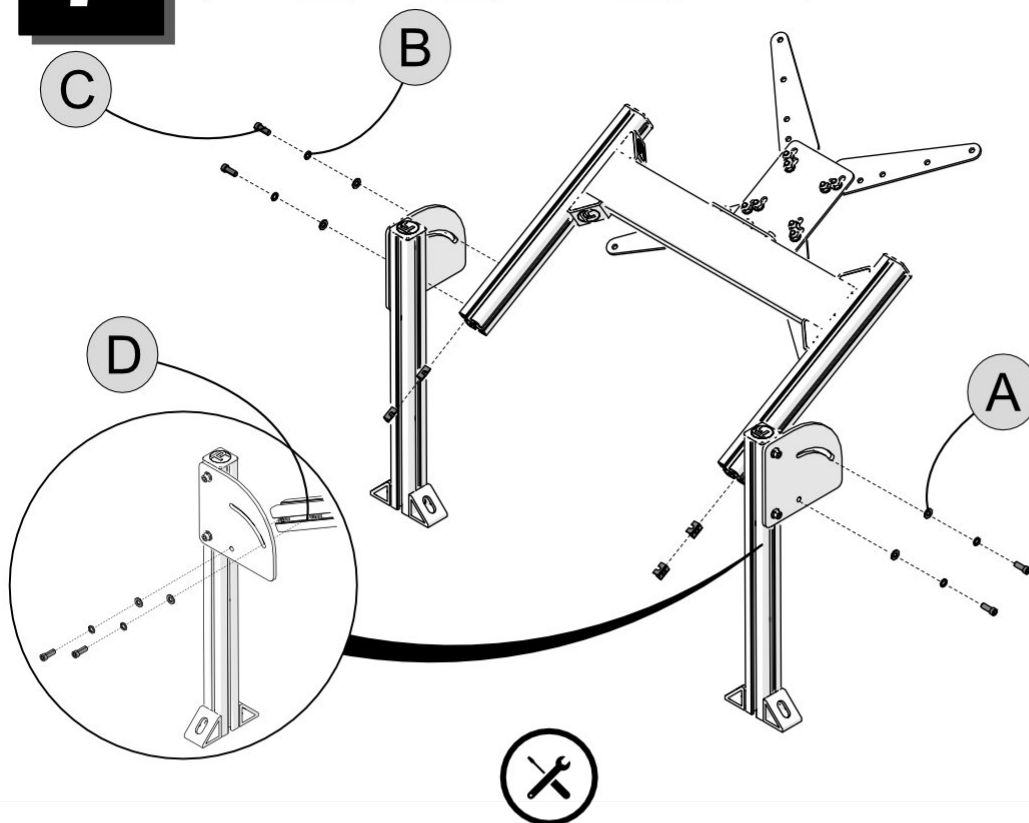

Adjust position angle  
To liking.

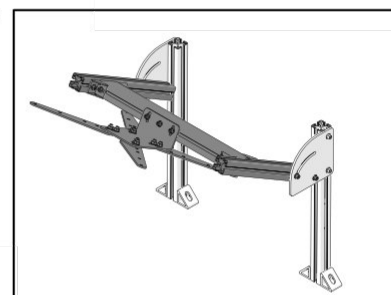

# 8

- |                          |                      |
|--------------------------|----------------------|
| <b>A</b> BC-40-CAP<br>x4 | <b>B</b> EC-40<br>x6 |
|--------------------------|----------------------|

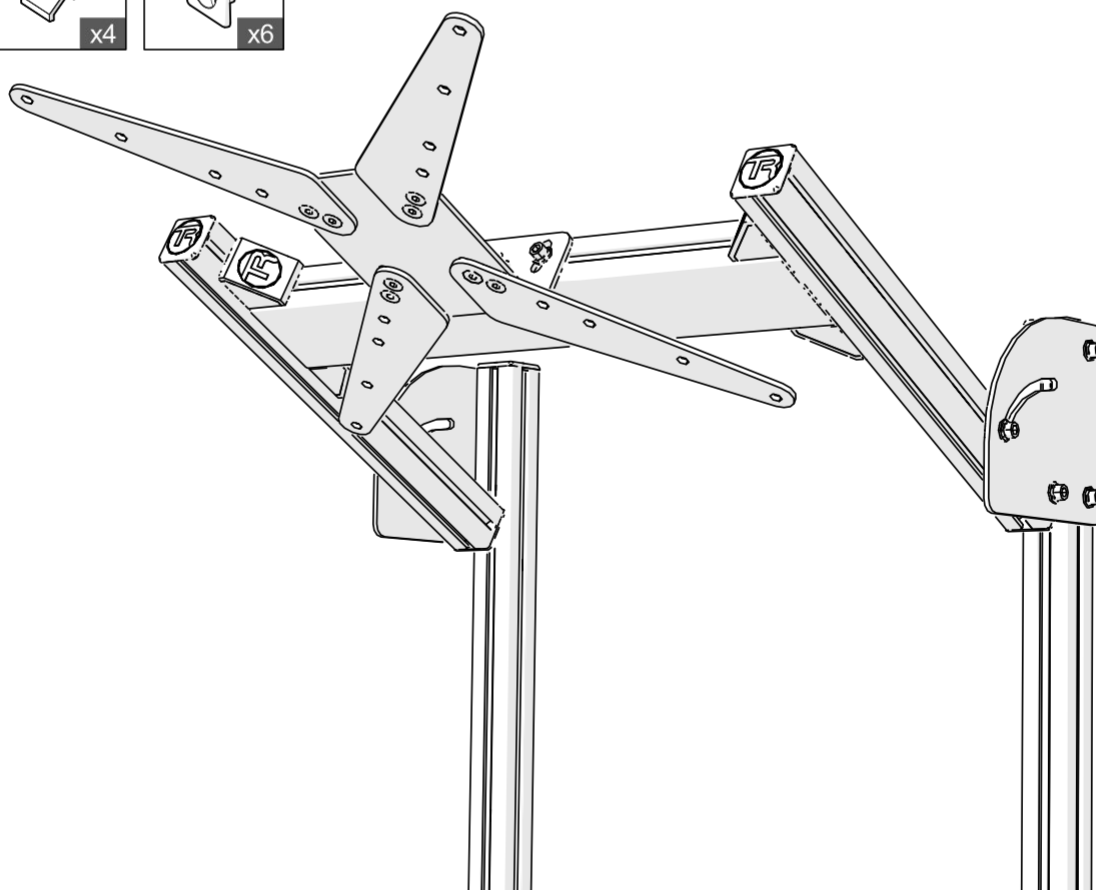

# Single Monitor Stand with Overhead Monitor Stand



MS-CM-SIN2

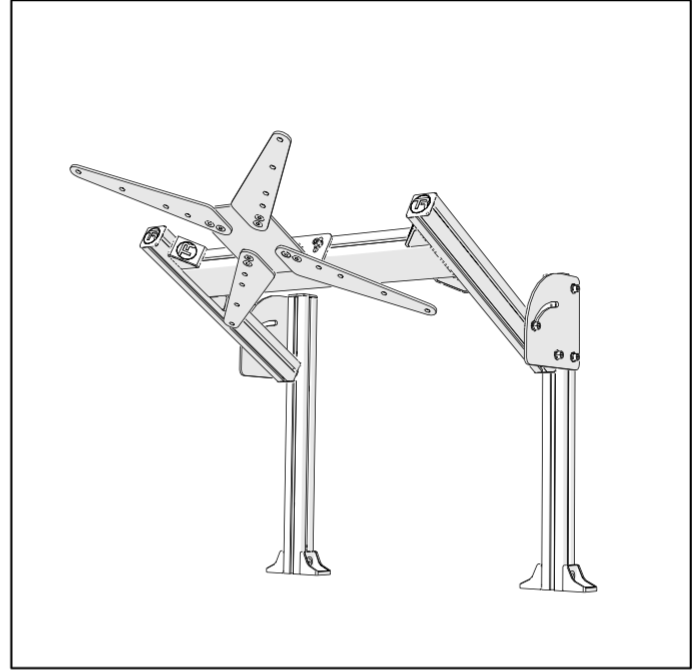

TR80-4M4

## PART LISTS

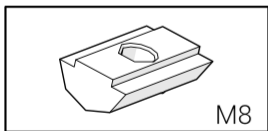

M8

M8 T-Nut

NS-M8

x8

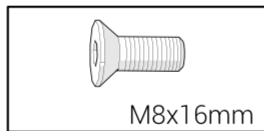

M8x16mm

M8x16 Flat Hex Screw

SF-M8-16

x8



**NOTE:** Some screws and washers may be pre-installed. These are included in the parts list and will need to be loosened and reattached according to the instructions.

If you have any issues, please contact us at [support@trakracer.com](mailto:support@trakracer.com)

# MS-CM-DL2



# 1

**A** SF-M8-16

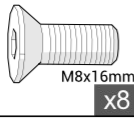

**B** NS-M8

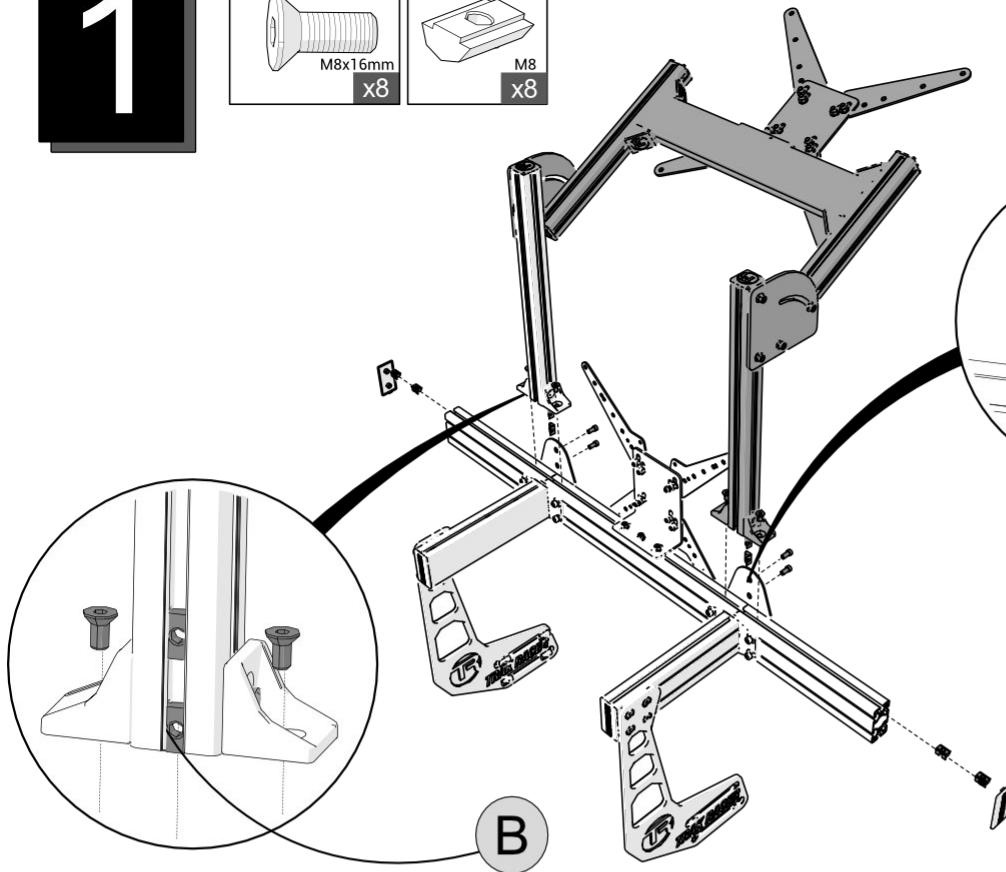
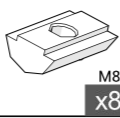

**A**

Slide 'B' to the position First.

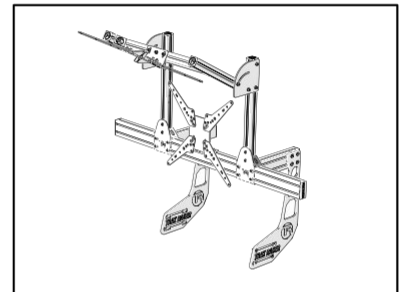

# 2



**IMPORTANT:** If your monitor screws are under 8mm (M8), you will need to use washers (not supplied)

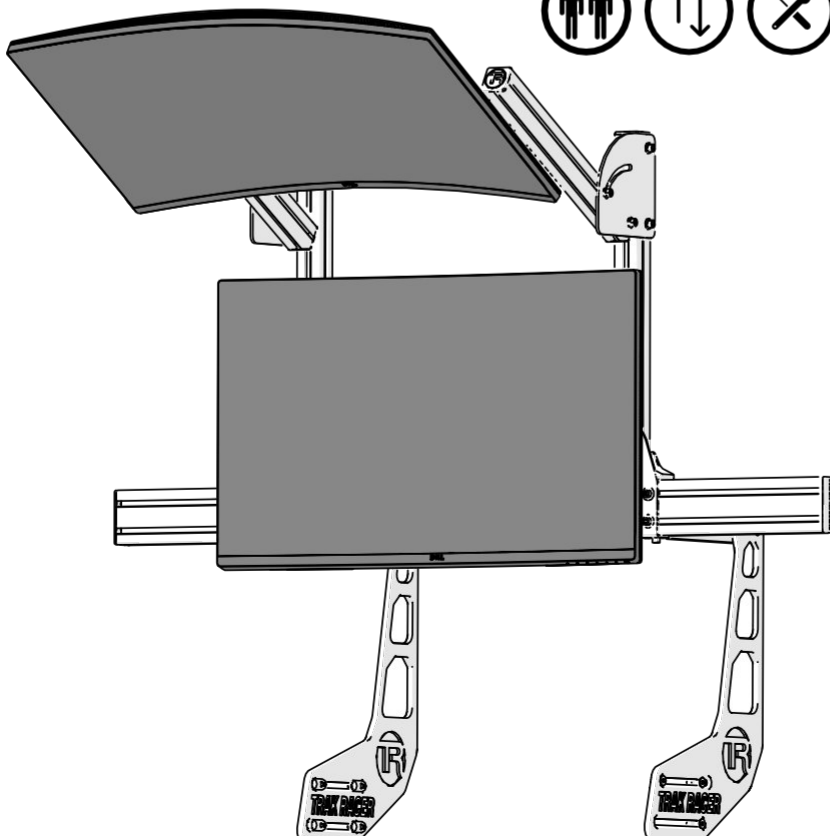

# FINISHED



@trakracer



@trakracer



@trak\_racer