



Rotary Hose End Installation Kit

Structure and Function Instruction Booklet

PN#: 60-58366 (Steel AN Dies)

PN#: 60-58367 (Polycarbonate AN Dies)

Rotary Hose End Installation Kit

Structure and Function Instruction Booklet



KIT INCLUDES:

Hose End Socket
Clamp Sizes:
-4AN, -6AN, -8AN,
-10AN, and -12AN

Hose Clamp Sizes:
-4AN, -6AN, -8AN,
-10AN, and -12AN

Vise Blocks

Plastic Locking Case

Vise Clamp
Lock Ring

Rotating Tool



Various Sizes of Clamping Mechanisms

This Rotary Hose End Installation Kit comes complete with various sizes of hose end sockets and hose clamps. Sizes range from -4AN, -6AN, -8AN, -10AN, and -12AN. The hose end socket and hose clamps can be swapped out of the clamp housings to meet your needs. This kit is offered in two different configurations, polycarbonate (PN: 60-58367) or steel (PN: 60-58366) clamps.



Rotary Hose End Installation Kit

Structure and Function Instruction Booklet



Structure, Assembly, and Disassembly of the Rotary Hose End Installation Kit

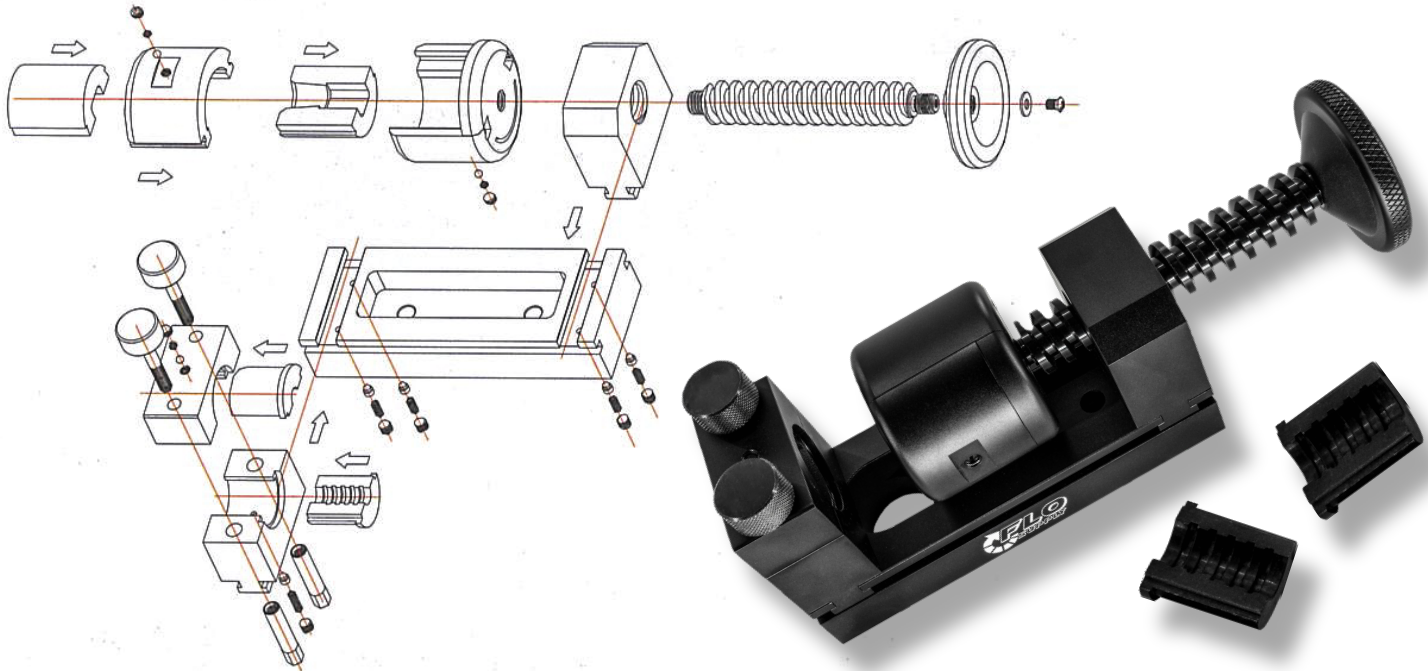

Product Assembly Process - For Hose End Socket Installation

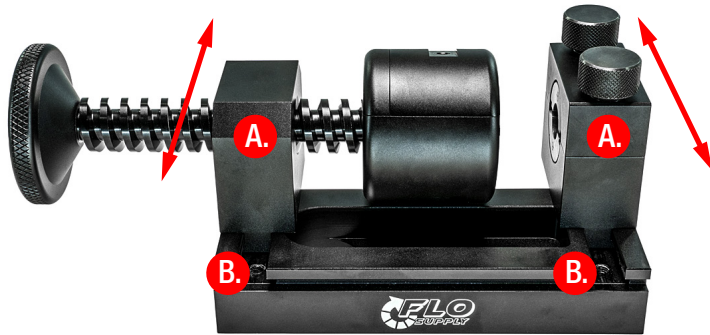

- A.** Jig components can move forward and backwards
- B.** Steel bearings and detents hold jig components in place

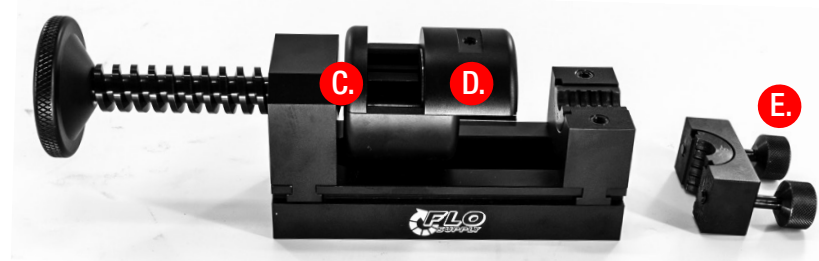

- C.** Back off auger to provide adequate clearance for opening of socket housing
- D.** Slide open hose end socket clamp housing
- E.** Remove thumb screws to open vise

Rotary Hose End Installation Kit

Structure and Function Instruction Booklet



Hose End Socket Hose Installation

Step 1. Prepare work materials by selecting the appropriate jigs that match the size of the hose to be assembled. Insert by sliding jigs into clamp and socket housing.

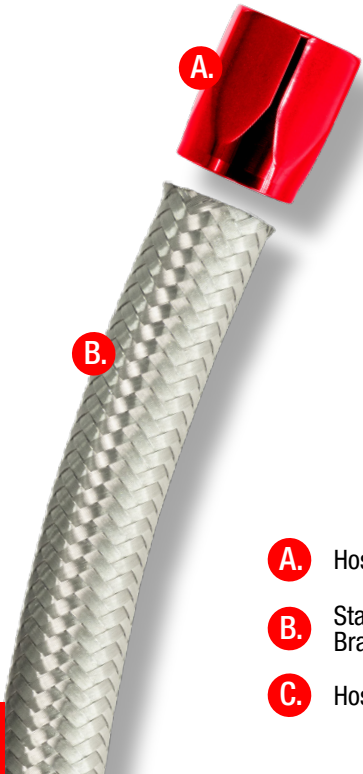

A. Hose End Socket

B. Stainless Steel Braided Hose

C. Hose Clamps

D. Hose End Clamps

E. Hose End Socket Clamp Housing

F. Hose Clamp Housing

Step 2. Place the hose end socket into clamp housing with the open hose end towards the hose. Slide the socket end clamp housing into the closed position. Place the braided hose into the hose clamp. Adjust the hose to length. Secure hose clamp housing with thumb screws.



B. Secure Socket Clamp Housing with Screw

C. Place Braided Hose into Hose Clamp

D. Secure Hose Clamp Housing Cover with Thumb Screws

A. Place Hose End Socket into Socket Housing

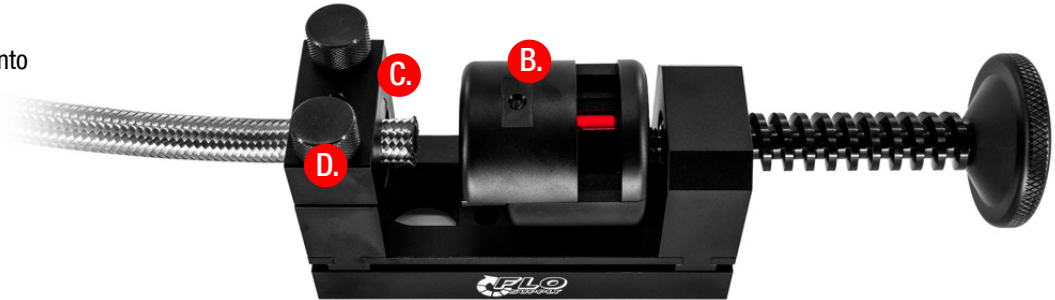

Rotary Hose End Installation Kit

Structure and Function Instruction Booklet



Step 3. Turn the hand wheel clockwise until the socket housing stops against the hose clamp housing. Remove the top of the socket housing by moving it towards the left. Remove hose clamp housing by turning the thumb screws counter clockwise to remove the assembled hose.

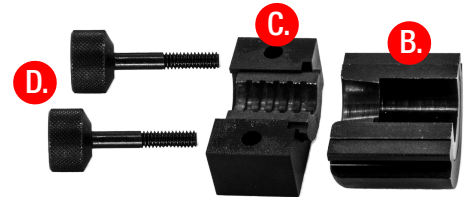
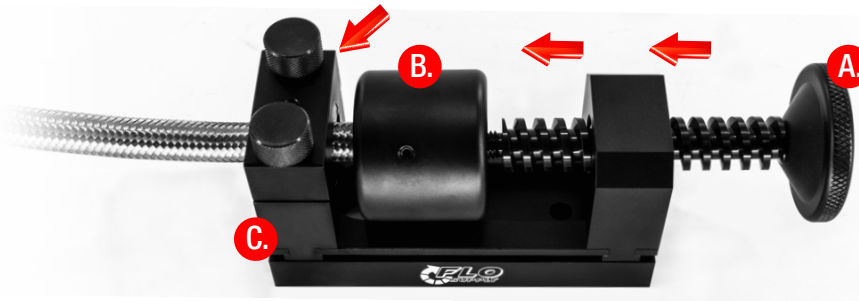

- A.** Hand Wheel
- B.** Socket Clamp Housing
- C.** Hose Clamp Housing
- D.** Thumb Screws

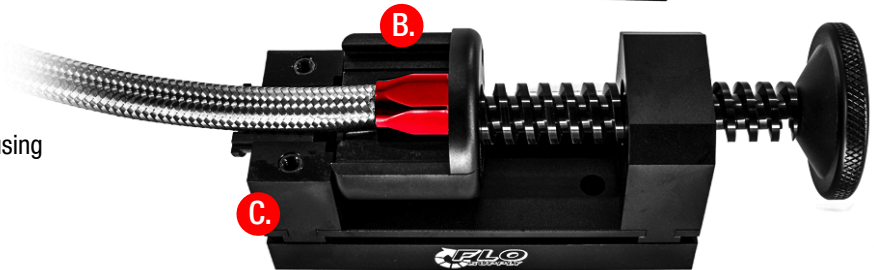

Vise Clamp Option for Screwing Hose Into the Hose Socket

This tool can quickly become a vise clamp tool for simplifying the step of screwing the hose end into the hose socket with out marring the anodized finish.

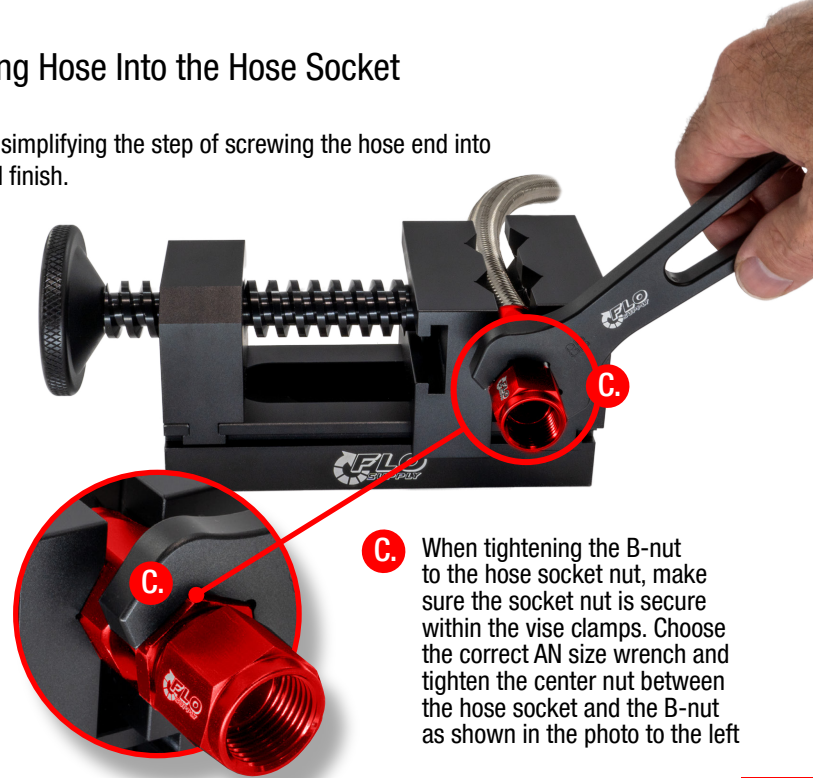
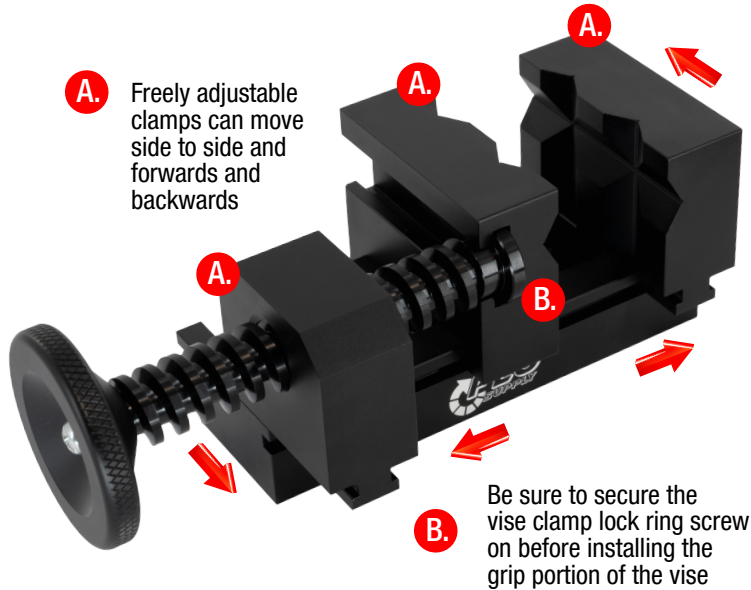



305 SOUTH 28TH STREET | WACO, TX 76710

SALES@FLOSUPPLY.COM
FLOSUPPLY.COM | (254) 848-4800

FLO SUPPLY, A DIVISION OF NITRO DAVE'S LLC

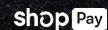

EXCLUSIONS MAY APPLY.
ITEMS SUBJECT TO CHANGE
WITHOUT NOTICE.